



US00D537639S

(12) **United States Design Patent** (10) **Patent No.:** **US D537,639 S**
Mayne (45) **Date of Patent:** **** Mar. 6, 2007**

(54) **LETTER FRAME**

(76) Inventor: **Larry Lee Mayne**, 140-D Private Dr.,
54, South Point, OH (US) 45680

(**) Term: **14 Years**

(21) Appl. No.: **29/239,129**

(22) Filed: **Sep. 26, 2005**

(51) **LOC (8) Cl.** **06-04**

(52) **U.S. Cl.** **D6/307**

(58) **Field of Classification Search** D6/300,
D6/307; D18/24, 25, 28, 32, 33; 101/298-399;
715/535; 400/484

See application file for complete search history.

(56) **References Cited**

U.S. PATENT DOCUMENTS

D221,306 S * 7/1971 Preble et al. D18/24
4,842,921 A * 6/1989 Sorko-Ram 428/187

* cited by examiner

Primary Examiner—Caron D. Veynar
Assistant Examiner—Sydney R. Buffalow

(74) *Attorney, Agent, or Firm*—Curatolo Sidoti Co., LPA;
Joseph G. Curatolo; Salvatore A. Sidoti

(57) **CLAIM**

The ornamental design for a letter frame, as shown and described.

DESCRIPTION

FIG. 1 is a front perspective view of one embodiment of the letter frame.

FIG. 2 is a front view of the embodiment of the letter frame shown in FIG. 1.

FIG. 3 is a side view of the embodiment of the letter frame shown in FIG. 1.

FIG. 4 is a top view of the embodiment of the letter frame shown in FIG. 1.

FIG. 5 is a bottom view of the embodiment of the letter frame shown in FIG. 1; and,

FIG. 6 is a back view of the embodiment of the letter frame shown in FIG. 1.

The broken lines define the bounds of the claimed design, but do not form part of the claimed design.

The design as shown and described is a letter frame, such as a picture frame, photoframe or shadow box.

1 Claim, 1 Drawing Sheet

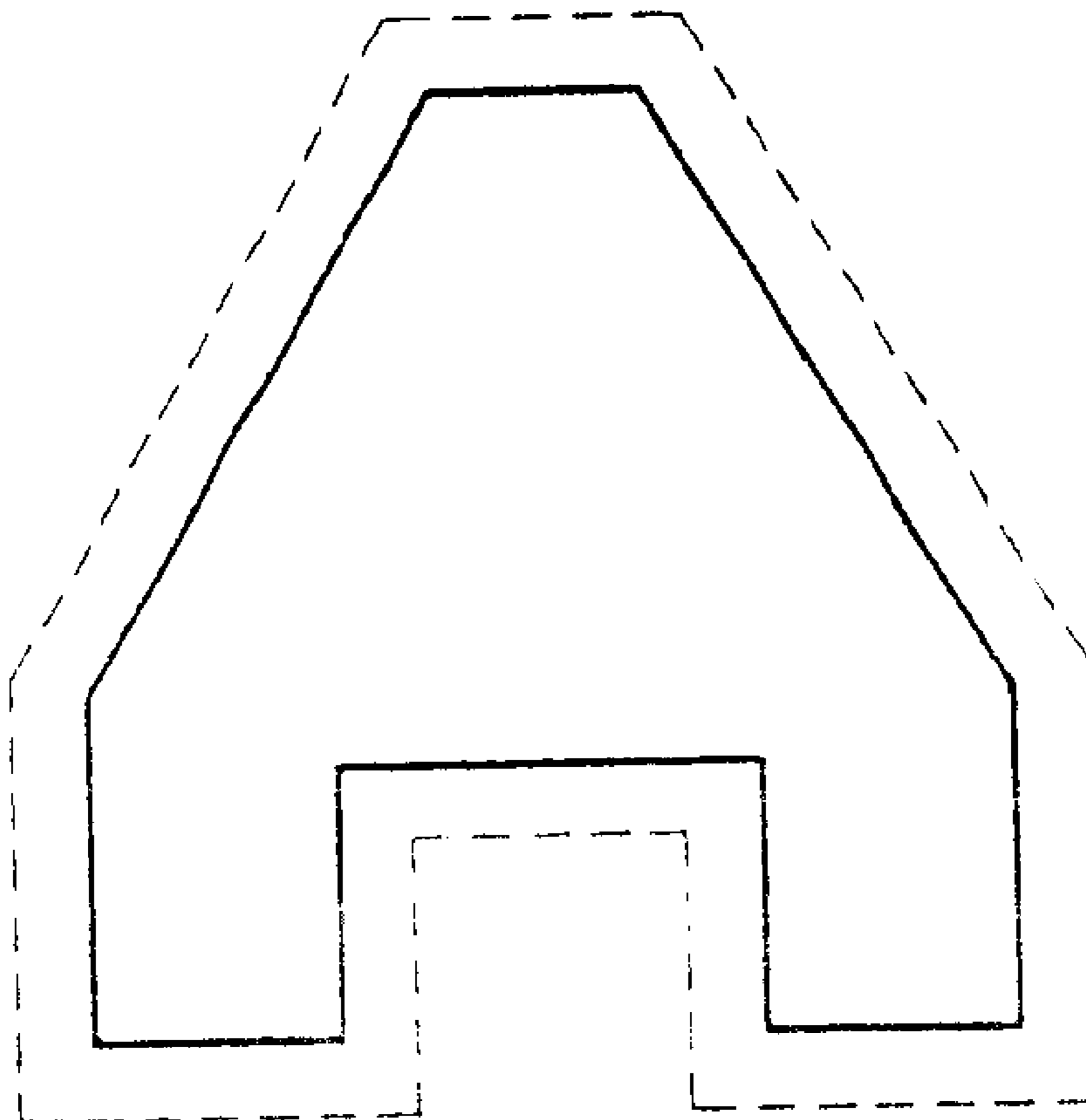

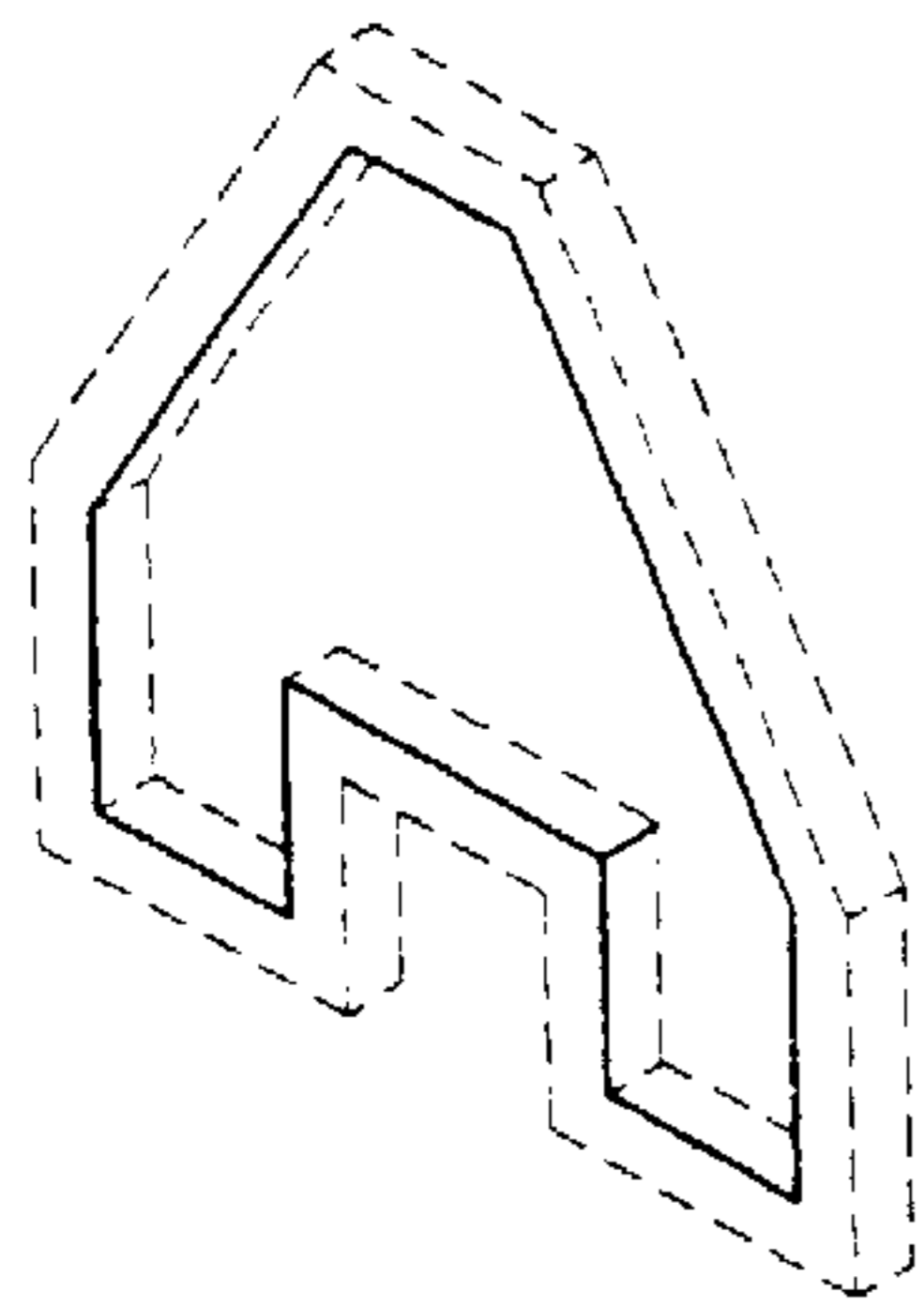

FIG. 1

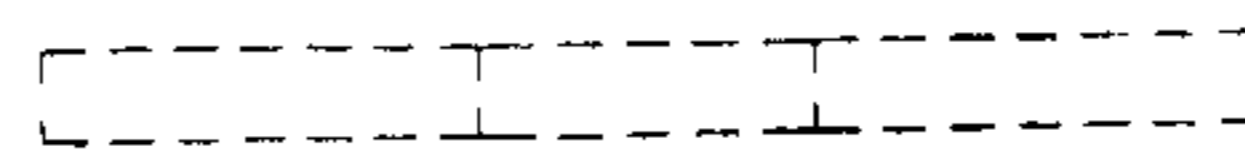

FIG. 4

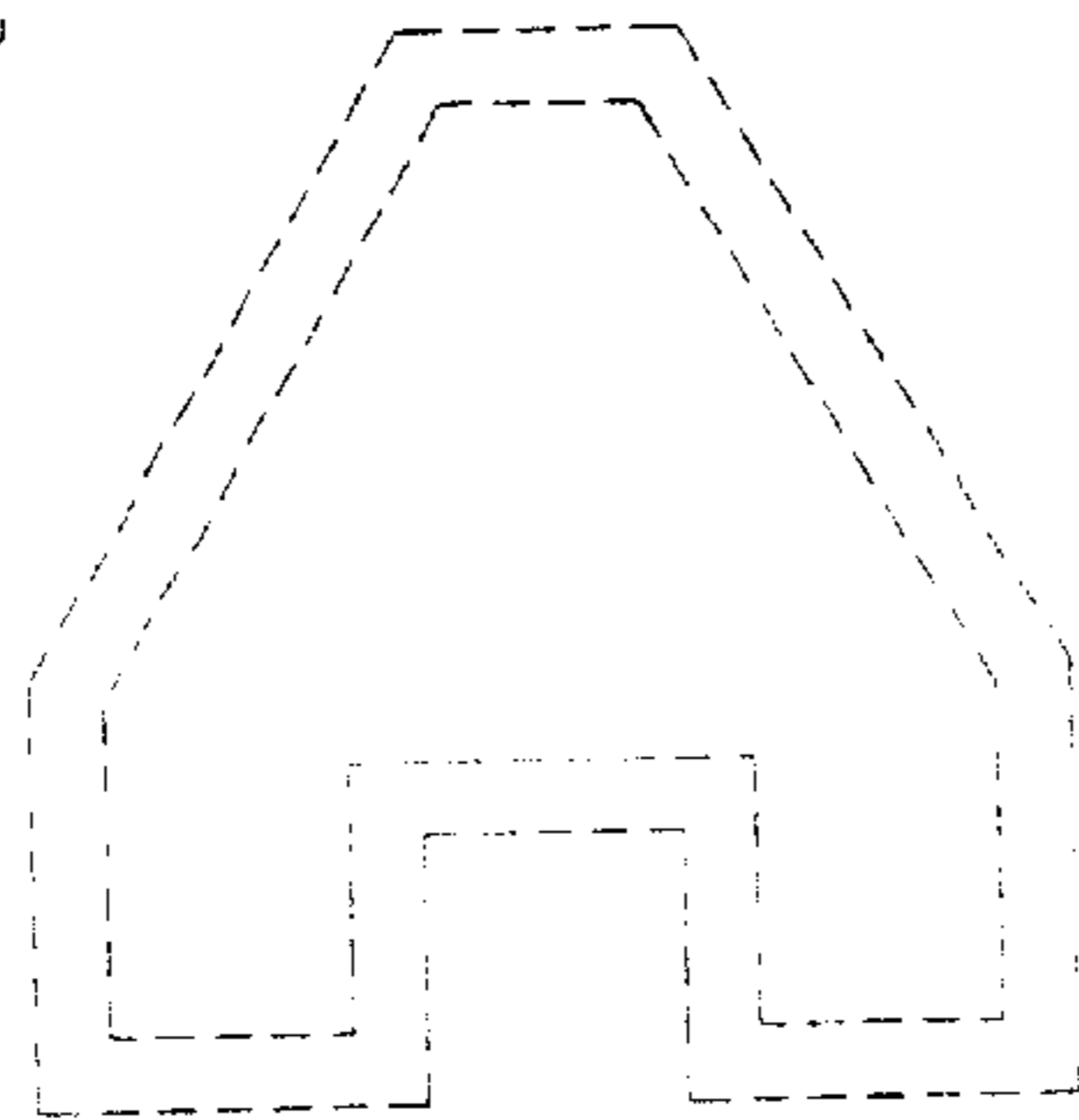

FIG. 6

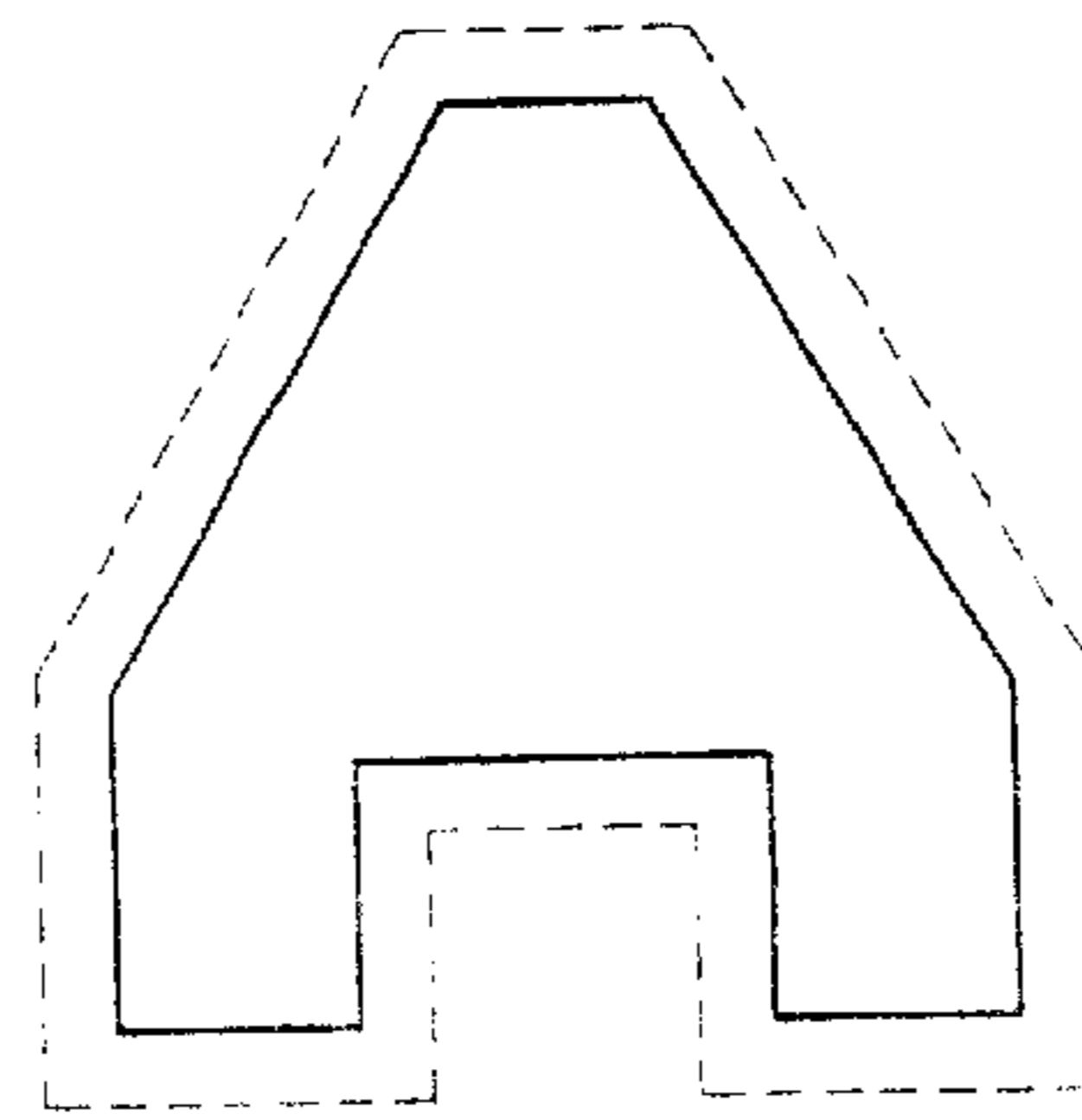

FIG. 2

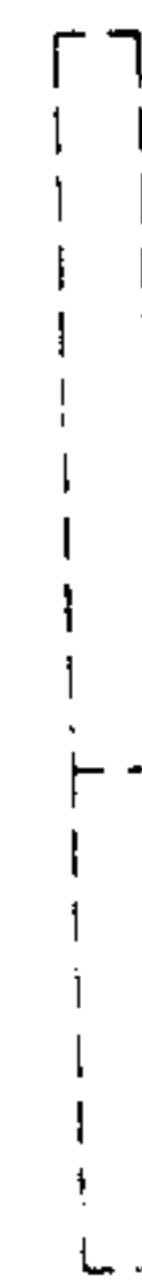

FIG. 3

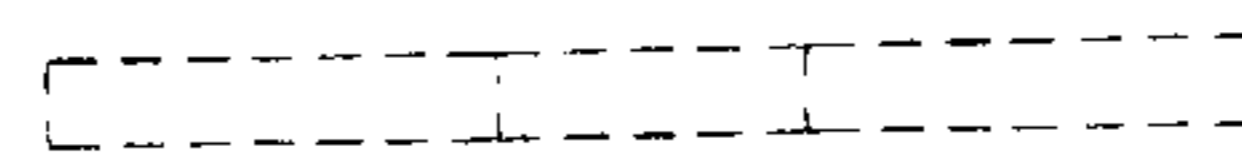

FIG. 5