



US00D537193S

(12) **United States Design Patent**
Lehman

(10) **Patent No.:** **US D537,193 S**

(45) **Date of Patent:** **** Feb. 20, 2007**

(54) **BALLAST HOUSING**

(75) **Inventor:** **Gregg Arthur Lehman**, Peachtree City, GA (US)

(73) **Assignee:** **Cooper Technologies Company**, Houston, TX (US)

(**) **Term:** **14 Years**

(21) **Appl. No.:** **29/191,784**

(22) **Filed:** **Oct. 14, 2003**

(51) **LOC (8) Cl.** **26-99**

(52) **U.S. Cl.** **D26/138; D26/64**

(58) **Field of Classification Search** D26/138, D26/141, 60-66, 24; D13/110, 133, 139.1, D13/139.2; 362/269, 270, 285, 287, 418, 362/419, 427, 428, 430, 457, 370, 372; 439/111, 439/117, 121

See application file for complete search history.

(56) **References Cited**

U.S. PATENT DOCUMENTS

1,610,127 A	12/1926	Godley	
D100,918 S	* 8/1936	Graff	D23/411
2,078,028 A	4/1937	Schneider	
D215,873 S	* 11/1969	Andre	D26/64
D224,038 S	* 6/1972	Adra	D26/63
3,711,702 A	* 1/1973	Adra	362/345
4,307,439 A	12/1981	Sassmannshausen	362/186
4,533,984 A	8/1985	Gatton	362/232
D316,909 S	* 5/1991	Atkinson Paul et al.	D26/63
5,017,327 A	5/1991	Bamber	362/389
D337,173 S	* 7/1993	Yamada et al.	D26/140
5,249,109 A	9/1993	Denison et al.	362/285
D357,547 S	* 4/1995	Layh	D26/63
5,461,552 A	10/1995	Tillery	362/188
D370,075 S	* 5/1996	Mier-Langner et al.	D26/63
5,735,594 A	4/1998	Own	362/202
D394,424 S	* 5/1998	Wachter	D13/110
D394,723 S	* 5/1998	Mier-Langner et al.	D26/63
5,938,317 A	8/1999	Thornton	362/290
D414,888 S	* 10/1999	McNatt et al.	D26/63
D417,300 S	* 11/1999	Stacy et al.	D26/63

6,004,005 A	* 12/1999	Demshki, Jr.	439/118
6,022,130 A	* 2/2000	Donato	362/428
6,045,236 A	4/2000	Cheng et al.	362/188
D431,307 S	* 9/2000	Zelina et al.	D26/24
6,174,071 B1	1/2001	Chan	362/187
D439,998 S	* 4/2001	Lin	D26/63
6,290,373 B1	9/2001	Dwight et al.	362/285
6,390,649 B1	5/2002	Tang	362/285
2003/0081422 A1	* 5/2003	Ward	362/428

OTHER PUBLICATIONS

Cooper Lighting's Powertrac Crosshair lampholder, Model L2792 Specification.

Concord Torus 35/70 FX, dated Oct. 14, 2003, 1 page.

Concord Torus 100 FX, dated Oct. 14, 2003, 1 page.

Article, Amerlux Lighting Solutions Introduces Impact T4 Line of Compact Low Wattage Ceramic Metal Halide Lighting, 2 pages.

* cited by examiner

Primary Examiner—Clare E Heflin

(74) *Attorney, Agent, or Firm*—Haynes and Boone LLP; Todd Mattingly

(57) **CLAIM**

The ornamental design for a ballast housing, as shown.

DESCRIPTION

The subject matter of the present application generally relates to U.S. Utility patent application Ser. No. 10/685, 033, entitled "Focus Assembly for a Track Light" which is being filed concurrently with the present application and is incorporated by reference here in its entirety.

FIG. 1 is an oblique view of the ballast housing showing my new design;

FIG. 2 is a front view thereof;

FIG. 3 is a left side view thereof;

FIG. 4 is a rear view thereof;

FIG. 5 is a right side view thereof;

FIG. 6 is a top view thereof; and,

FIG. 7 is a bottom view thereof.

1 Claim, 3 Drawing Sheets

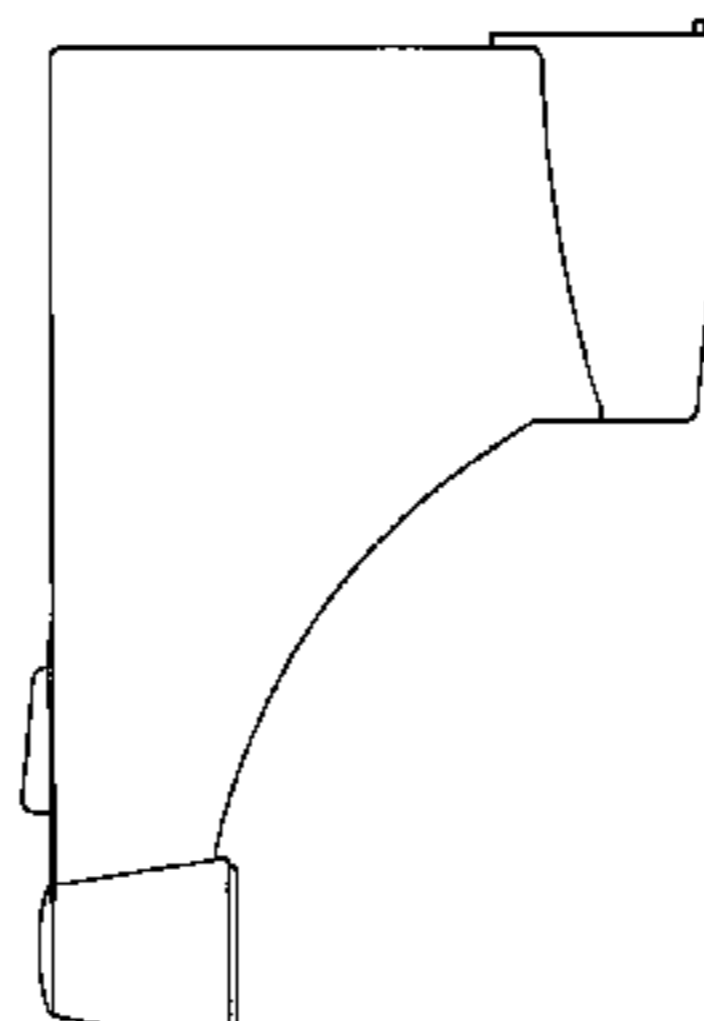
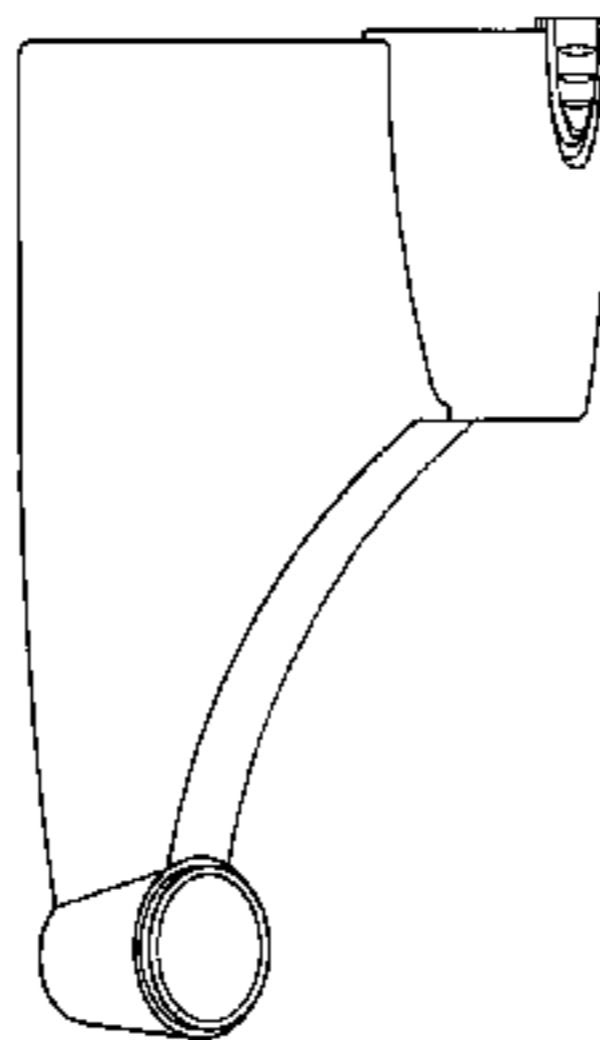

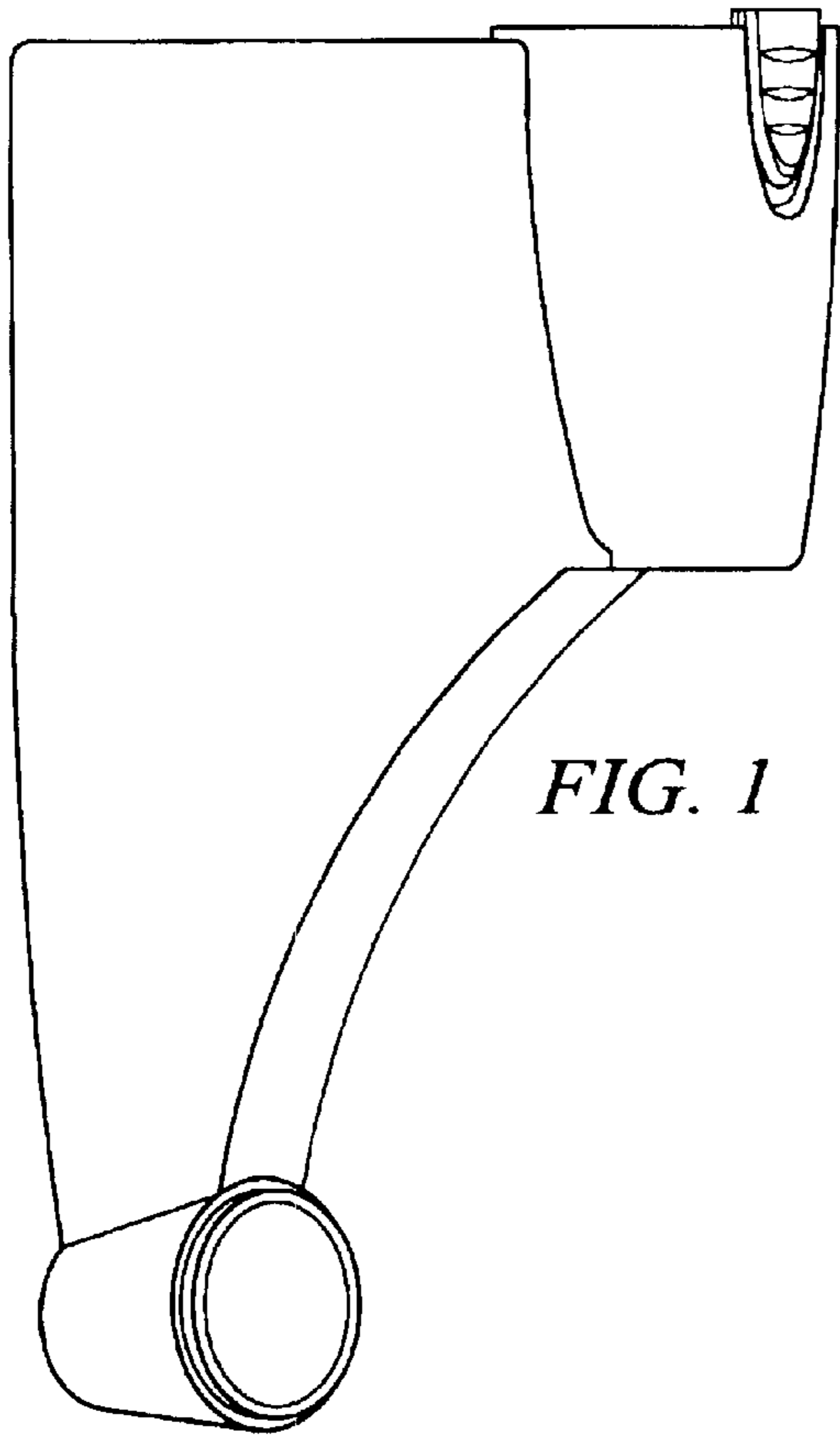

FIG. 1

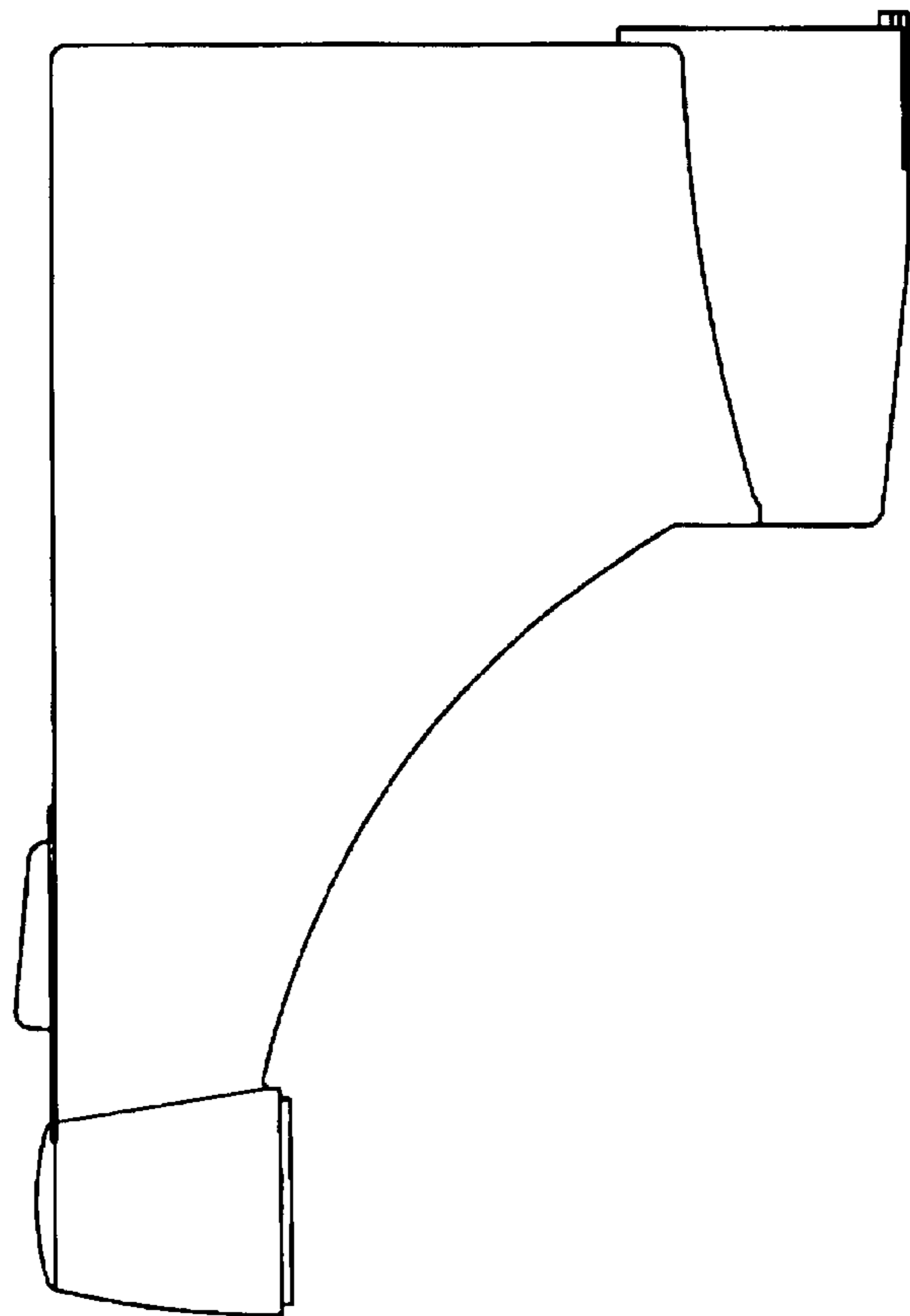

FIG. 2

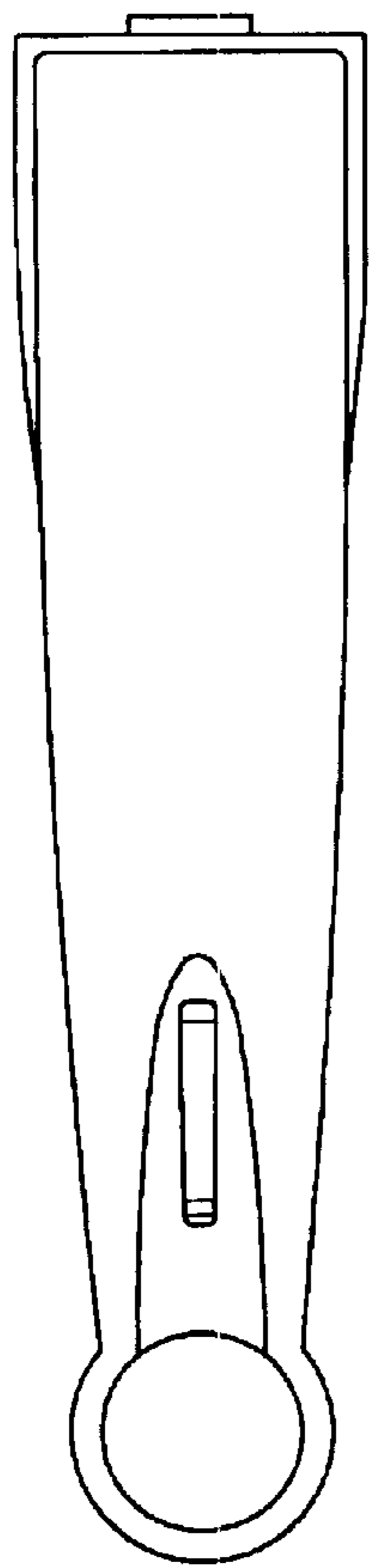

FIG. 3

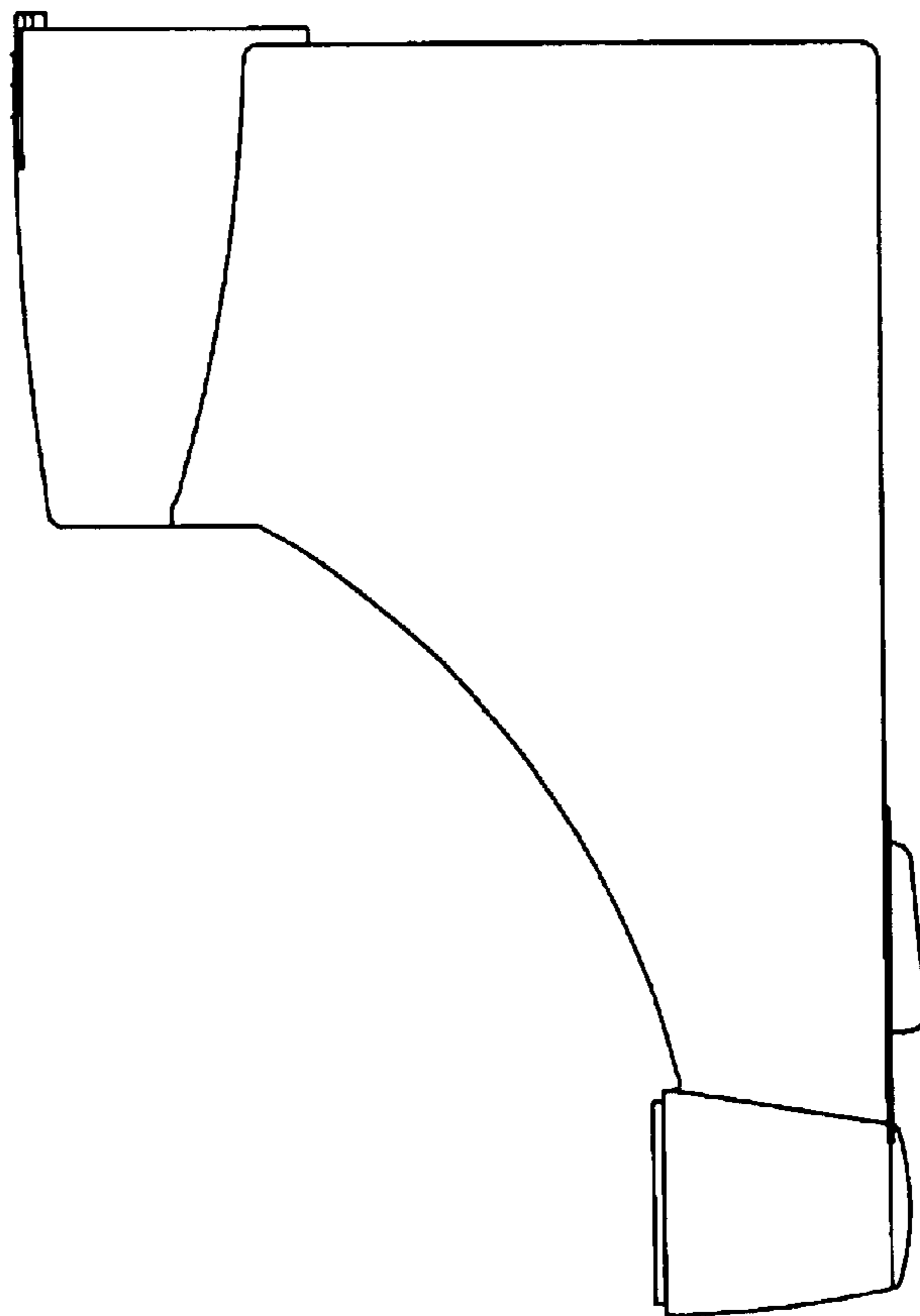

FIG. 4

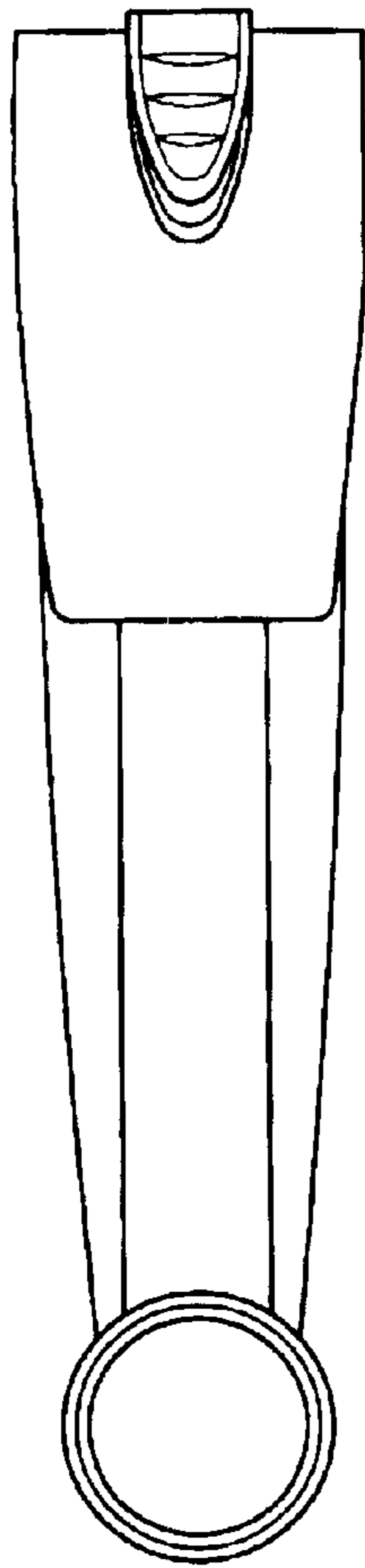

FIG. 5

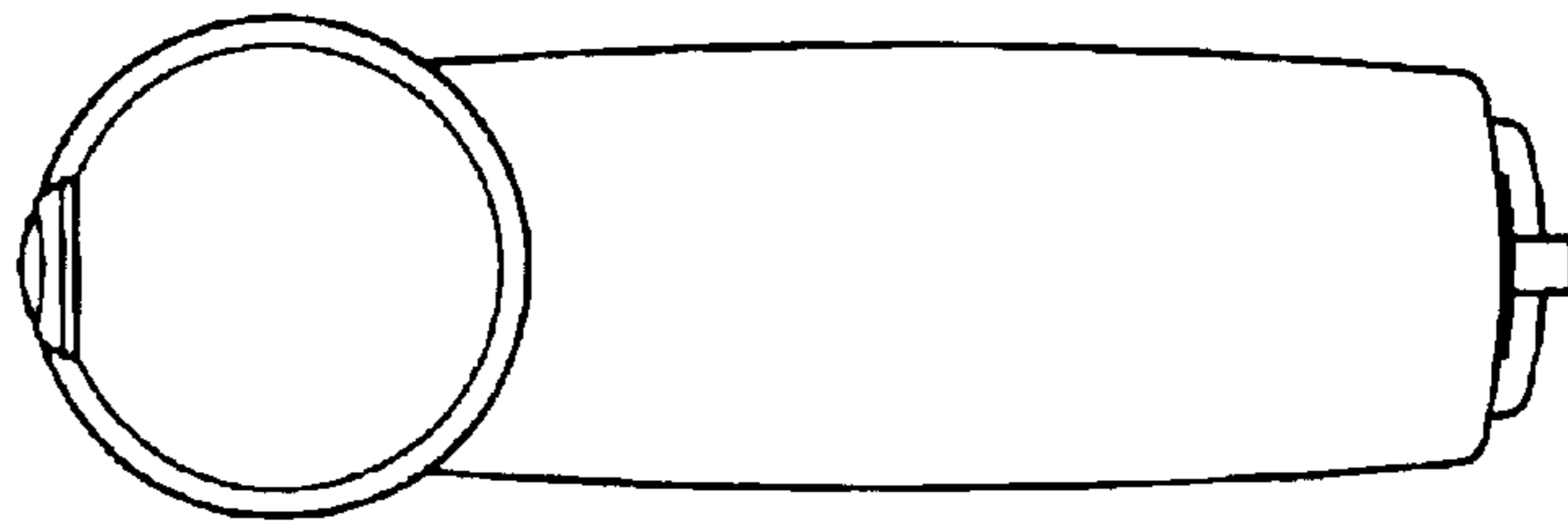

FIG. 6

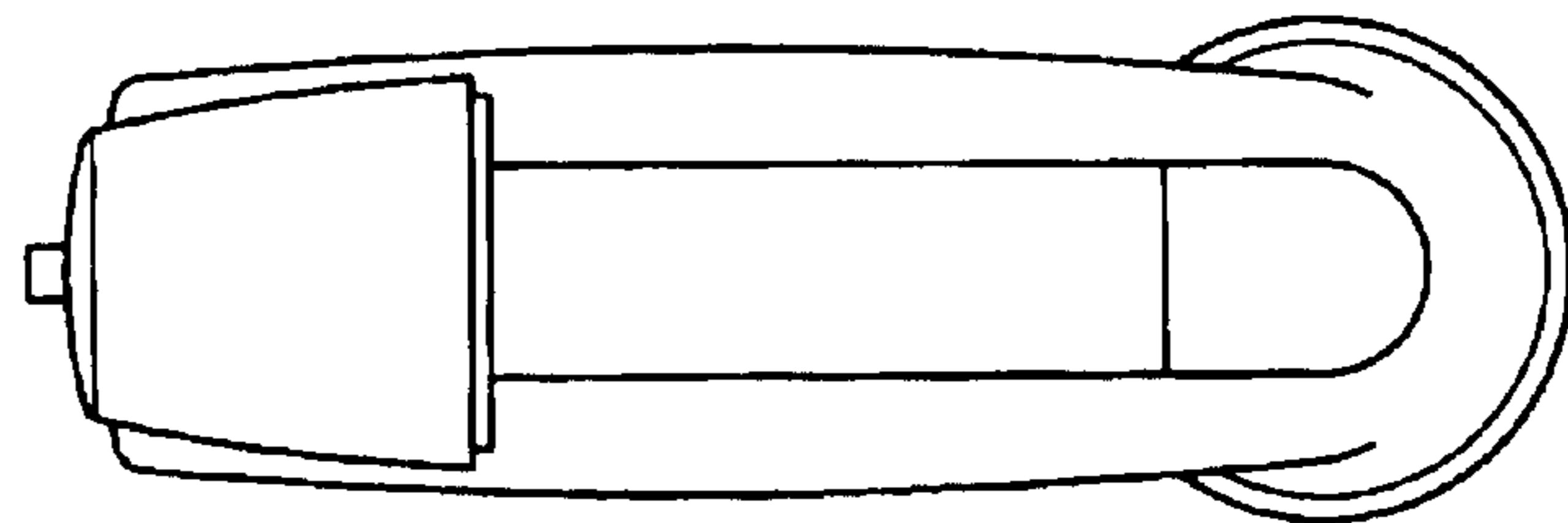

FIG. 7