



US00D534840S

(12) **United States Design Patent**
Basset et al.

(10) **Patent No.:** **US D534,840 S**
(45) **Date of Patent:** **** Jan. 9, 2007**

(54) **TANK COVER PANEL**

(75) Inventors: **Damien B. Basset**, Los Angeles, CA (US); **Hideaki Yamazumi**, Torrance, CA (US); **Asao Itaya**, Torrance, CA (US); **Michael Peterson**, Marysville, OH (US)

(73) Assignee: **Honda Motor Company, Ltd.**, Tokyo (JP)

(**) Term: **14 Years**

(21) Appl. No.: **29/226,822**

(22) Filed: **Apr. 1, 2005**

(51) **LOC (8) Cl.** **12-11**

(52) **U.S. Cl.** **D12/126**

(58) **Field of Classification Search** D12/3,
D12/86, 87, 107, 110, 114, 126, 218; 280/833,
280/835, 304.3, 770; 296/78.1; 180/219,
180/225, 69.4, 229

See application file for complete search history.

(56) **References Cited**

U.S. PATENT DOCUMENTS

6,105,701 A * 8/2000 Buell 180/229
6,926,110 B1 * 8/2005 Armstrong et al. 180/219
D515,985 S * 2/2006 Kishi et al. D12/126

* cited by examiner

Primary Examiner—Alan P. Douglas

Assistant Examiner—Linda Brooks

(74) *Attorney, Agent, or Firm*—Dinsmore & Shohl LLP

(57) **CLAIM**

The ornamental design for a tank cover panel, as shown and described.

DESCRIPTION

FIG. 1 is a left front perspective view of a tank cover panel; FIG. 2 is a top plan view of the tank cover panel of FIG. 1; FIG. 3 is a left side elevational view of the tank cover panel of FIG. 1;

FIG. 4 is a left front perspective view of the tank cover panel of FIG. 1 on a reduced scale provided upon an exemplary four wheeled vehicle;

FIG. 5 is a left rear perspective view of the tank cover panel of FIG. 1 on a reduced scale provided upon the exemplary four wheeled vehicle;

FIG. 6 is a rear perspective view of the tank cover panel of FIG. 1 on a reduced scale provided upon the exemplary four wheeled vehicle;

FIG. 7 is a left side perspective view of the tank cover panel of FIG. 1 on a reduced scale provided upon the exemplary four wheeled vehicle;

FIG. 8 is a right side perspective view of the tank cover panel of FIG. 1 on a reduced scale provided upon the exemplary four wheeled vehicle; and,

FIG. 9 is a top perspective view of the tank cover panel of FIG. 1 on a reduced scale provided upon the exemplary four wheeled vehicle.

The broken lines immediately adjacent the shaded areas represent the boundaries of the claimed design and form no part thereof, while the other broken lines show environment and form no part of the claimed design.

1 Claim, 9 Drawing Sheets

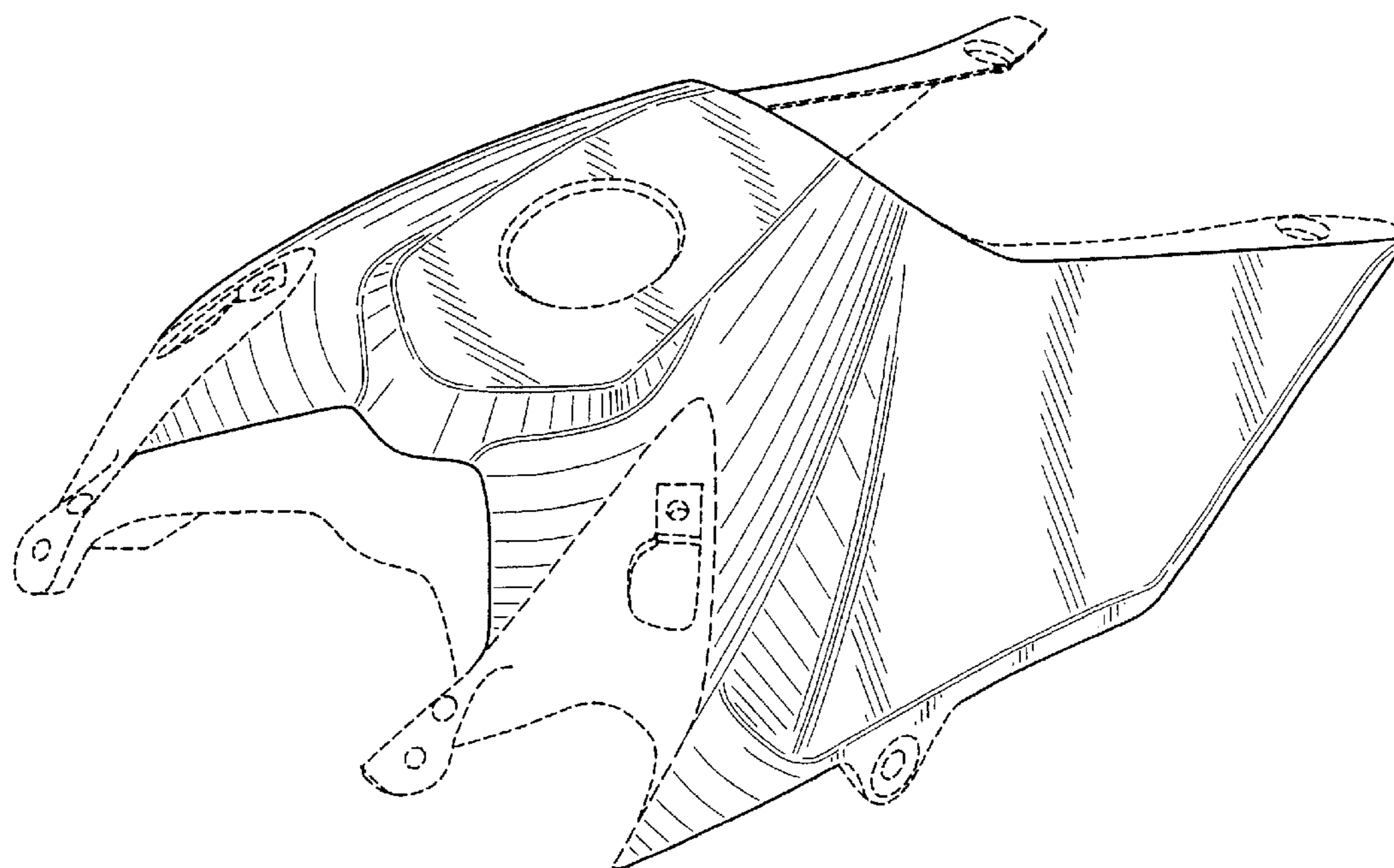

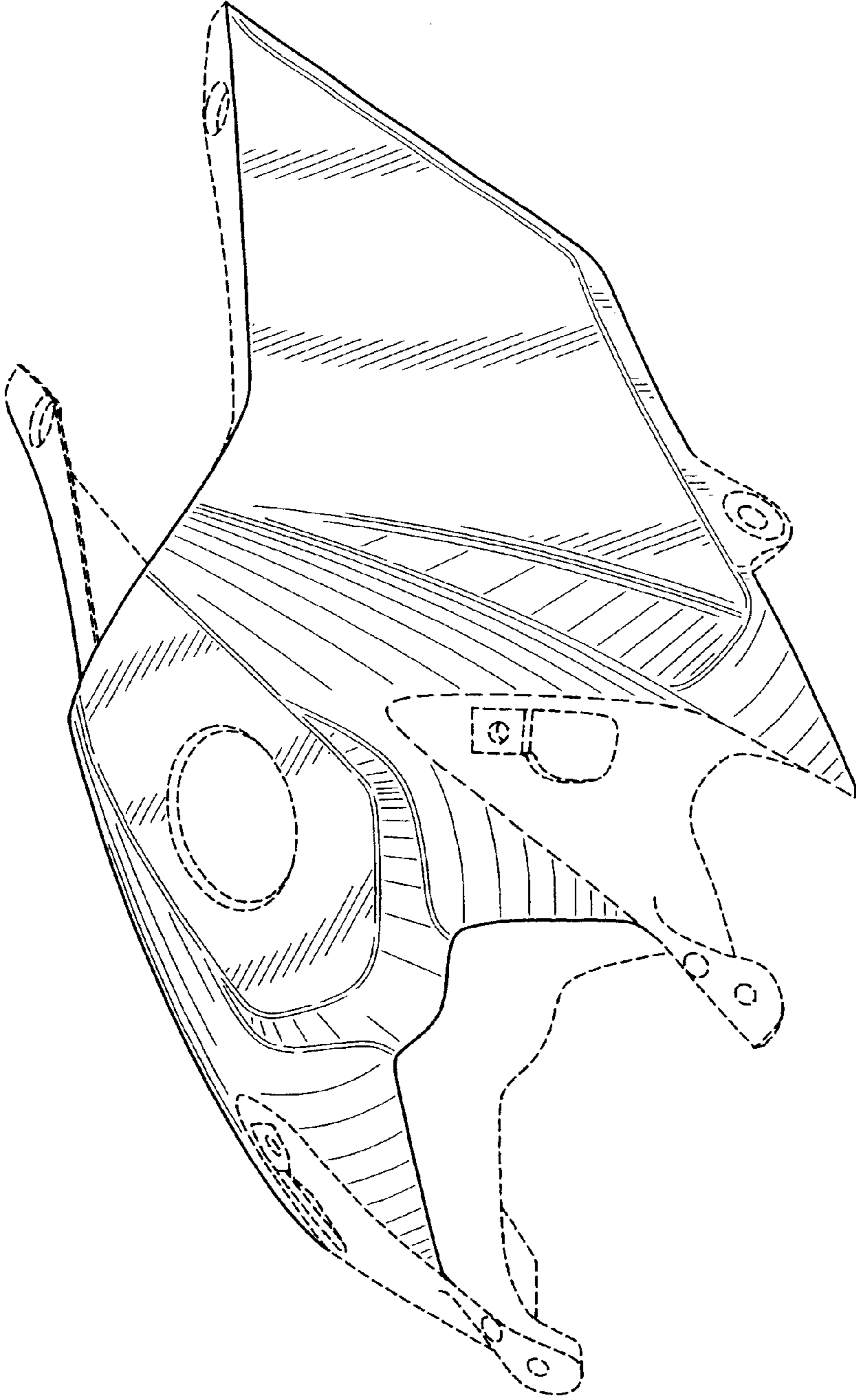

FIG. 1

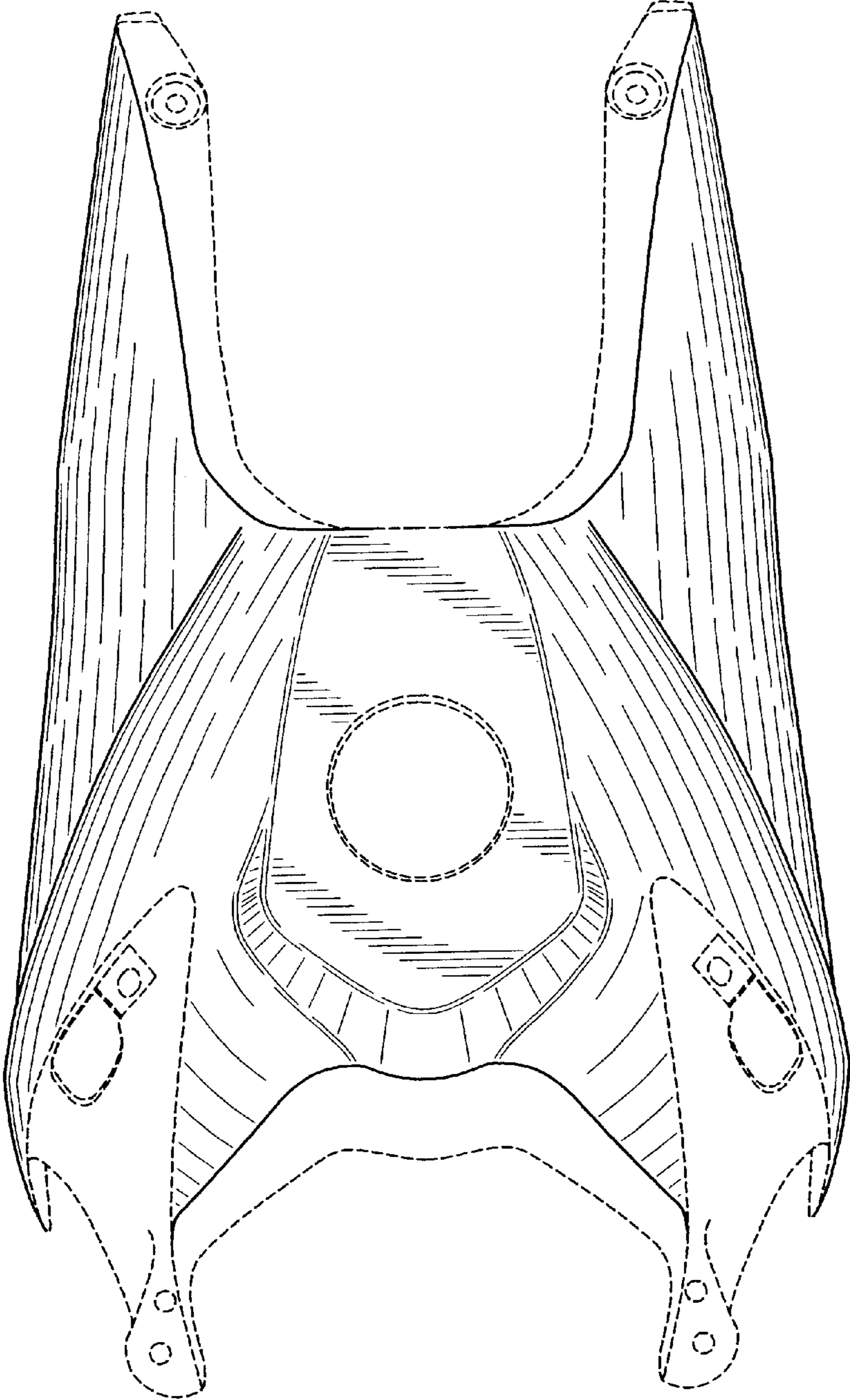

FIG. 2

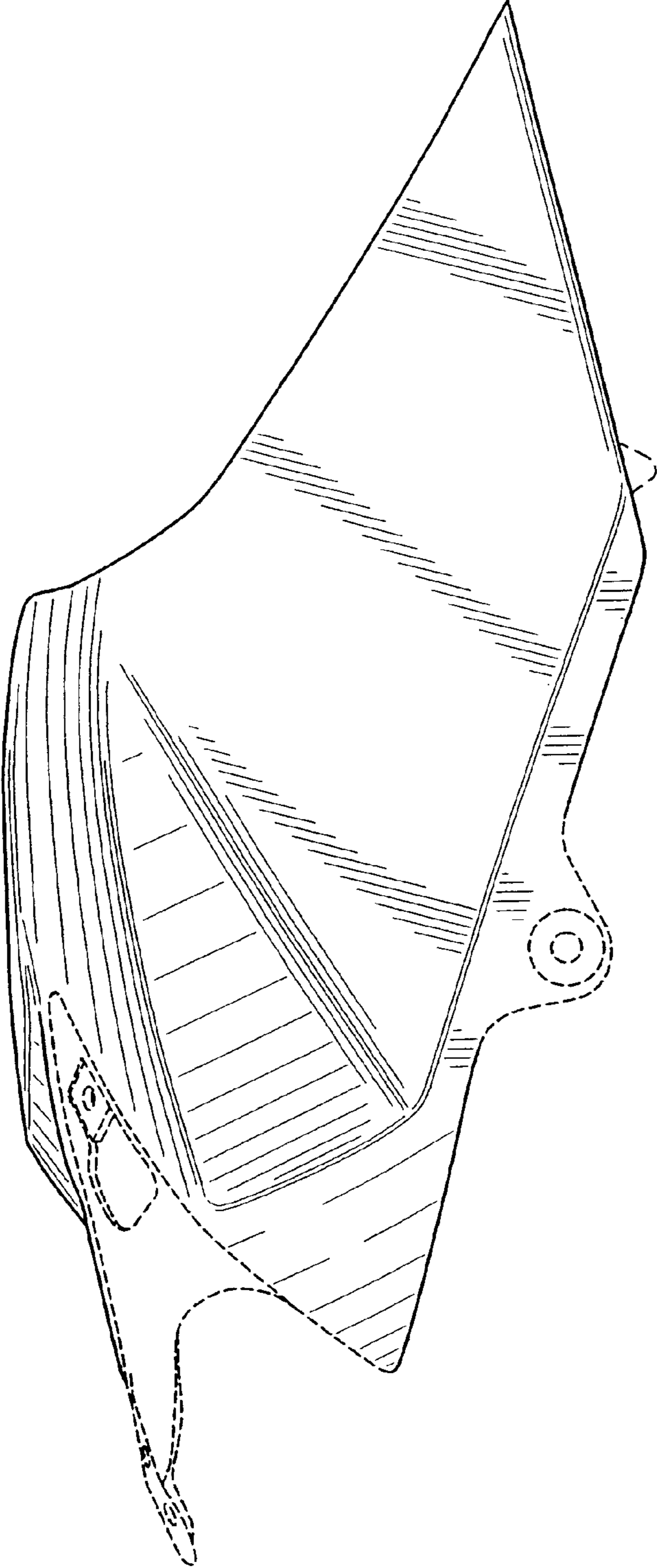

FIG. 3

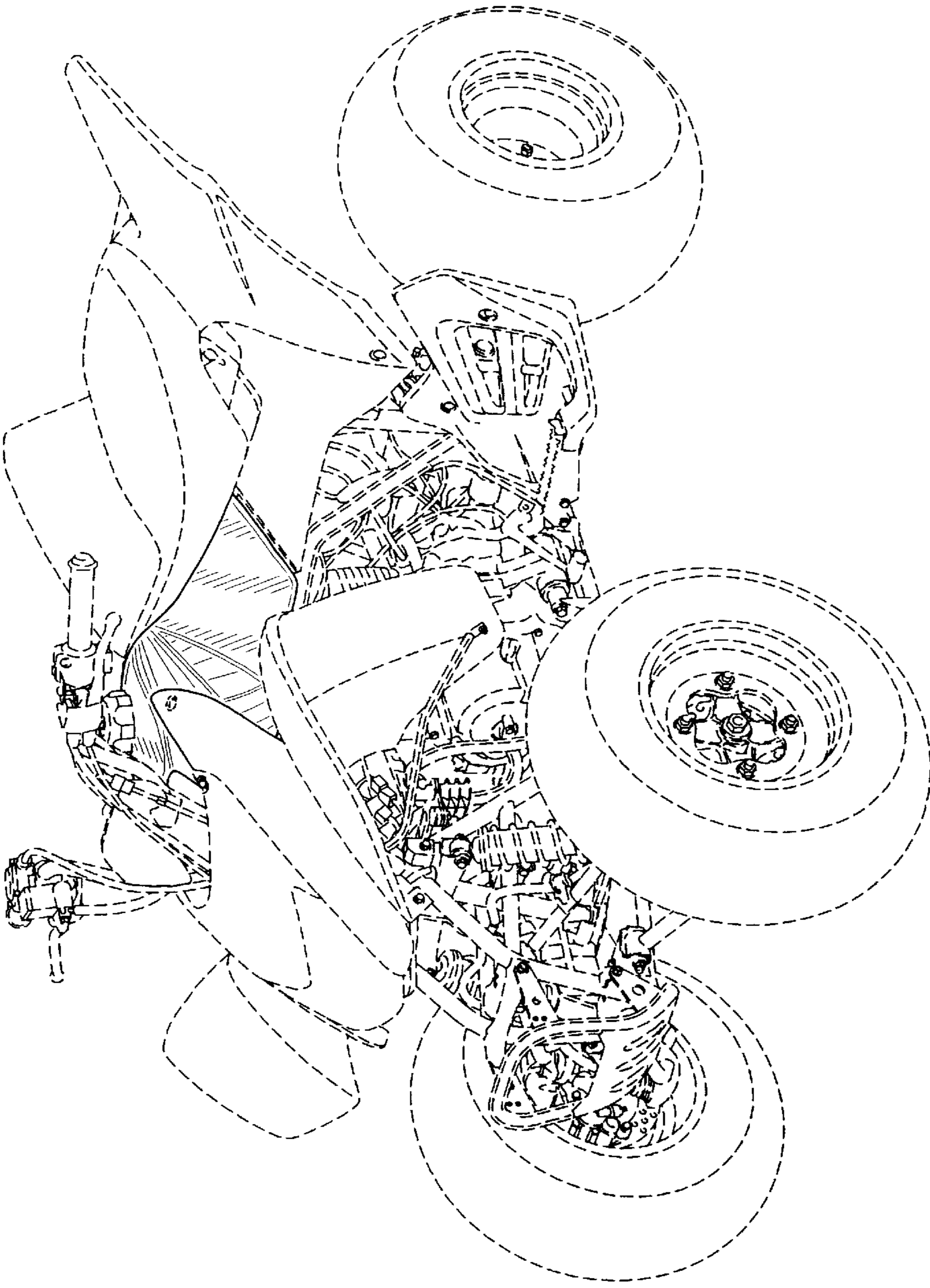

FIG. 4

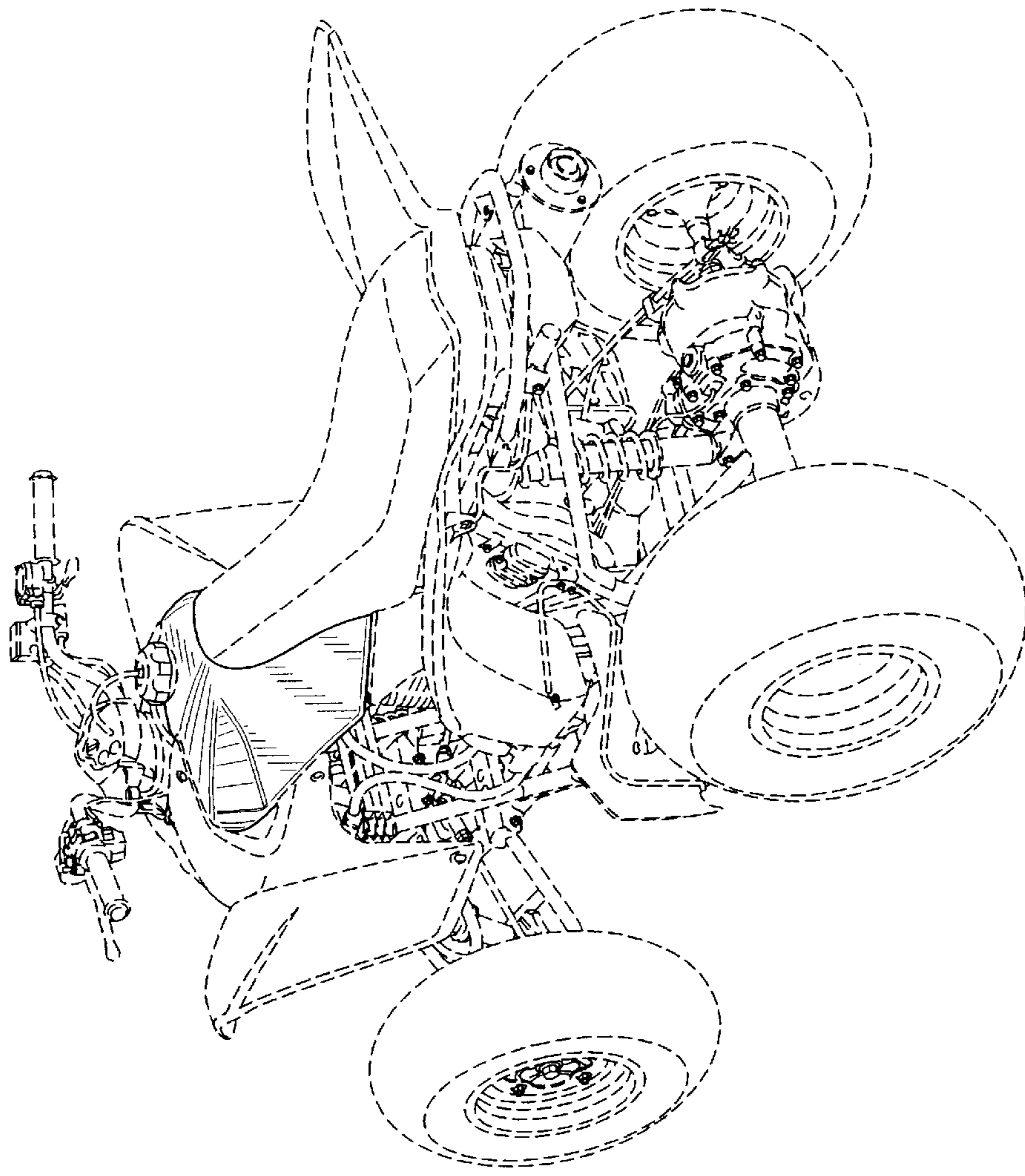

FIG. 5

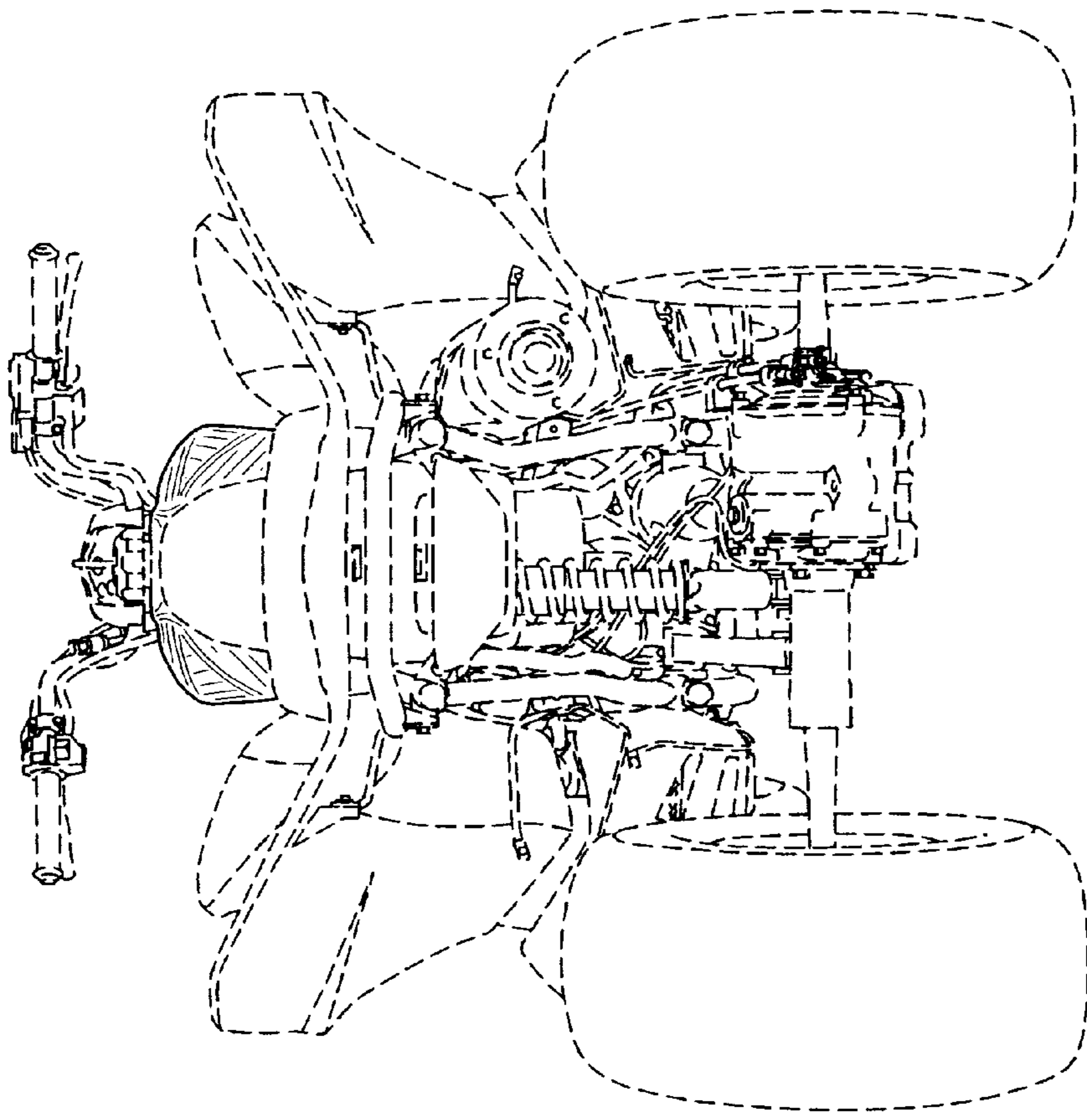

FIG. 6

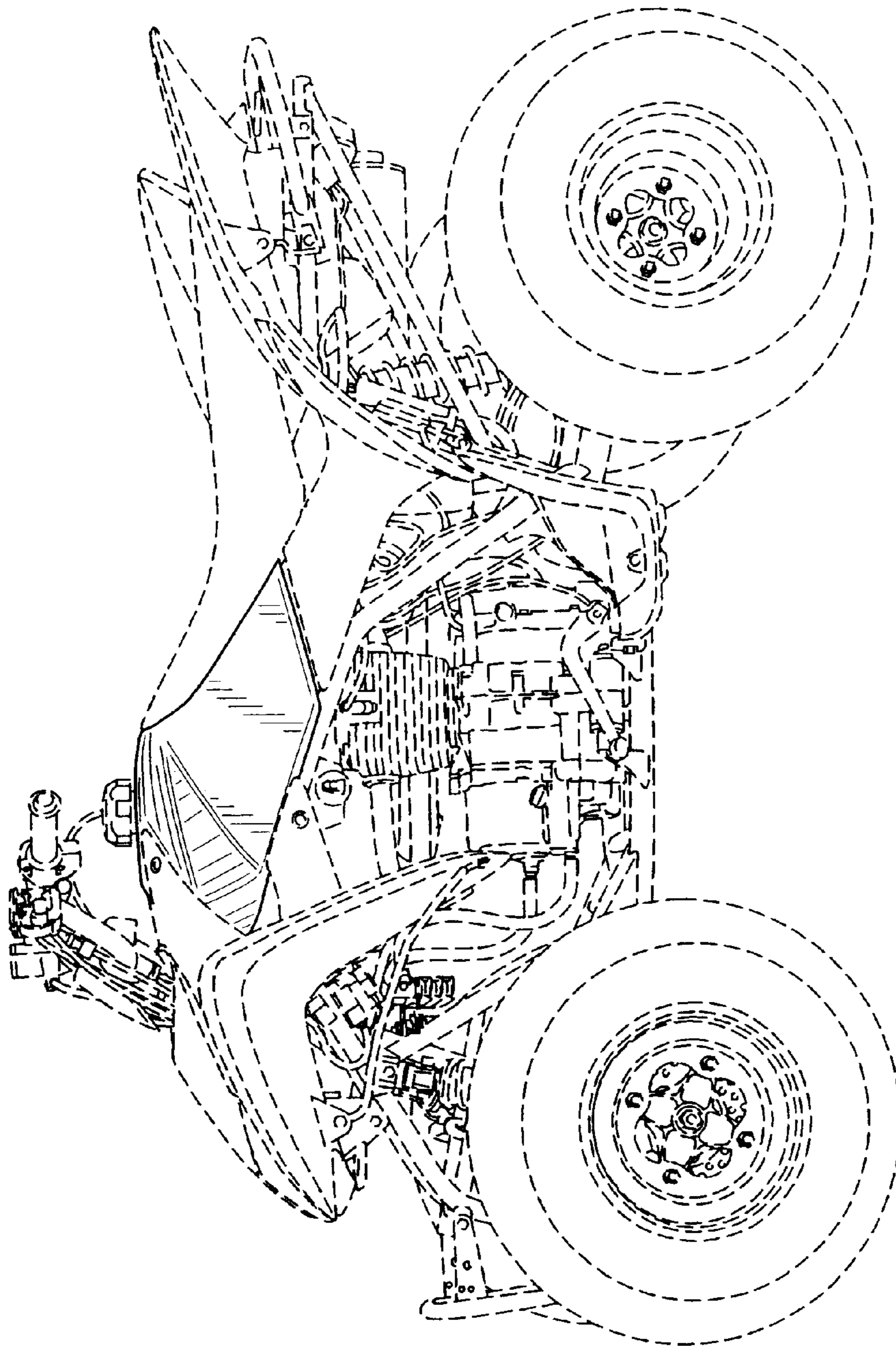

FIG. 7

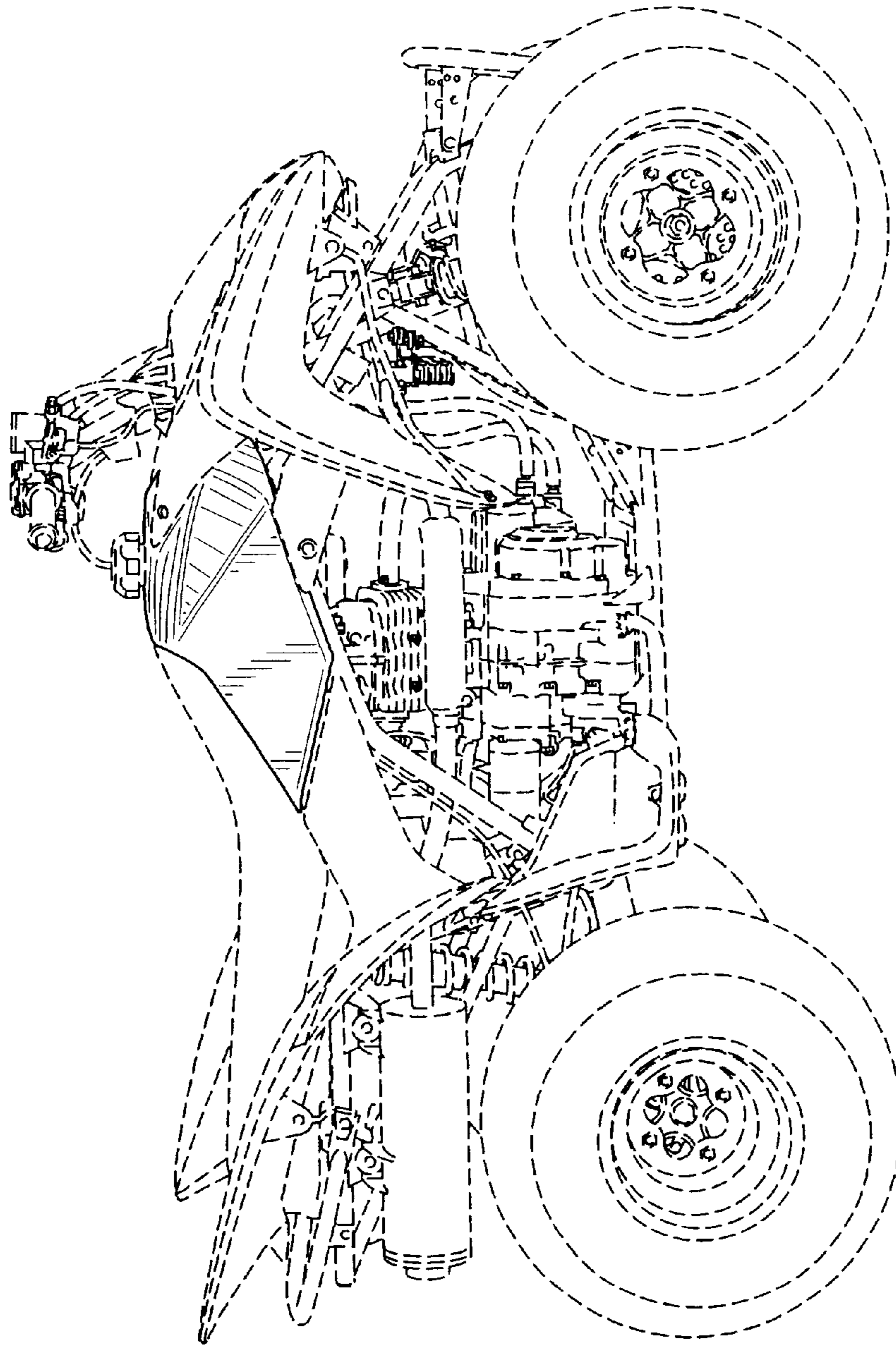

FIG. 8

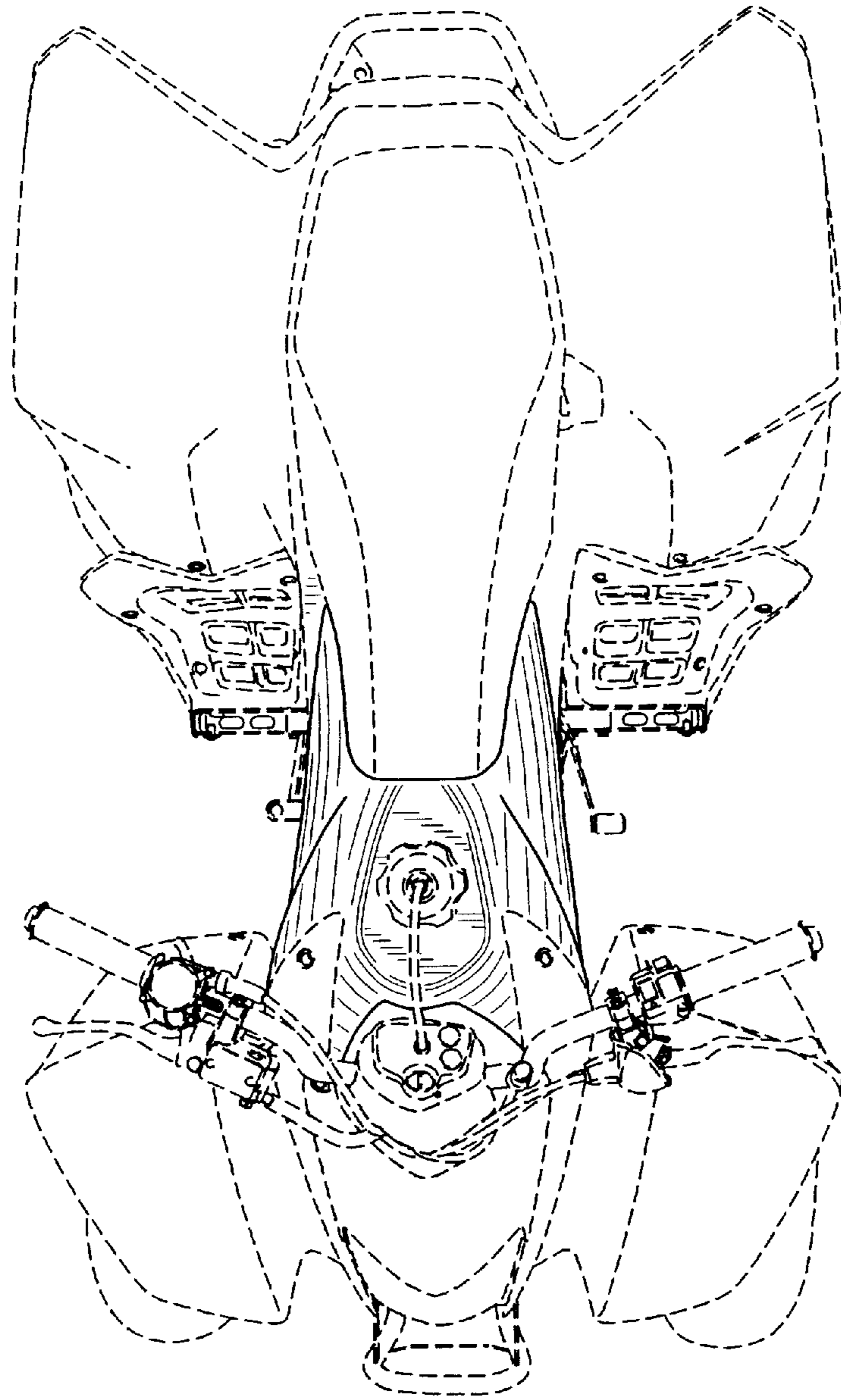

FIG. 9