



US00D531295S

(12) **United States Design Patent**
Seelig et al.

(10) **Patent No.:** **US D531,295 S**
(45) **Date of Patent:** **** Oct. 31, 2006**

(54) **FACEPLATE FOR A PLUG-IN VAPORIZER**

(76) Inventors: **Barry G. Seelig**, 250 E. 30th St., Apt. 14A, New York, NY (US) 10011;
Nancy Brogden, 148 W. 23rd St., New York, NY (US) 10011

(**) Term: **14 Years**

(21) Appl. No.: **29/210,541**

(22) Filed: **Aug. 3, 2004**

(51) **LOC (8) Cl.** **28-99**

(52) **U.S. Cl.** **D23/366**

(58) **Field of Classification Search** D23/356-369;
392/390, 392, 393, 394, 398; 239/34, 53,
239/56, 57, 58, 135, 136; 261/DIG. 17, DIG. 65,
261/DIG. 88, DIG. 89

See application file for complete search history.

(56) **References Cited**

U.S. PATENT DOCUMENTS

D163,475 S	*	5/1951	Olbres	D23/367
D228,911 S	*	10/1973	Gatter	D23/367
3,817,371 A	*	6/1974	Gatter	206/0.5
5,136,684 A	*	8/1992	Lonker et al.	392/392
D332,138 S	*	12/1992	Lonker et al.	D23/366
D400,662 S	*	11/1998	Davis	D23/366
5,947,061 A	*	9/1999	Markham et al.	119/710
D466,205 S	*	11/2002	Garcia	D23/366
D478,973 S	*	8/2003	Wagner	D23/367
D484,229 S	*	12/2003	Upton	D23/366

D489,123 S	*	4/2004	Basaganas Millan	D23/366
D491,257 S	*	6/2004	Picken, Jr.	D23/366
D494,064 S		8/2004	Hook	D9/445

* cited by examiner

Primary Examiner—Sandra S. Snapp

(74) *Attorney, Agent, or Firm*—Evan J. Federman; Karen G. Horowitz

(57) **CLAIM**

We claim the ornamental design for a faceplate for a plug-in vaporizer, as shown and described.

DESCRIPTION

FIG. 1 is a front perspective view of a faceplate for a plug-in vaporizer.

FIG. 2 is a front elevation view of the faceplate shown in FIG. 1.

FIG. 3 is a right side elevation view of the plug-in vaporizer shown in FIG. 1. The left side elevation is a mirror image to the right side elevation shown in FIG. 3.

FIG. 4 is a top plan view of the faceplate shown in FIG. 1. FIG. 5 is a bottom plan view of the plug-in vaporizer shown in FIG. 1; and,

FIG. 6 is a rear elevation view of the plug-in vaporizer shown in FIG. 1.

The ornamental design which is claimed is shown in solid lines in the drawings. The broken lines in the drawings are for illustrative purposes only and form no part of the claimed design.

1 Claim, 3 Drawing Sheets

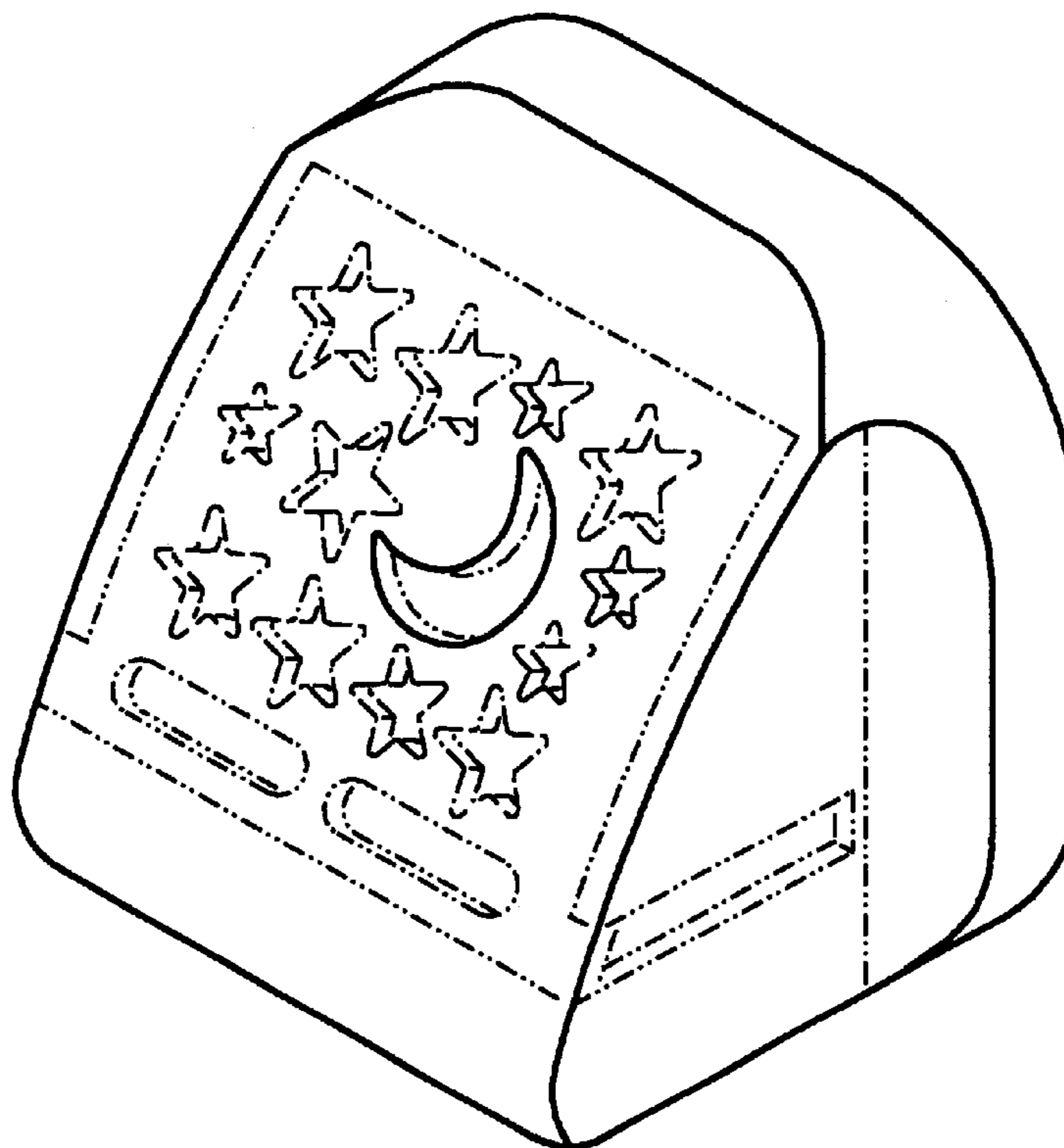

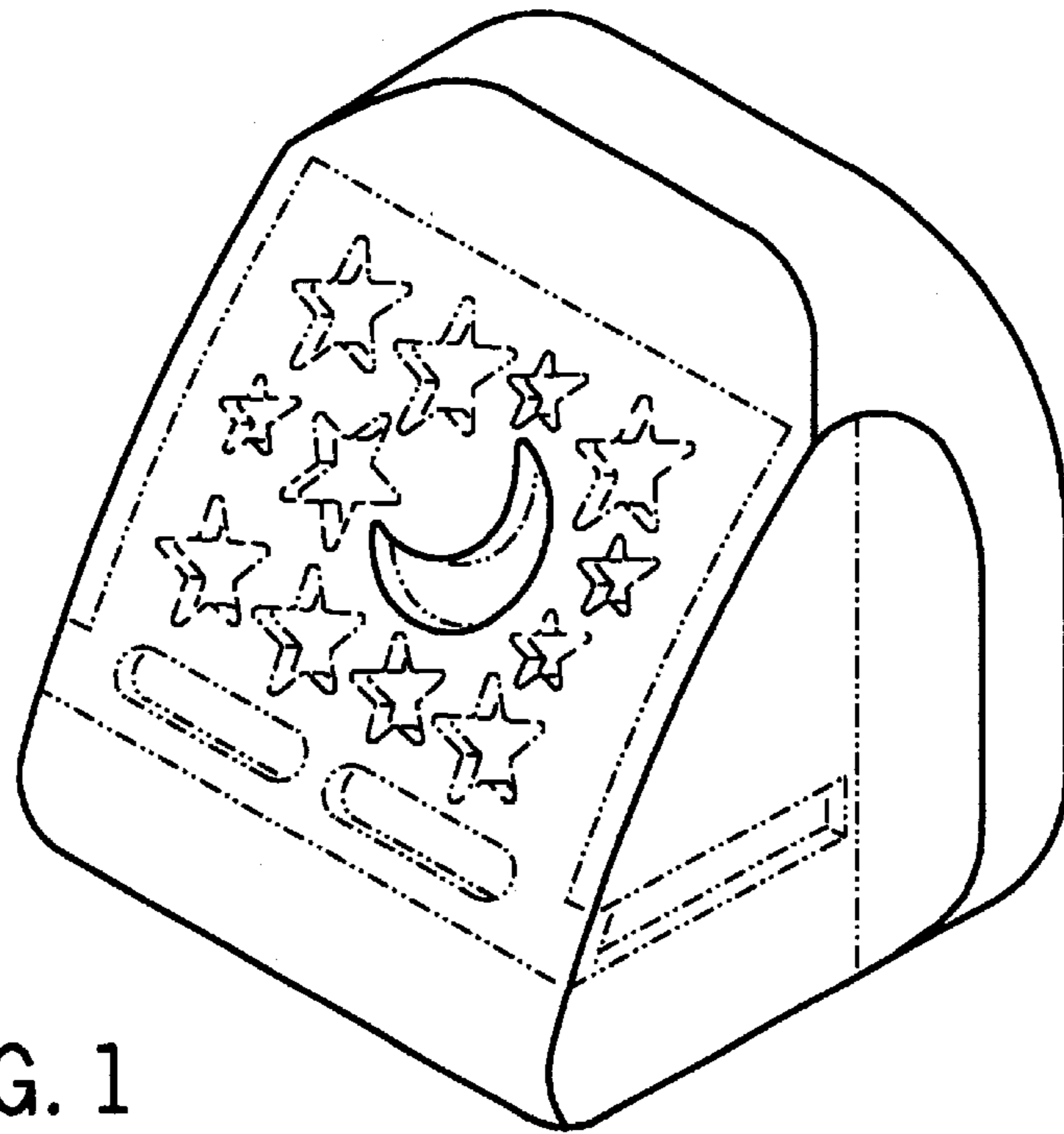

FIG. 1

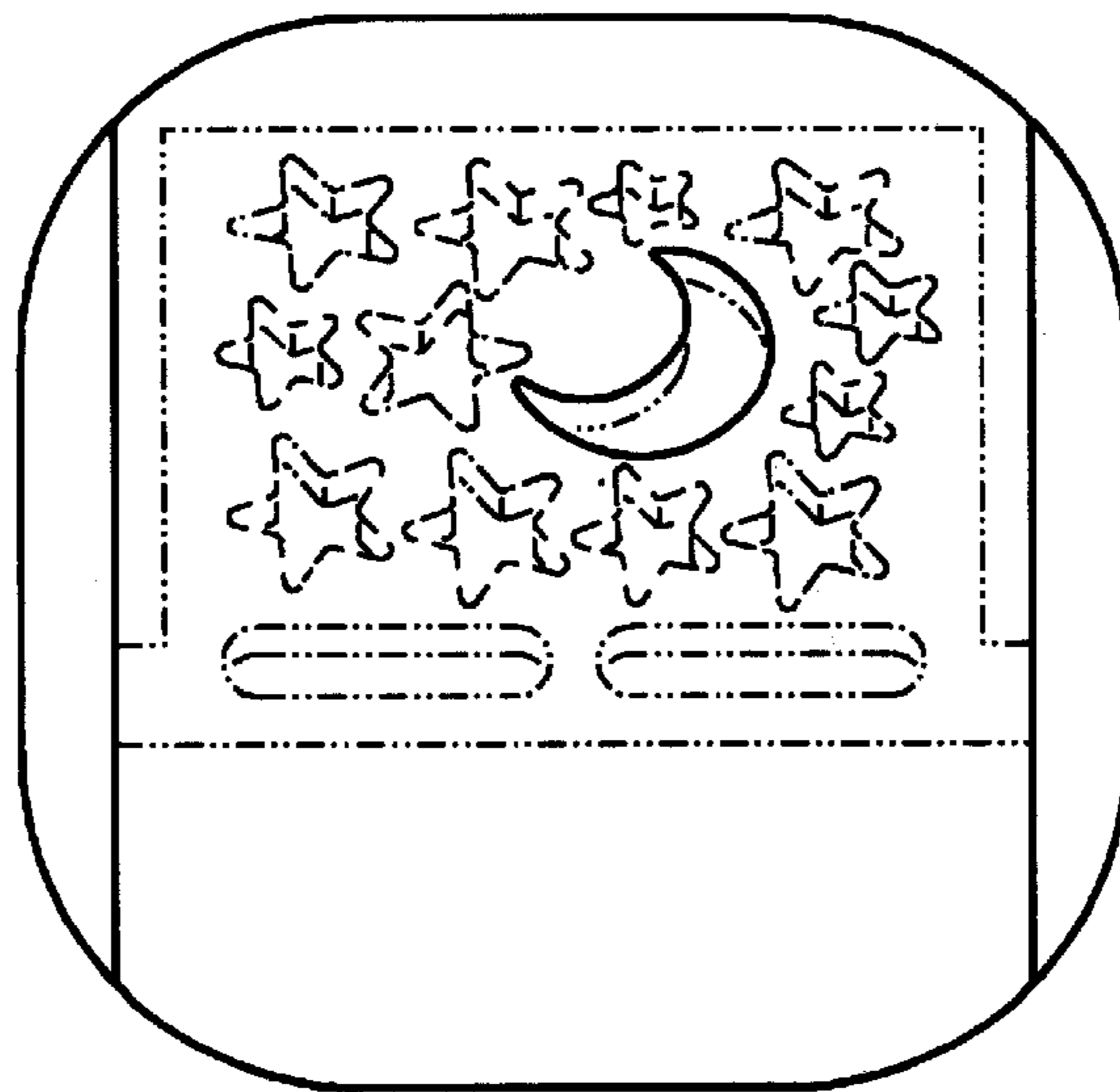

FIG. 2

FIG. 3

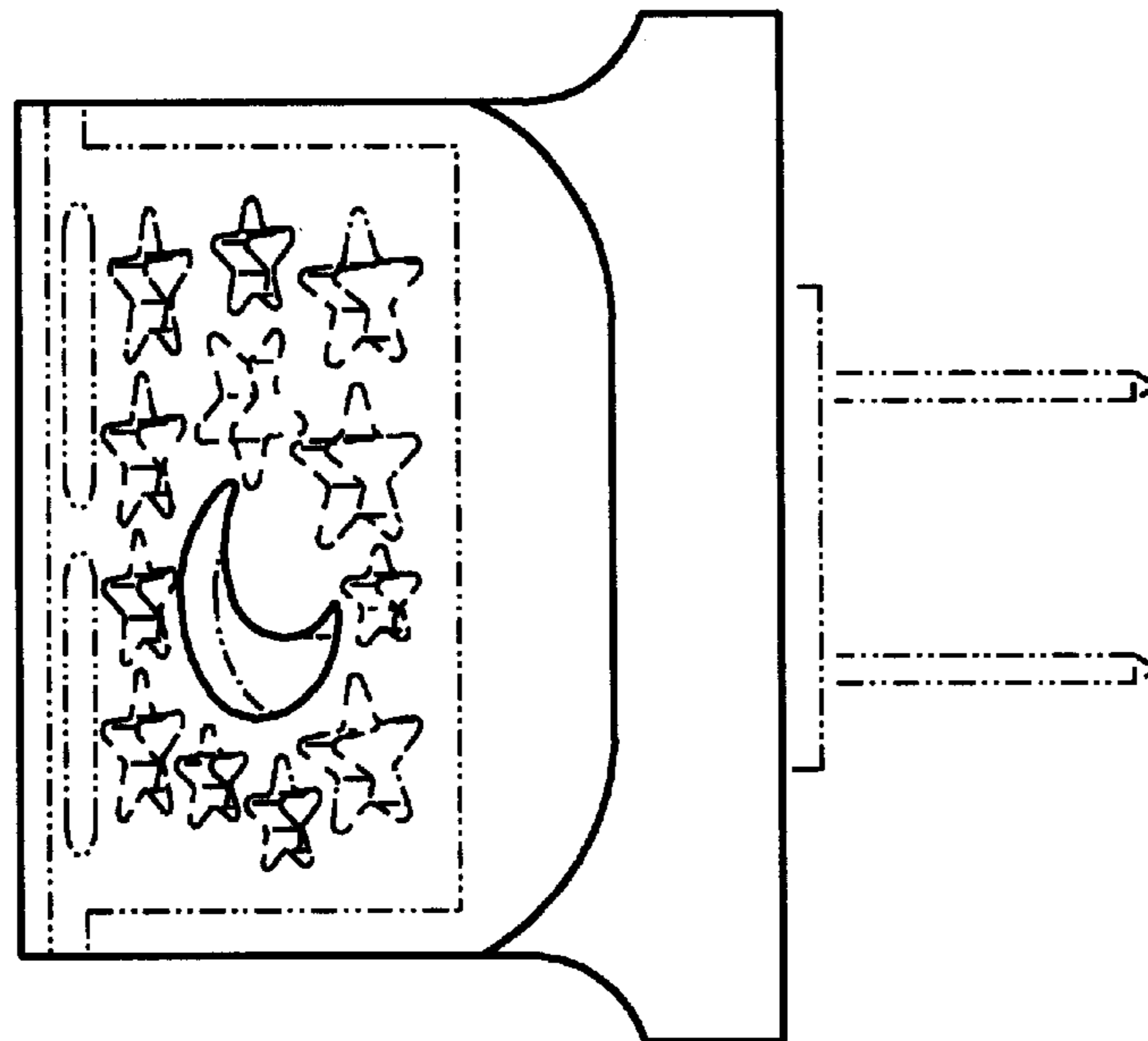
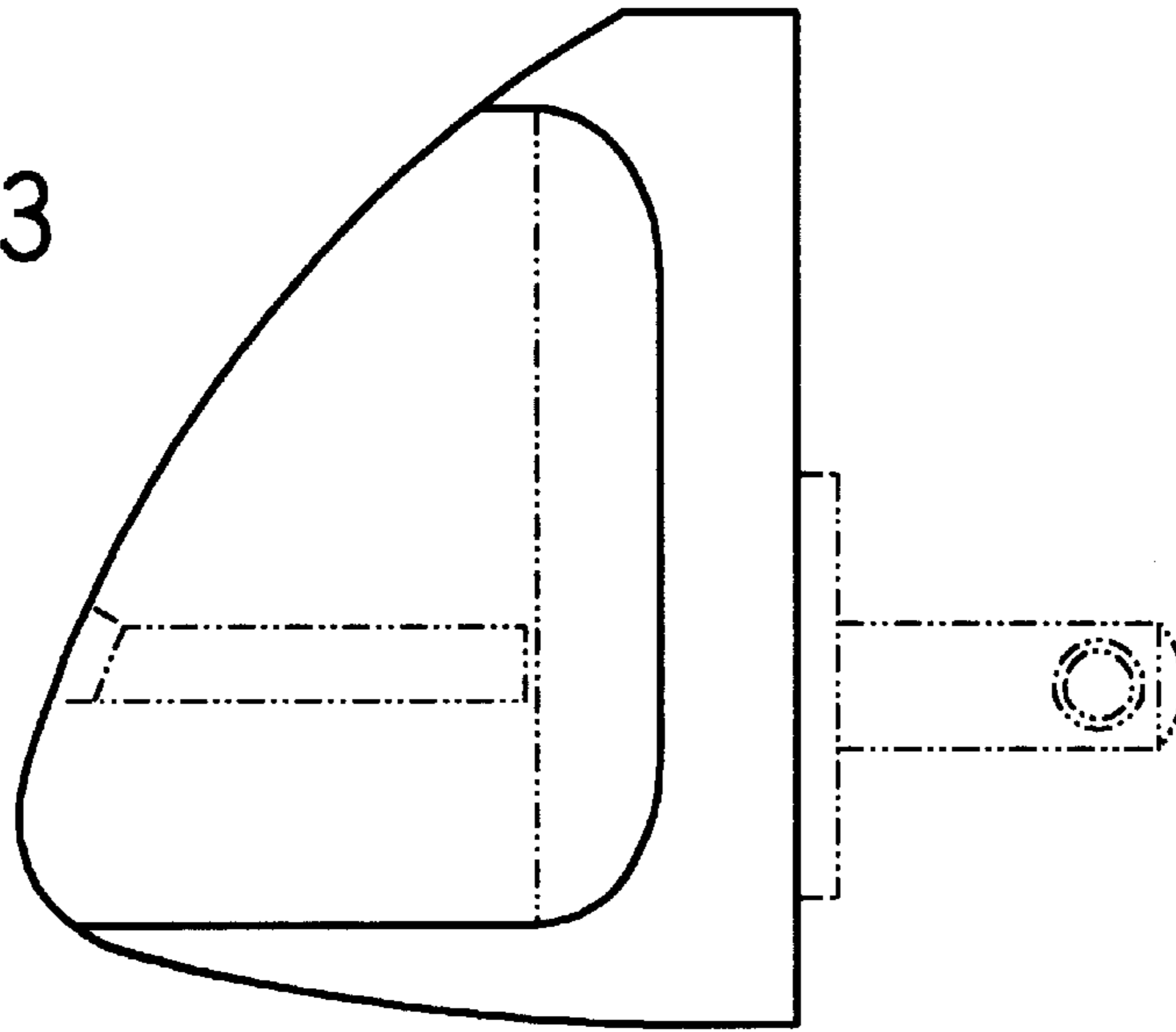

FIG. 4

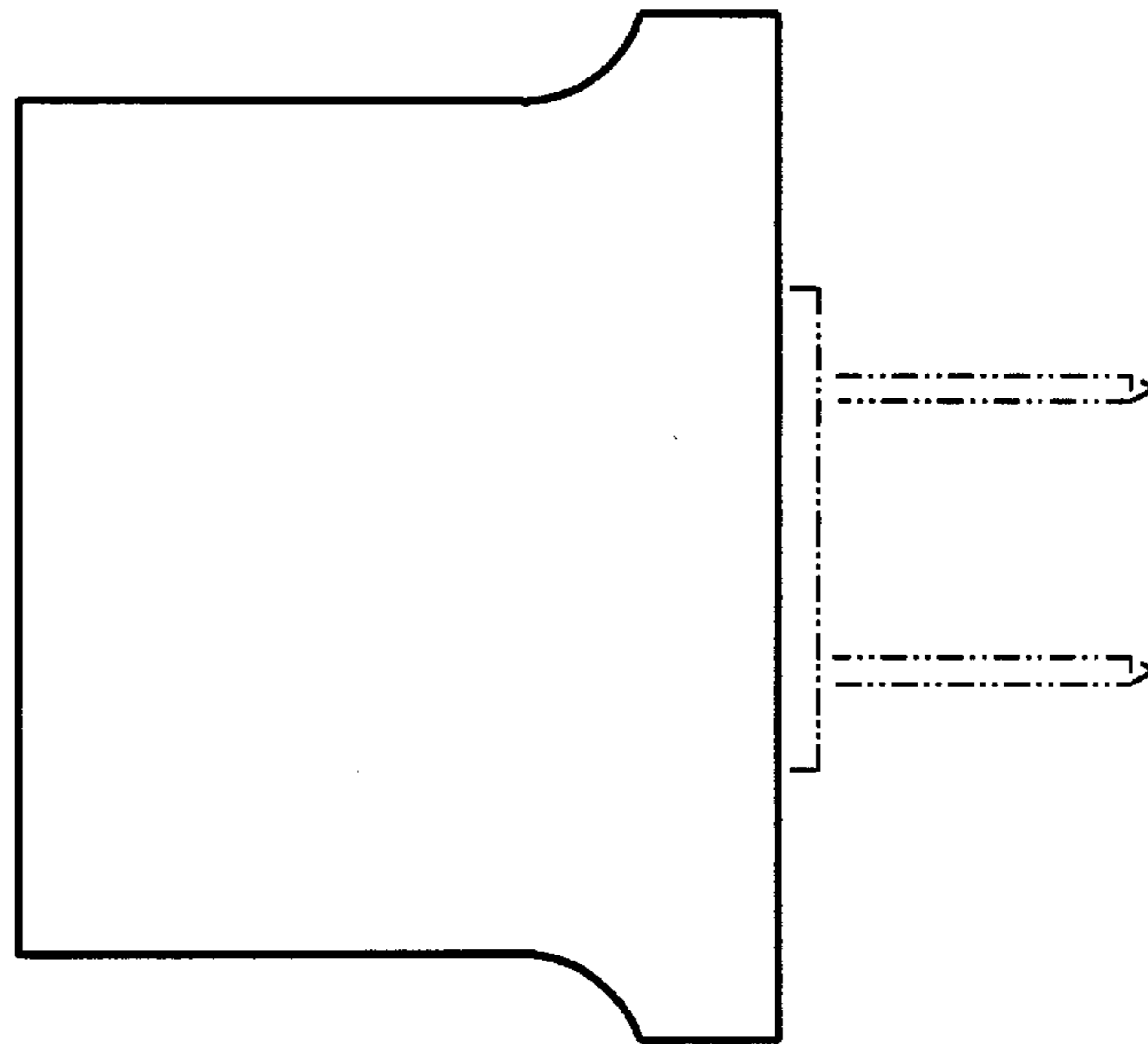

FIG. 5

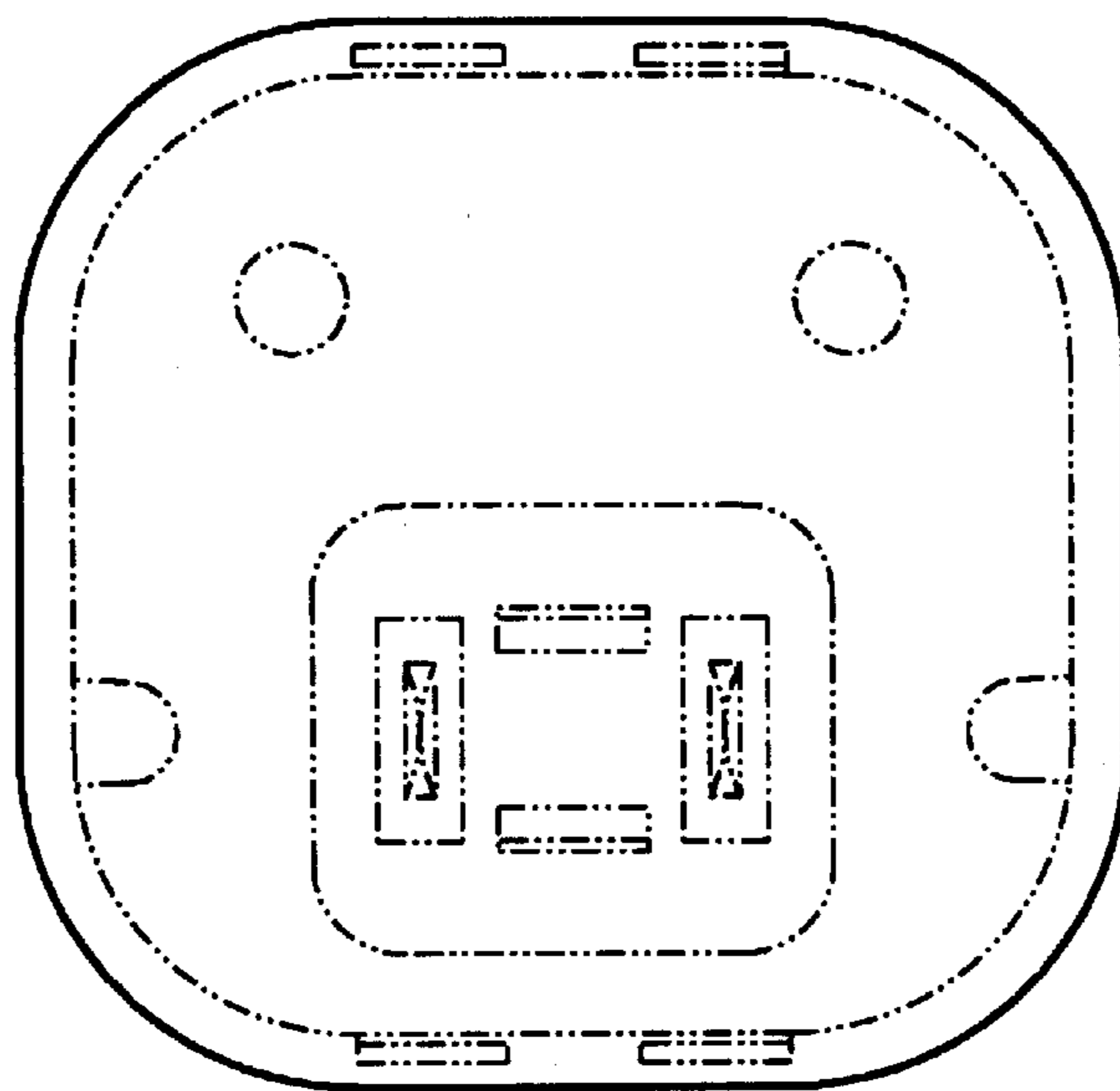

FIG. 6