



US00D529742S

(12) **United States Design Patent**
Gilbert

(10) **Patent No.:** **US D529,742 S**

(45) **Date of Patent:** **** Oct. 10, 2006**

(54) **ACCESSORY POST**

(75) **Inventor:** **Christopher Jon Gilbert**, Moreland Hills, OH (US)

(73) **Assignee:** **Moen Incorporated**, North Olmsted, OH (US)

(**) **Term:** **14 Years**

(21) **Appl. No.:** **29/218,240**

(22) **Filed:** **Nov. 30, 2004**

(51) **LOC (8) Cl.** **06-04**

(52) **U.S. Cl.** **D6/550**

(58) **Field of Classification Search** D6/546-550,
D6/518-523; D8/300, 303, 315-321, 349,
D8/354, 363, 373, 380; 108/28-29; 211/13.1,
211/16, 60.1, 100, 86.01, 87.01, 88.01, 88.04,
211/105.1-105.2, 123, 182, 181.1; 248/175,
248/176.1, 251, 302, 309.1; 16/110.1, 412,
16/415; 242/570, 590, 595-598

See application file for complete search history.

(56) **References Cited**

U.S. PATENT DOCUMENTS

D222,279 S	10/1971	Clayton	
D226,297 S	2/1973	Shames	
4,907,771 A	* 3/1990	Wang	248/251
D418,346 S	1/2000	Lee	
D449,952 S	* 11/2001	Lyndon	D6/549
D451,739 S	* 12/2001	Yeh	D6/550
D452,790 S	1/2002	Chen	
D454,742 S	* 3/2002	Meck et al.	D6/549

D455,948 S	* 4/2002	Zetsche	D8/367
D461,985 S	* 8/2002	Fuchs	D6/550
D462,554 S	* 9/2002	Fuchs	D6/550
D477,953 S	8/2003	Gilbert	
D493,993 S	* 8/2004	Roberts et al.	D6/550
D495,181 S	* 8/2004	Sale, Jr.	D6/550
D499,292 S	* 12/2004	Sale, Jr.	D6/550
D499,592 S	* 12/2004	Sale, Jr.	D6/550
D501,110 S	* 1/2005	Roberts, III et al.	D6/550
D502,346 S	* 3/2005	Berberet	D6/550

* cited by examiner

Primary Examiner—Brian N Vinson

(74) *Attorney, Agent, or Firm*—Calfee, Halter & Griswold LLP

(57) **CLAIM**

The ornamental design for an accessory post, as shown and described.

DESCRIPTION

FIG. 1 is a perspective view of an accessory post of the new design;

FIG. 2 is a top plan view of the accessory post of FIG. 1, the bottom being a mirror image;

FIG. 3 is a front elevational view of the accessory post of FIG. 1;

FIG. 4 is a side elevational view of the accessory post of FIG. 1, the other side being a mirror image; and,

FIG. 5 is a rear elevational view of the accessory post of FIG. 1.

The portions of the Figures shown in broken lines are not part of the claimed design but are for illustration only.

1 Claim, 1 Drawing Sheet

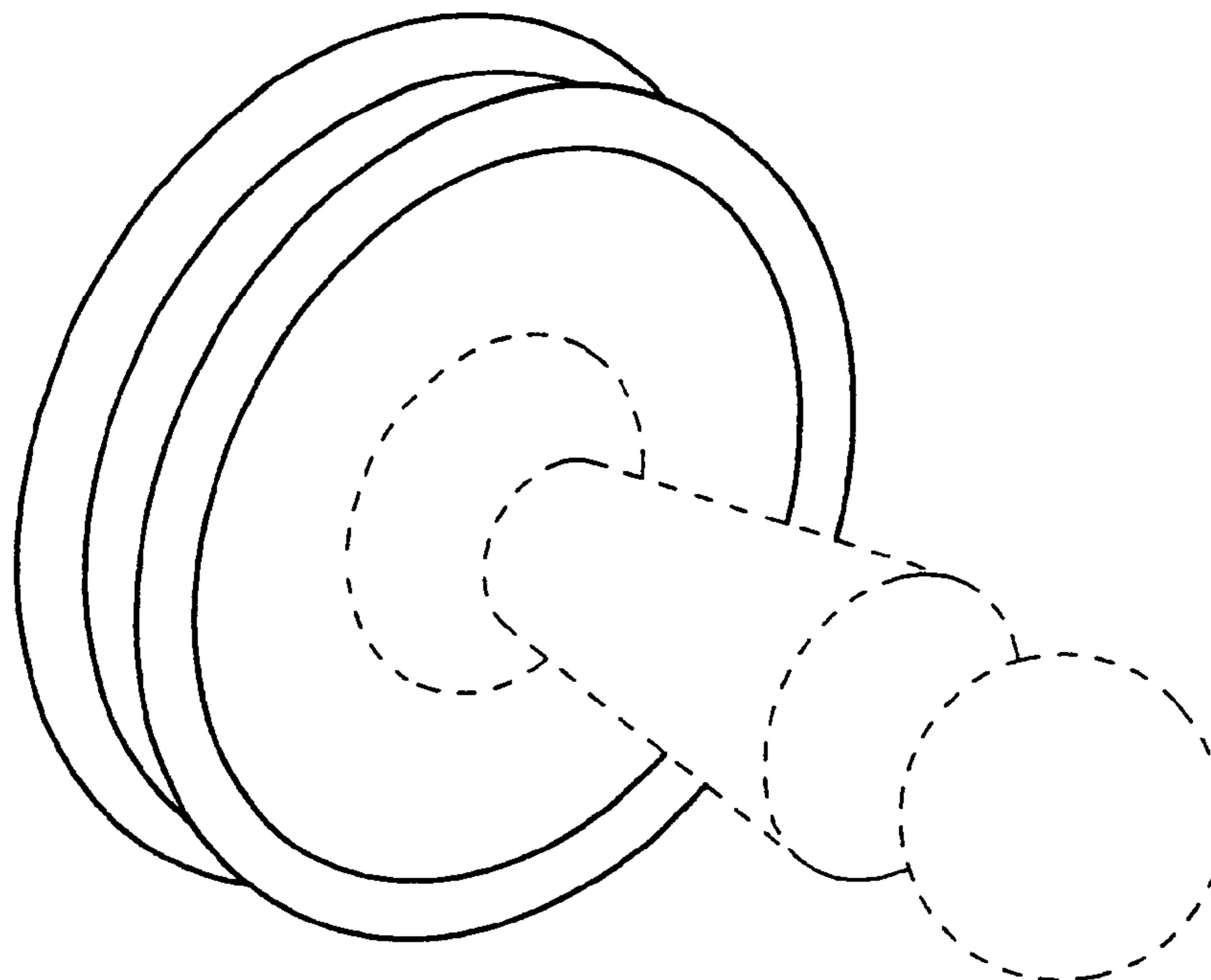

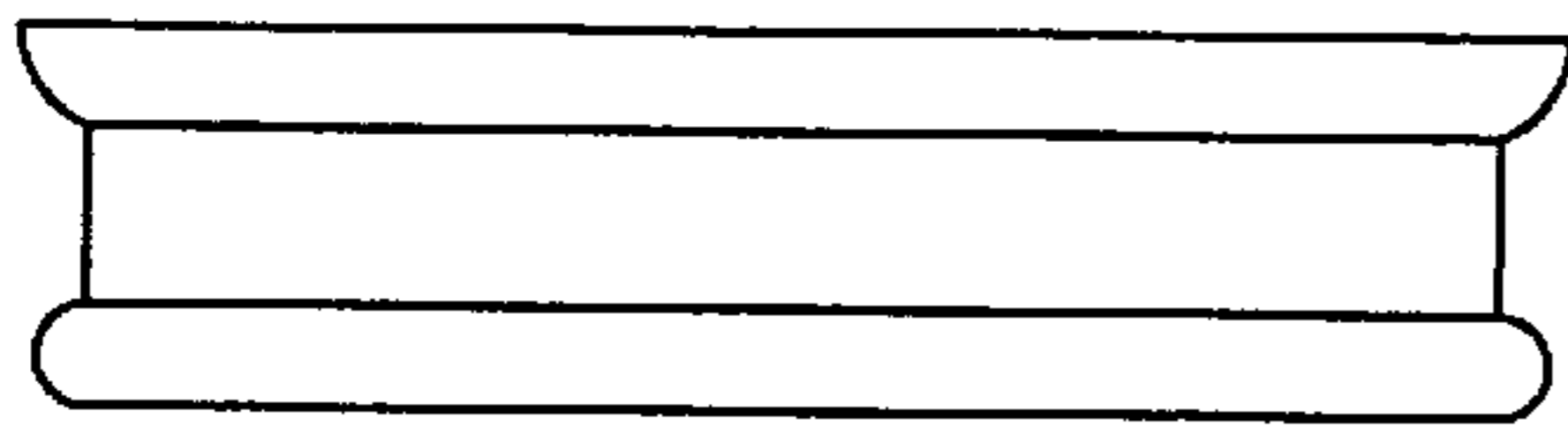
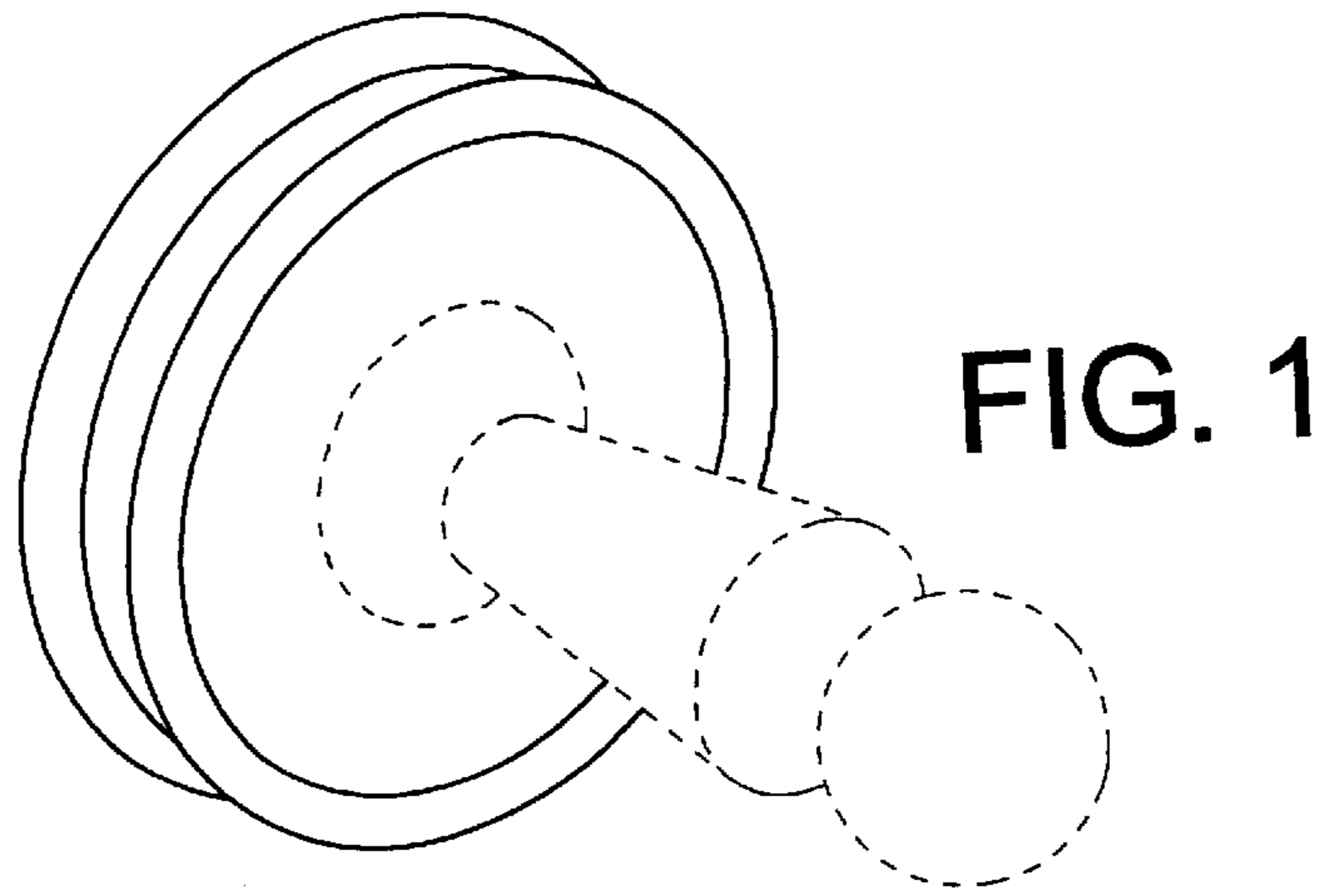

FIG. 2

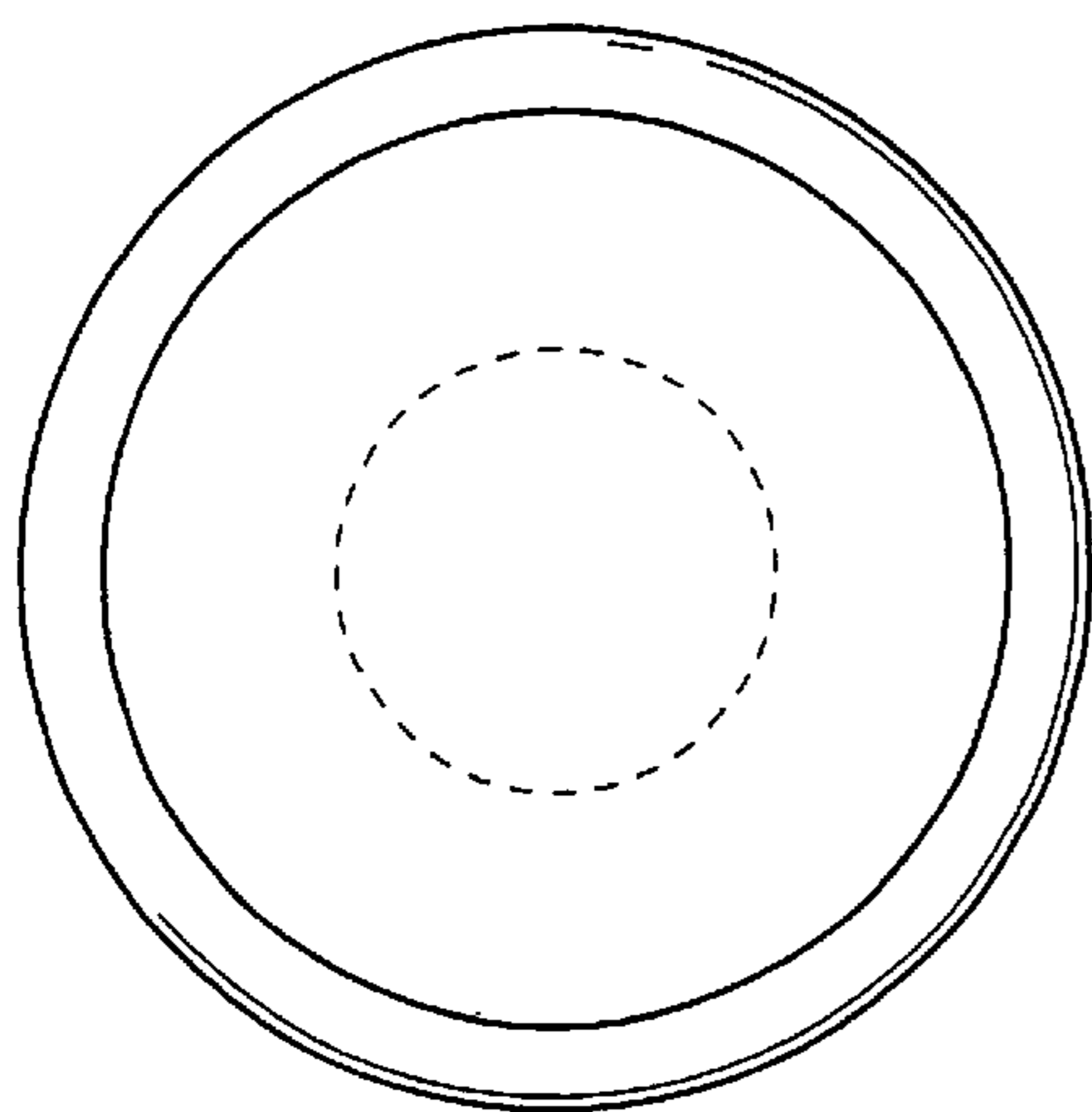

FIG. 3



FIG. 4

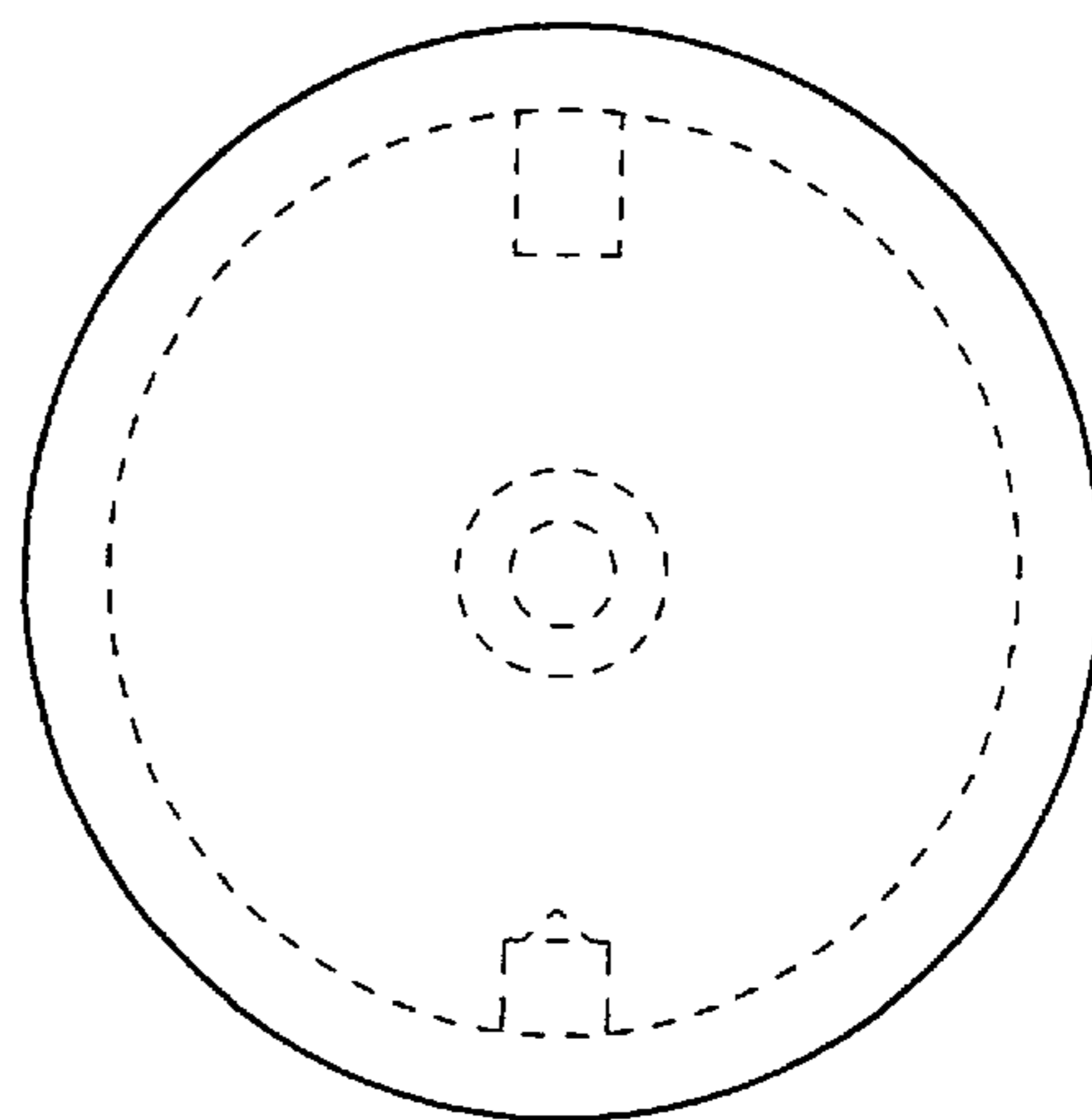

FIG. 5