



US00D529554S

(12) **United States Design Patent**
Tou

(10) **Patent No.:** **US D529,554 S**

(45) **Date of Patent:** **** Oct. 3, 2006**

(54) **HAND-HELD CRAFT PUNCH AND
RETRACTABLE BLADE**

D512,617 S * 12/2005 Adams et al. D8/50
D515,374 S * 2/2006 Sinisi D8/50
2005/0257658 A1 * 11/2005 Weng 83/588

(75) Inventor: **Chie Tou**, Kowloon (HK)

* cited by examiner

(73) Assignee: **Midas Enterprises (Far East) Ltd.**,
Kowloon (HK)

Primary Examiner—Elizabeth A. Albert
(74) *Attorney, Agent, or Firm*—Law Office of Sergei Orel,
LLC

(**) Term: **14 Years**

(57) **CLAIM**

(21) Appl. No.: **29/218,608**

The ornamental design for a hand-held craft punch and retractable blade, as shown and described.

(22) Filed: **Dec. 3, 2004**

(30) **Foreign Application Priority Data**

DESCRIPTION

Aug. 12, 2004 (HK) 0411797

(51) **LOC (8) Cl.** **19-02**

(52) **U.S. Cl.** **D19/72**

(58) **Field of Classification Search** D8/49,
D8/98; D19/72, 73; 30/229, 358, 363; 83/467.1,
83/588, 620, 633, 684, 691, 698.91; 227/134
See application file for complete search history.

FIG. 1 is a front elevational view of the hand-held craft punch and retractable blade showing my new design;
FIG. 2 is a rear elevational view thereof;
FIG. 3 is a left side elevational view thereof;
FIG. 4 is a right side elevational view thereof;
FIG. 5 is a top plan view thereof;
FIG. 6 is a bottom plan view thereof;
FIG. 7 is perspective view thereof; and,
FIG. 8 is an exploded perspective view thereof, with lowered handle.

(56) **References Cited**

U.S. PATENT DOCUMENTS

D491,230 S * 6/2004 Lee D19/72

1 Claim, 6 Drawing Sheets

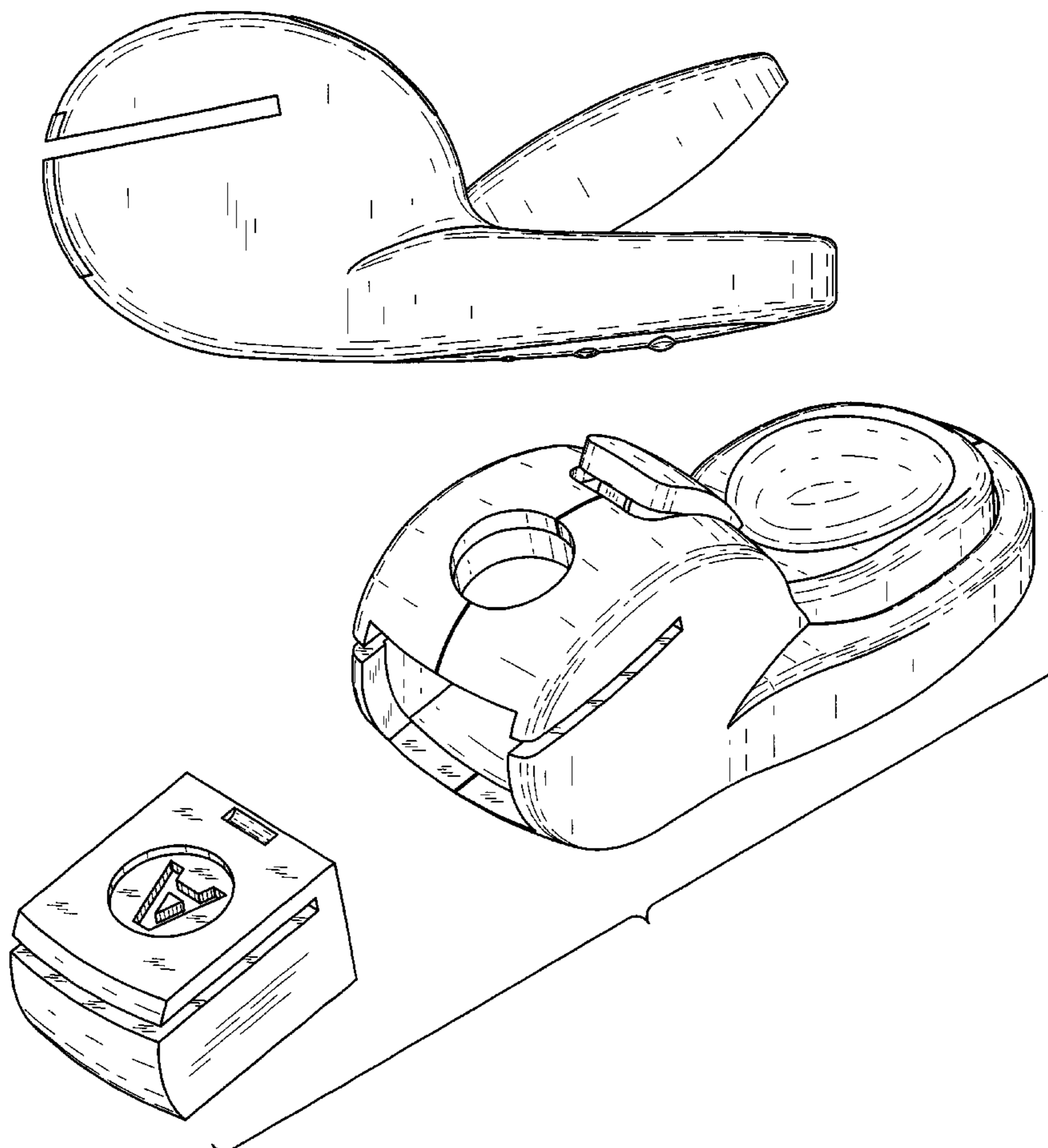

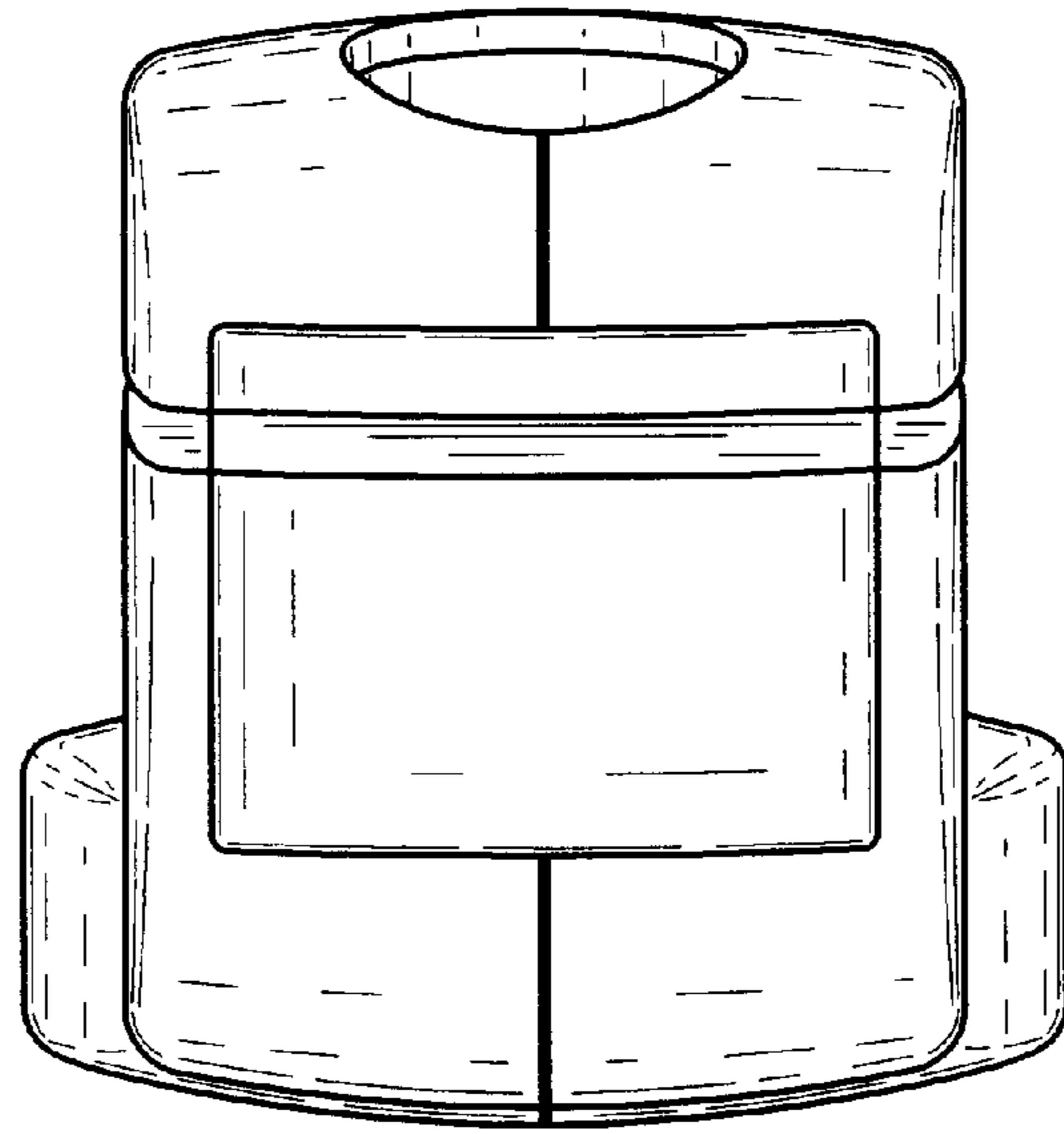

Fig.1

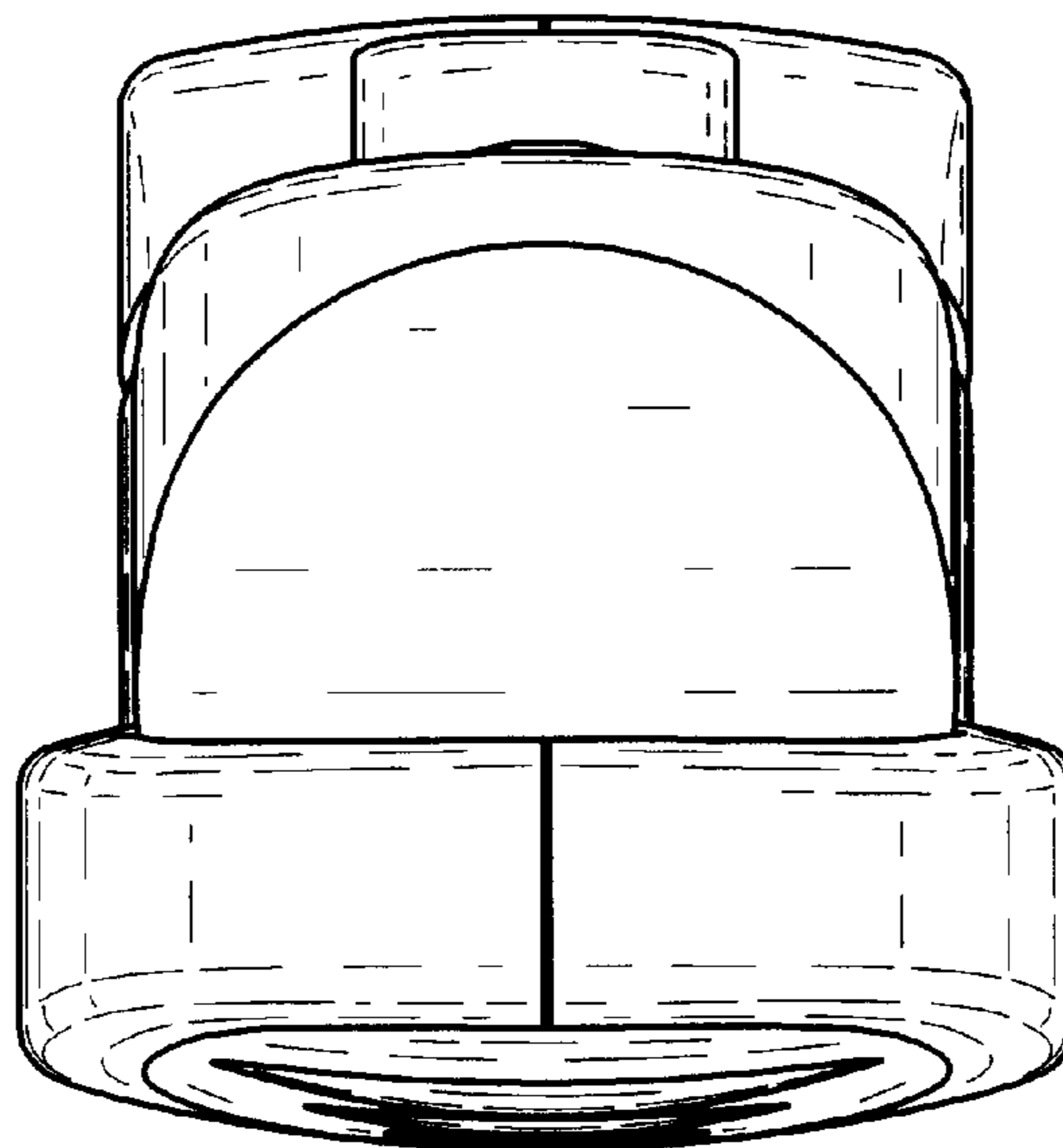

Fig.2

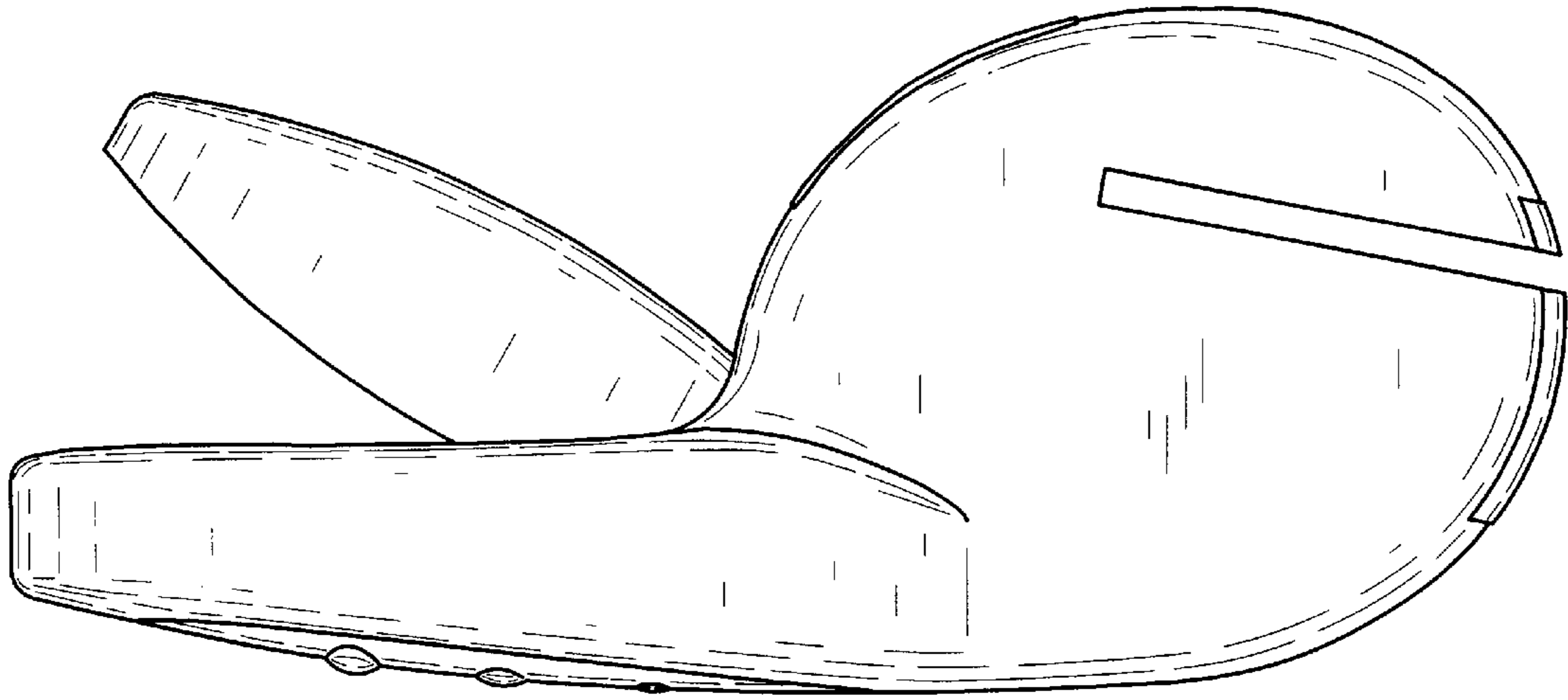

Fig.3

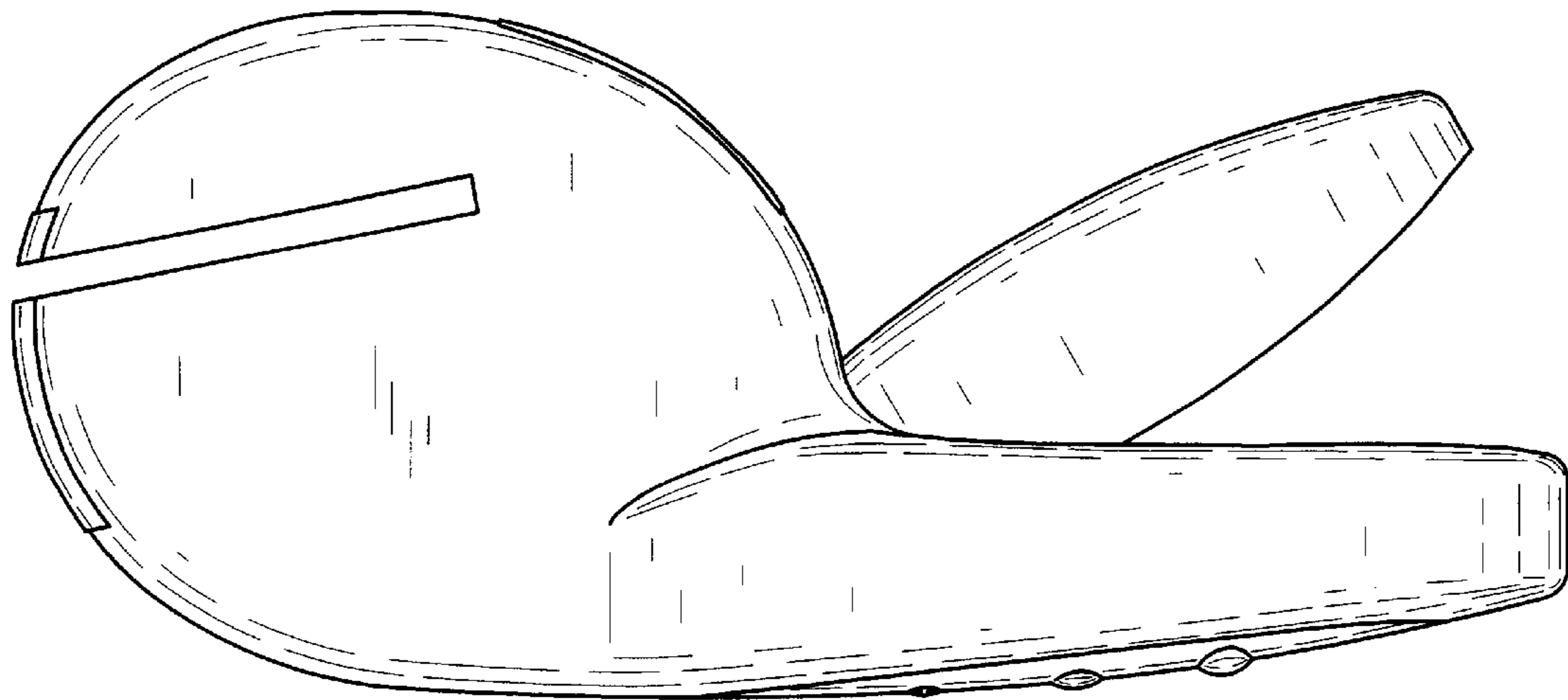

Fig.4

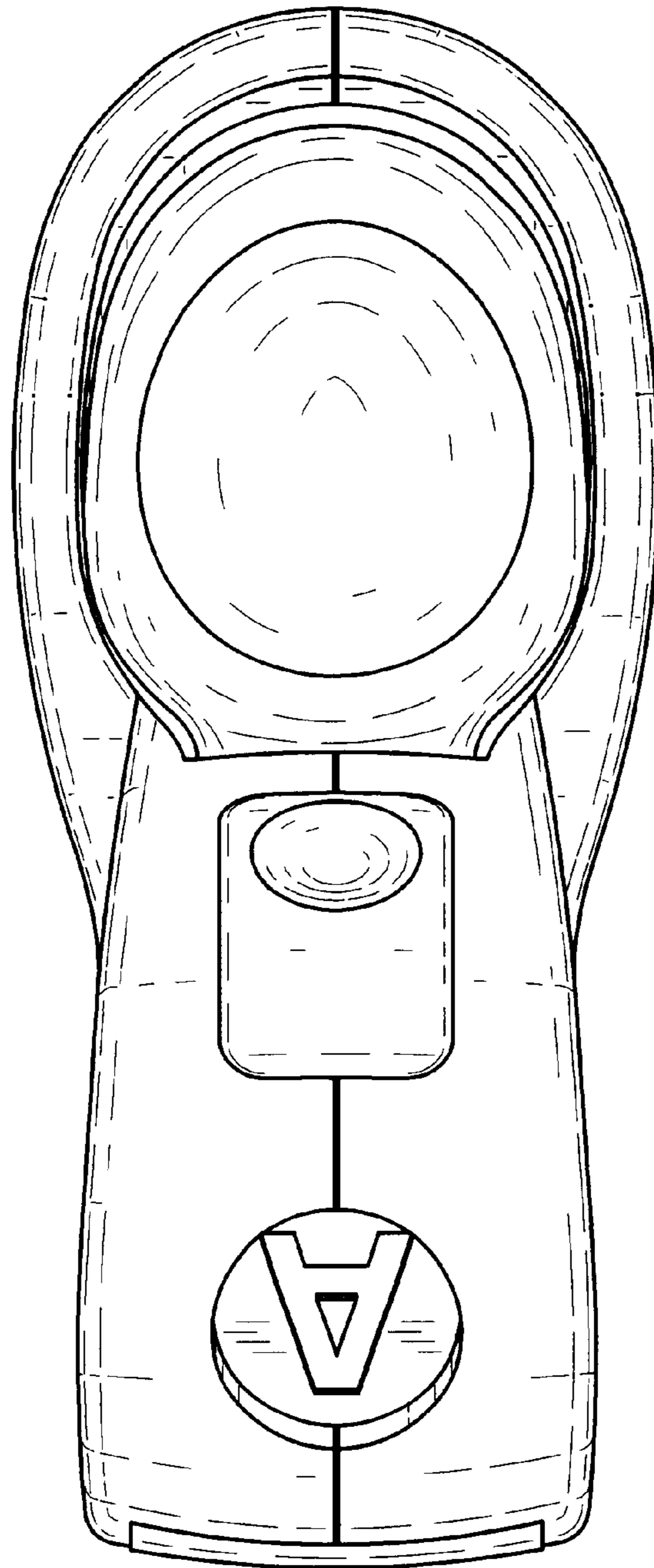

Fig.5

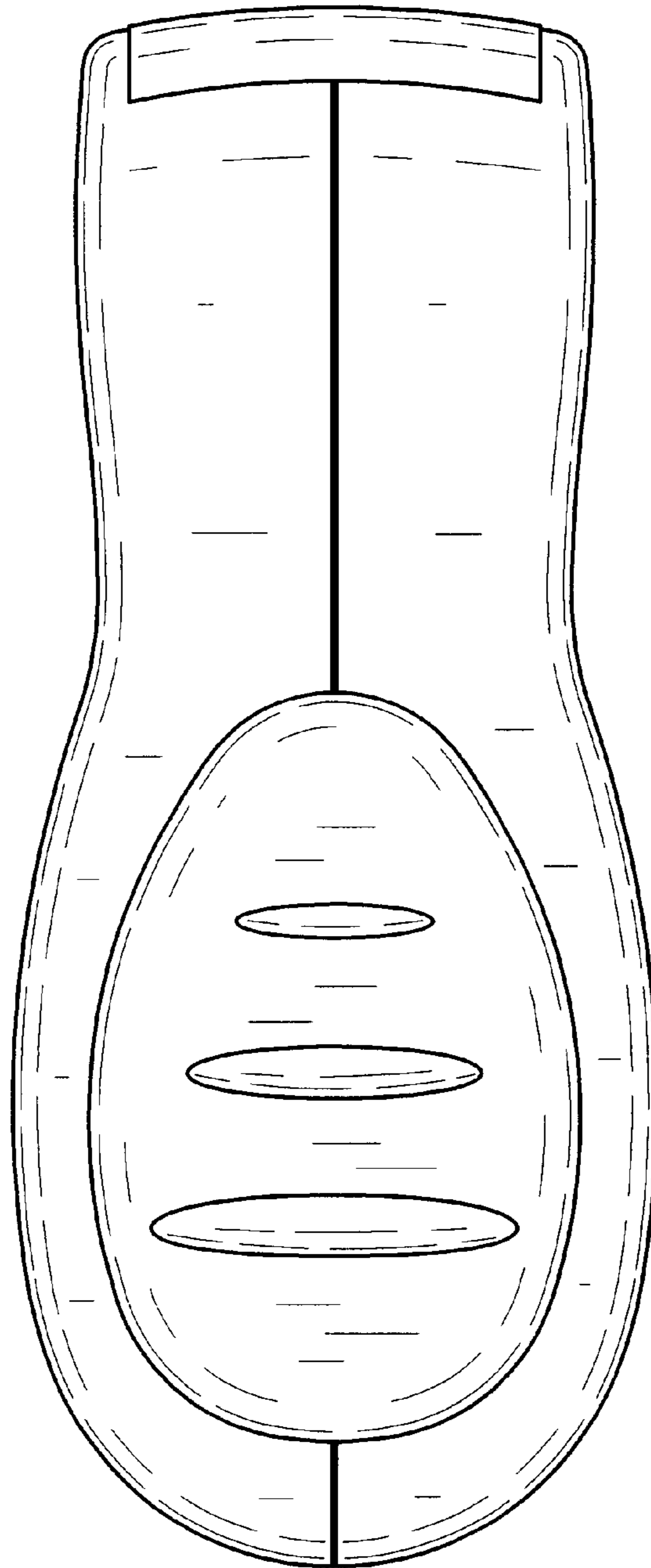

Fig.6

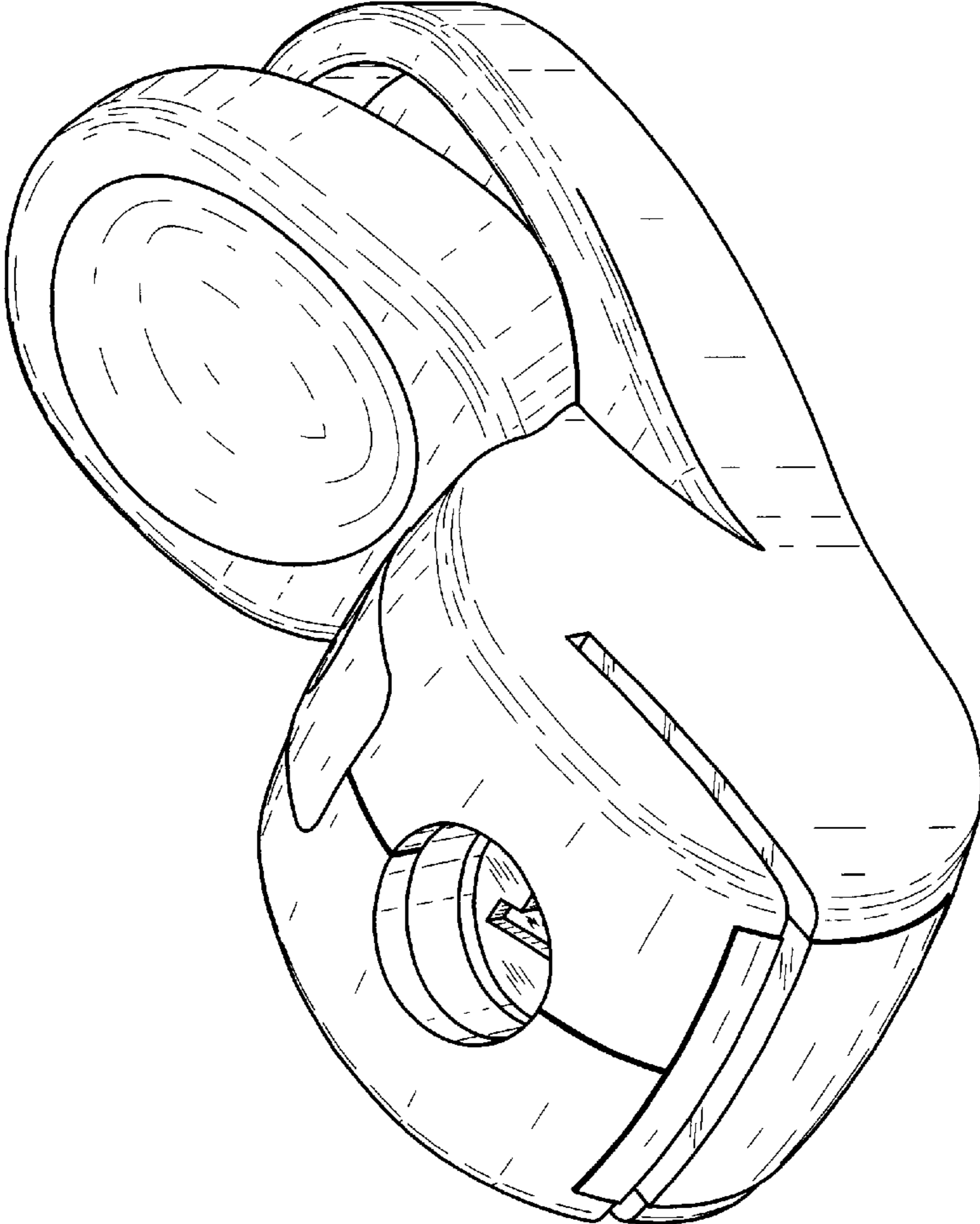

Fig.7

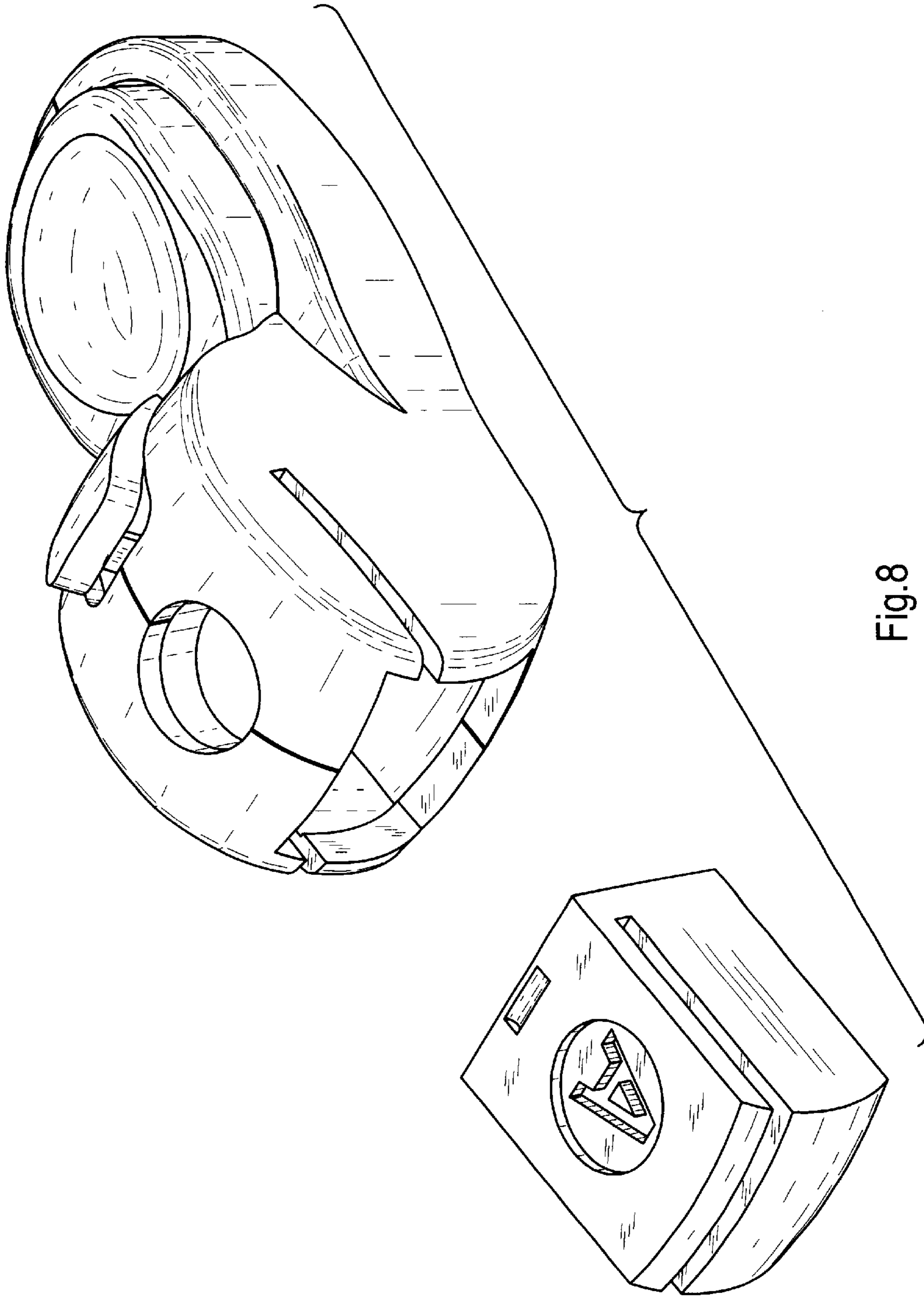

Fig.8