

US00D529358S

(12) **United States Design Patent**
Wright

(10) **Patent No.:** **US D529,358 S**

(45) **Date of Patent:** **** Oct. 3, 2006**

(54) **SAW**
(75) **Inventor:** **Stuart J. Wright**, Timonium, MD (US)
(73) **Assignee:** **Black & Decker Inc.**, Newark, DE (US)
(**) **Term:** **14 Years**

D391,973 S * 3/1998 Price et al. D15/133
D400,215 S * 10/1998 Price et al. D15/133
D412,510 S * 8/1999 Chen D15/133
D415,942 S * 11/1999 Shibata et al. D8/66
D471,216 S * 3/2003 Hollinger et al. D15/133
D479,454 S * 9/2003 Shih D8/66

* cited by examiner

(21) **Appl. No.:** **29/252,976**
(22) **Filed:** **Jan. 31, 2006**

Primary Examiner—Cathron C. Brooks
Assistant Examiner—Austin Murphy
(74) *Attorney, Agent, or Firm*—Adan Ayala

(51) **LOC (8) Cl.** **08-03**
(52) **U.S. Cl.** **D8/66**
(58) **Field of Classification Search** D8/69,
D8/68, 67; D15/133; 83/397, 468.3, 469,
83/471.3; 30/377, 378, 388, 391
See application file for complete search history.

(57) **CLAIM**

The ornamental design for a saw, as shown and described.

DESCRIPTION

FIG. 1 is a perspective view of a saw according to the invention.
FIG. 2 is a front elevational view thereof.
FIG. 3 is a rear elevational view thereof.
FIG. 4 is a left elevational view thereof.
FIG. 5 is a right elevational view thereof.
FIG. 6 is a top plan view thereof; and,
FIG. 7 is a bottom plan view thereof.

(56) **References Cited**
U.S. PATENT DOCUMENTS

D317,110 S * 5/1991 Arehart D8/66
D331,416 S * 12/1992 Fushiya et al. D15/133
D346,173 S * 4/1994 Price D15/133
D374,803 S * 10/1996 Terpstra et al. D8/66
D388,443 S * 12/1997 Kondo D15/133

1 Claim, 7 Drawing Sheets

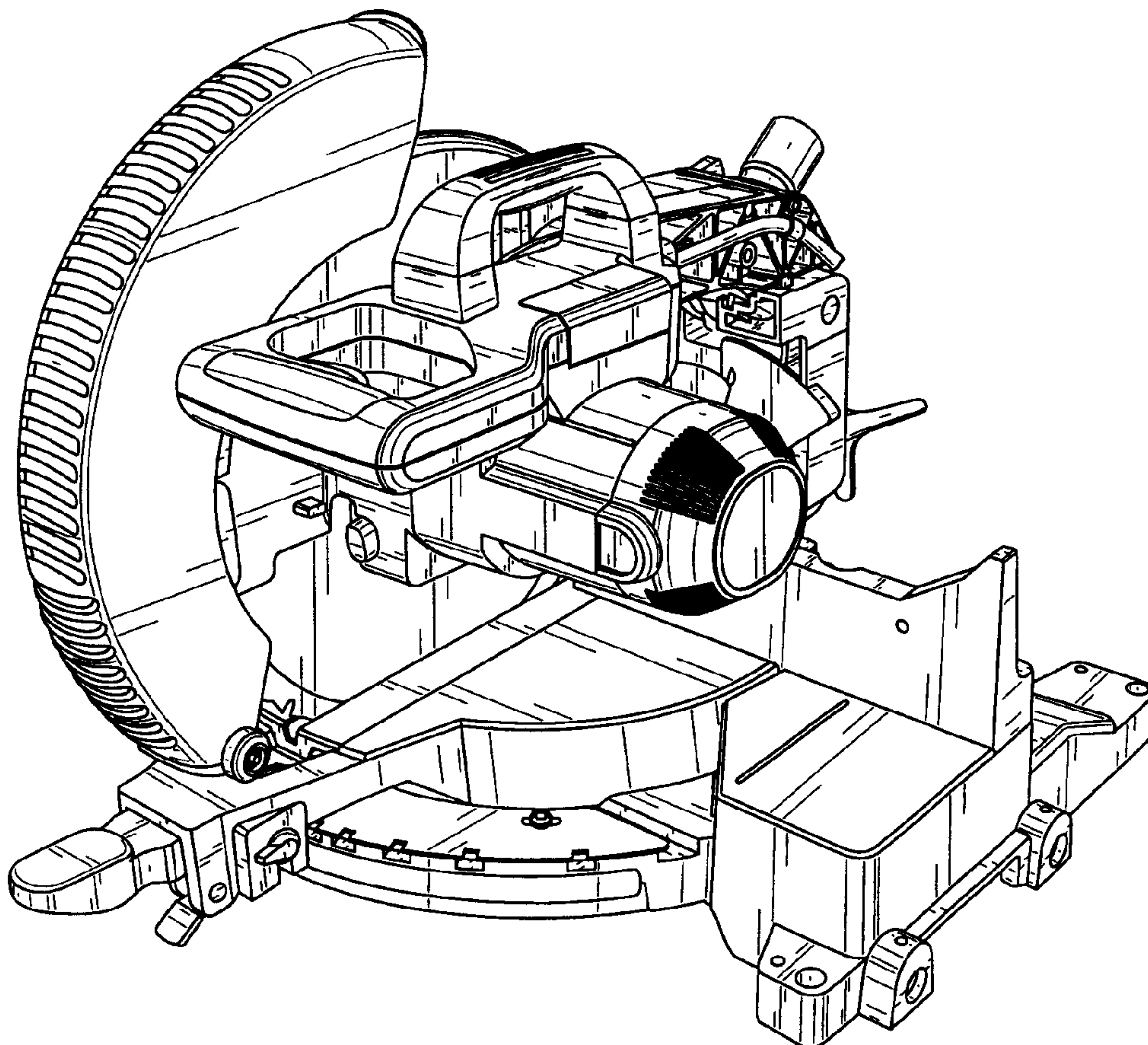

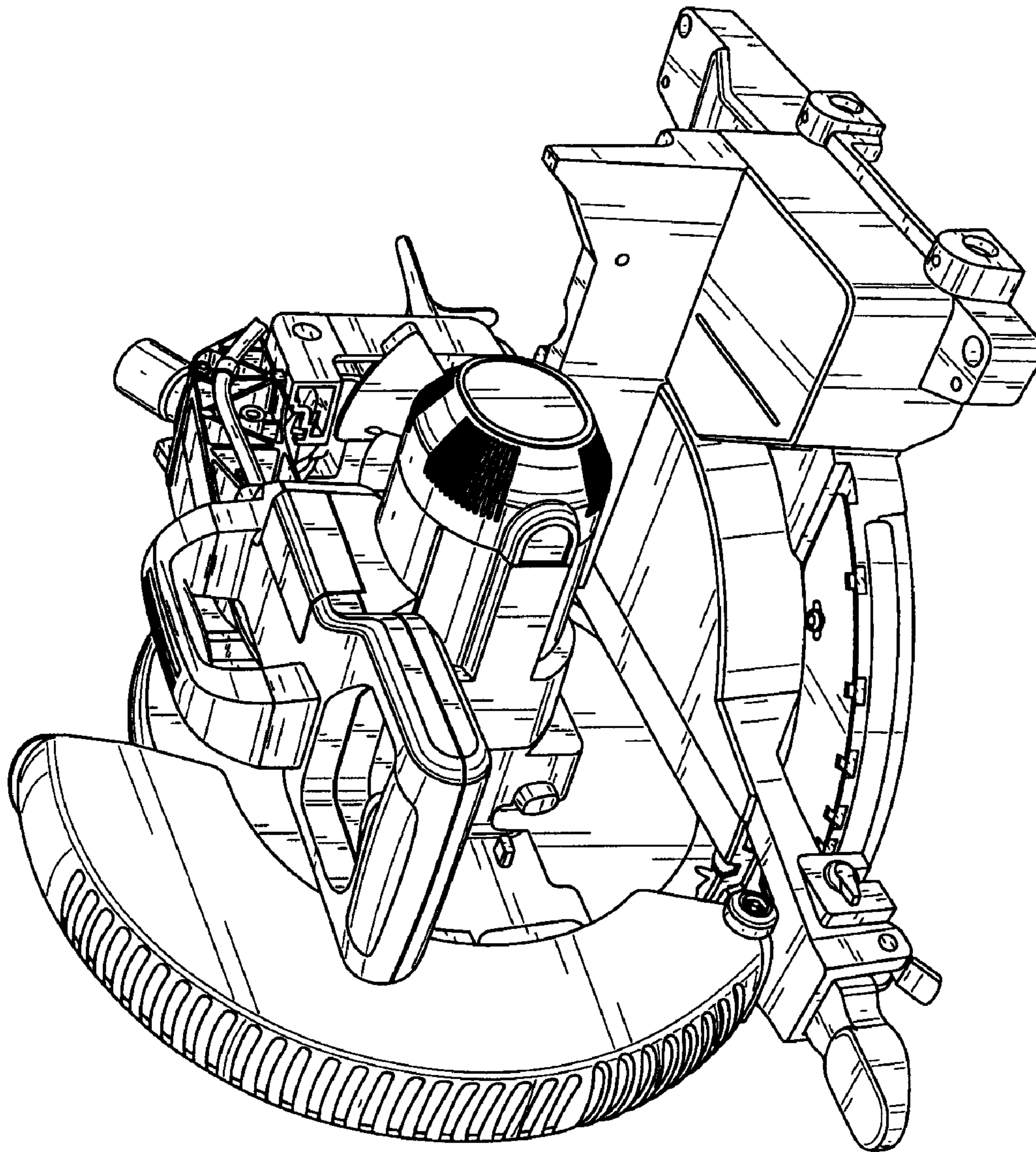

FIG. 1

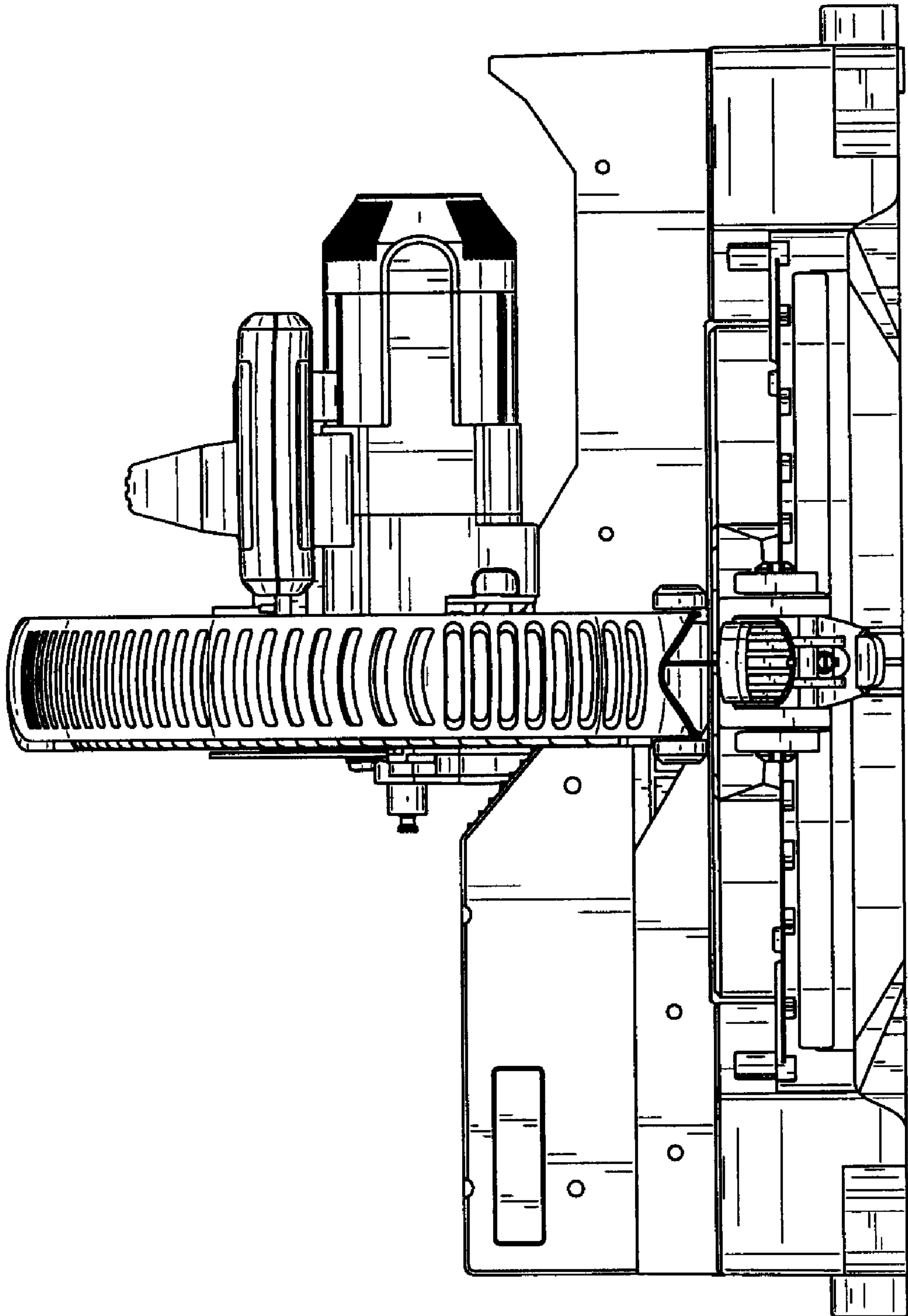

FIG. 2

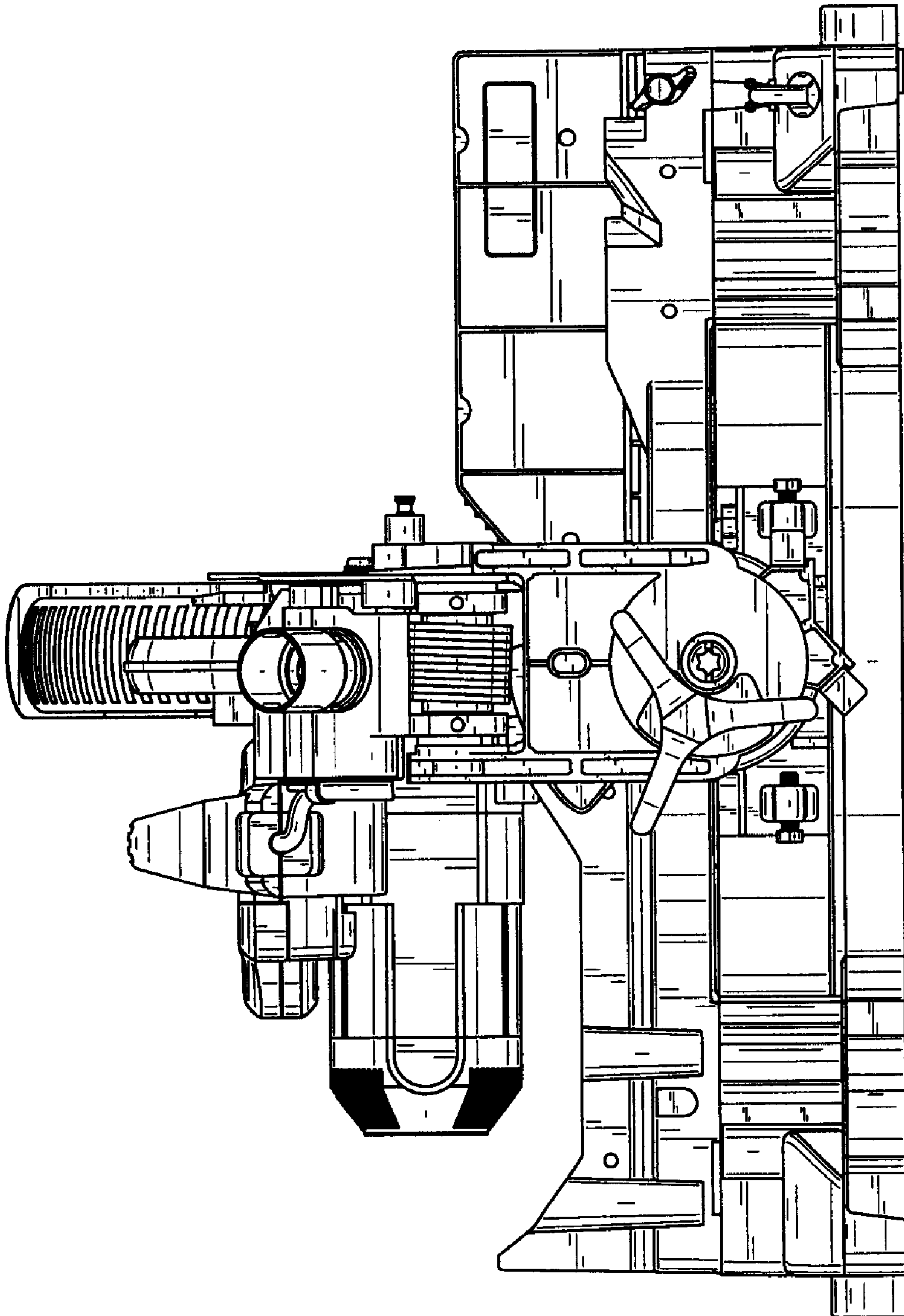

FIG. 3

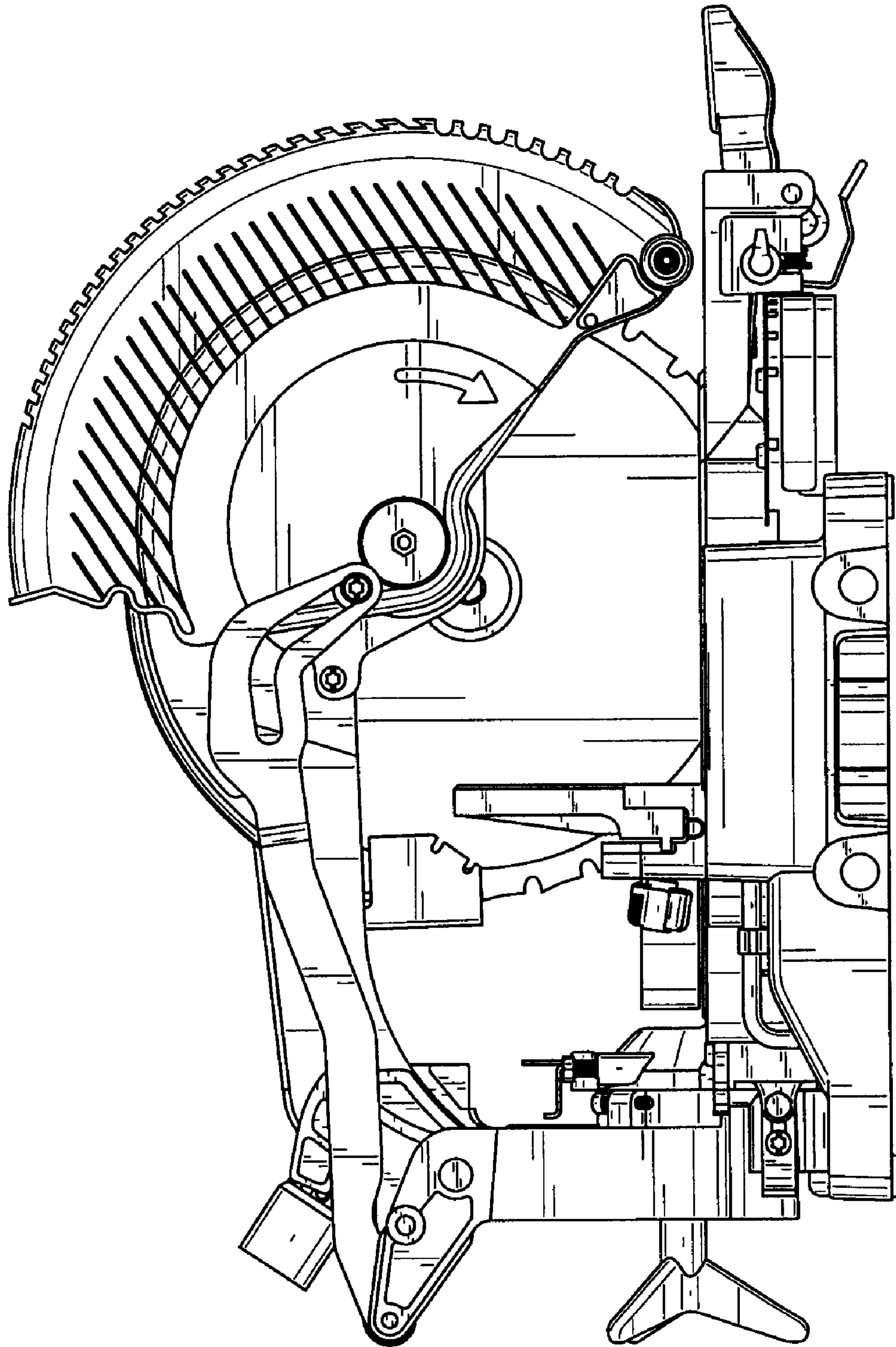

FIG. 4

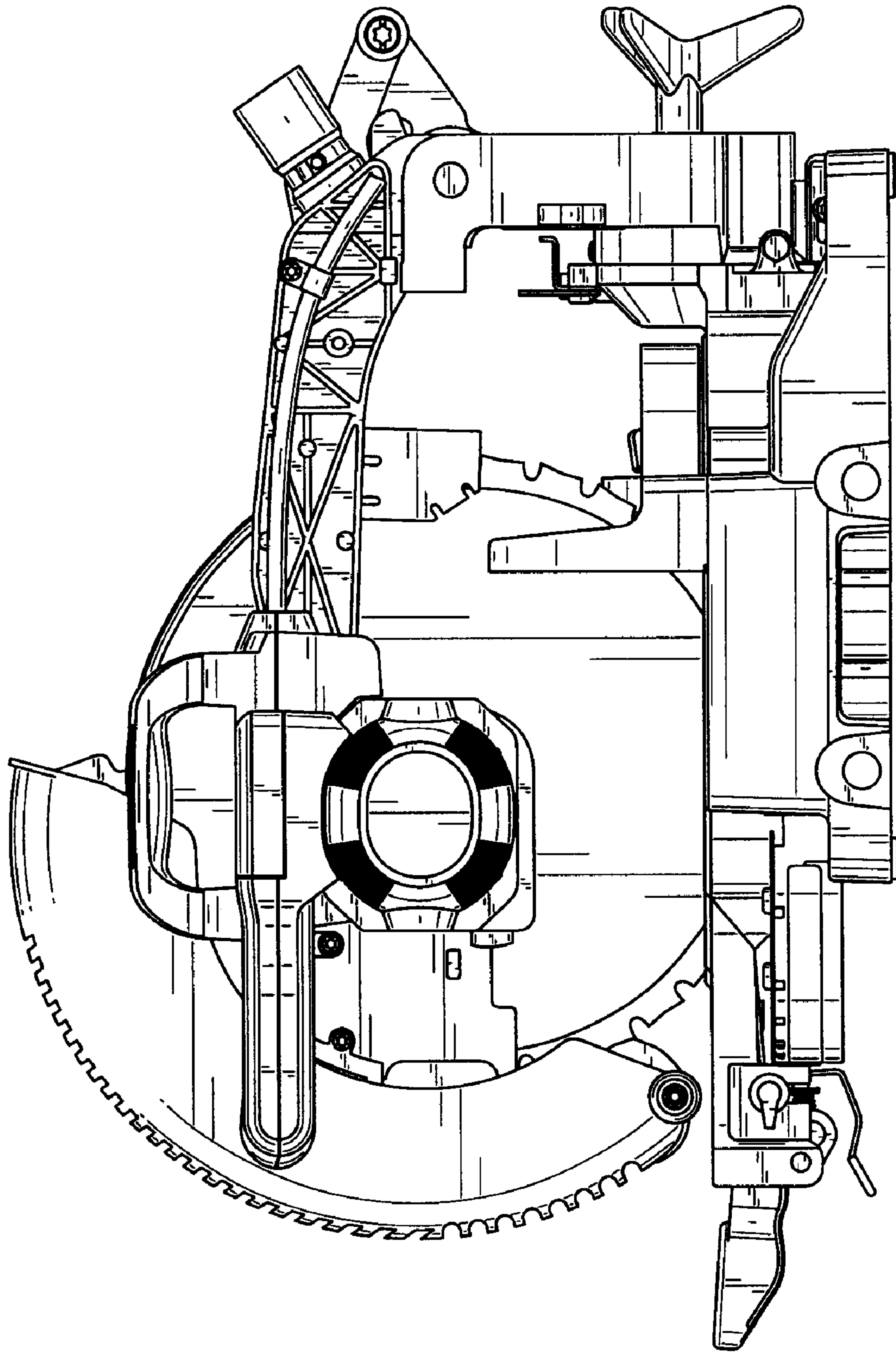

FIG. 5

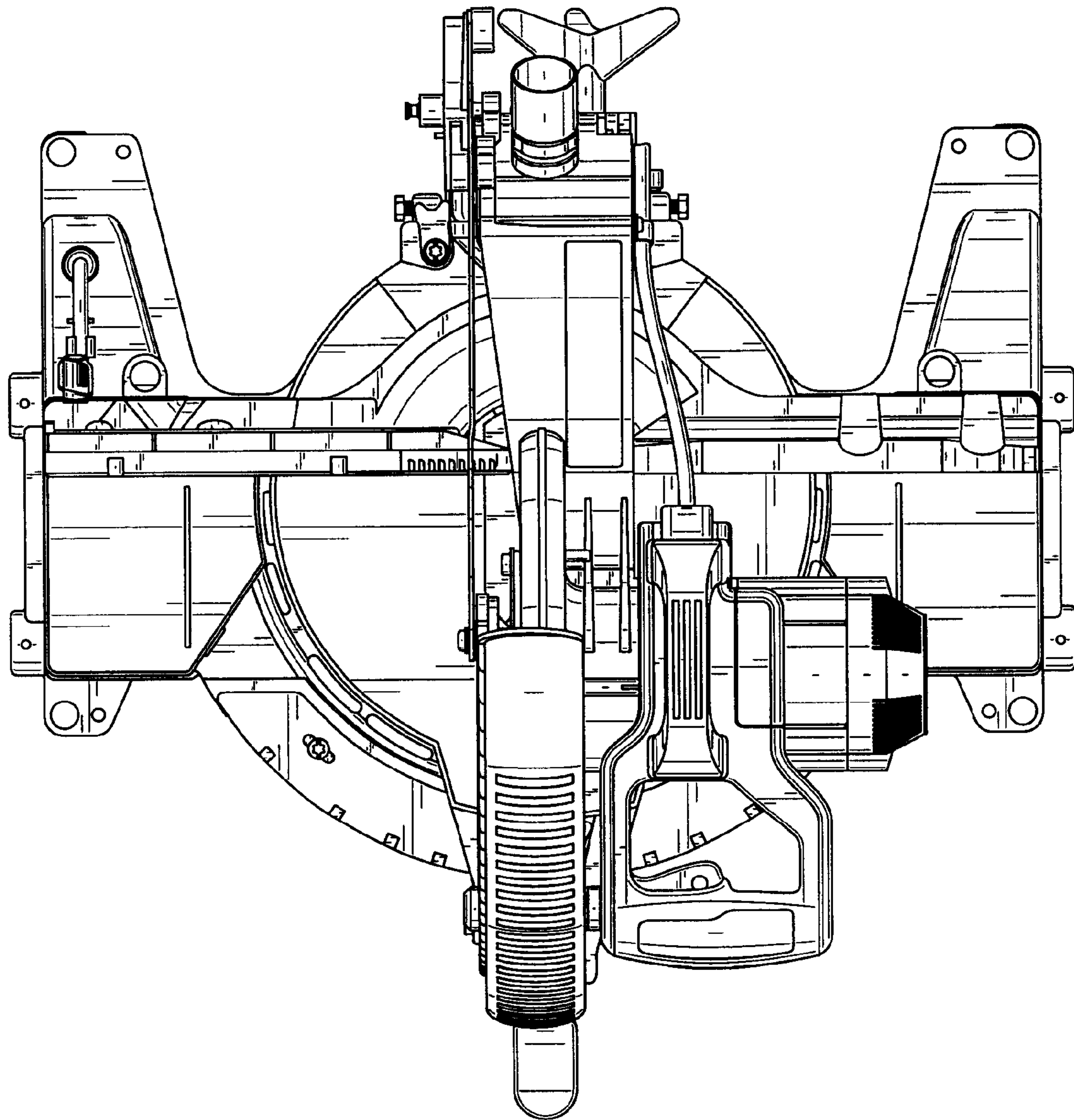

FIG. 6

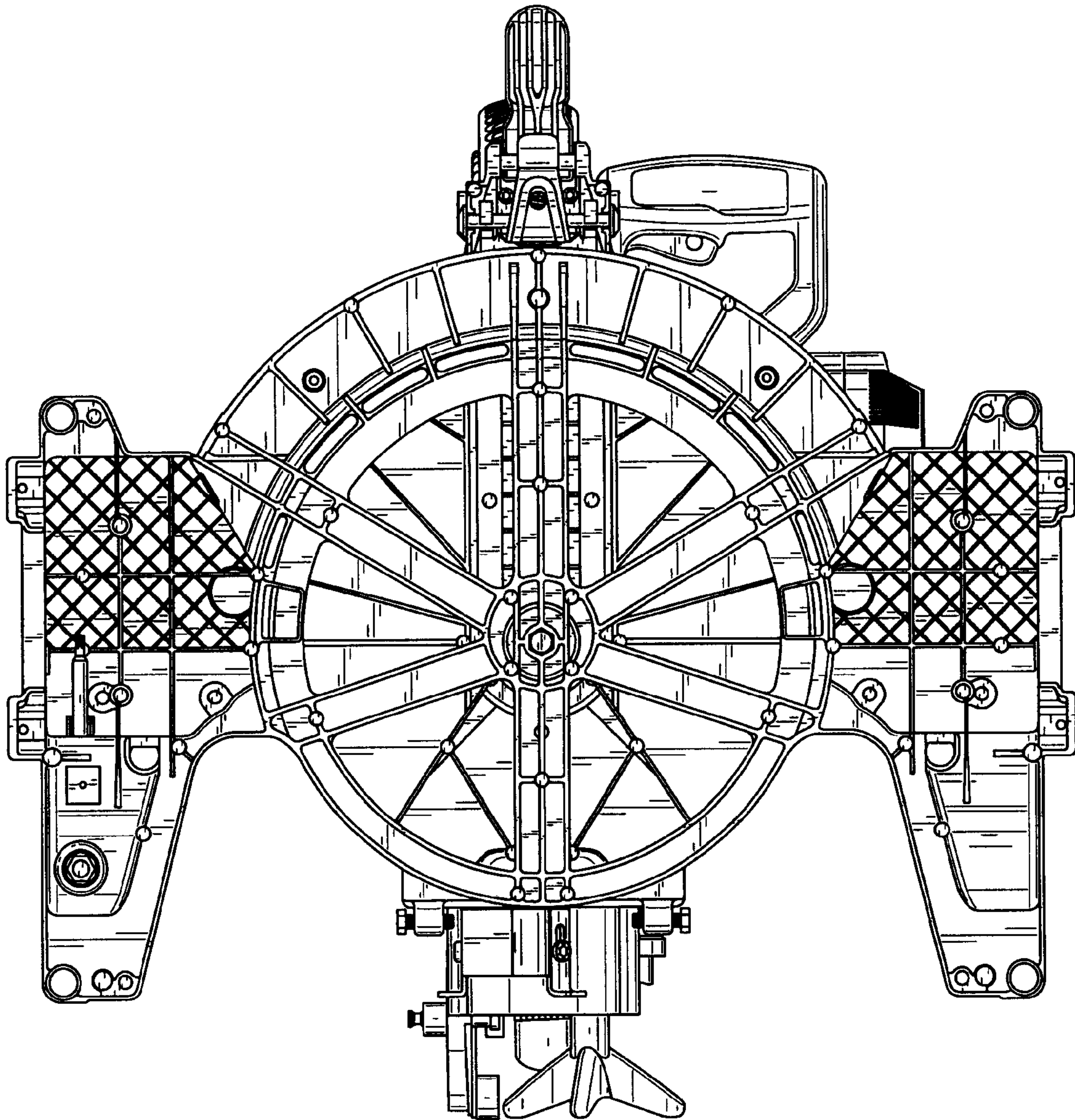

FIG. 7