

US00D525503S

(12) **United States Design Patent**  
**Waldron**

(10) **Patent No.:** **US D525,503 S**

(45) **Date of Patent:** **\*\* Jul. 25, 2006**

(54) **CIRCULAR LASER SAW**

(75) Inventor: **Michael Waldron**, County Durham  
(GB)

(73) Assignee: **GMCA PTY Ltd.** (AU)

(\*\*) Term: **14 Years**

(21) Appl. No.: **29/209,283**

(22) Filed: **Jul. 14, 2004**

(30) **Foreign Application Priority Data**

Feb. 3, 2004 (EM) ..... 136882

(51) **LOC (8) Cl.** ..... **08-03**

(52) **U.S. Cl.** ..... **D8/66**

(58) **Field of Classification Search** ..... D8/69,  
D8/68, 67, 66, 64, 61, 70; 83/698.41, 747;  
30/166.3, 374, 373, 375, 376, 391, 377, 390,  
30/388, 389; 125/13.01; 144/218

See application file for complete search history.

(56) **References Cited**

**U.S. PATENT DOCUMENTS**

5,121,545 A \* 6/1992 Nonaka et al. .... 30/376  
D329,363 S \* 9/1992 Sasaki et al. .... D8/66  
D334,523 S \* 4/1993 Hoshino et al. .... D8/66  
5,327,649 A \* 7/1994 Skinner ..... 30/124  
5,873,169 A \* 2/1999 James et al. .... 30/391  
5,924,207 A \* 7/1999 Price et al. .... 30/376

6,167,626 B1 \* 1/2001 Doumani et al. .... 30/124  
D453,099 S \* 1/2002 Welsh ..... D8/66  
D474,952 S \* 5/2003 Andriolo ..... D8/66  
6,681,493 B1 \* 1/2004 Mori et al. .... 30/376  
D499,001 S \* 11/2004 Wu ..... D8/66  
D501,776 S \* 2/2005 Wu ..... D8/66  
D502,373 S \* 3/2005 Wu ..... D8/66  
D503,878 S \* 4/2005 Tillman et al. .... D8/66  
6,951,057 B1 \* 10/2005 Yoshida et al. .... 30/376  
2003/0024128 A1 \* 2/2003 Kani ..... 30/376  
2003/0024368 A1 \* 2/2003 Fukuoka ..... 83/698.41

\* cited by examiner

*Primary Examiner*—Cathron C. Brooks

*Assistant Examiner*—Austin Murphy

(74) *Attorney, Agent, or Firm*—McKee, Voorhees & Sease,  
P.L.C.

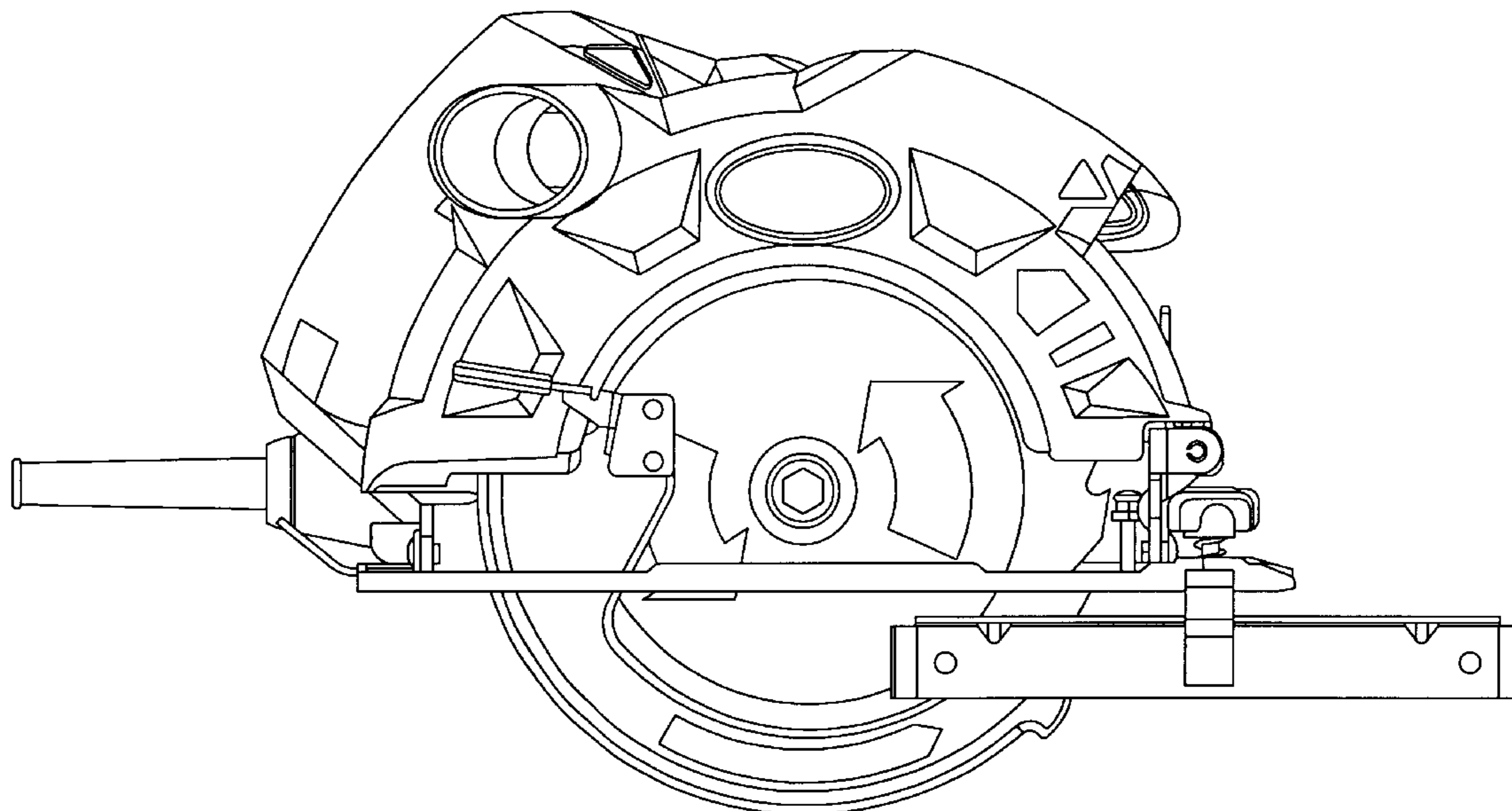
(57) **CLAIM**

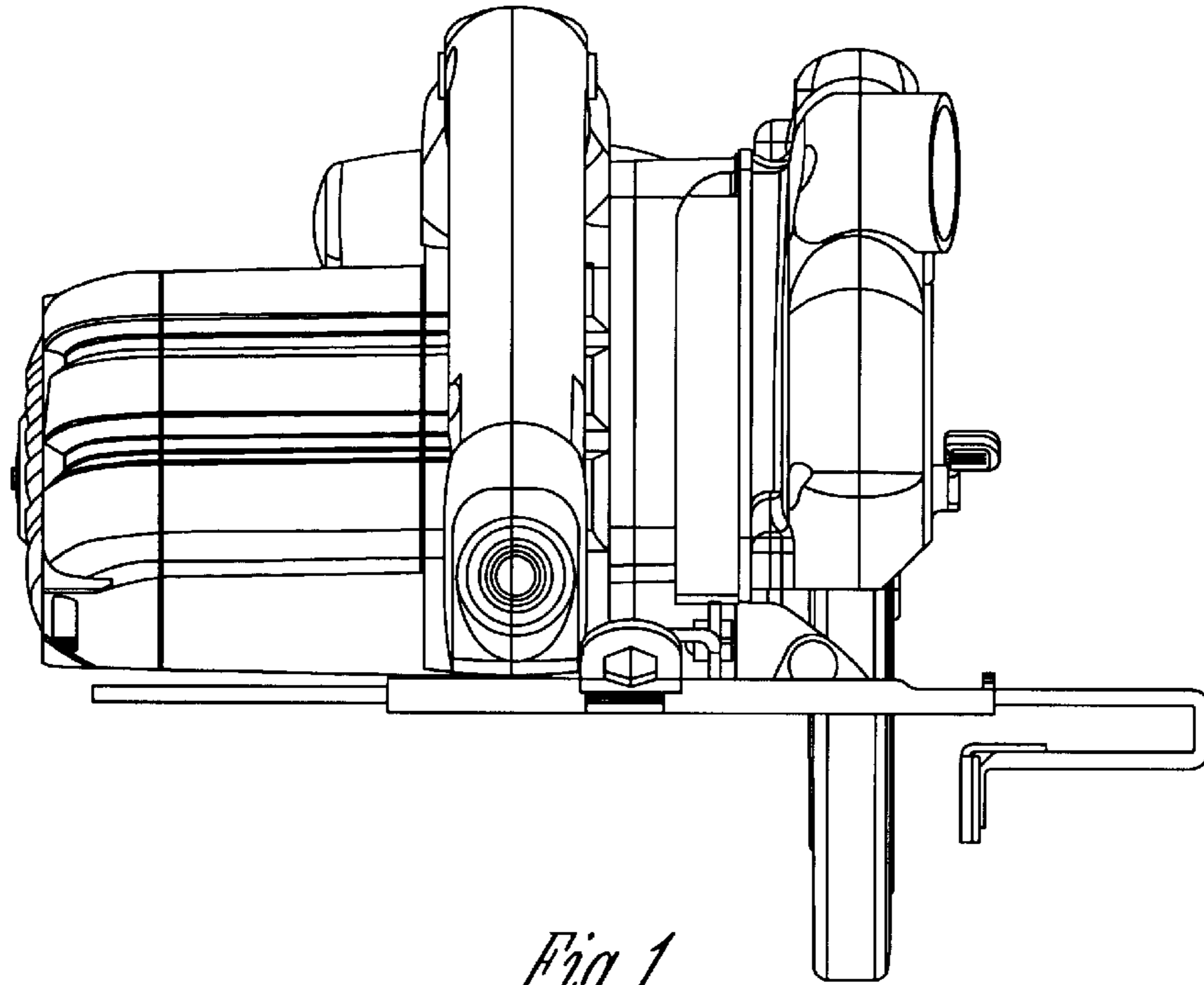
I claim the ornamental design for a circular laser saw,  
substantially as shown.

**DESCRIPTION**

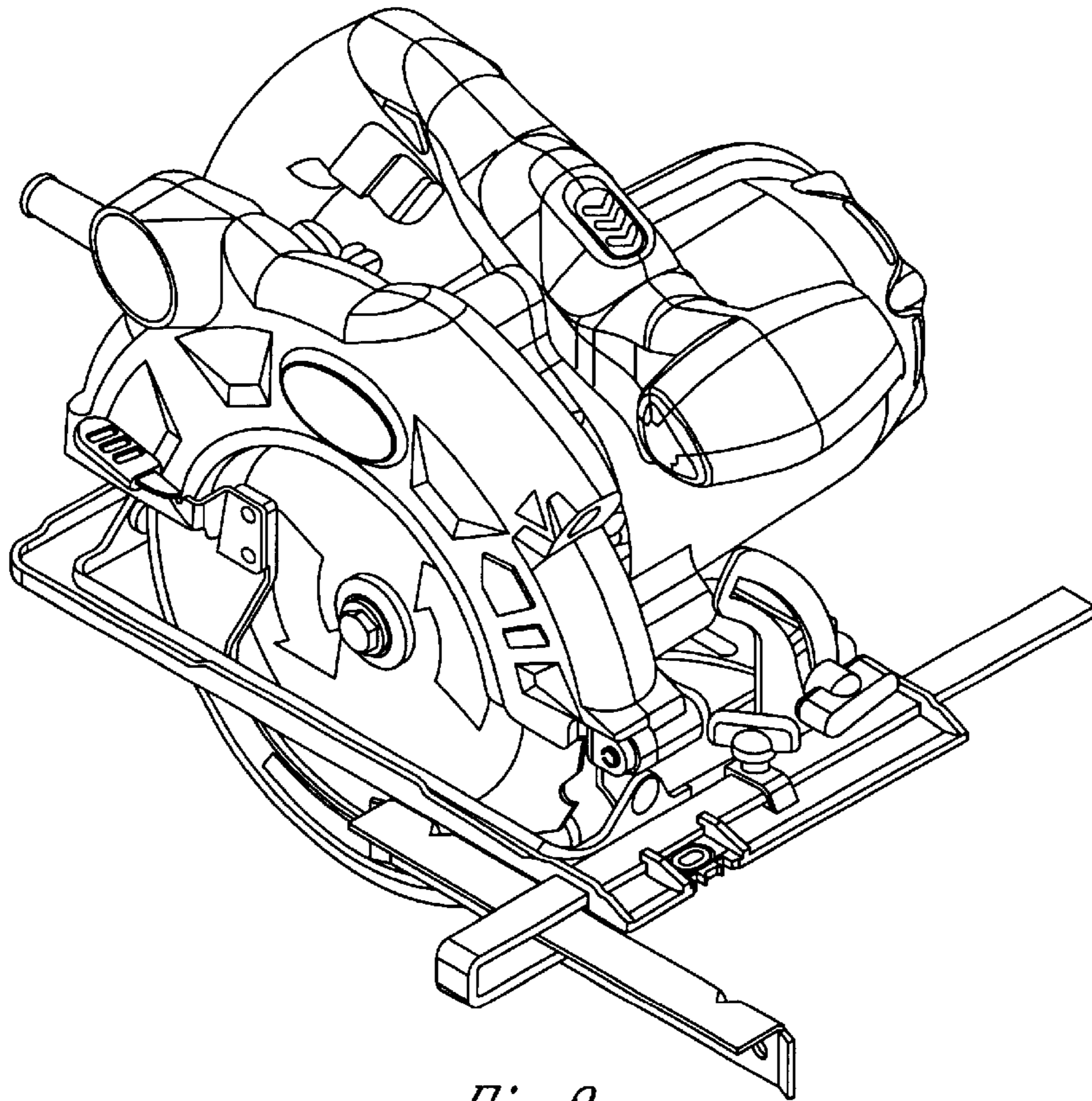
FIG. 1 is a rear view of the circular laser saw.  
FIG. 2 is a perspective view of the circular laser saw.  
FIG. 3 is a first side view of the circular laser saw.  
FIG. 4 is an opposite side view of the circular laser saw.  
FIG. 5 is a bottom plan view of the circular laser saw.  
FIG. 6 is an elevational view of the circular laser saw; and,  
FIG. 7 is a front view of the circular laser saw.

**1 Claim, 6 Drawing Sheets**

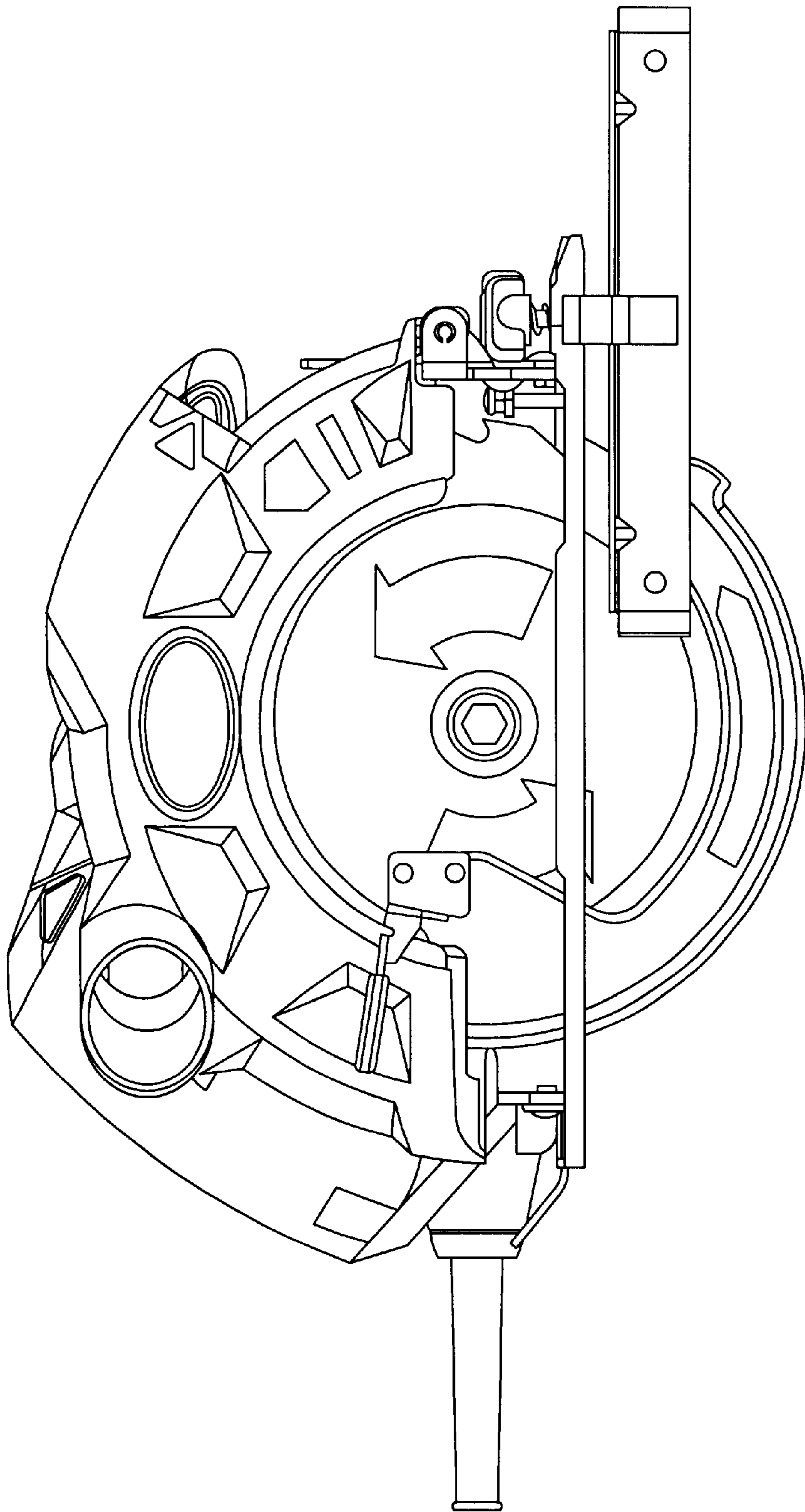




*Fig. 1*

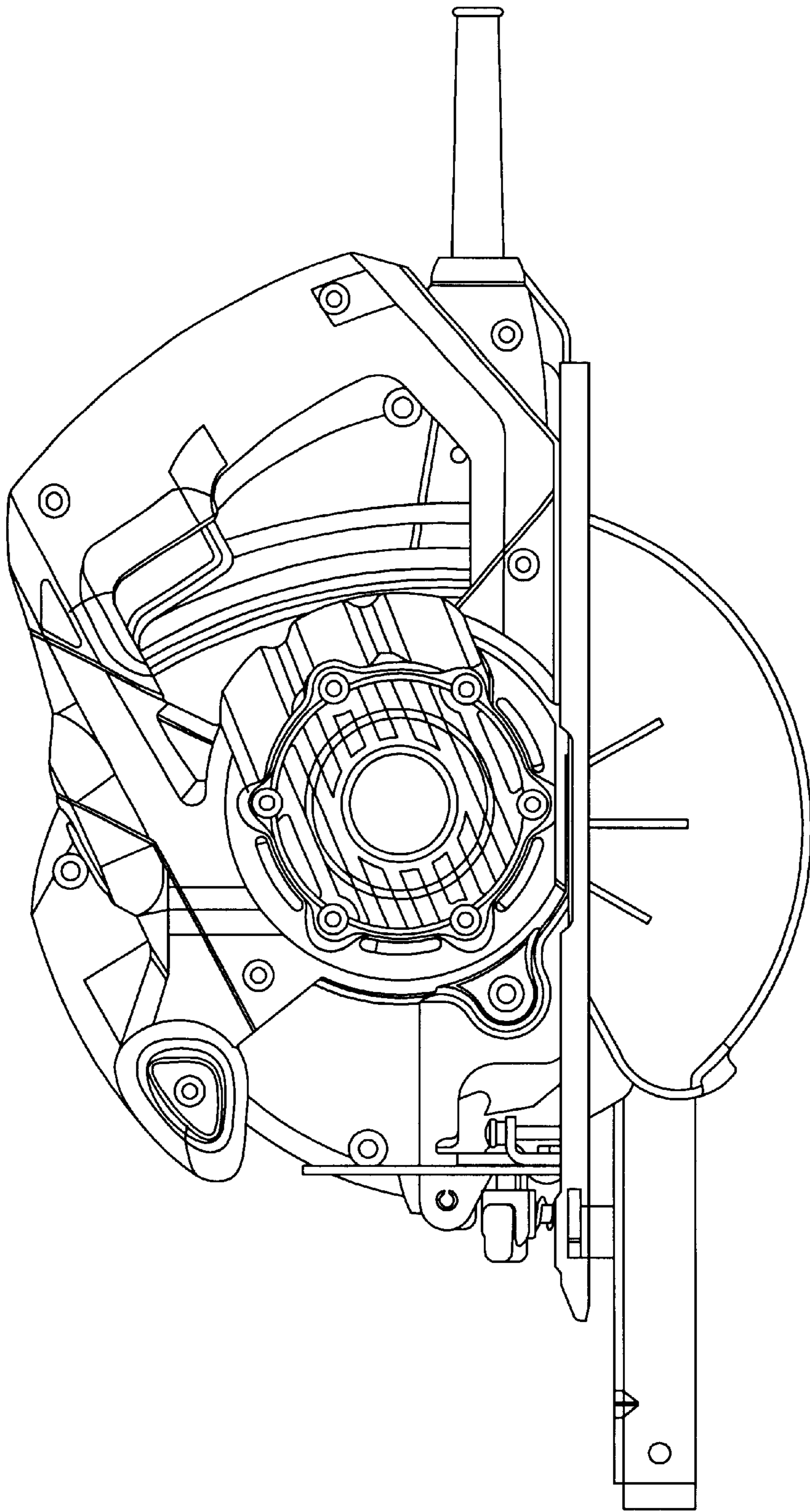


*Fig. 2*

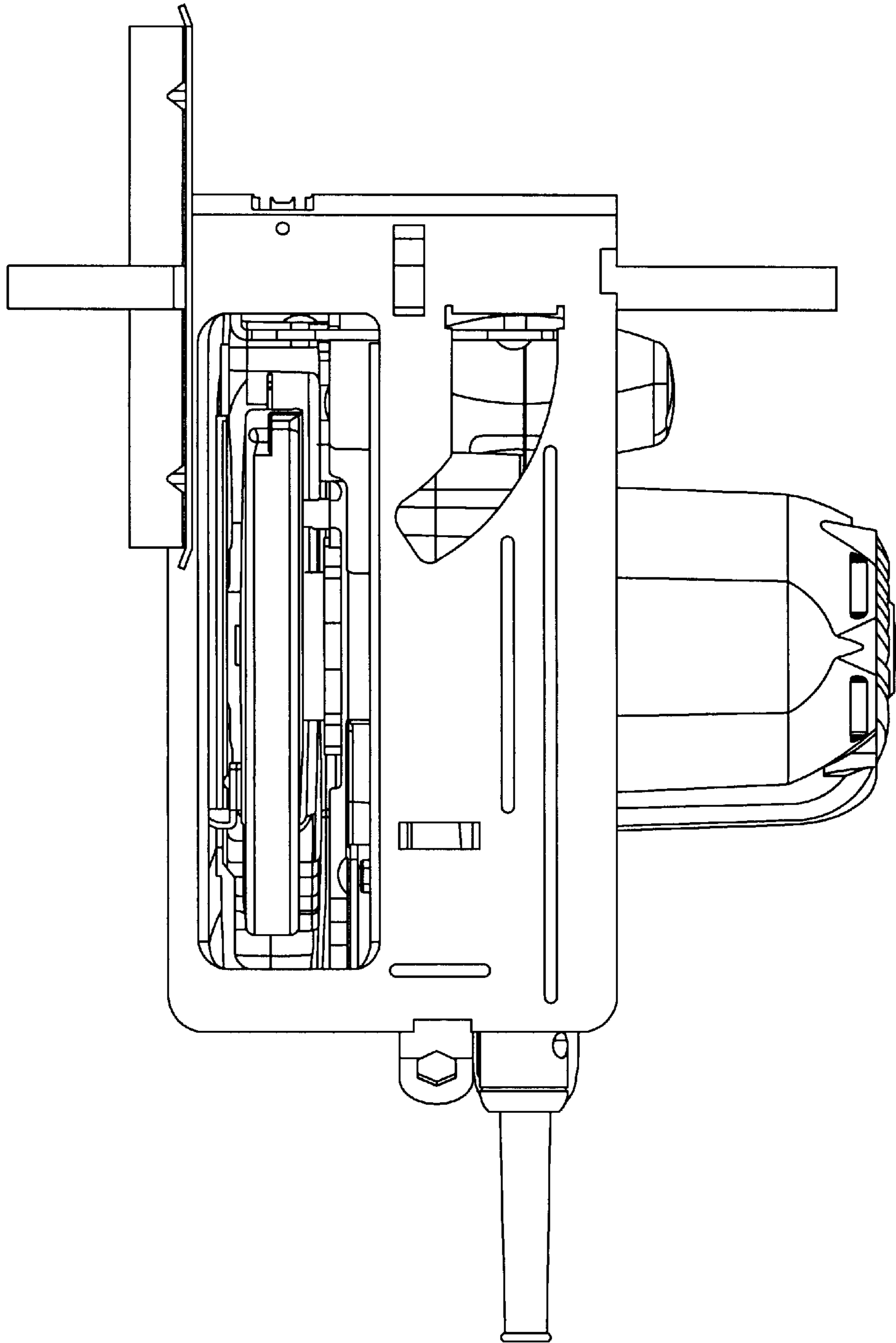


*Fig. 3*

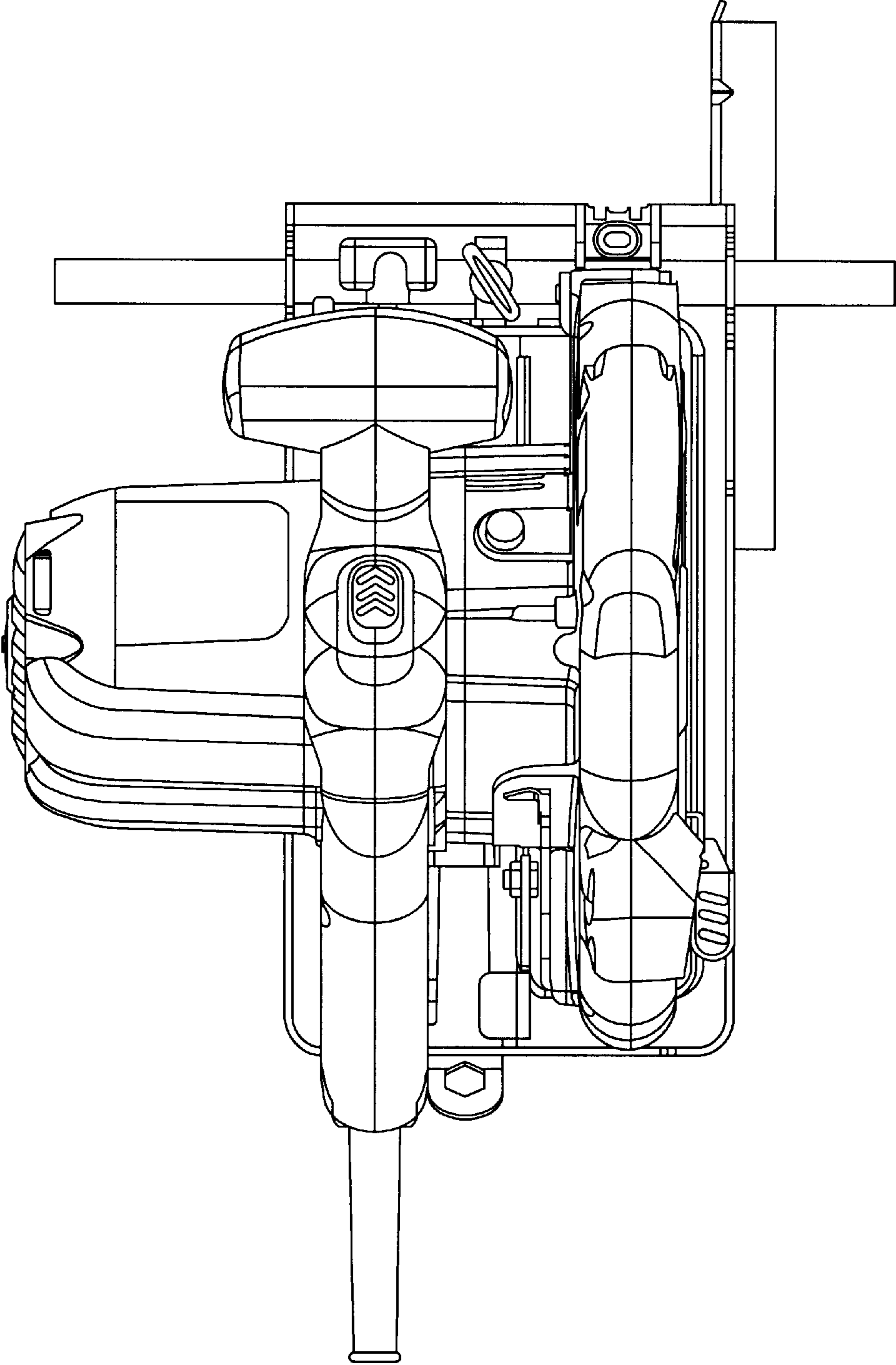




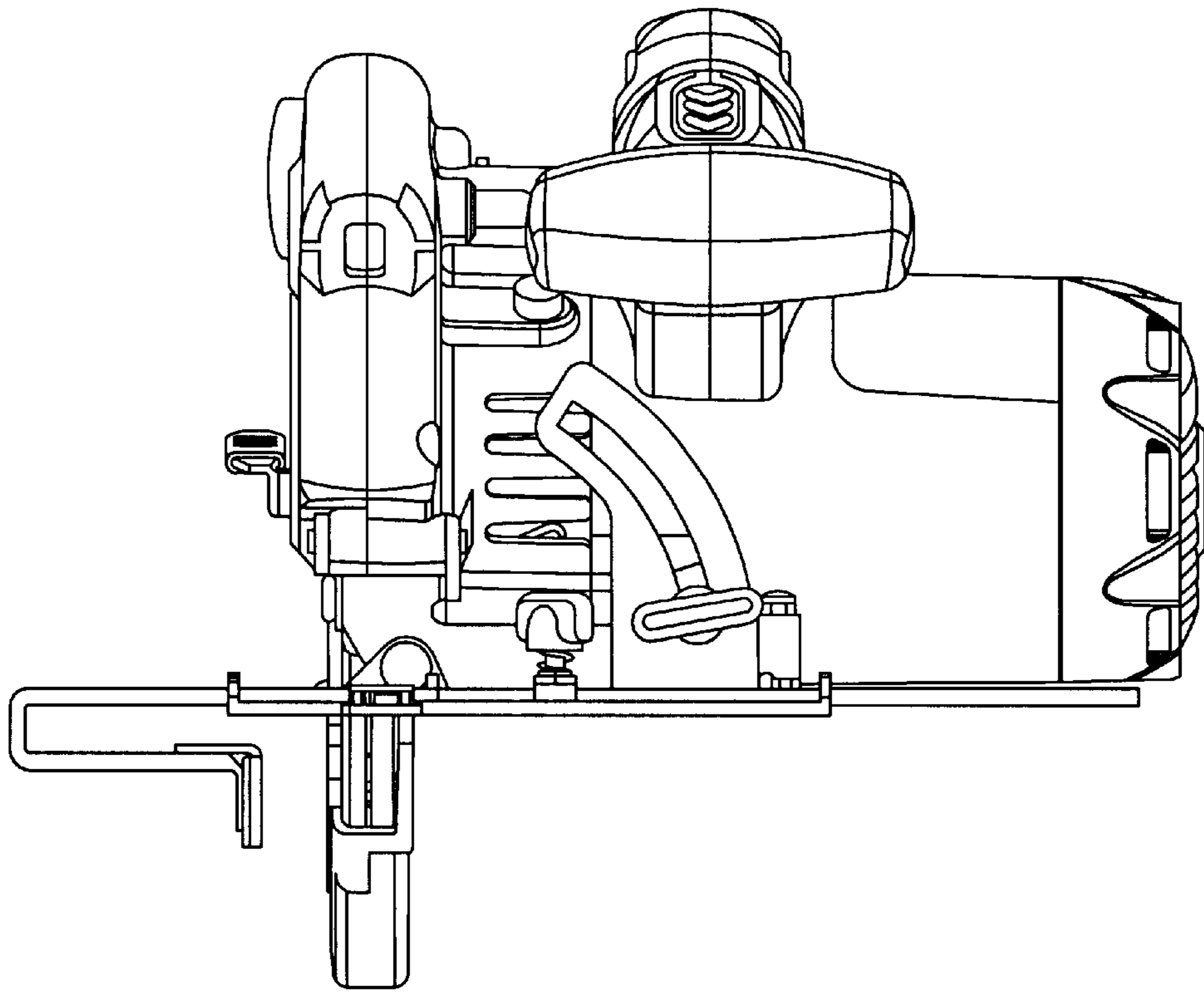
*Fig. 4*



*Fig. 5*



*Fig. 6*



*Fig. 7*