



US00D523690S

(12) **United States Design Patent**
Giannone

(10) **Patent No.:** **US D523,690 S**

(45) **Date of Patent:** **** Jun. 27, 2006**

(54) **PAN HANDLE**

(75) Inventor: **Alfonso Giannone**, Brembate (IT)

(73) Assignee: **Bialetti Industrie S.p.A.**, Coccaglio (IT)

(**) Term: **14 Years**

(21) Appl. No.: **29/224,494**

(22) Filed: **Mar. 3, 2005**

(30) **Foreign Application Priority Data**

Jan. 25, 2005 (EM) 000296447

(51) **LOC (8) Cl.** **07-02**

(52) **U.S. Cl.** **D7/395**

(58) **Field of Classification Search** D7/354-361,
D7/393-395, 401.2; D8/107, 307; D4/138,
D4/129; 16/430, 431, 110.1, 407; 220/573.1-573.5,
220/752, 753, 755, 756, 912

See application file for complete search history.

(56) **References Cited**

U.S. PATENT DOCUMENTS

4,413,767 A * 11/1983 Hellinger 228/136

6,149,107 A * 11/2000 Kerr et al. 248/49

D447,383 S * 9/2001 Rae D7/395

D458,801 S * 6/2002 Coudurier D7/395

D488,801 S * 4/2004 Shindo et al. D14/216

D491,764 S * 6/2004 Munari D7/395

D494,412 S * 8/2004 Prakasa D7/395

D512,602 S * 12/2005 Spagnolo D7/395

* cited by examiner

Primary Examiner—Holly Baynham

Assistant Examiner—Cynthia M. Chin

(74) *Attorney, Agent, or Firm*—Shoemaker and Mattare

(57) **CLAIM**

The ornamental design for a pan handle, as shown and described.

DESCRIPTION

FIG. 1 is a perspective view of a pan handle, showing my new design from the top and left side; FIG. 2 is a left side elevational view thereof, the right side view being a mirror image thereof; FIG. 3 is a front elevational view thereof; FIG. 4 is a rear elevational view thereof; FIG. 5 is a top plan view thereof; and, FIG. 6 is a bottom plan view thereof.

1 Claim, 2 Drawing Sheets

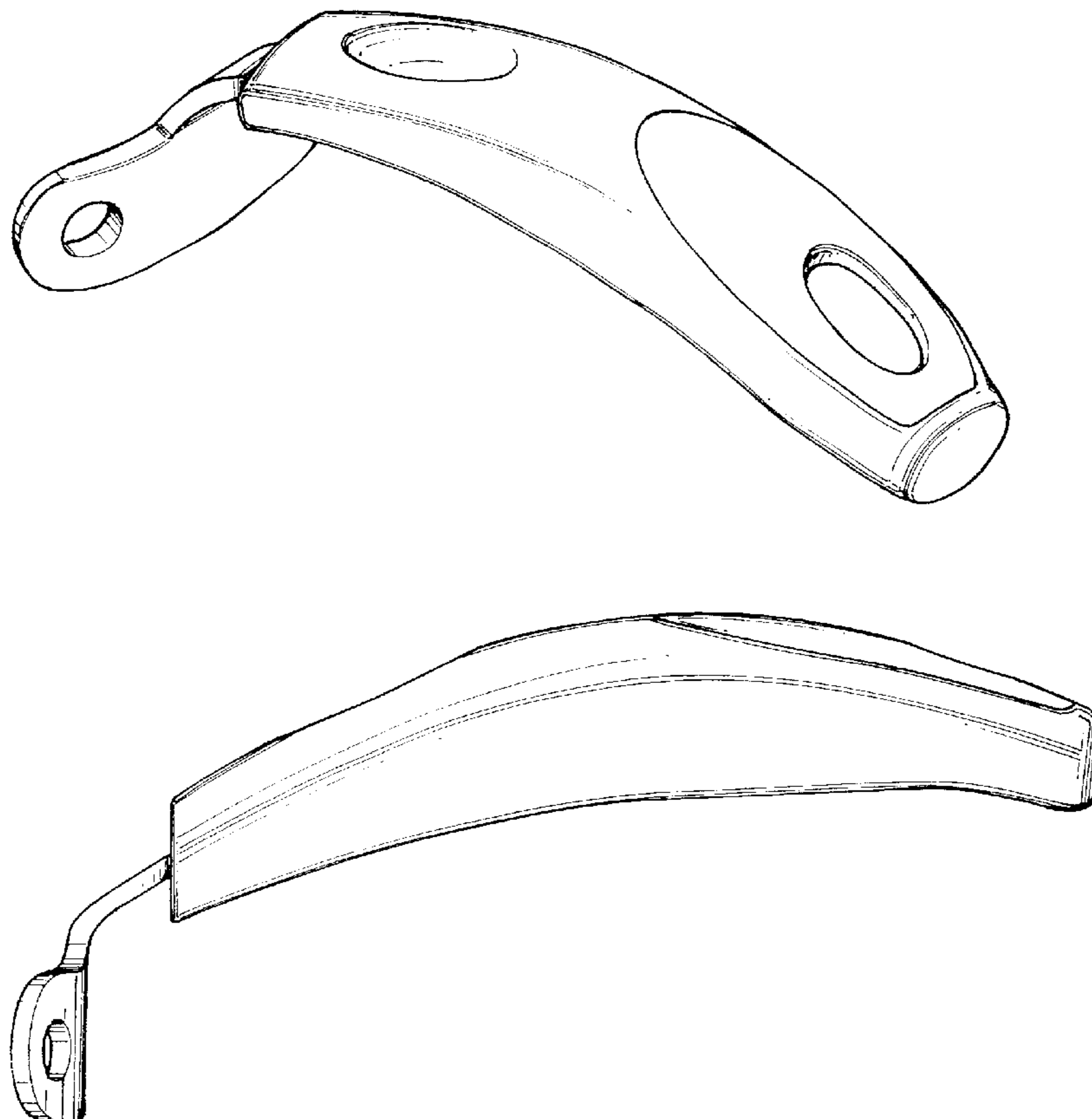

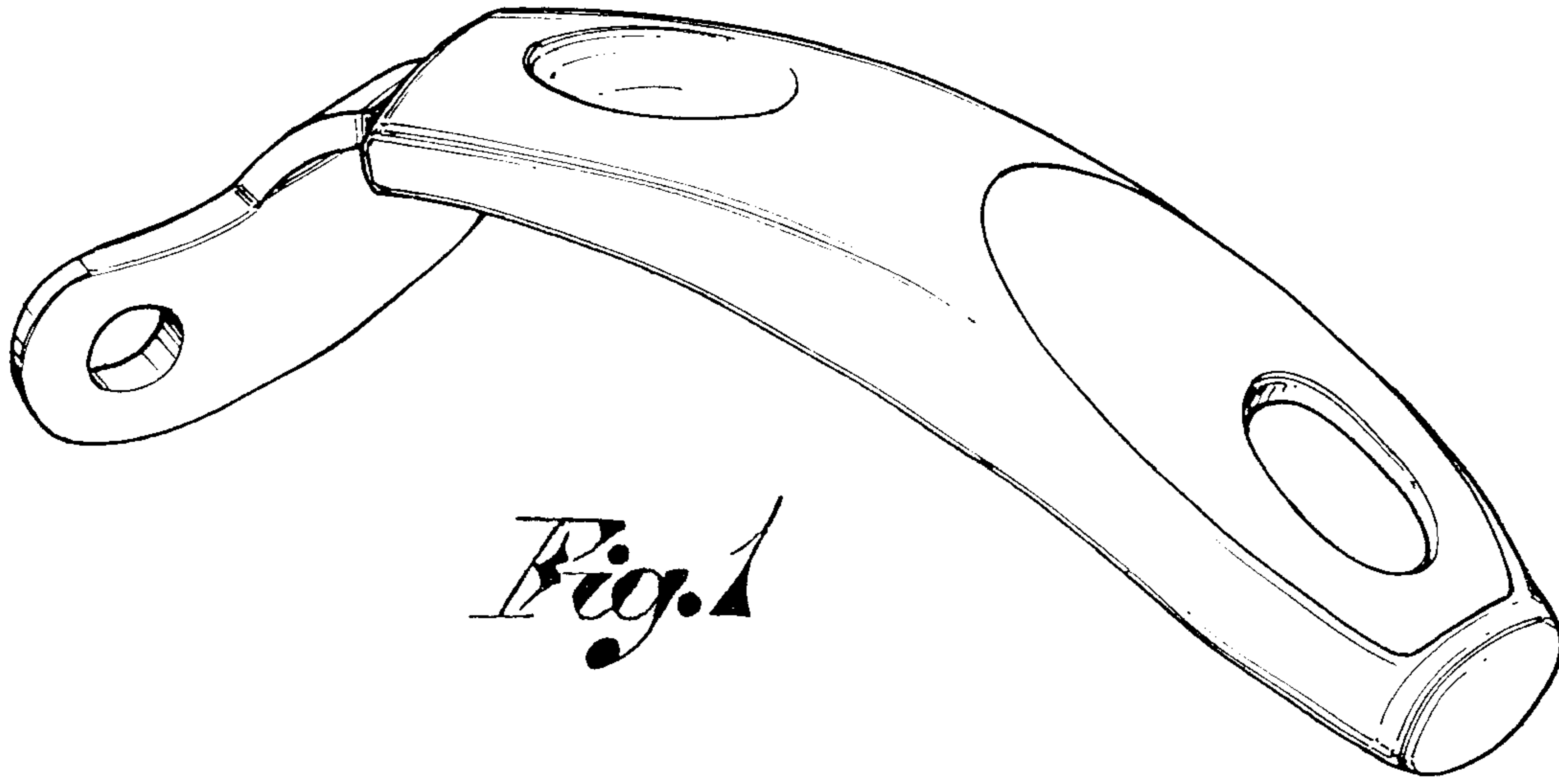

Fig. 1

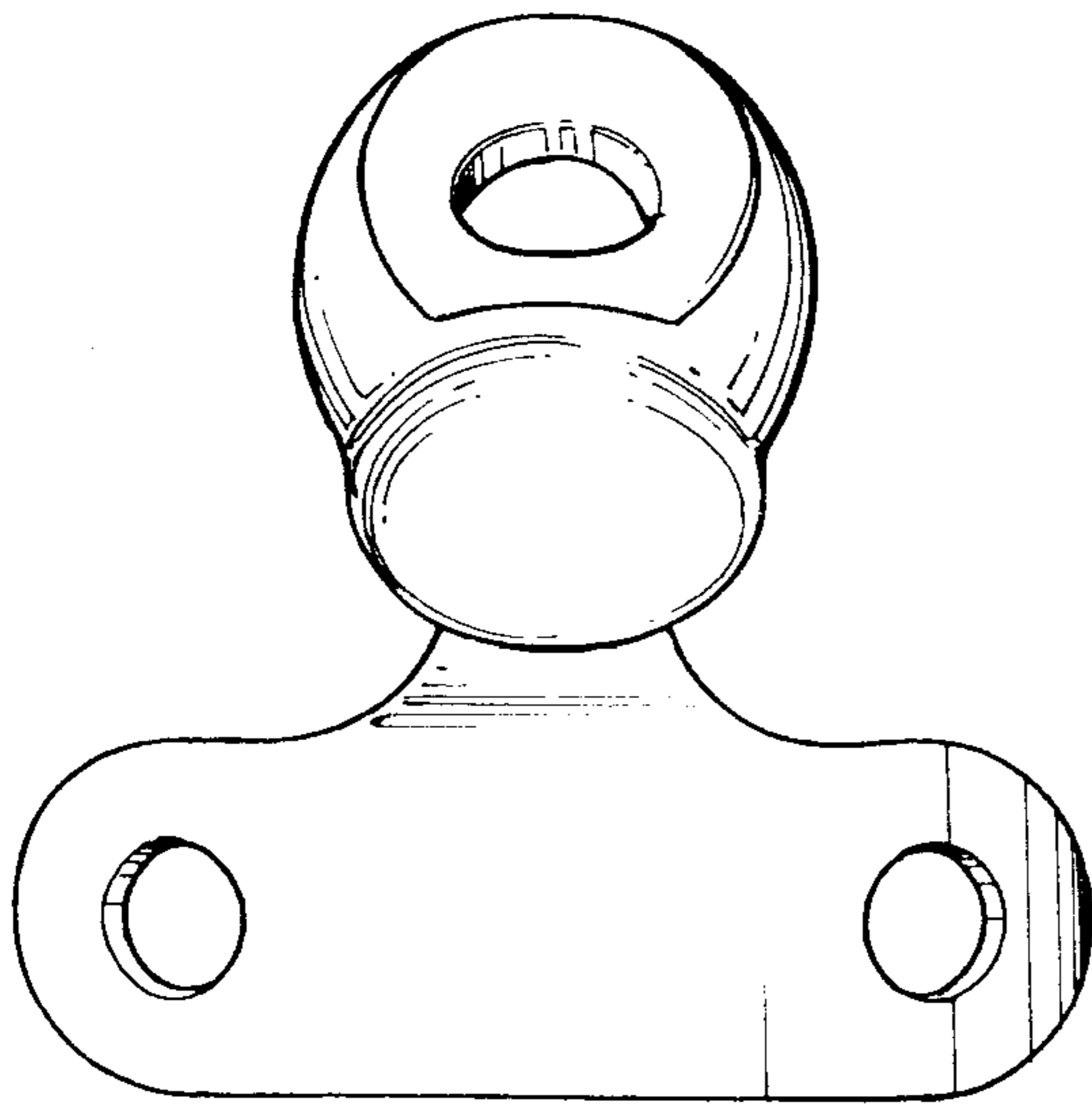
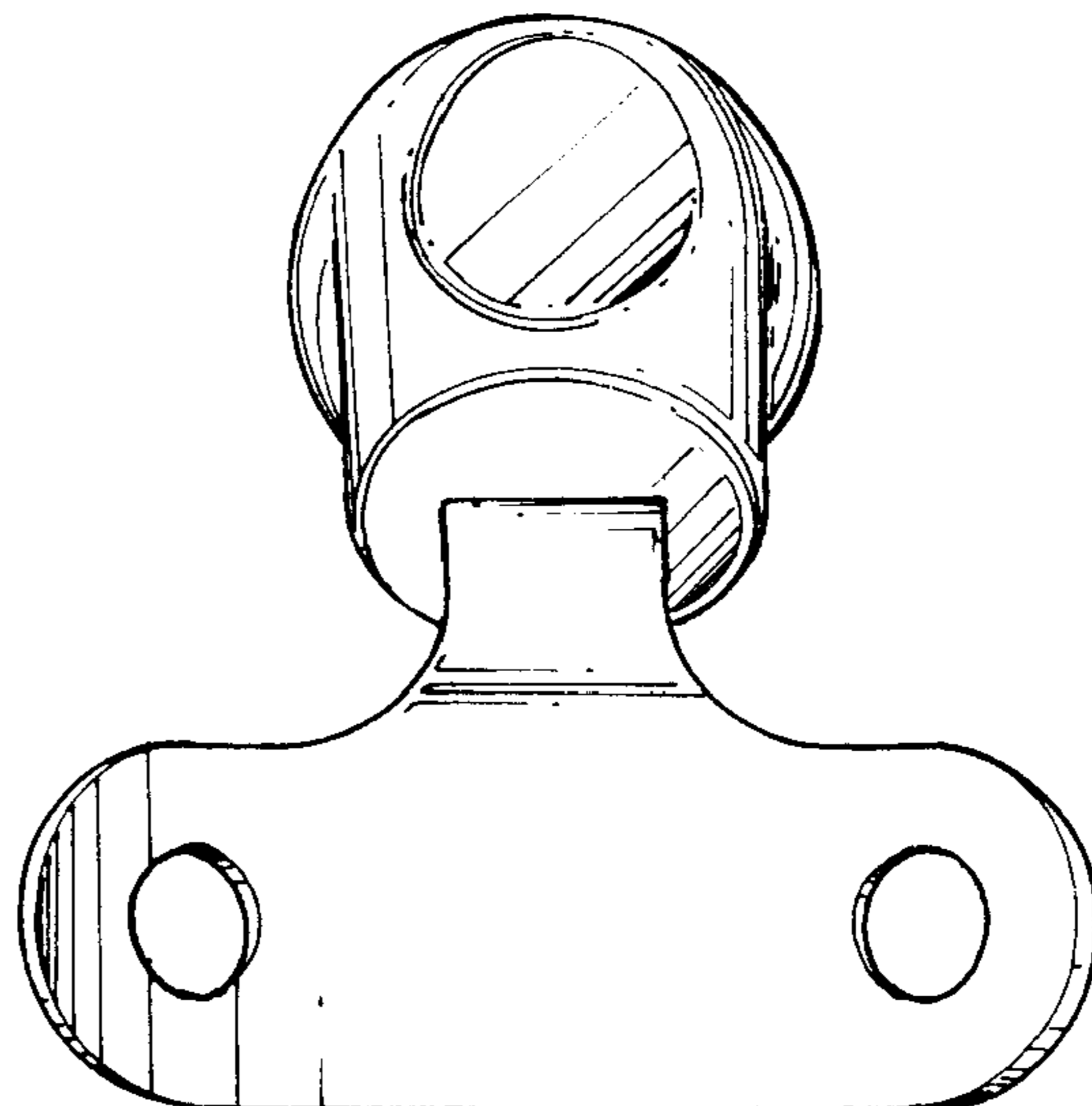

Fig. 3

Fig. 4



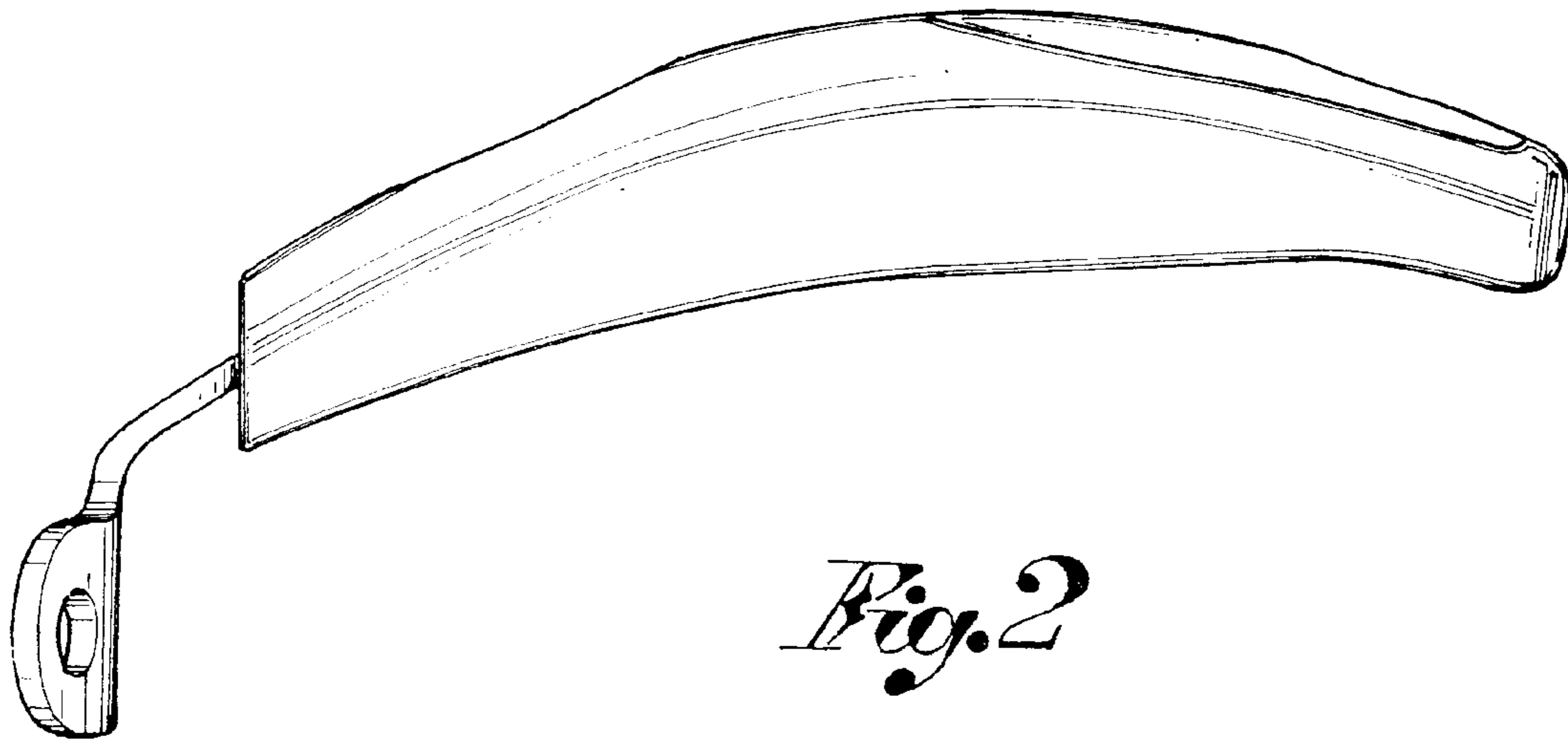

Fig. 2

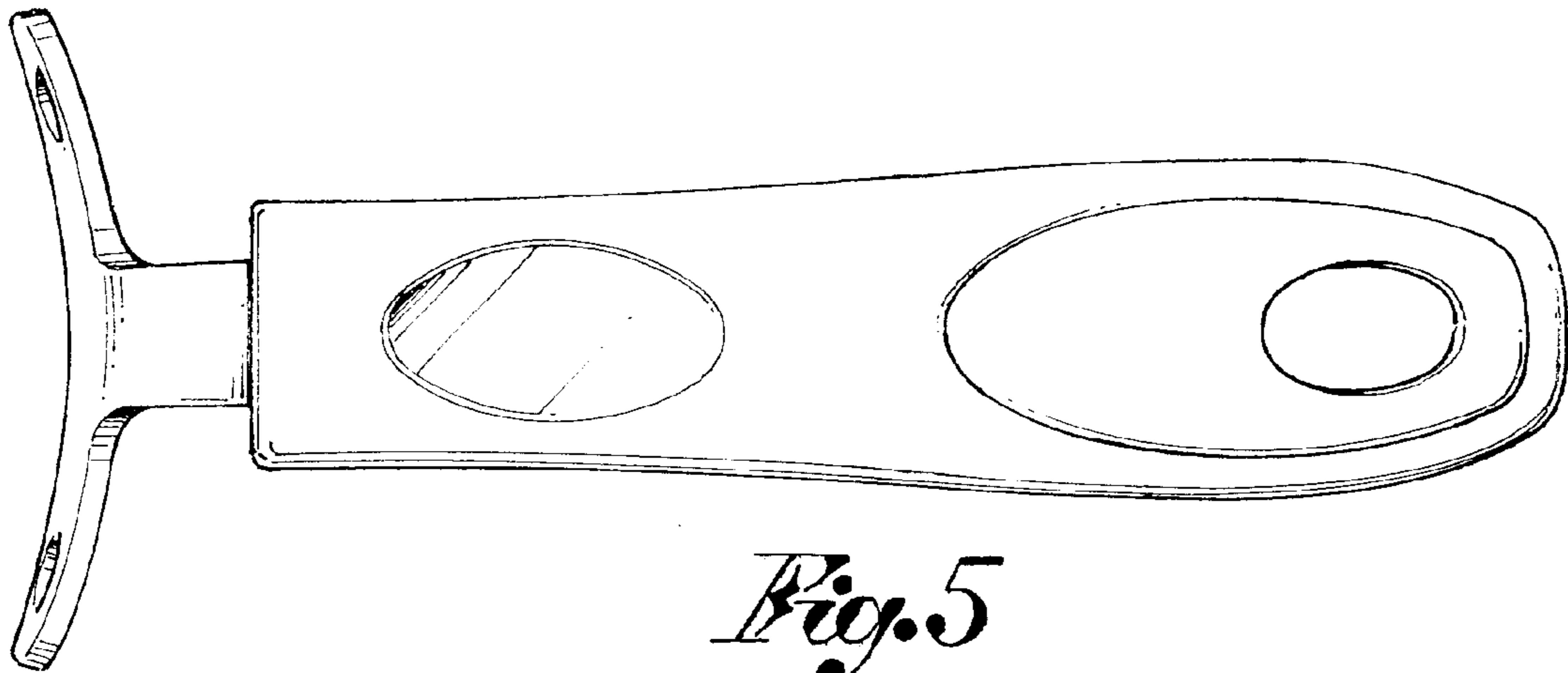

Fig. 5

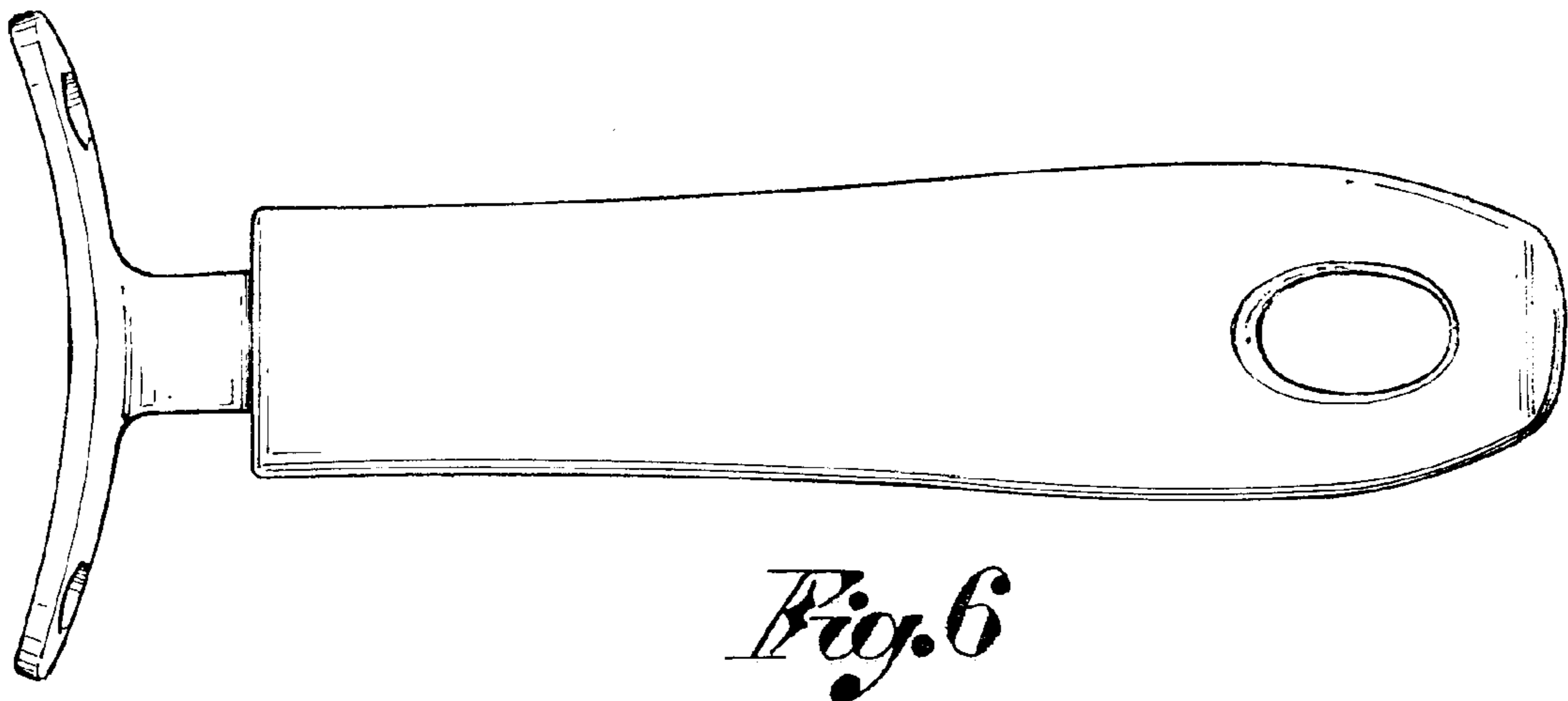

Fig. 6