



US00D523024S

(12) **United States Design Patent**
Saito et al.

(10) **Patent No.:** **US D523,024 S**
(45) **Date of Patent:** **** Jun. 13, 2006**

(54) **ENGINE FOR AN AIRPLANE**
(75) Inventors: **Kazuhiko Saito**, Saitama (JP);
Yukinori Kawaguchi, Saitama (JP)

5,513,601 A * 5/1996 Benson 123/54.4
6,279,519 B1 * 8/2001 Nagel et al. 123/55.5
6,526,927 B1 * 3/2003 Palmer 123/56.1

* cited by examiner

(73) Assignee: **Honda Giken Kogyo Kabushiki Kaisha**, Tokyo (JP)

Primary Examiner—Ian Simmons
Assistant Examiner—Maurice Stevens

(**) Term: **14 Years**

(74) *Attorney, Agent, or Firm*—Westerman, Hattori,
Daniels & Adrian, L.L.P.

(21) Appl. No.: **29/186,730**

(57) **CLAIM**

(22) Filed: **Jul. 23, 2003**

What is claimed; the ornamental design for an engine of an airplane, as shown and described.

(30) **Foreign Application Priority Data**

Jan. 28, 2003 (JP) 2003-001790

DESCRIPTION

(51) **LOC (8) Cl.** **15-01**

FIG. 1 is a front elevation view of an engine for an airplane, showing our new design;

(52) **U.S. Cl.** **D15/1**

FIG. 2 is a rear elevation view thereof;

(58) **Field of Classification Search** D15/1,
D15/3

FIG. 3 is a top plan view thereof;

See application file for complete search history.

FIG. 4 is a right side elevation view thereof;

FIG. 5 is a left side elevation view thereof;

FIG. 6 is a front perspective view 1 thereof;

FIG. 7 is a front perspective view 2 thereof;

FIG. 8 is a rear perspective view 1 thereof; and,

FIG. 9 is a rear perspective view 2 thereof.

(56) **References Cited**

U.S. PATENT DOCUMENTS

2,419,787 A * 4/1947 Muffly 416/129
4,469,078 A * 9/1984 Speer et al. 123/564
5,083,544 A * 1/1992 Brighigna 123/508

1 Claim, 9 Drawing Sheets

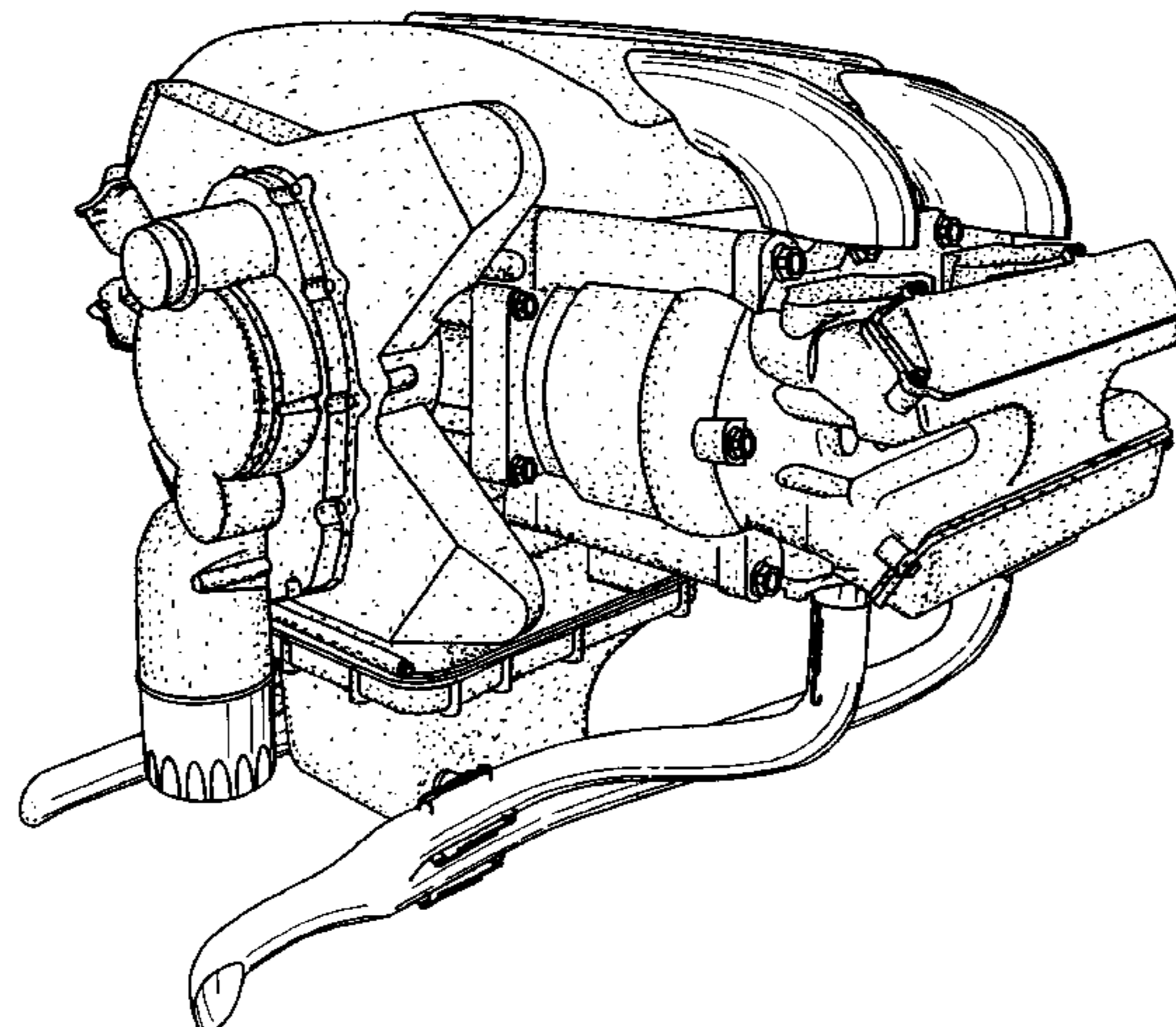
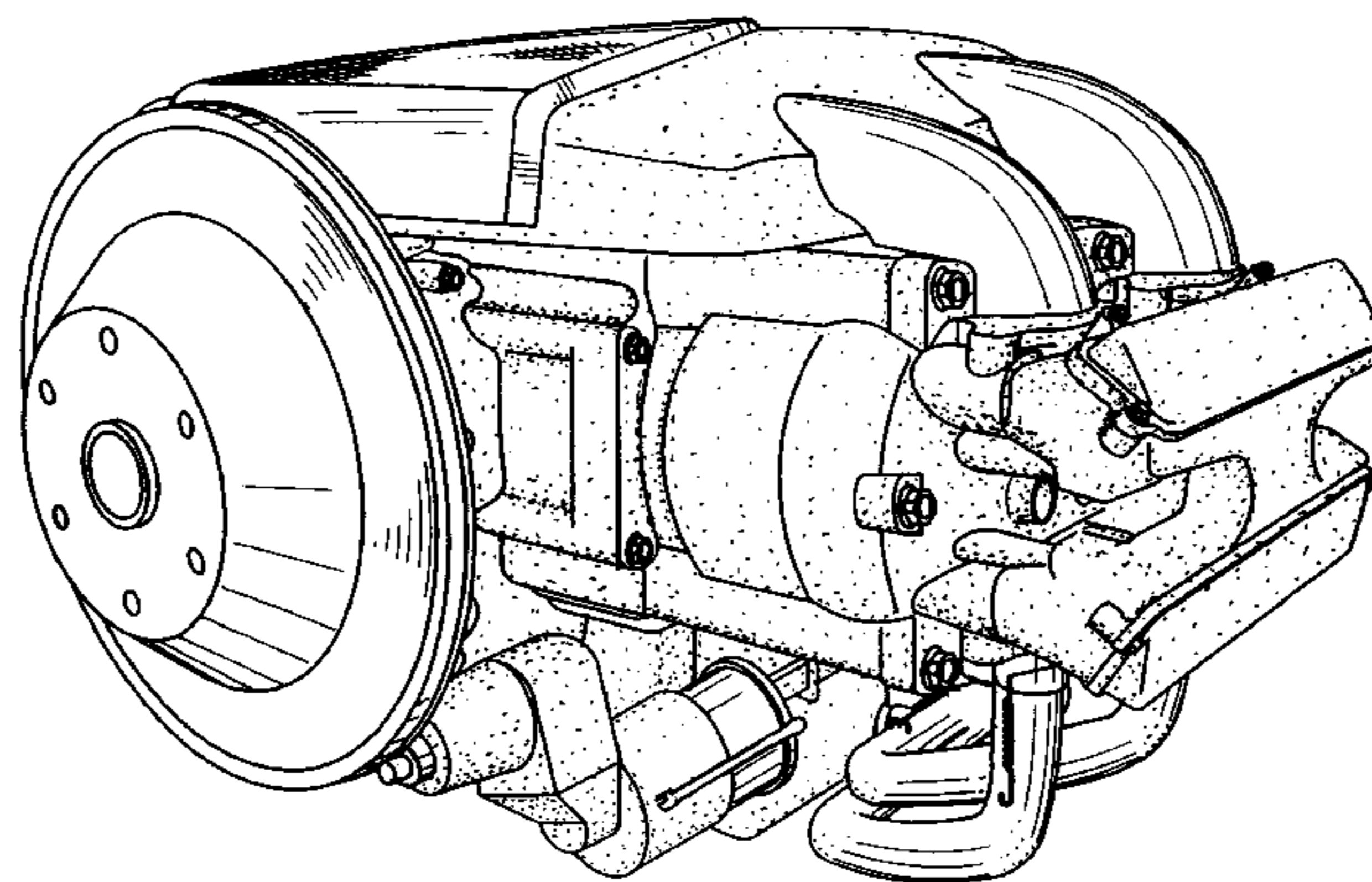

FIG.1

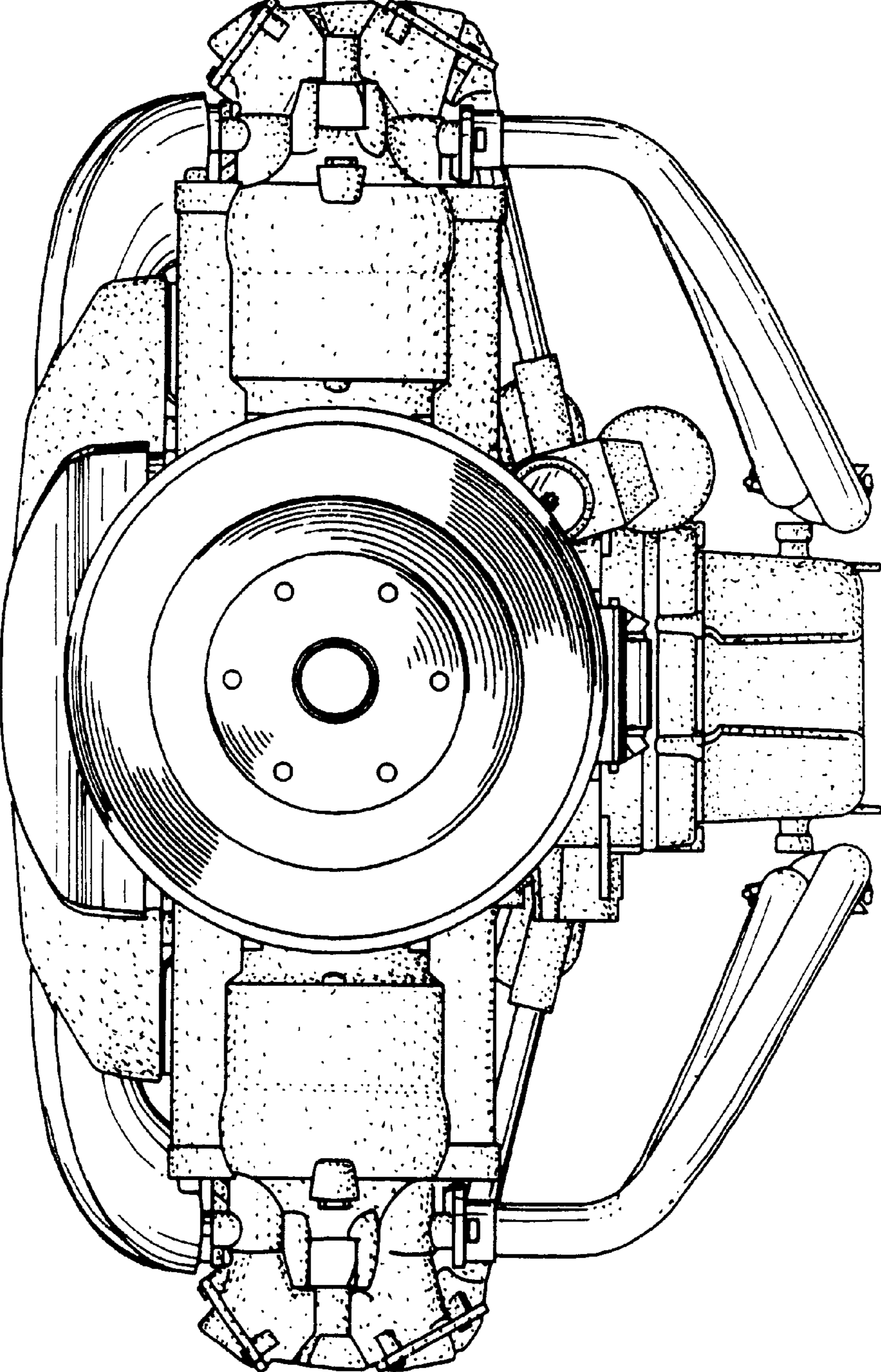

FIG.2

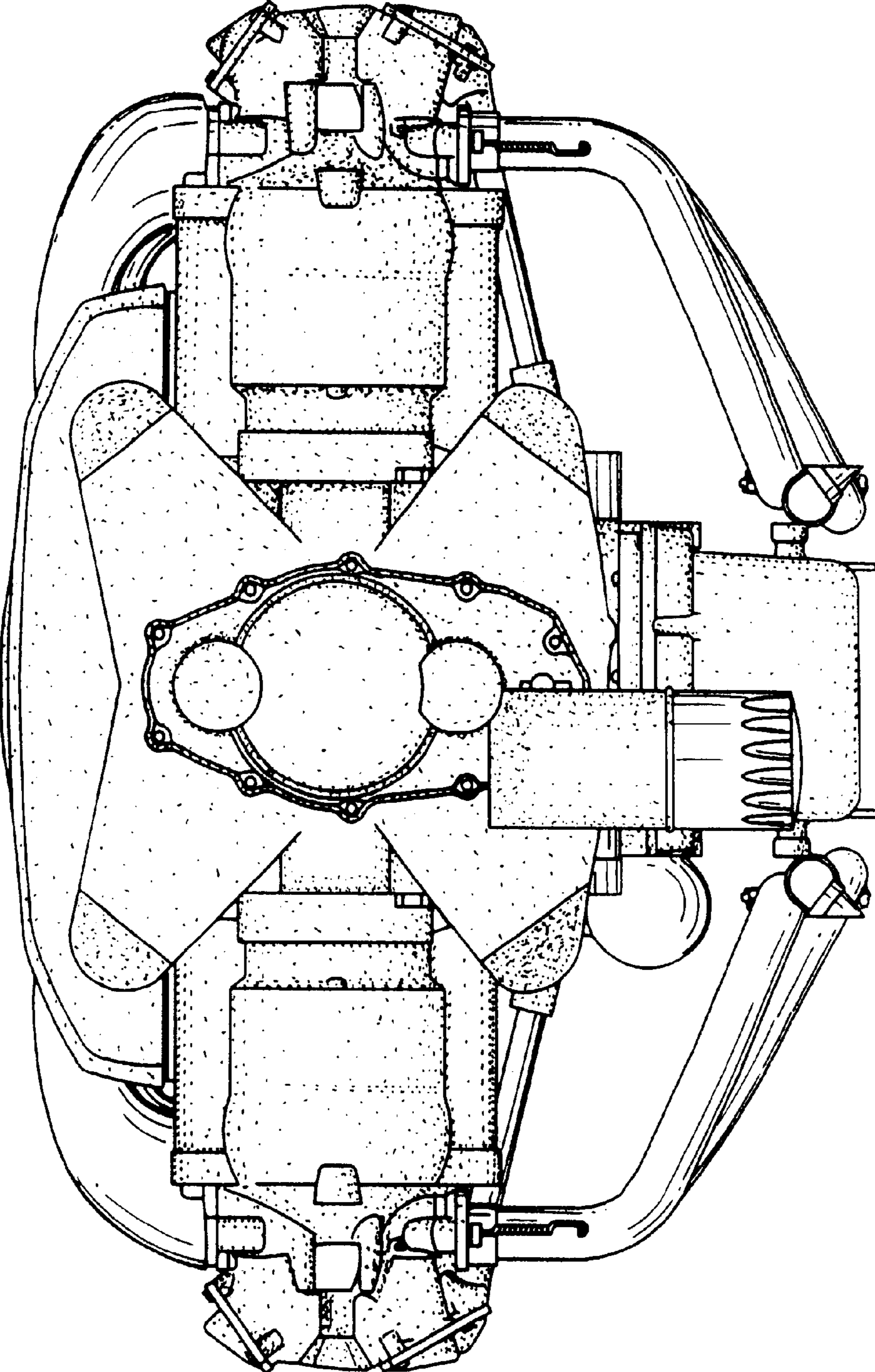

FIG.3

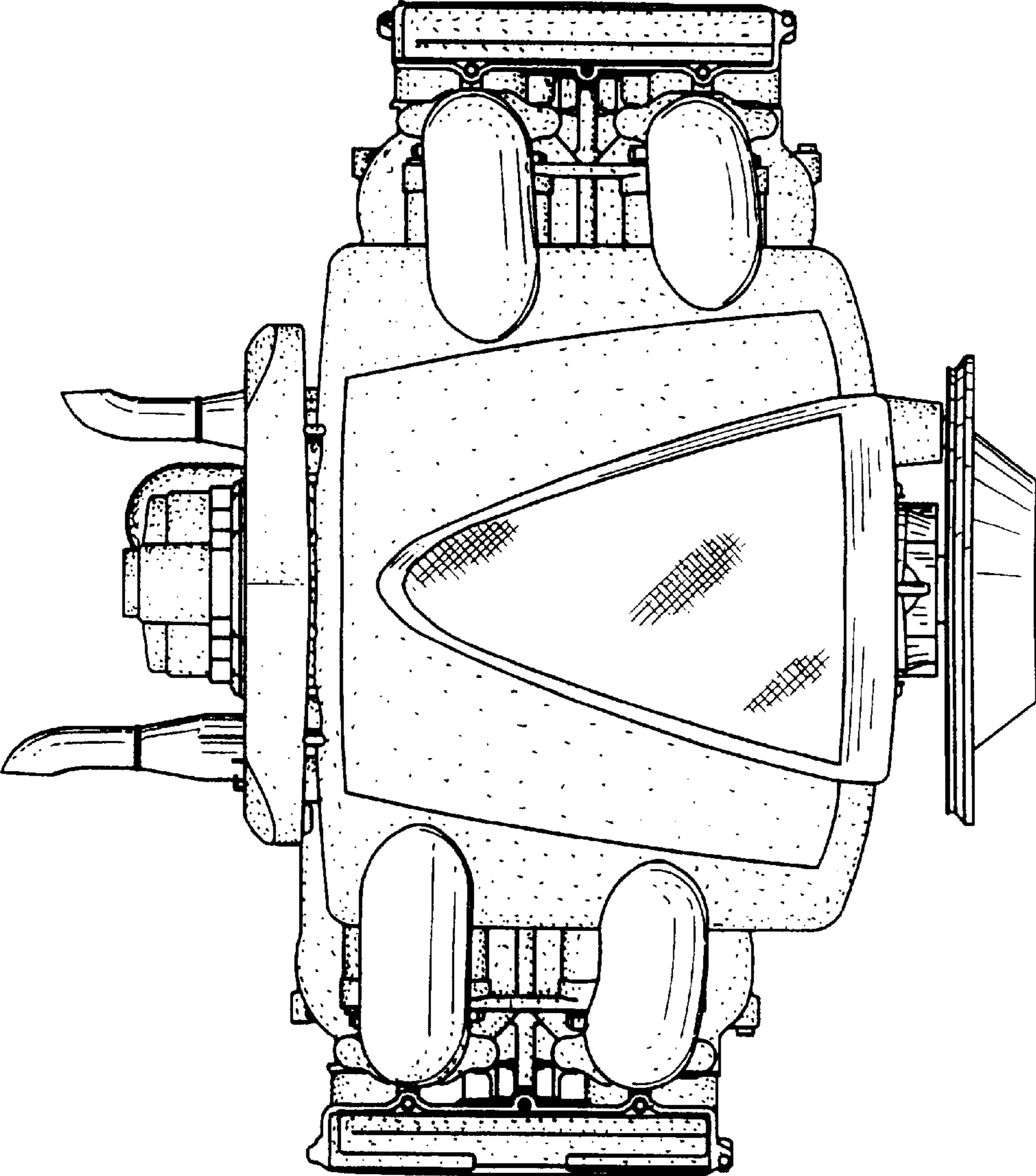

FIG.4

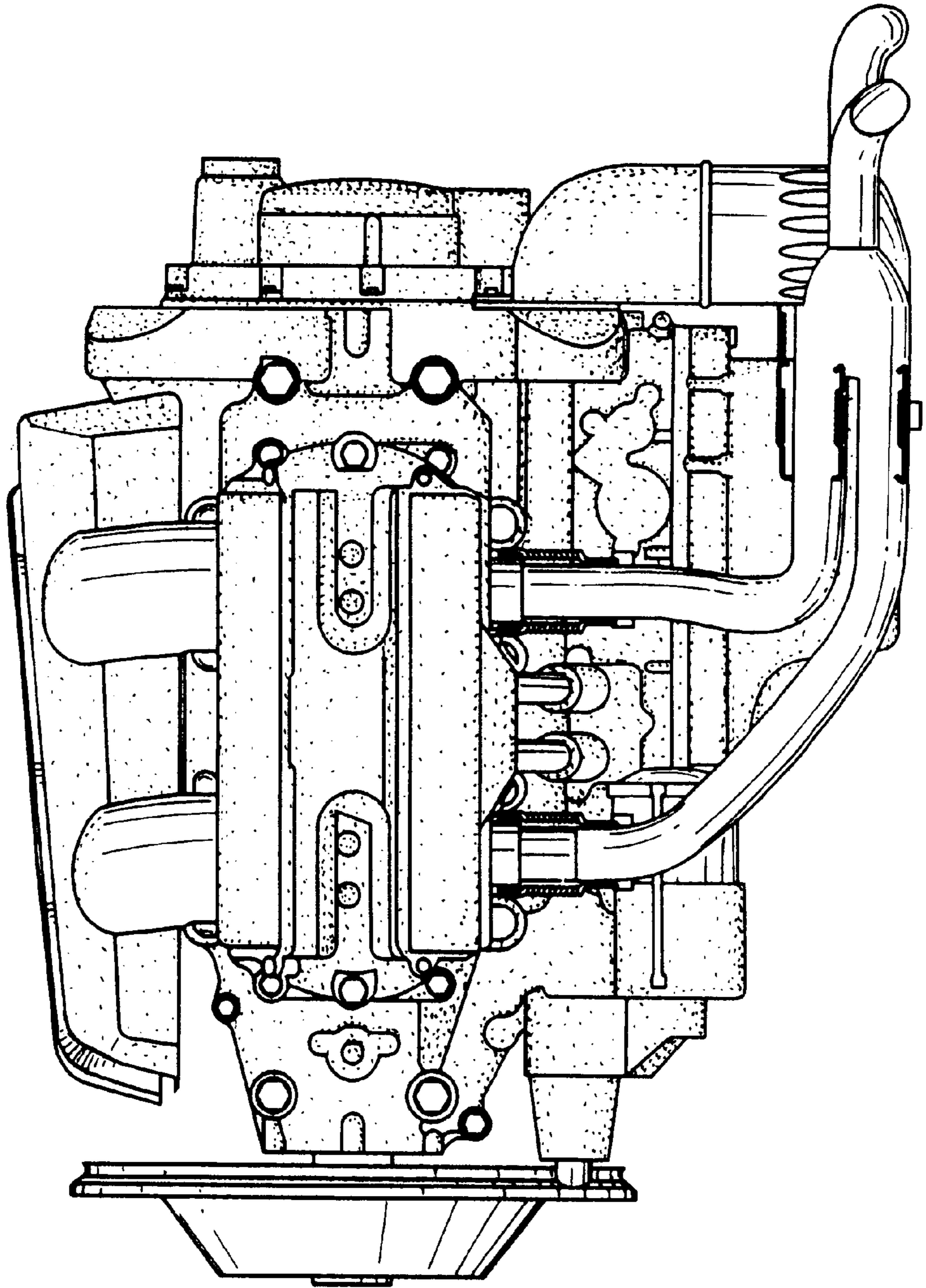

FIG.5

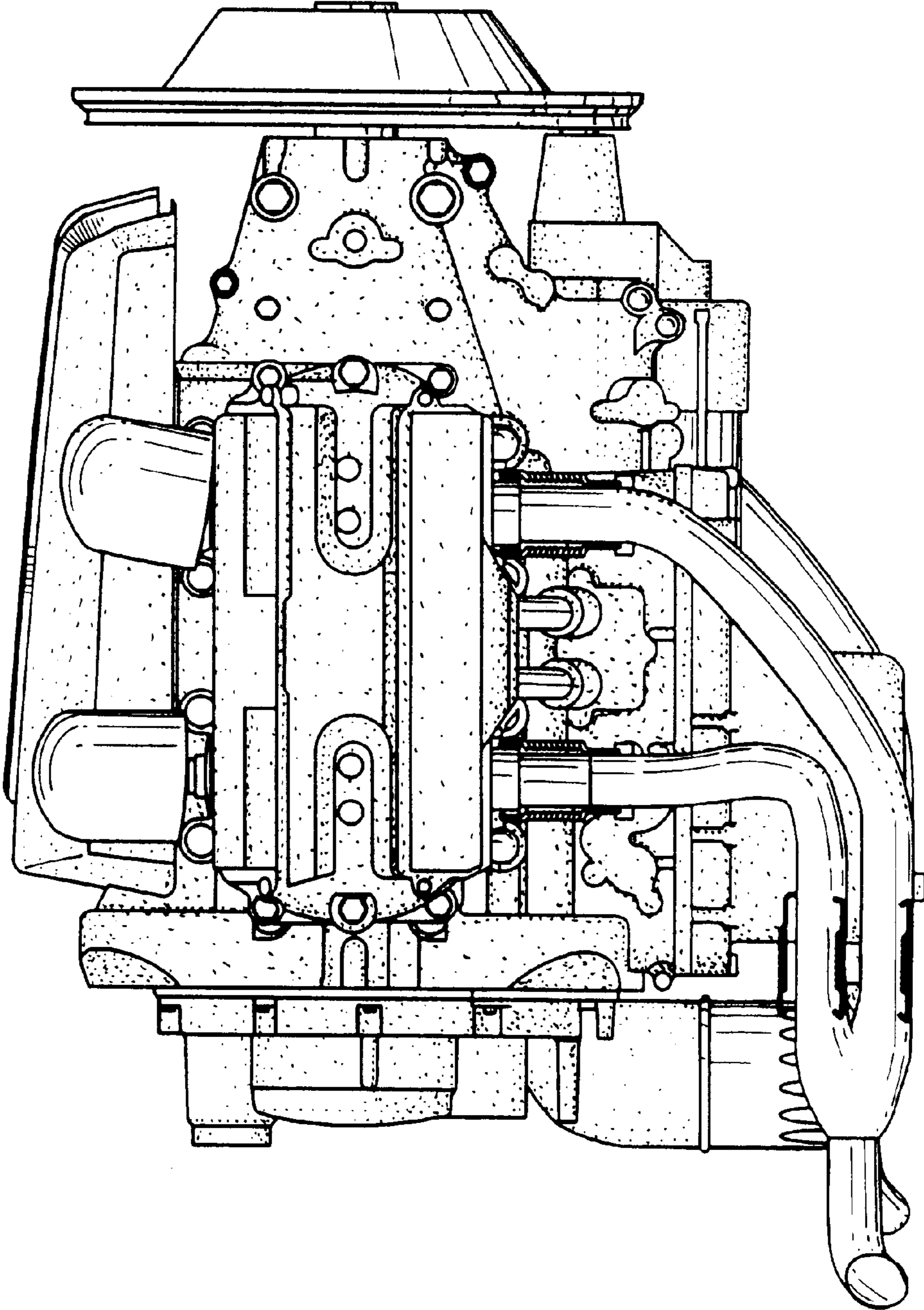

FIG.6

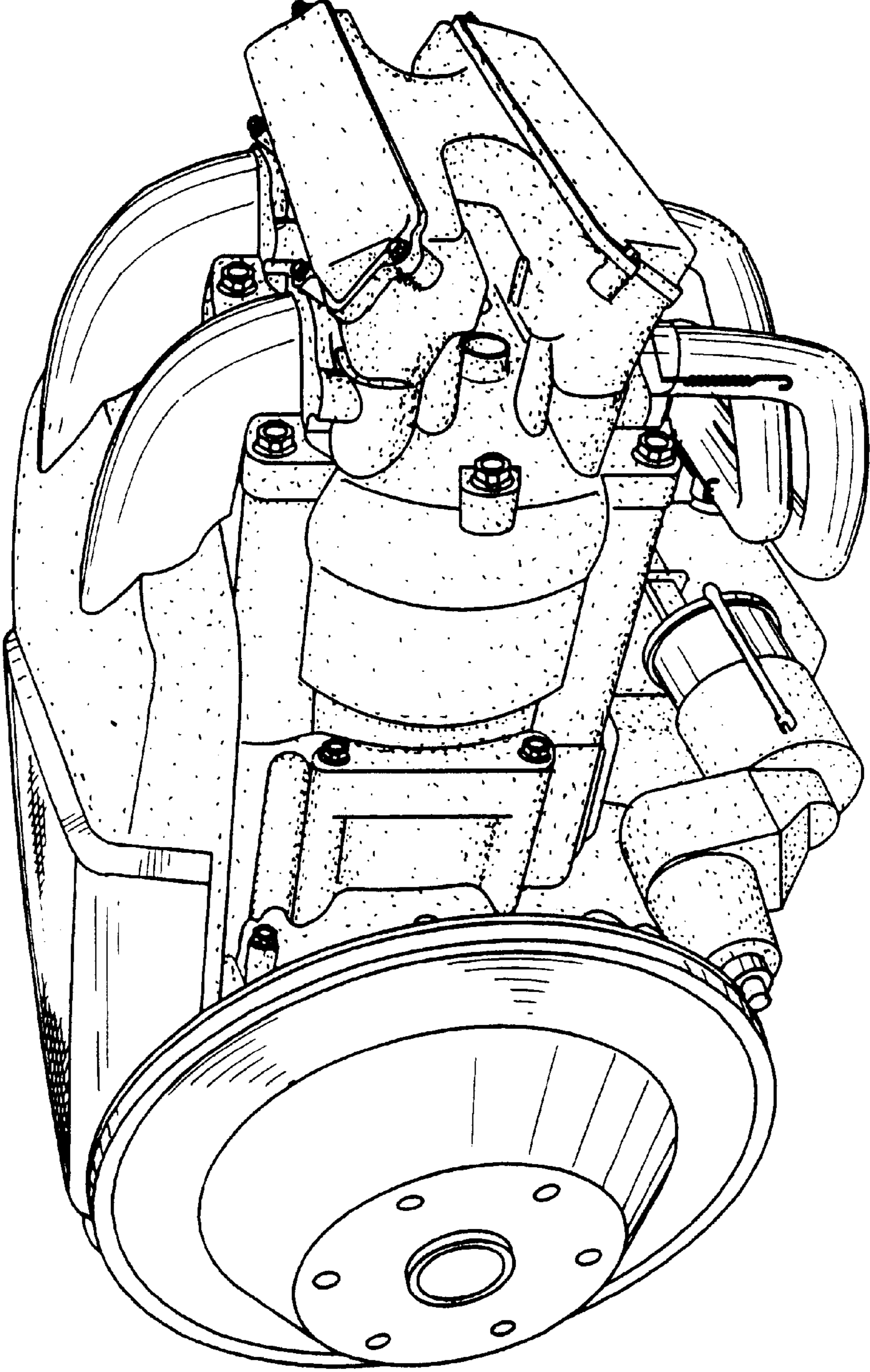

FIG. 7

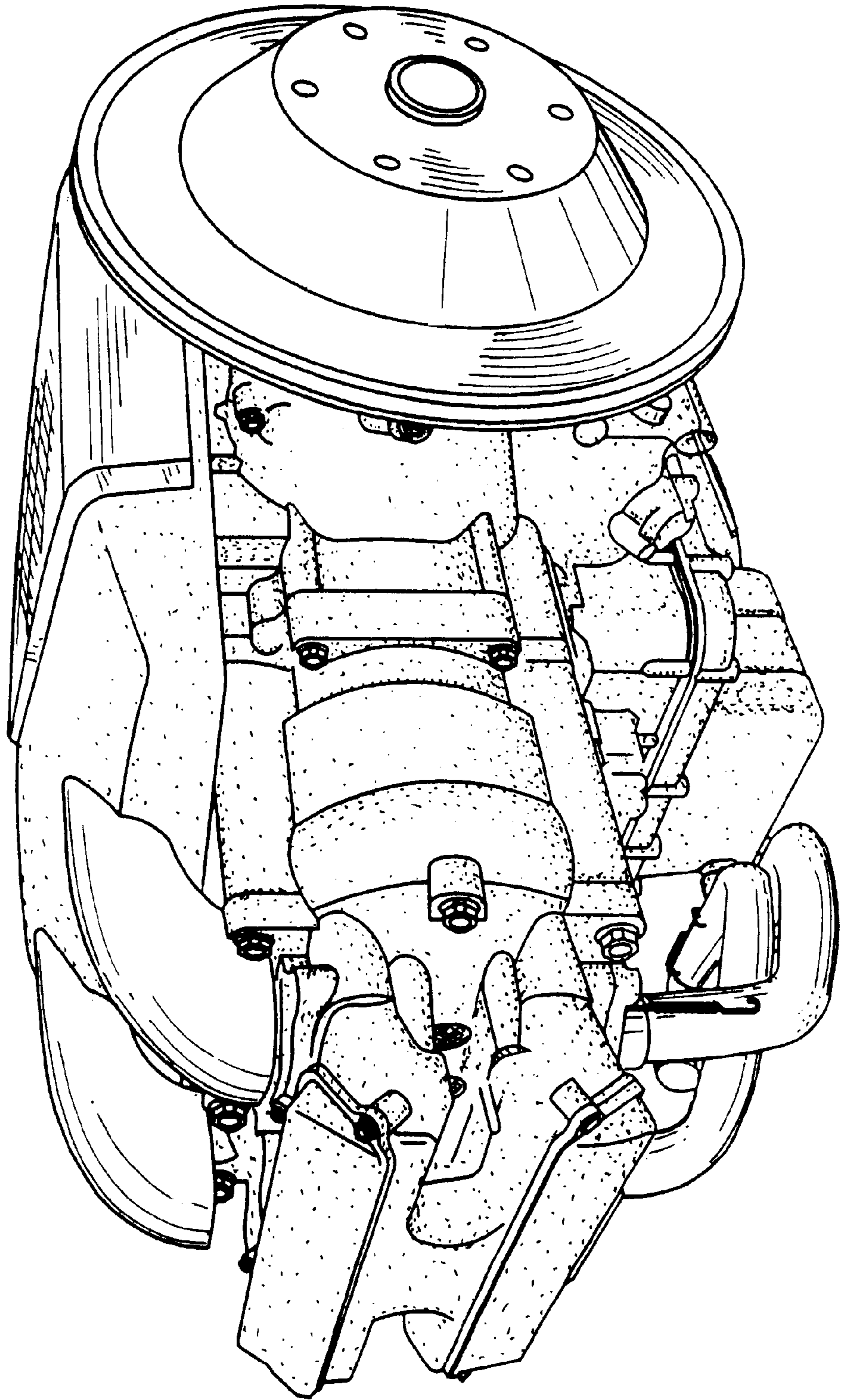

FIG.8

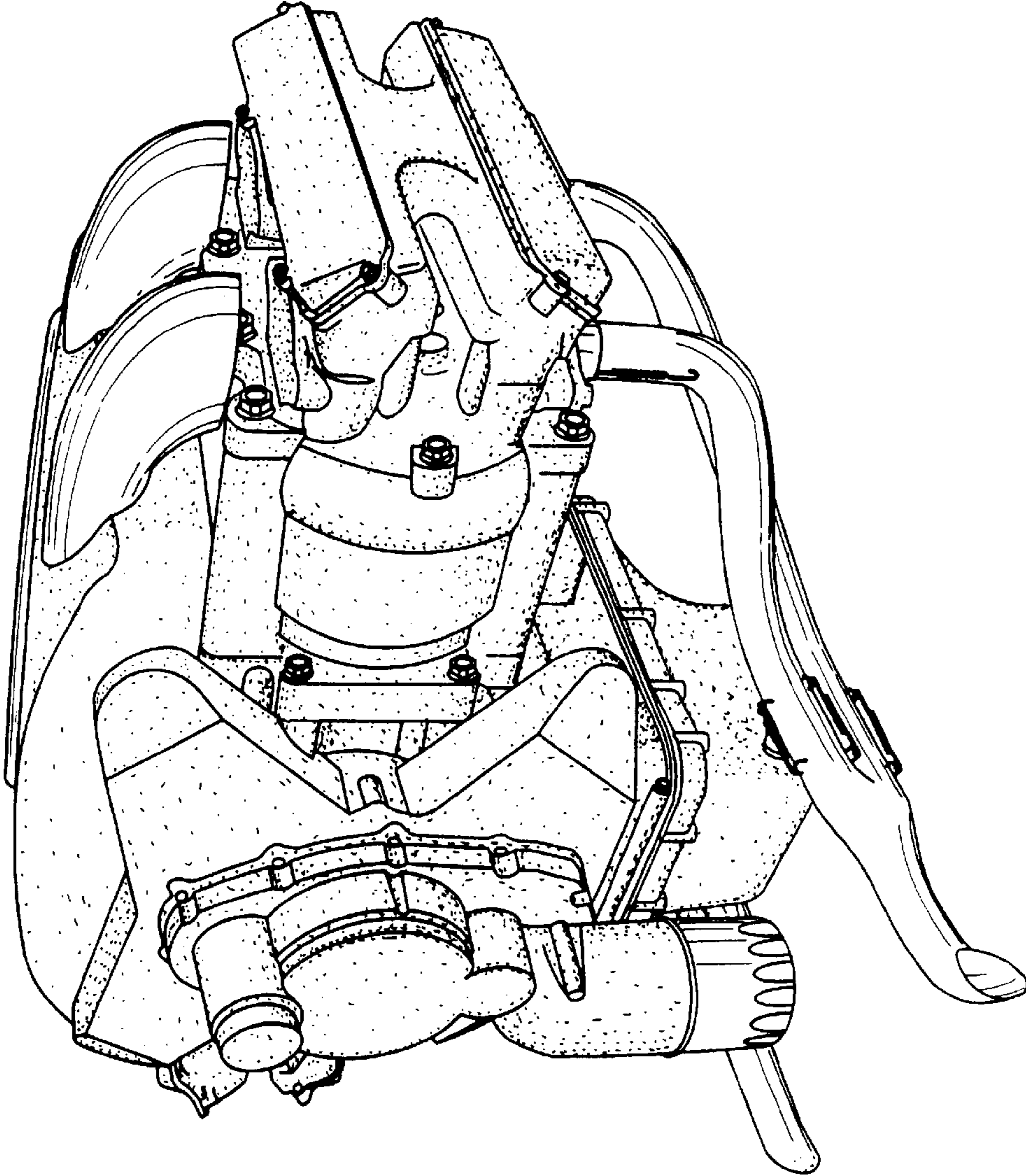

FIG. 9

