



US00D519884S

(12) **United States Design Patent** (10) **Patent No.:** **US D519,884 S**  
**Heinrich et al.** (45) **Date of Patent:** **\*\* May 2, 2006**

(54) **SURFACE CONFIGURATION OF A  
MOTORCYCLE, TOY, AND/OR OTHER  
REPLICAS**

(75) Inventors: **Edgar Heinrich**, Freising (DE); **David  
Irwin Robb**, Munich (DE)

(73) Assignee: **Bayerische Motoren Werke  
Aktiengesellschaft**, Munich (DE)

(\*\*) Term: **14 Years**

(21) Appl. No.: **29/225,861**

(22) Filed: **Mar. 22, 2005**

(51) **LOC (8) Cl.** ..... **12-11**

(52) **U.S. Cl.** ..... **D12/110**

(58) **Field of Classification Search** ..... D12/110;  
180/219, 220, 225, 229; D21/432, 538; 446/440  
See application file for complete search history.

(56) **References Cited**

**U.S. PATENT DOCUMENTS**

D378,204 S	*	2/1997	Heinrich et al.	.....	D12/110
D437,262 S	*	2/2001	Robb et al.	.....	D12/110
D444,103 S	*	6/2001	Robb et al.	.....	D12/110
D455,373 S	*	4/2002	Robb et al.	.....	D12/110

\* cited by examiner

*Primary Examiner*—Alan P. Douglas

*Assistant Examiner*—Linda Brooks

(74) *Attorney, Agent, or Firm*—Crowell & Moring LLP

(57) **CLAIM**

The ornamental design for a surface configuration of a motorcycle, toy, and/or other replicas, as shown and described.

**DESCRIPTION**

FIG. 1 is a front, left perspective view of a surface configuration of a motorcycle, toy, and/or other replicas according to our novel design;

FIG. 2 is a rear, left perspective view of the surface configuration of a motorcycle, toy, and/or other replicas according to our novel design;

FIG. 3 is a front, right perspective view of the surface configuration of a motorcycle, toy, and/or other replicas according to our novel design;

FIG. 4 is a rear, right perspective view of the surface configuration of a motorcycle, toy, and/or other replicas according to our novel design;

FIG. 5 is a left side view of the surface configuration of a motorcycle, toy, and/or other replicas according to our novel design;

FIG. 6 is a right side view of the surface configuration of a motorcycle, toy, and/or other replicas according to our novel design;

FIG. 7 is a front view of the surface configuration of a motorcycle, toy, and/or other replicas according to our novel design;

FIG. 8 is a rear view of the surface configuration of a motorcycle, toy, and/or other replicas according to our novel design; and,

FIG. 9 is a top view of the surface configuration of a motorcycle, toy, and/or other replicas according to our novel design.

The broken lines are for illustrative purposes only and form no part of the claimed design.

**1 Claim, 8 Drawing Sheets**

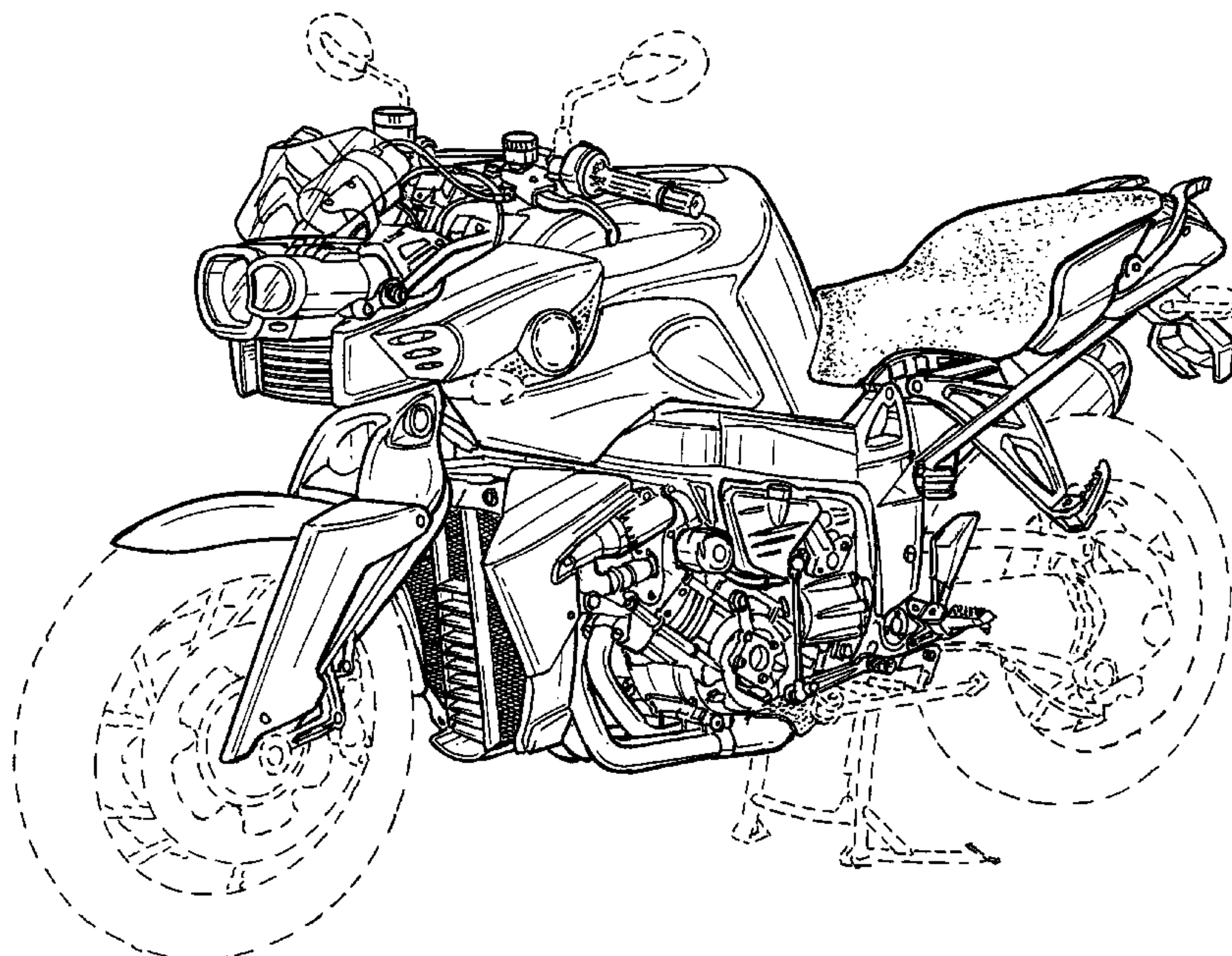

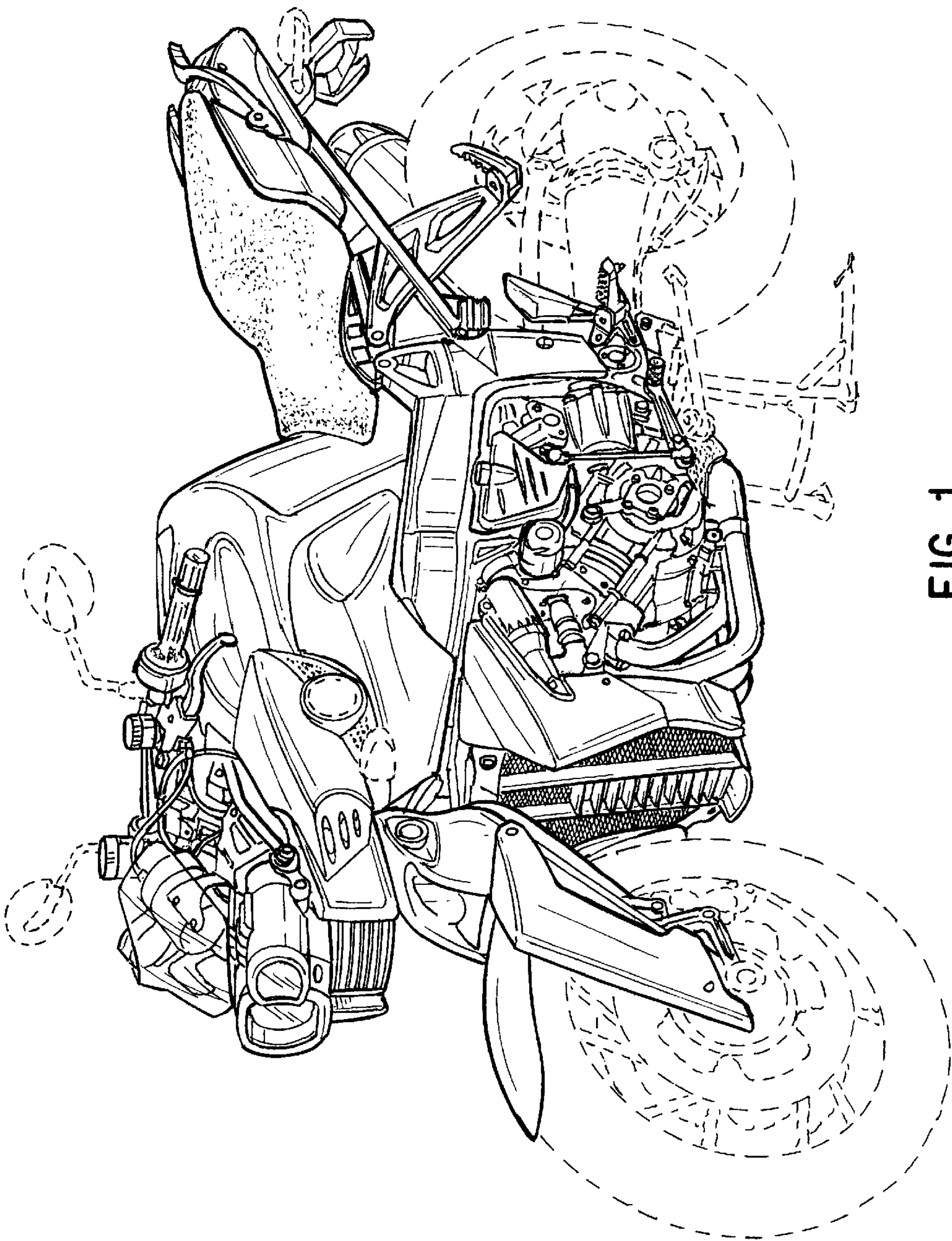

FIG. 1



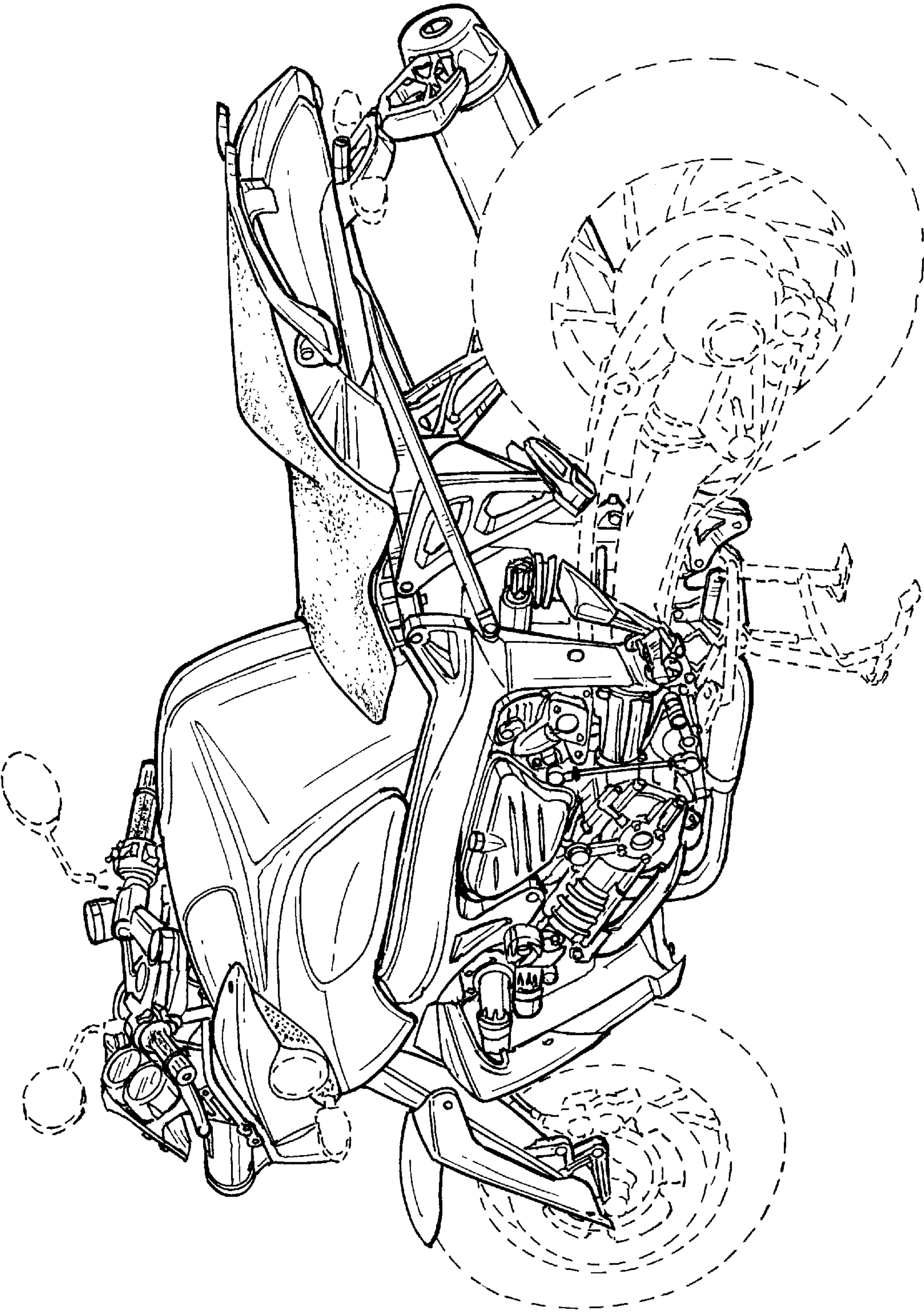

FIG. 2

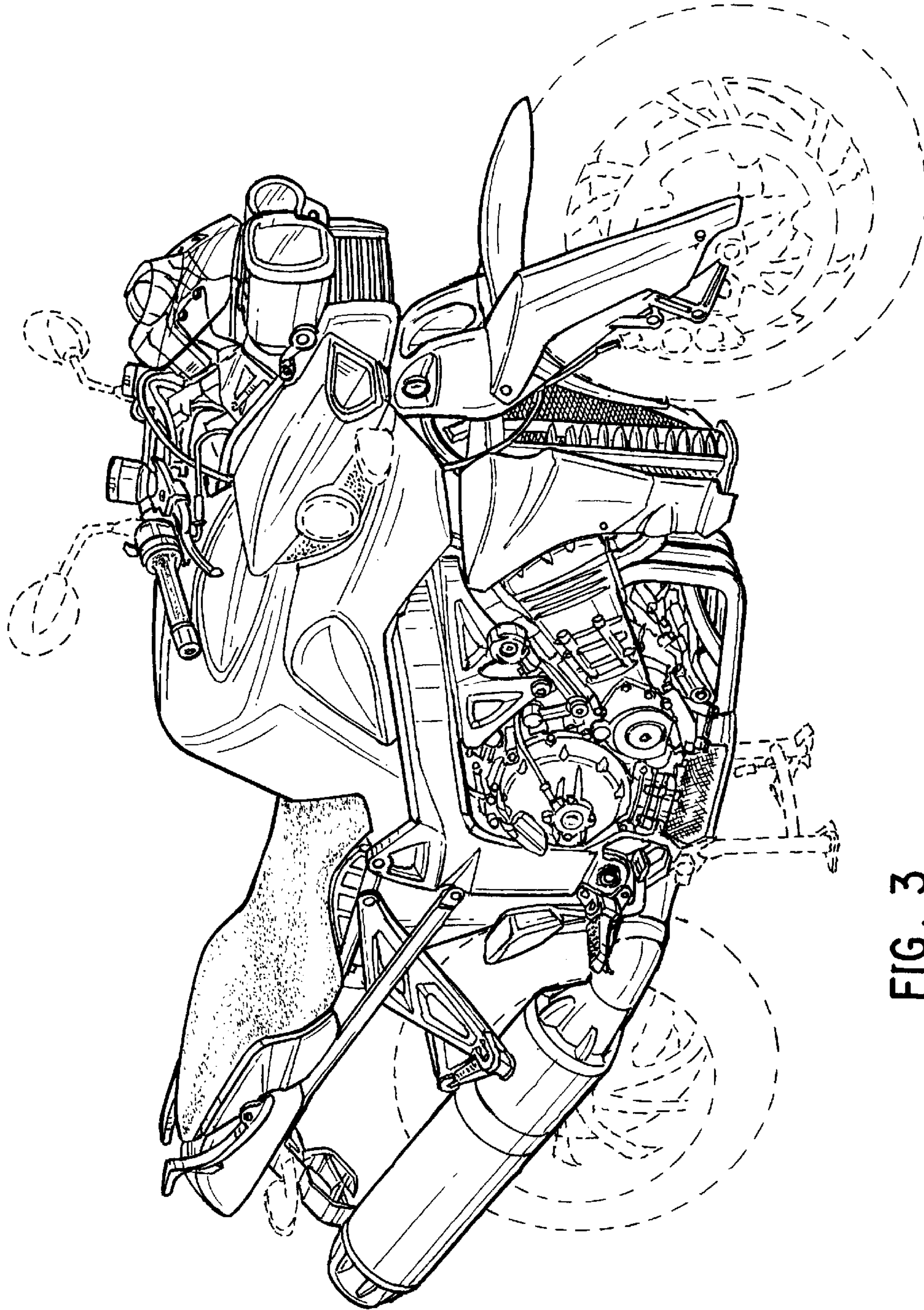

FIG. 3



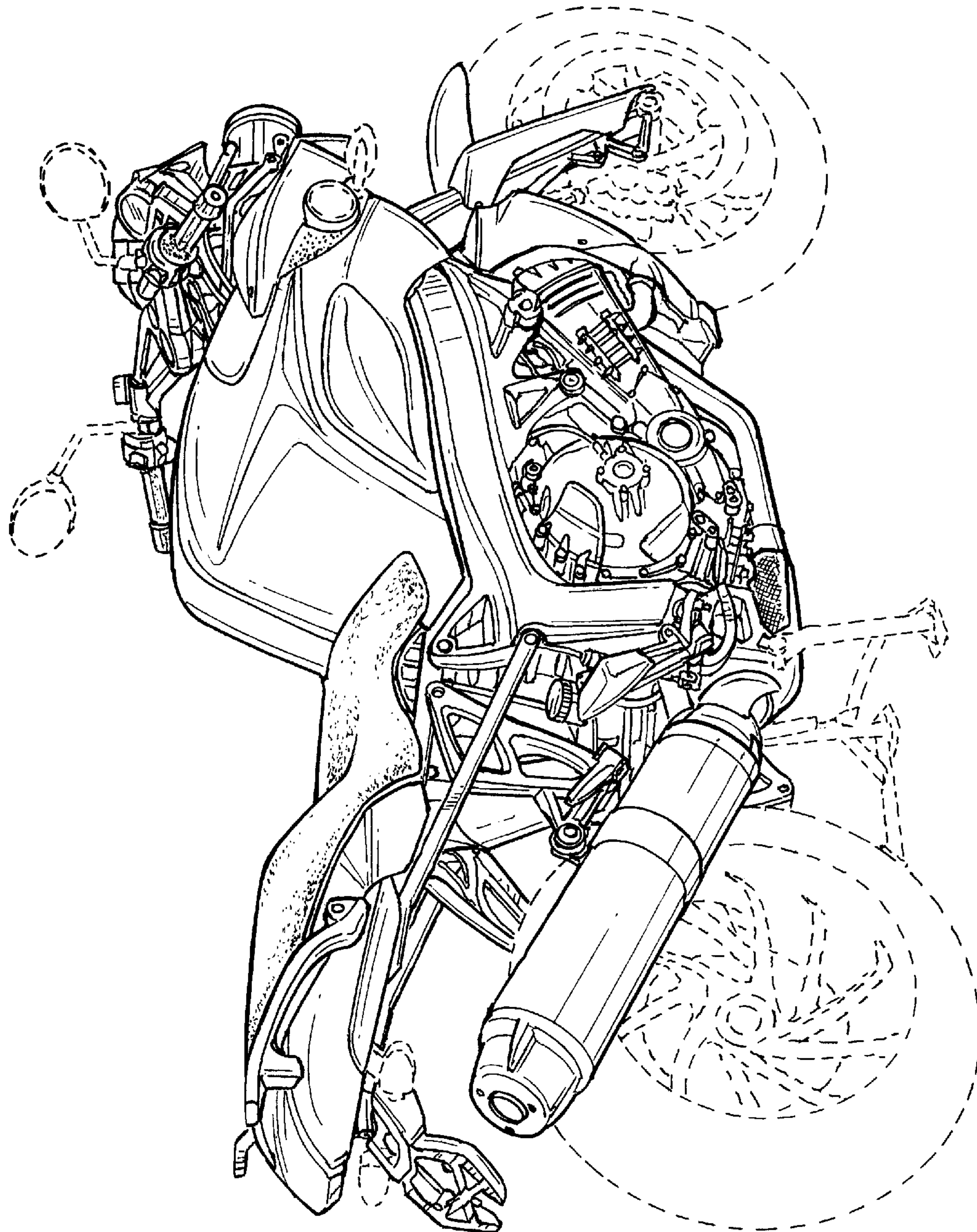

FIG. 4

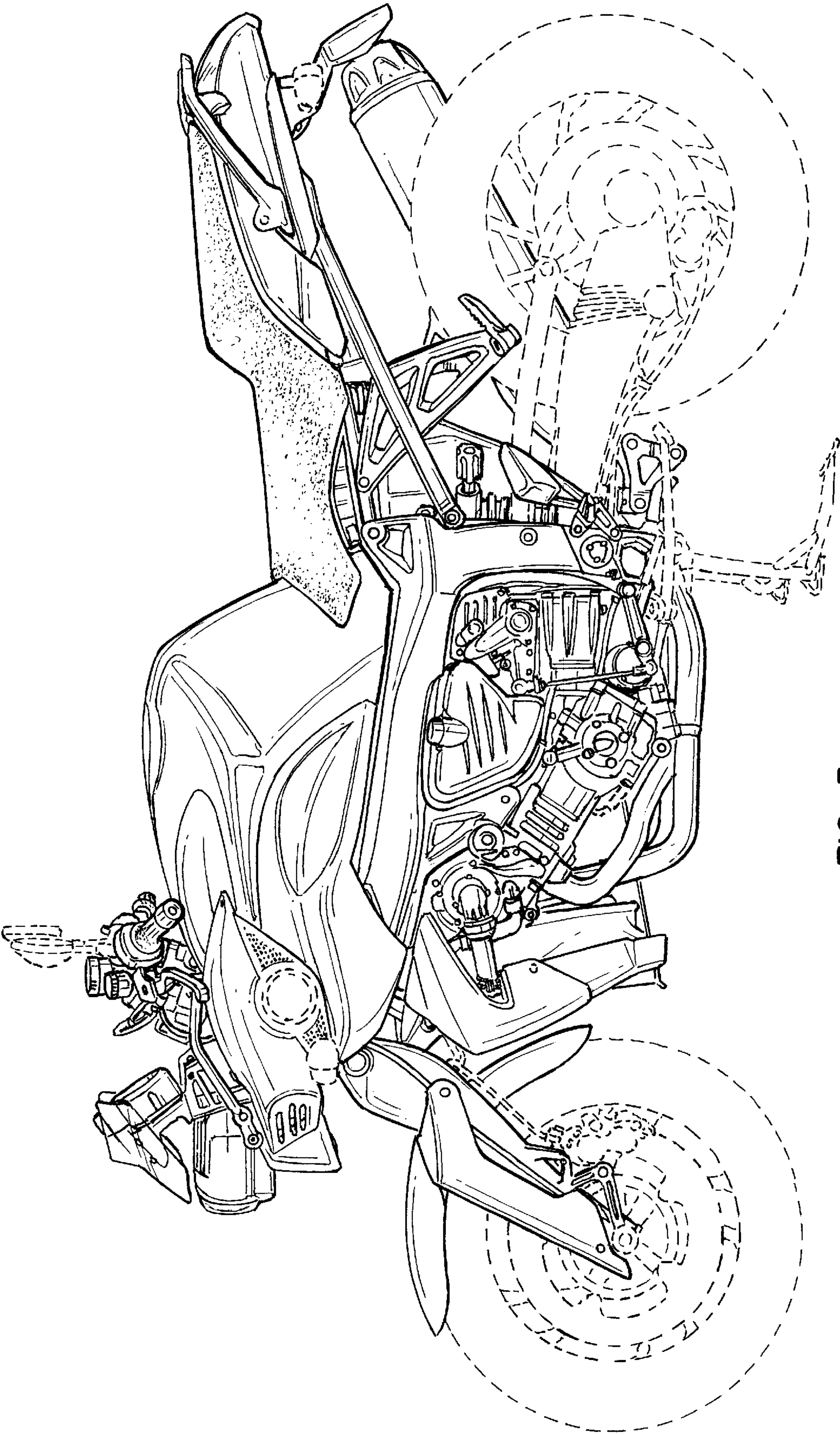

FIG. 5



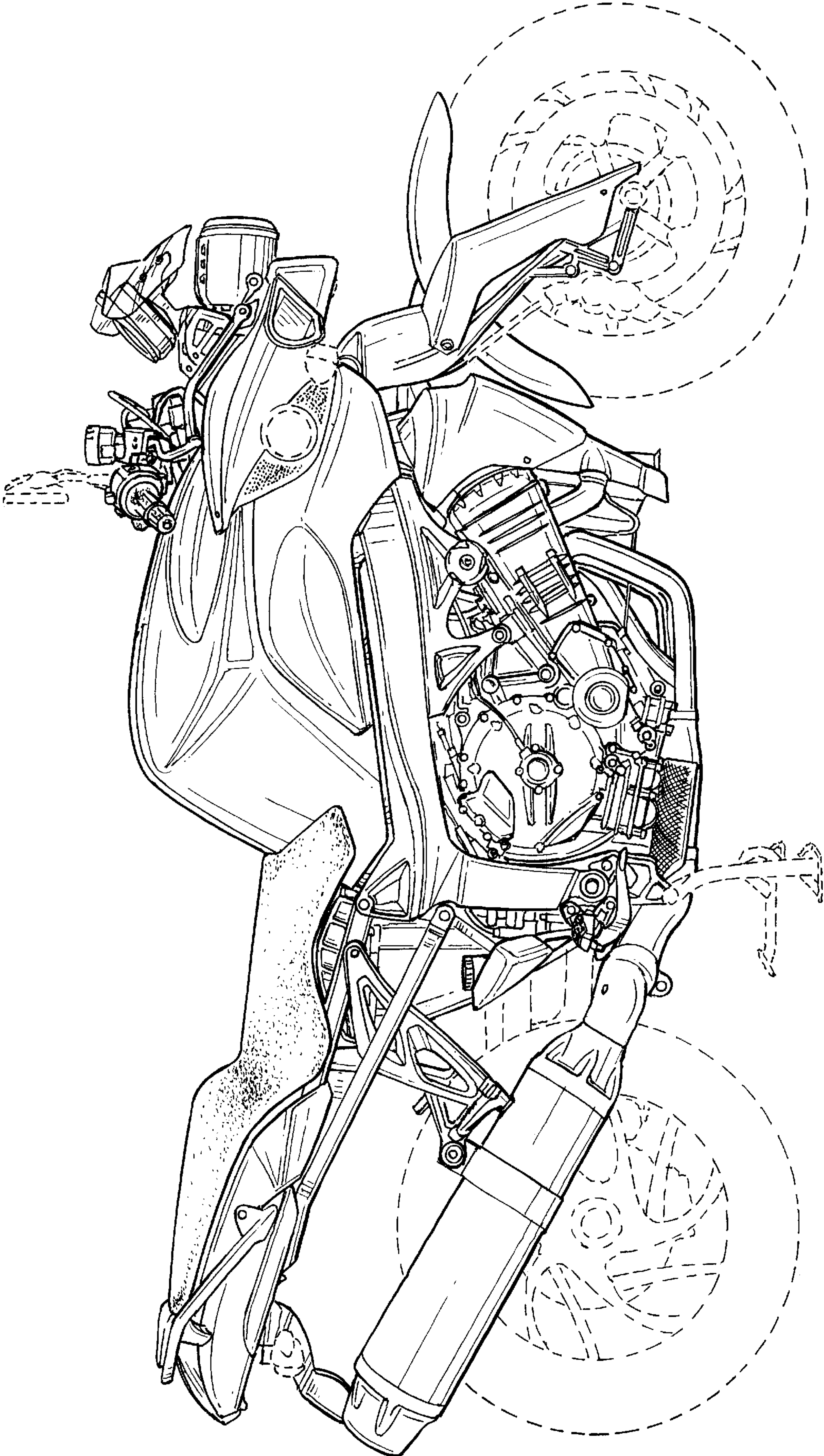

FIG. 6

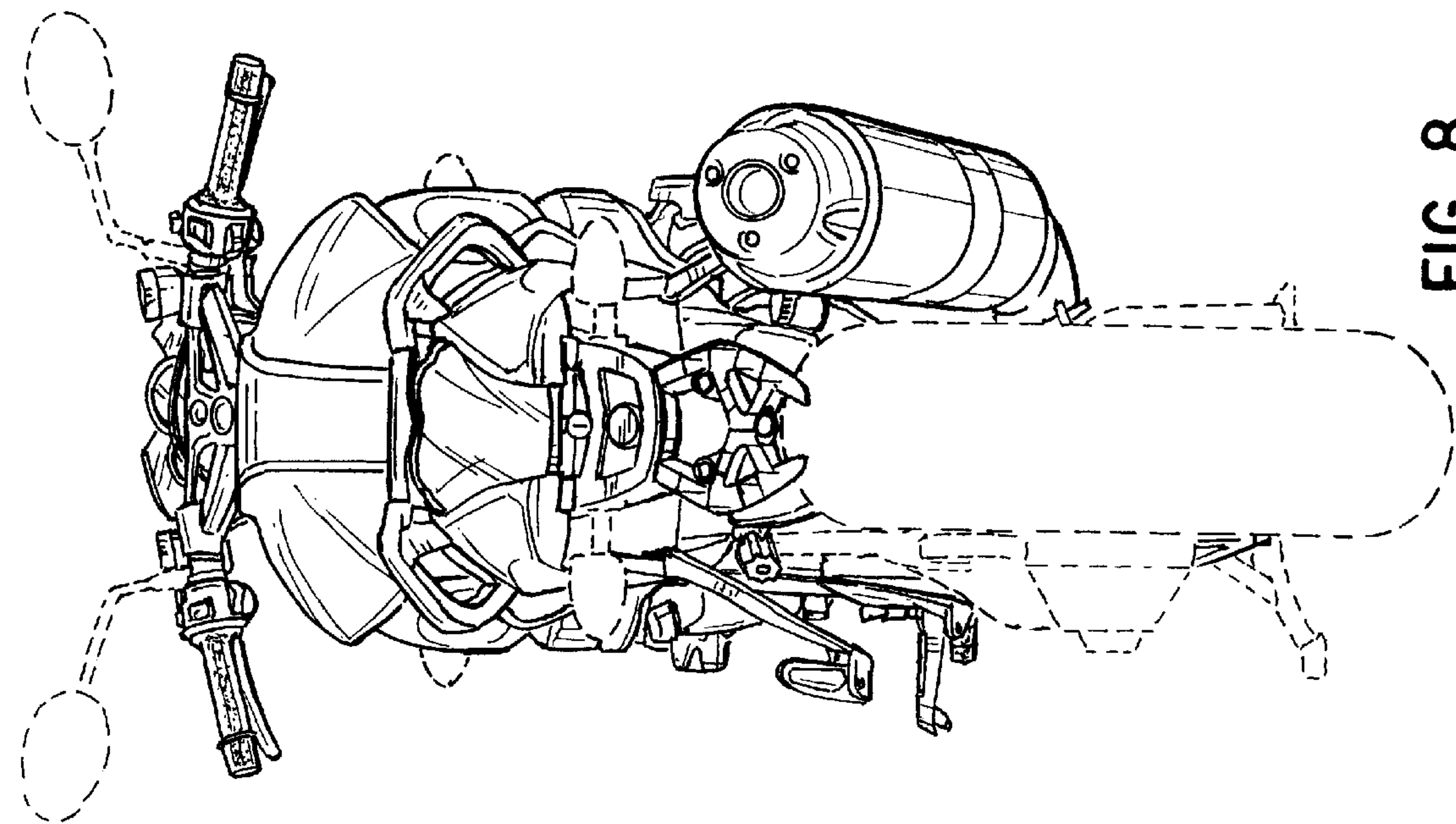

FIG. 7

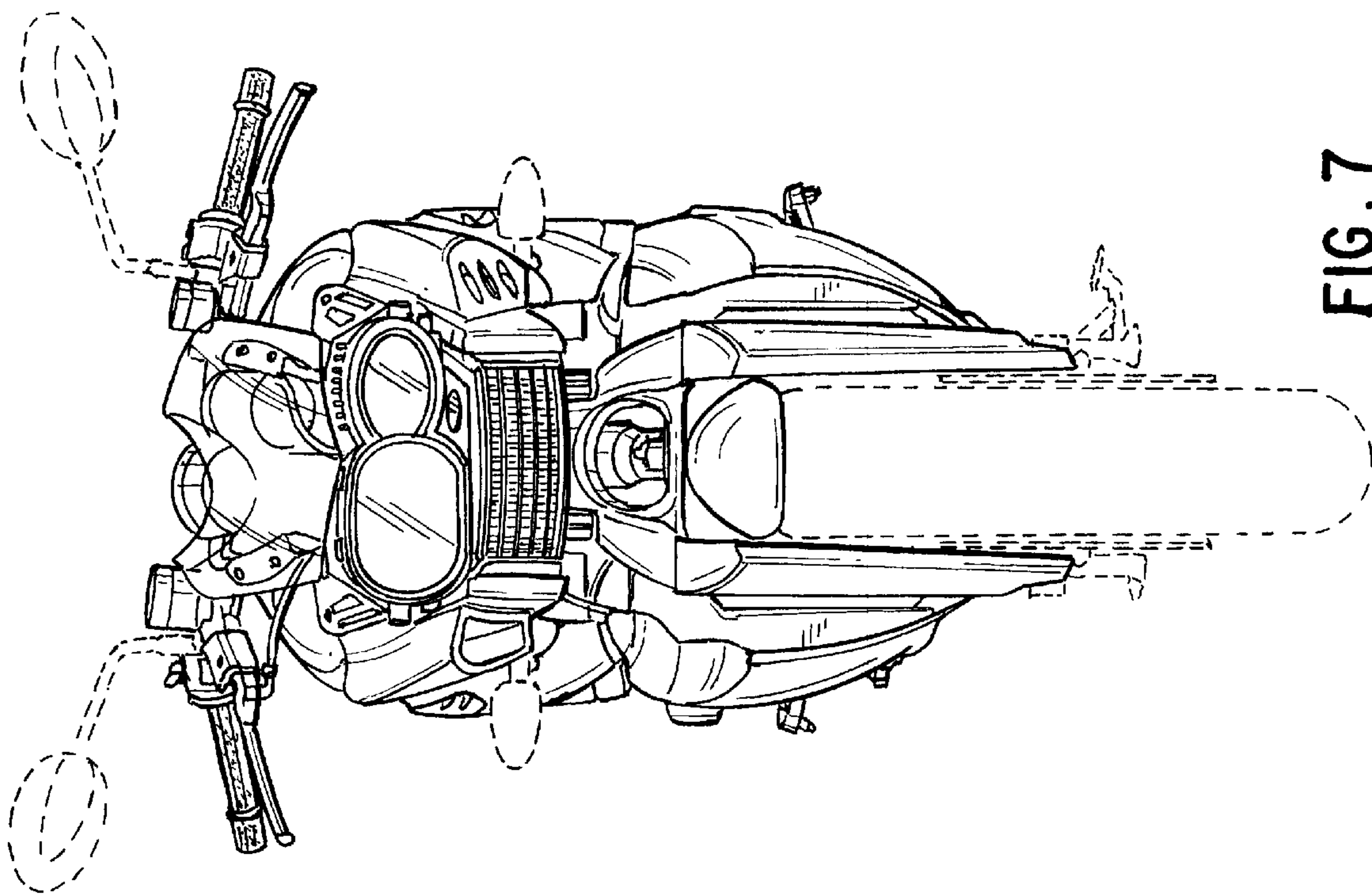

FIG. 8



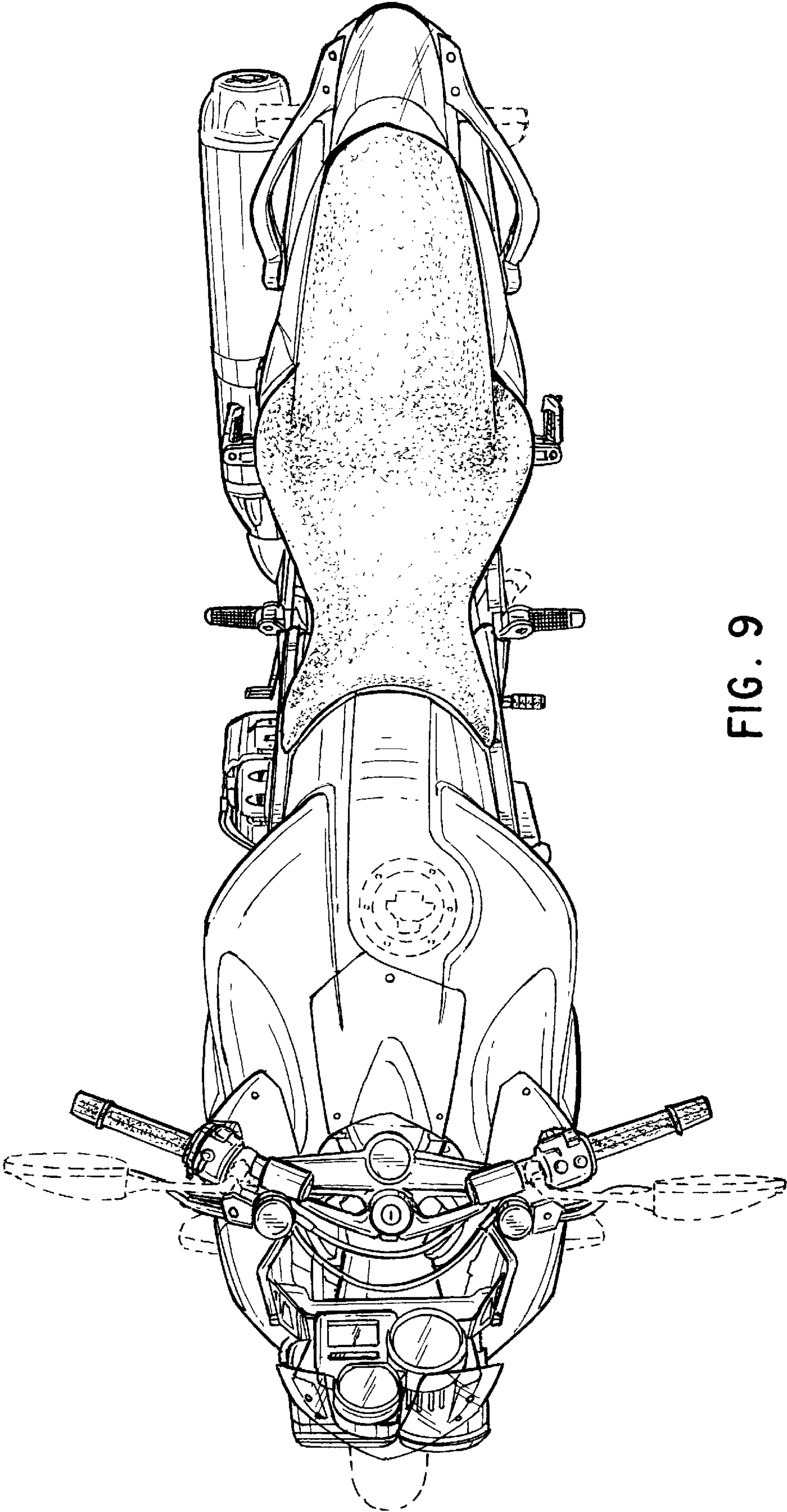

FIG. 9