



US00D519755S

(12) **United States Design Patent**
Luong

(10) **Patent No.:** **US D519,755 S**

(45) **Date of Patent:** **** May 2, 2006**

(54) **ENTERTAINMENT CENTER**

D477,292 S * 7/2003 Inoue et al. D14/129
D485,539 S * 1/2004 Goto et al. D14/128
D506,328 S * 6/2005 Inoue D6/477

(75) Inventor: **Phuoc Hong Luong**, Fountain Valley,
CA (US)

* cited by examiner

(73) Assignee: **Elite Manufacturing Corporation**,
Santa Fe Springs, CA (US)

Primary Examiner—Cathron C. Brooks

(74) *Attorney, Agent, or Firm*—Marvin E. Jacobs

(**) Term: **14 Years**

(57) **CLAIM**

(21) Appl. No.: **29/228,685**

The ornamental design for entertainment center, as shown
and described.

(22) Filed: **Apr. 26, 2005**

DESCRIPTION

(51) **LOC (8) Cl.** **06-04**

FIG. 1 is a perspective view of the entertainment center of
the invention (broken lines of a plasma T.V. are for illus-
trative purposes only and forms no part of the claimed
design);

(52) **U.S. Cl.** **D6/477; D6/479; D6/466;**
D14/129

FIG. 2 is a front elevational view of the entertainment center
of FIG. 1;

(58) **Field of Classification Search** D6/460,
D6/461, 468, 474, 477-479; D14/126, 129;
312/7.2, 9.1; 108/59, 91, 92, 96; 211/40,
211/41.12, 42, 49.1, 50, 85.2, 90.04, 187,
211/190, 119.003, 134.153, 87.01, 71.01

FIG. 3 is a right side elevational view of the entertain-
ment center (left side is identical) of FIG. 1;

See application file for complete search history.

FIG. 4 is a rear elevational view of the entertainment center
of FIG. 1;

(56) **References Cited**

FIG. 5 is a top plan view of the entertainment center of FIG.
1; and,

U.S. PATENT DOCUMENTS

FIG. 6 is a bottom plan view of the entertainment center of
FIG. 1.

5,584,595 A * 12/1996 Gantitano et al. 403/24
D471,034 S * 3/2003 Bong et al. D6/479
D477,159 S * 7/2003 Niitsu D6/479

1 Claim, 2 Drawing Sheets

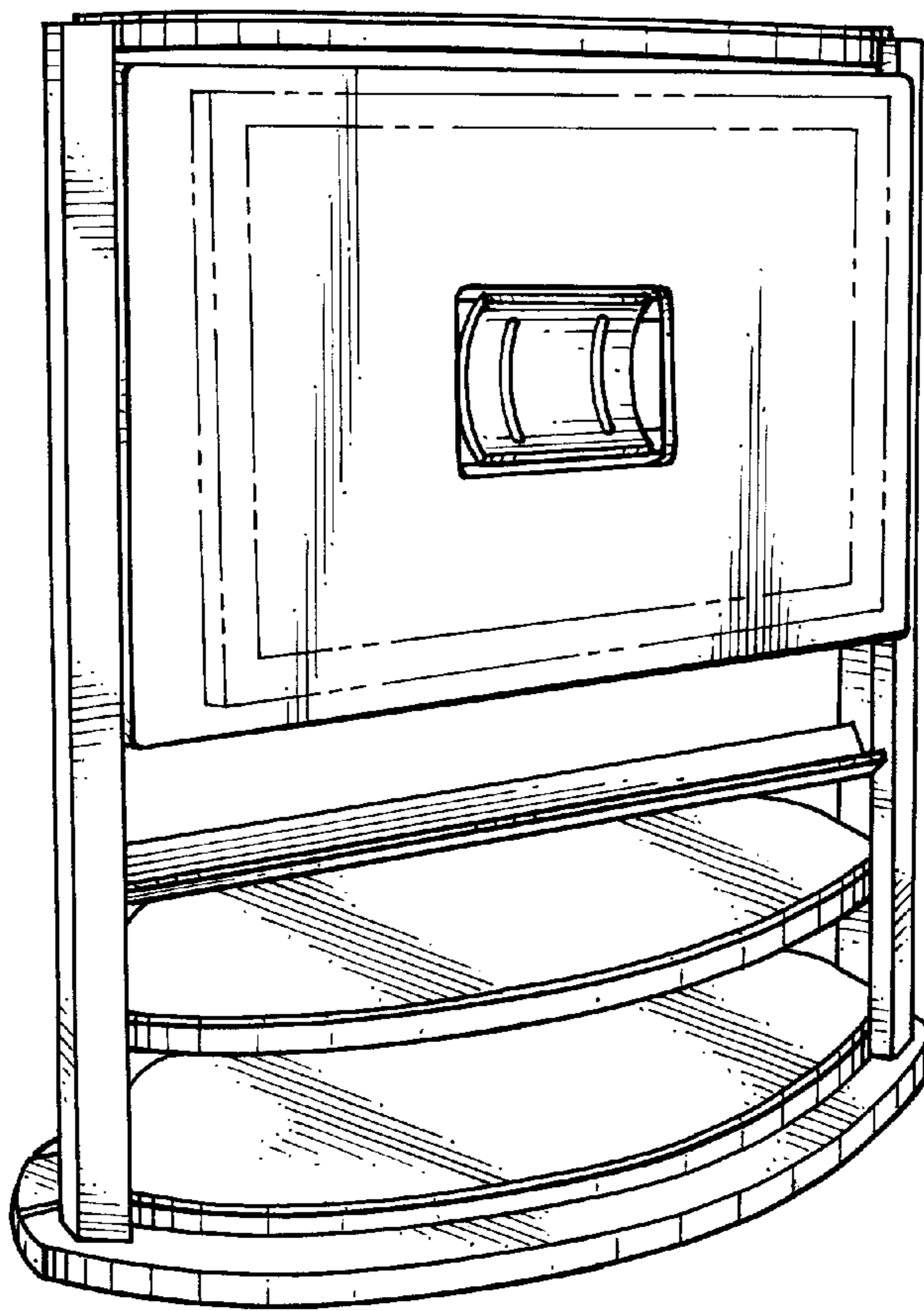

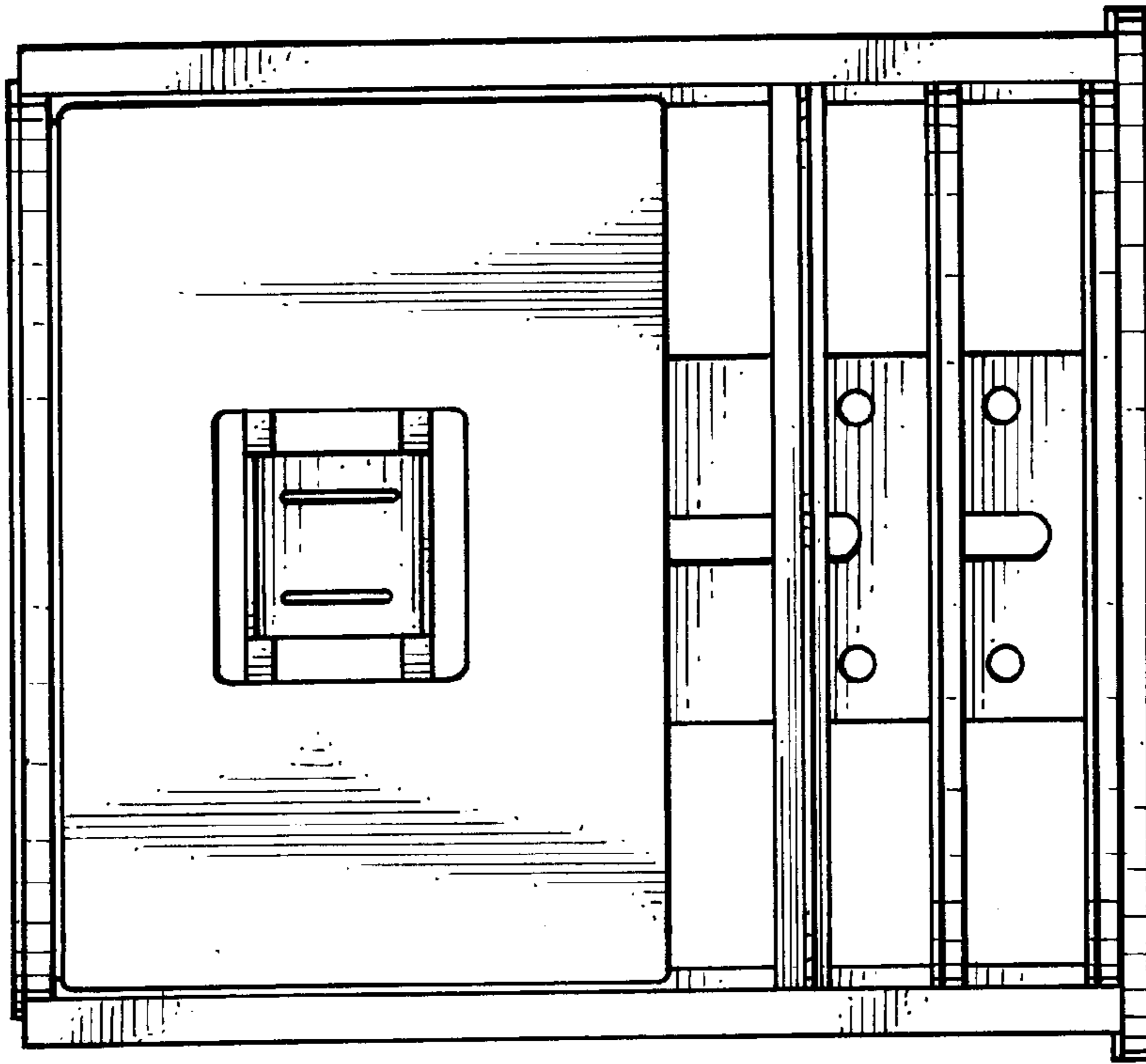

Fig. 2.

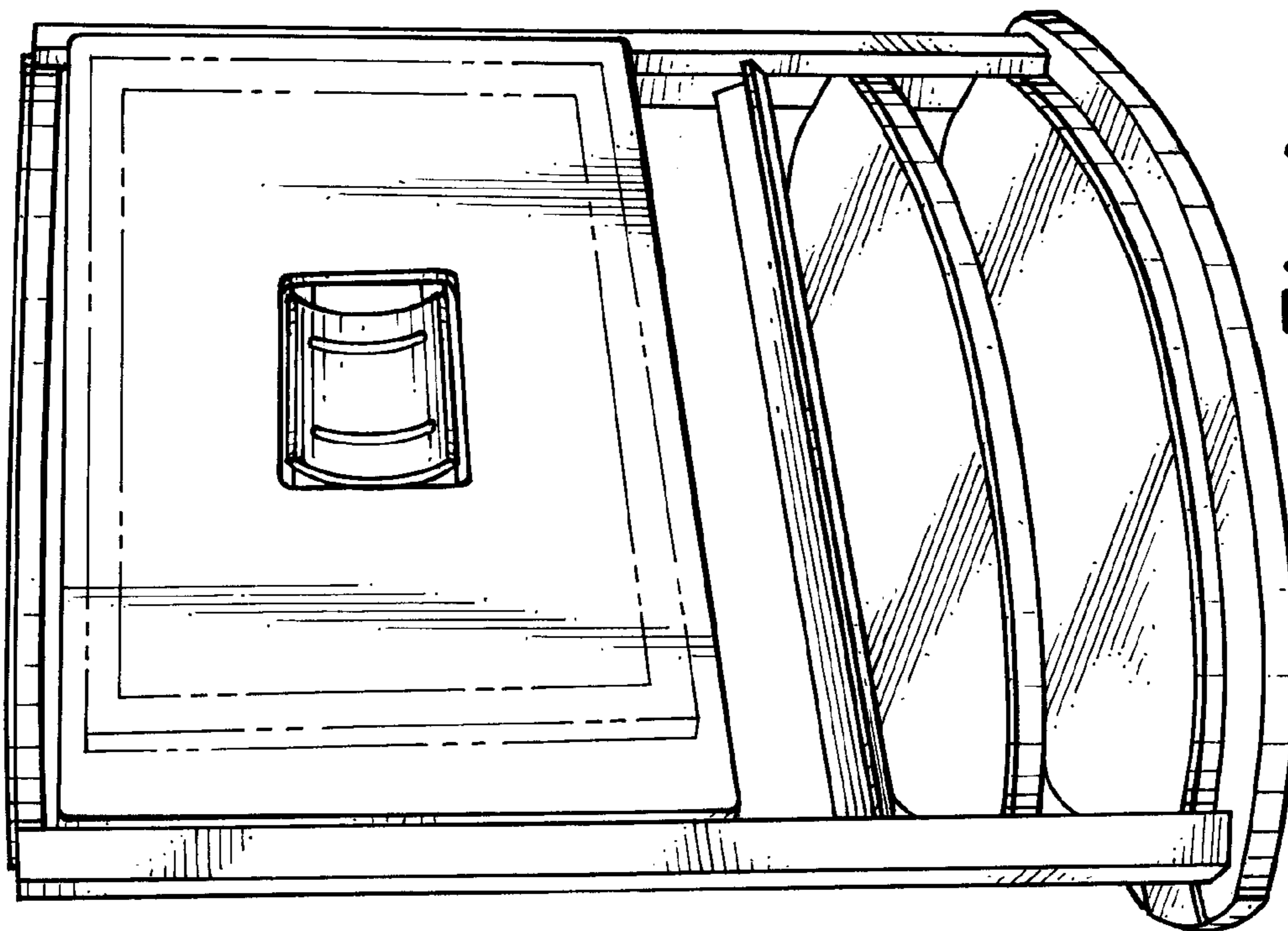

Fig. 1.

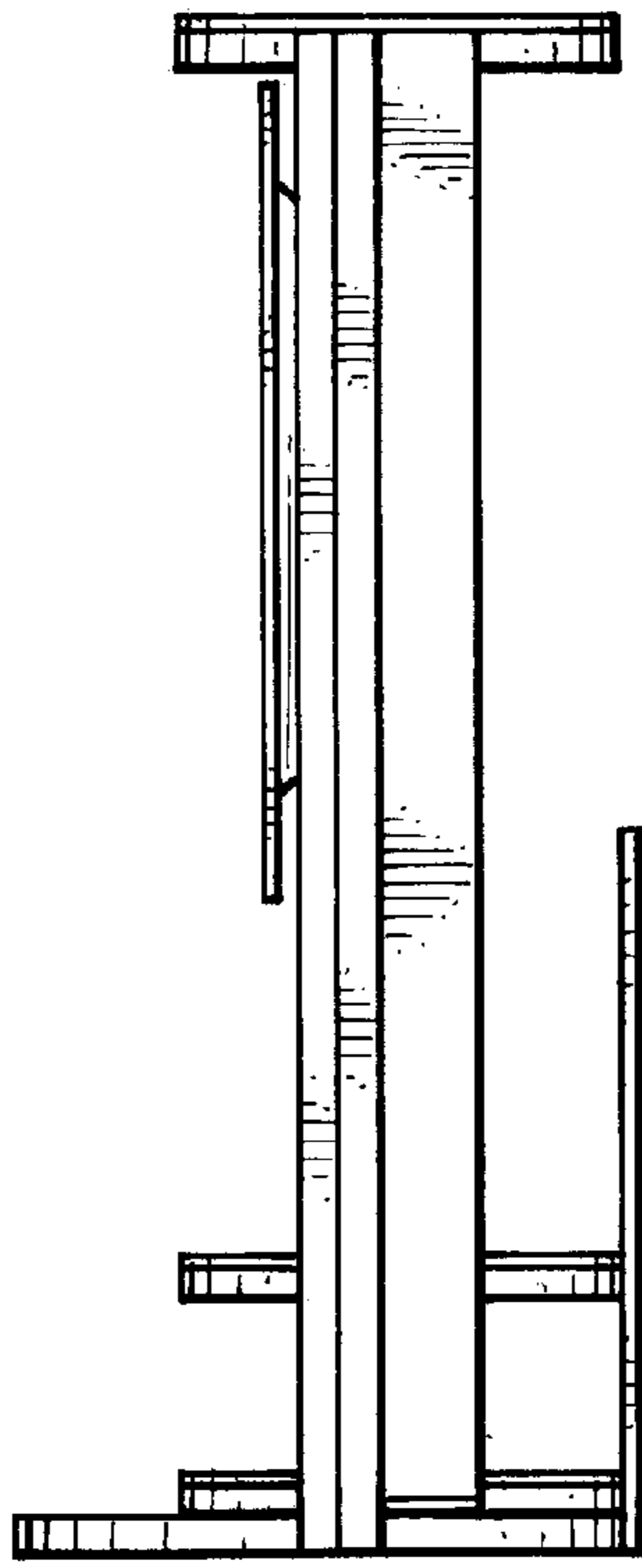

Fig. 3.

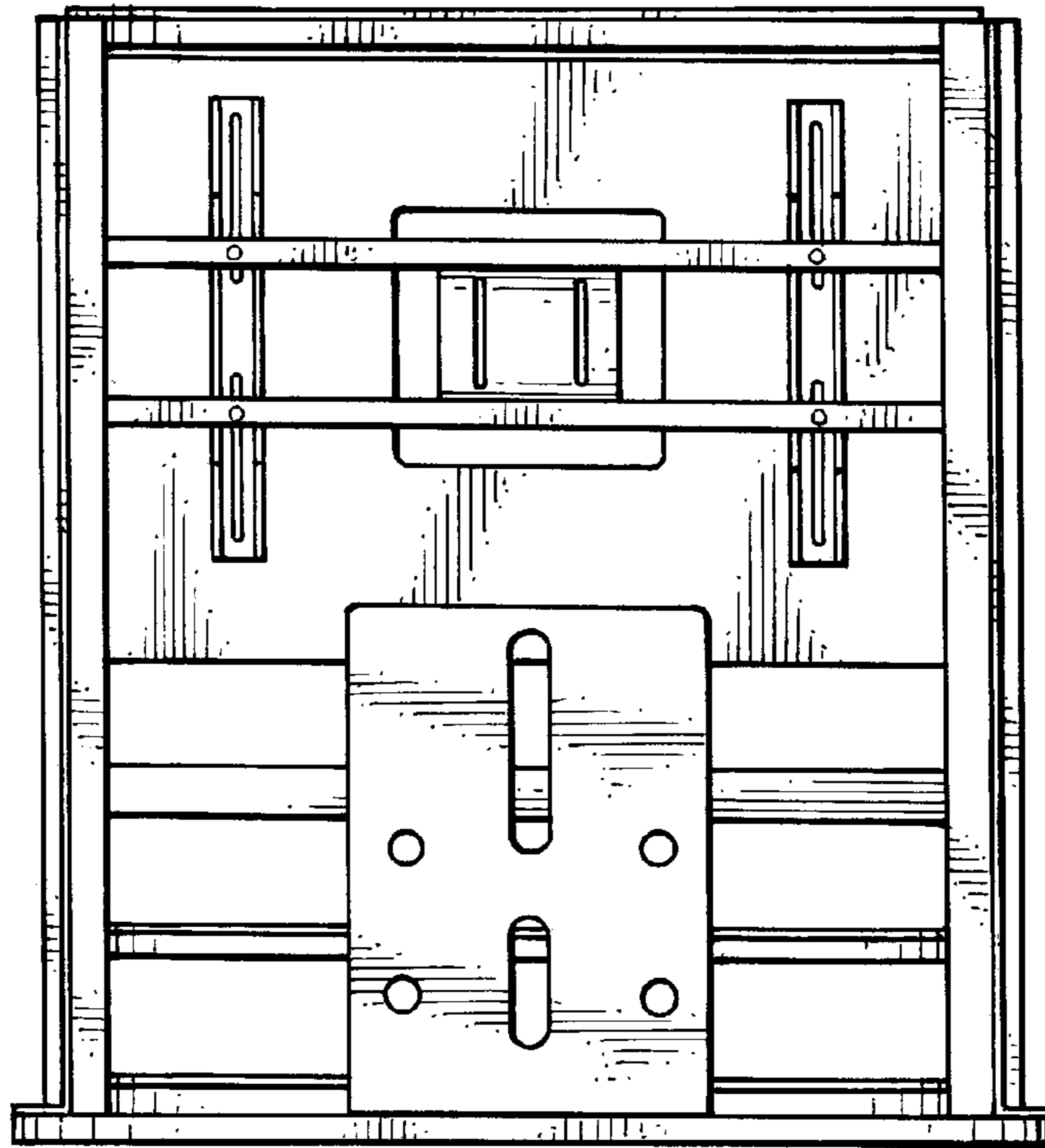

Fig. 4.

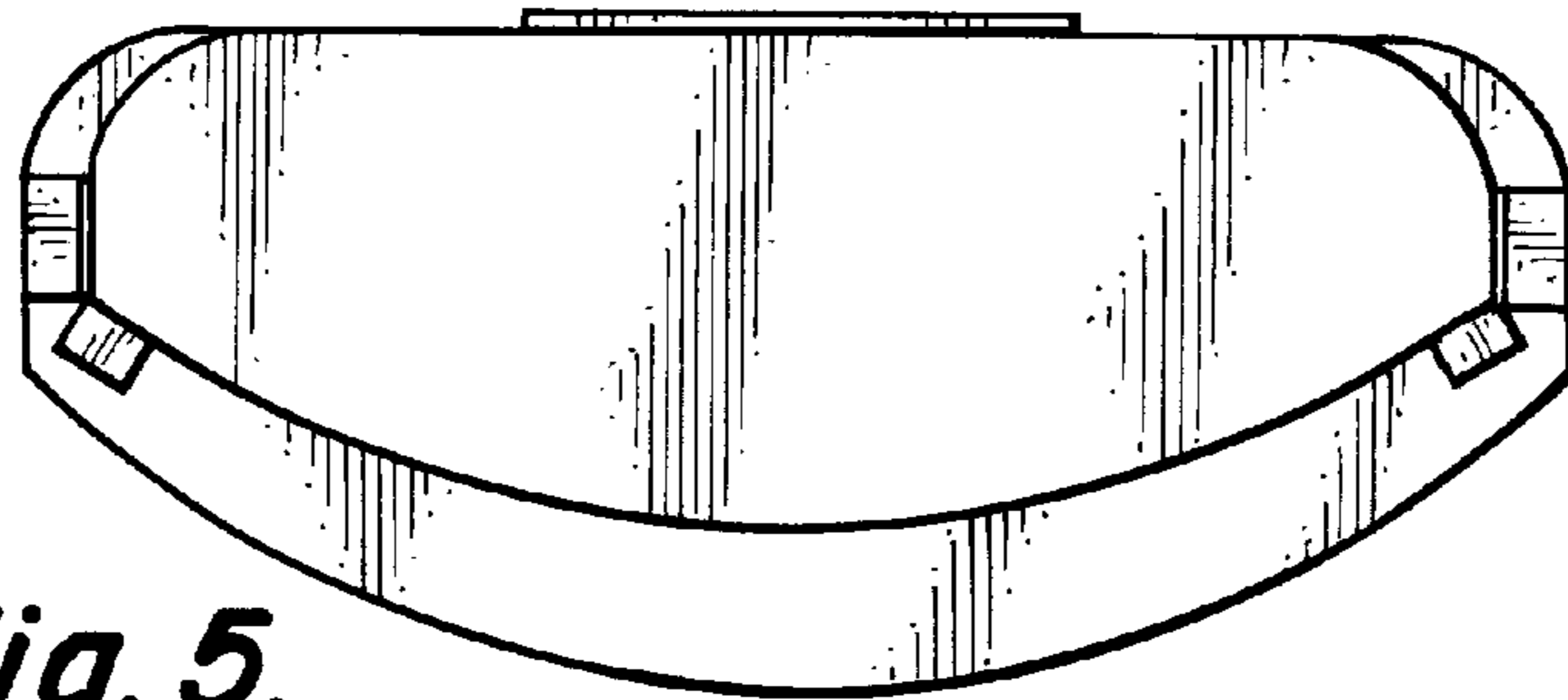

Fig. 5.

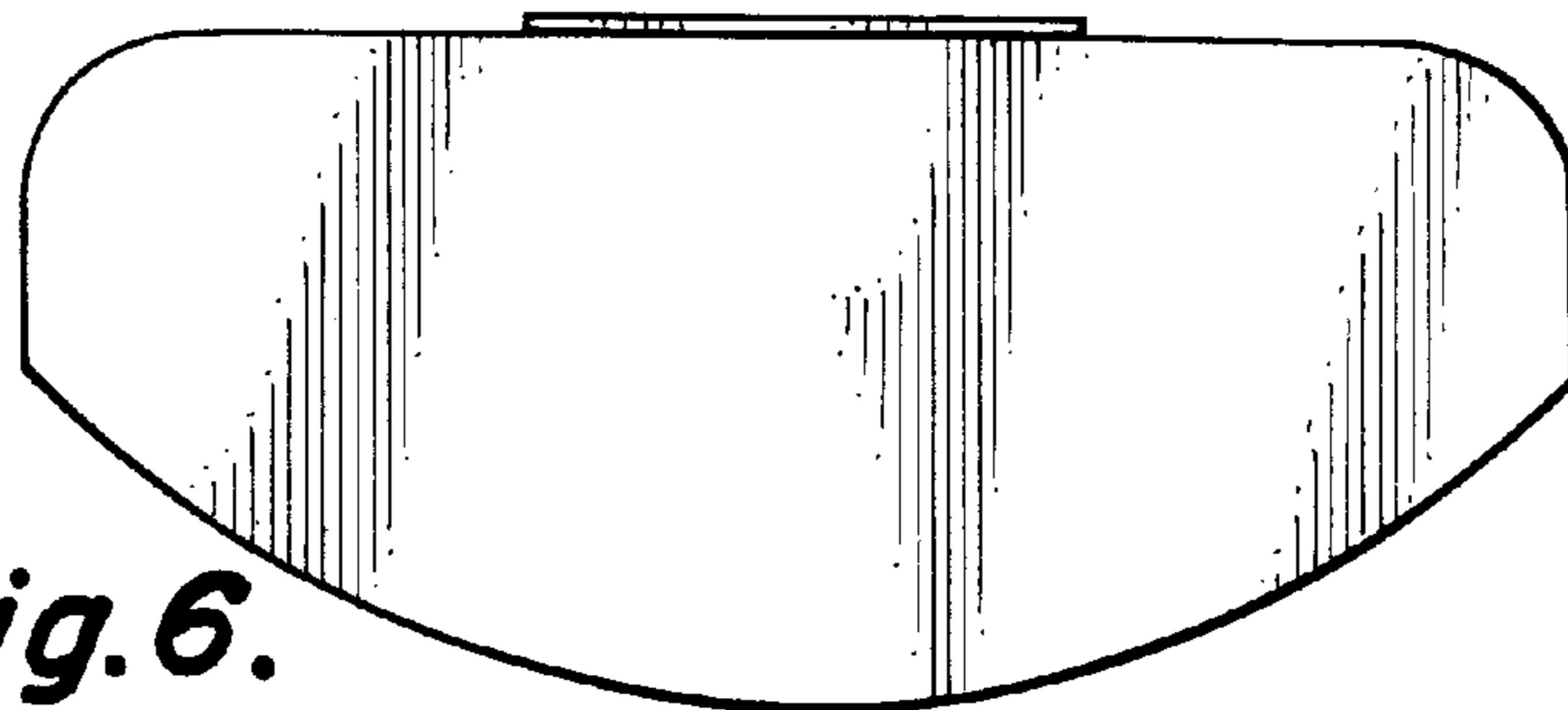

Fig. 6.