



US00D518930S

(12) **United States Design Patent**
Parr

(10) **Patent No.:** **US D518,930 S**
(45) **Date of Patent:** **** Apr. 11, 2006**

(54) **MIDDLE HANDLE PORTION FOR AN UPRIGHT EXTRACTOR**
(75) Inventor: **Richard S. Parr**, Uniontown, OH (US)
(73) Assignee: **The Hoover Company**, North Canton, OH (US)
(**) Term: **14 Years**

(21) Appl. No.: **29/212,812**
(22) Filed: **Sep. 8, 2004**

(51) **LOC (8) Cl.** **15-05**
(52) **U.S. Cl.** **D32/31**
(58) **Field of Classification Search** D32/22,
D32/25, 30-34; 15/319, 320-323, 347, 350-353,
15/410, 412, 414, 415.1, 383, 50.1; 55/DIG. 3,
55/337, 345
See application file for complete search history.

(56) **References Cited**
U.S. PATENT DOCUMENTS

D188,411 S	7/1960	Gantz	
D194,025 S	11/1962	Gantz	
D214,084 S	5/1969	Chi	
D305,269 S	* 12/1989	Dyson	D32/22
D343,707 S	* 1/1994	Dyson	D32/22
D413,698 S	9/1999	Dyson	
D420,475 S	2/2000	Yuen	
D436,701 S	* 1/2001	Salo et al.	D32/25
6,253,414 B1	* 7/2001	Bradd et al.	15/320

D455,876 S	* 4/2002	Arney et al.	D32/22
D456,964 S	5/2002	Alford et al.	
D462,814 S	9/2002	Sugimoto	
D463,078 S	* 9/2002	Harada	D32/22
D473,981 S	* 4/2003	Wareham	D32/22
D484,653 S	12/2003	Parr et al.	
6,725,498 B1	* 4/2004	Symensma et al.	15/320

OTHER PUBLICATIONS

Photographs of Panasonic Model MC E583K, undated.
* cited by examiner

Primary Examiner—Ruth McInroy
(74) *Attorney, Agent, or Firm*—A. Burgess Lowe; John W. Morrison

(57) **CLAIM**

The ornamental design for a middle handle portion for an upright extractor, as shown and described.

DESCRIPTION

FIG. 1 is a top, front and right side perspective view of a middle handle portion for an upright extractor showing my new design;
FIG. 2 is a right side elevational view thereof;
FIG. 3 is a front view thereof; and,
FIG. 4 is a left side elevational view thereof.
The details shown in broken lines in FIG. 1 are for illustrative purposes only and form no part of the claimed design.

1 Claim, 2 Drawing Sheets

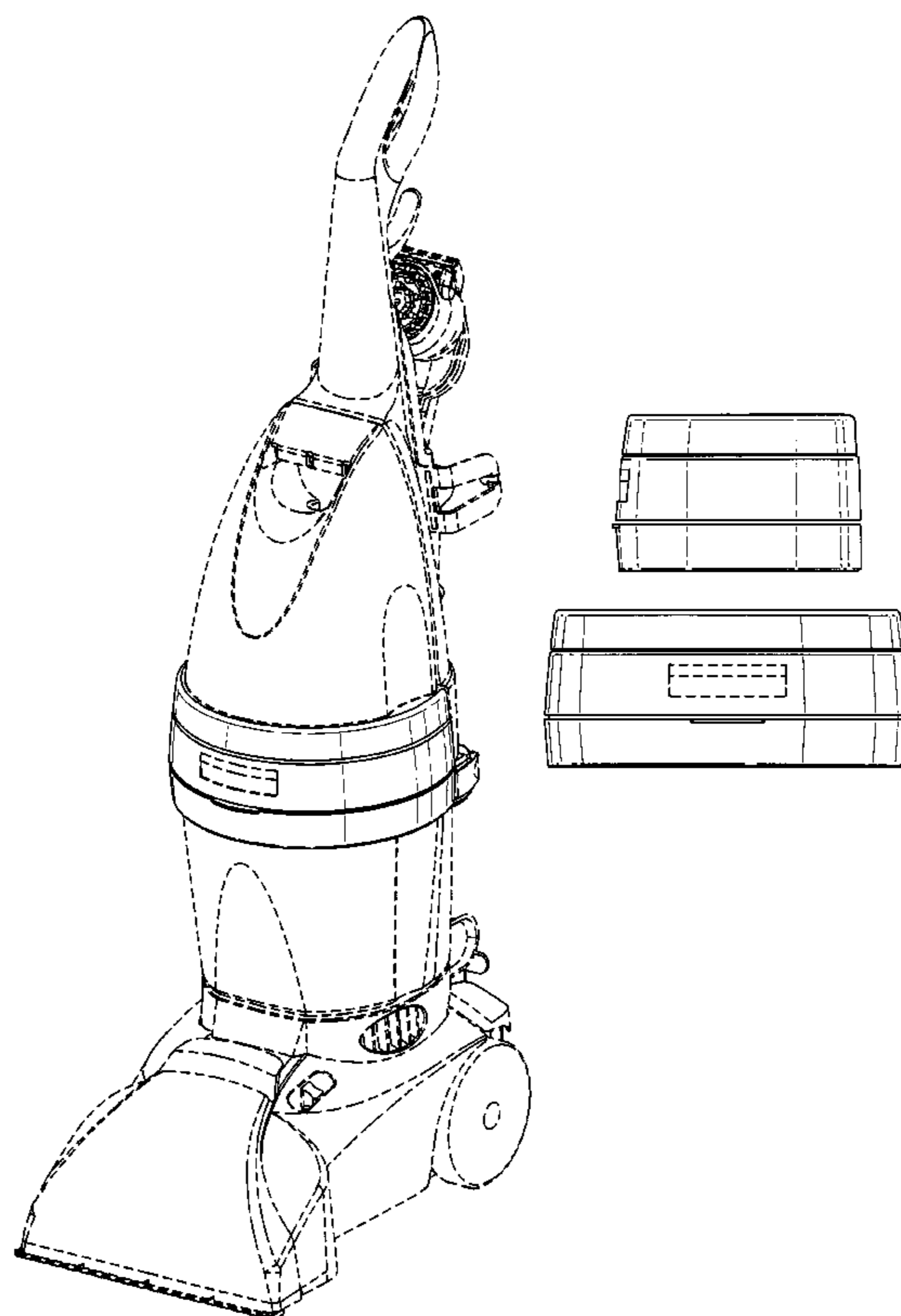

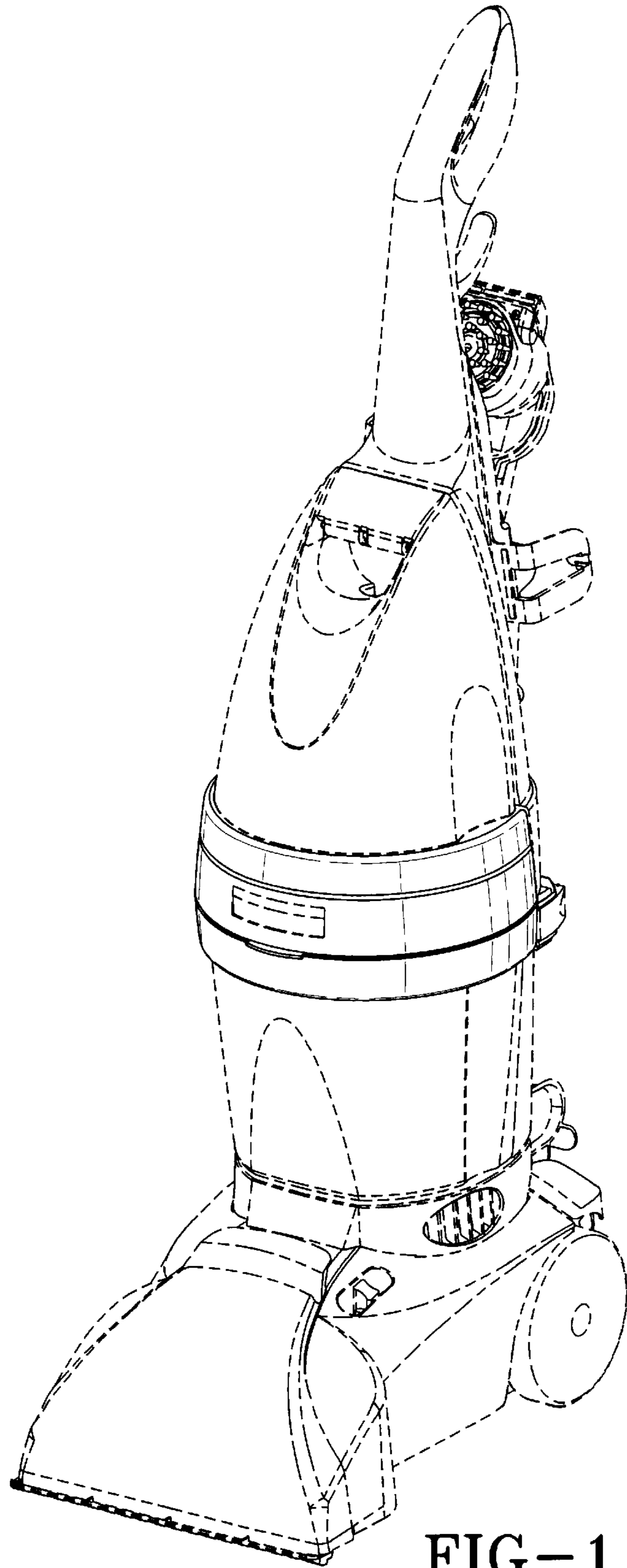

FIG-1

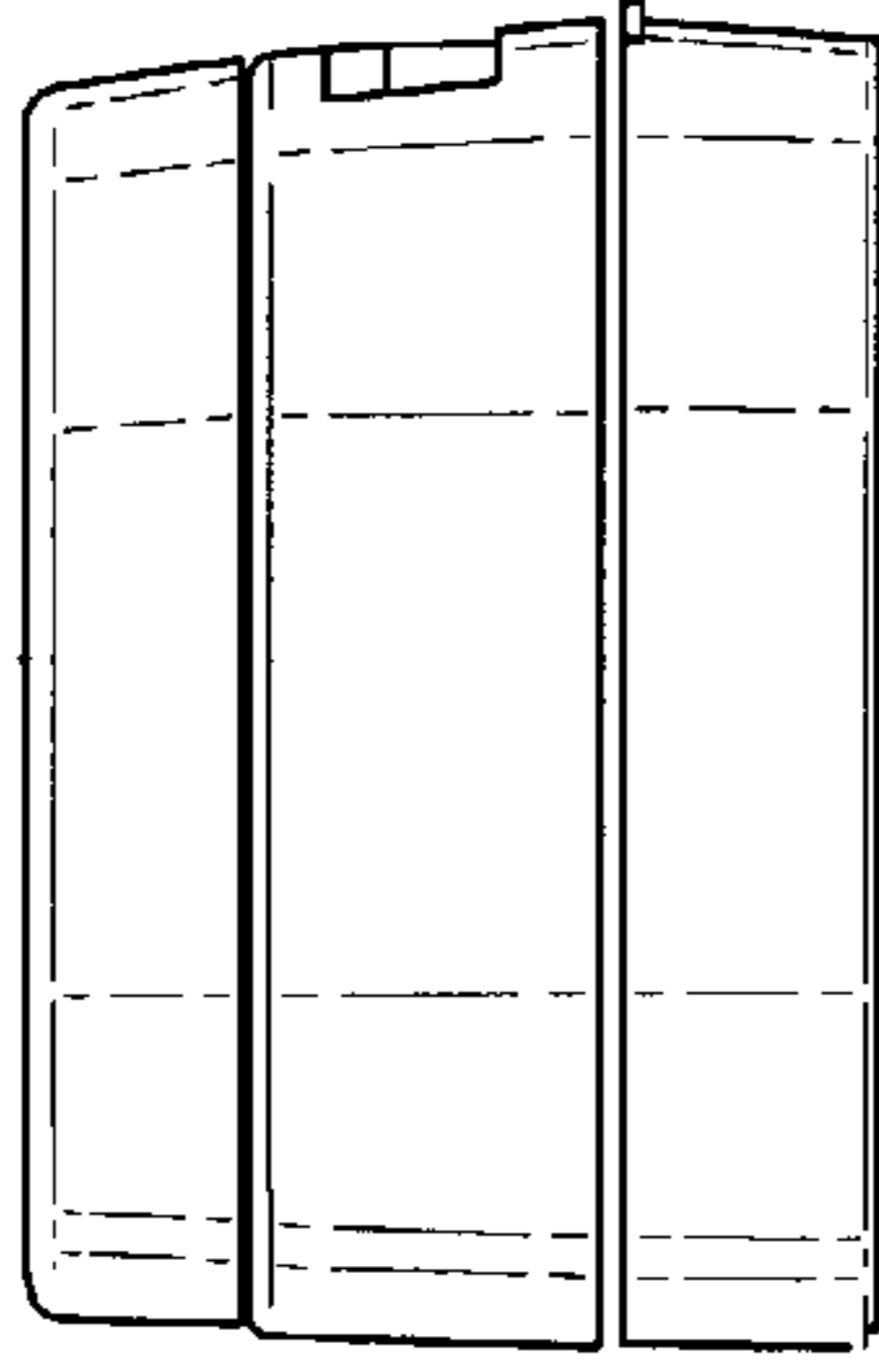

FIG-4

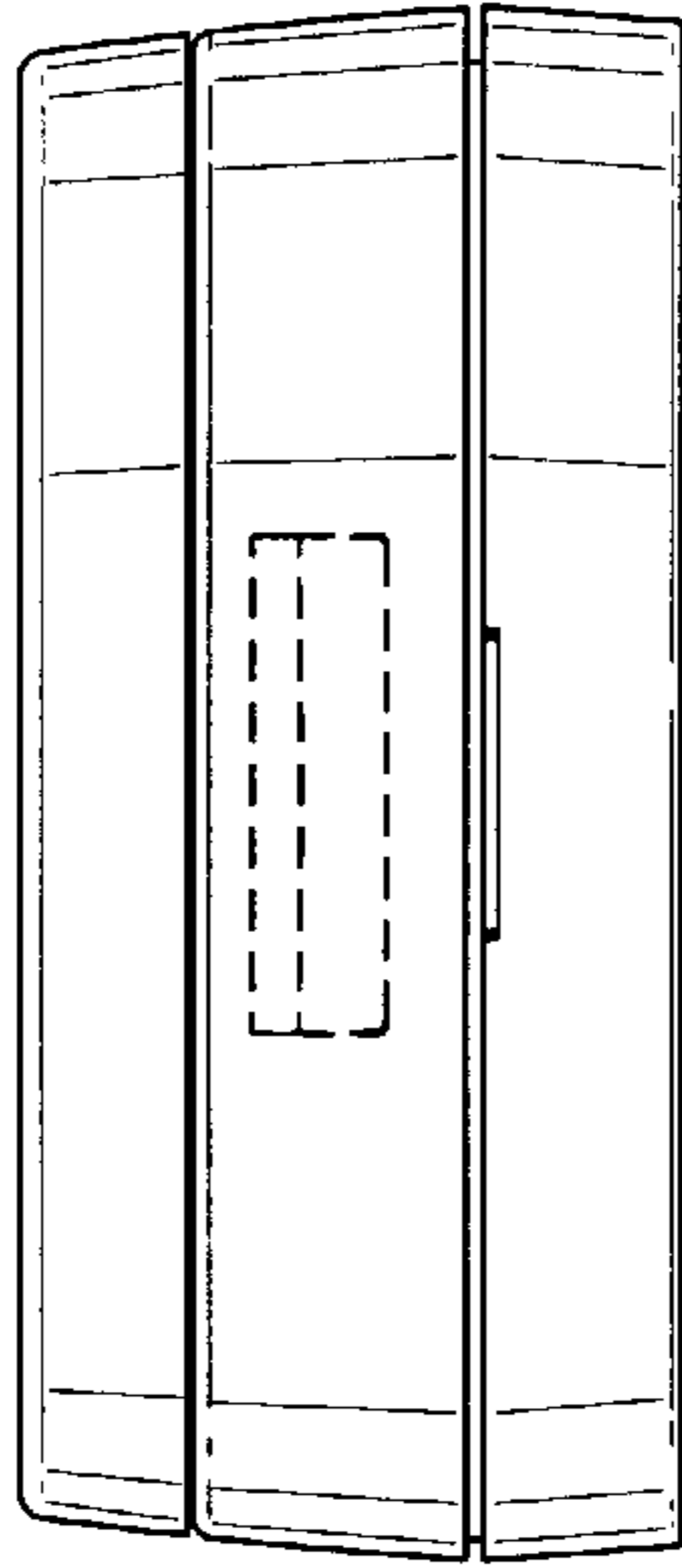

FIG-3

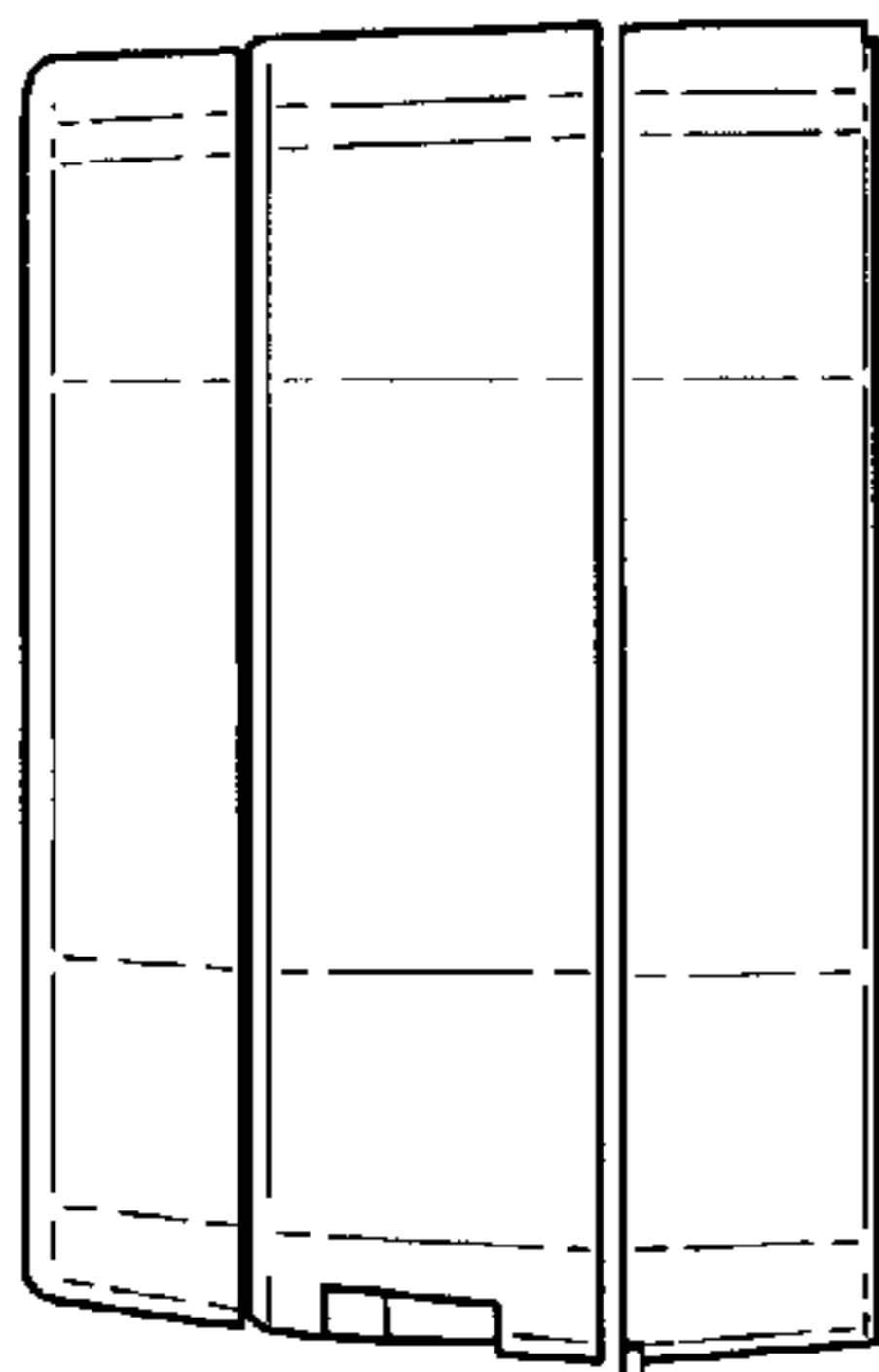

FIG-2