



US00D517859S

(12) **United States Design Patent**  
**Fung**

(10) **Patent No.:** **US D517,859 S**

(45) **Date of Patent:** **\*\* Mar. 28, 2006**

(54) **GRINDER**

(75) Inventor: **Shiu Po Fung**, New Territories (CN)

(73) Assignee: **Fatia Industrial Company Limited**,  
New Territories (CN)

(\*\*) Term: **14 Years**

(21) Appl. No.: **29/225,063**

(22) Filed: **Mar. 10, 2005**

(30) **Foreign Application Priority Data**

Oct. 11, 2004 (HK) ..... 0412277

(51) **LOC (8) Cl.** ..... **31-00**

(52) **U.S. Cl.** ..... **D7/372; D7/679**

(58) **Field of Classification Search** ..... D7/372-375,  
D7/381-384, 679; 99/279, 280, 286, 288,  
99/290, 292, 323.2; 241/56, 168, 169, 169.1,  
241/248, 259.1, 273.3, 277, 279, 280

See application file for complete search history.

(56) **References Cited**

**U.S. PATENT DOCUMENTS**

4,109,873 A \* 8/1978 Lichfield ..... 241/56

D269,489 S \* 6/1983 Akita ..... D7/372

D303,482 S \* 9/1989 Barrault ..... D7/381

5,562,256 A \* 10/1996 Wolman et al. .... 241/169.1

D455,324 S \* 4/2002 Wright ..... D7/679

\* cited by examiner

*Primary Examiner*—Terry A. Wallace

(74) *Attorney, Agent, or Firm*—Alix, Yale & Ristas, LLP

(57) **CLAIM**

The ornamental design for a grinder, as shown and described.

**DESCRIPTION**

FIG. 1 is a front perspective view of the grinder showing my new design;

FIG. 2 is a front view of the grinder of FIG. 1;

FIG. 3 is a left side view of the grinder of FIG. 1;

FIG. 4 is a top plan view of the grinder of FIG. 1;

FIG. 5 is a right side view of the grinder of FIG. 1;

FIG. 6 is a rear view of the grinder of FIG. 1;

FIG. 7 is a bottom plan view of the grinder of FIG. 1; and,

FIG. 8 is a front perspective view of the grinder of FIG. 1, with the cover separated from the body.

**1 Claim, 4 Drawing Sheets**

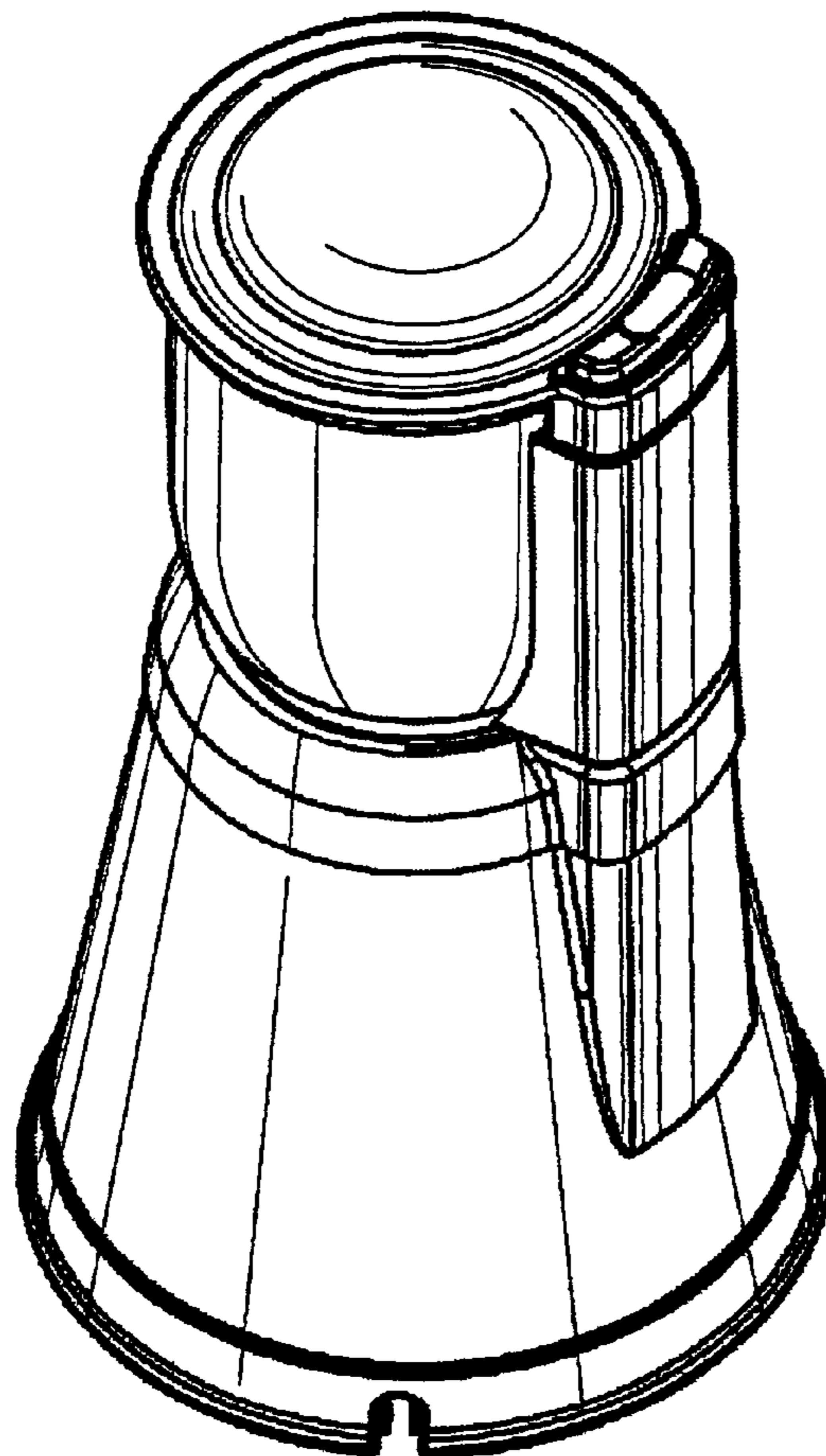

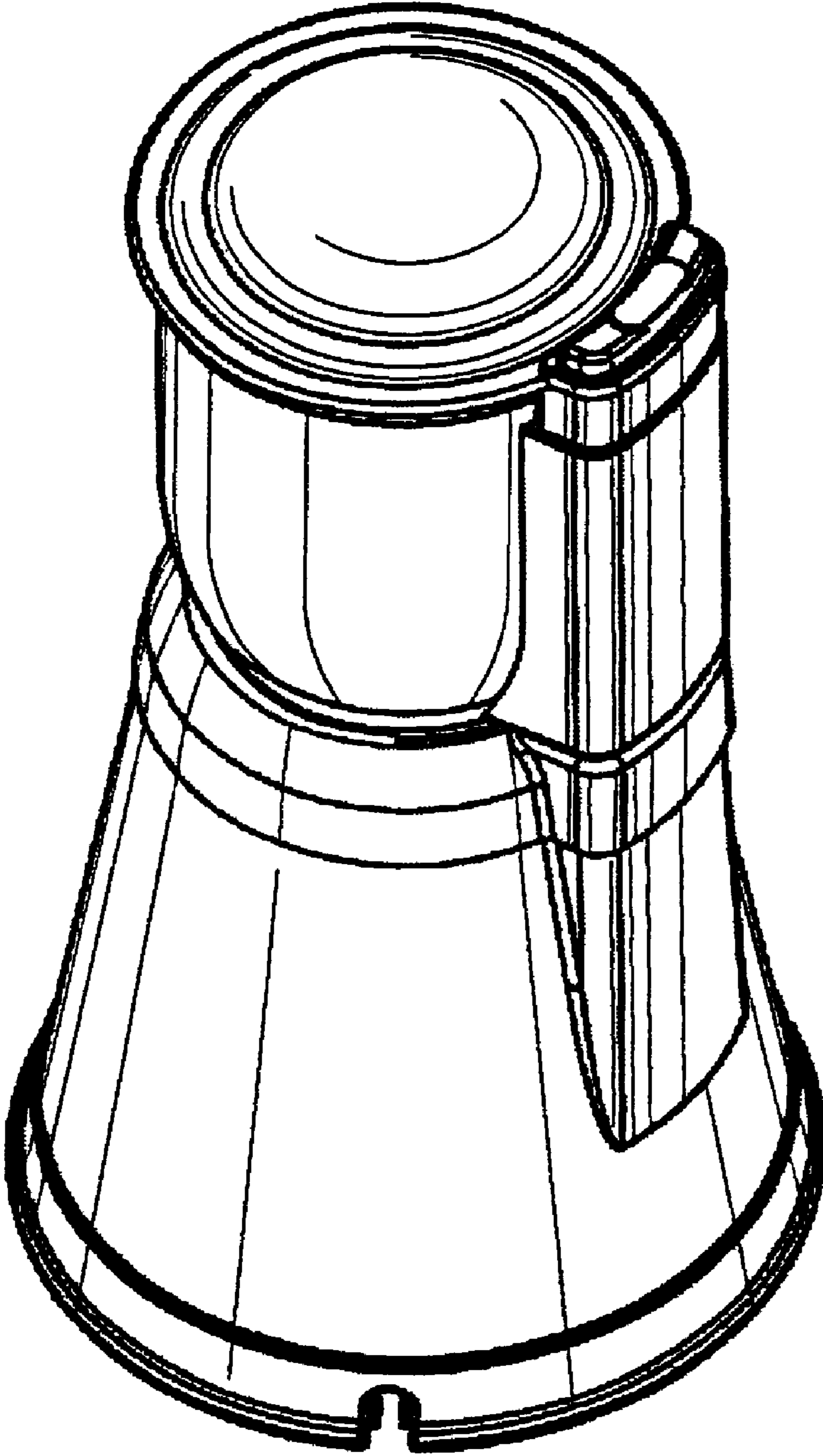

FIG. 1

FIG. 4

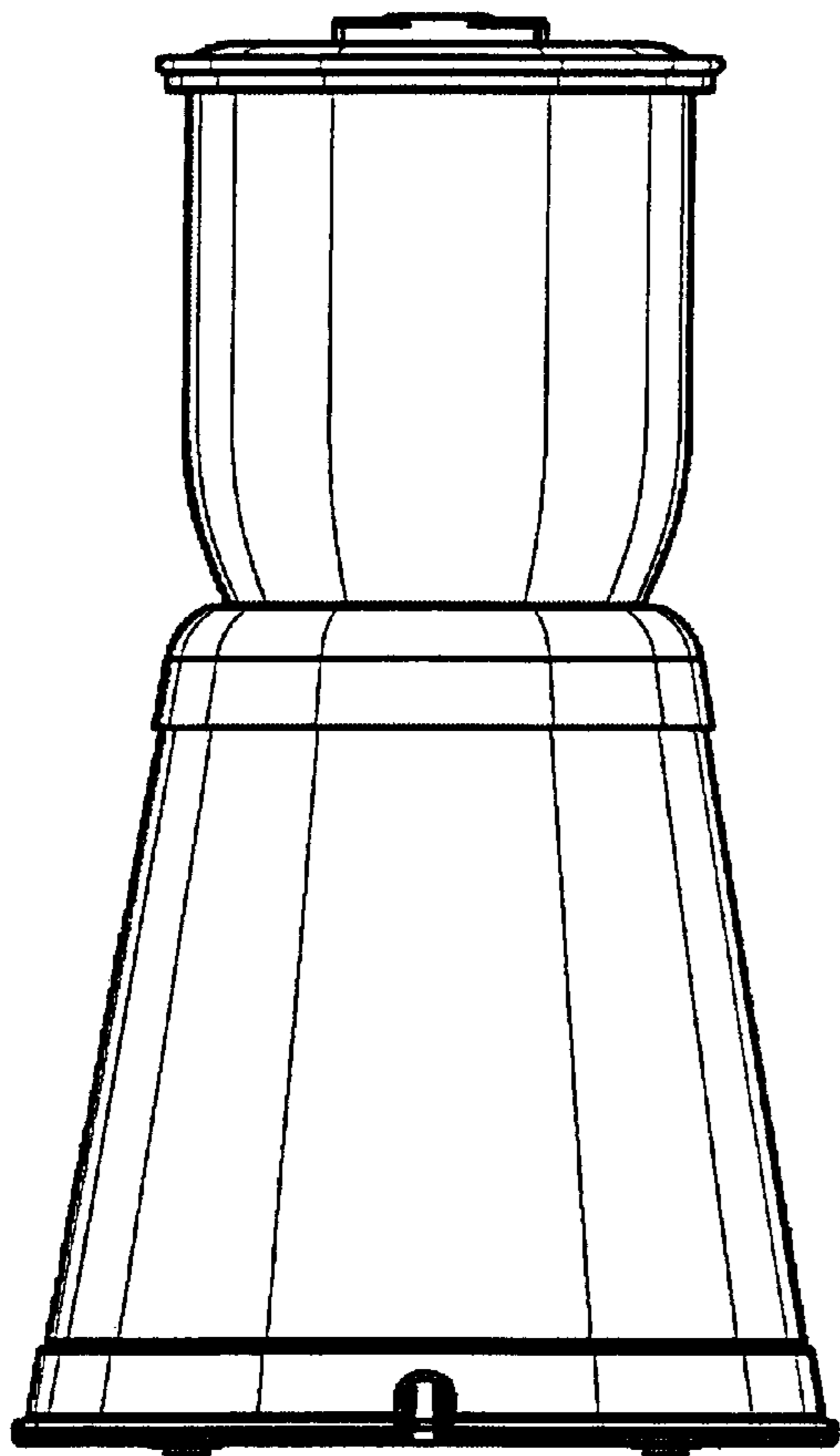
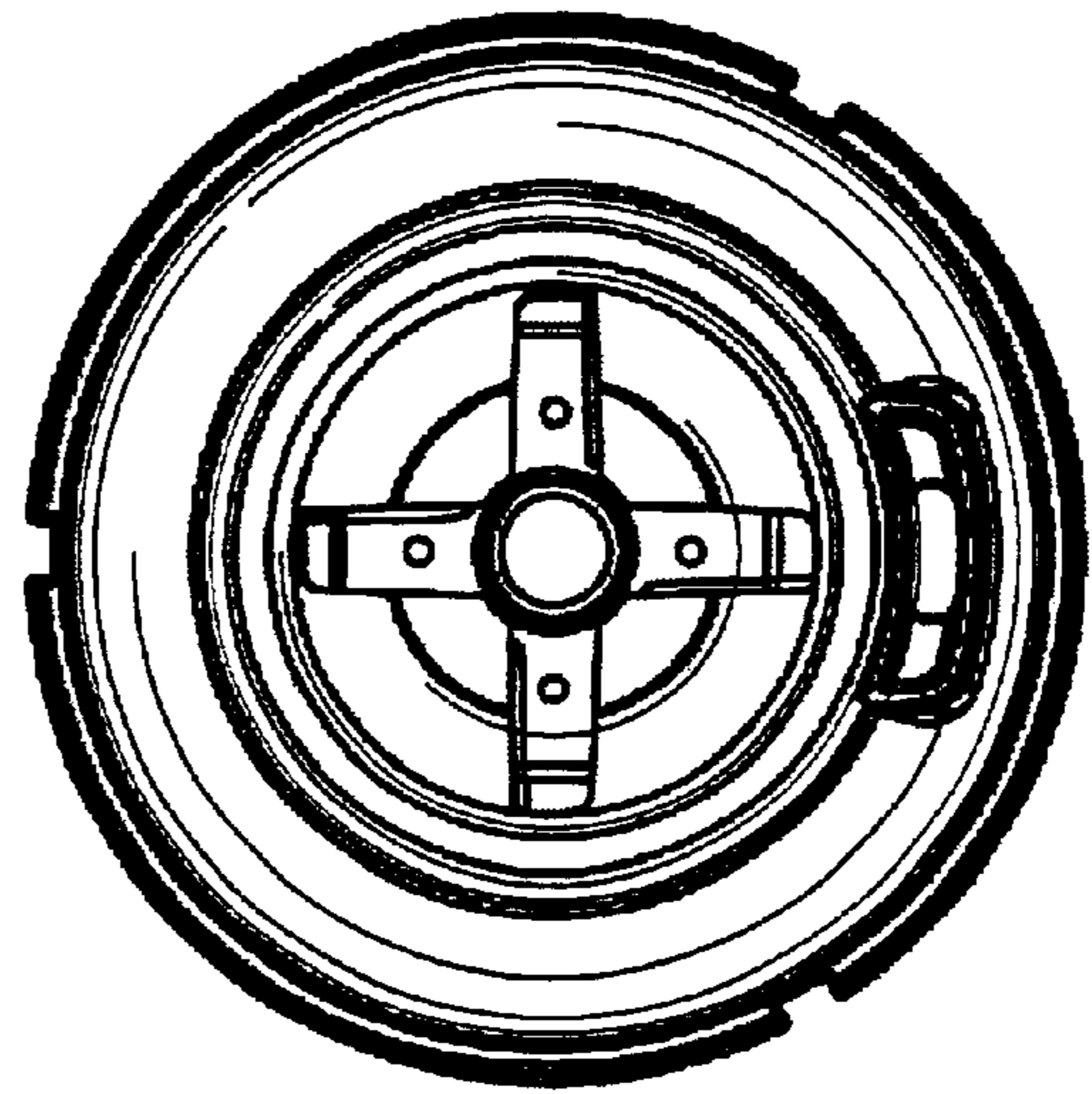

FIG. 3

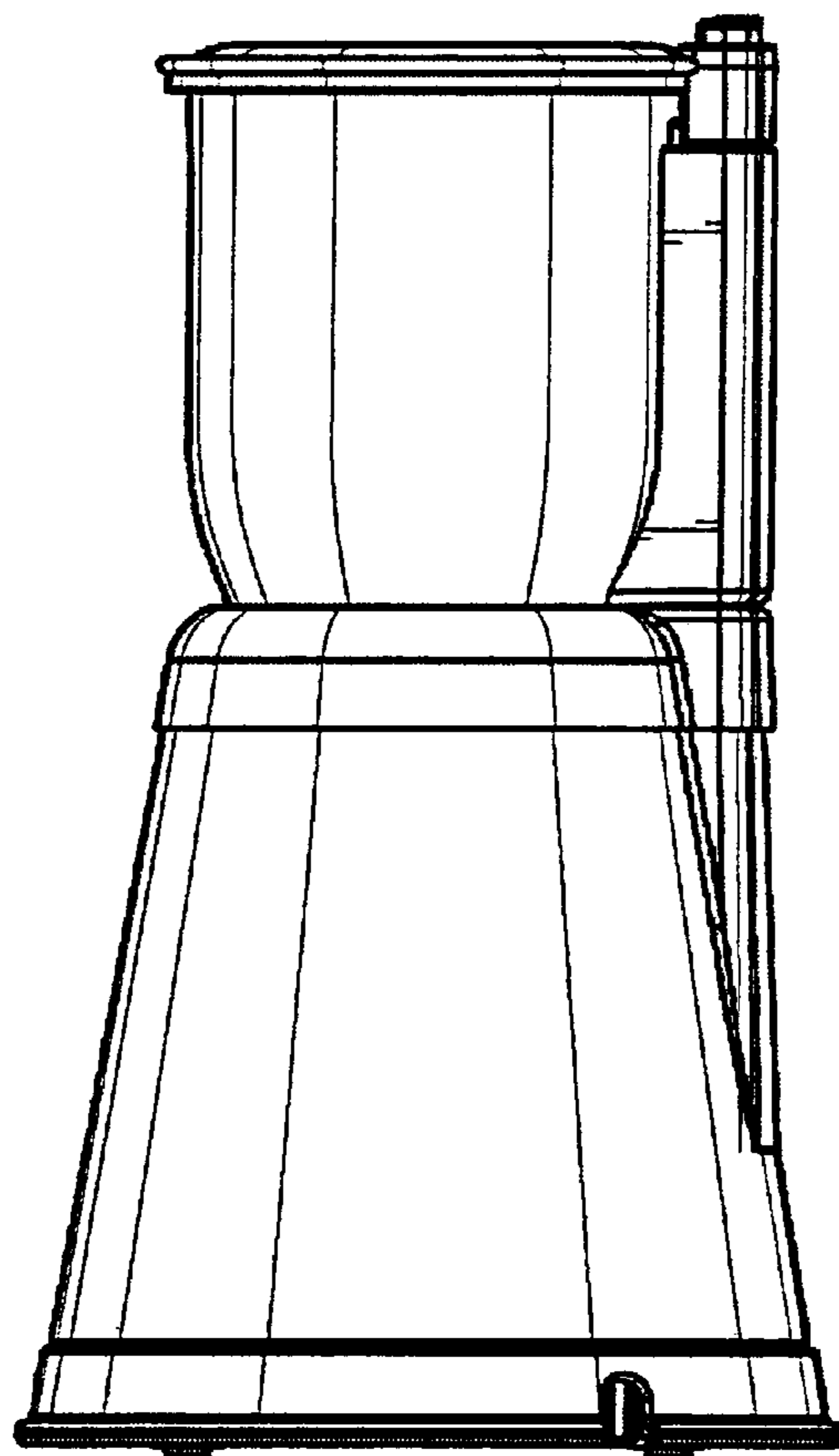

FIG. 2

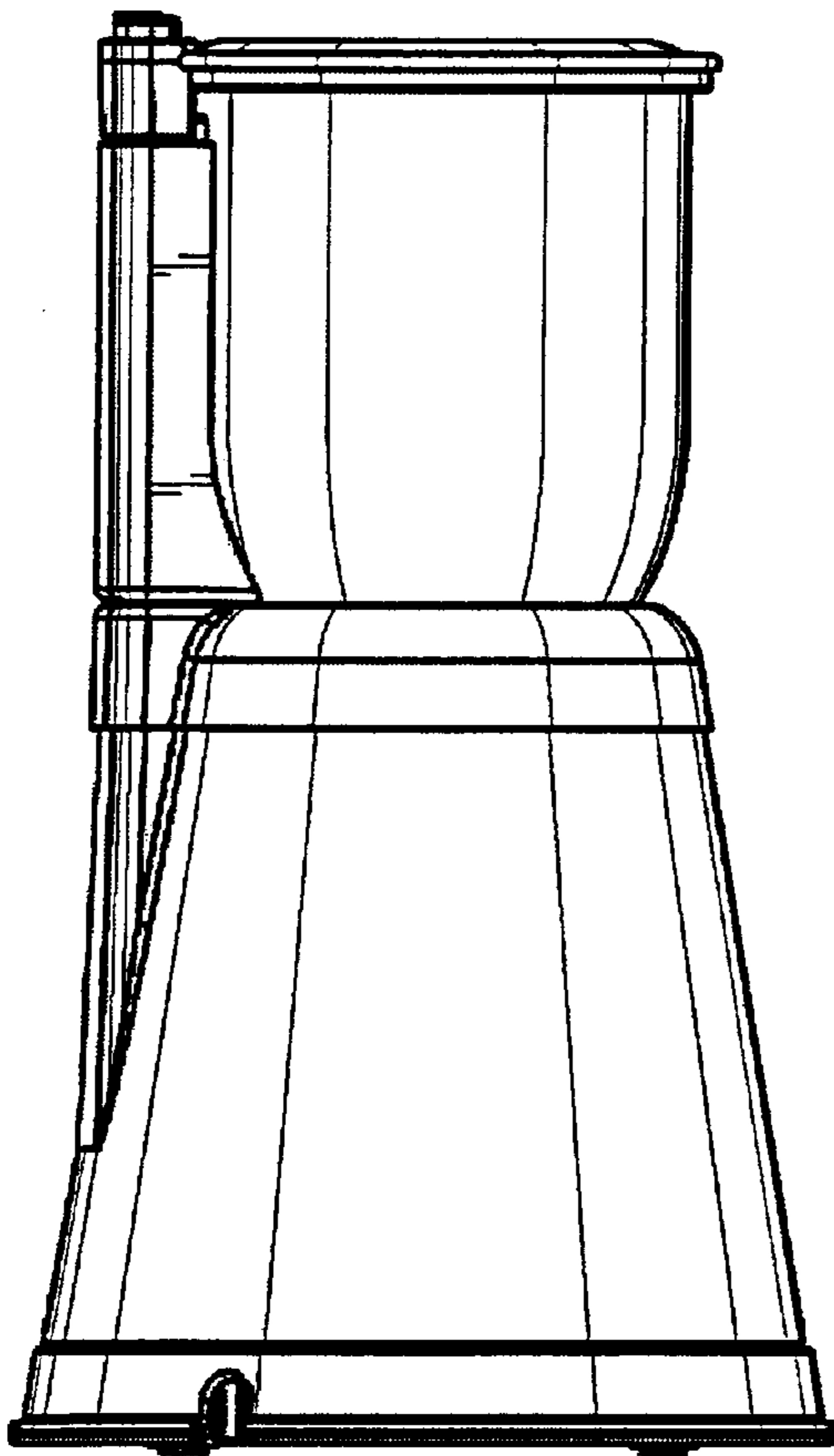

FIG. 6

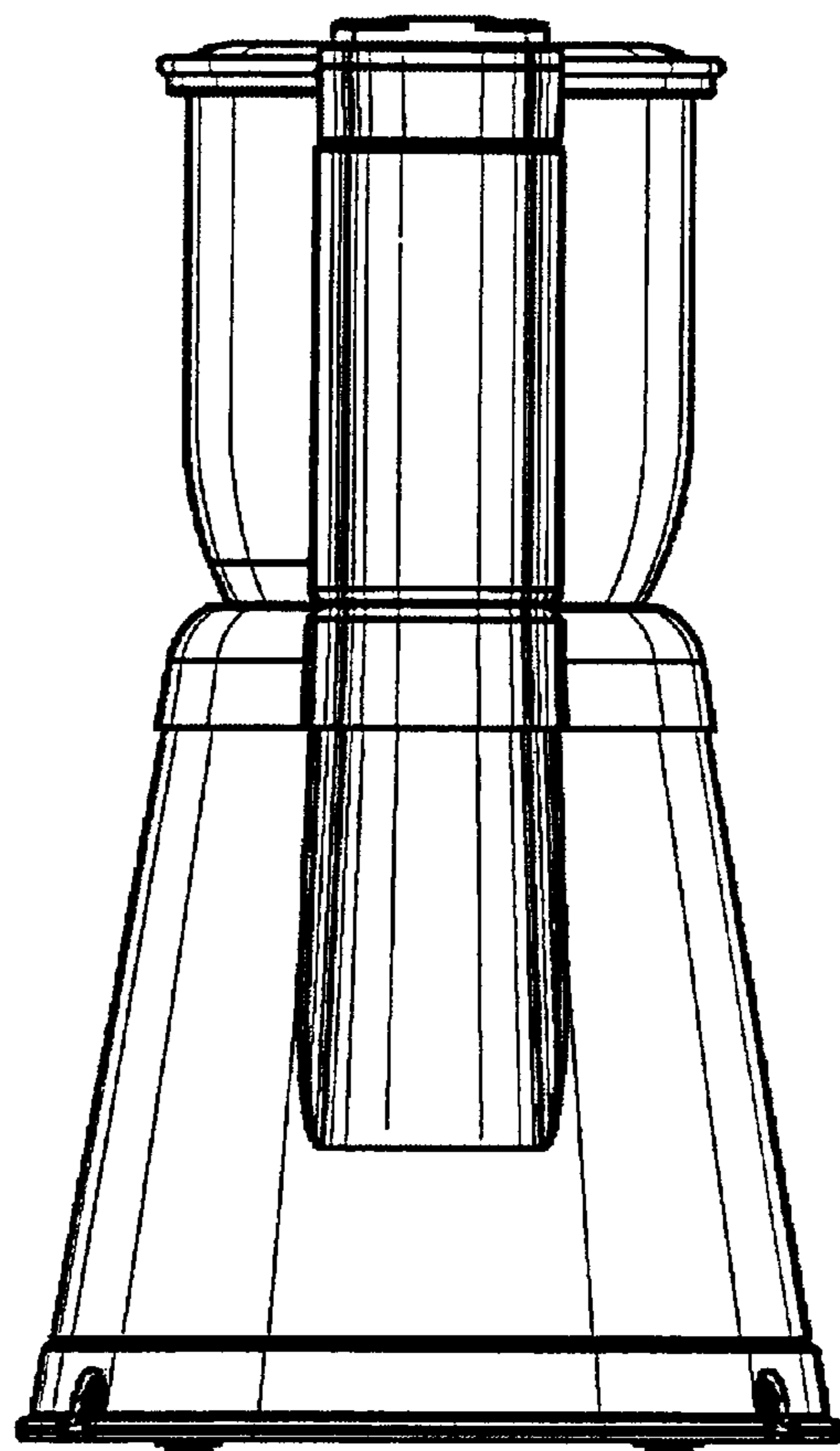

FIG. 5

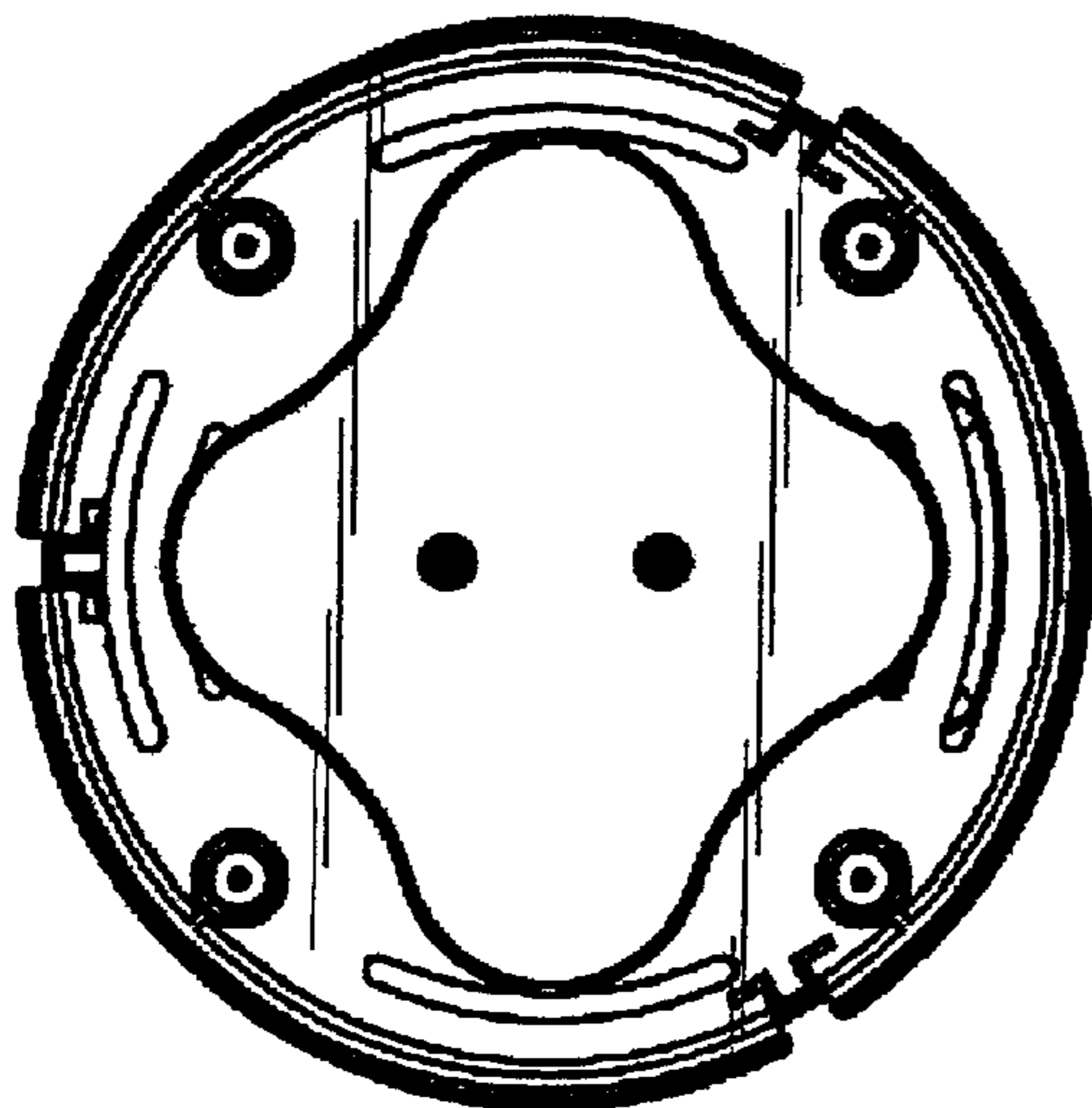

FIG. 7

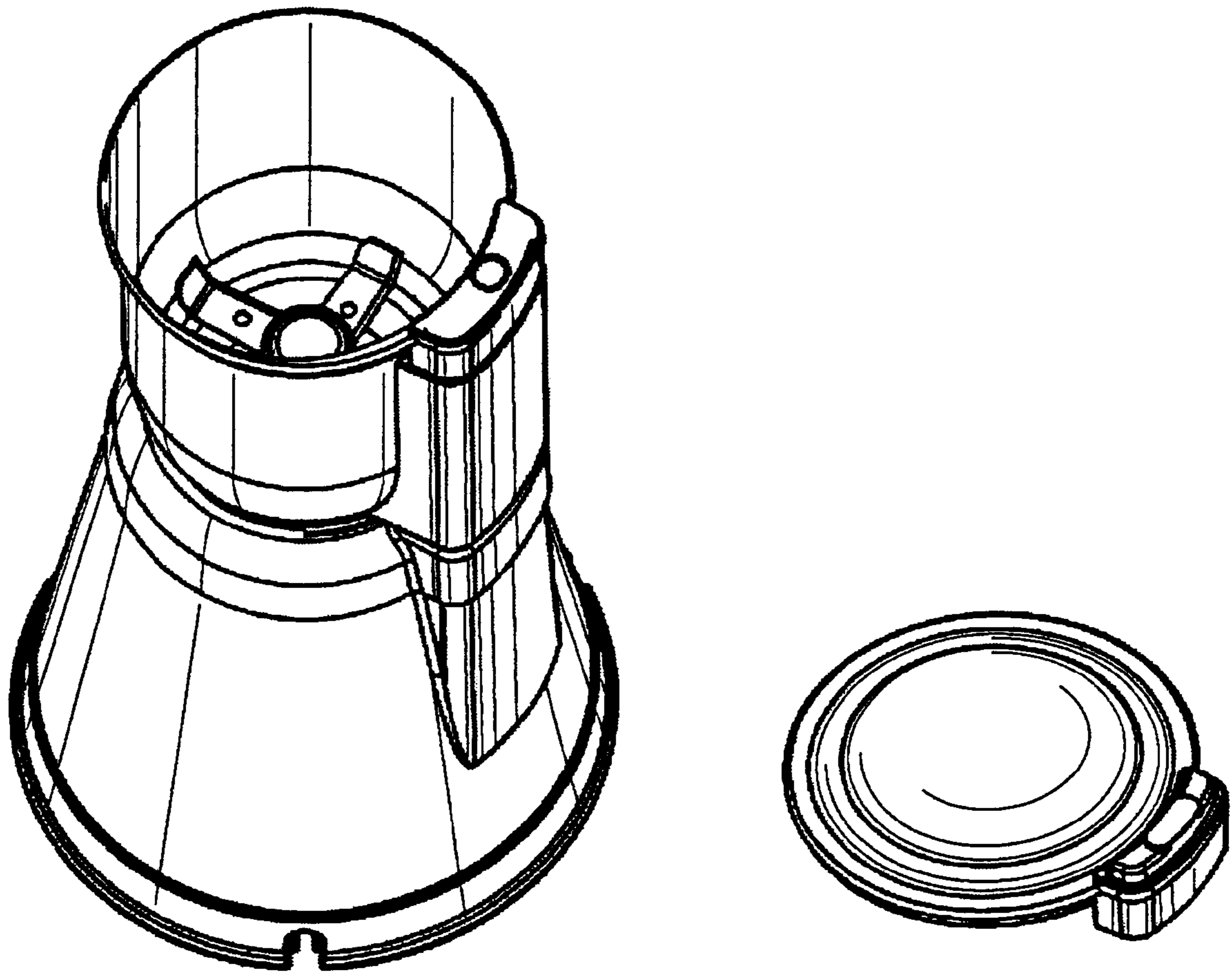

FIG. 8