



US00D517105S

(12) **United States Design Patent**
Negishi

(10) **Patent No.:** **US D517,105 S**
(45) **Date of Patent:** **** Mar. 14, 2006**

(54) **ACTUATOR FOR ADJUSTING POSITION OF VEHICLE PEDAL**

6,882,124 B1 * 4/2005 Waite 318/551

* cited by examiner

(75) Inventor: **Toshihiro Negishi, Yokohama (JP)**

Primary Examiner—Antoine D. Davis

(73) Assignee: **Jidosha Denki Kogyo Co., Ltd., Yokohama (JP)**

(74) *Attorney, Agent, or Firm*—Sughrue Mion, PLLC

(**) Term: **14 Years**

(57) **CLAIM**

The ornamental design for an actuator for adjusting position of vehicle pedal, as shown.

(21) Appl. No.: **29/203,663**

DESCRIPTION

(22) Filed: **Apr. 19, 2004**

(30) **Foreign Application Priority Data**

Dec. 12, 2003 (JP) 2003-039028

FIG. 1 is a perspective view of the top, front and right side of an actuator for adjusting position of vehicle pedal showing my new design;

(51) **LOC (8) Cl.** **15-99**

(52) **U.S. Cl.** **D15/199**

FIG. 2 is a perspective view of the bottom, rear and left side thereof;

(58) **Field of Classification Search** D15/199;

74/513, 560; 318/550, 551

See application file for complete search history.

FIG. 3 is a front elevational view thereof;

FIG. 4 is a rear elevational view thereof;

FIG. 5 is a left side elevational view thereof;

FIG. 6 is a right side elevational view thereof;

FIG. 7 is a top plan view thereof; and,

FIG. 8 is a bottom plan view thereof.

(56) **References Cited**

U.S. PATENT DOCUMENTS

6,566,831 B1 * 5/2003 Waite 318/551

1 Claim, 4 Drawing Sheets

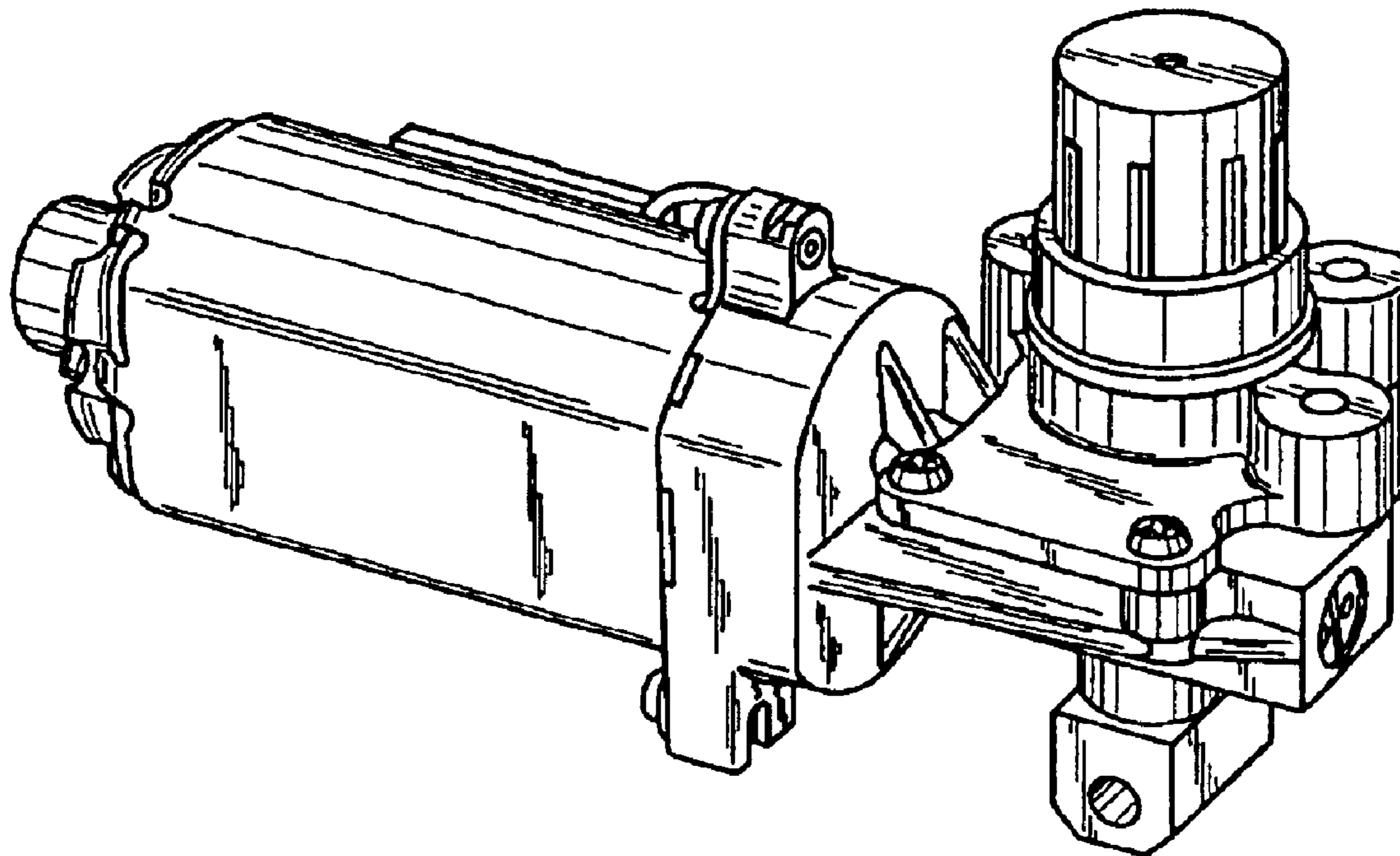

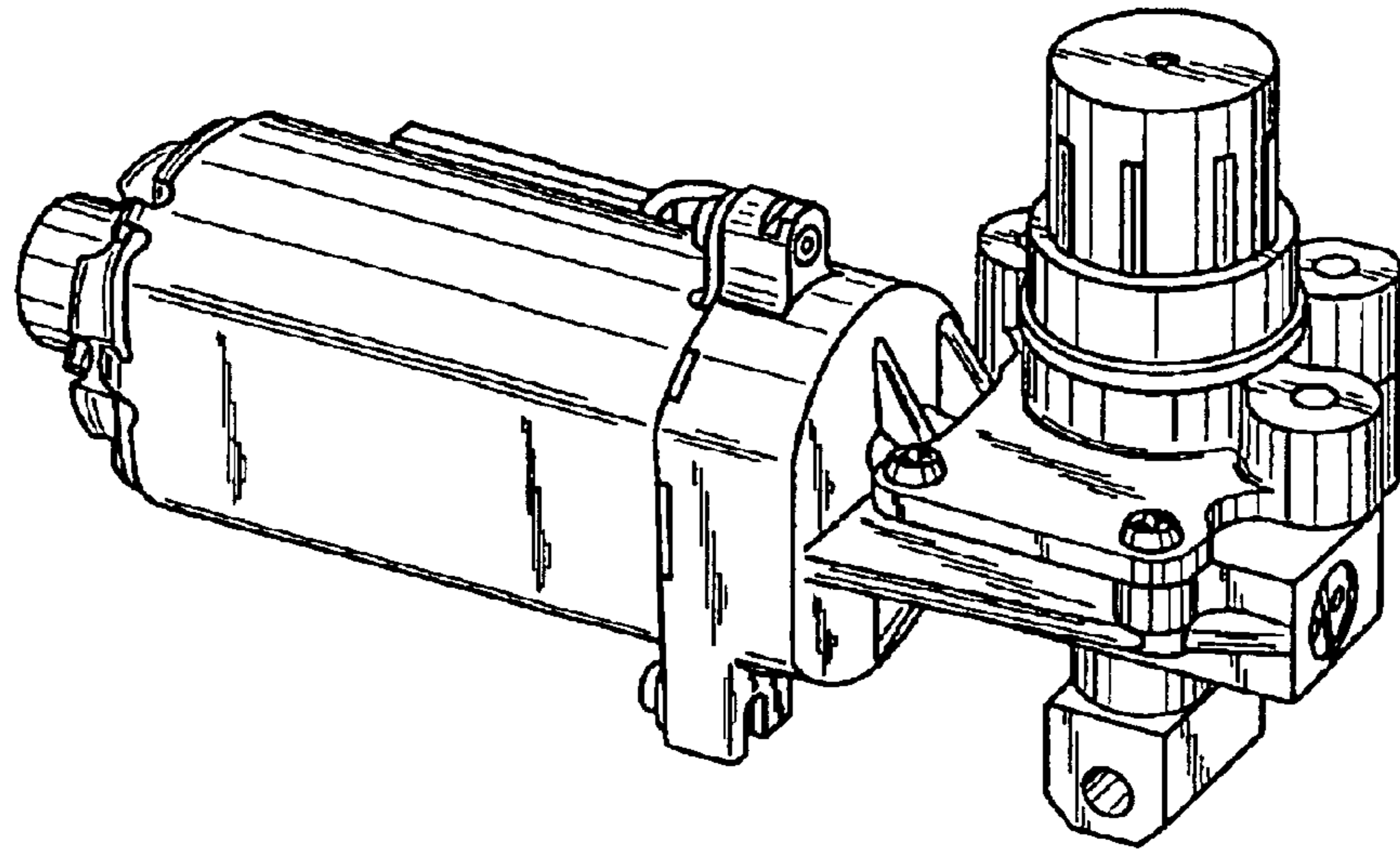

Fig. 1

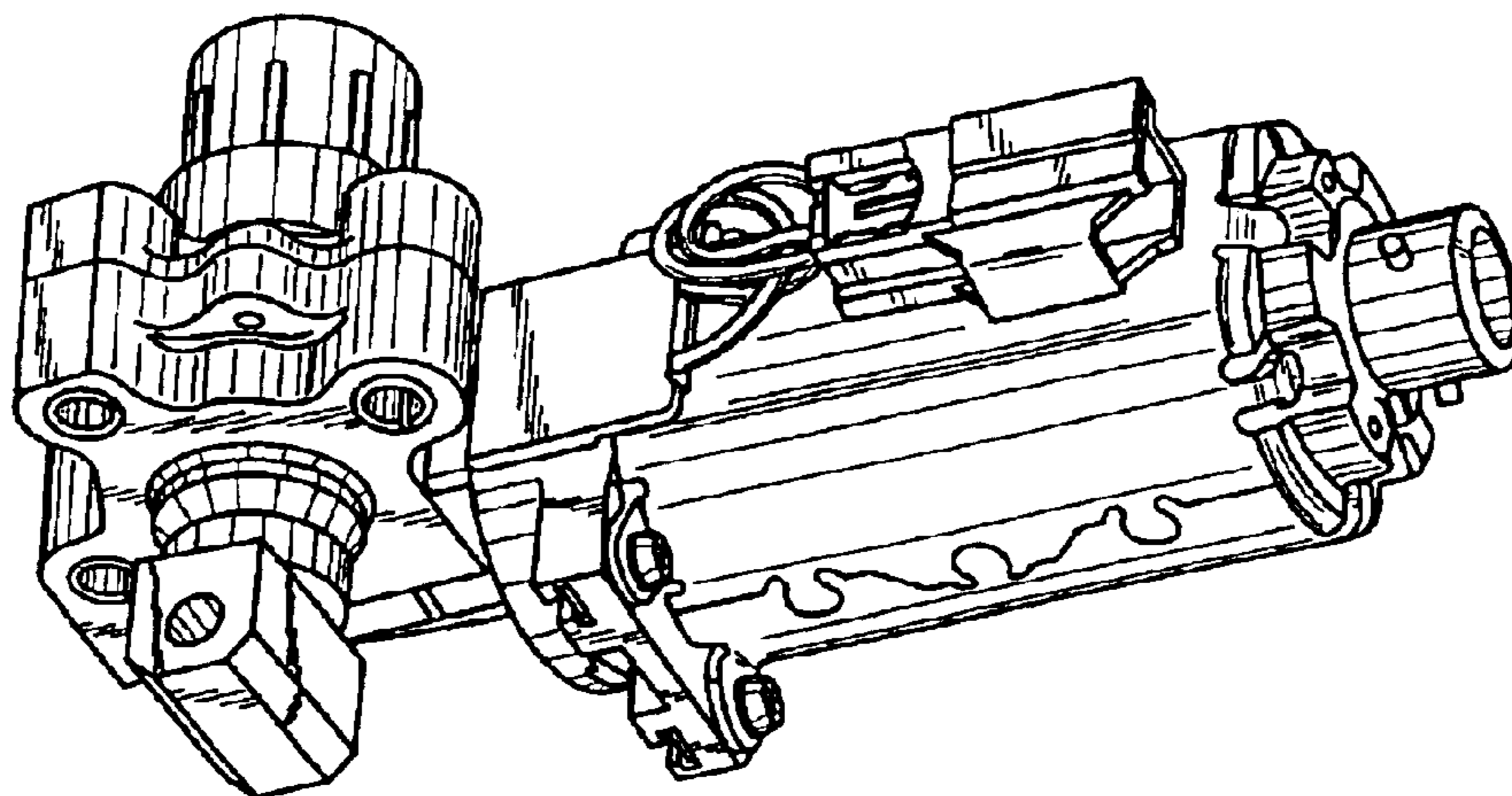

Fig. 2

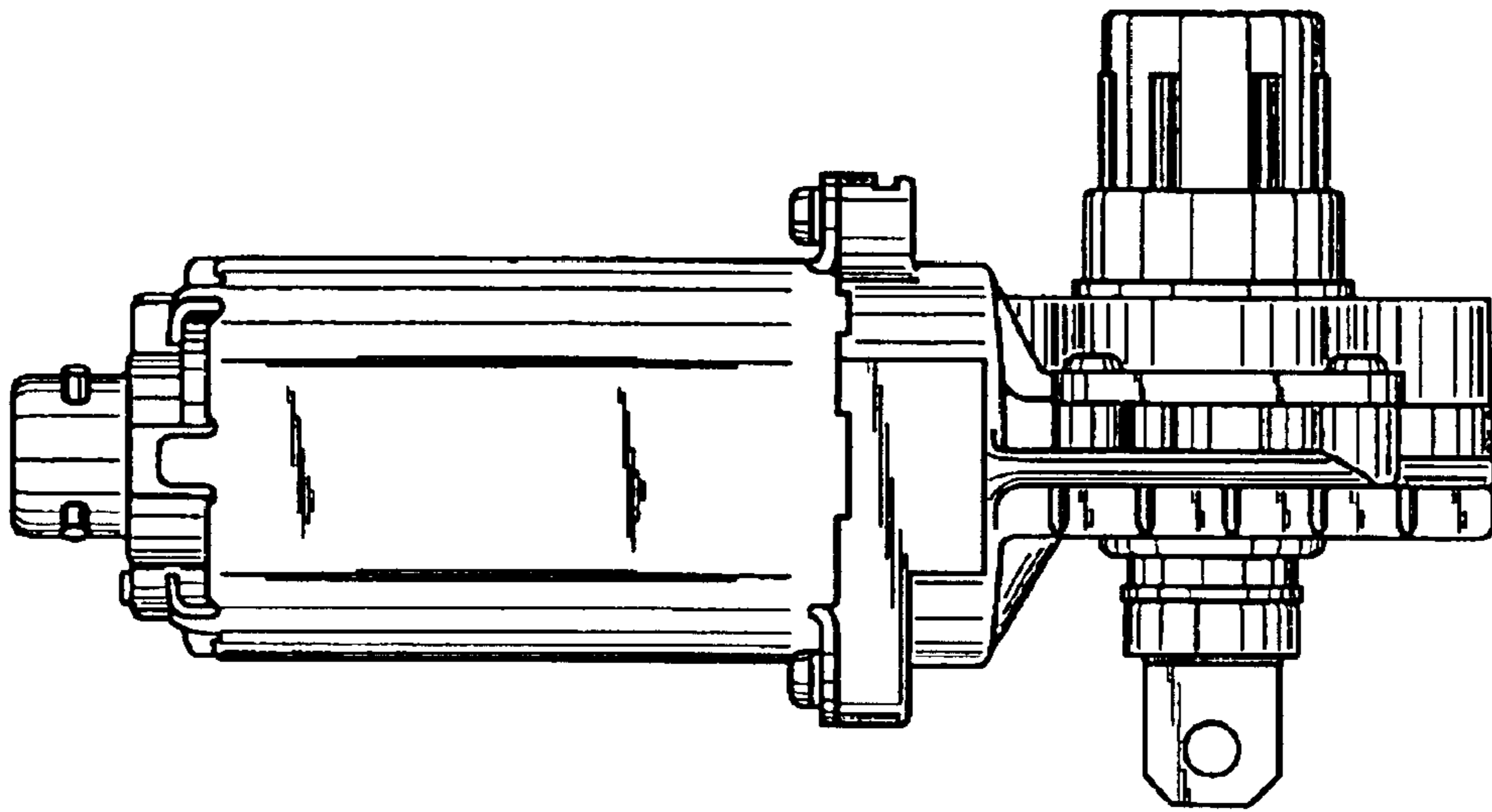

Fig. 3

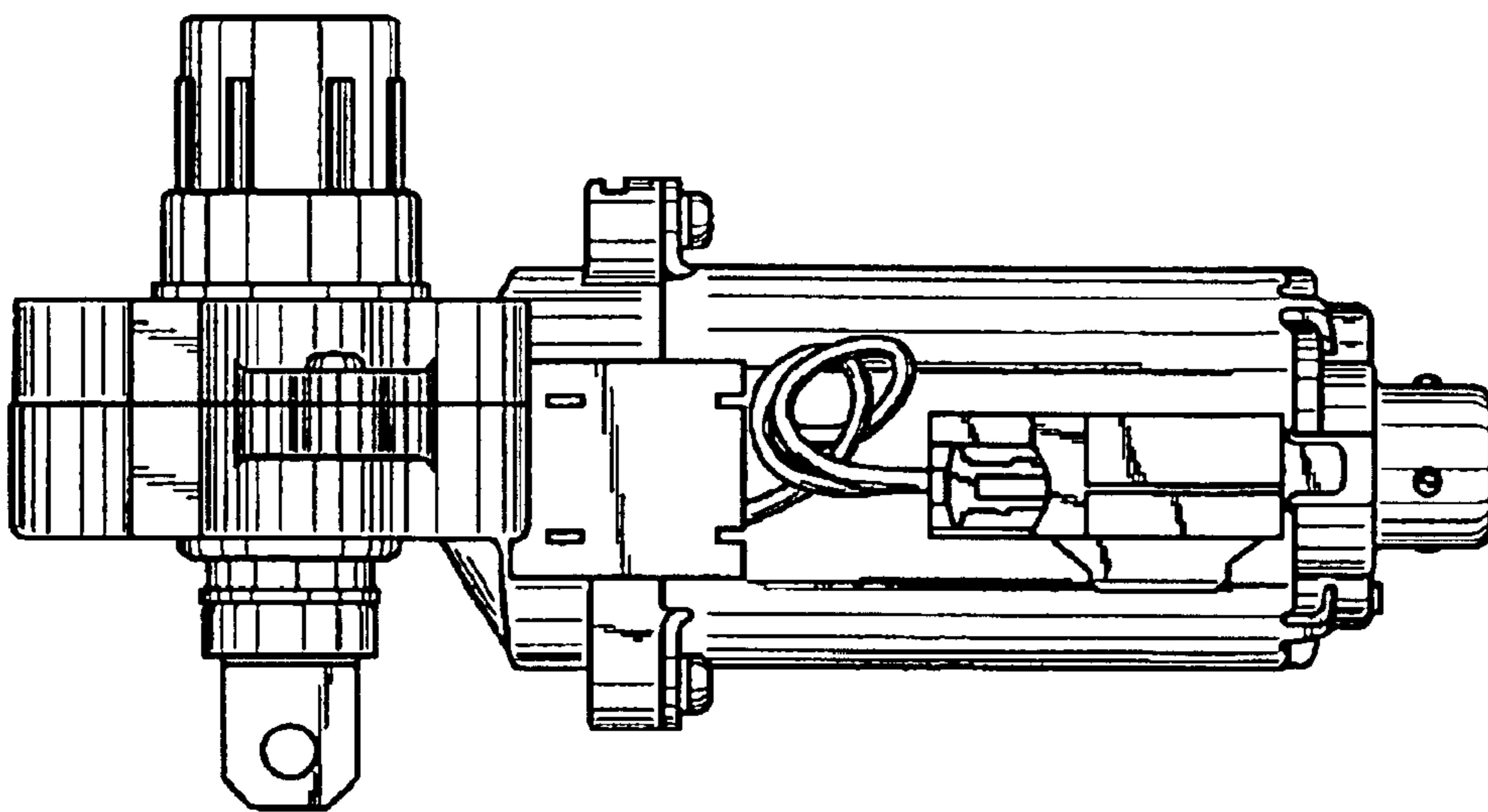

Fig. 4

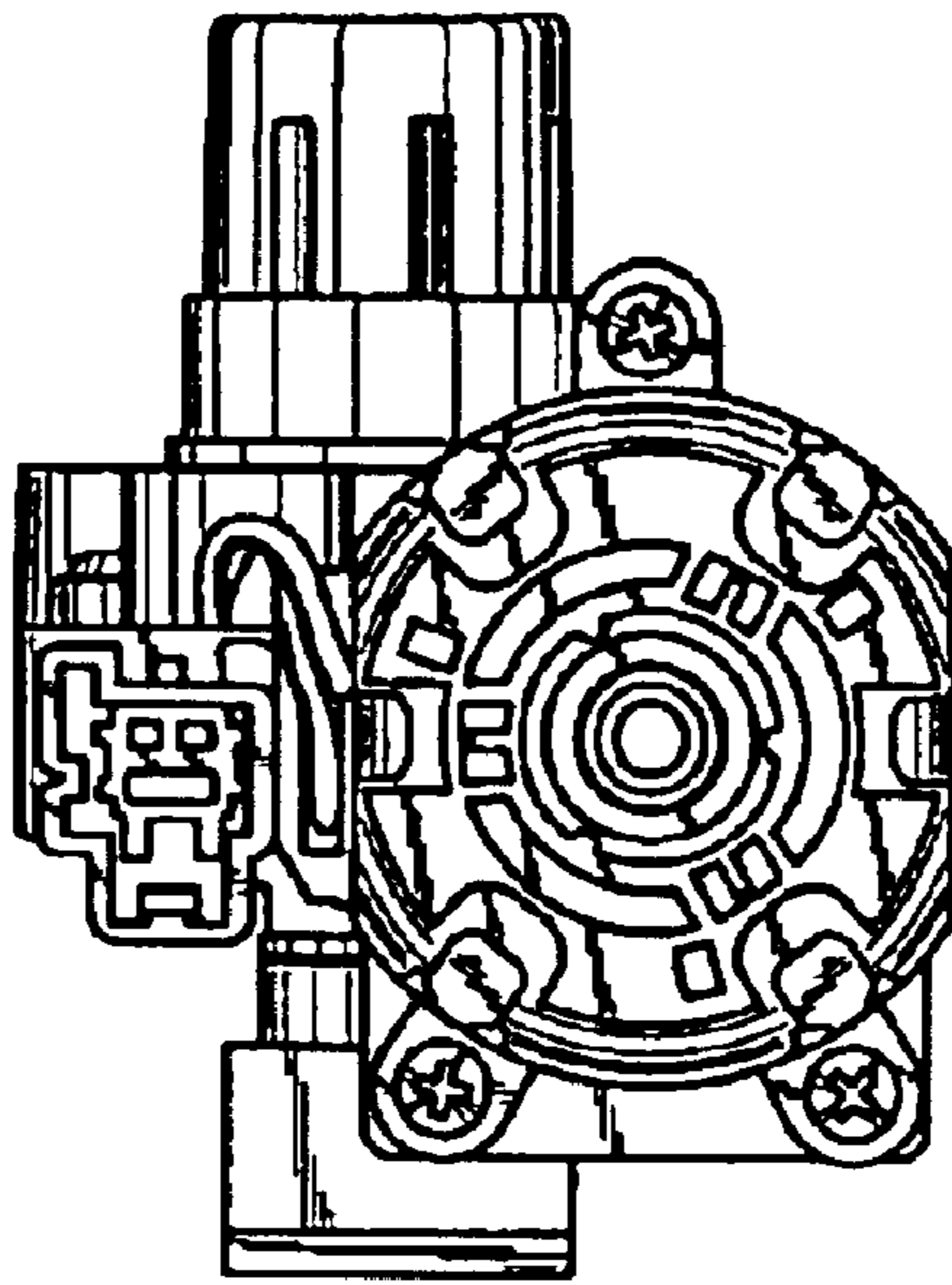

Fig. 5

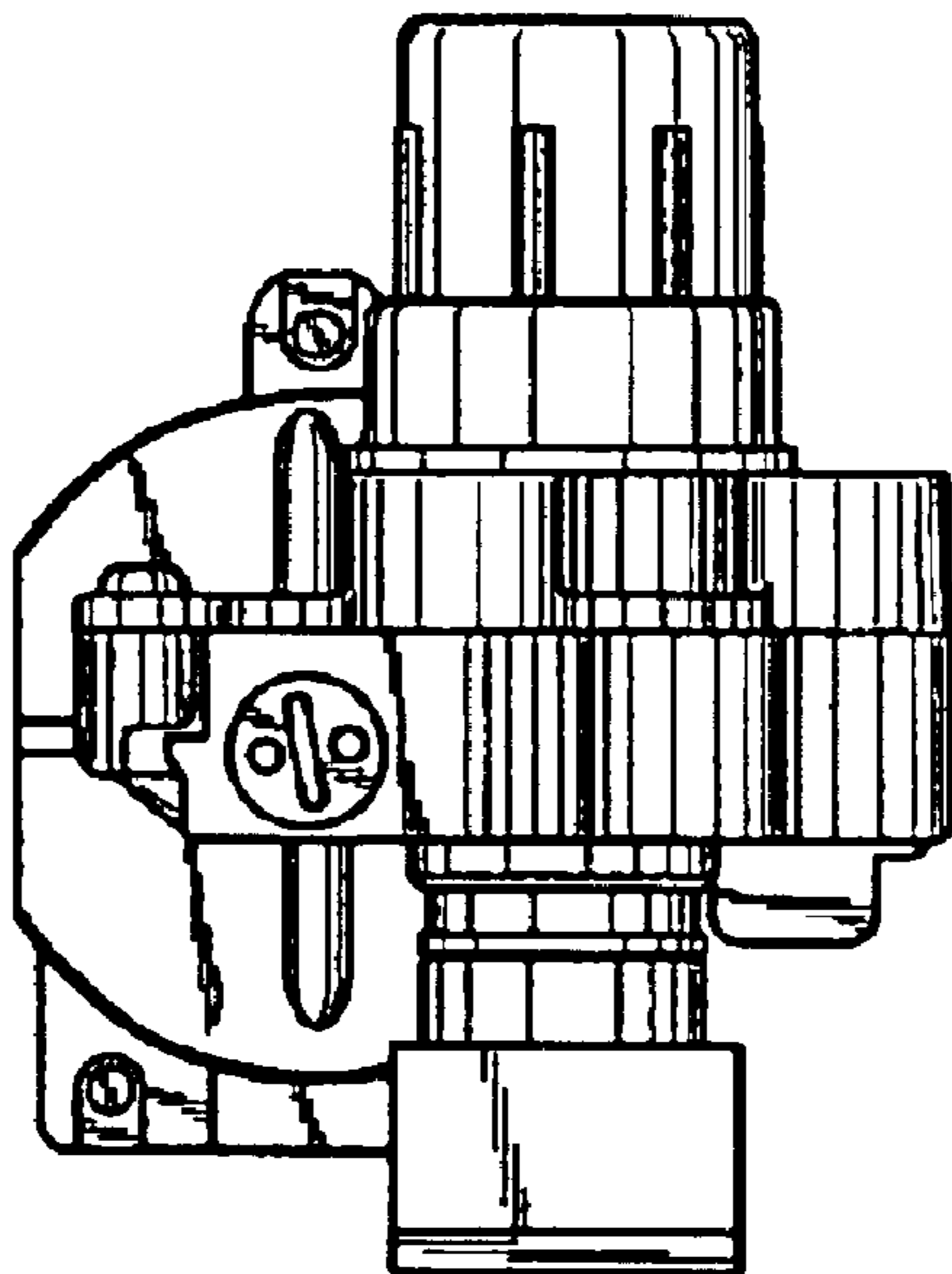

Fig. 6

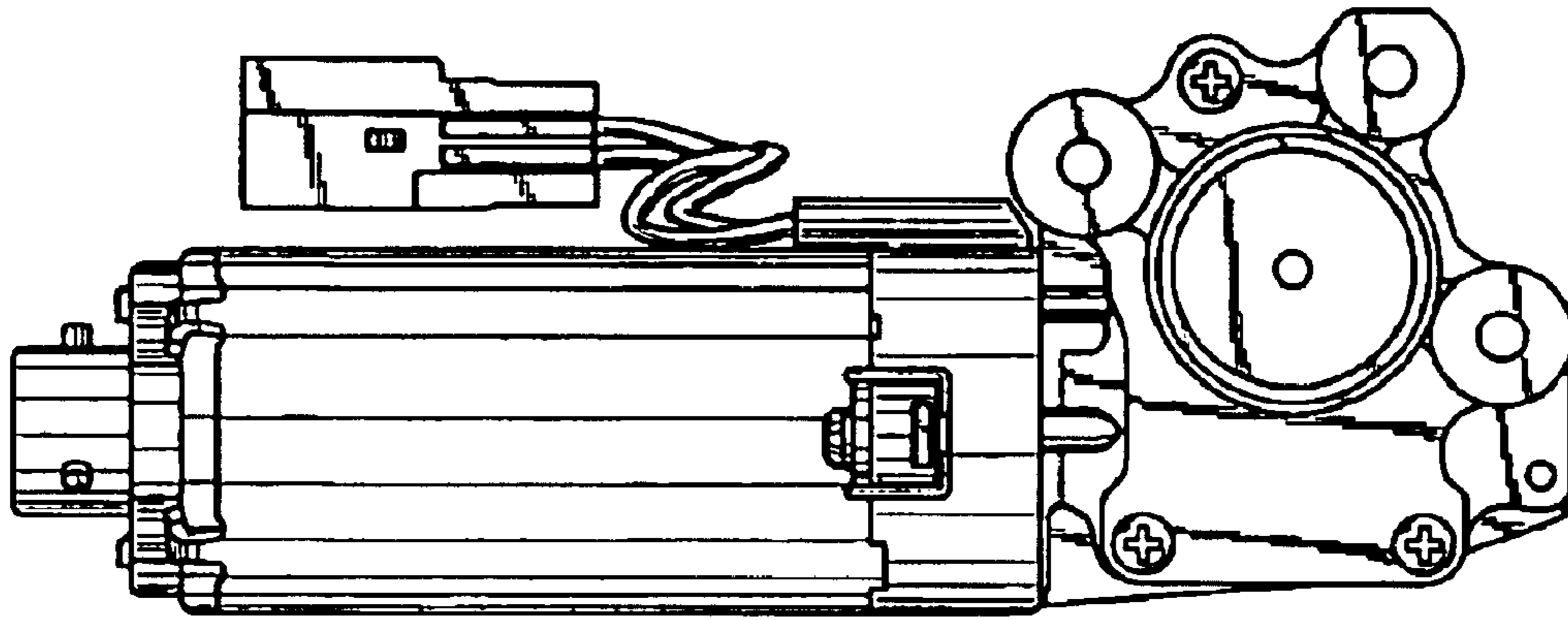

Fig. 7

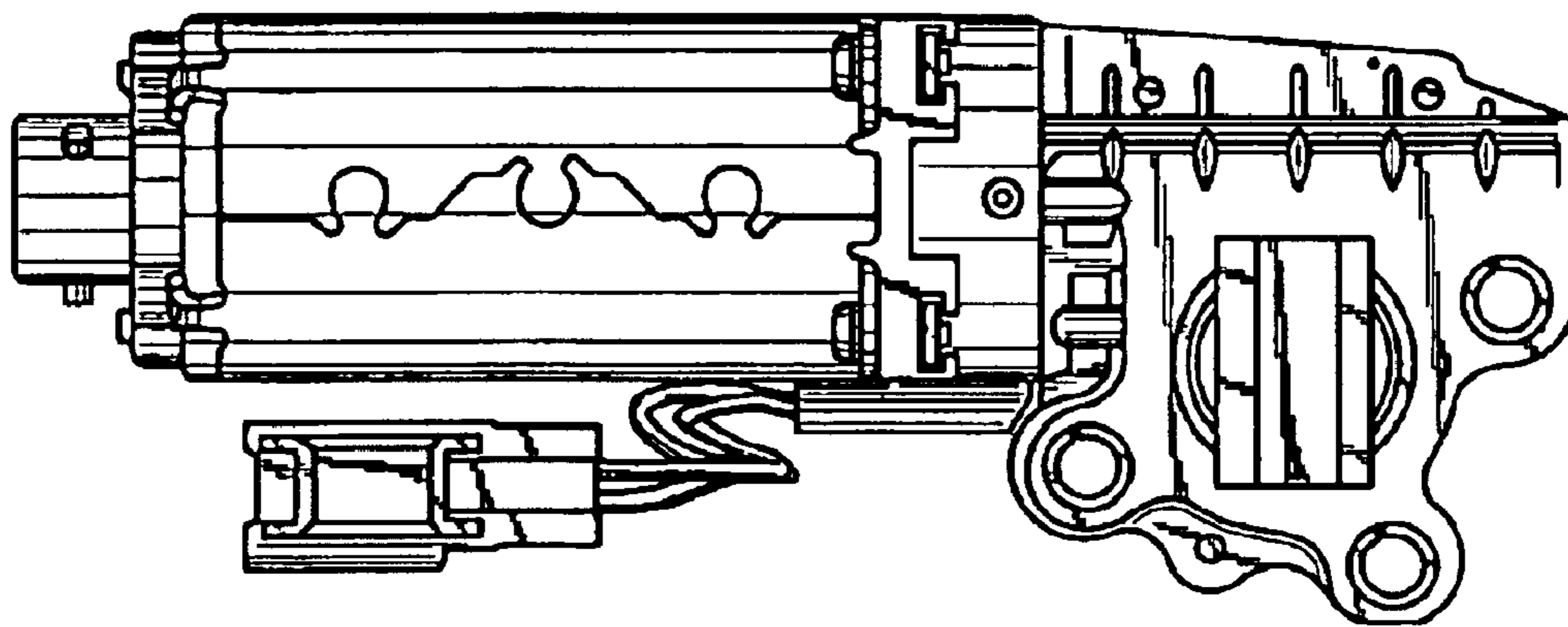

Fig. 8