



US00D516573S

(12) **United States Design Patent**
Gibson

(10) **Patent No.:** **US D516,573 S**
(45) **Date of Patent:** **** Mar. 7, 2006**

- (54) **ICON FOR A DISPLAY SCREEN**
- (75) **Inventor:** **Mark R. Gibson**, Seattle, WA (US)
- (73) **Assignee:** **Microsoft Corporation**, Redmond, WA (US)
- (**) **Term:** **14 Years**

D478,090 S	*	8/2003	Nguyen et al.	D14/486
D479,720 S		9/2003	Ohashi et al.		
D490,438 S	*	5/2004	Greminger	D14/485
2002/0075323 A1	*	6/2002	O'Dell	345/835
2004/0155906 A1	*	8/2004	Sekiguchi et al.	345/781
2004/0221244 A1	*	11/2004	Baldino	715/835
2004/0233238 A1	*	11/2004	Lahdesmaki	345/810

* cited by examiner

- (21) **Appl. No.:** **29/211,270**
- (22) **Filed:** **Aug. 13, 2004**

Primary Examiner—M. H. Tung
(74) *Attorney, Agent, or Firm*—Banner & Witcoff, Ltd.

- (51) **LOC (8) Cl.** **14-04**
- (52) **U.S. Cl.** **D14/488**
- (58) **Field of Classification Search** D14/485-95;
D18/24-33; D19/6; D20/11; D21/324-33;
715/700-866

(57) **CLAIM**

The ornamental design for a icon for a display screen, as shown and described.

See application file for complete search history.

DESCRIPTION

The FIGURE is a front view of a icon for a display screen showing my new design.

(56) **References Cited**
U.S. PATENT DOCUMENTS

The areas within the four squares defined by broken lines are not part of the claimed design. The broken line drawing of a square immediately surrounding the solid line disclosure is not part of the claimed design. The broken line drawing of a display screen is for illustrative purposes only and forms no part of the claimed design.

D321,904 S	11/1991	Thomas	
D392,266 S	3/1998	Snyder et al.	
D400,519 S	11/1998	Marshall, Jr. et al.	
D401,230 S	11/1998	Marshall, Jr. et al.	
D470,857 S	*	2/2003	Anderson et al. D14/485
D474,778 S	*	5/2003	Barnes D14/486

1 Claim, 1 Drawing Sheet

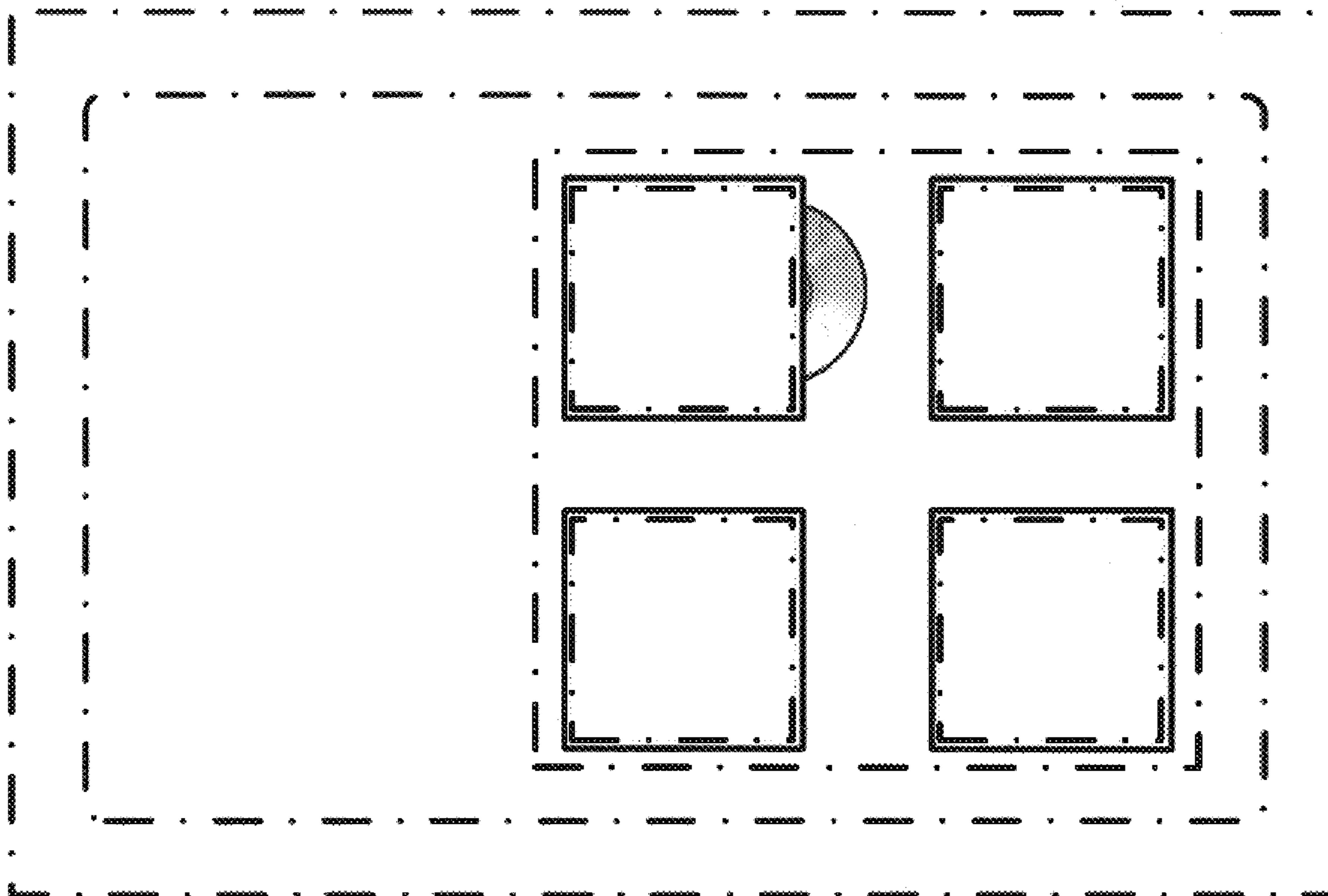

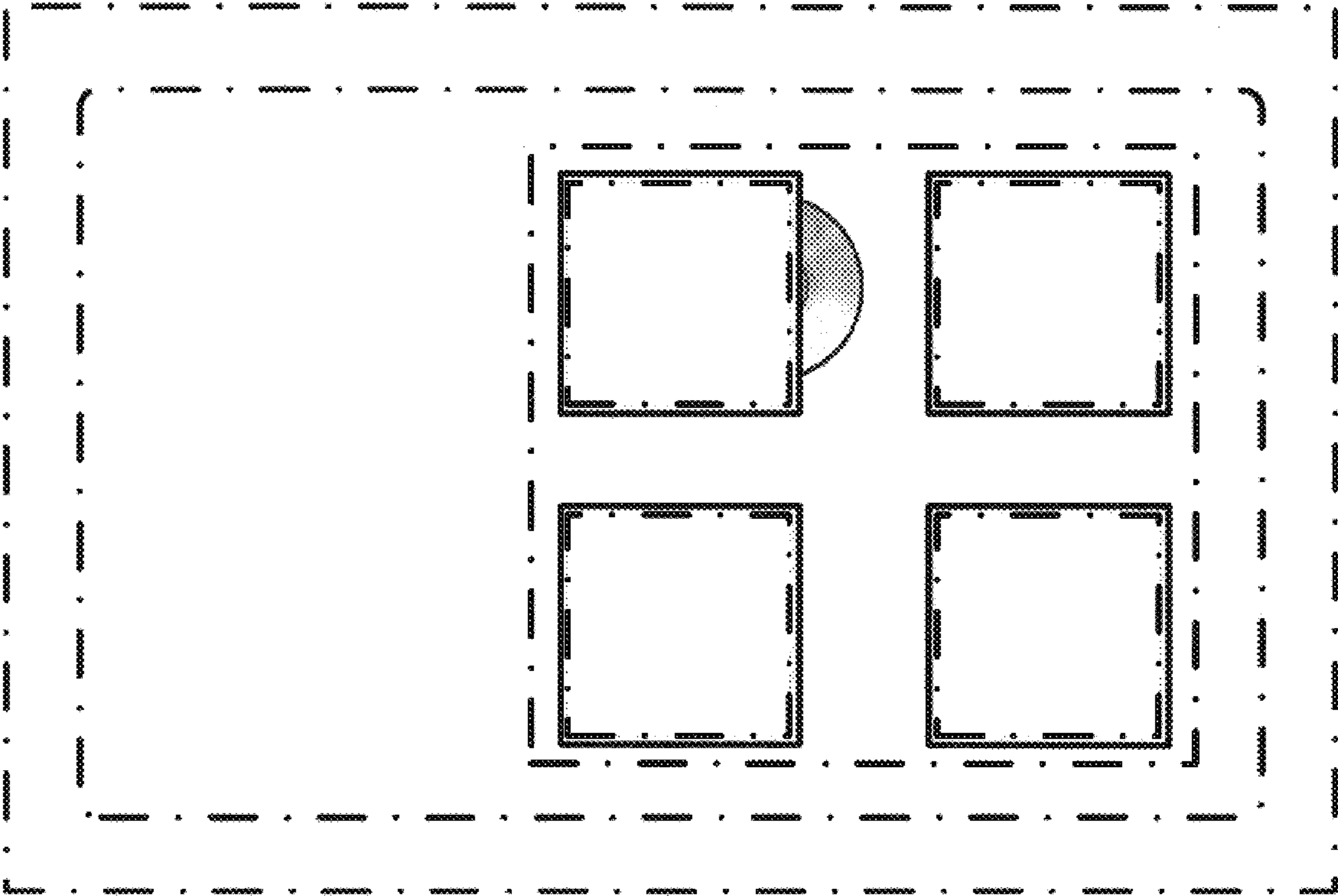

FIGURE