



US00D516040S

(12) **United States Design Patent**
Moye

(10) **Patent No.:** **US D516,040 S**

(45) **Date of Patent:** **** Feb. 28, 2006**

(54) **INFRARED TRANSMITTER/RECEIVER**

D439,220 S * 3/2001 Mayo et al. D13/125
D466,106 S * 11/2002 Cronk D14/217

(75) Inventor: **Douglas Maurice Moye**, Allentown, PA (US)

* cited by examiner

(73) Assignee: **Lutron Electronics Co., Inc.**, Coopersburg, PA (US)

Primary Examiner—Alan P. Douglas
Assistant Examiner—Susan Moon Lee

(**) Term: **14 Years**

(74) *Attorney, Agent, or Firm*—Ostrolenk, Faber, Gerb & Soffen, LLP

(21) Appl. No.: **29/203,609**

(57) **CLAIM**

(22) Filed: **Apr. 16, 2004**

The ornamental design for an infrared transmitter/receiver, as shown and described.

Related U.S. Application Data

DESCRIPTION

(63) Continuation-in-part of application No. 29/199,487, filed on Feb. 13, 2004.

FIG. 1 is a perspective of the infrared transmitter/receiver of the present invention.

(51) **LOC (8) Cl.** **13-03**

FIG. 2 is a front elevational view thereof;

(52) **U.S. Cl.** **D13/162**

FIG. 3 is a right side elevational view of the infrared transmitter/receiver of the present invention, the left side being a mirror image thereof.

(58) **Field of Classification Search** D13/160, D13/162, 158, 168, 171, 173, 177, 169, 123, D13/125; D8/353; 315/149–159, 129–136, 315/293; 359/355–356; 307/157; 323/905; D14/358, 217

FIG. 4 is a bottom view thereof;

FIG. 5 is a top view thereof;

FIG. 6 is a rear view thereof;

FIG. 7 is a right side view elevational view of a second embodiment of the design according to the present invention, the left side being a mirror image thereof.

See application file for complete search history.

FIG. 8 is a bottom view thereof; and,

FIG. 9 is a top view thereof.

(56) **References Cited**

U.S. PATENT DOCUMENTS

D315,145 S * 3/1991 Pearlman et al. D13/169
D336,744 S * 6/1993 Kahn et al. D13/171
5,399,940 A * 3/1995 Hanna et al. 315/129
D364,141 S * 11/1995 Hanna et al. D13/125
D392,256 S * 3/1998 Saint-Cyr et al. D13/158
5,909,087 A * 6/1999 Bryde et al. 315/149
6,005,308 A * 12/1999 Bryde et al. 307/157

The perspective and front elevational views of the embodiment of FIG. 7 are the same as the perspective and front elevational views of the embodiment of FIG. 3 and are shown in FIGS. 1 and 2, respectively. The rear view of the second embodiment forms no part of the claimed design.

1 Claim, 2 Drawing Sheets

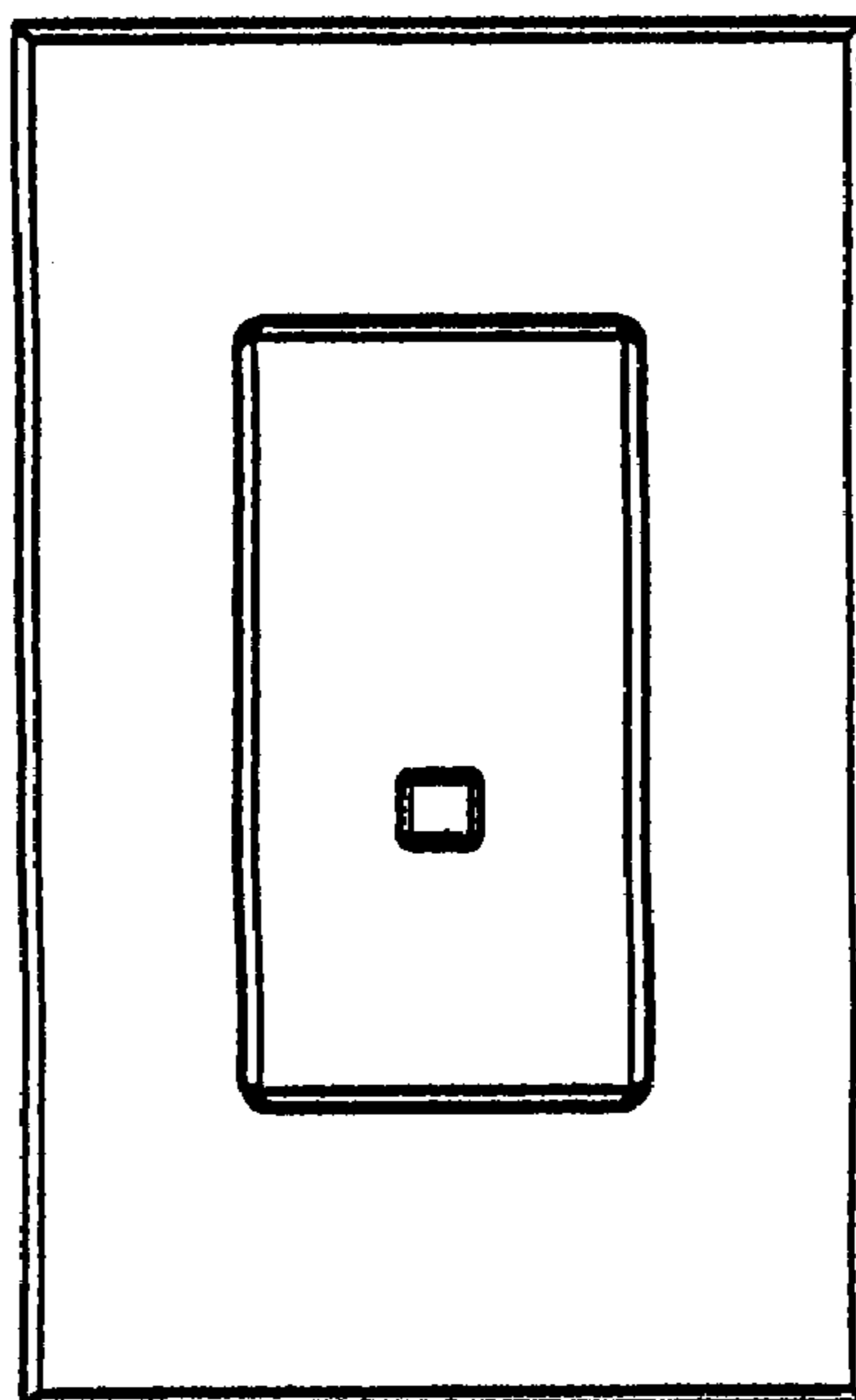

FIG. 2

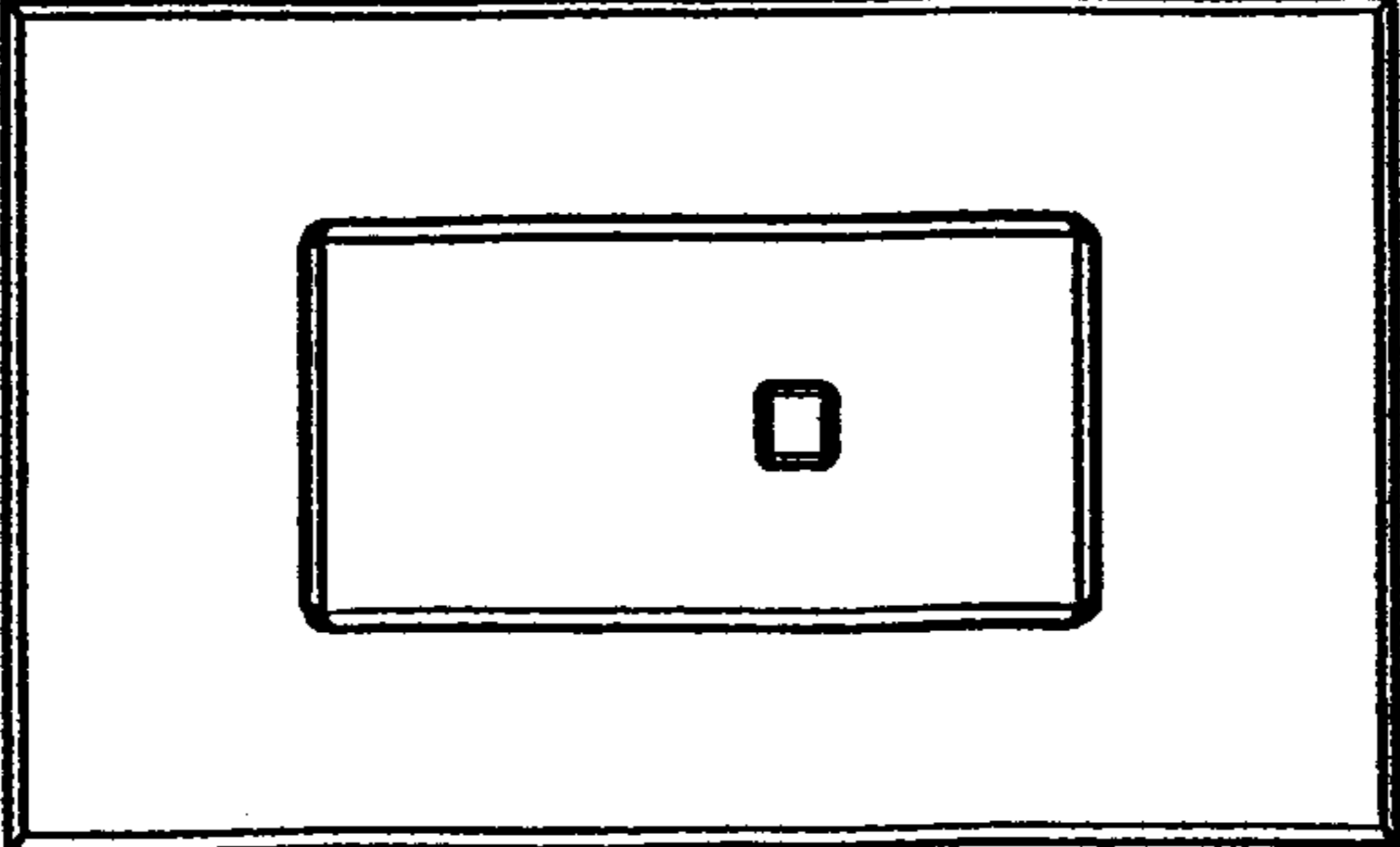

FIG. 3

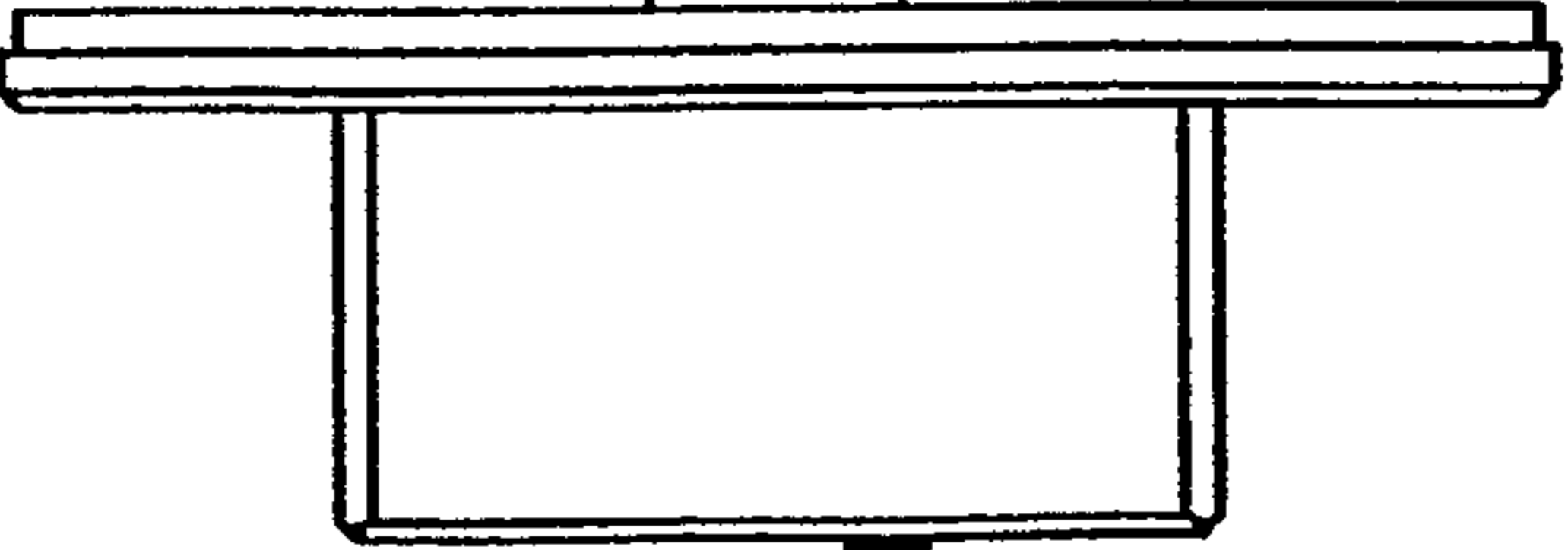

FIG. 6

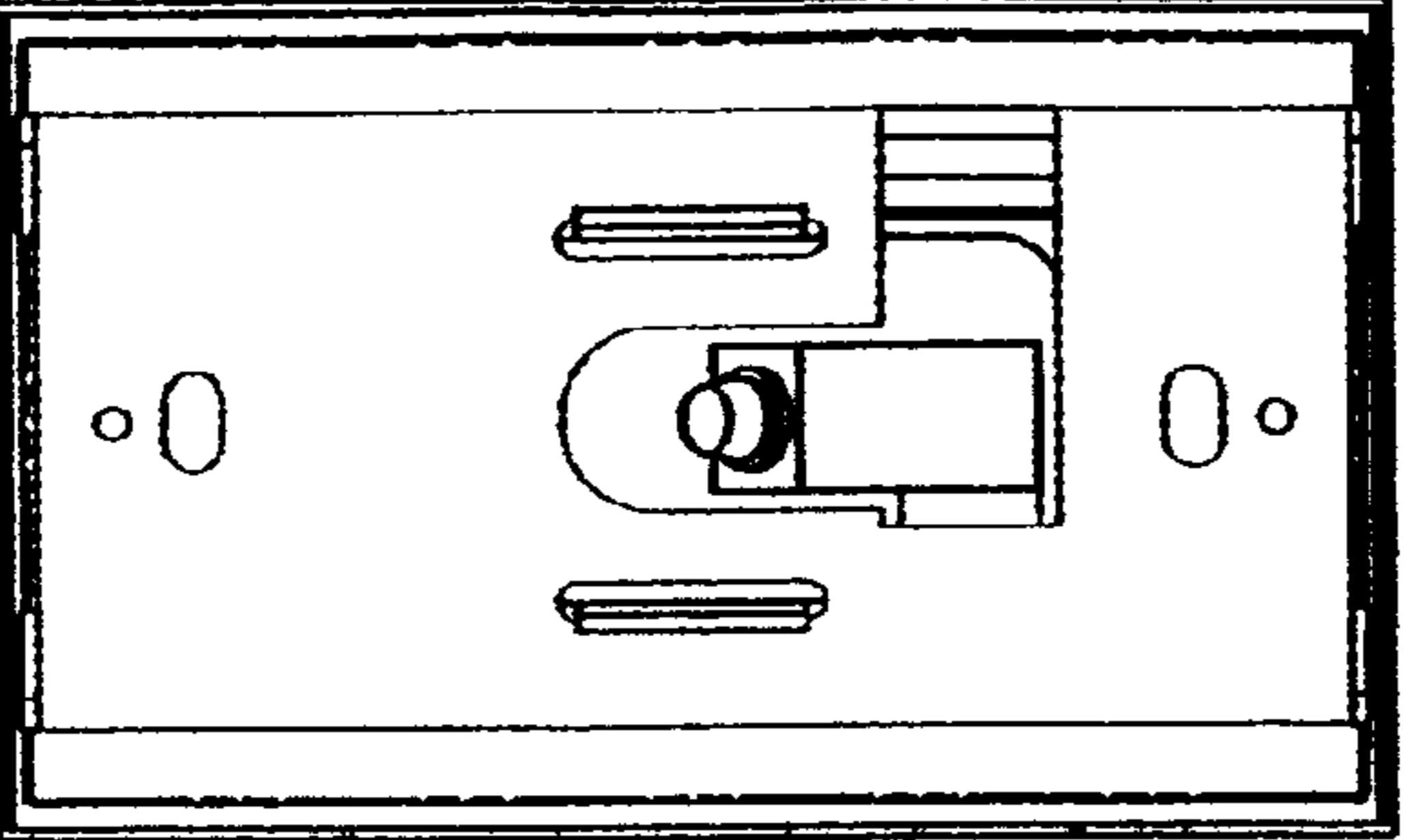

FIG. 1

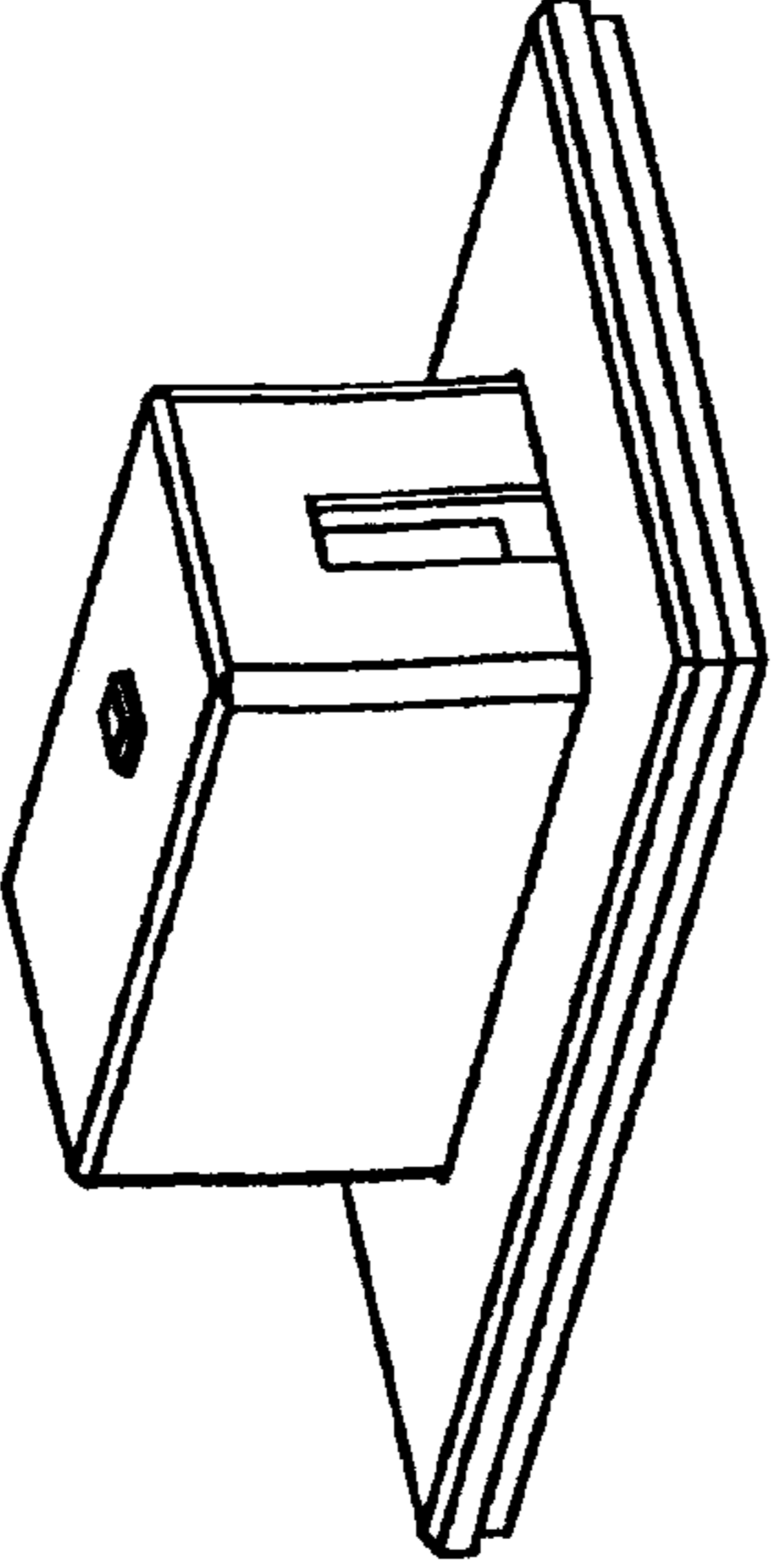

FIG. 4

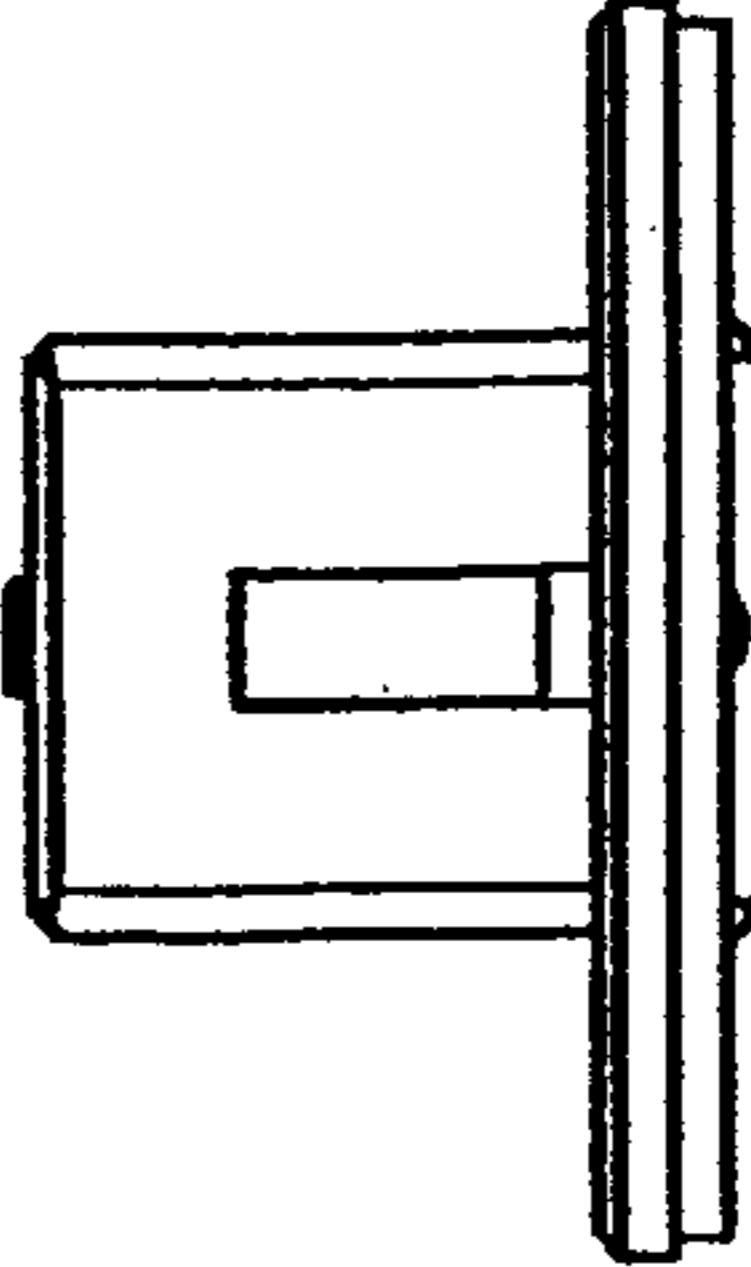

FIG. 9

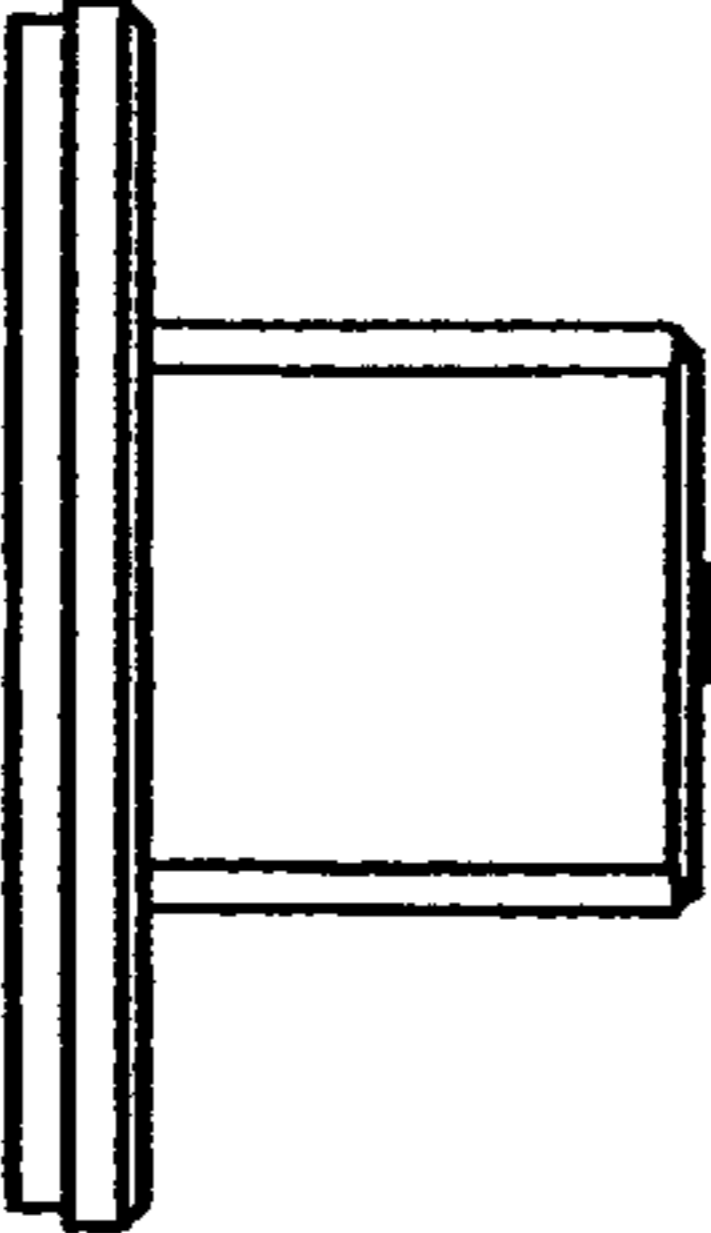

FIG. 8

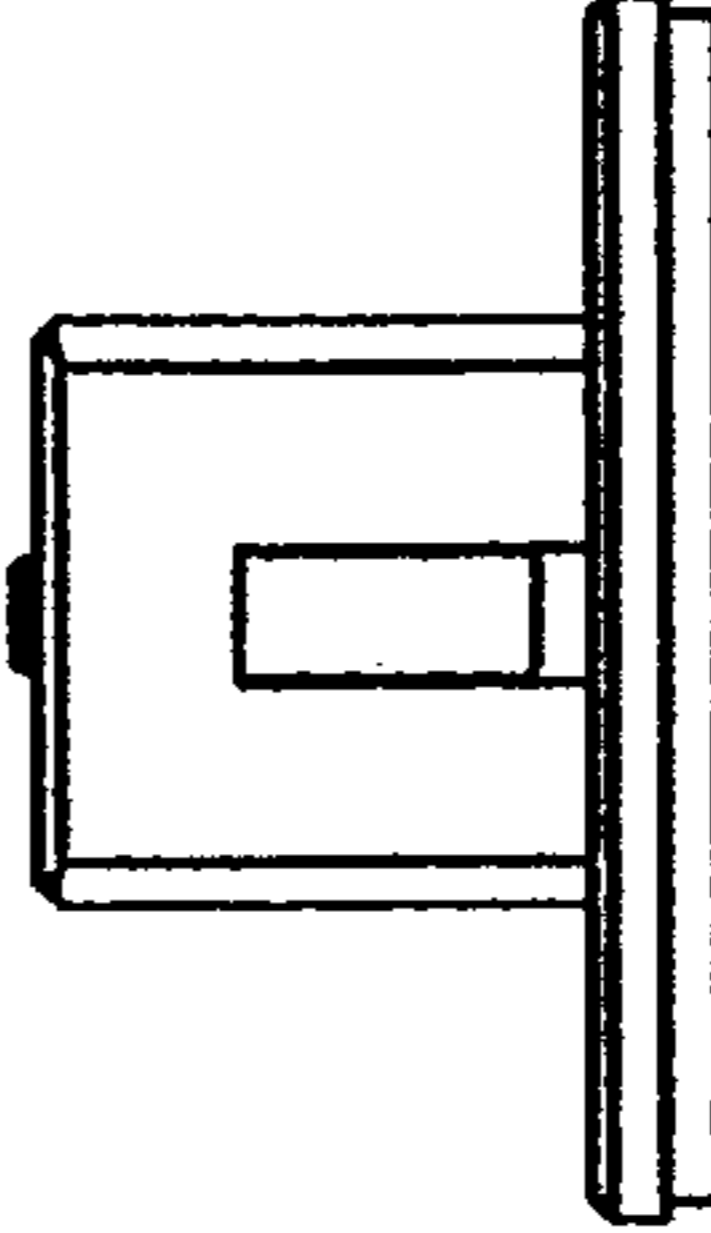

FIG. 7

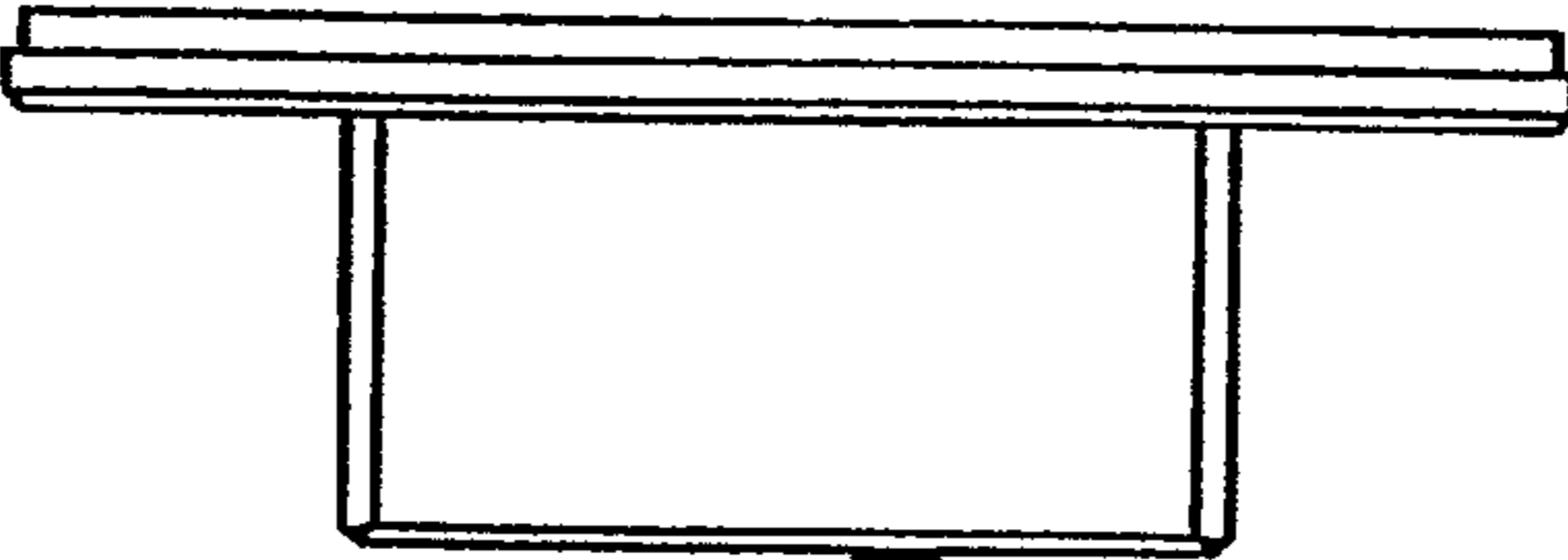

FIG. 5

