



US00D513605S

(12) **United States Design Patent**  
**Lin**

(10) **Patent No.:** **US D513,605 S**  
(45) **Date of Patent:** **\*\* Jan. 17, 2006**

(54) **CABLE CONNECTOR ASSEMBLY**

(75) **Inventor:** **Qing Hong Lin, Dong-Guan (CN)**

(73) **Assignee:** **Cheng Uei Precision Industry Co., Ltd., Taipei (TW)**

(\*\*) **Term:** **14 Years**

(21) **Appl. No.:** **29/205,503**

(22) **Filed:** **May 17, 2004**

(51) **LOC (8) Cl. .... 13-03**

(52) **U.S. Cl. .... D13/133; D13/153; D13/146; D13/147**

(58) **Field of Classification Search .... D12/133, D12/146, 147, 153, 184, 199; 174/174 A; 439/502, 540.1, 623, 638**

See application file for complete search history.

(56) **References Cited**

**U.S. PATENT DOCUMENTS**

- 4,477,801 A \* 10/1984 Robinson et al. .... 340/684
- 5,203,720 A \* 4/1993 Zini ..... 439/502
- 5,547,399 A \* 8/1996 Naghi et al. .... 439/623

- 5,954,538 A \* 9/1999 Huang ..... 439/502
- D422,968 S \* 4/2000 Tsai et al. .... D13/147
- 6,454,597 B1 \* 9/2002 Marsh et al. .... 439/502
- D473,848 S \* 4/2003 Zheng et al. .... D13/147
- D491,532 S \* 6/2004 Chung et al. .... D13/147

\* cited by examiner

*Primary Examiner*—Stella Reid

*Assistant Examiner*—Daniel Bui

(74) *Attorney, Agent, or Firm*—Rosenberg, Klein & Lee

(57) **CLAIM**

The ornamental design for a cable connector assembly, as shown and described.

**DESCRIPTION**

FIG. 1 is a perspective view of a cable connector assembly showing my new design;  
 FIG. 2 is a front elevational view thereof;  
 FIG. 3 is a rear elevational view thereof;  
 FIG. 4 is a left side elevational view thereof;  
 FIG. 5 is a right side elevational view thereof;  
 FIG. 6 is a top plan view thereof; and,  
 FIG. 7 is a bottom plan view thereof.

**1 Claim, 7 Drawing Sheets**

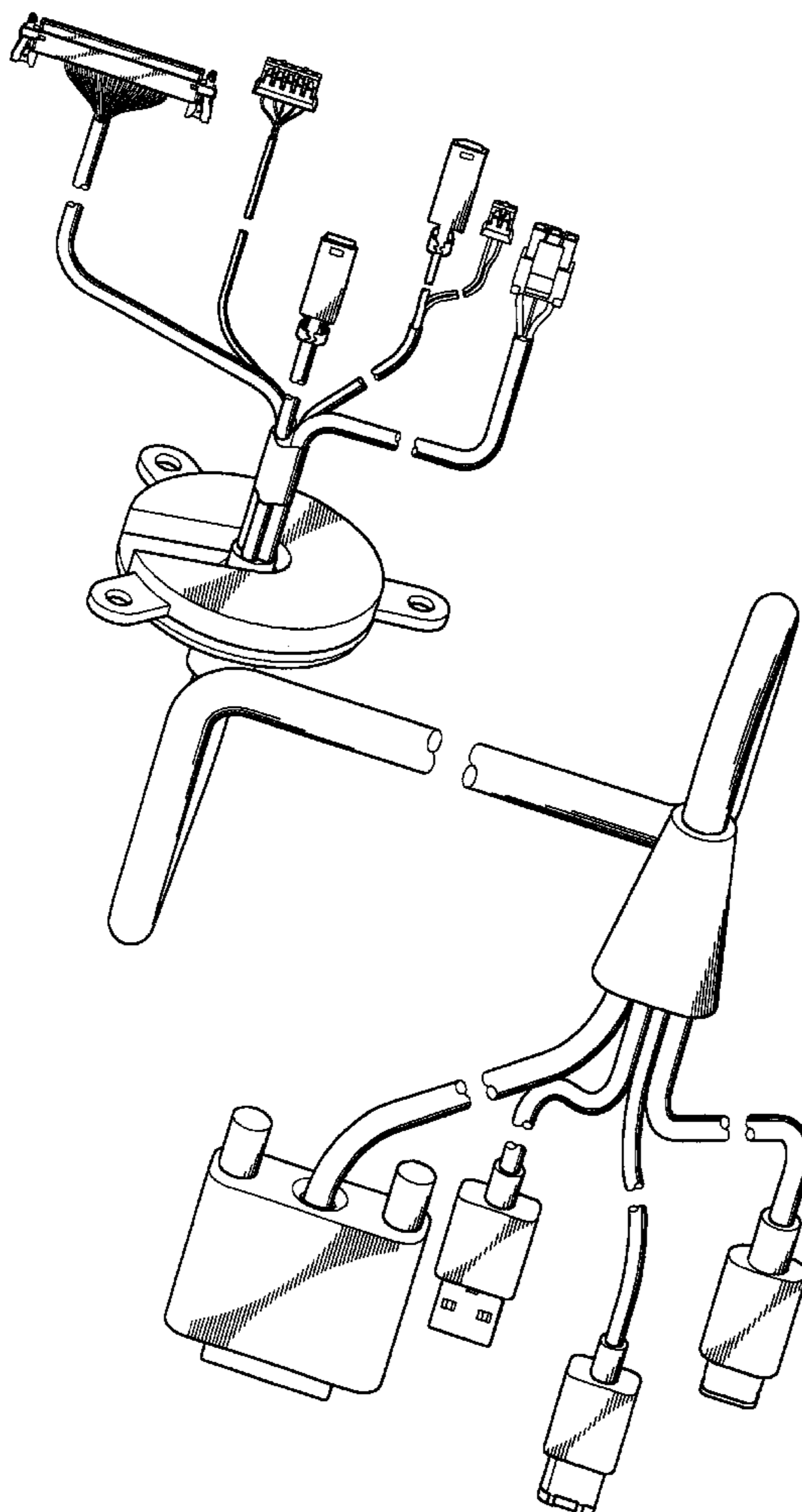

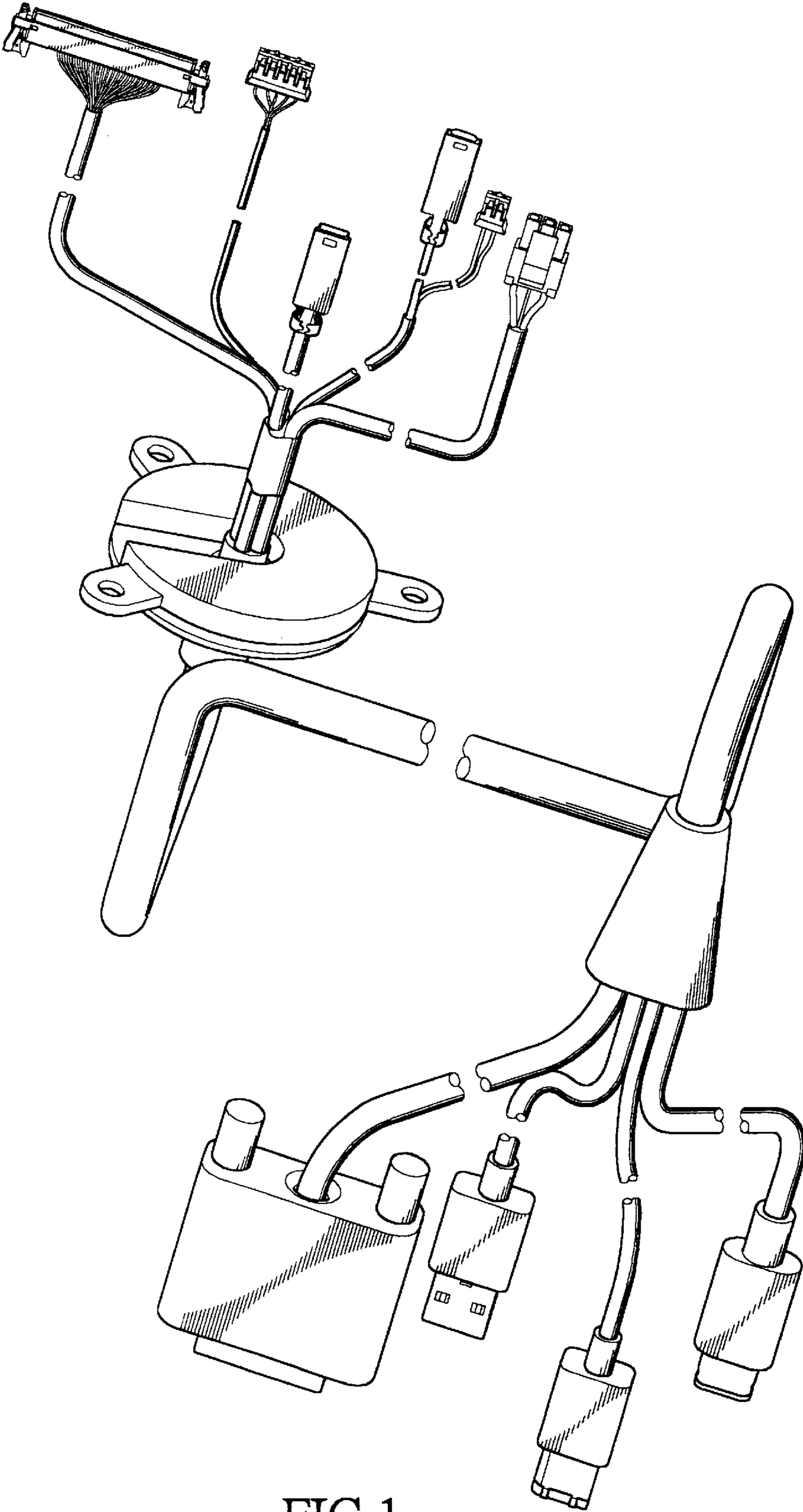

FIG.1

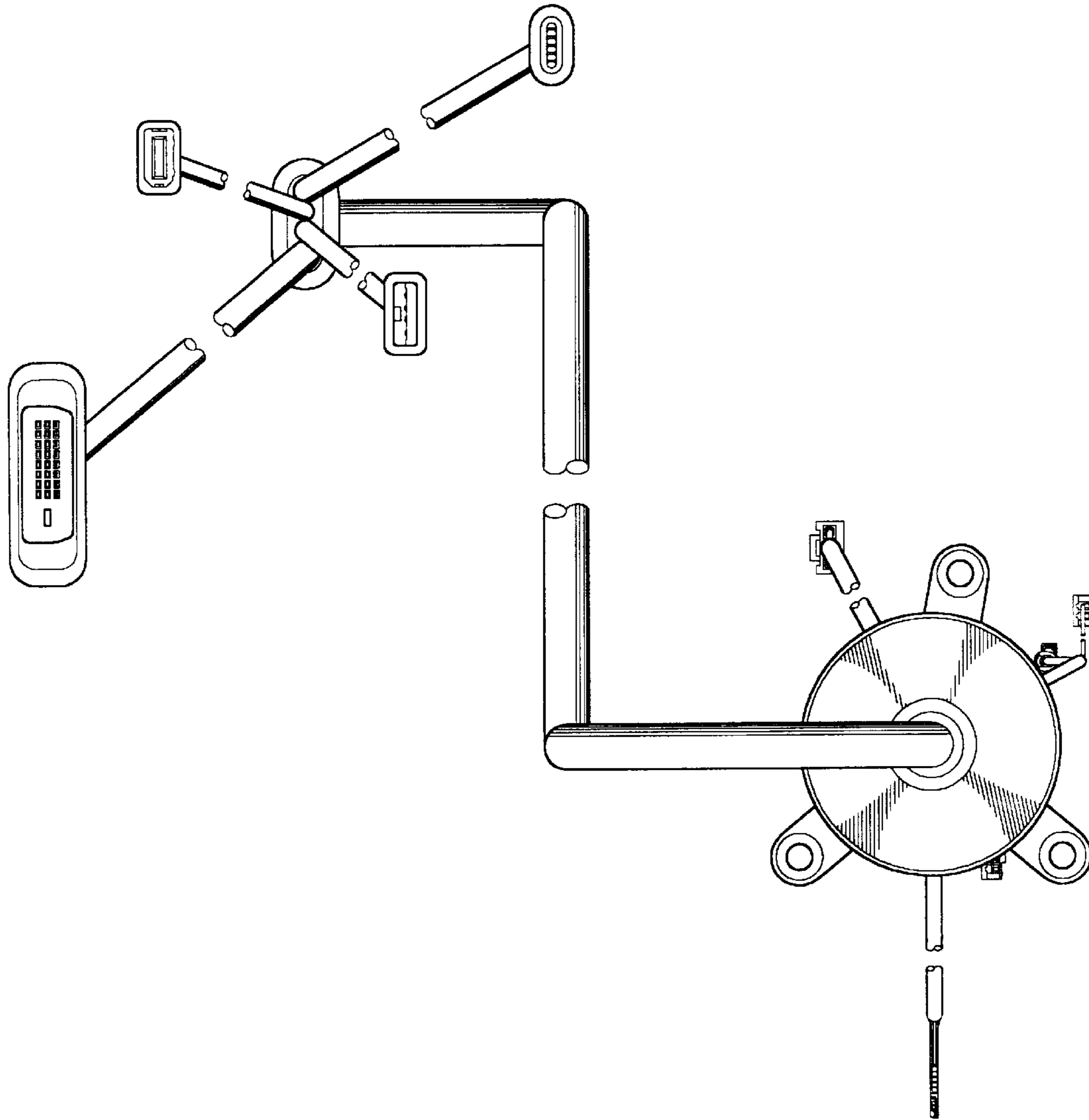

FIG.2

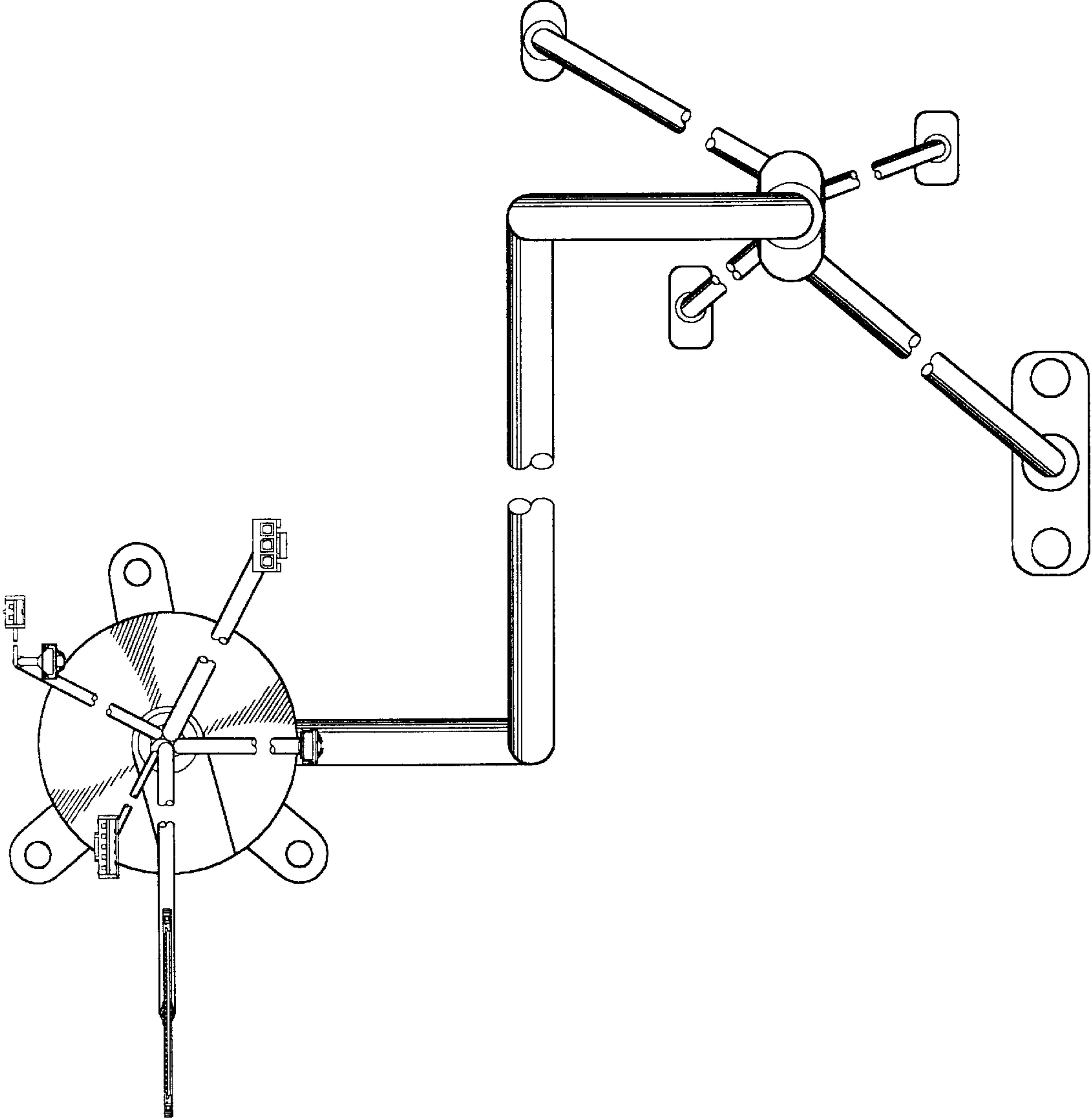

FIG.3

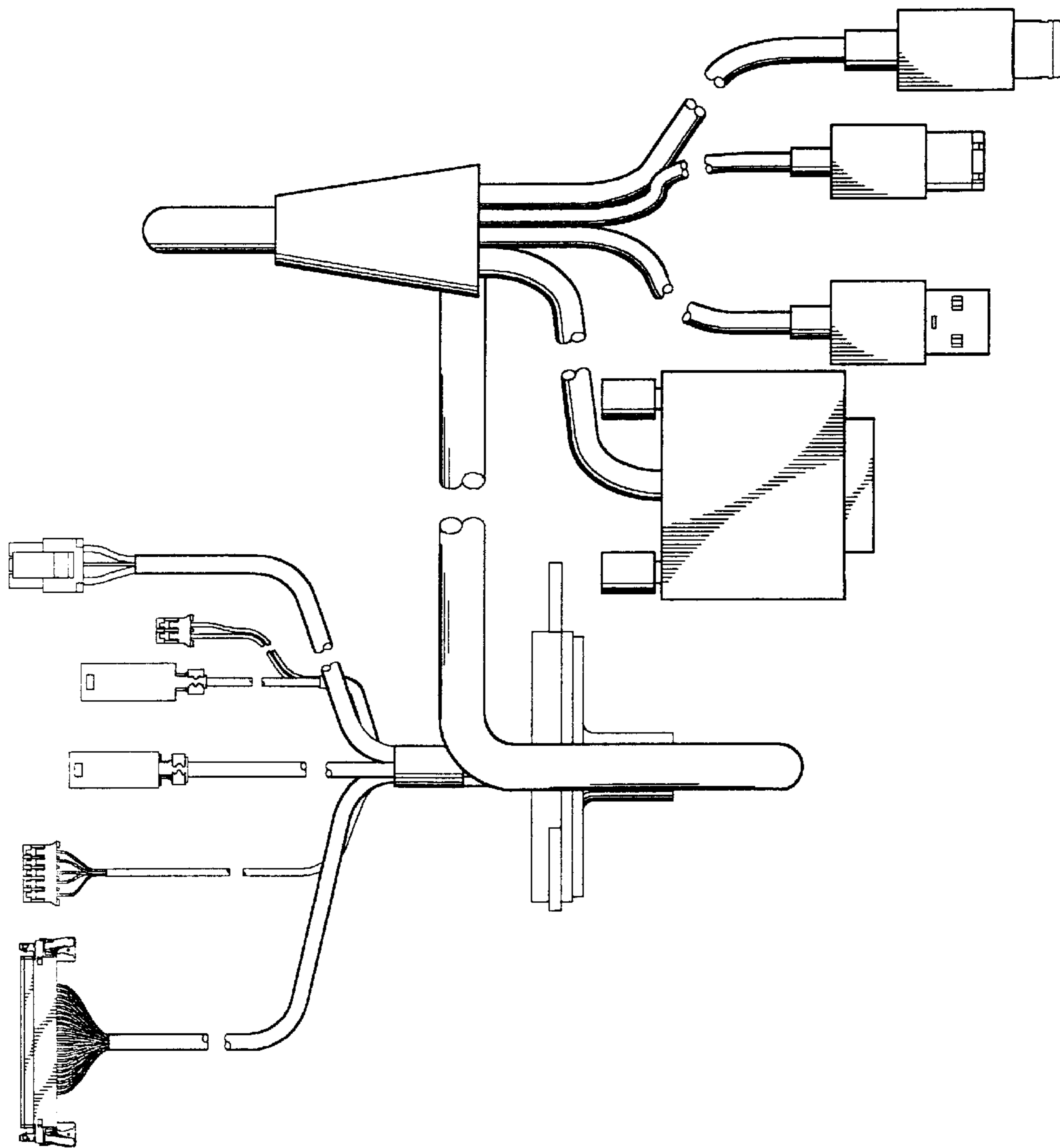

FIG.4

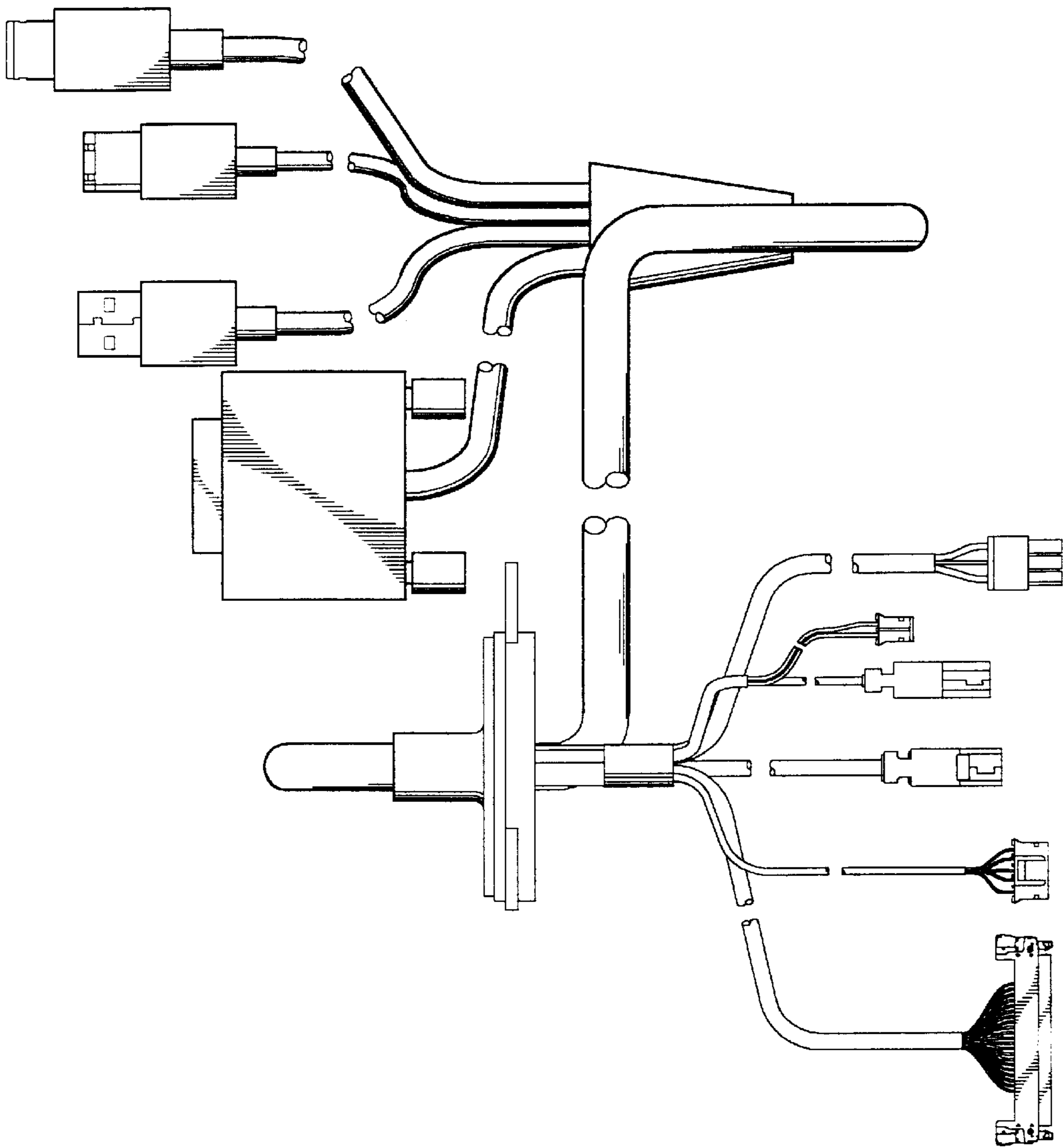

FIG.5

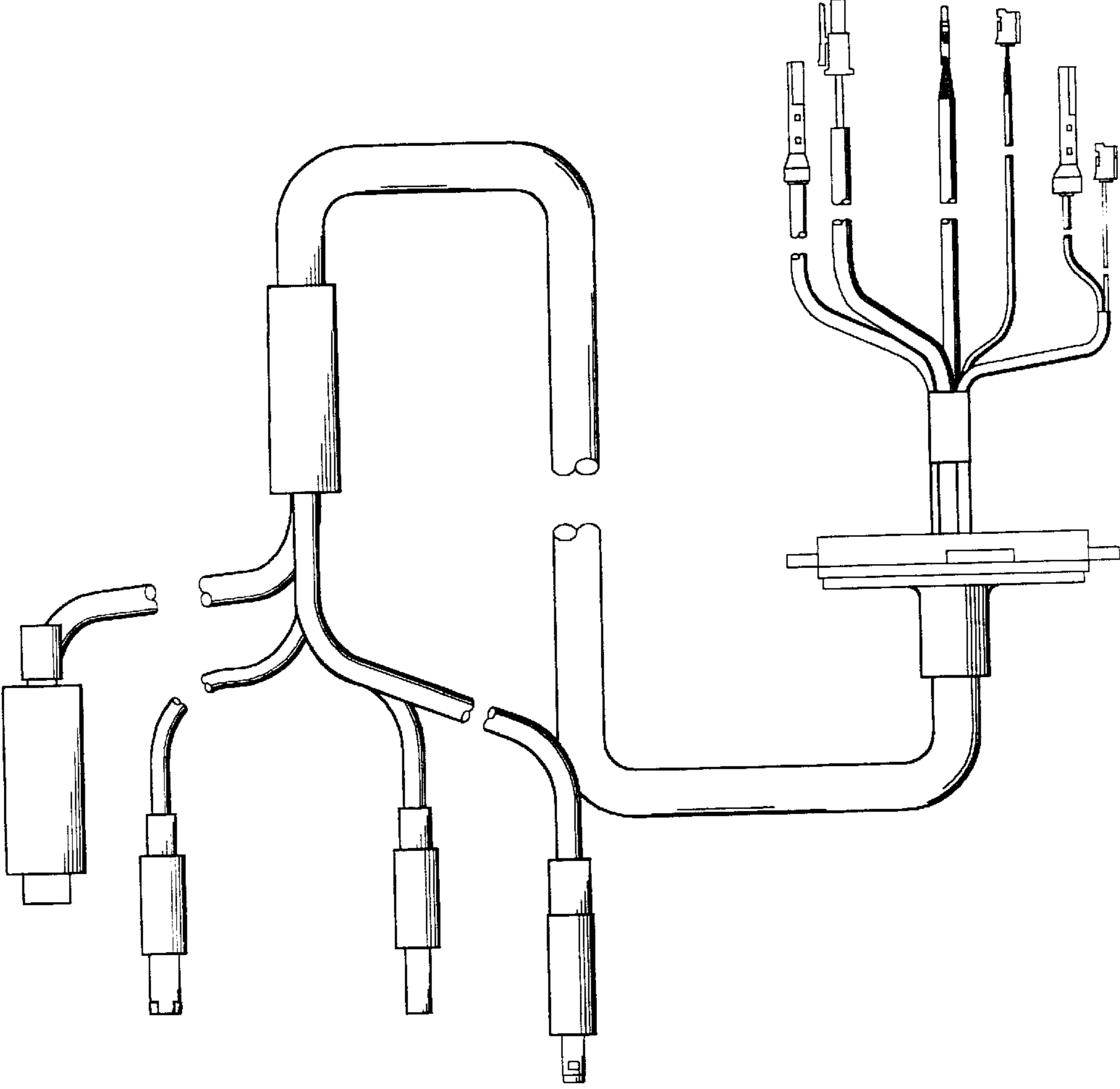

FIG.6

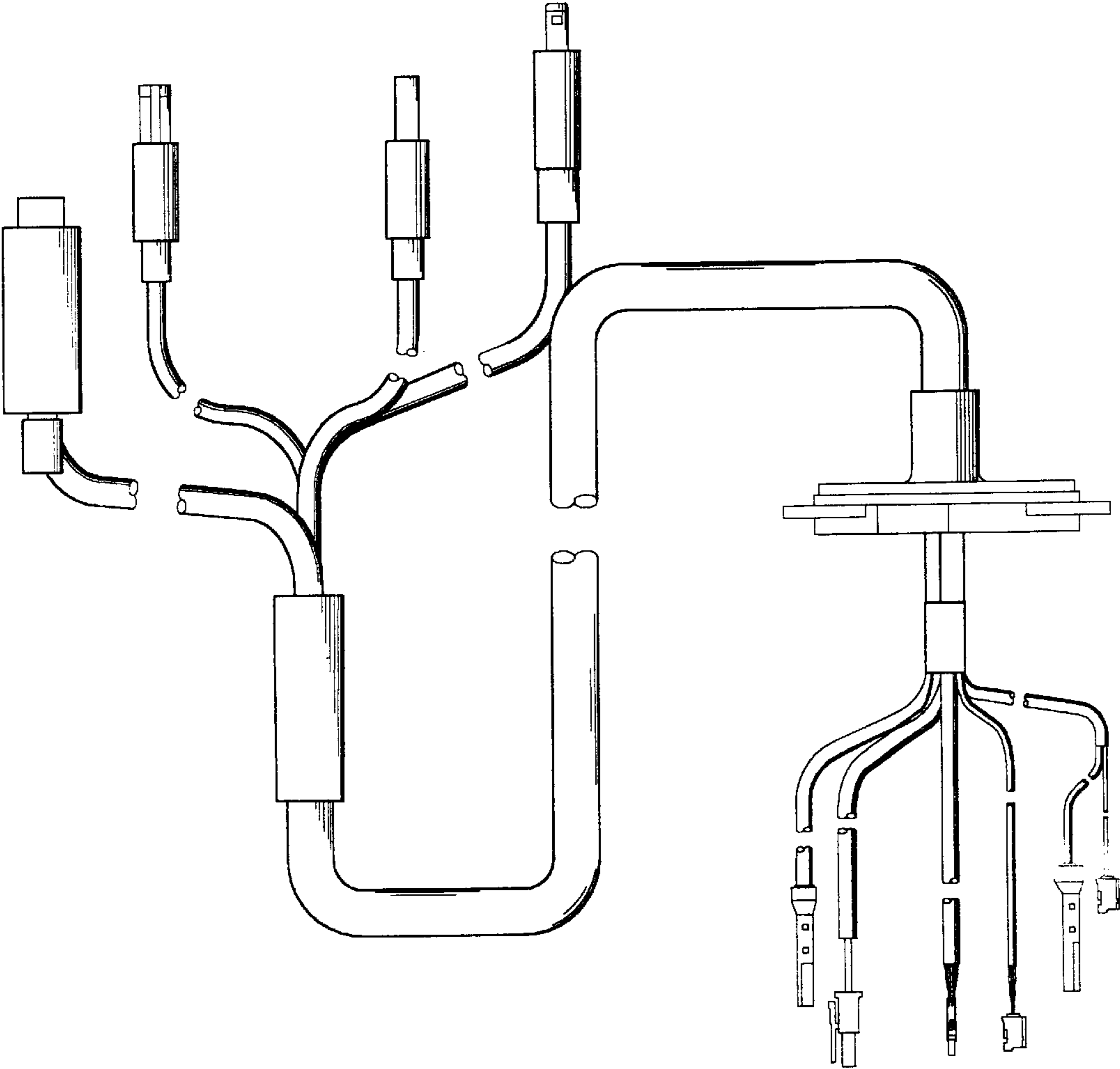

FIG.7