



US00D511104S

(12) **United States Design Patent**
Akopyan

(10) **Patent No.:** **US D511,104 S**

(45) **Date of Patent:** **** Nov. 1, 2005**

(54) **SET OF THREE INTERLOCKED BOTTLES**

(76) **Inventor:** **Arshak Sh. Akopyan**, 1215 E.
Colorado st., Suite 202B, Glendale, CA
(US) 91205

(**) **Term:** **14 Years**

(21) **Appl. No.:** **29/202,150**

(22) **Filed:** **Mar. 26, 2004**

(51) **LOC (8) Cl.** **09-01**

(52) **U.S. Cl.** **D9/739; D9/522; D9/543;**
D9/561

(58) **Field of Search** D7/598; D9/684,
D9/738-742, 501, 516-517, 523-524, 527-528,
530-531, 533-534, 544, 546, 549-550,
561, 563, 575; D24/197; 215/6, 10, 382-384,
396, 398; 220/23.4, 524

(56) **References Cited**

U.S. PATENT DOCUMENTS

59,333	A	*	10/1866	Bullard	215/383	X
146,783	A	*	1/1874	Richardson	215/10	
255,642	A	*	3/1882	Lubin	215/6	X
D203,950	S	*	3/1966	Swayze	D9/526	
4,249,766	A	*	2/1981	Erickson	294/87.2	
D263,118	S	*	2/1982	Weckman	D9/741	
4,544,194	A	*	10/1985	Allen	294/87.2	
D281,824	S	*	12/1985	Field	D9/739	X
5,356,040	A	*	10/1994	Reggiani	220/23.83	X
D376,955	S	*	12/1996	Petrosyan et al.	D7/598	
D429,633	S	*	8/2000	Godio	D9/743	

6,325,229	B1	*	12/2001	Anders	220/23.4	
D453,113	S	*	1/2002	Feen et al.	D9/561	
D476,902	S	*	7/2003	Snyder	D9/561	
D481,627	S	*	11/2003	Hillesland	D9/522	

* cited by examiner

Primary Examiner—Carol Rademaker

(57) **CLAIM**

The ornamental design for a set of three interlocked bottles, as shown and described.

DESCRIPTION

FIG. 1 is a perspective view of the set of three interlocked bottles, including upper and lower horizontal straps, showing my new design;

FIG. 2 is a front elevational view thereof, including upper and lower horizontal straps, shown at an enlarged scale from FIG. 1;

FIG. 3 is a top plan view of thereof, shown at a reduced scale from FIG. 2;

FIG. 4 is a front elevational view of one of the set of three interlocked bottles of FIG. 2, shown separately and without the upper and lower horizontal straps for clarity of illustration, and shown at the same scale as FIG. 3;

FIG. 5 is a left side elevational view thereof, the right side elevational view being a mirror image except that the bumps are instead recesses;

FIG. 6 is a rear elevational view thereof; and,

FIG. 7 is a top plan view thereof.

1 Claim, 3 Drawing Sheets

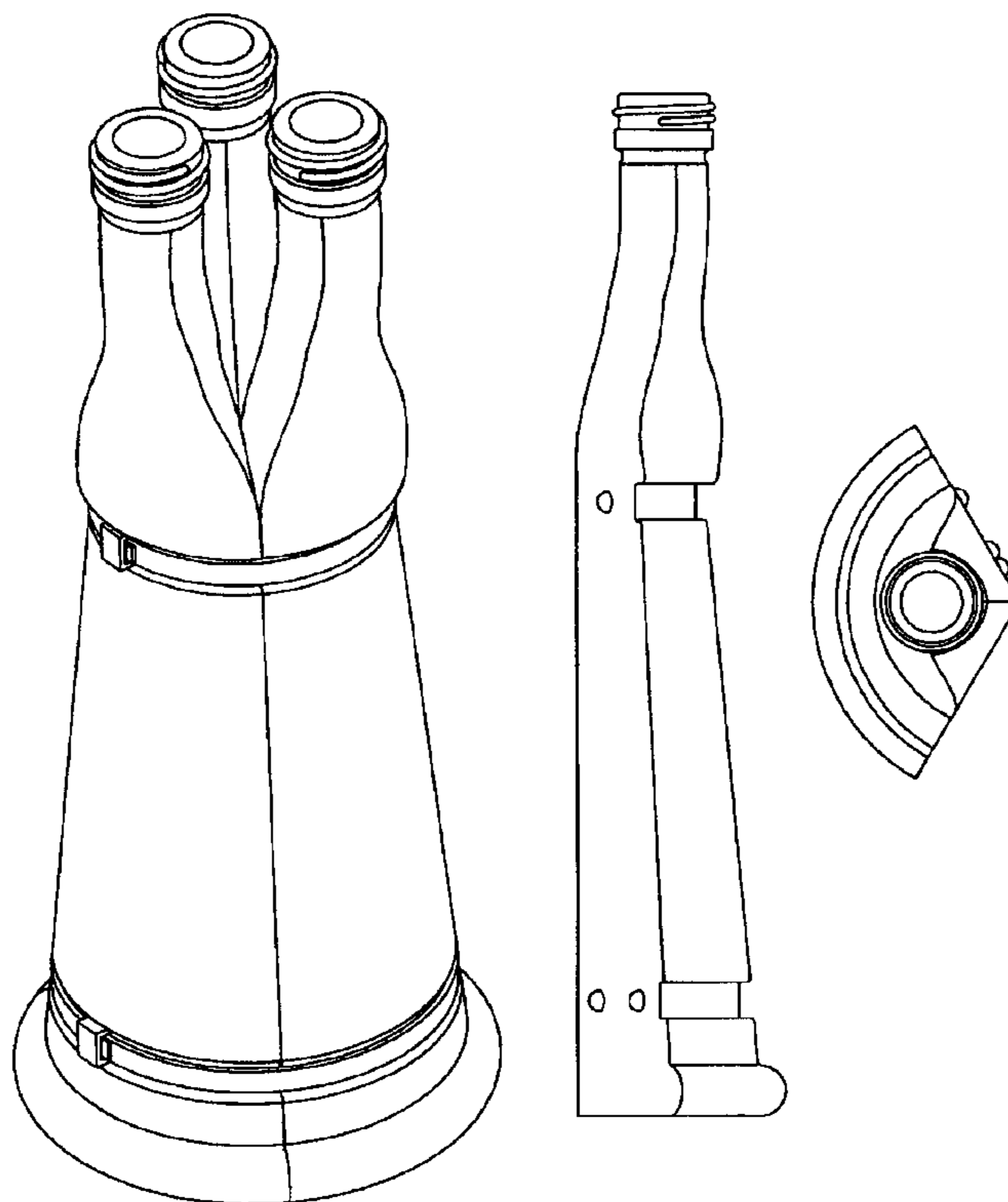

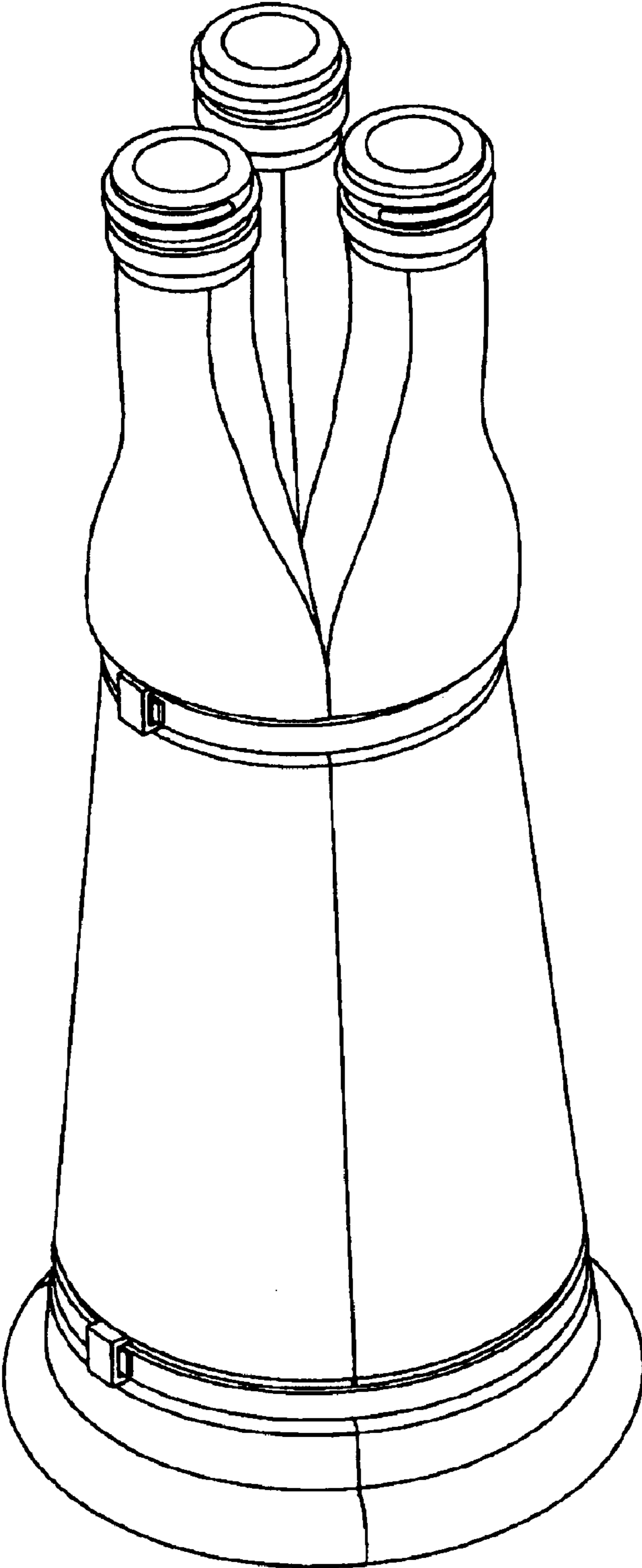

Fig 1

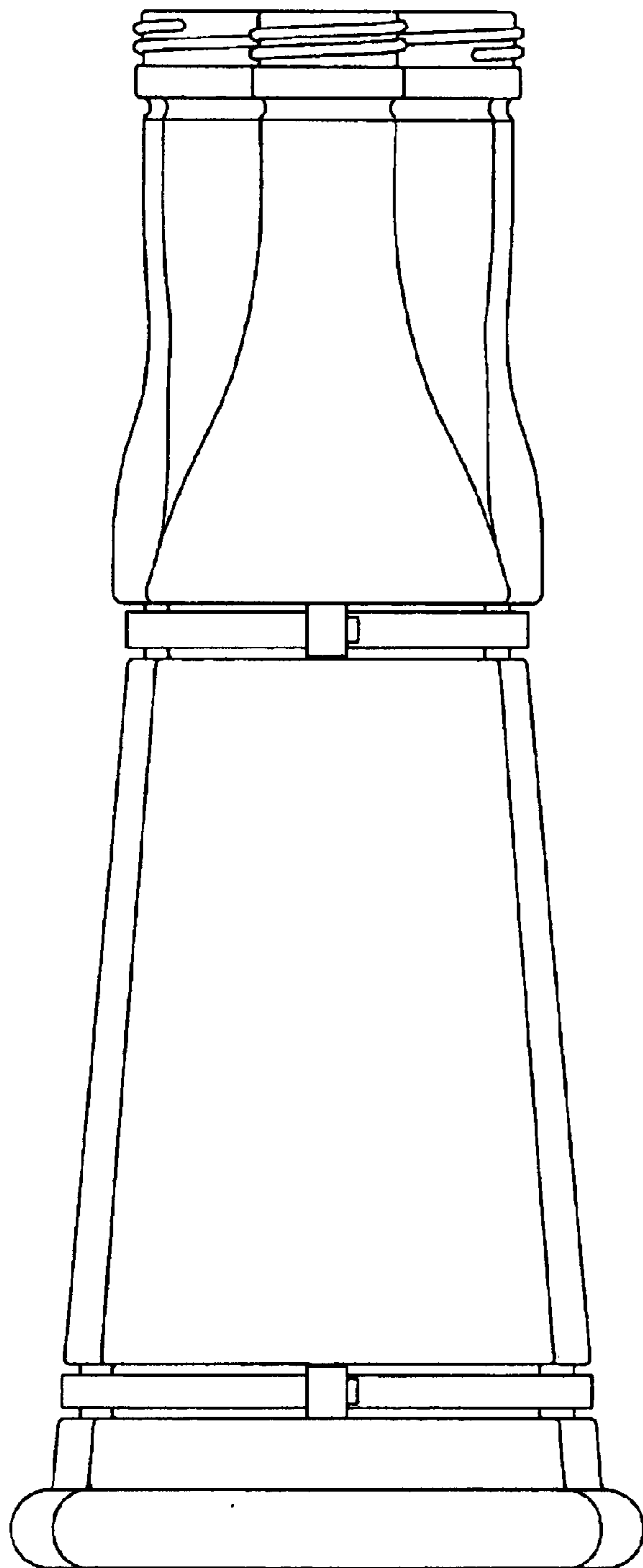

Fig 2

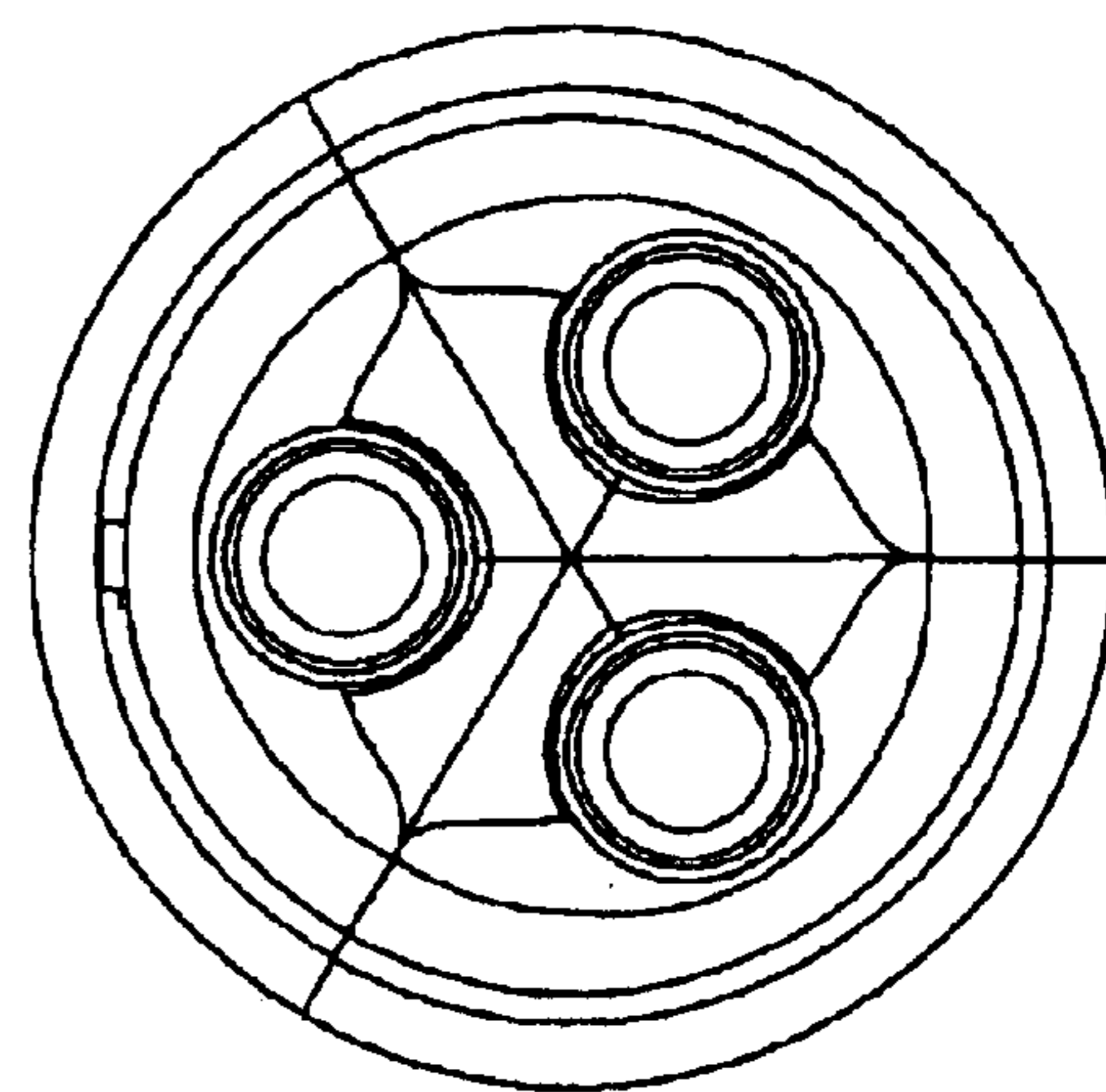

Fig 3

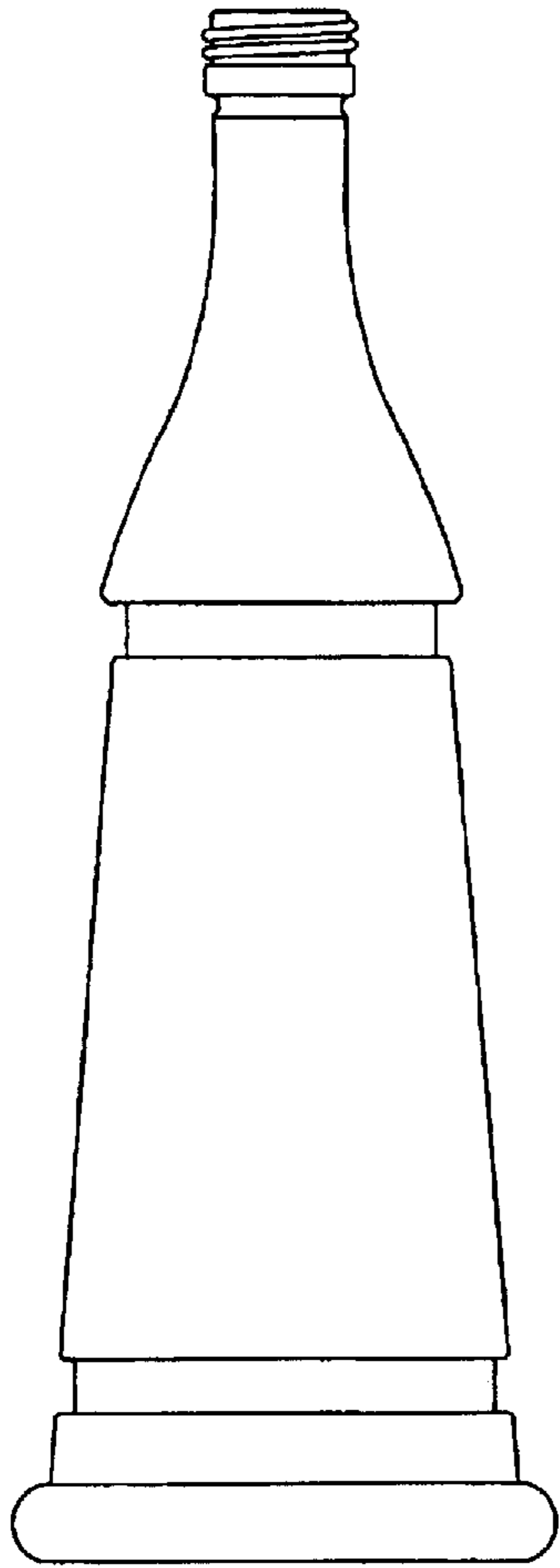

Fig 4

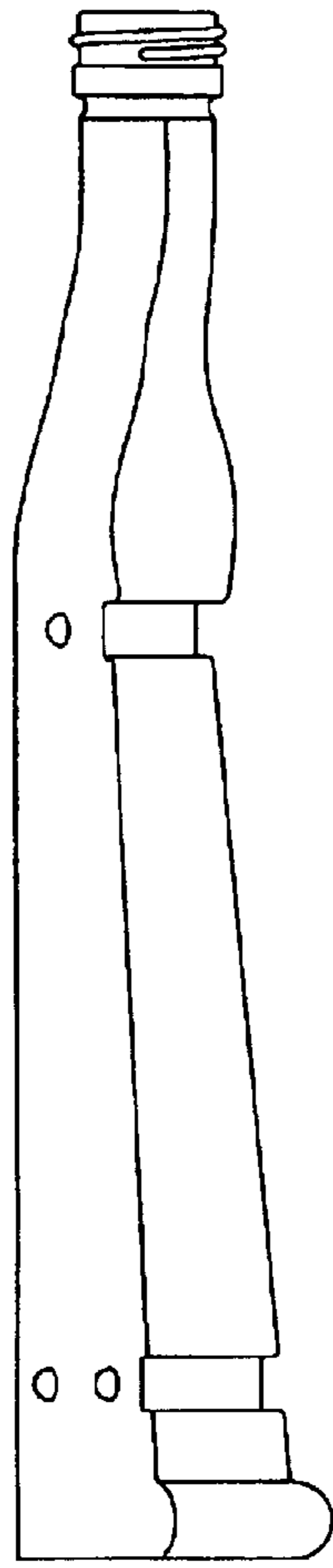

Fig 5

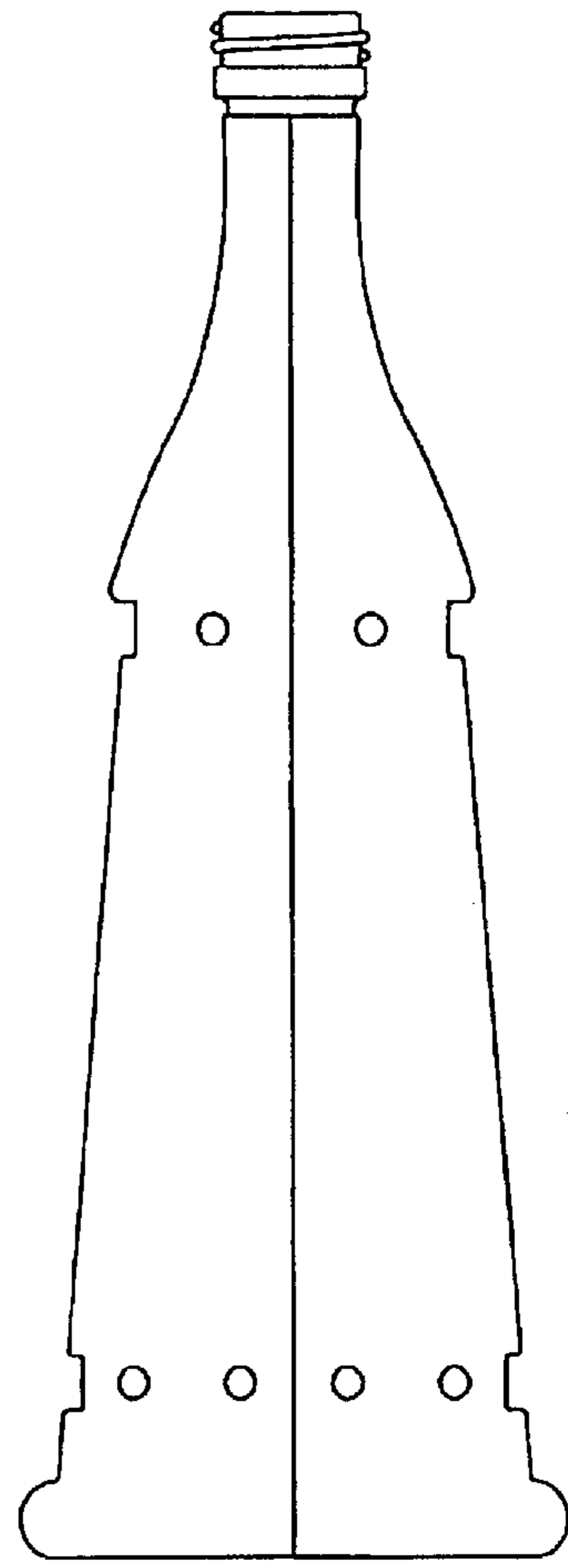

Fig 6

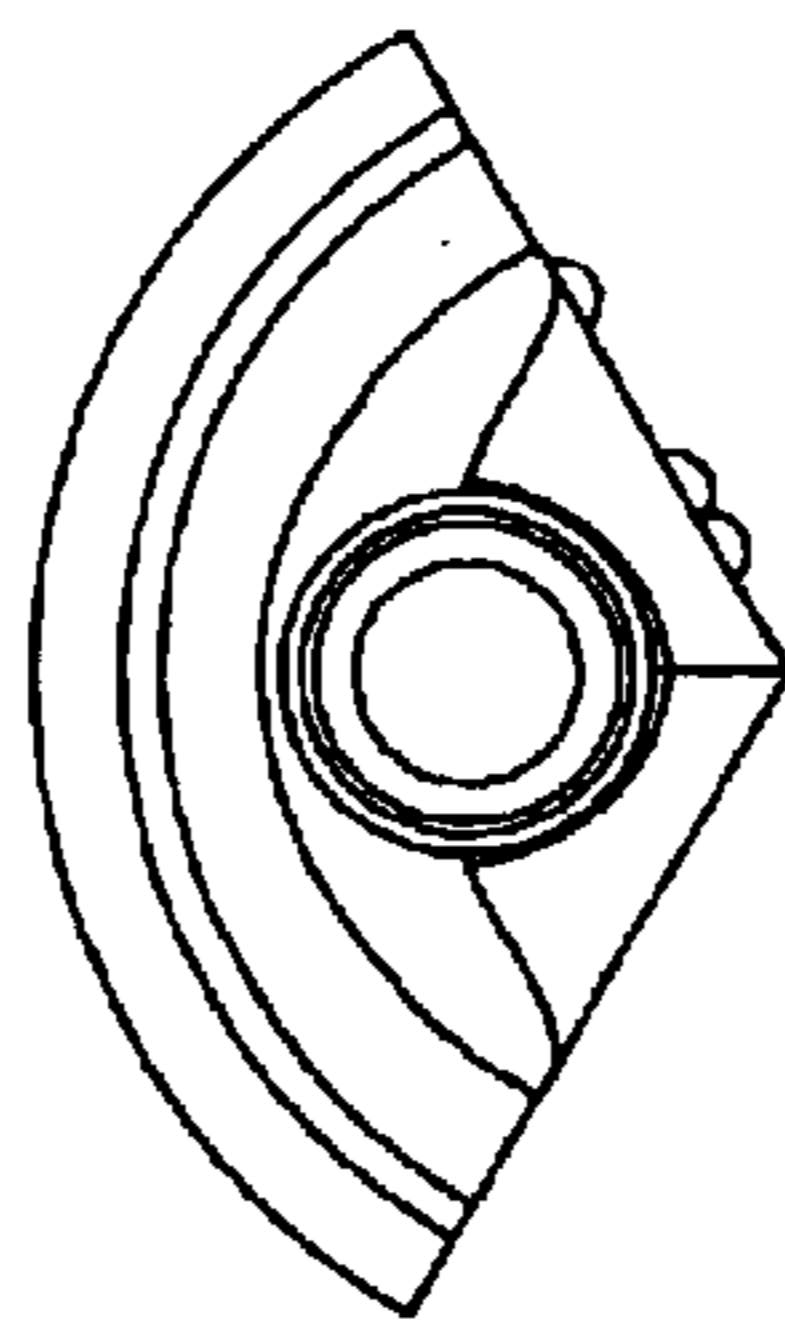

Fig 7