



US00D510015S

(12) **United States Design Patent** (10) **Patent No.:** **US D510,015 S**
Hostetler (45) **Date of Patent:** **** Sep. 27, 2005**

(54) **PORTABLE HOLDER FOR GAS CYLINDERS**

(76) Inventor: **Paul E. Hostetler**, P.O. Box
1987-34274, Nokomis, FL (US) 34275

(**) Term: **14 Years**

(21) Appl. No.: **29/214,756**

(22) Filed: **Oct. 8, 2004**

(51) **LOC (8) Cl.** **08-05**

(52) **U.S. Cl.** **D8/373**

(58) **Field of Search** D8/373, 363; D6/552;
211/85.18, 70.6, 13.1; 248/309.1, 205.3,
205.5, 206.3

(56) **References Cited**

U.S. PATENT DOCUMENTS

| | | | | |
|----------------|---------|-------------------|-------|-----------|
| 3,368,691 A * | 2/1968 | Blake | | 211/85.18 |
| 4,941,577 A * | 7/1990 | Ferree et al. | | 211/70.6 |
| 5,655,673 A * | 8/1997 | Weterrings et al. | | 211/75 |
| 6,481,583 B1 * | 11/2002 | Black et al. | | 211/70.6 |

* cited by examiner

Primary Examiner—Holly Baynham

(74) *Attorney, Agent, or Firm*—Burns, Doane, Swecker & Mathis, LLP

(57) **CLAIM**

I claim the ornamental design for a portable holder for gas cylinders, as shown and described.

DESCRIPTION

FIG. 1 is a top plan view of a first embodiment of a portable holder for gas cylinders, illustrating the new design.

FIG. 2 is a bottom plan view of the portable holder of FIG. 1.

FIG. 3 is a rear side elevational view of the portable holder of FIG. 1.

FIG. 4 is an elevational view of the portable holder of FIG. 1.

FIG. 5 is a front side elevational view of the portable holder of FIG. 1.

FIG. 6 is a top rear perspective view of the portable holder of FIG. 1. The broken line showing a gas cylinder is for illustrational purposes only and forms no part of the claimed design.

FIG. 7 is a top rear perspective view of a second embodiment of a portable holder, illustrating the new design, the difference relating to the number of cylinder-supporting brackets. The broken line showing a gas cylinder is for illustrative purposes only and forms no part of the claimed design.

FIG. 8 is a bottom plan view of a third embodiment of a portable holder, illustrating the new design, the difference from the first embodiment relating to the shape of manually grippable valve actuator for actuating a suction cup relief valve. The top plan view, the rear side elevational view, and the front side elevational view of the third embodiment are identical to FIGS. 1, 3, and 5, respectively.

FIG. 9 is an end elevational view of the portable holder of FIG. 8.

FIG. 10 is a top rear perspective view of the portable holder of FIG. 8; and,

FIG. 11 is a top rear perspective view of a fourth embodiment of a portable holder for gas cylinders, illustrating the new design, the difference over FIG. 8 relating to the number of cylinder-supporting brackets.

1 Claim, 9 Drawing Sheets

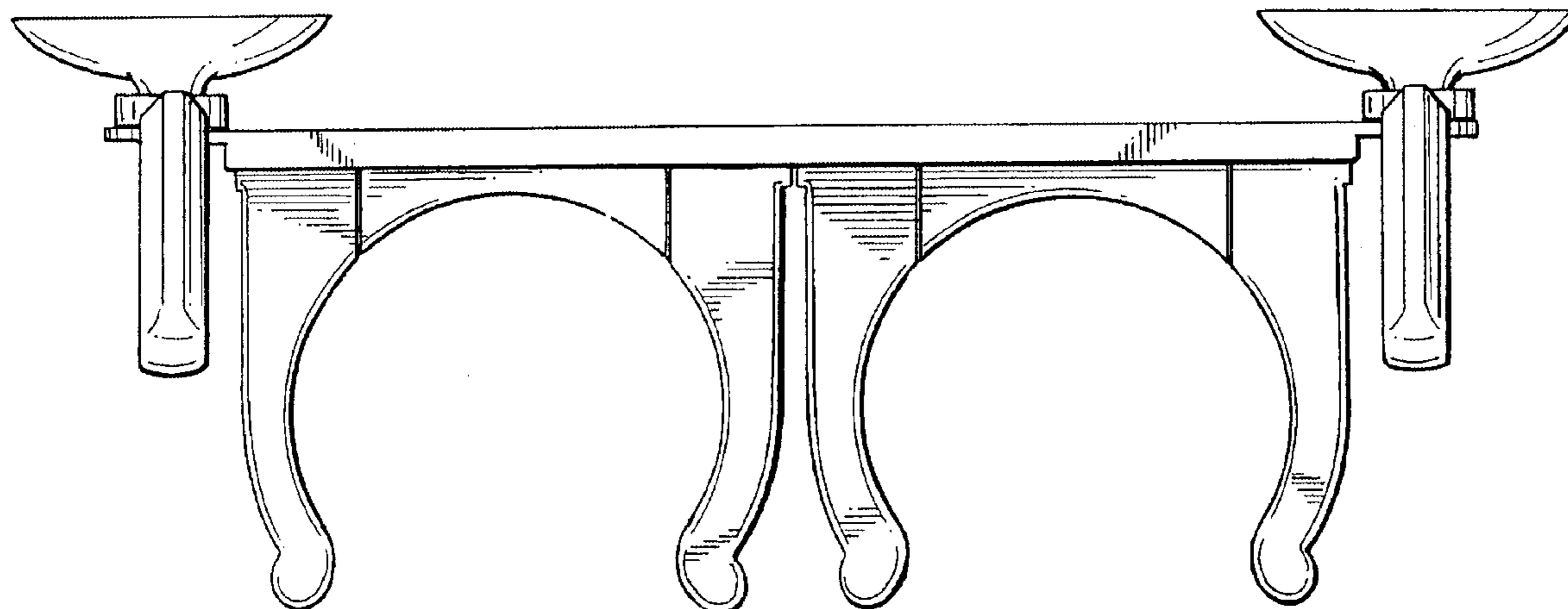

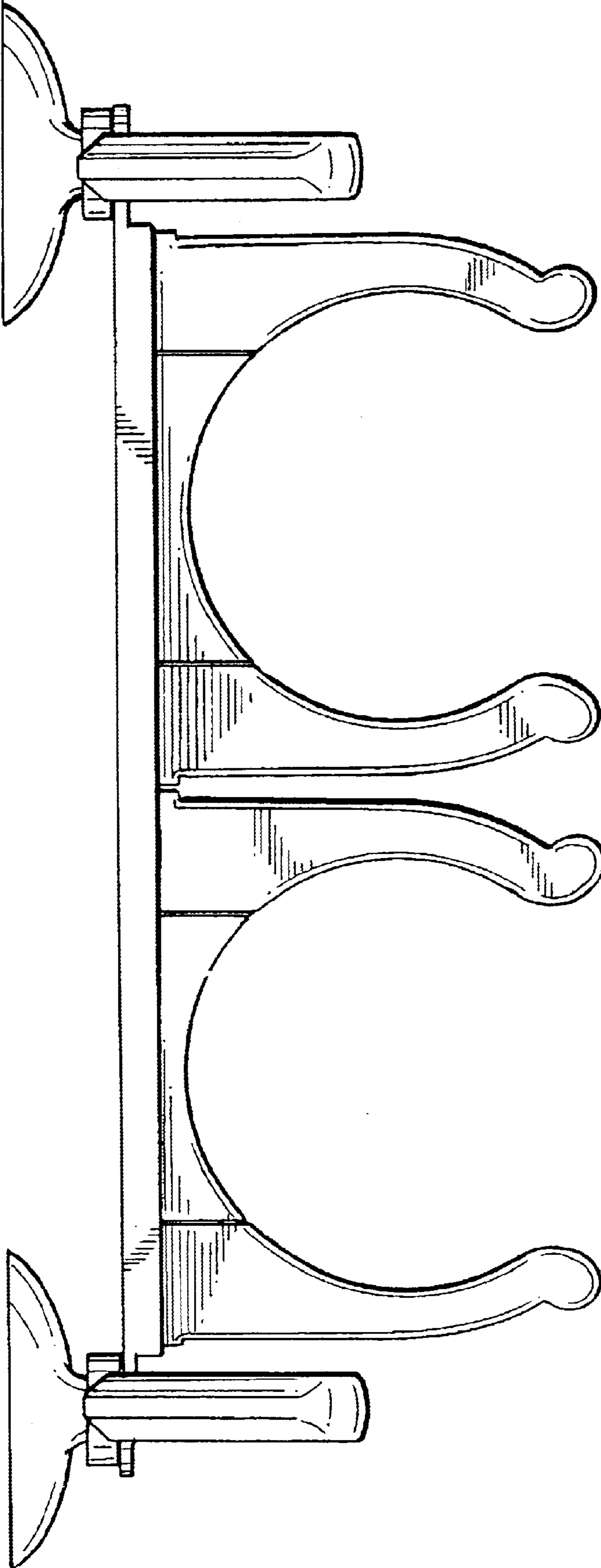

FIG. 1

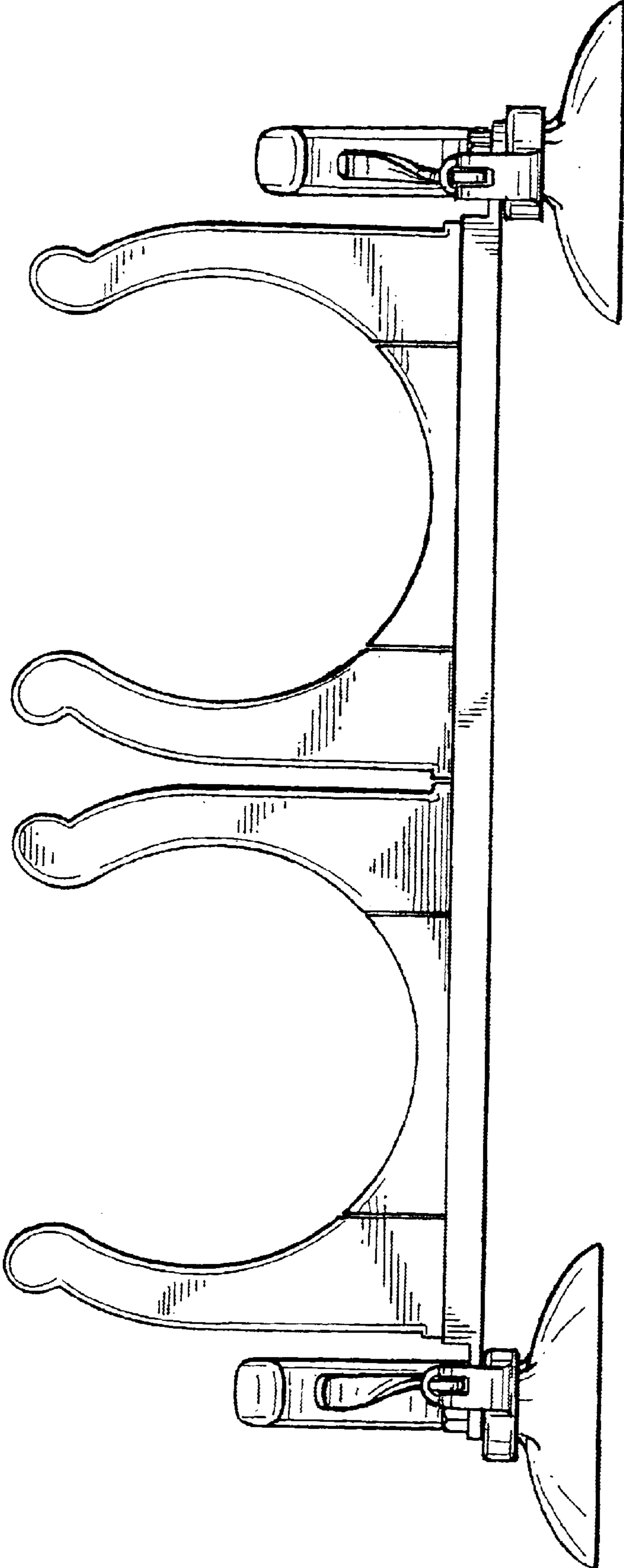

FIG. 2

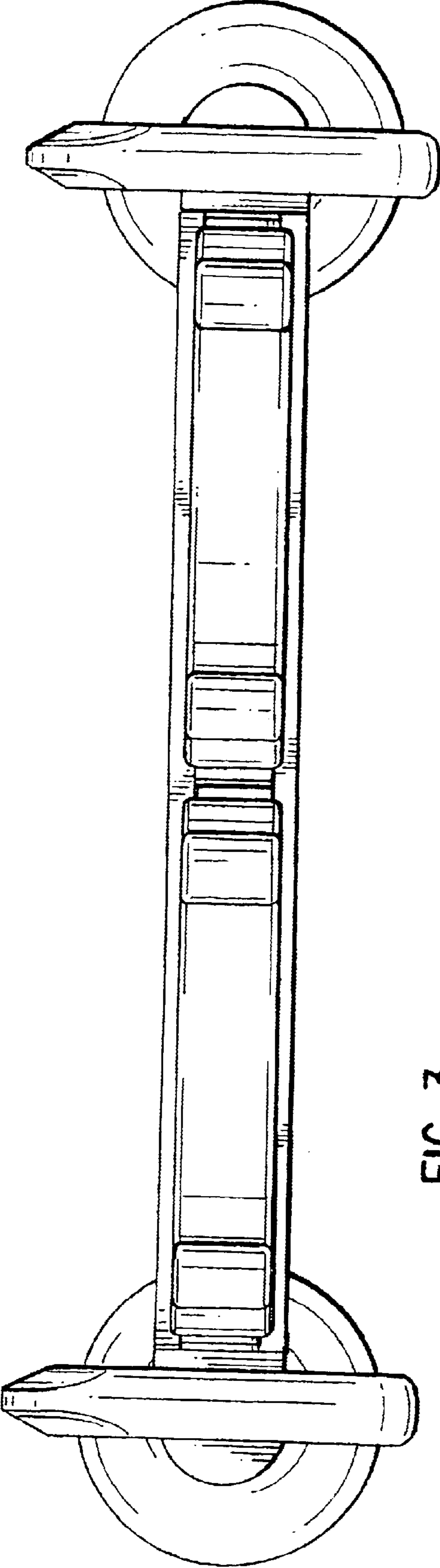

FIG. 3

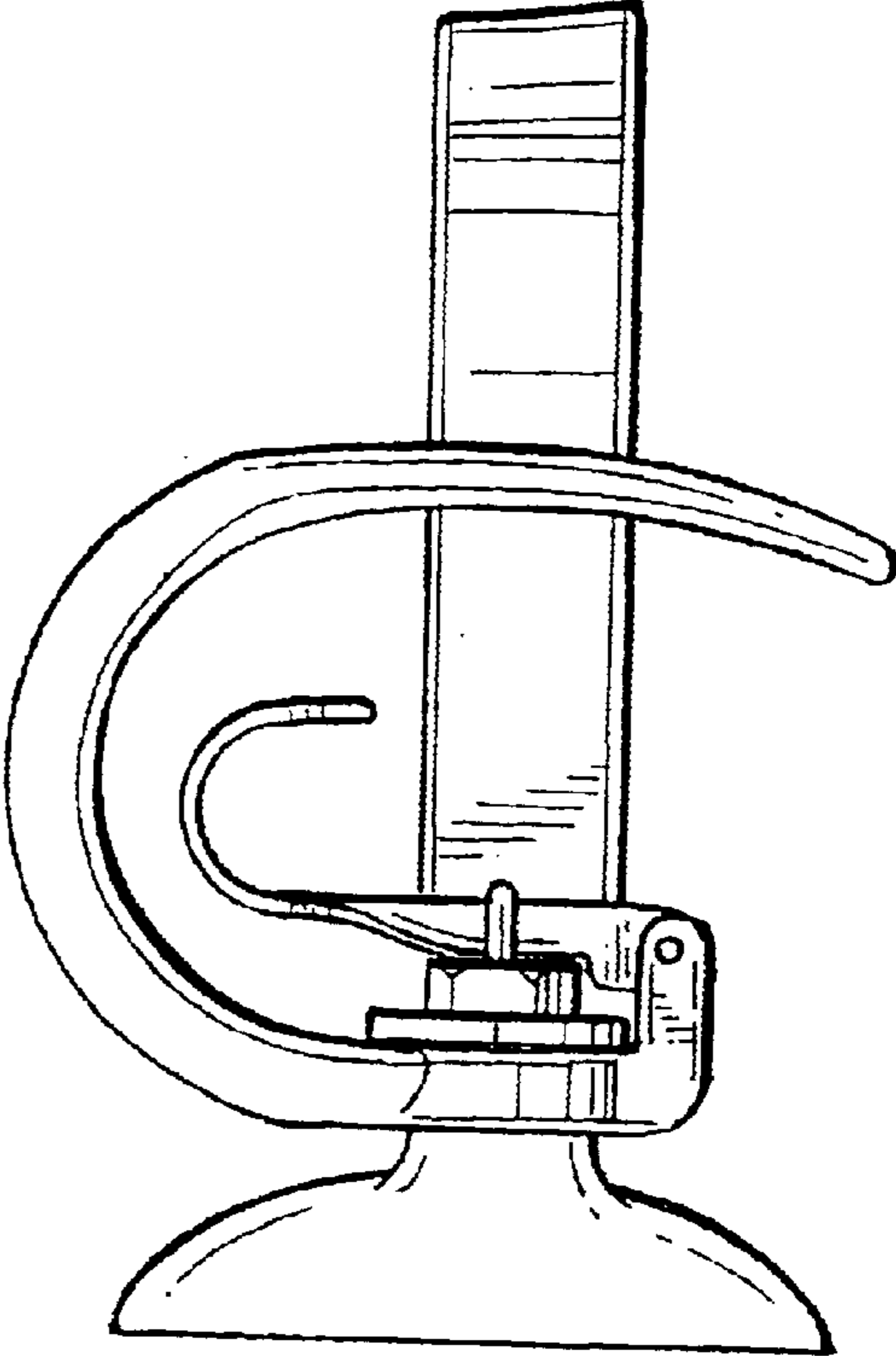

FIG. 4

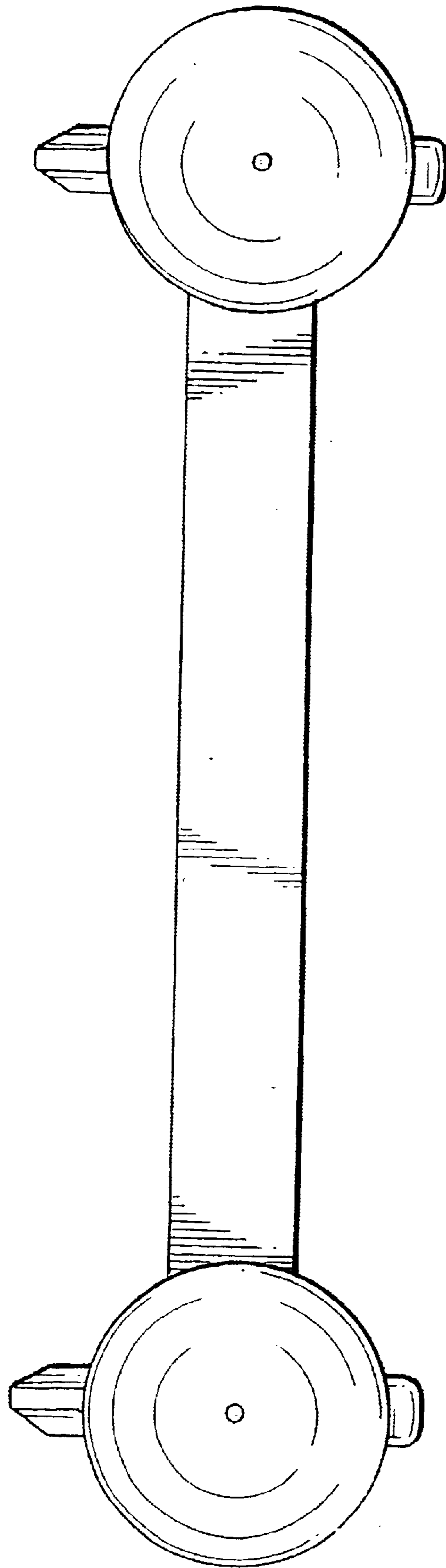

FIG. 5

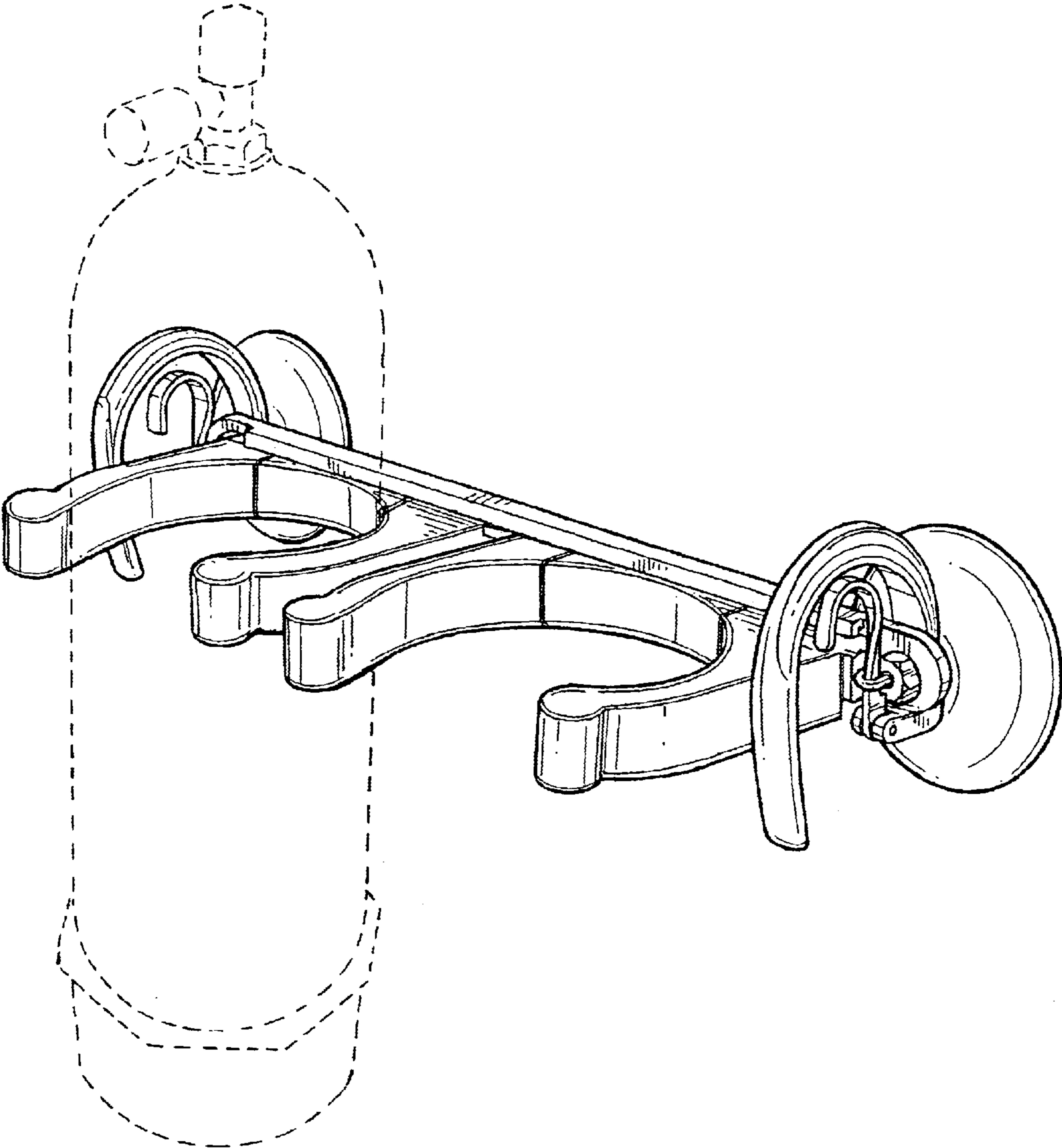

FIG. 6

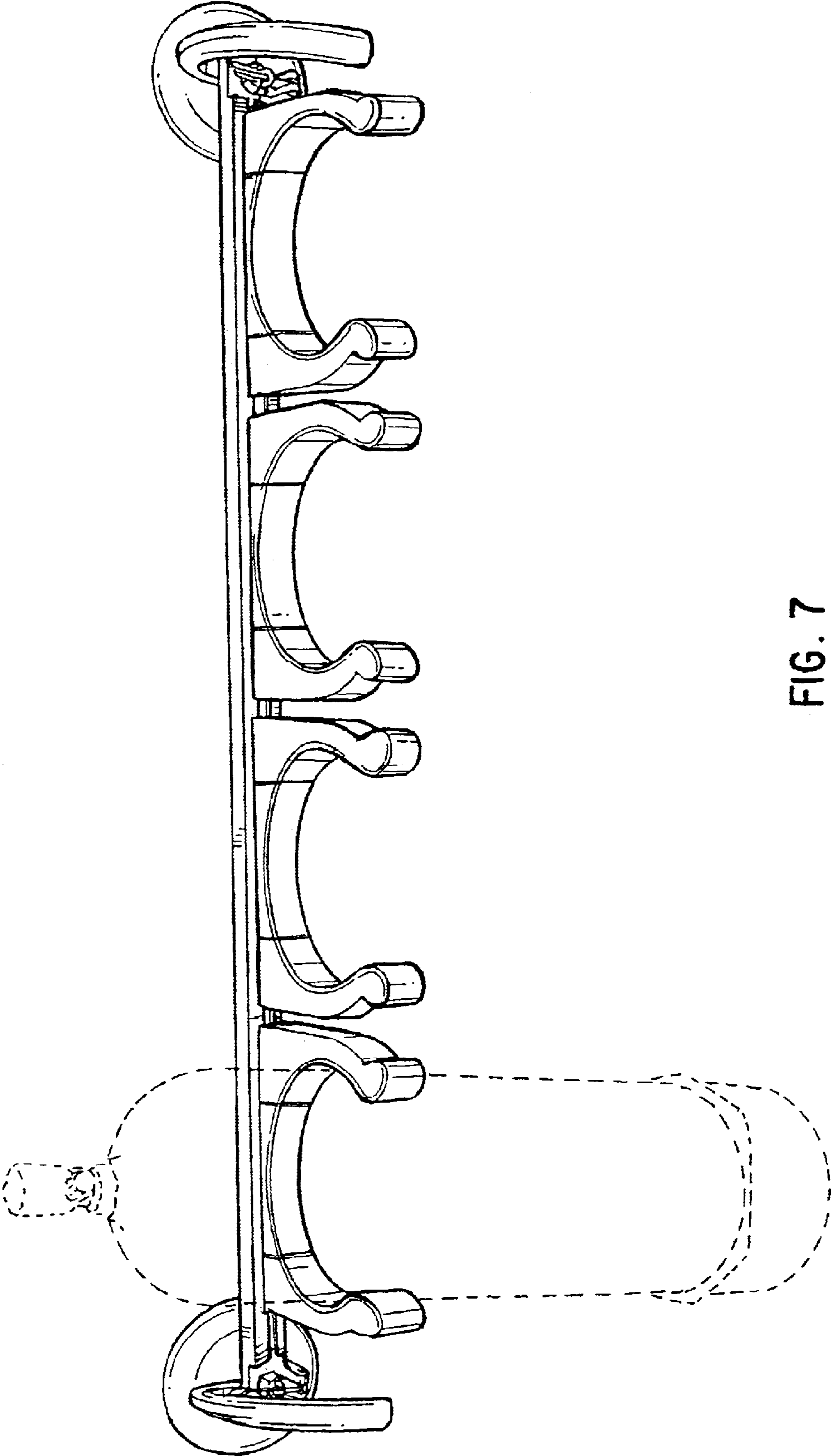

FIG. 7

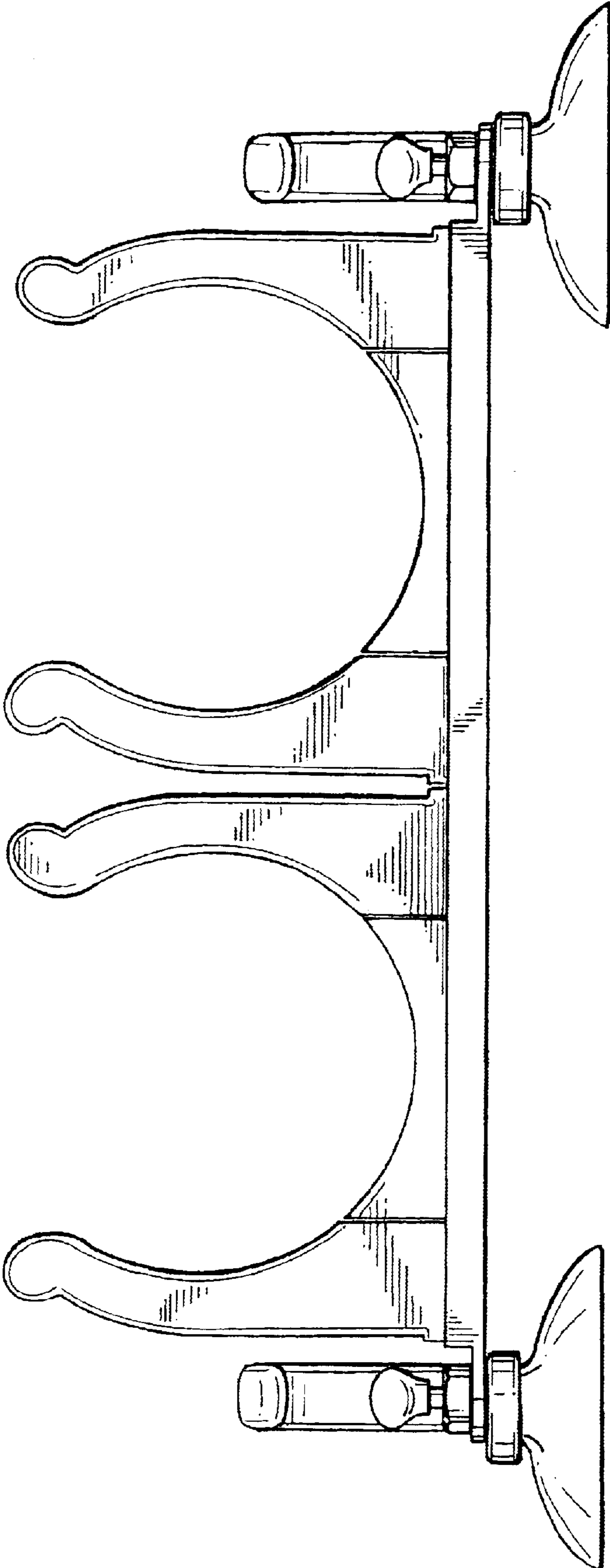

FIG. 8

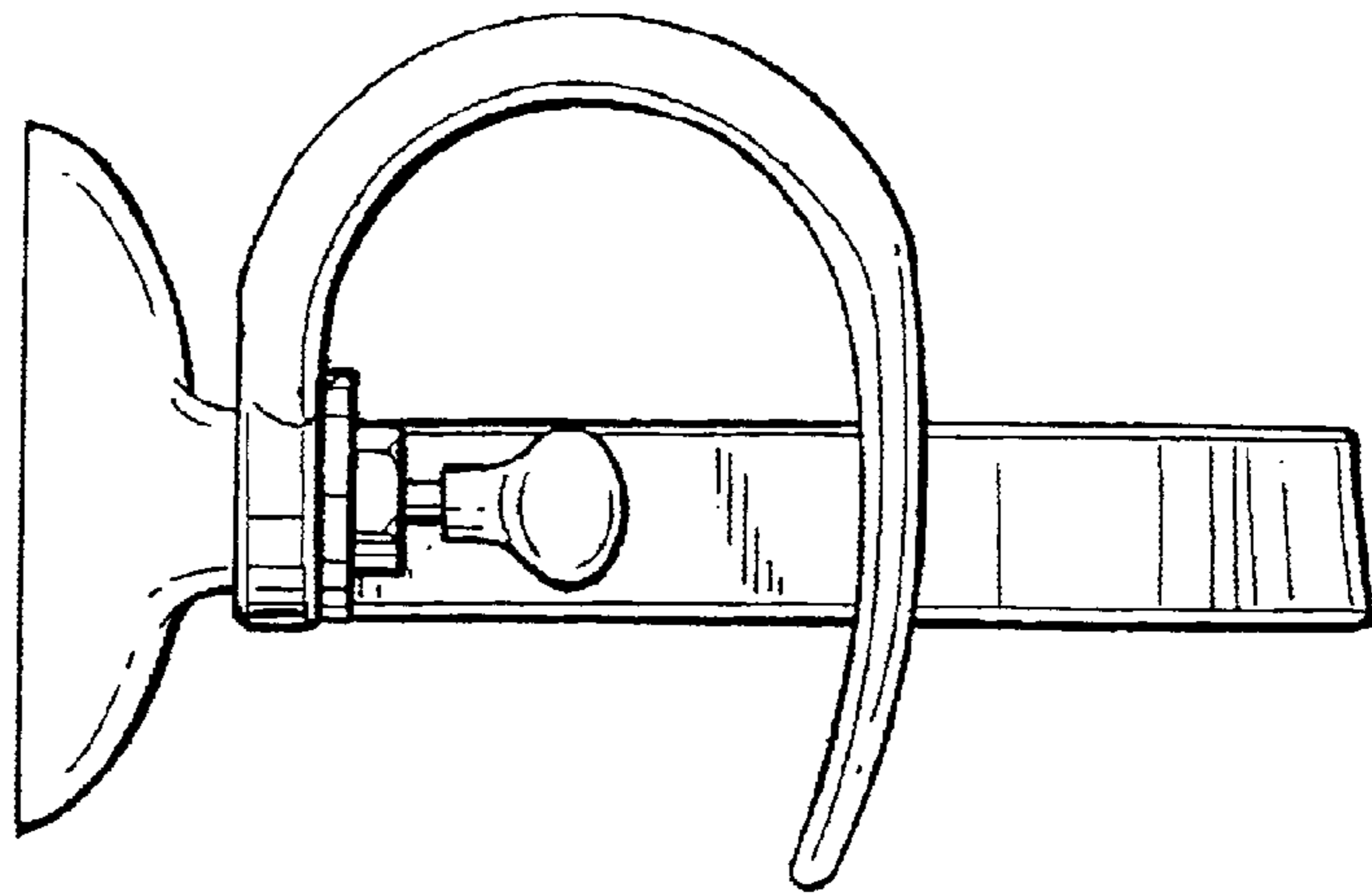

FIG. 9

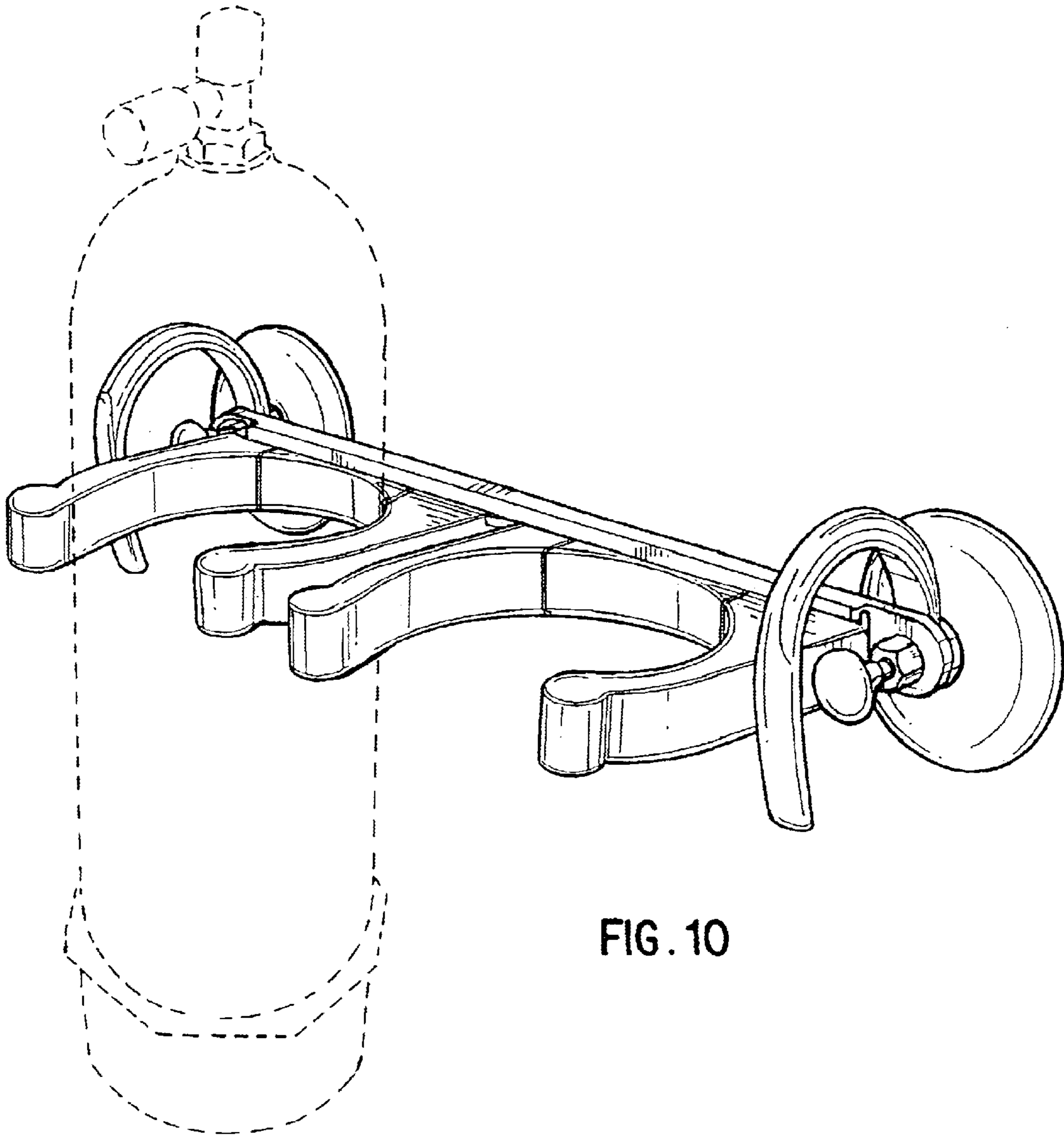

FIG. 10

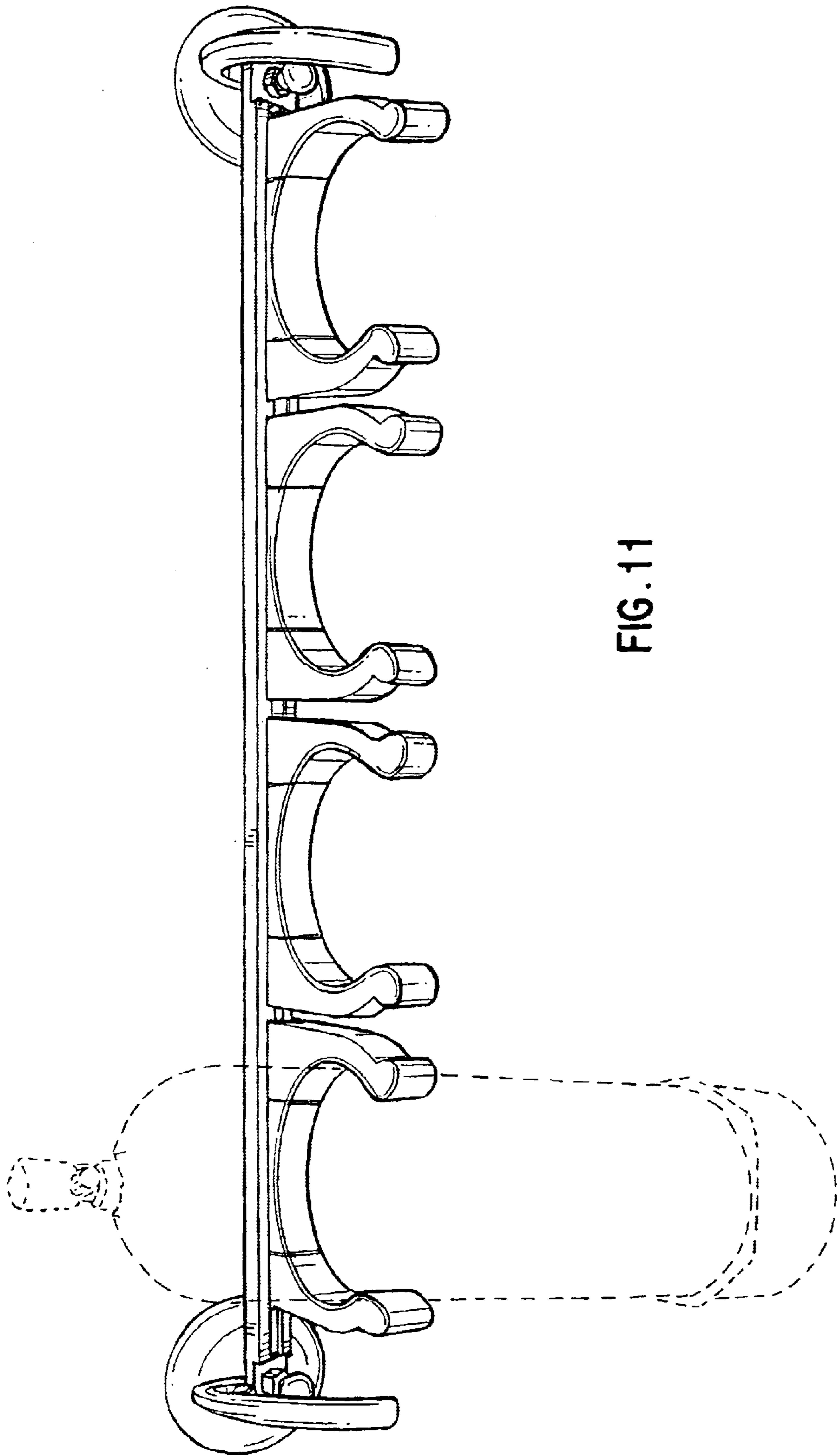

FIG. 11