

US00D508621S

(12) **United States Design Patent**
Brandon

(10) **Patent No.:** **US D508,621 S**

(45) **Date of Patent:** **** Aug. 23, 2005**

(54) **COMBINATION DESK AND HUTCH**

(75) **Inventor:** **John Bradford Brandon**, Attica, NY (US)

(73) **Assignee:** **Soft Office, LLC**, Jamestown, NY (US)

(**) **Term:** **14 Years**

(21) **Appl. No.:** **29/201,363**

(22) **Filed:** **Mar. 15, 2004**

(51) **LOC (8) Cl.** **06-03**

(52) **U.S. Cl.** **D6/426; D6/438**

(58) **Field of Search** D6/422-428, 436, D6/438, 480, 484, 485; 312/208.1, 238, 194-196, 204; 108/50.01, 50.02

(56) **References Cited**

U.S. PATENT DOCUMENTS

| | | | | | |
|-------------|---|--------|-----------------|-------|---------|
| D234,390 S | * | 2/1975 | Hodges | | D6/397 |
| D251,526 S | * | 4/1979 | Zapf | | D6/426 |
| D282,421 S | * | 2/1986 | Lewellen et al. | | D6/425 |
| 5,183,319 A | * | 2/1993 | Pearson et al. | | 312/196 |
| D459,619 S | * | 7/2002 | Glass | | D6/480 |

OTHER PUBLICATIONS

Modern Office 1993-94, p. 23 workstation at top right.*

* cited by examiner

Primary Examiner—Janice E. Seeger

(74) *Attorney, Agent, or Firm*—Coats & Bennett, P.L.L.C.

(57) **CLAIM**

The ornamental design for a combination desk and hutch, as shown and described.

DESCRIPTION

FIG. 1 is a perspective view of the combination desk and hutch.

FIG. 2 is a front elevational view of the combination desk and hutch; and,

FIG. 3 is a side elevational view of the combination desk and hutch with the opposite side being a mirror image of the same.

The top and bottom of the combination desk and hutch form no part of the claimed design.

The broken lines in the drawings form no part of the claimed design.

1 Claim, 3 Drawing Sheets

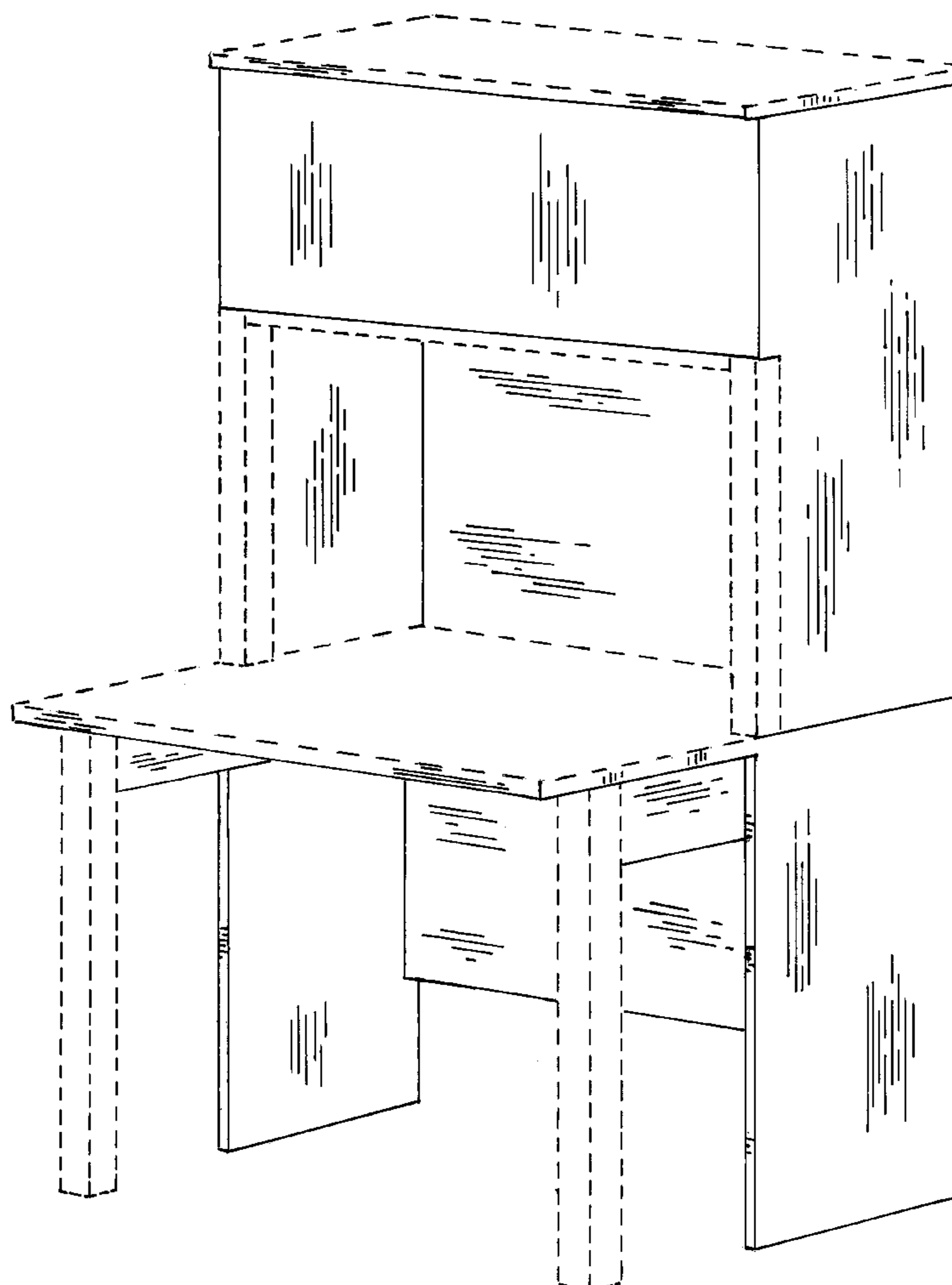

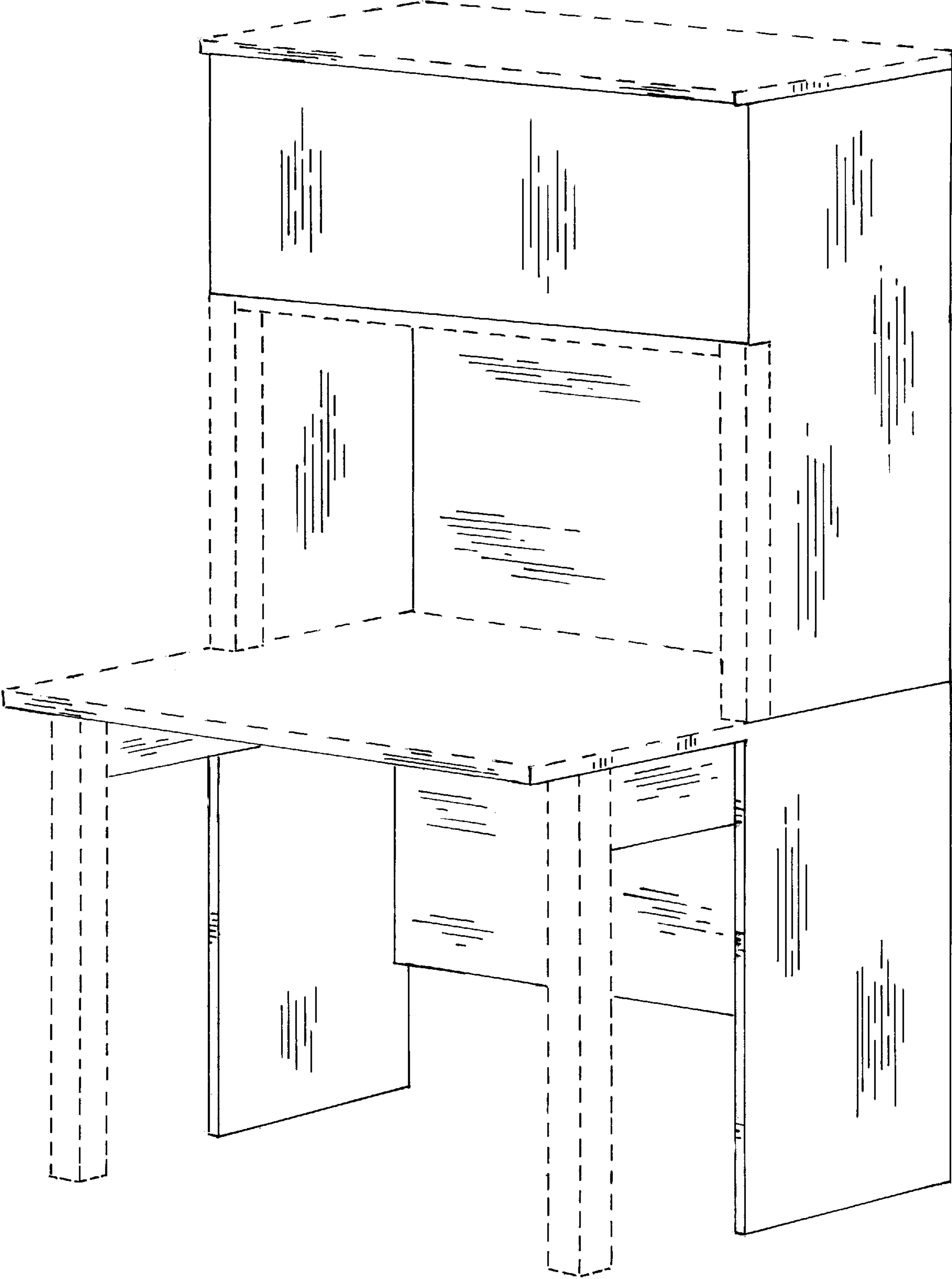

Fig. 1

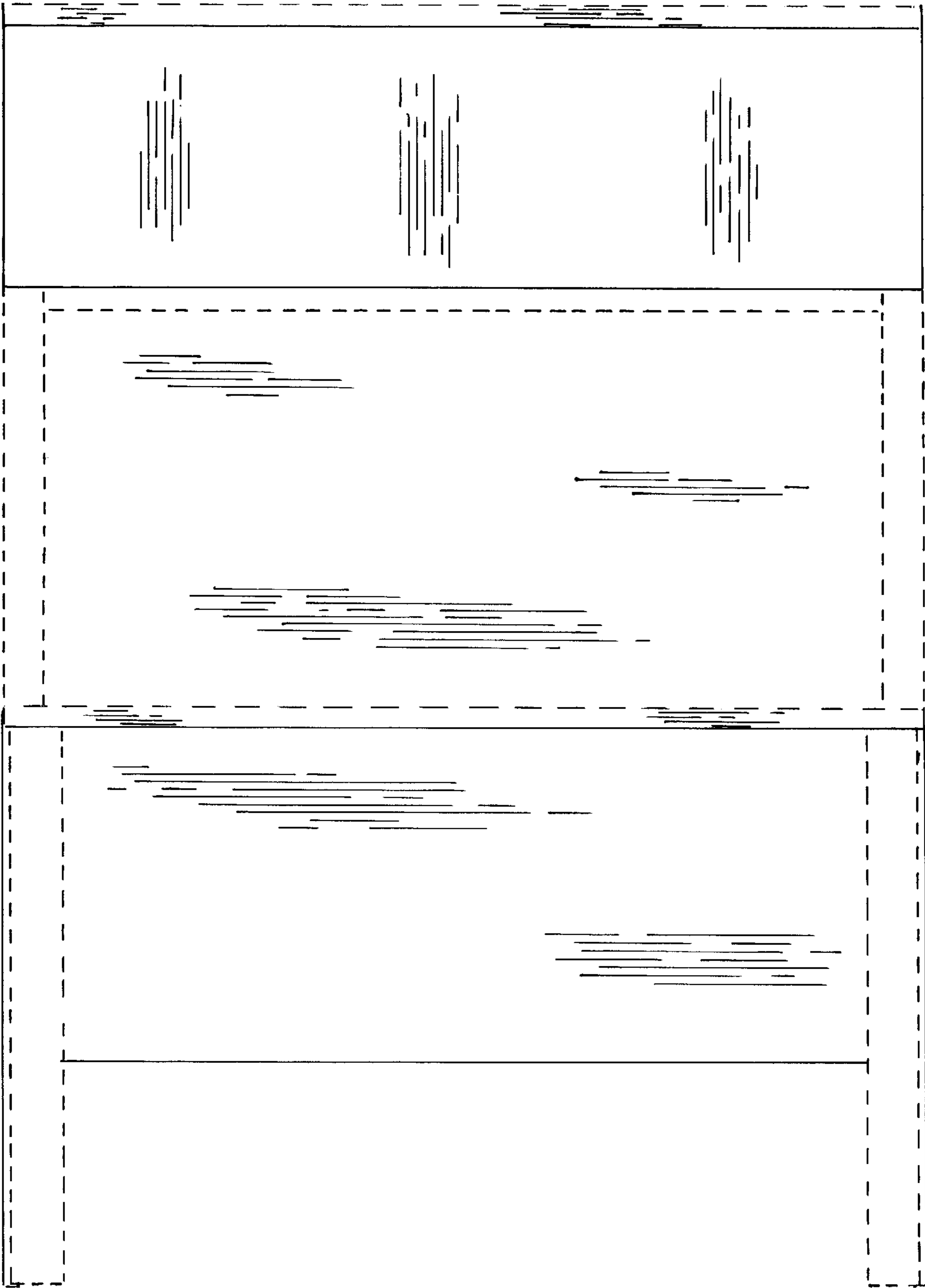

Fig. 2

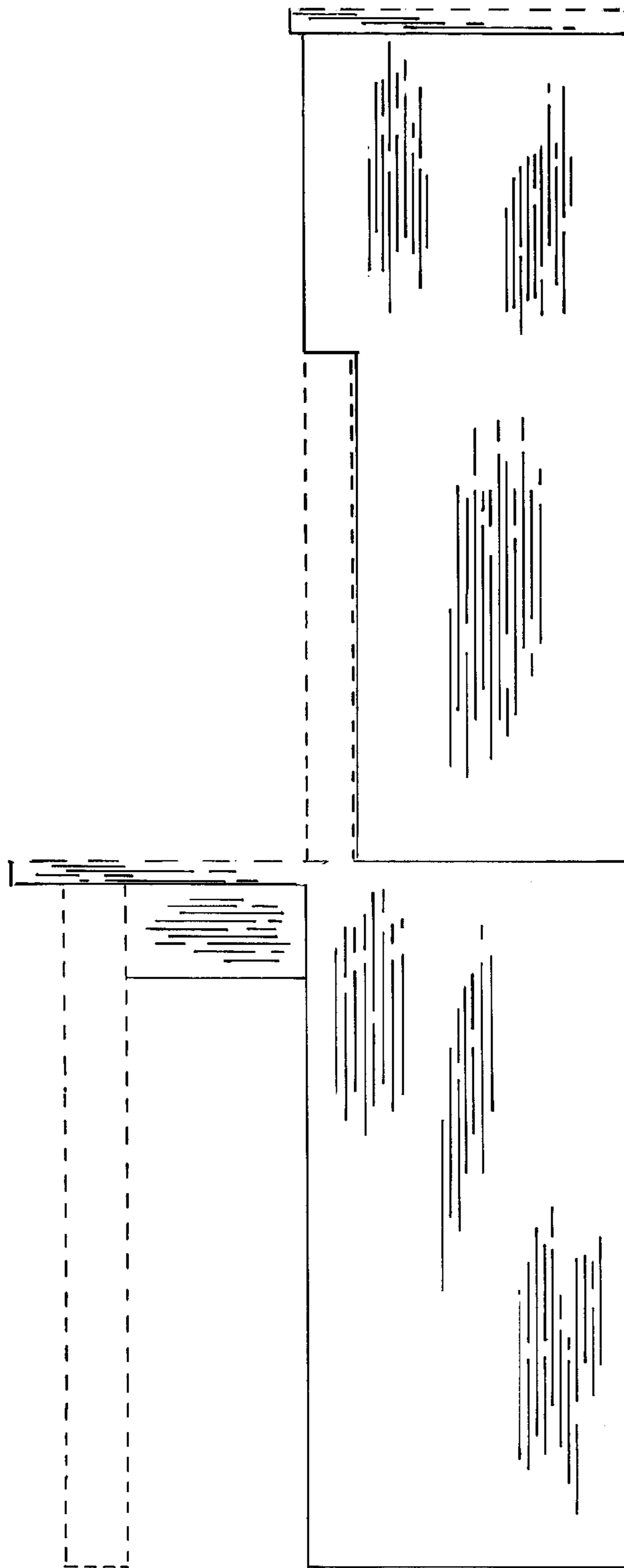

FIG. 3