



US00D507226S

(12) **United States Design Patent**
Oksa

(10) **Patent No.:** **US D507,226 S**

(45) **Date of Patent:** **** Jul. 12, 2005**

(54) **VEHICLE WHEEL CLAMP SUPPORT**

(76) **Inventor:** **Donald Leroy Oksa**, 2013 Edgebrook Ct., Arlington, TX (US) 76015

(**) **Term:** **14 Years**

(21) **Appl. No.:** **29/175,298**

(22) **Filed:** **Feb. 3, 2003**

(51) **LOC (8) Cl.** **12-06**

(52) **U.S. Cl.** **D12/223; D8/349**

(58) **Field of Search** D8/72, 330, 331, D8/341, 349, 354, 355, 394; 70/14, 18, 225, 226, 235, 258, 259, 260; 224/42.25; D12/223, 608; 248/300

5,833,034 A	*	11/1998	Banholzer	70/226
5,887,462 A	*	3/1999	Stone	70/226
D418,391 S	*	1/2000	Tsai	D8/330
D419,424 S	*	1/2000	Holden	D8/341
6,116,062 A	*	9/2000	Markegard et al.	70/226

* cited by examiner

Primary Examiner—Gary D. Watson

Assistant Examiner—T. Chase Nelson

(74) *Attorney, Agent, or Firm*—Guy V. Manning

(57) **CLAIM**

The ornamental design for vehicle wheel clamp support, as shown and described.

DESCRIPTION

FIG. 1 is a perspective view of the invention of the new design in use context;

FIG. 2 is a front elevational view of the design shown in FIG. 1 as seen from the right side of FIG. 1;

FIG. 3 is a rear elevational view of the design shown in FIG. 1;

FIG. 4 is a top plan view of the design shown in FIG. 1;

FIG. 5 is a bottom plan view of the design shown in FIG. 1;

FIG. 6 is a left side elevational view of the design shown in FIG. 1; and,

FIG. 7 is a right side elevational view of the design shown in FIG. 1.

The broken line showing of environmental structure in FIG. 1 is for illustrative purposes only and forms no part of the claimed design.

(56) **References Cited**

U.S. PATENT DOCUMENTS

1,900,314 A	*	3/1933	Strom	7/100
D204,491 S	*	4/1966	Neill	D8/355
D265,081 S	*	6/1982	Zielinski	D12/608
D276,696 S	*	12/1984	Spinka	D8/349
4,651,849 A	*	3/1987	Givati	70/225
D348,197 S	*	6/1994	Denman	D8/72
5,375,442 A	*	12/1994	Hammer	70/14
5,385,038 A	*	1/1995	Walker	70/226
D358,698 S	*	5/1995	Henry	D8/331
D373,718 S	*	9/1996	Rondeau	D8/349
D374,600 S	*	10/1996	Buttner	D8/331
D392,933 S	*	3/1998	Mattila	D12/223
5,735,410 A	*	4/1998	Kallstrom	70/235
D395,592 S	*	6/1998	Clavel et al.	D8/354

1 Claim, 4 Drawing Sheets

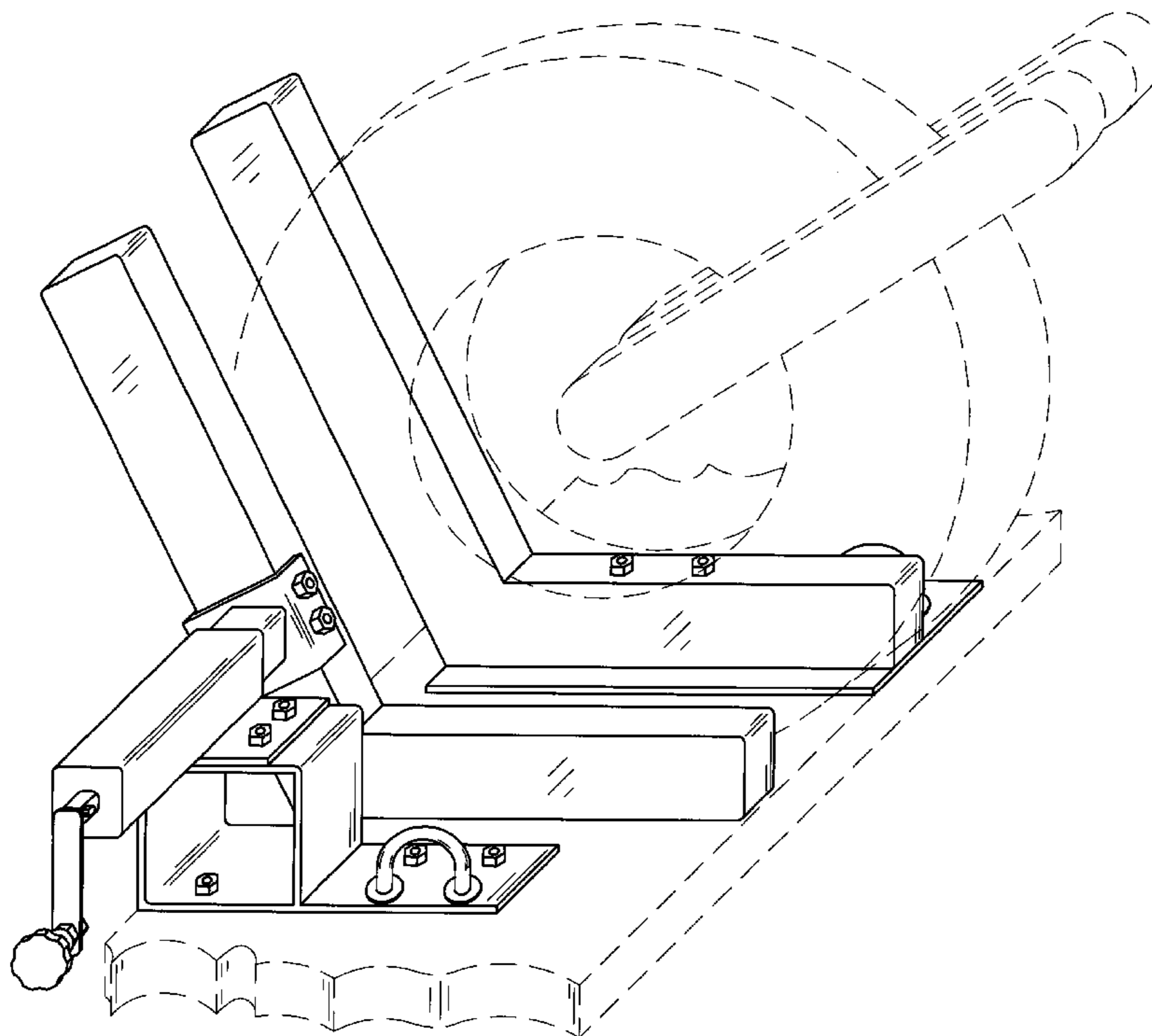

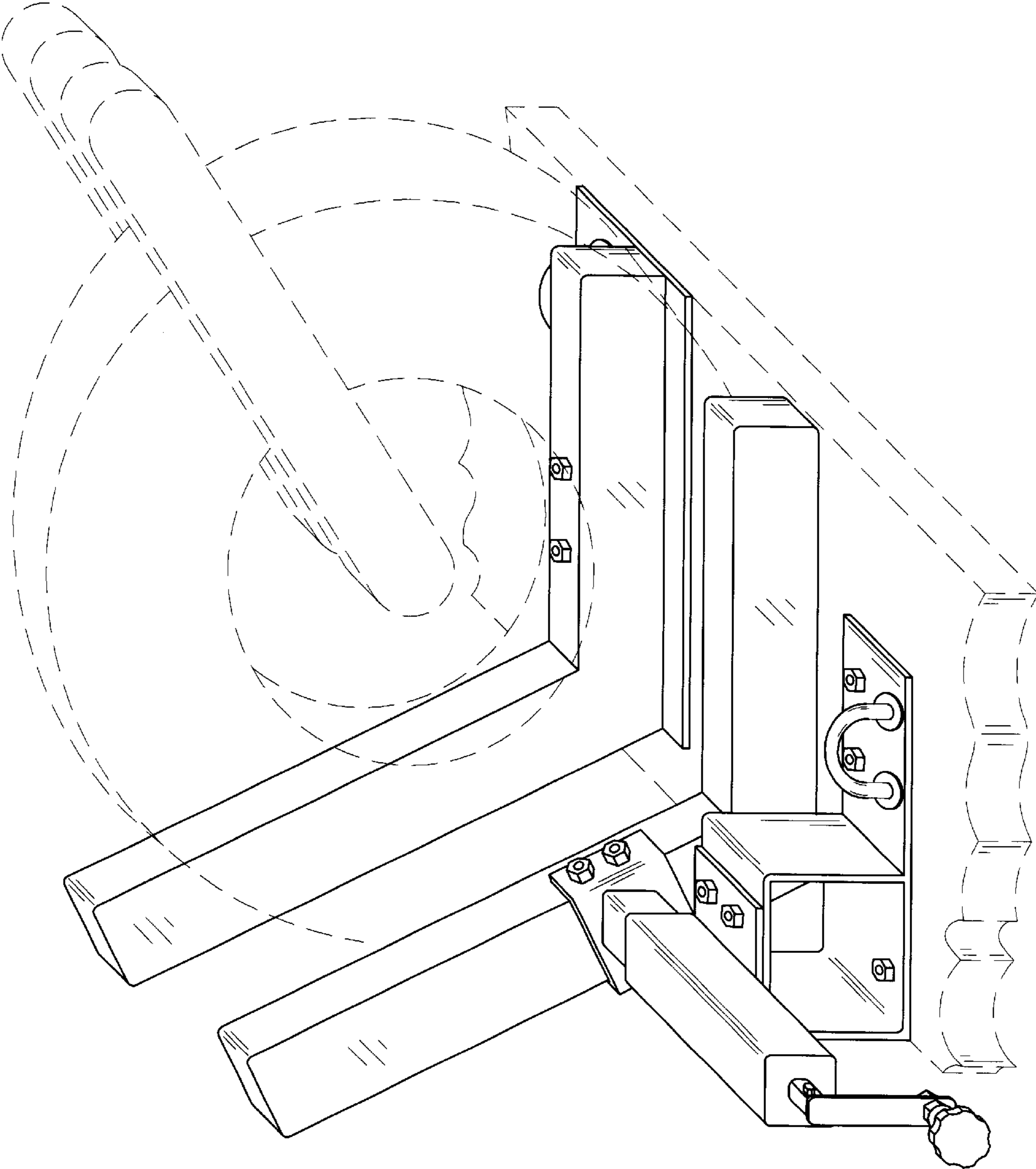

Fig. 1

Fig. 2

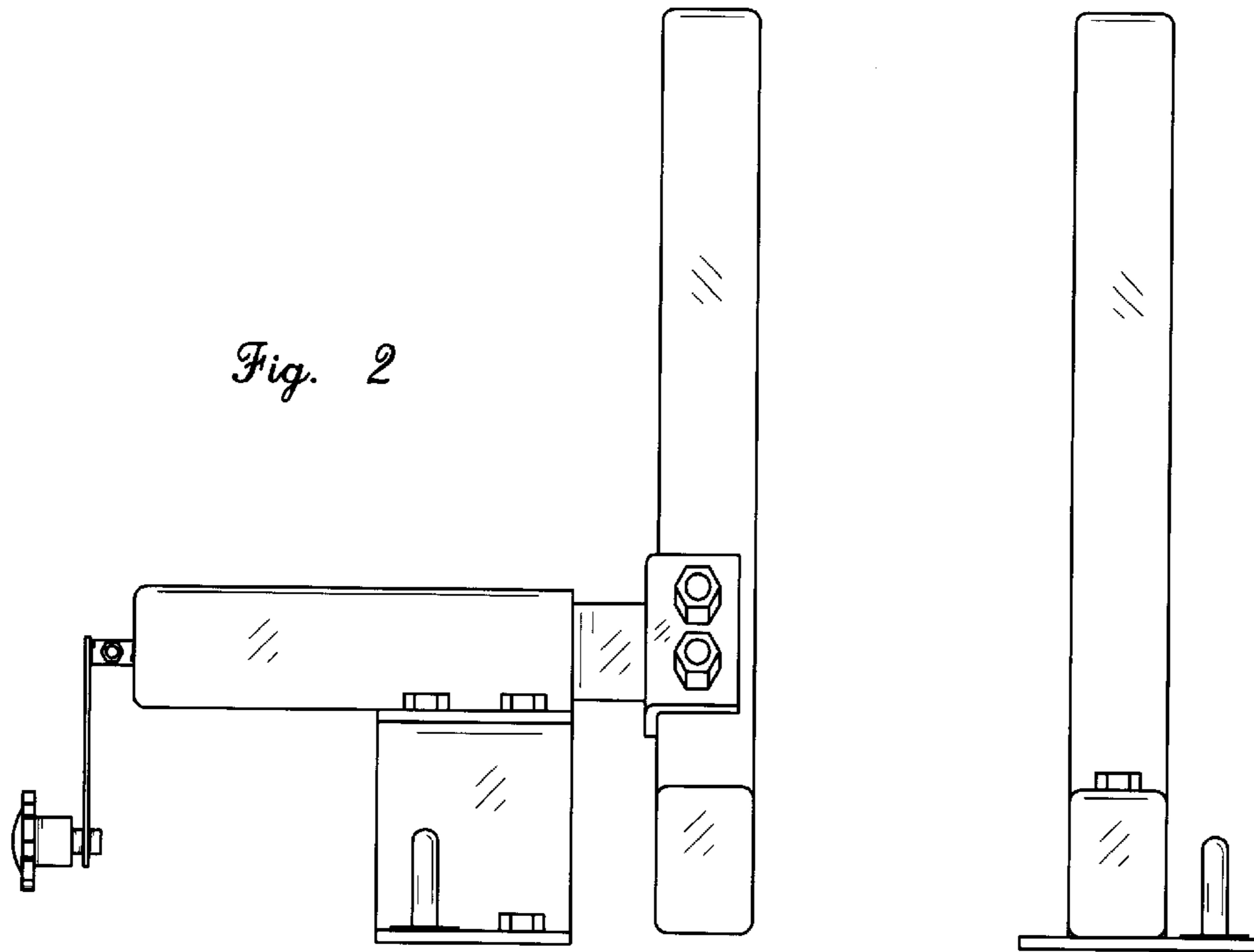

Fig. 3

