

US00D506760S

(12) **United States Design Patent**
Lin et al.

(10) **Patent No.: US D506,760 S**
(45) **Date of Patent: ** Jun. 28, 2005**

(54) **INTERNAL COMBUSTION ENGINE**

D396,476 S * 7/1998 Shimizu D15/1
D474,783 S * 5/2003 Momoi D15/1
D488,167 S * 4/2004 Momoi D15/1

(75) Inventors: **Tsang-Mao Lin**, Kaohsiung (TW);
San-Chi Lee, Kaohsiung (TW)

* cited by examiner

(73) Assignee: **Kwang Yang Motor Co., Ltd.**,
Kaohsiung (TW)

Primary Examiner—Joel Sincavage
Assistant Examiner—Maurice Stevens

(**) Term: **14 Years**

(74) *Attorney, Agent, or Firm*—Rosenberg, Klein & Lee

(21) Appl. No.: **29/200,859**

(57) **CLAIM**

(22) Filed: **Mar. 8, 2004**

We claim, the ornamental design or an internal combustion engine, as shown and described.

(51) **LOC (8) Cl. 15-01**

(52) **U.S. Cl. D15/1**

(58) **Field of Search D15/1, 3**

DESCRIPTION

(56) **References Cited**

U.S. PATENT DOCUMENTS

D293,114 S * 12/1987 Brogdon D15/1
D307,147 S * 4/1990 Sasaki et al. D15/1
D353,381 S * 12/1994 Yoshida et al. D15/1
D367,070 S * 2/1996 Maeda et al. D15/1
D396,045 S * 7/1998 Neeley D15/1

FIG. 1 is a perspective view of an internal combustion engine showing our present design;
FIG. 2 is a front view thereof;
FIG. 3 is a rear view thereof;
FIG. 4 is a left view thereof;
FIG. 5 is a right view thereof;
FIG. 6 is a top plan view thereof; and,
FIG. 7 is a bottom plan view.

1 Claim, 7 Drawing Sheets

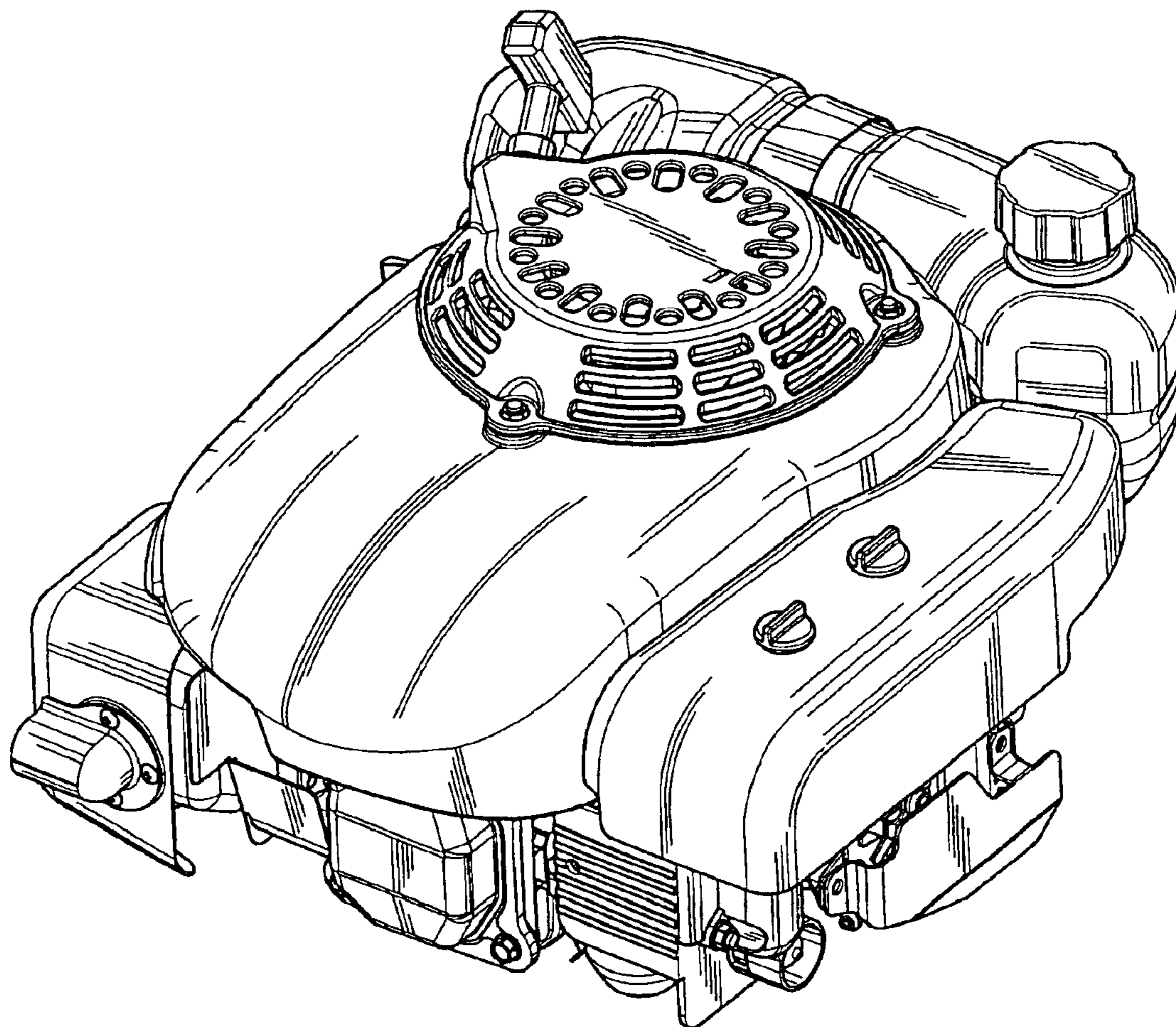

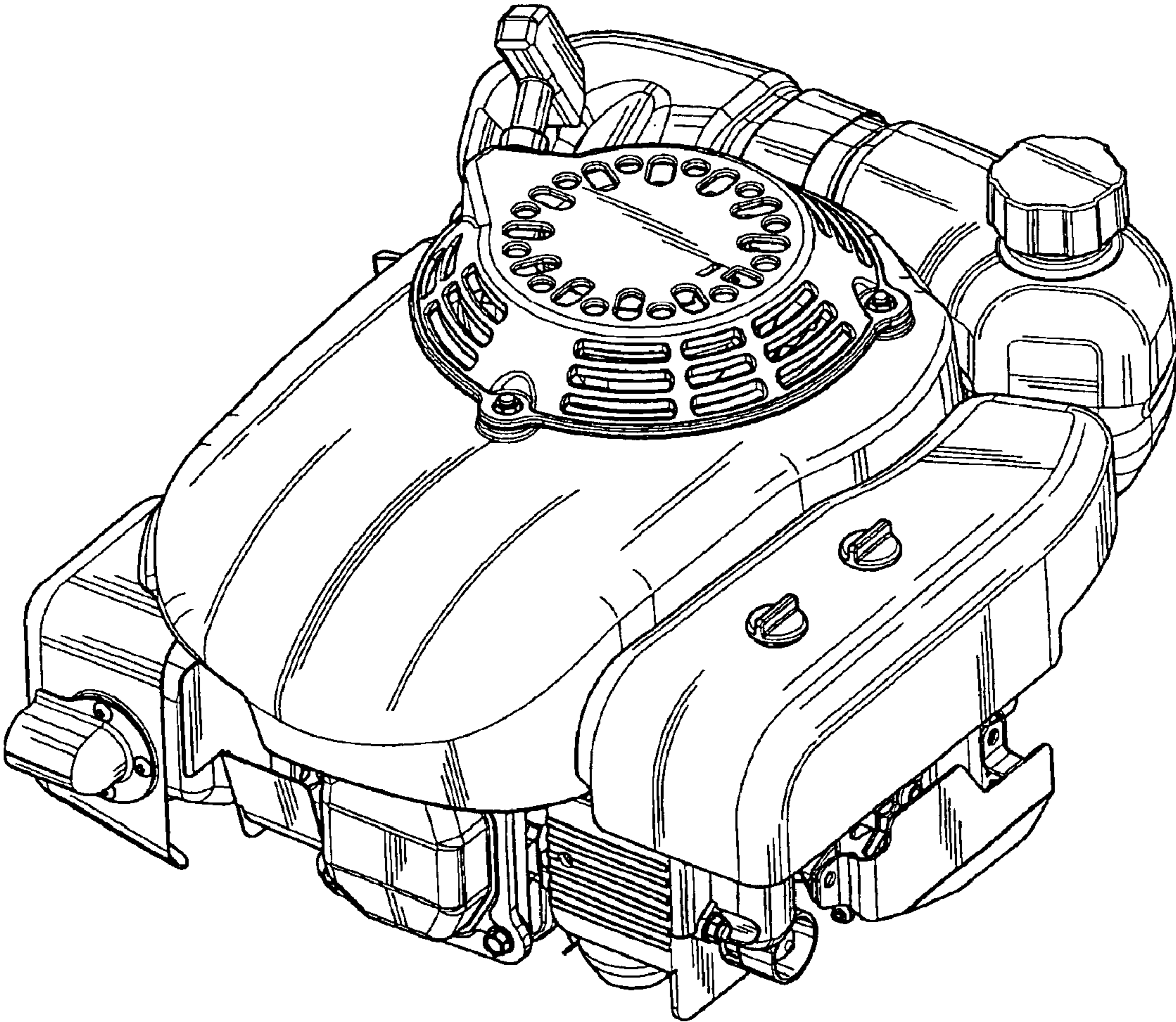

FIG. 1

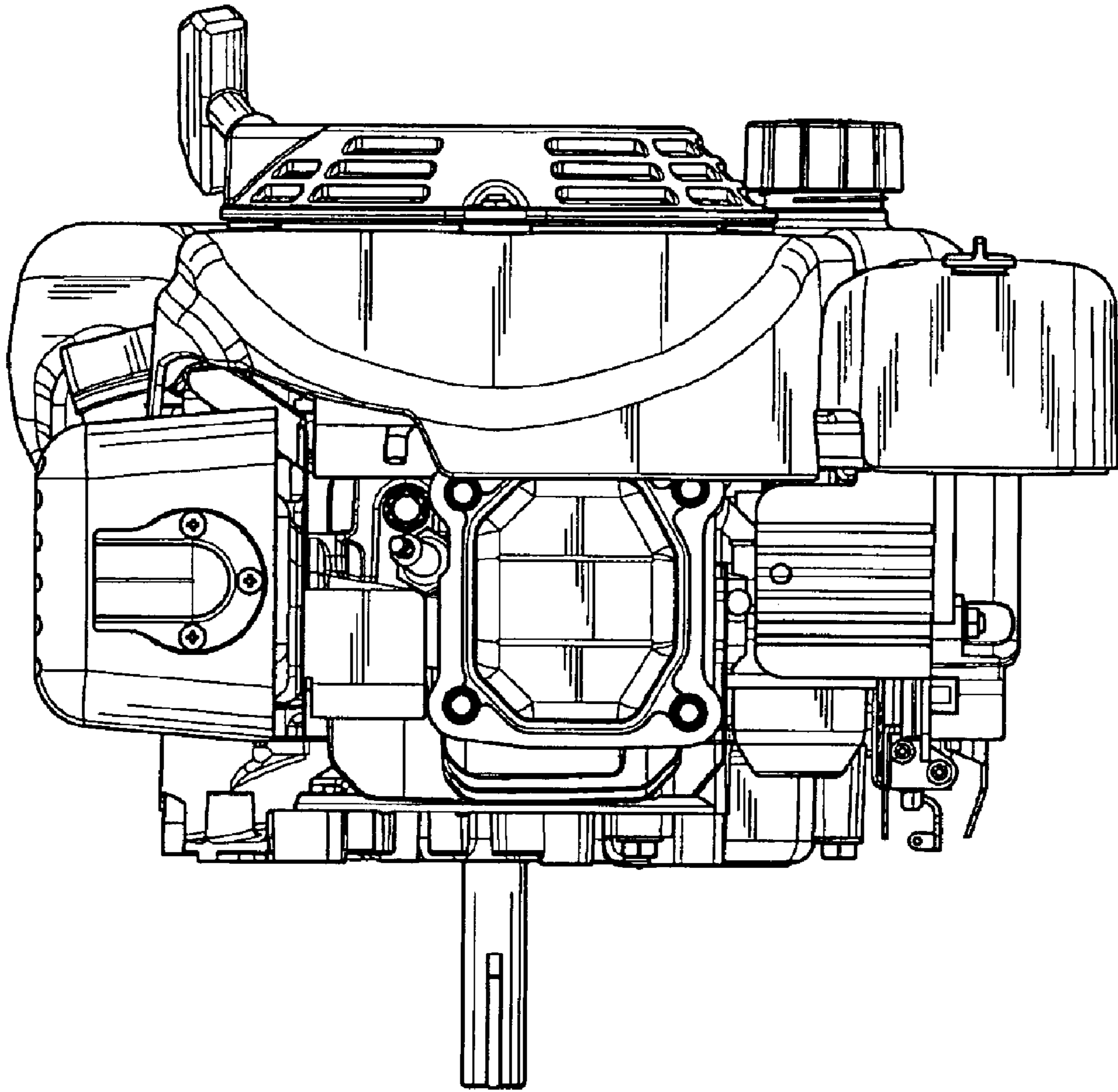

FIG. 2

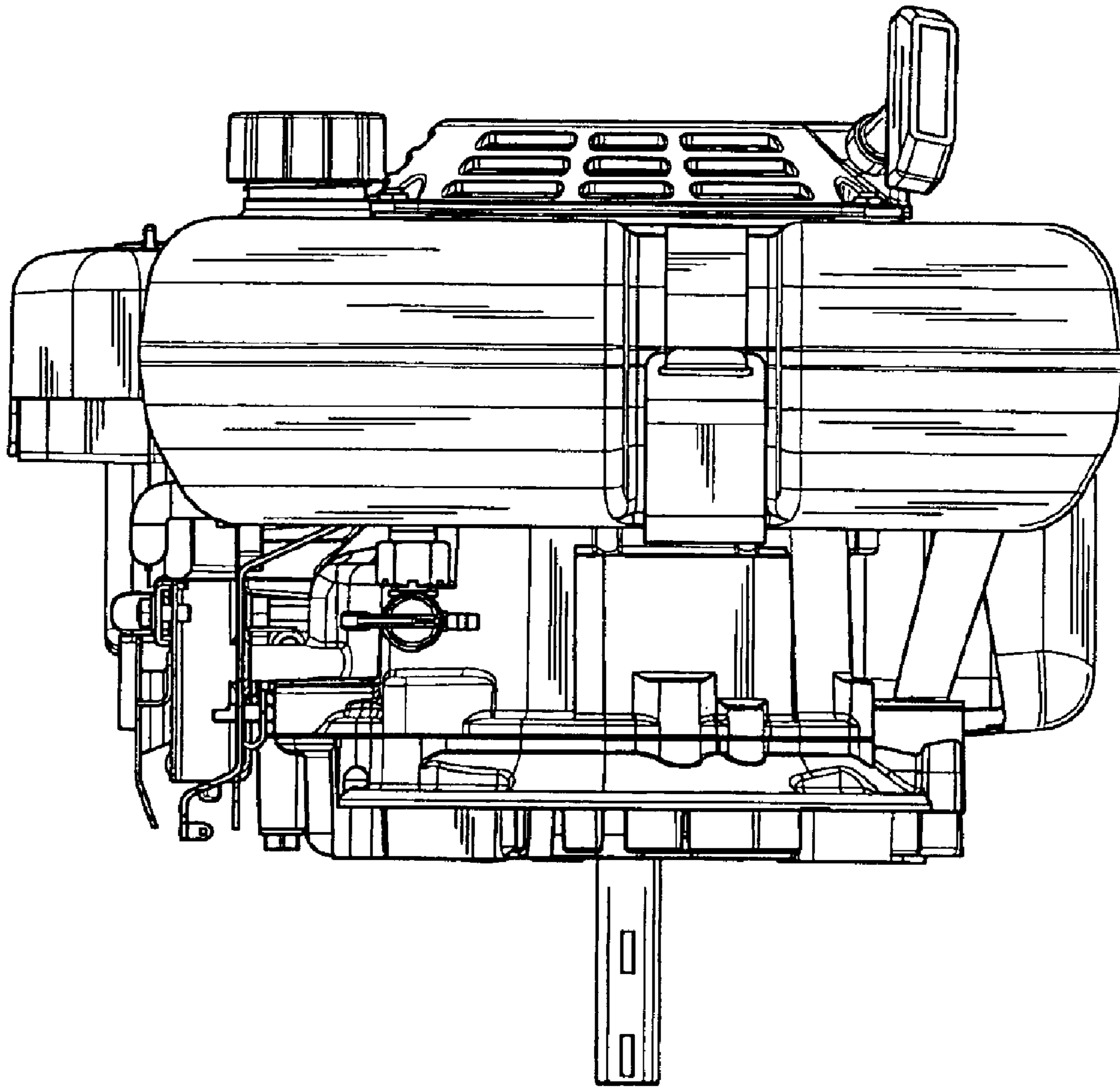

FIG. 3

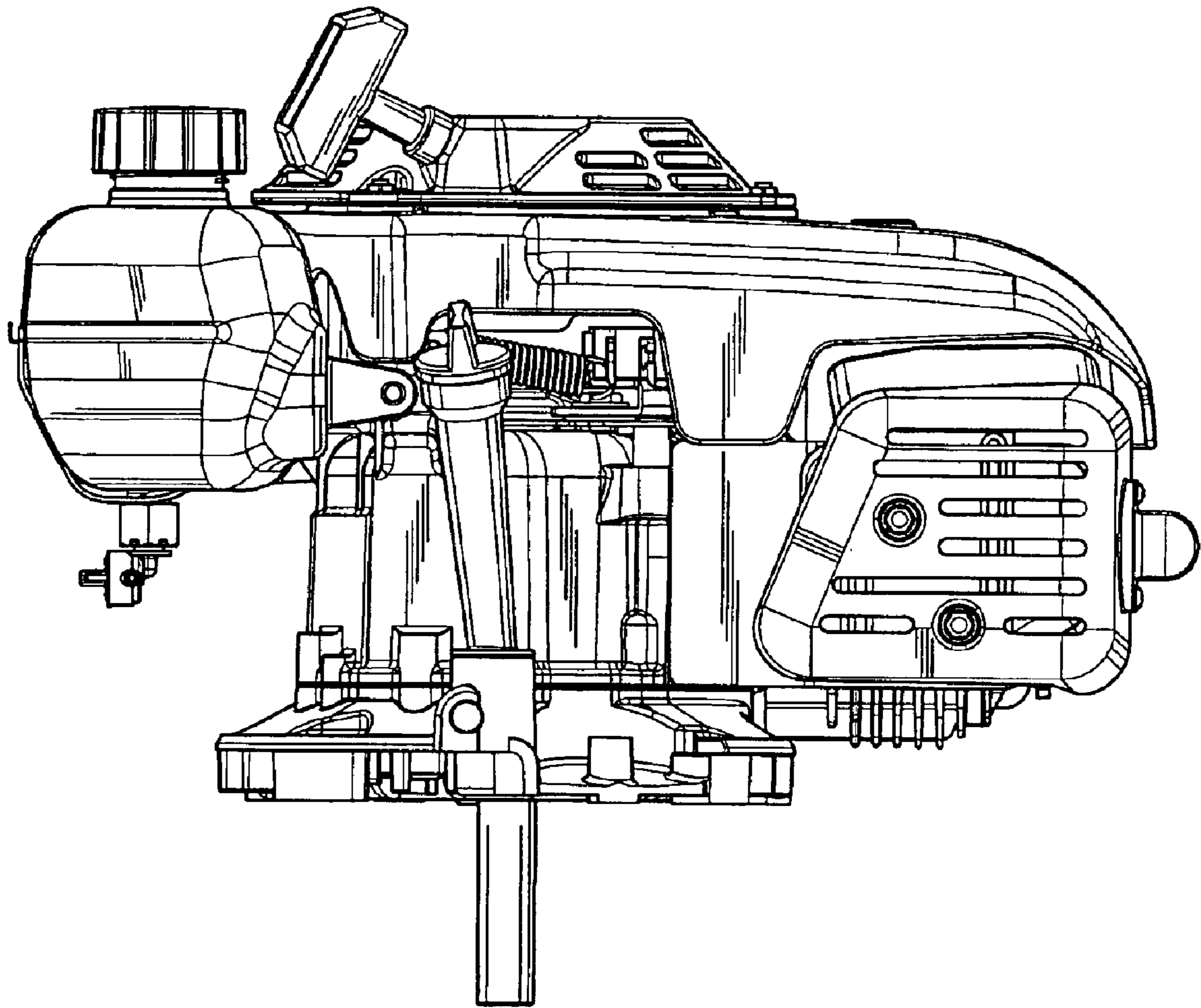

FIG. 4

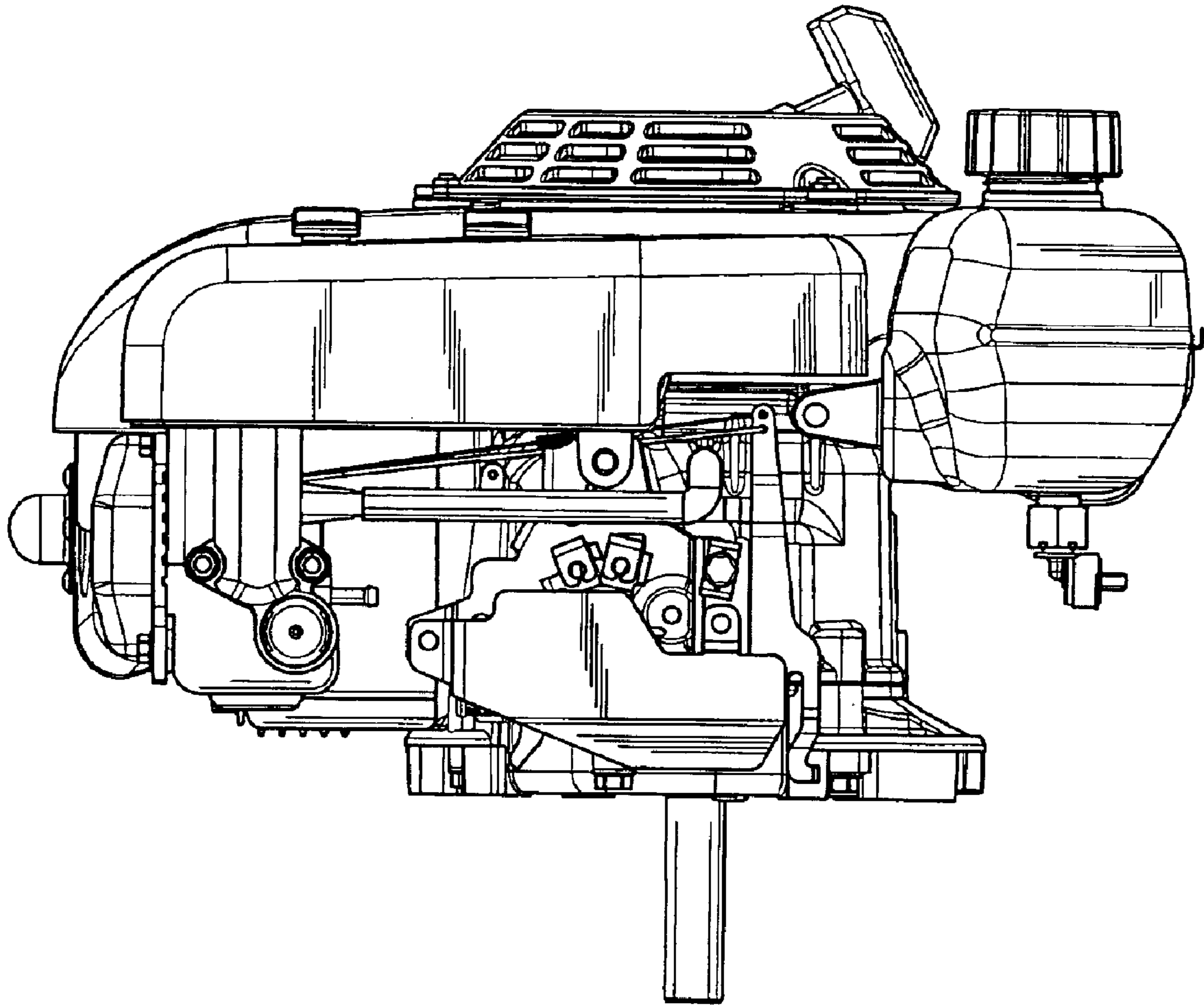

FIG. 5

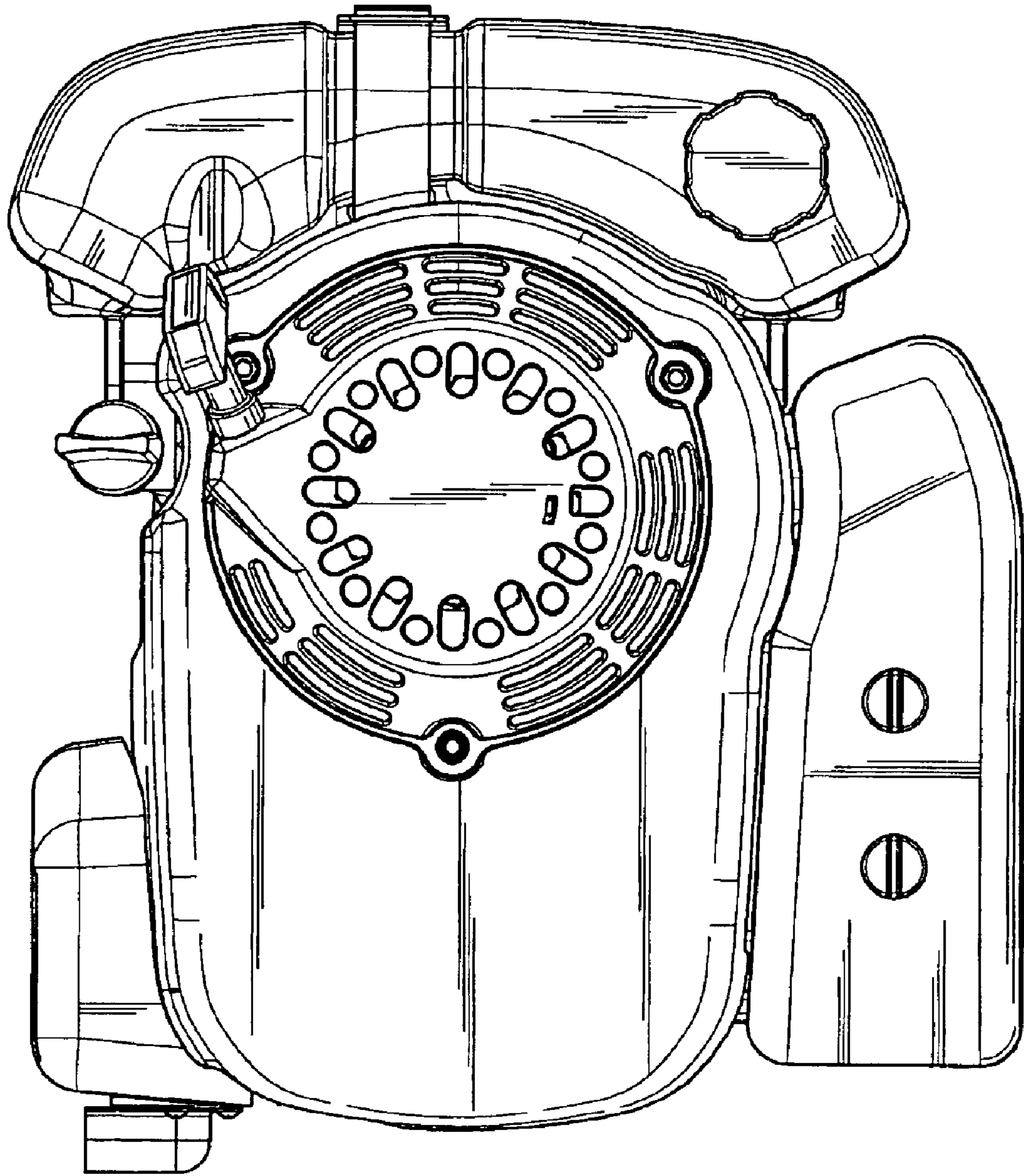

FIG. 6

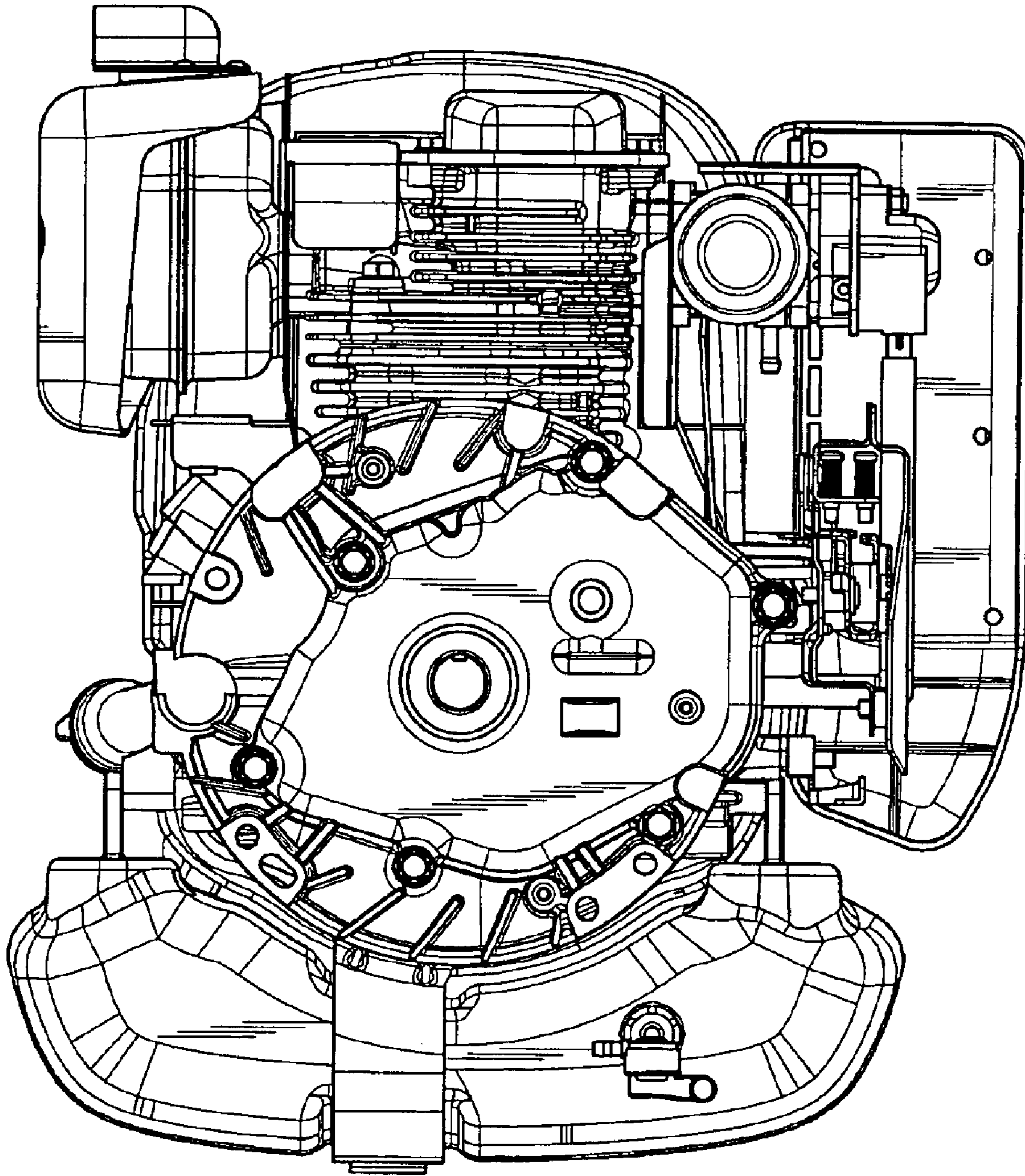

FIG. 7