

US00D506263S

(12) **United States Design Patent**
Wang

(10) **Patent No.:** **US D506,263 S**
(45) **Date of Patent:** **** Jun. 14, 2005**

(54) **HOURGLASS DESIGN BARZEBO WITH OVERHANG**

6,349,511 B1 * 2/2002 McAlpin et al. 52/82

* cited by examiner

(76) **Inventor:** **Leo Chi-Hong Wang**, 16033 Arrow Highway, Arcadia, CA (US) 91706

Primary Examiner—Doris Clark

(**) **Term:** **14 Years**

(57) **CLAIM**

The ornamental design for an hourglass design barzebo with overhang, as shown and described.

(21) **Appl. No.:** **29/202,476**

(22) **Filed:** **Mar. 31, 2004**

DESCRIPTION

(51) **LOC (8) Cl.** **25-02**

FIG. 1 is a front elevation view of the hourglass design barzebo with overhang of my new design.

(52) **U.S. Cl.** **D25/56; D25/1**

FIG. 2 is a rear elevation view thereof.

(58) **Field of Search** **D25/56, 1; 52/82,**

FIG. 3 is a side view thereof.

52/87; 135/87, 90, 908, 907

FIG. 4 is a top view thereof; and,

(56) **References Cited**

FIG. 5 is a cross-sectional view taken along line 5—5 of FIG. 1.

U.S. PATENT DOCUMENTS

D277,137 S * 1/1985 Van der Upwich D25/1

D296,593 S * 7/1988 Alpert D25/1

1 Claim, 5 Drawing Sheets

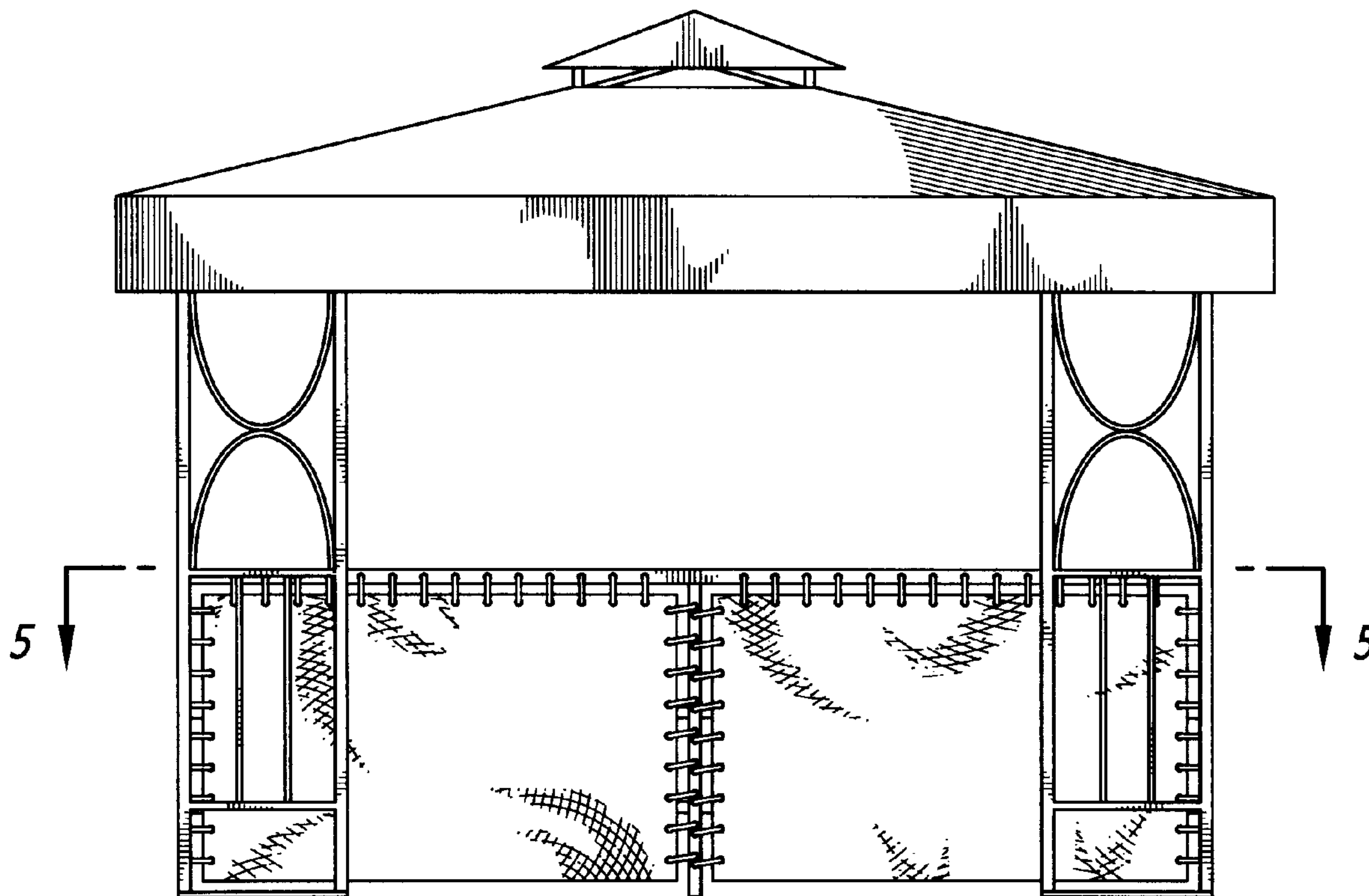

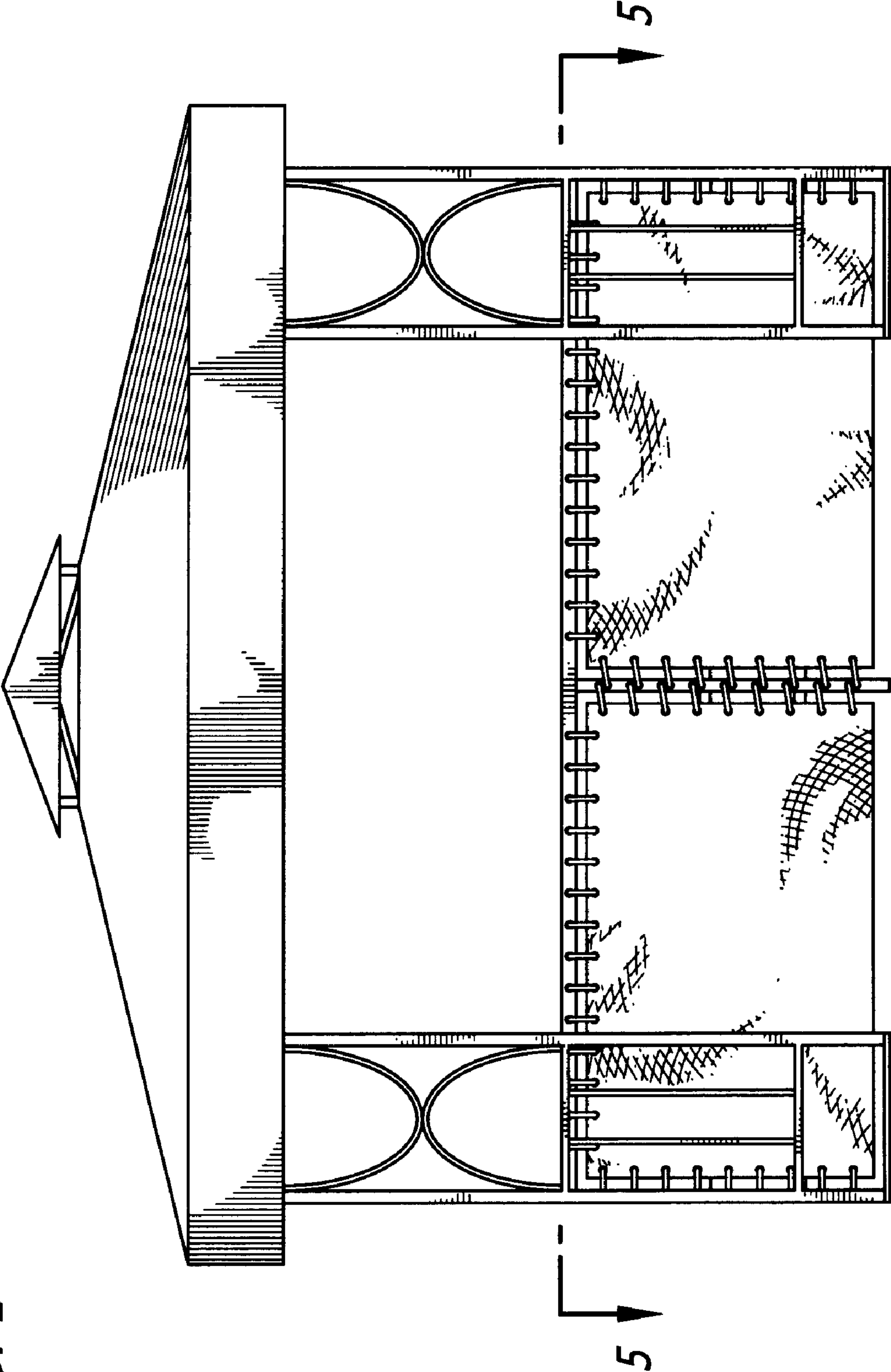

FIG. 1

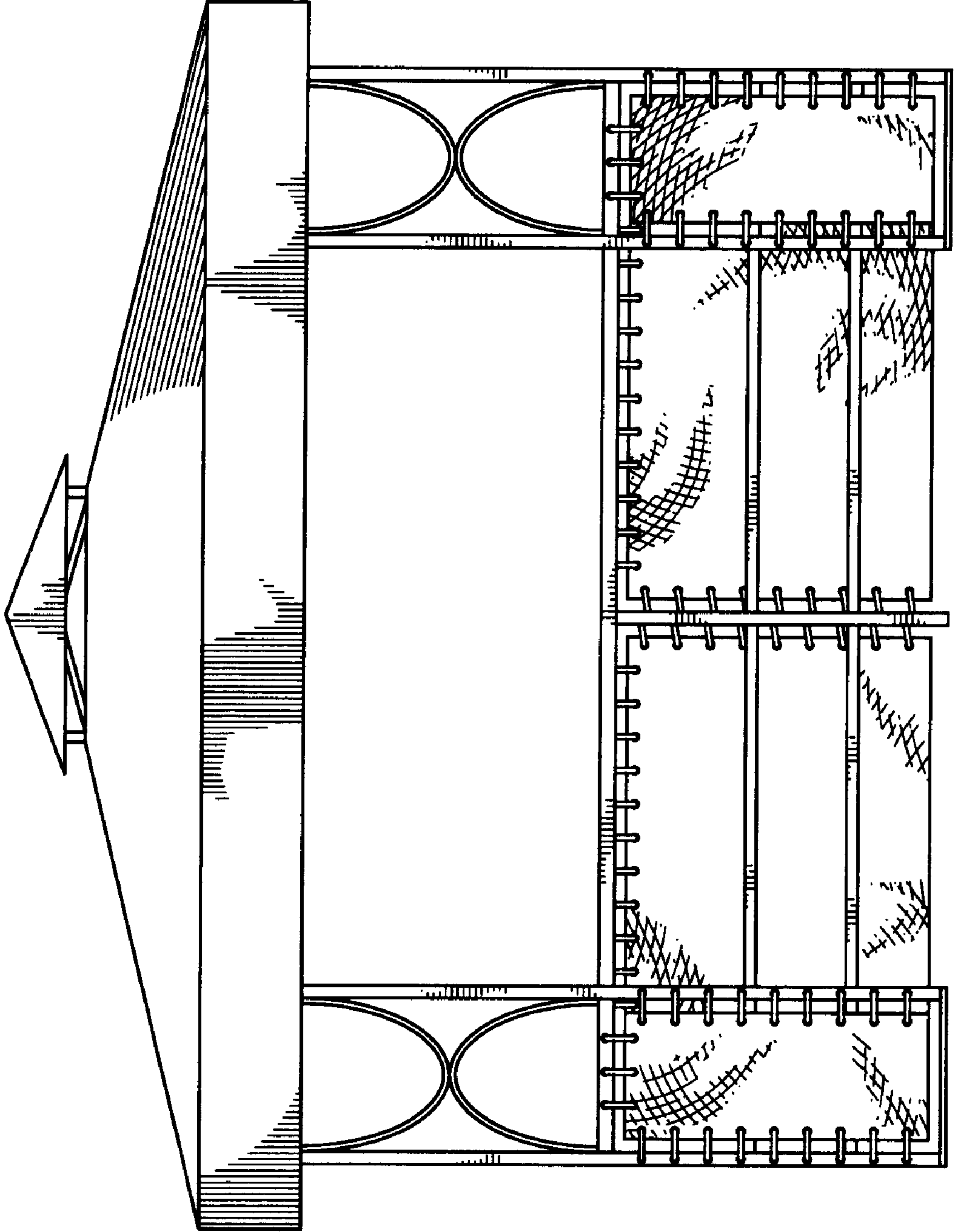

FIG. 2

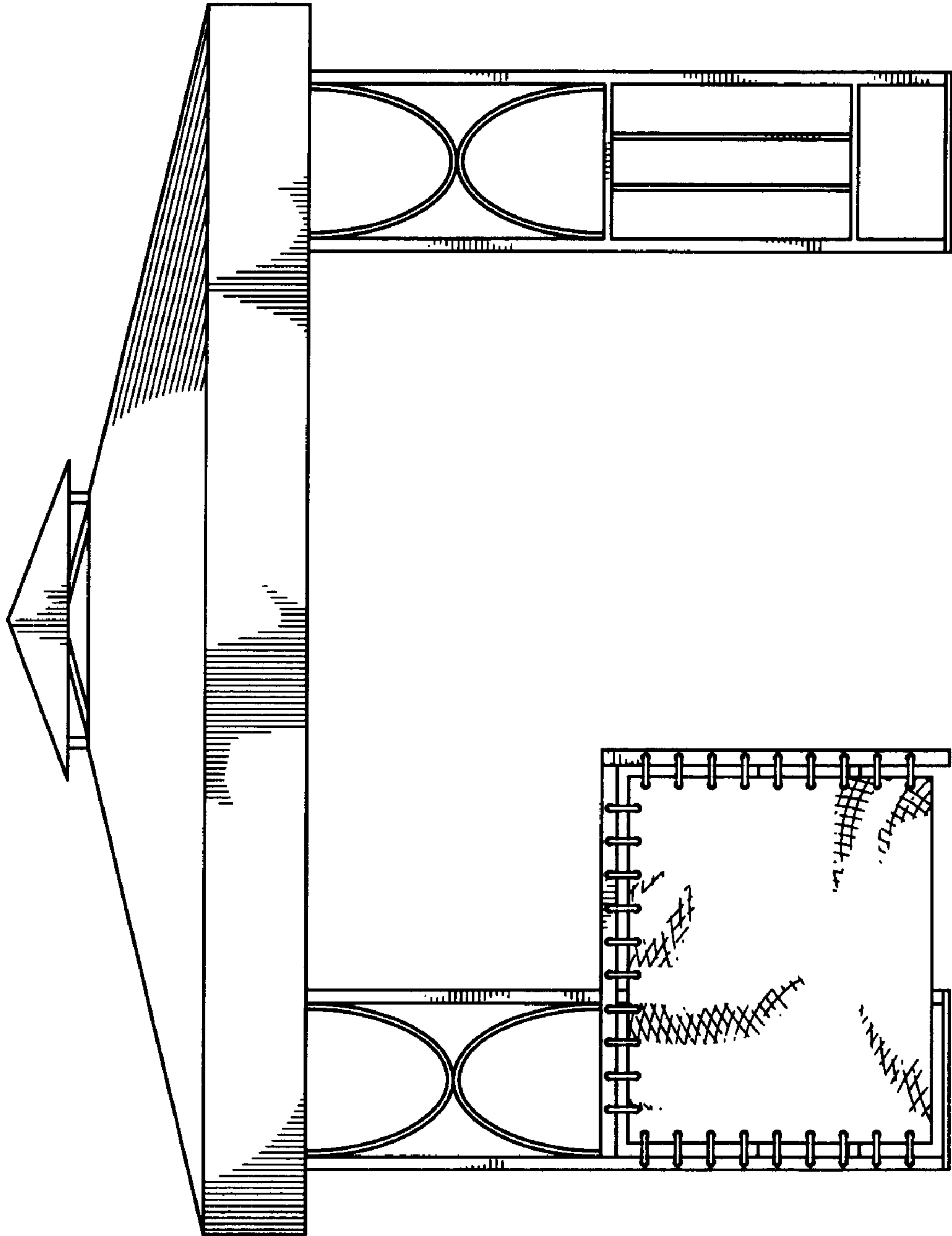

FIG. 3

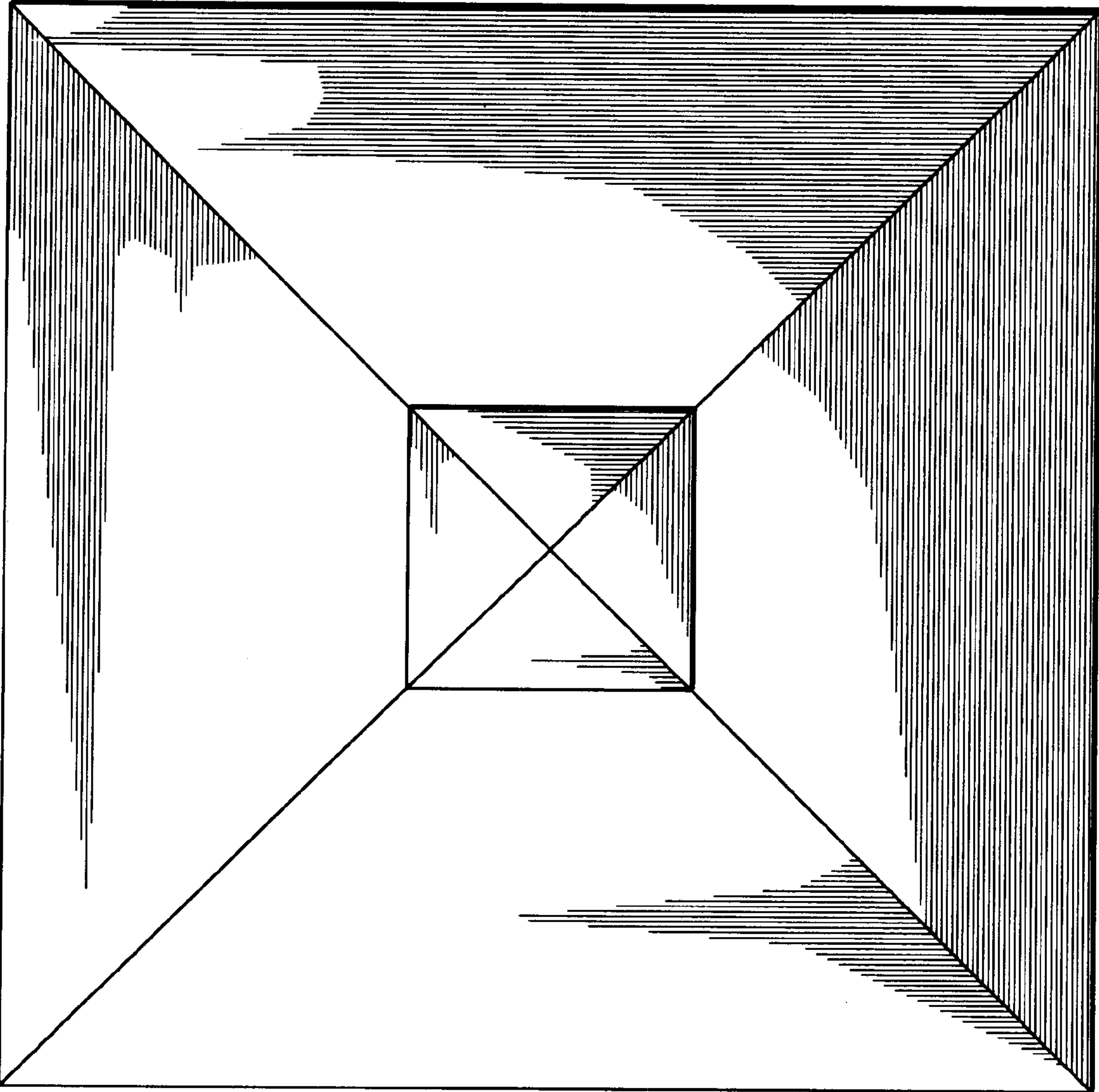

FIG. 4

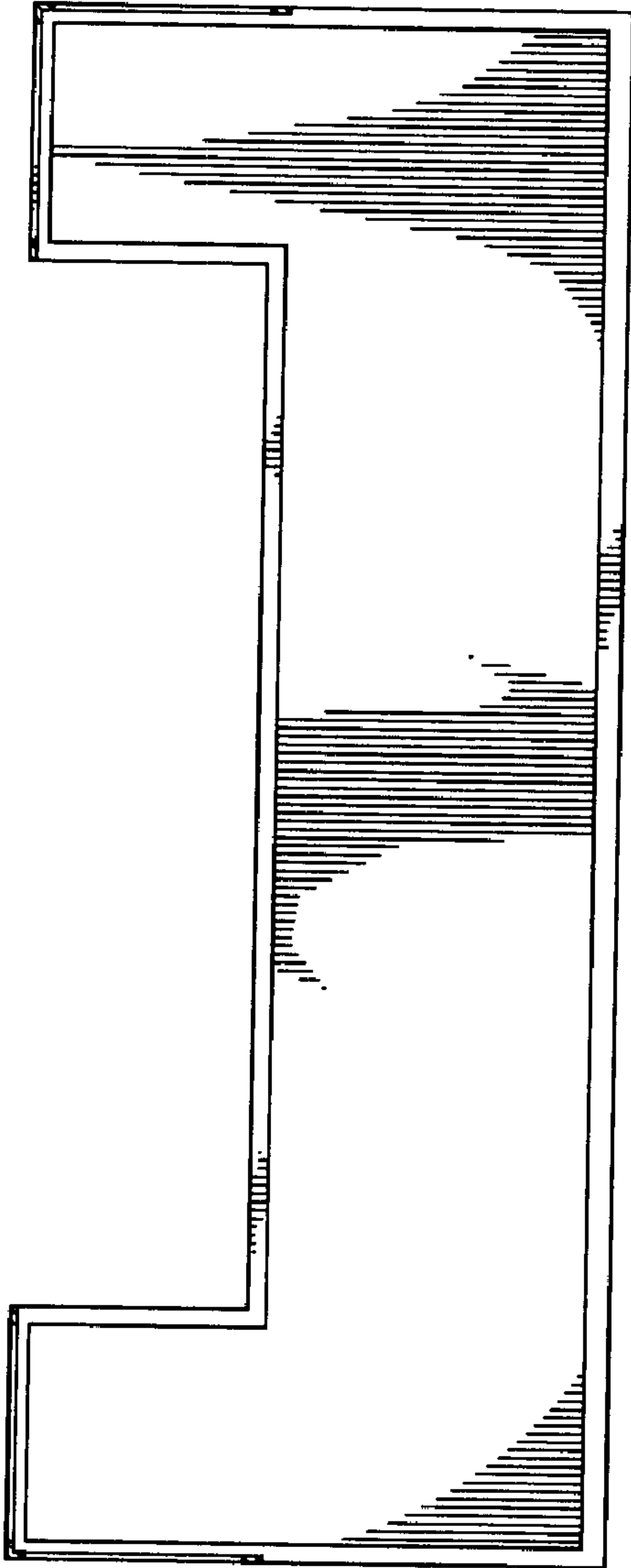

FIG. 5