

US00D504662S

(12) **United States Design Patent**  
**Person et al.**

(10) **Patent No.: US D504,662 S**

(45) **Date of Patent: \*\* May 3, 2005**

(54) **INVERTER-CHARGER**

D494,133 S \* 8/2004 Song ..... D13/110

(75) Inventors: **Edward Andre Person**, Coquitlam (CA); **Alexander Jeffrey Feldman**, Vancouver (CA)

(73) Assignee: **Xantrex International**, St. Michael (BB)

(\*\*) Term: **14 Years**

(21) Appl. No.: **29/209,352**

(22) Filed: **Jul. 15, 2004**

(51) **LOC (7) Cl.** ..... **13-02**

(52) **U.S. Cl.** ..... **D13/110**

(58) **Field of Search** ..... D13/101, 110,  
D13/123, 162, 184, 199; 307/150-151;  
361/600, 679, 692, 715, 727, 728

(56) **References Cited**

**U.S. PATENT DOCUMENTS**

D454,838 S	*	3/2002	Takeuchi et al.	.....	D13/110
D455,121 S	*	4/2002	Takeuchi et al.	.....	D13/110
D455,399 S	*	4/2002	Imamura et al.	.....	D13/110
D455,714 S	*	4/2002	Kim	.....	D13/110
D457,492 S	*	5/2002	Kim	.....	D13/110
D480,683 S	*	10/2003	Ho	.....	D13/110
D494,132 S	*	8/2004	Song	.....	D13/110

**OTHER PUBLICATIONS**

Photographs of Wooden/Plastic Mock-up of Xantrex RS20008 Sine Wave Inverter/Charger shown at The Family Motorcoach Rally in Pomona, California on Mar. 21-23, 2003.

\* cited by examiner

*Primary Examiner*—Stella Reid

*Assistant Examiner*—Daniel Bui

(57) **CLAIM**

The ornamental design for an inverter-charger, as shown and described.

**DESCRIPTION**

FIG. 1 is a perspective view of an inverter-charger, showing our new design;

FIG. 2 is a top plan view thereof;

FIG. 3 is a left side elevation view thereof;

FIG. 4 is a bottom plan view thereof;

FIG. 5 is a right side elevation view thereof;

FIG. 6 is front elevation view thereof; and,

FIG. 7 is rear elevation view thereof.

The broken line showing of the environment is for illustrative purposes only and forms no part of the claimed design.

**1 Claim, 4 Drawing Sheets**

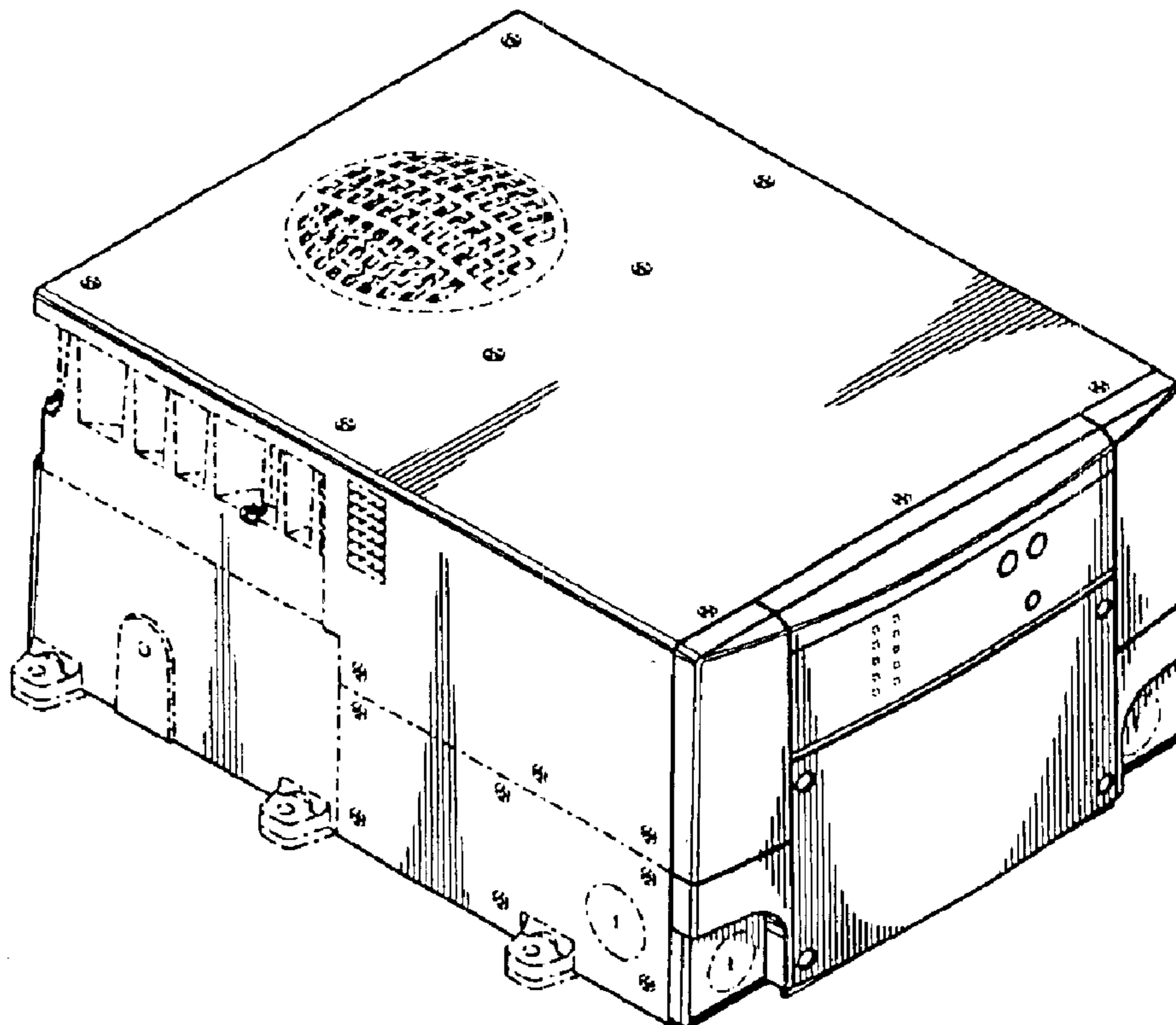

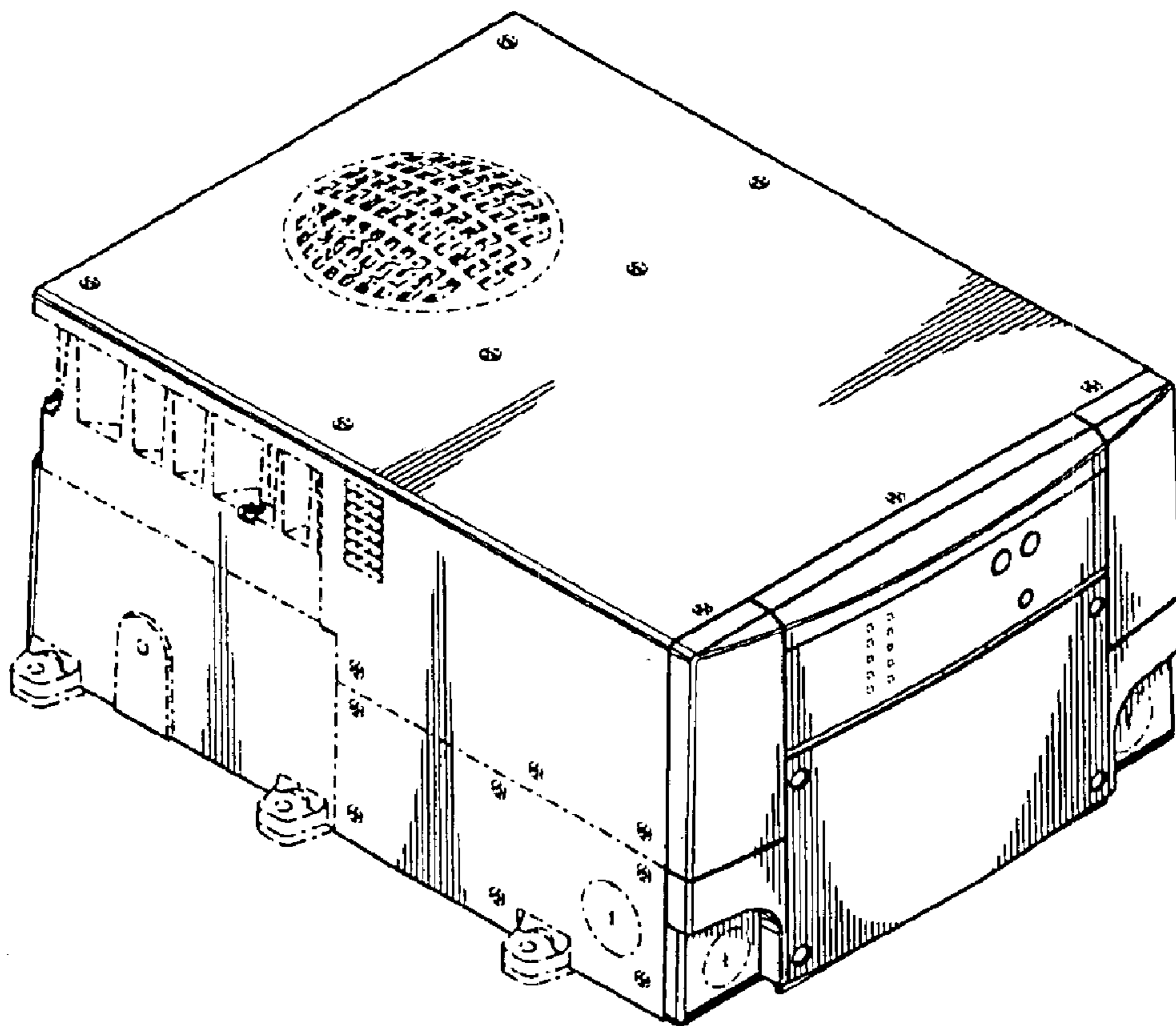

FIG. 1

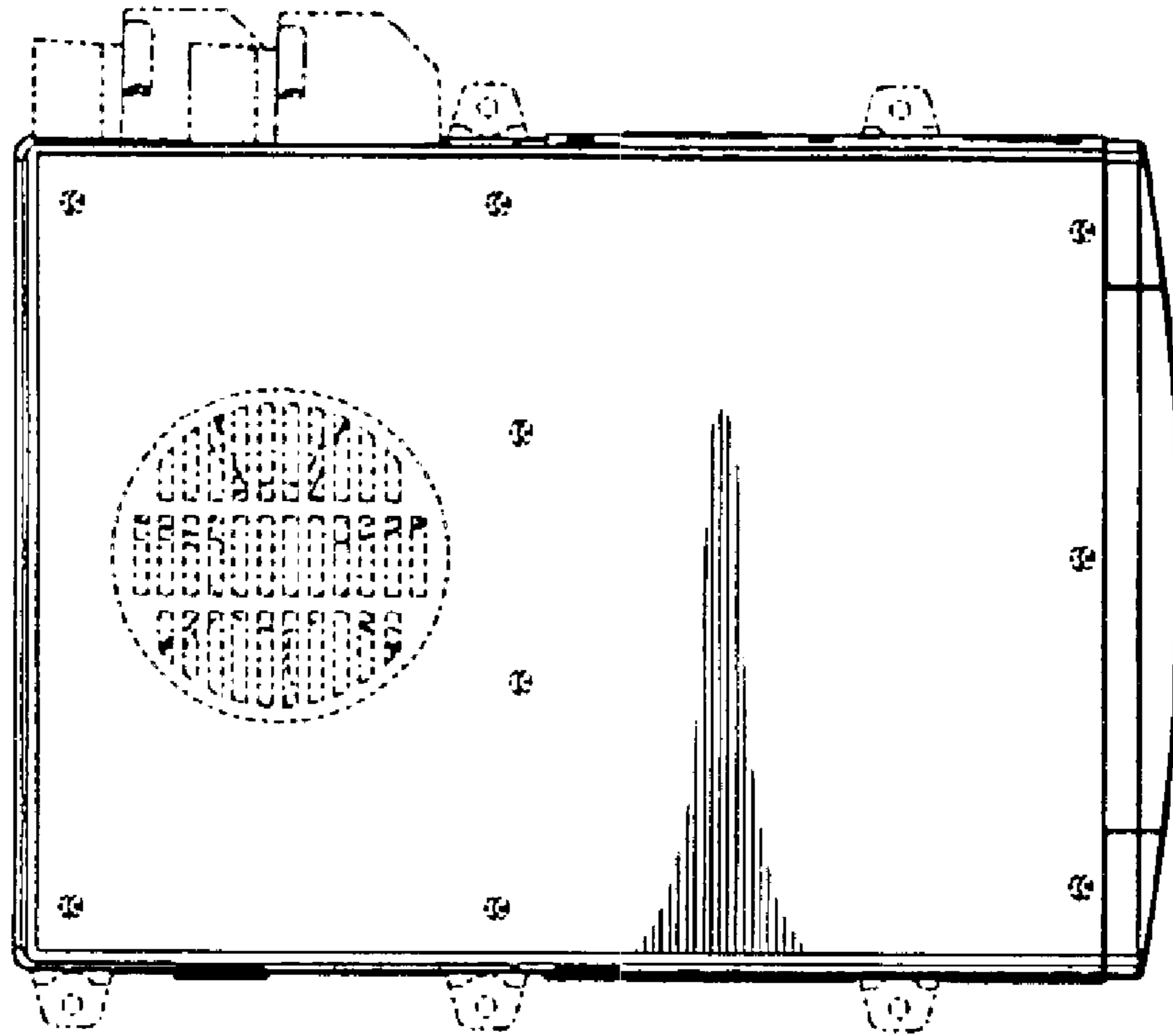

FIG. 2

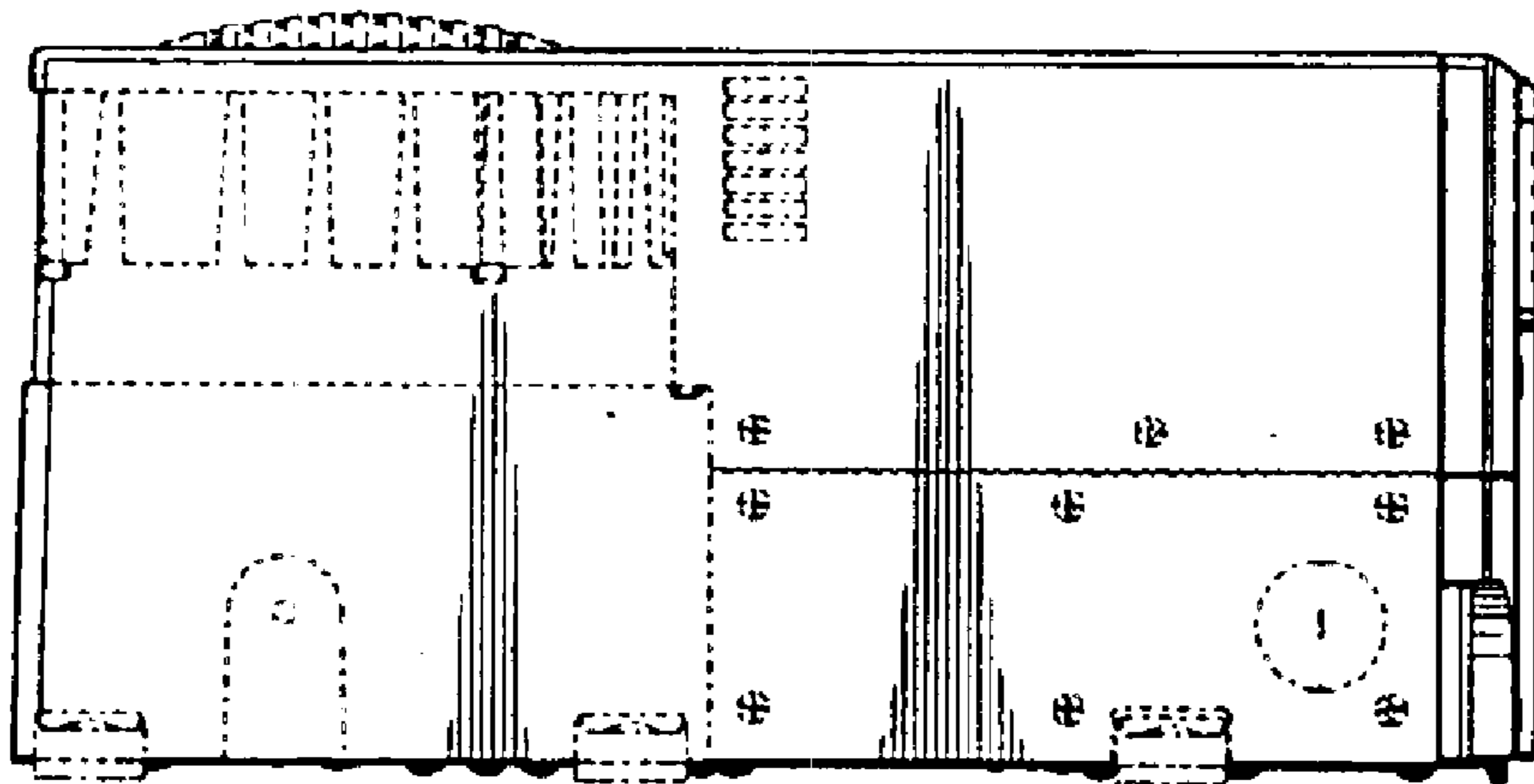

FIG. 3

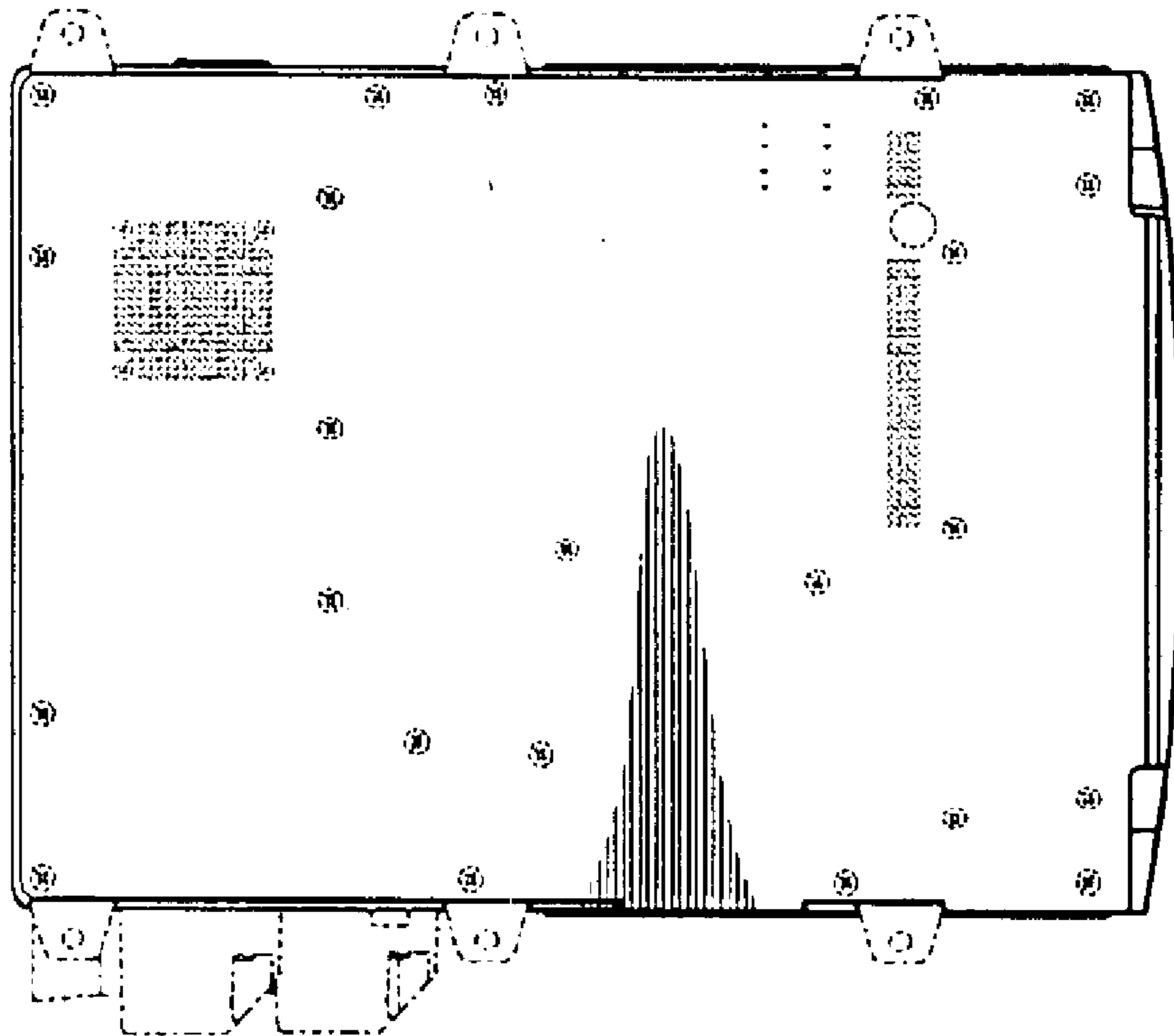

FIG. 4

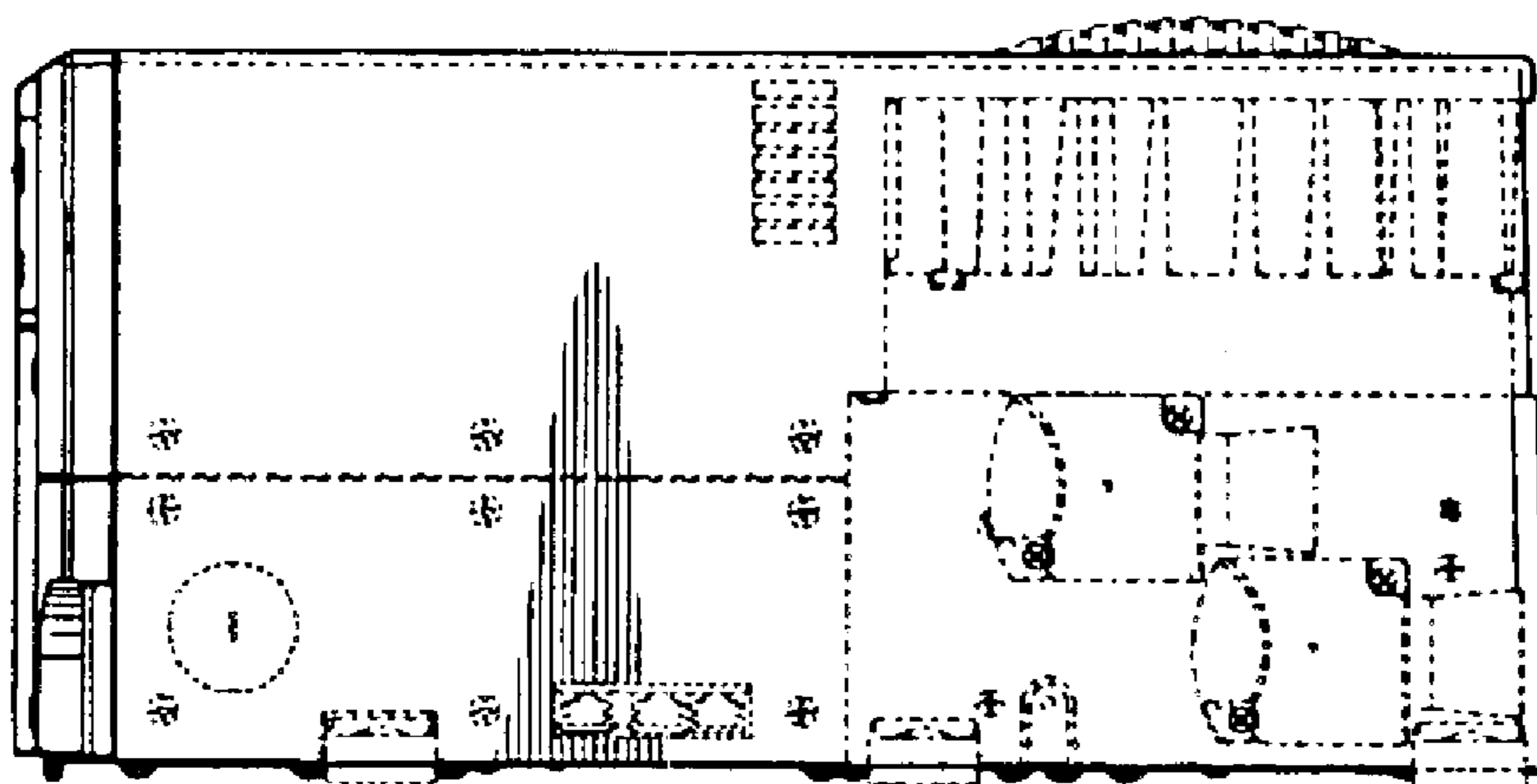

FIG. 5

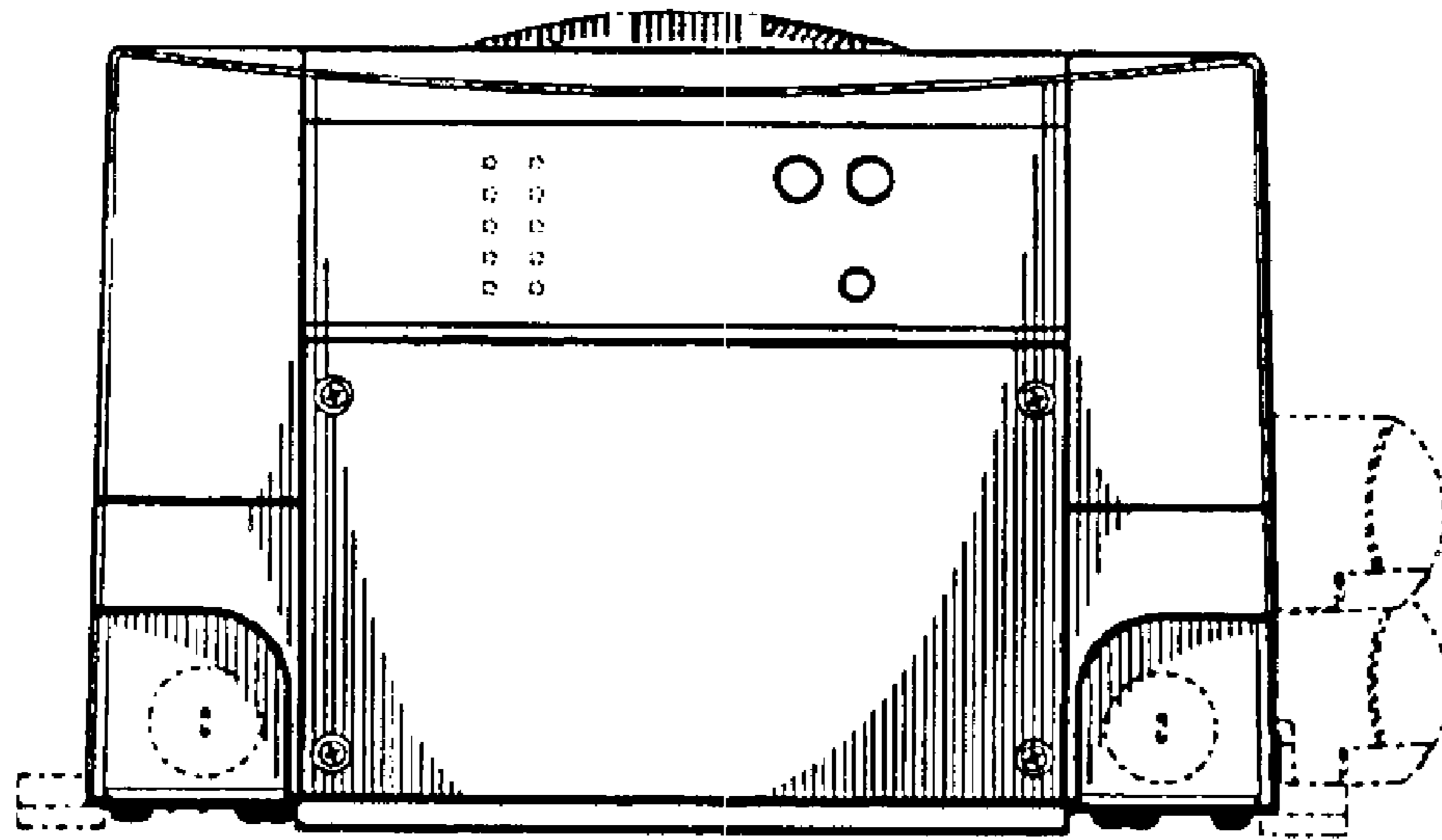

FIG. 6

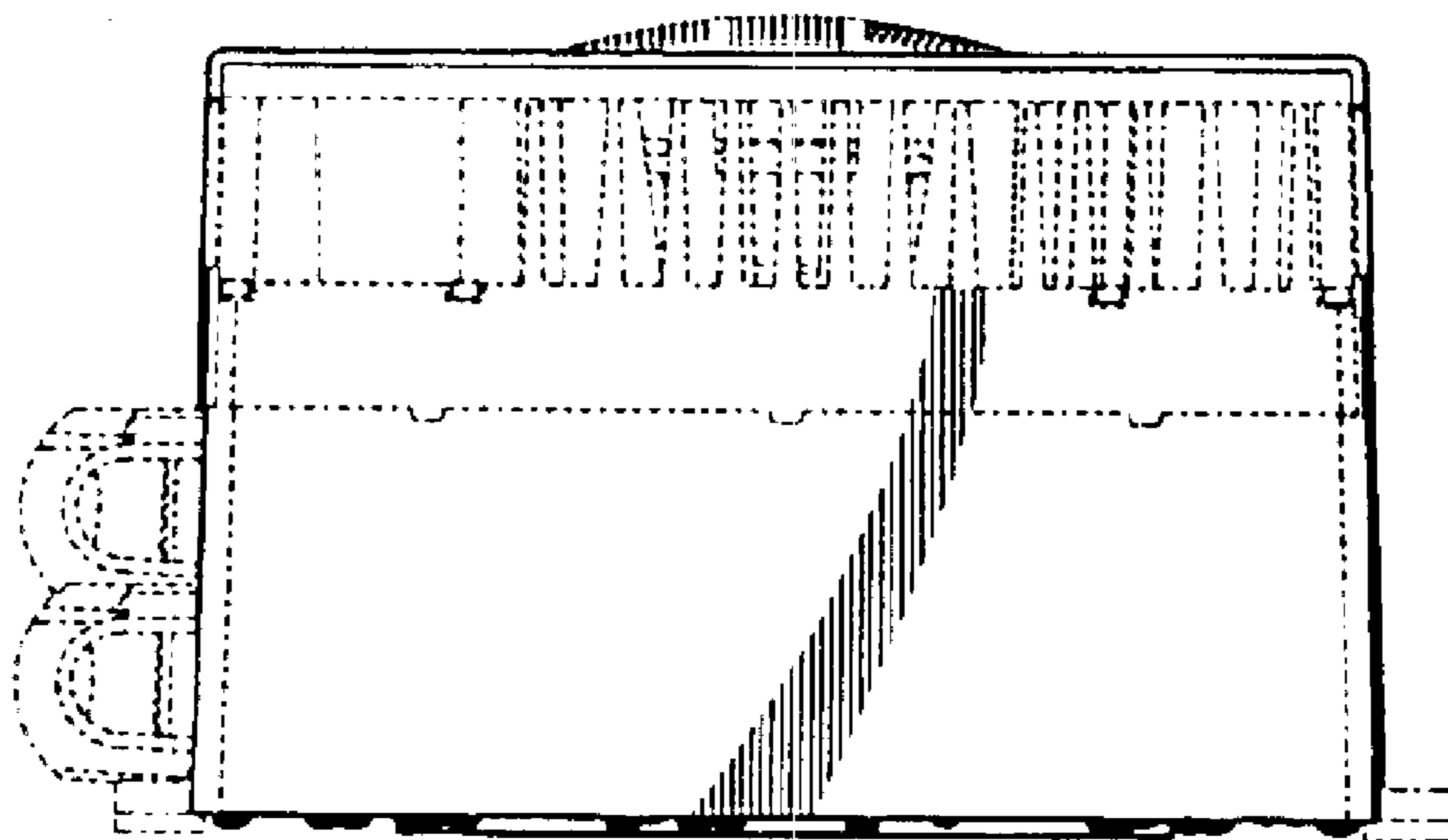

FIG. 7