

US00D503216S

(12) **United States Design Patent** (10) **Patent No.:** **US D503,216 S**
Berkman et al. (45) **Date of Patent:** **** Mar. 22, 2005**

(54) **VALVE HANDLE**

(75) Inventors: **Peter Berkman**, Highland Park, IL
(US); **Robert Tripp**, Brea, CA (US)

(73) Assignee: **B & K Industries**, Elk Grove Village,
IL (US)

(**) Term: **14 Years**

(21) Appl. No.: **29/187,348**

(22) Filed: **Jul. 31, 2003**

(51) **LOC (7) Cl.** **23-01**

(52) **U.S. Cl.** **D23/250; D23/249**

(58) **Field of Search** D23/238–243,
D23/249, 245, 250–257; D8/300–322, 350–353,
DIG. 3; 16/110.1, DIG. 30; 4/675–678;
137/801

(56) **References Cited**

U.S. PATENT DOCUMENTS

D187,847 S * 5/1960 Kohler D23/250
D187,849 S * 5/1960 Kohler D23/250
D274,085 S * 5/1984 Yanagi D23/253
D316,746 S * 5/1991 Ragonot D23/250
D467,312 S * 12/2002 Singtoroj D23/250

OTHER PUBLICATIONS

Registration No. 2,036,255; Registered Feb. 4, 1997.

* cited by examiner

Primary Examiner—Louis S. Zarfes

Assistant Examiner—Gregory Andoll

(74) *Attorney, Agent, or Firm*—Harness, Dickey & Pierce,
P.L.C.

(57) **CLAIM**

The ornamental design for a valve handle, as shown and
described.

DESCRIPTION

FIG. 1 is a top perspective view of the valve handle
according to a first embodiment of the present invention;

FIG. 2 is a bottom perspective view of the valve handle
according to the first embodiment of the present invention;

FIG. 3 is a front elevation view of the valve handle accord-
ing to the first embodiment of the present invention;

FIG. 4 is a left elevation view of the valve handle according
to the first embodiment of the present invention;

FIG. 5 is a top view of the valve handle according to the first
embodiment of the present invention;

FIG. 6 is a top perspective view of the valve handle
according to a second embodiment of the present invention;

FIG. 7 is a bottom perspective view of the valve handle
according to the second embodiment of the present inven-
tion,

FIG. 8 is a front elevation view of the valve handle accord-
ing to the second embodiment of the present invention;

FIG. 9 is a left elevation view of the valve handle according
to the second embodiment of the present invention; and,

FIG. 10 is a top view of the valve handle according to the
second embodiment of the present invention.

1 Claim, 6 Drawing Sheets

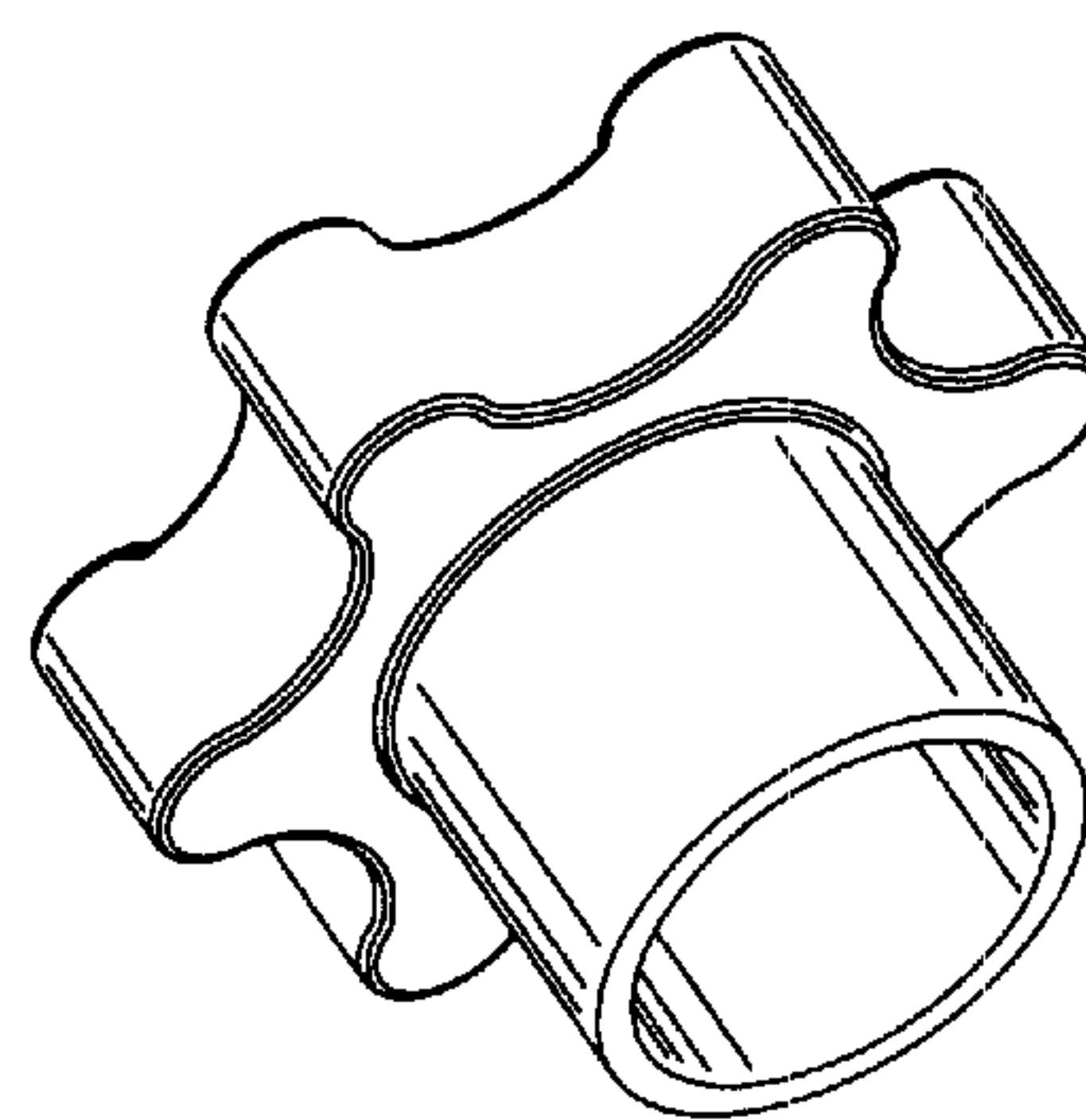
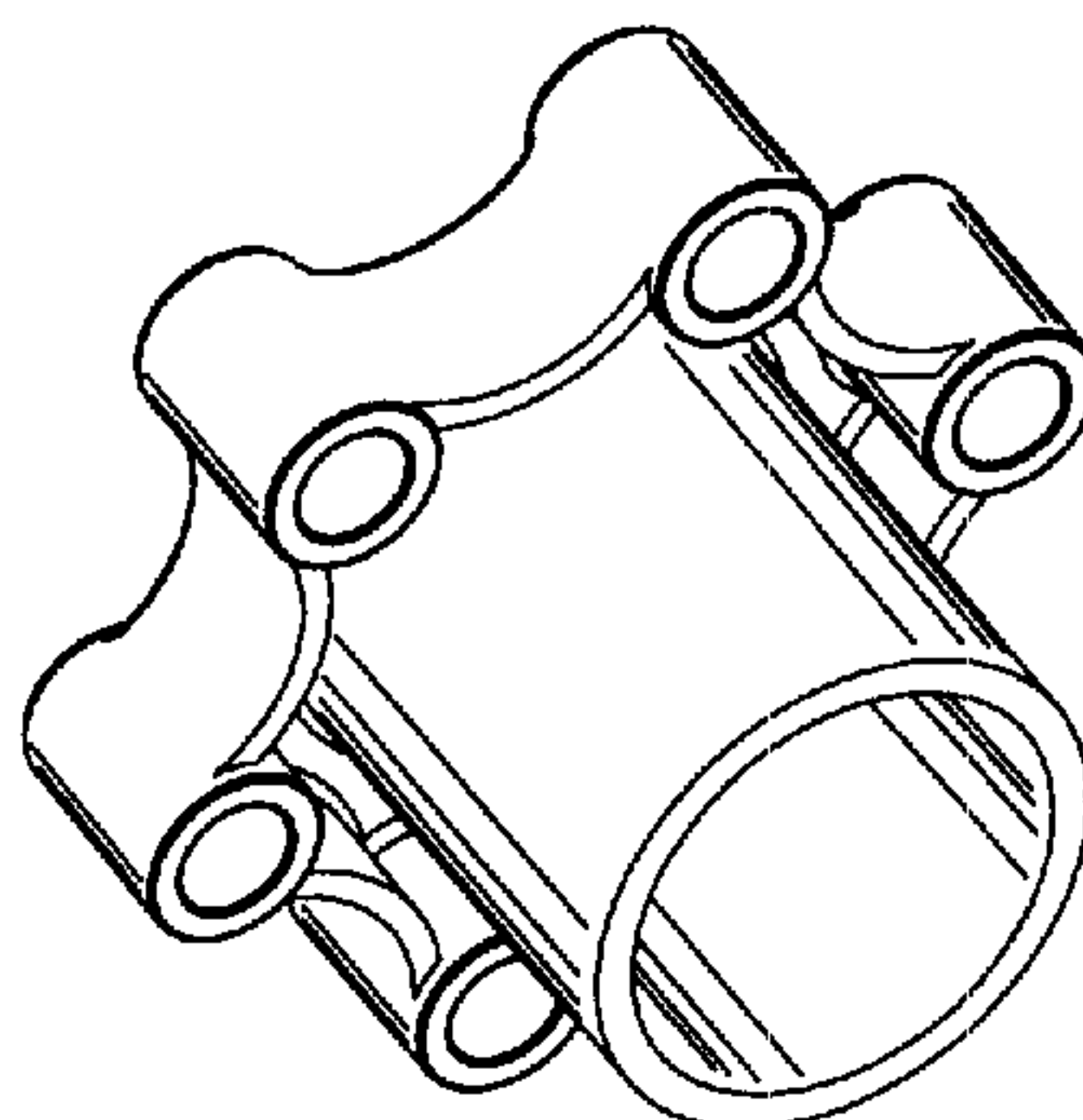
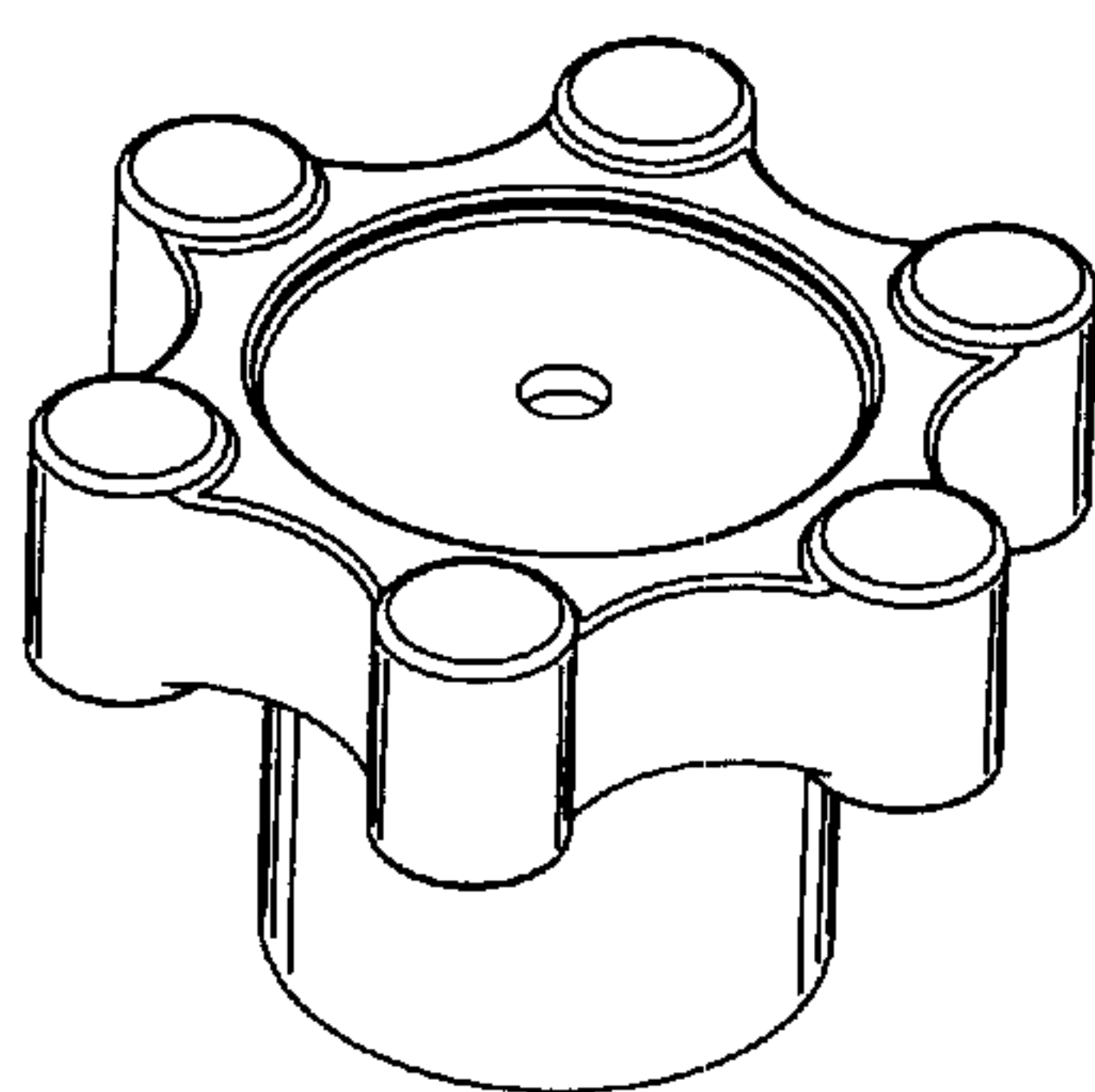

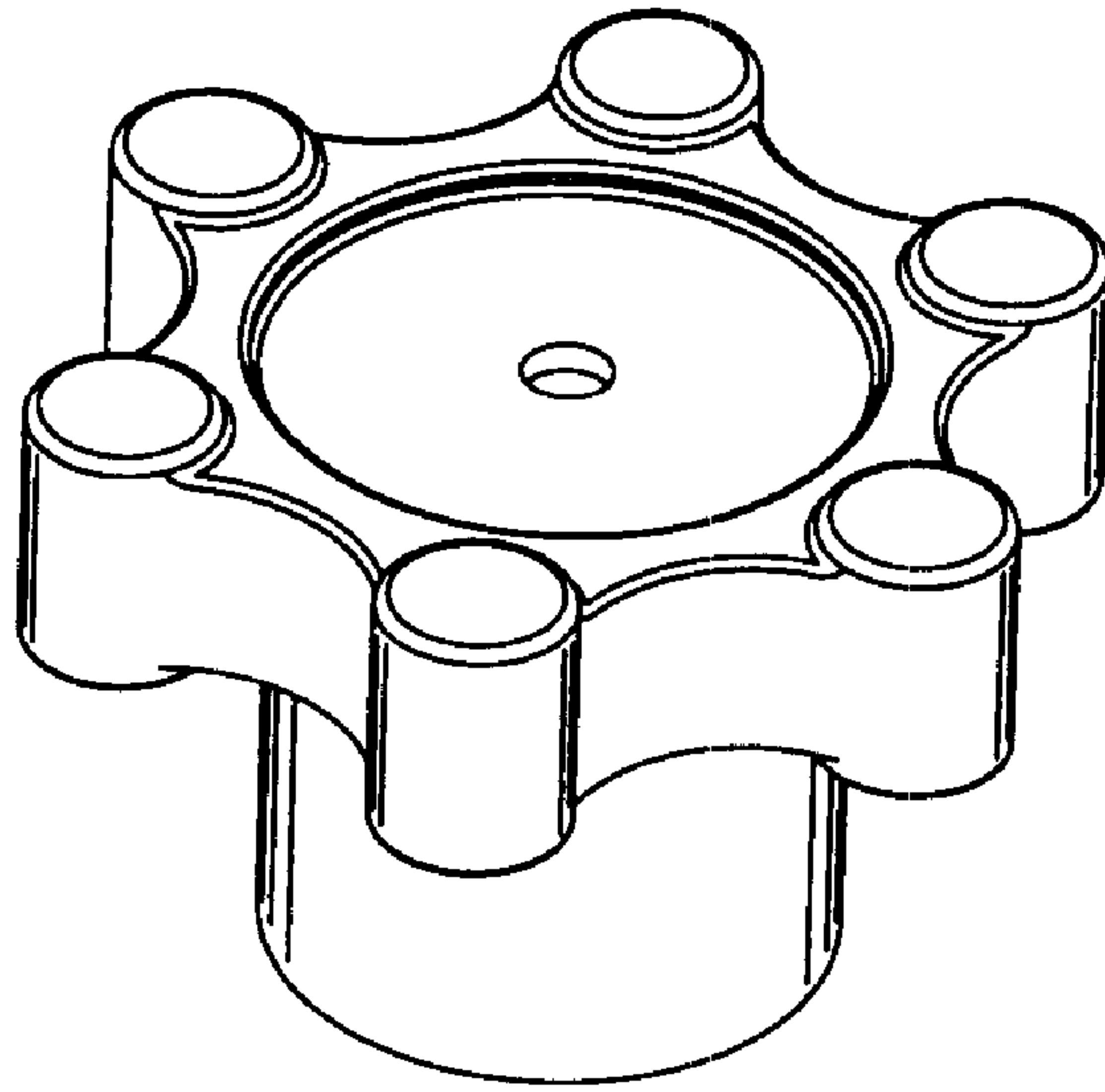

FIG 1

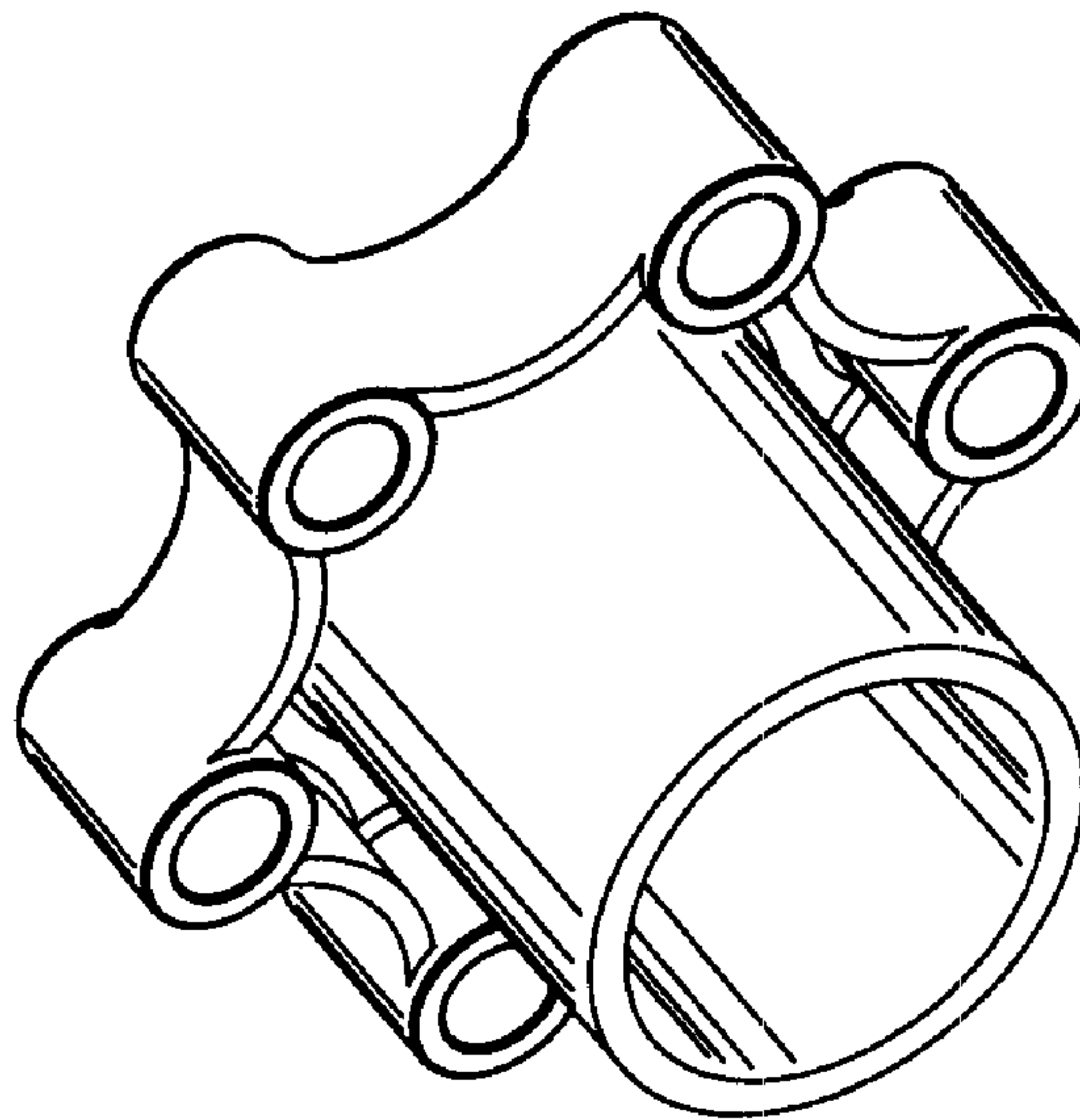

FIG 2

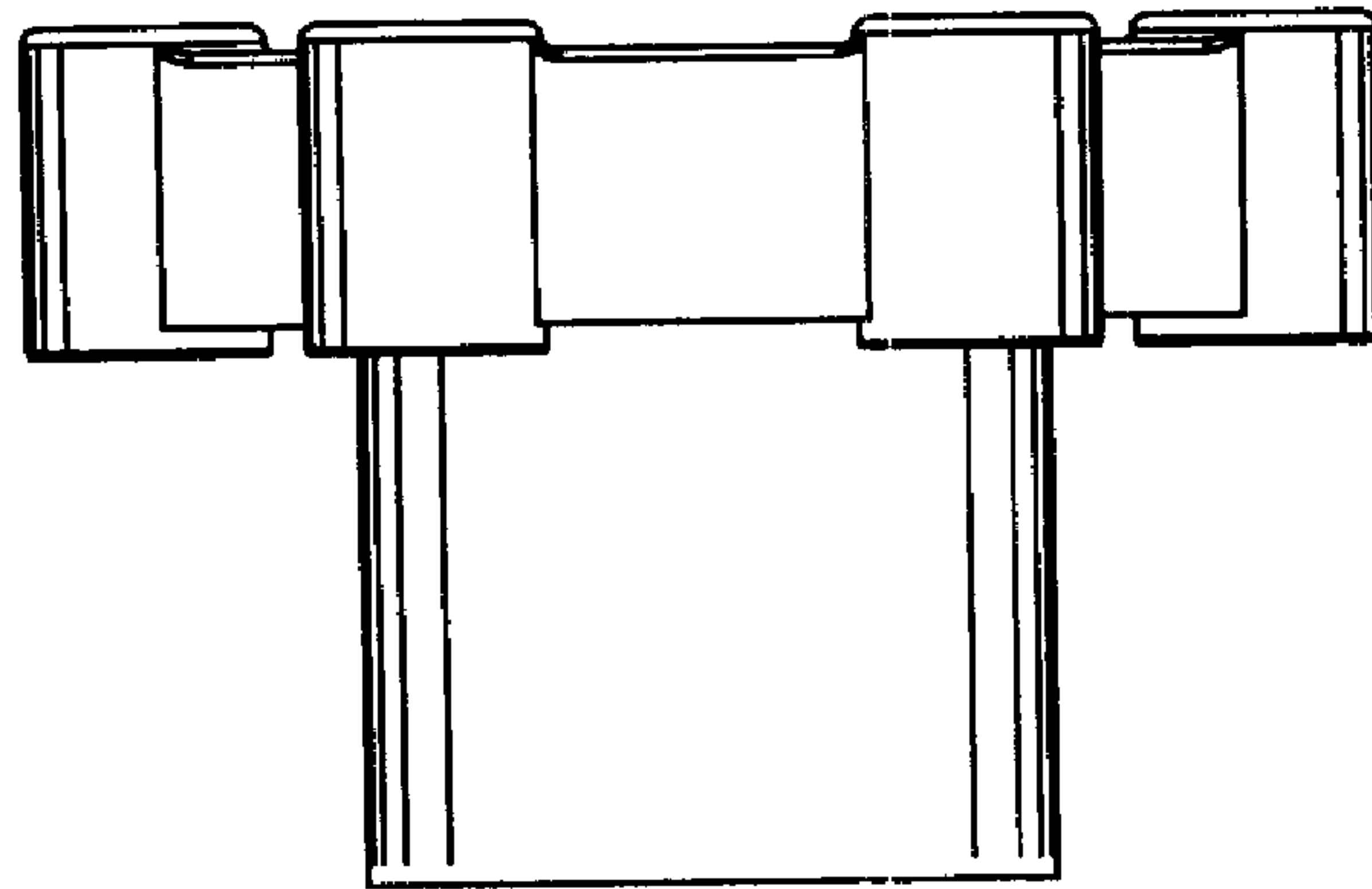

FIG 3

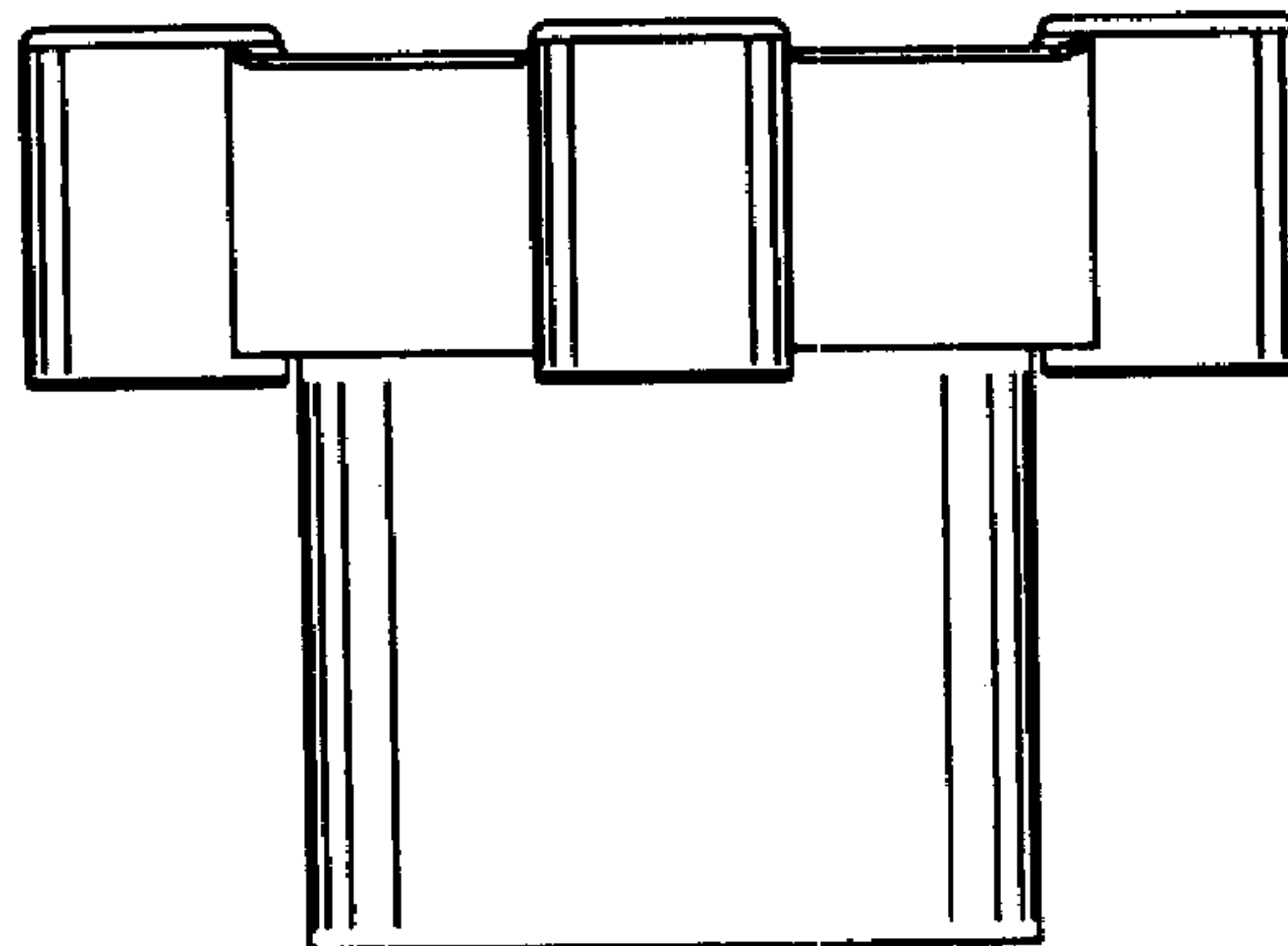

FIG 4

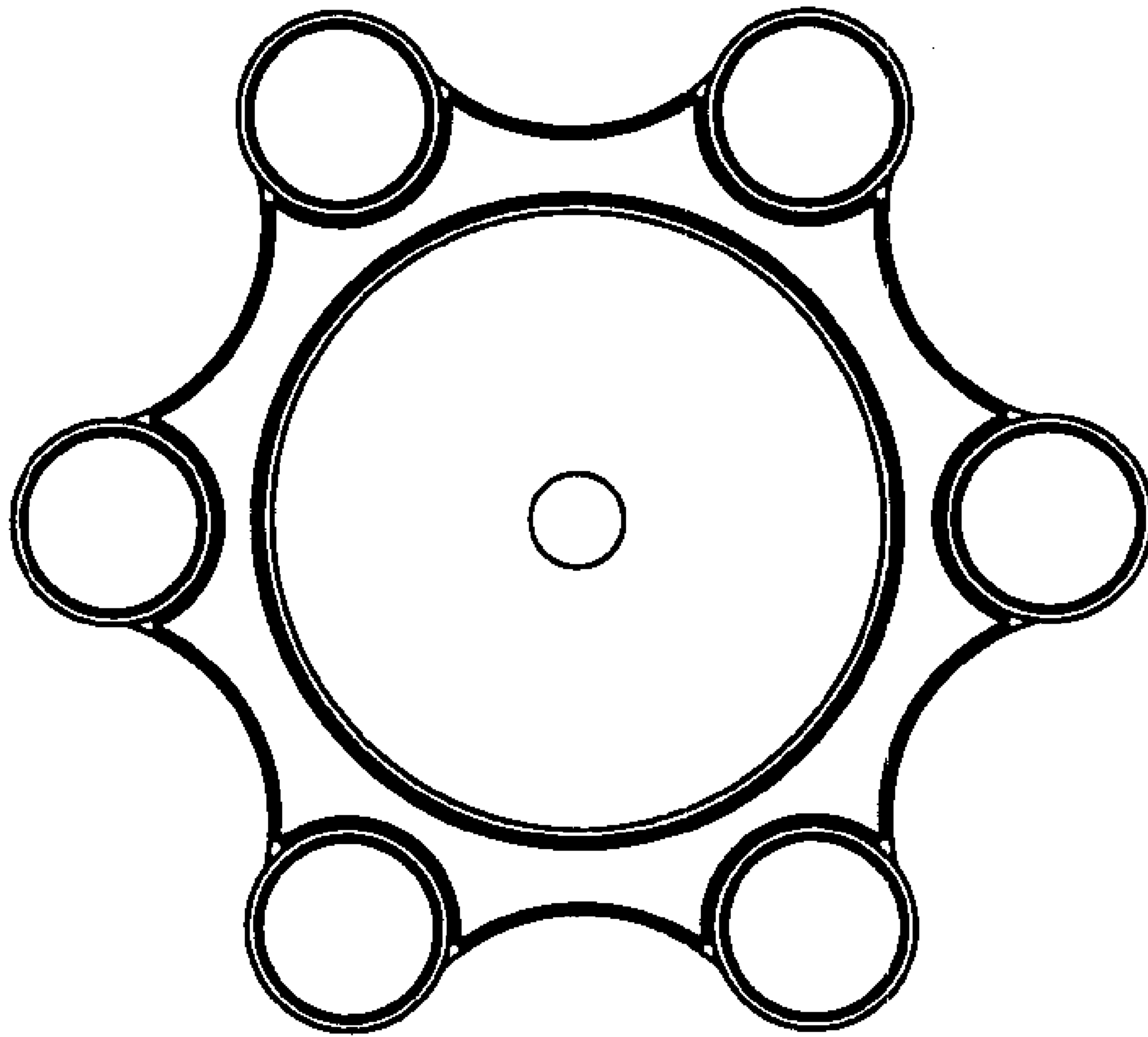

FIG 5

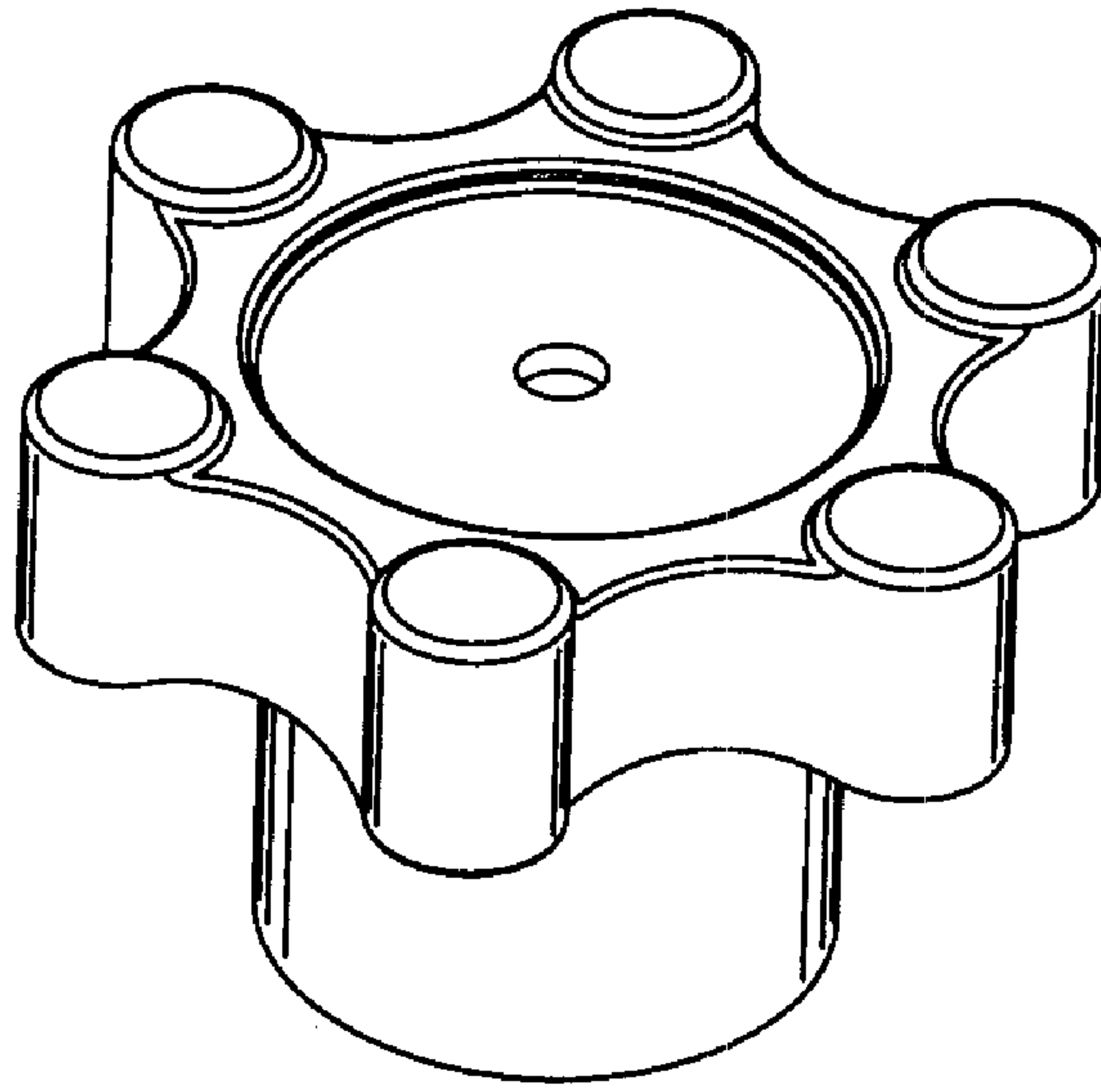

FIG 6

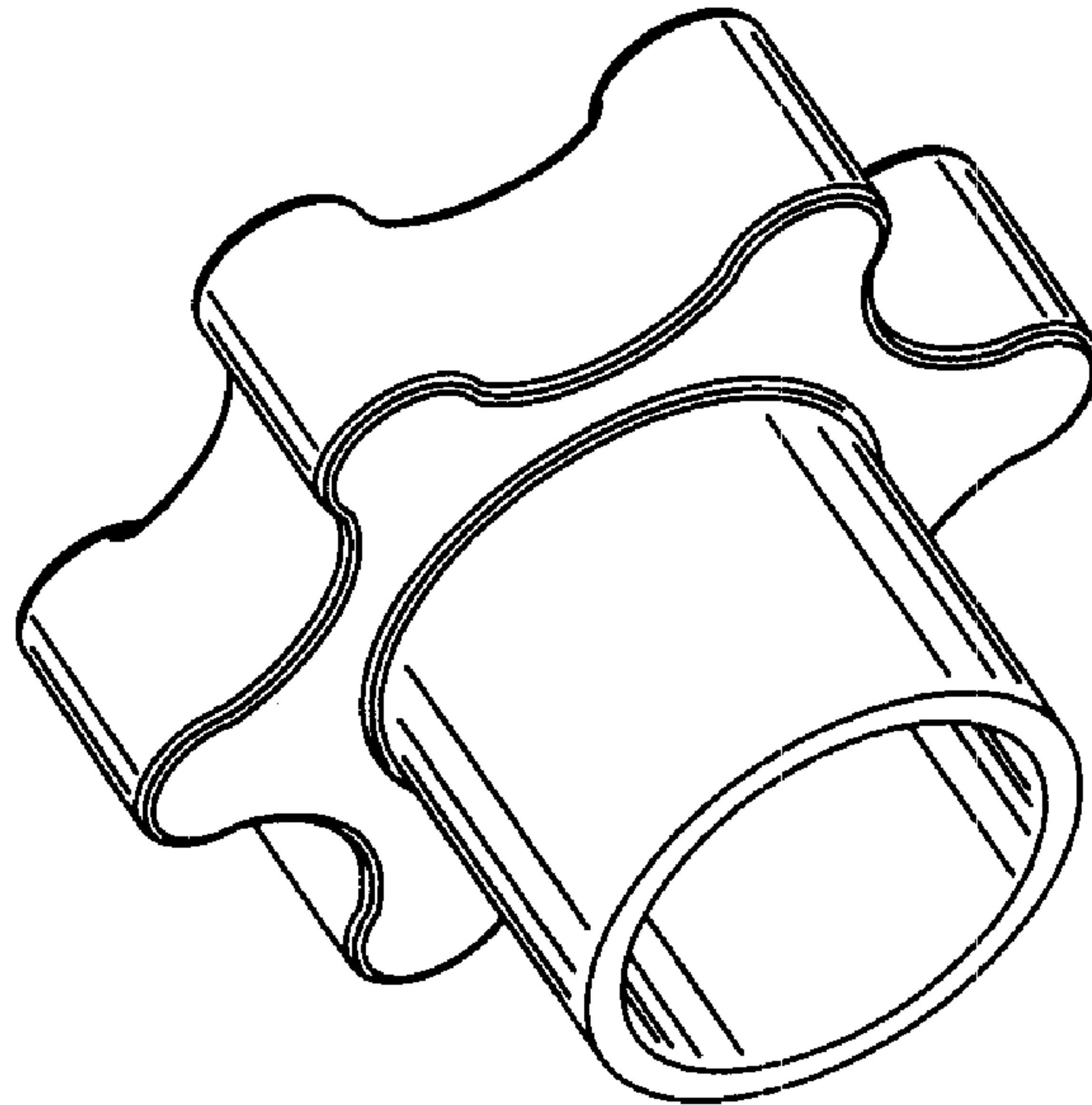

FIG 7

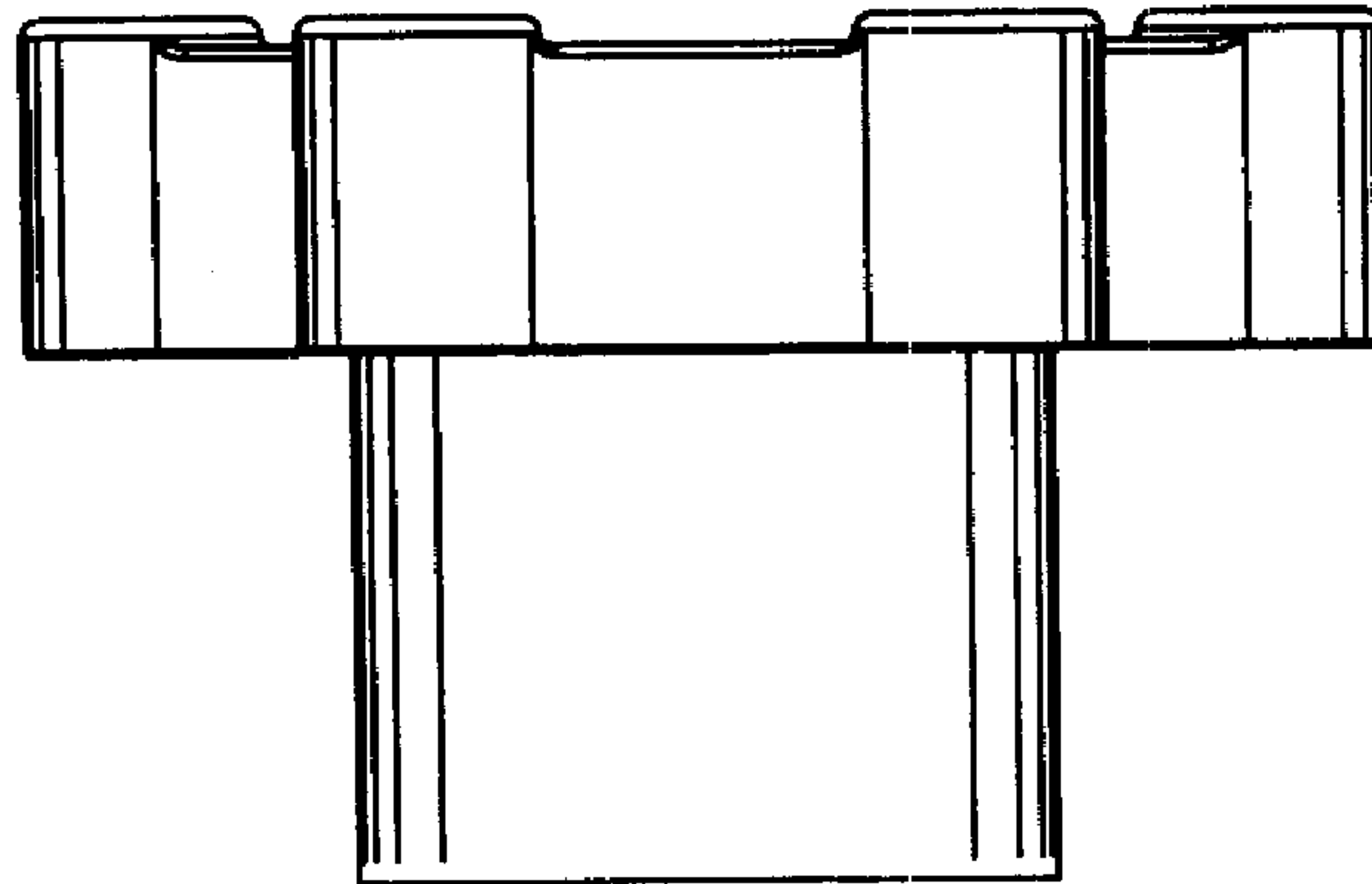

FIG 8

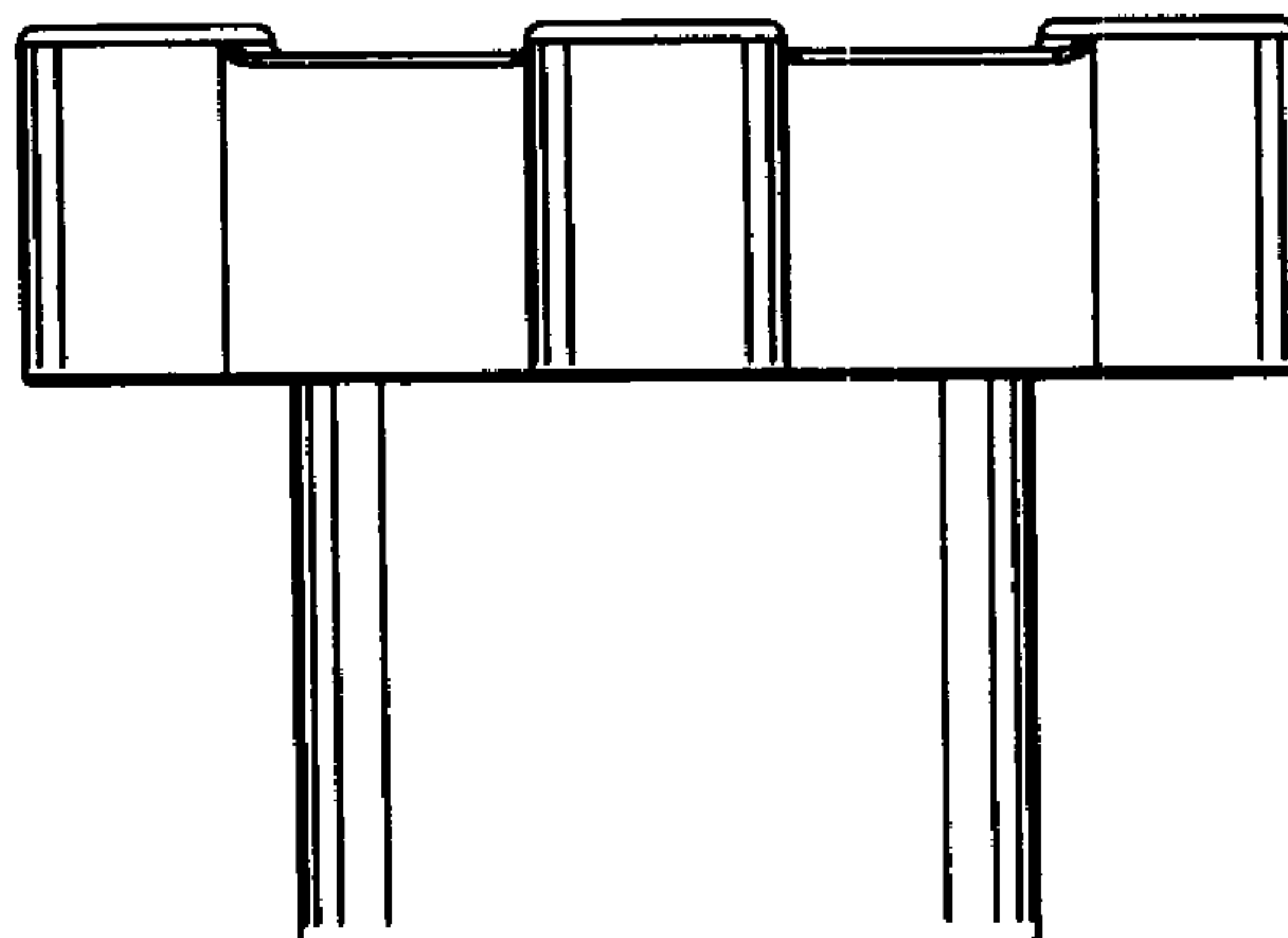

FIG 9

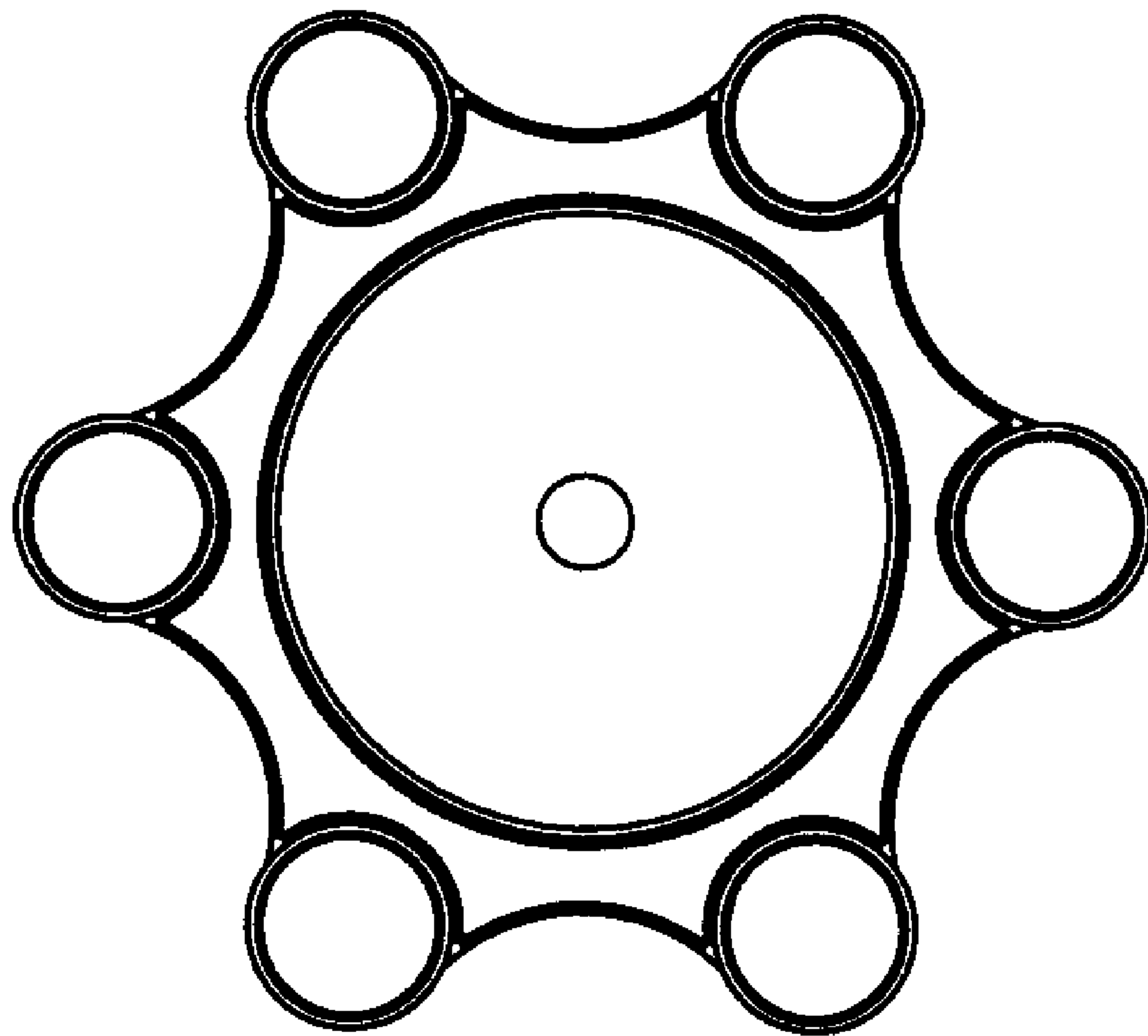

FIG 10