



US00D502395S

(12) **United States Design Patent**
Blanchester

(10) **Patent No.:** **US D502,395 S**
(45) **Date of Patent:** **** Mar. 1, 2005**

(54) **CARRYING DEVICE FOR A BOTTLE**

(76) **Inventor:** **Tom Blanchester**, 1348 Washington Ave., Suite 418, Miami Beach, FL (US) 33139

(**) **Term:** **14 Years**

(21) **Appl. No.:** **29/177,805**

(22) **Filed:** **Mar. 16, 2003**

(30) **Foreign Application Priority Data**

Sep. 18, 2002 (SE) 02-1364

(51) **LOC (7) Cl.** **09-07**

(52) **U.S. Cl.** **D9/434; D9/455**

(58) **Field of Search** D9/455, 434, 499; D7/601, 387, 393-395, 622, 619.1; 215/399, 396, 395; 220/751, 737, 741, 742; 294/31.2, 137, 149

(56) **References Cited**

U.S. PATENT DOCUMENTS

- 3,612,595 A * 10/1971 Updegraff et al. 215/100 A
- D272,316 S * 1/1984 Braun D9/434
- D276,504 S * 11/1984 Moran et al. D9/434
- 5,806,904 A * 9/1998 Smith 294/31.2
- D490,235 S * 5/2004 Nykoluk D9/655
- 2004/0050815 A1 * 3/2004 Blanchester

FOREIGN PATENT DOCUMENTS

NO 300204 * 4/1997 B65D/23/10
SE 0202768-8 * 2/2003

* cited by examiner

Primary Examiner—Louis S. Zarfaz
Assistant Examiner—Gregory Andoll
(74) *Attorney, Agent, or Firm*—Yi Li

(57) **CLAIM**

The ornamental design for a carrying device for a bottle, as shown and described.

DESCRIPTION

FIG. 1 is a bottom view of a carrying device for a bottle showing an embodiment of my new design; FIG. 2 is a top view of the embodiment shown in FIG. 1; FIG. 3 is a bottom perspective view of the embodiment shown in FIG. 1; FIG. 4 is a top perspective view of the embodiment shown in FIG. 1; FIG. 5 is a bottom view of the embodiment shown in FIG. 1 in a folded condition; FIG. 6 is a top view of the embodiment shown in FIG. 1 in a folded condition; and, FIG. 7 is a perspective top view of the embodiment shown in FIG. 1 in a partially folded condition.

1 Claim, 2 Drawing Sheets

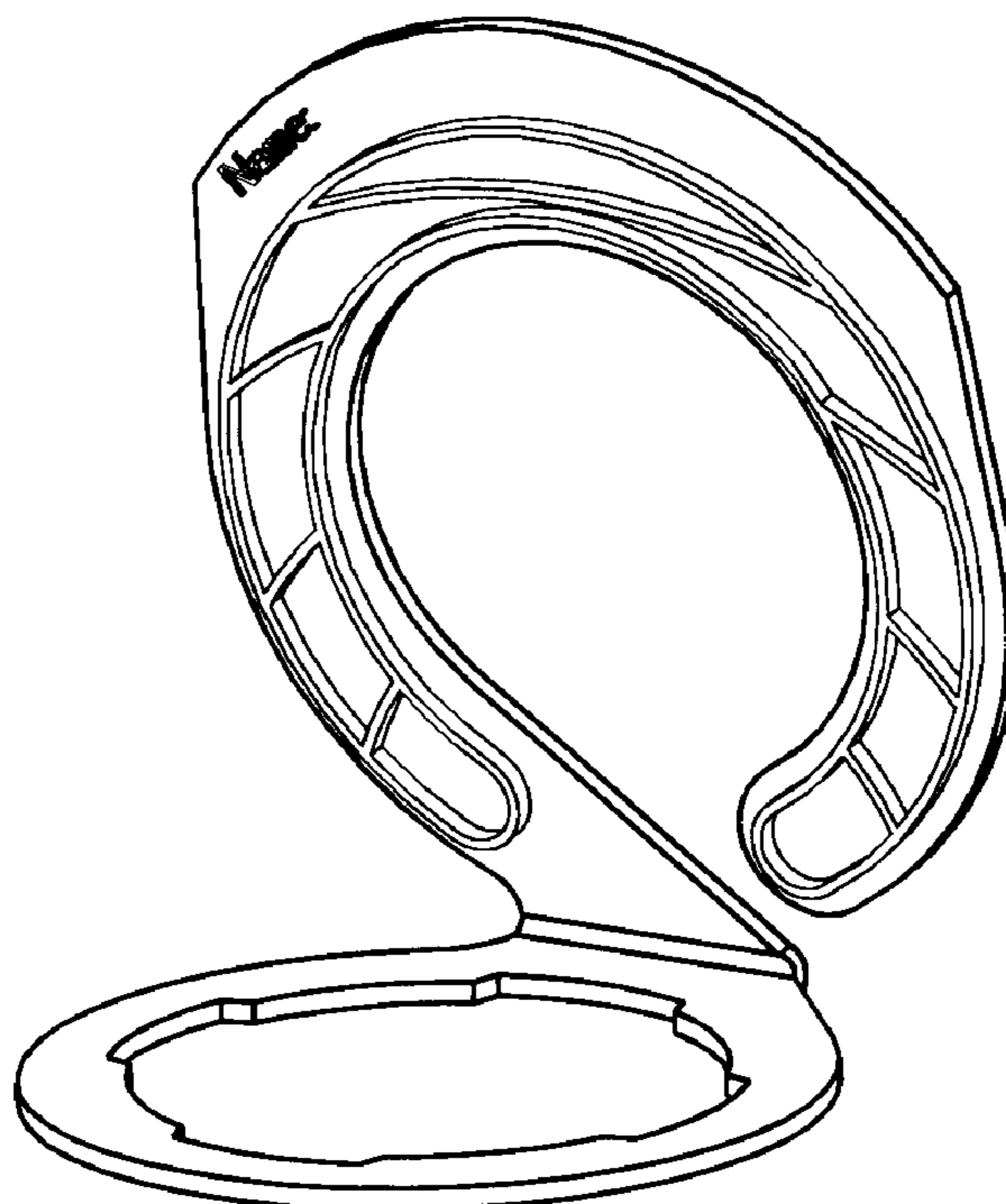
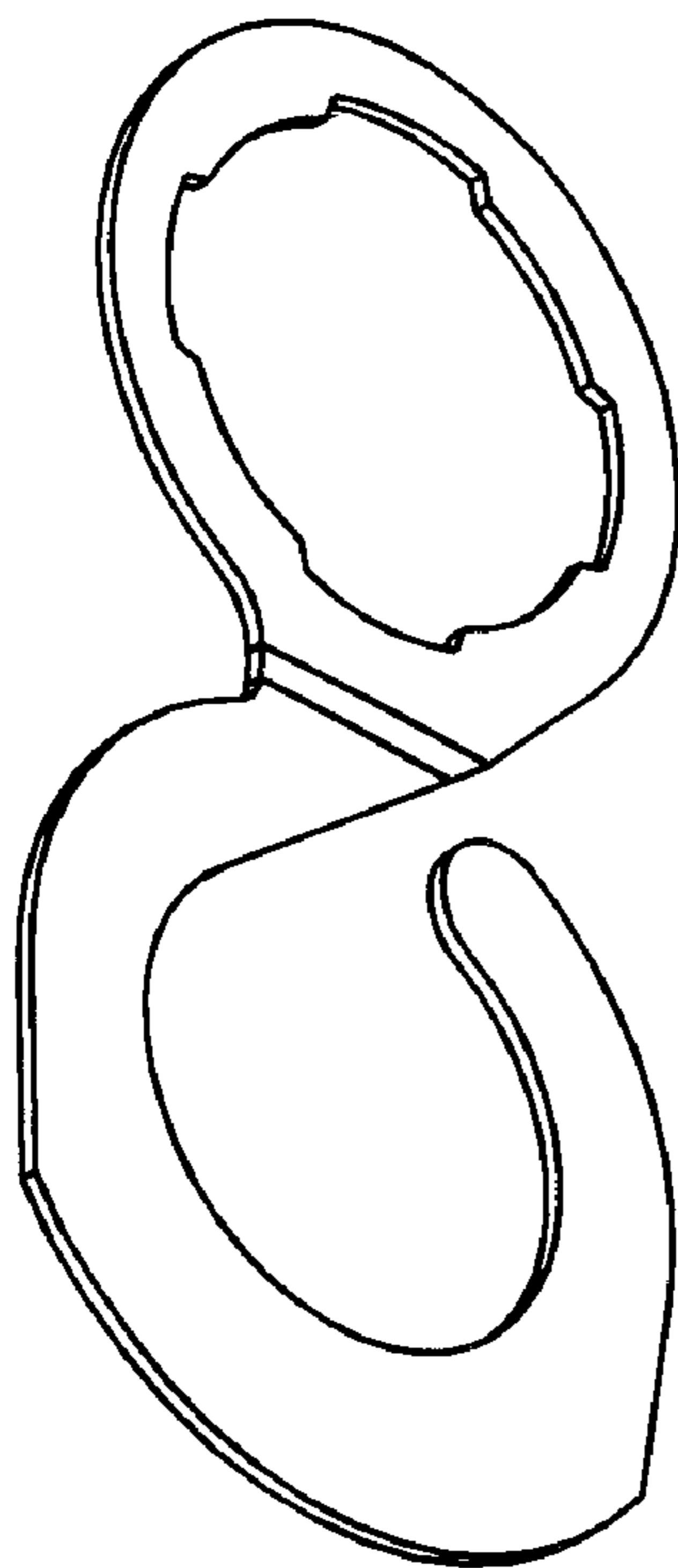

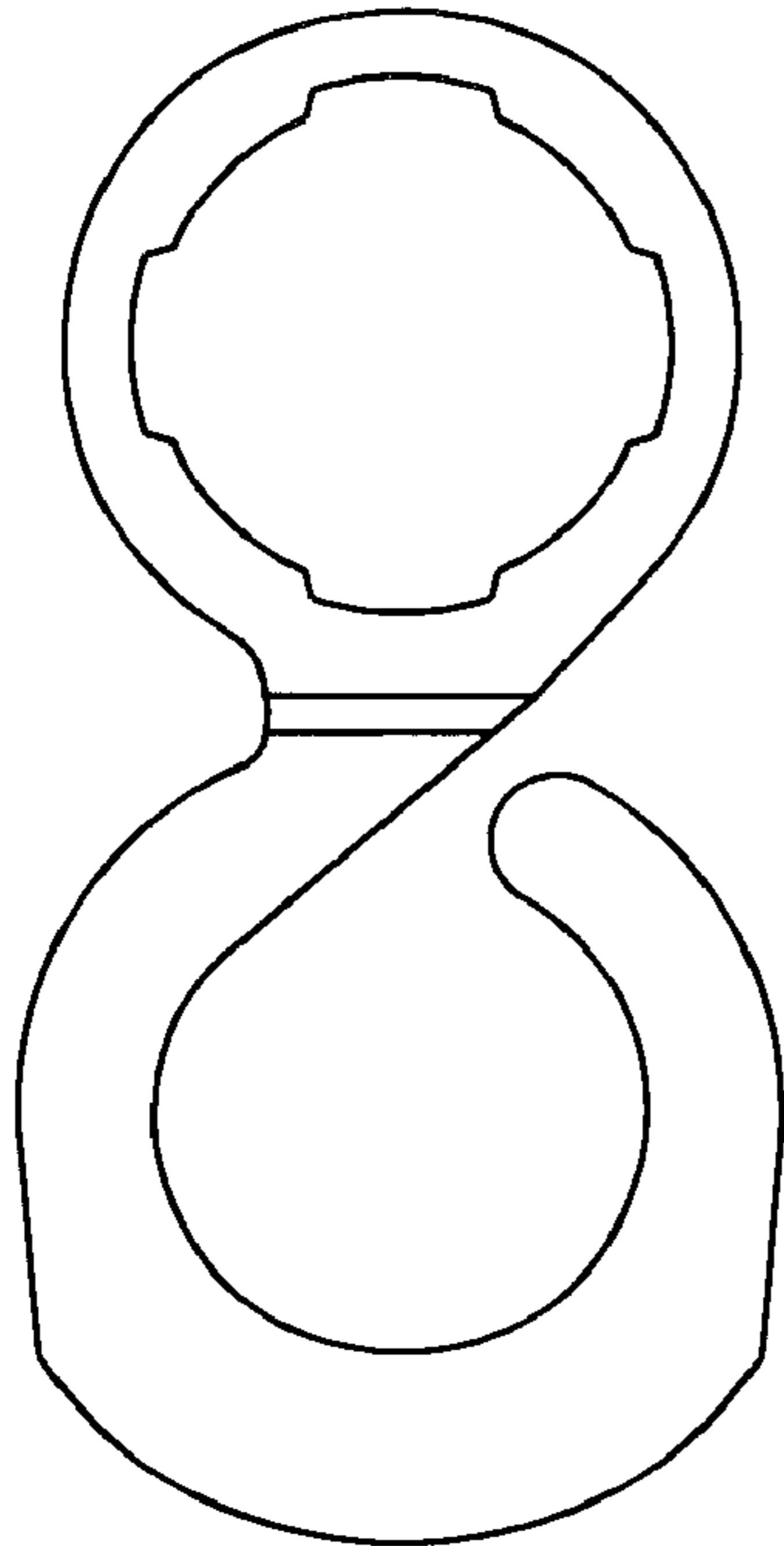

Fig. 1

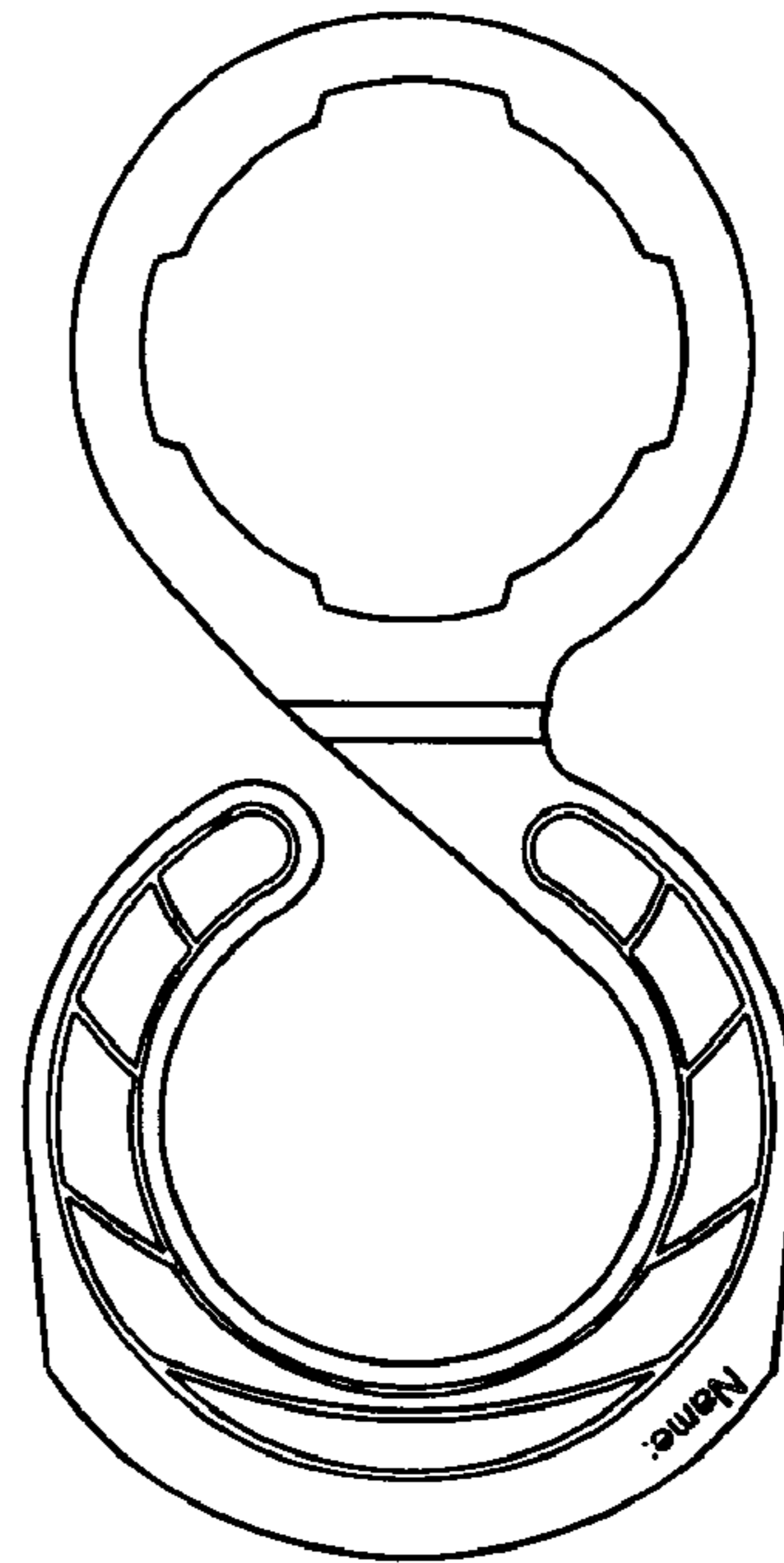

Fig. 2

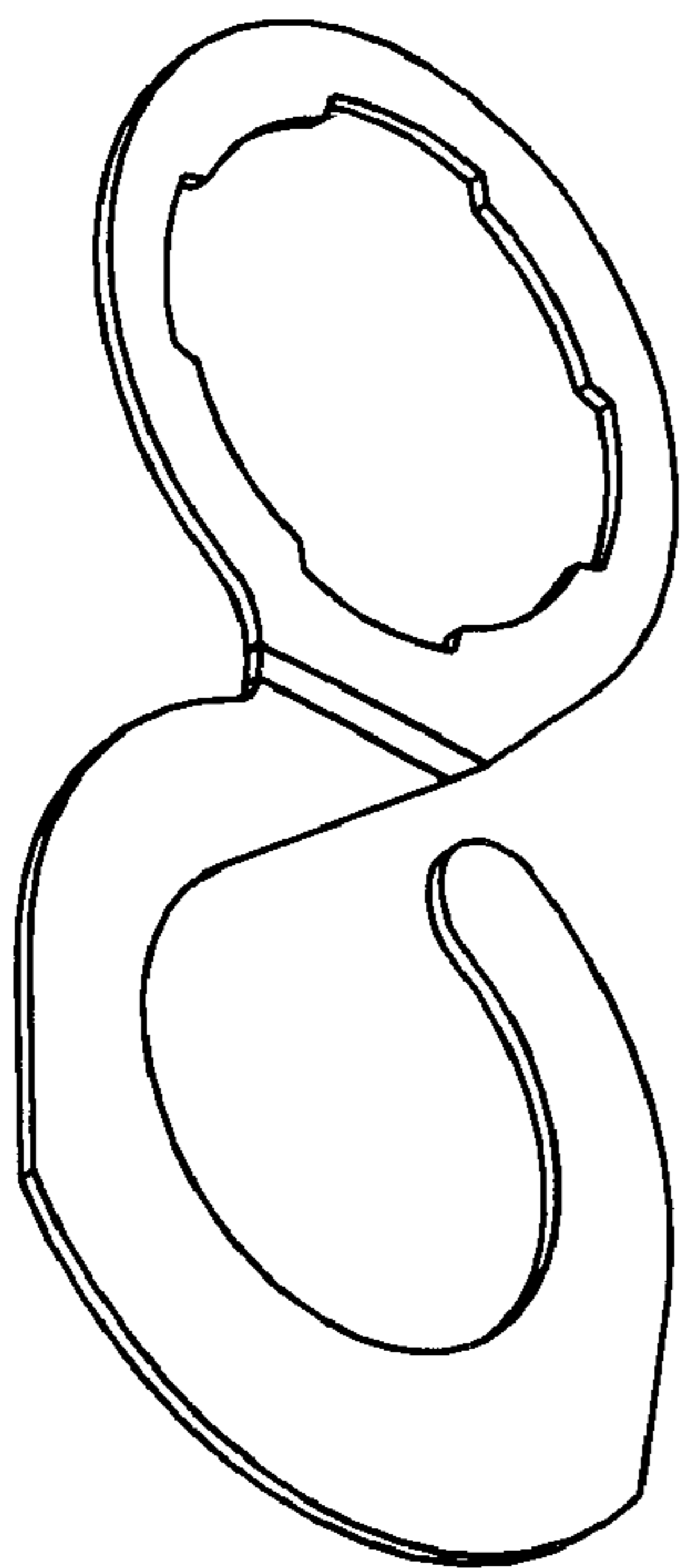

Fig. 3

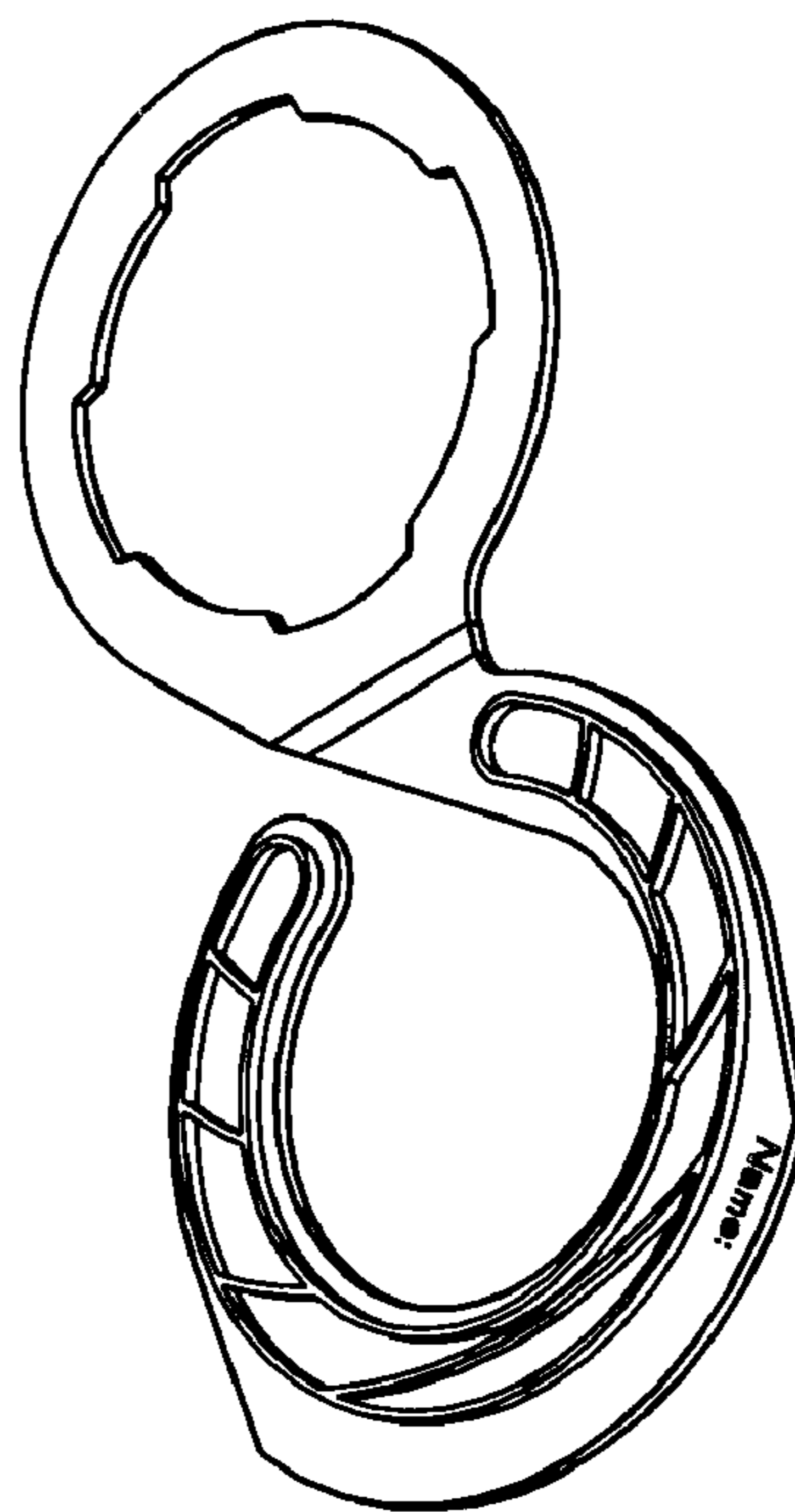

Fig. 4

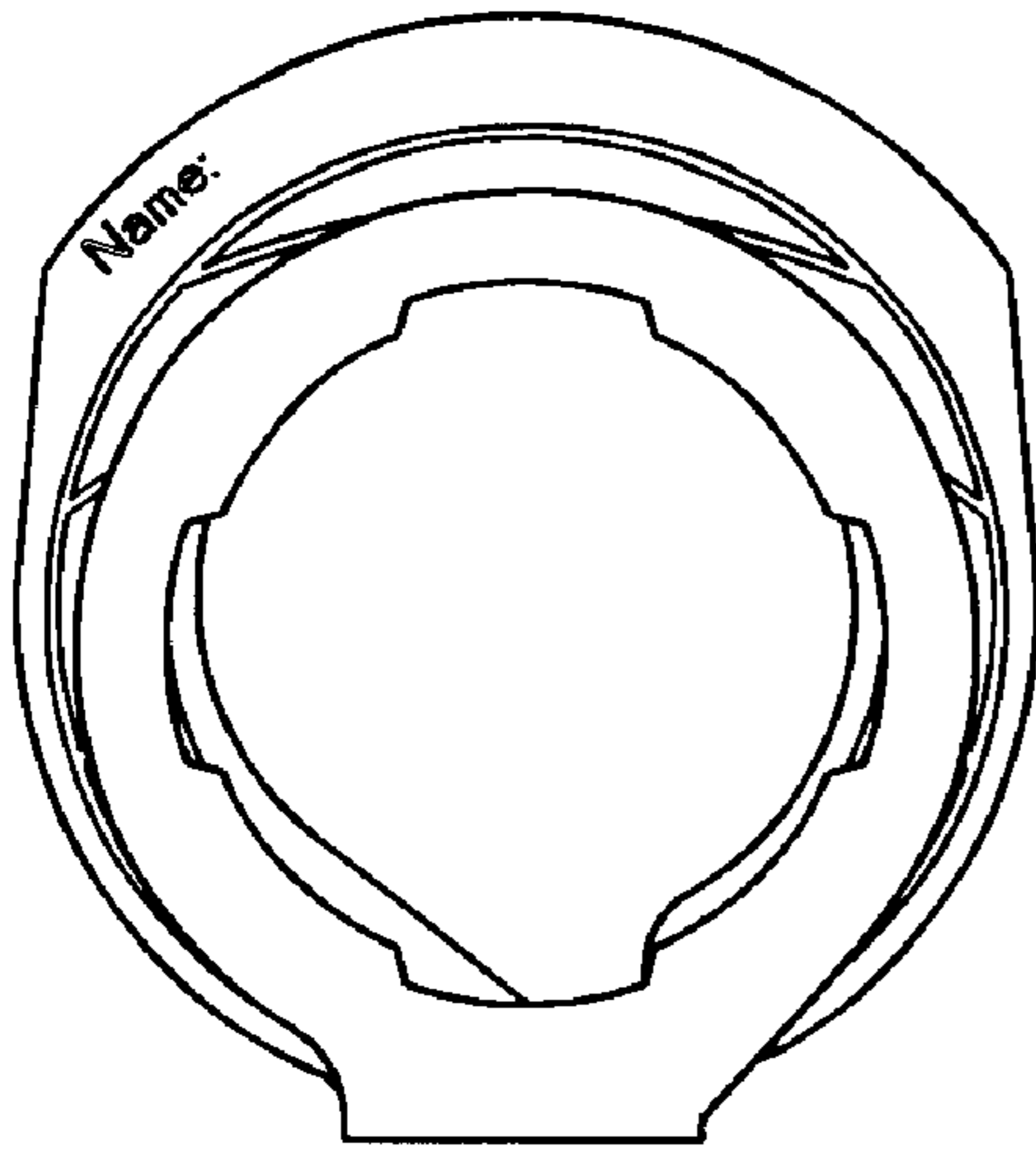

Fig. 5

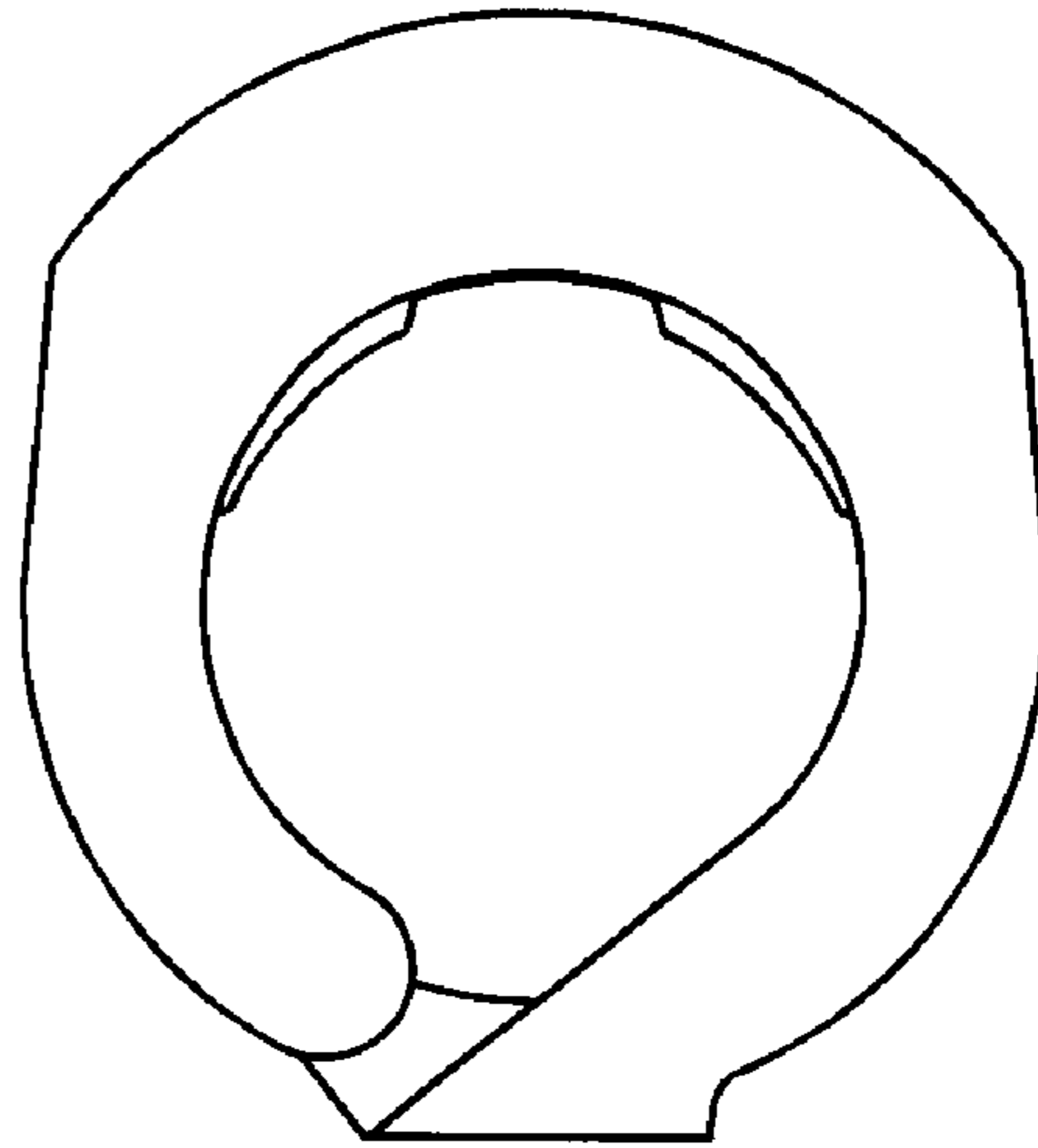

Fig. 6

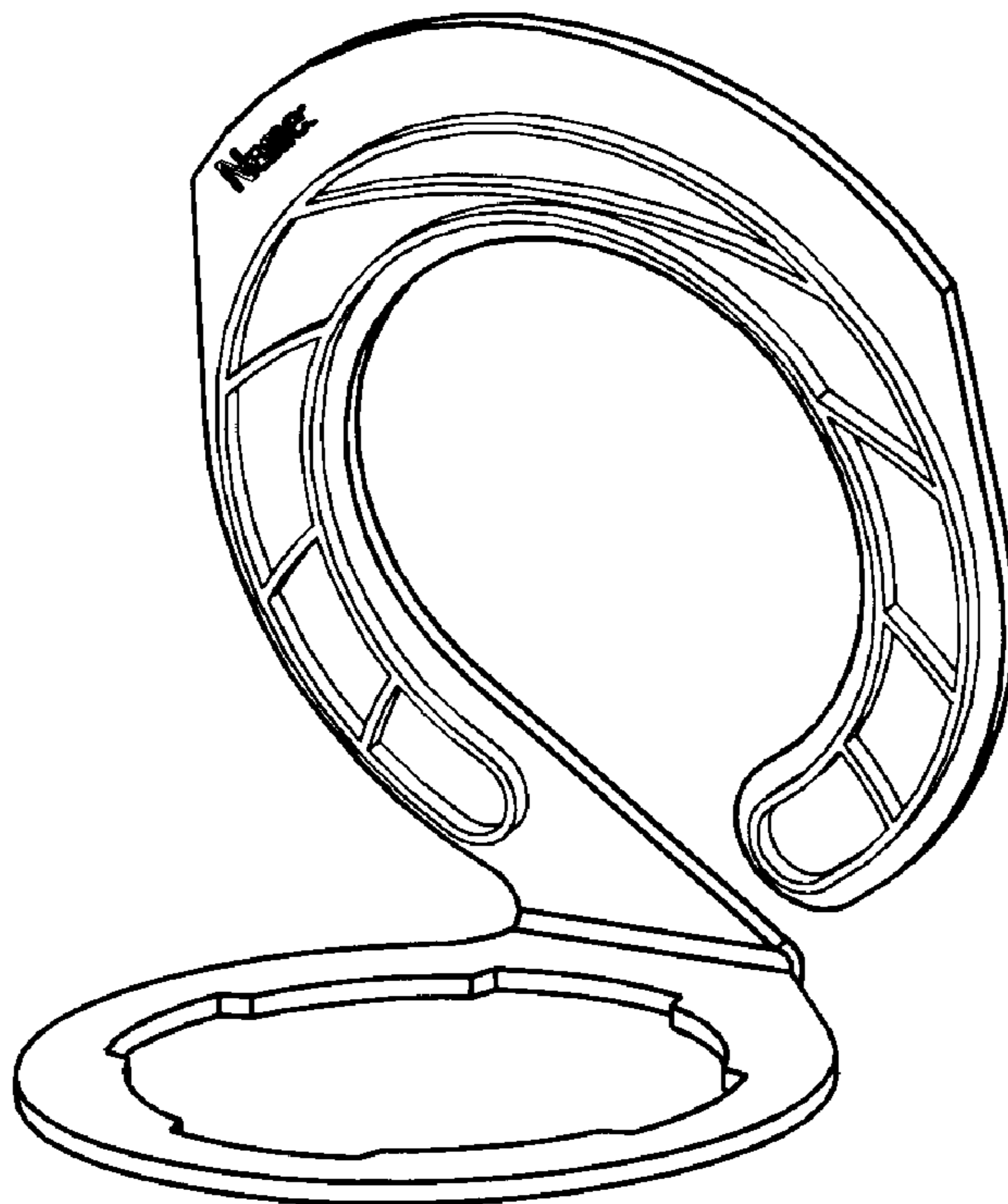

Fig. 7