

US00D502210S

(12) **United States Design Patent**
Katori et al.

(10) **Patent No.:** **US D502,210 S**
(45) **Date of Patent:** **** Feb. 22, 2005**

(54) **COPYING MACHINE WITH FACSIMILE**

D458,298 S * 6/2002 Katsuyama et al. D18/36
D473,587 S * 4/2003 Agata et al. D18/39
D486,851 S * 2/2004 Ohashi D18/39
D493,817 S * 8/2004 Yoshida et al. D18/39

(75) Inventors: **Takehito Katori**, Kanagawa (JP);
Junichi Ogawa, Saitama (JP)

(73) Assignee: **Matsushita Electric Industrial Co., Ltd.**, Osaka (JP)

(**) Term: **14 Years**

FOREIGN PATENT DOCUMENTS

JP D907055 6/1994
JP D973978 11/1996
JP D 1094217 10/2000

(21) Appl. No.: **29/196,429**

(22) Filed: **Dec. 29, 2003**

(30) **Foreign Application Priority Data**

Sep. 11, 2003 (JP) 2003-026584

(51) **LOC (7) Cl.** **16-03**

(52) **U.S. Cl.** **D18/39; D14/463**

(58) **Field of Search** D18/36-45, 50,
D18/53-56; 355/97; 399/1-7, 81, 107,
108, 130, 151, 411; D14/462-471

OTHER PUBLICATIONS

DiALTA Di 180f by Minolta; Jan. 1999.*

* cited by examiner

Primary Examiner—Caron D. Veynar

(74) *Attorney, Agent, or Firm*—Brinks Hofer Gilson & Lione

(57) **CLAIM**

The ornamental design for a copying machine with facsimile, as shown and described.

(56) **References Cited**

U.S. PATENT DOCUMENTS

D305,438 S 1/1990 Miyamoto et al.
D328,095 S 7/1992 Sugihara et al.
D329,454 S 9/1992 Sugihara et al.
D329,455 S 9/1992 Sugihara et al.
D339,370 S 9/1993 Sugihara et al.
D374,030 S 9/1996 Horiki et al.
D404,419 S * 1/1999 Kusanagi D18/39
D438,559 S * 3/2001 Matsumoto et al. D18/39
D451,124 S * 11/2001 Isomoto D18/39

DESCRIPTION

FIG. 1 is a top perspective view of a copying machine with facsimile of the present invention; FIG. 2 is a first side view thereof; FIG. 3 is a front view thereof; FIG. 4 is a second side view thereof; FIG. 5 is a rear view thereof; FIG. 6 is a top view thereof; and, FIG. 7 is a bottom view thereof.

1 Claim, 7 Drawing Sheets

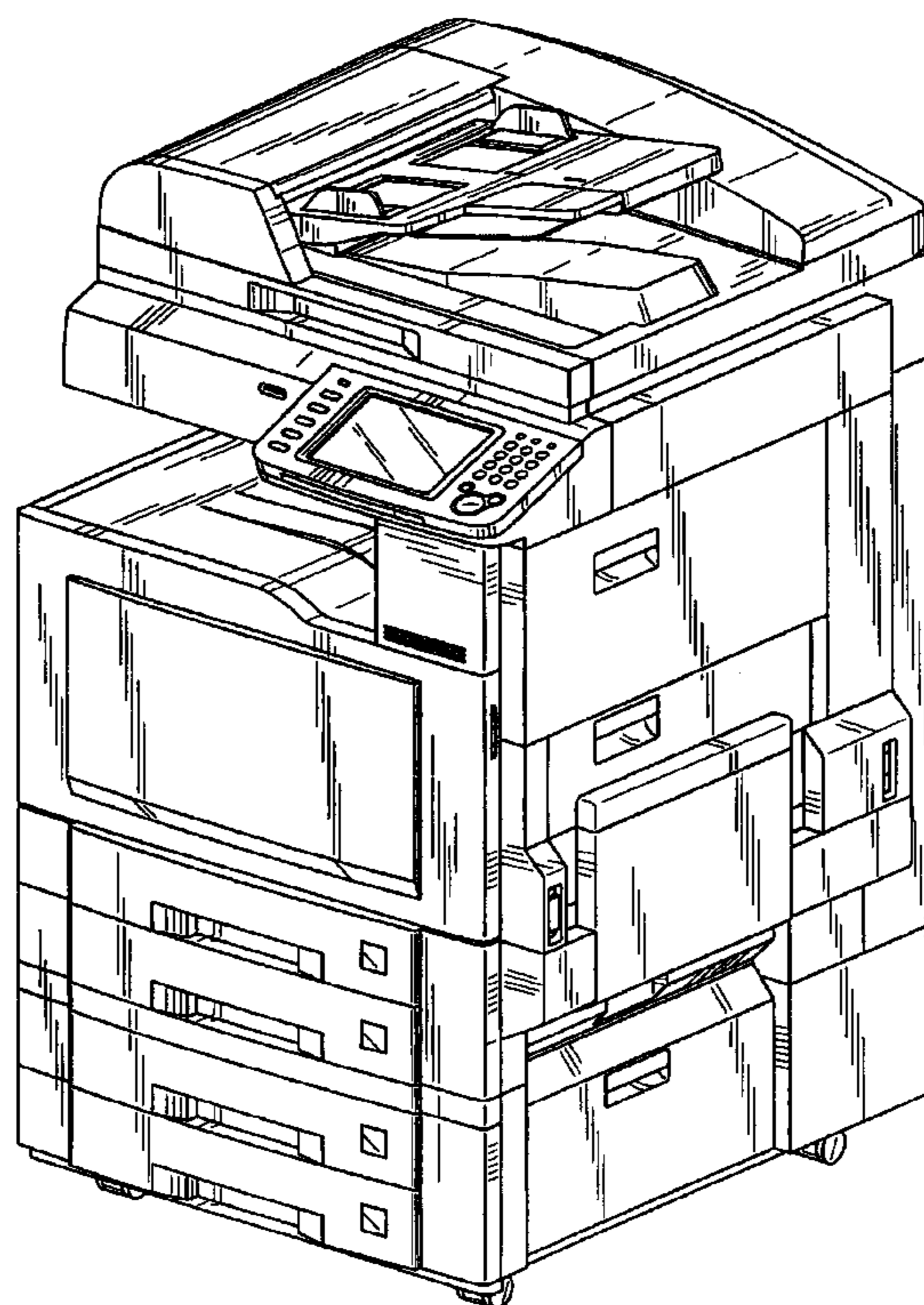

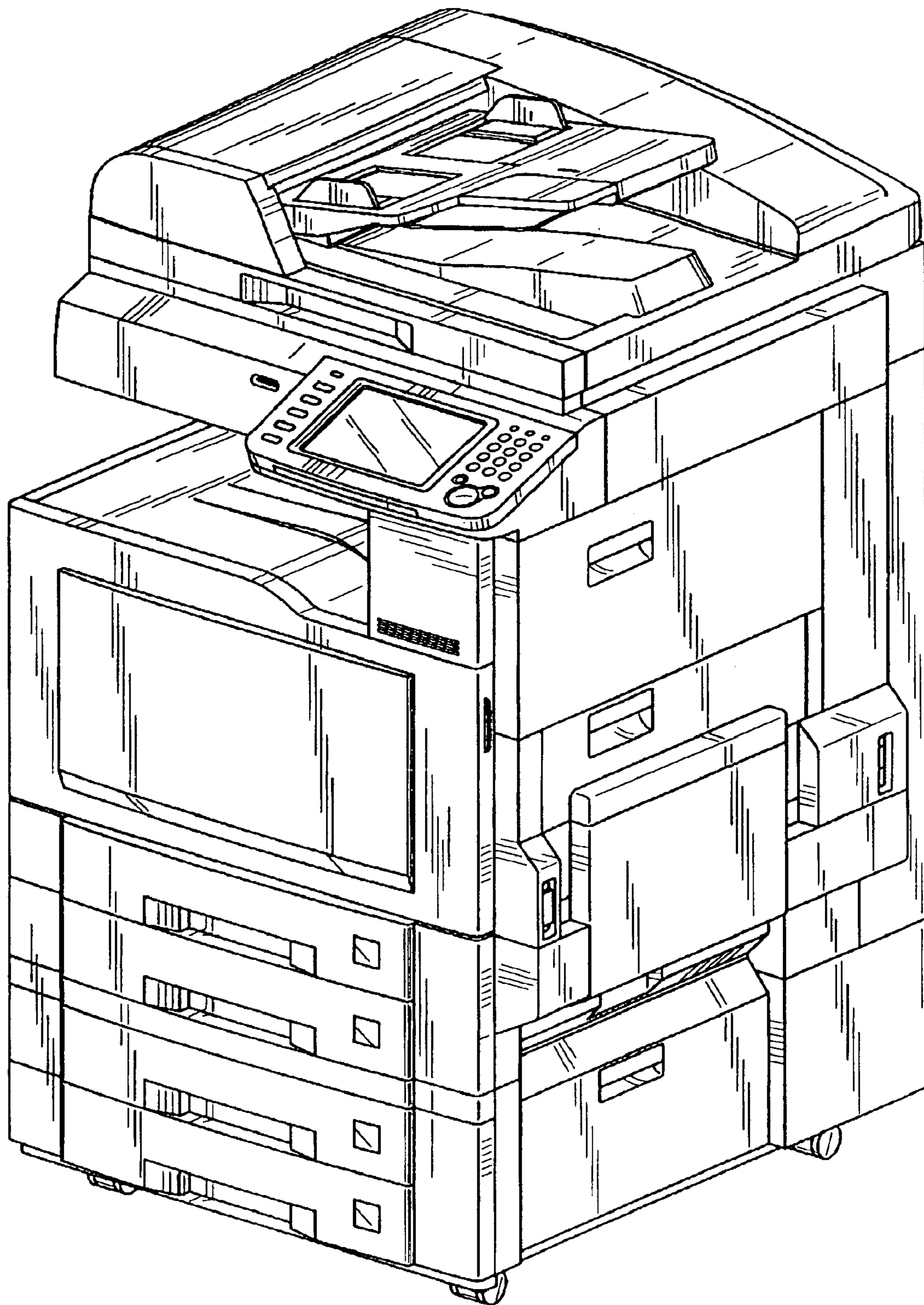

FIG. 1

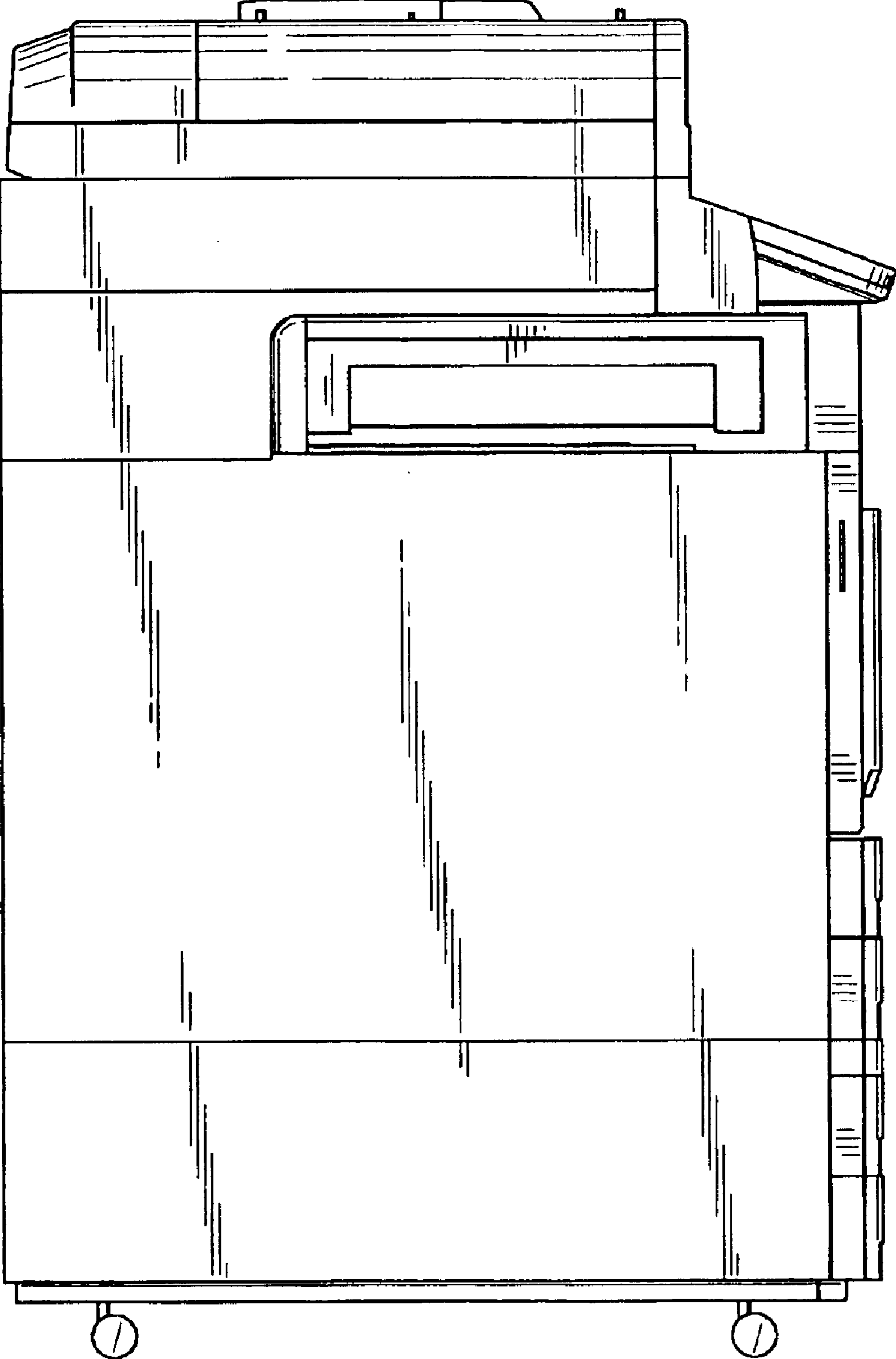

FIG. 2

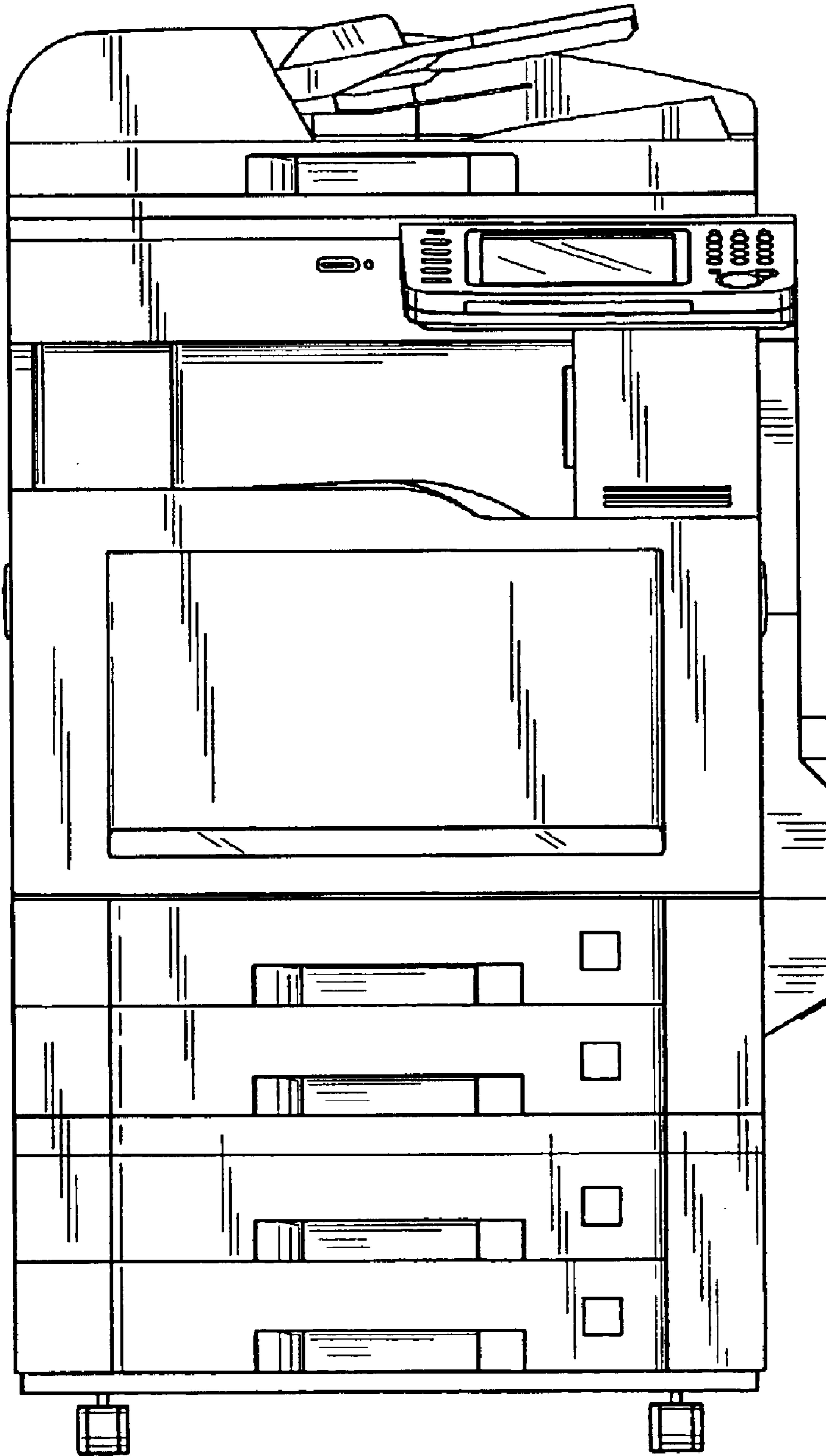

FIG. 3

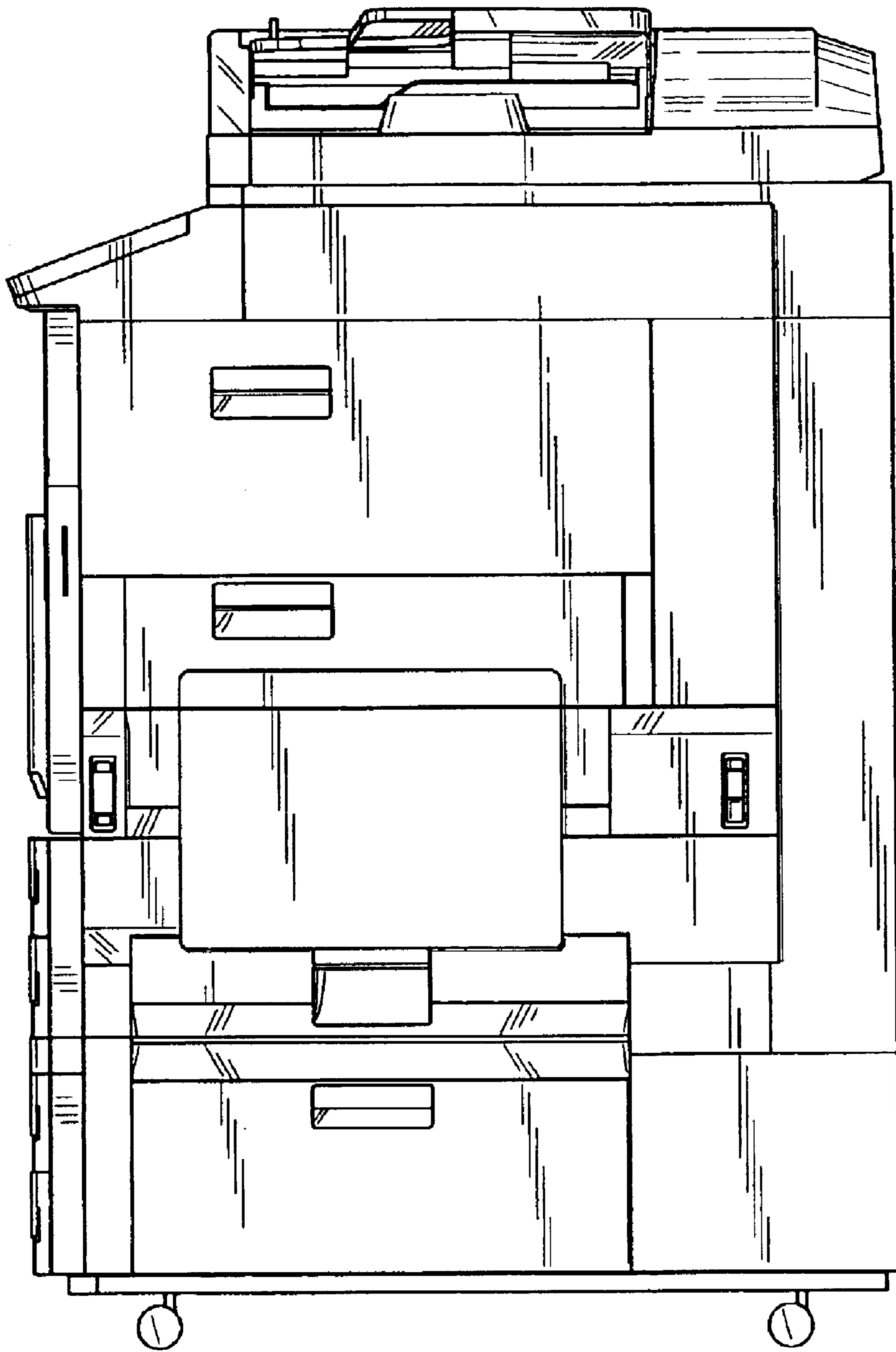

FIG. 4

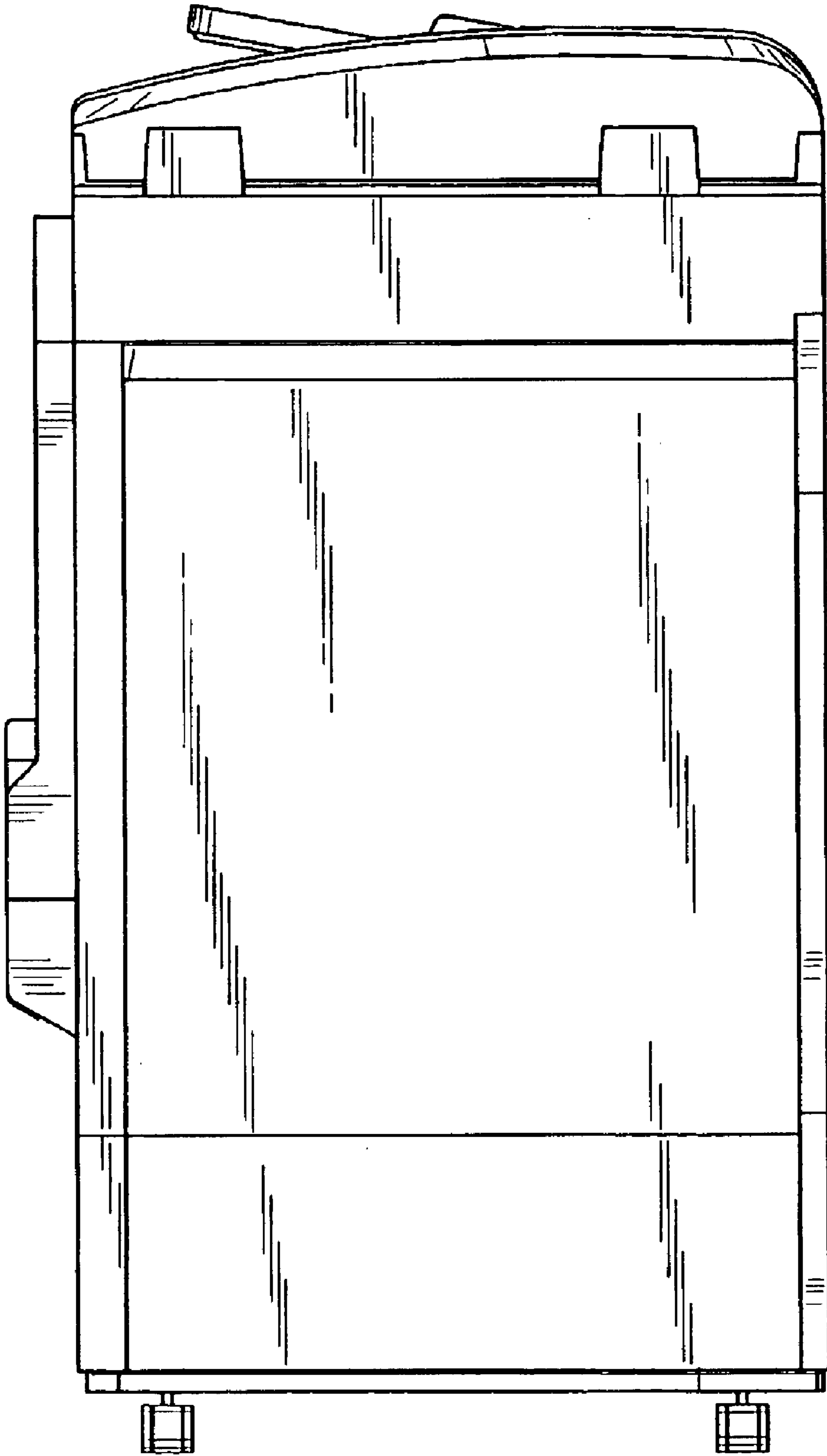

FIG. 5

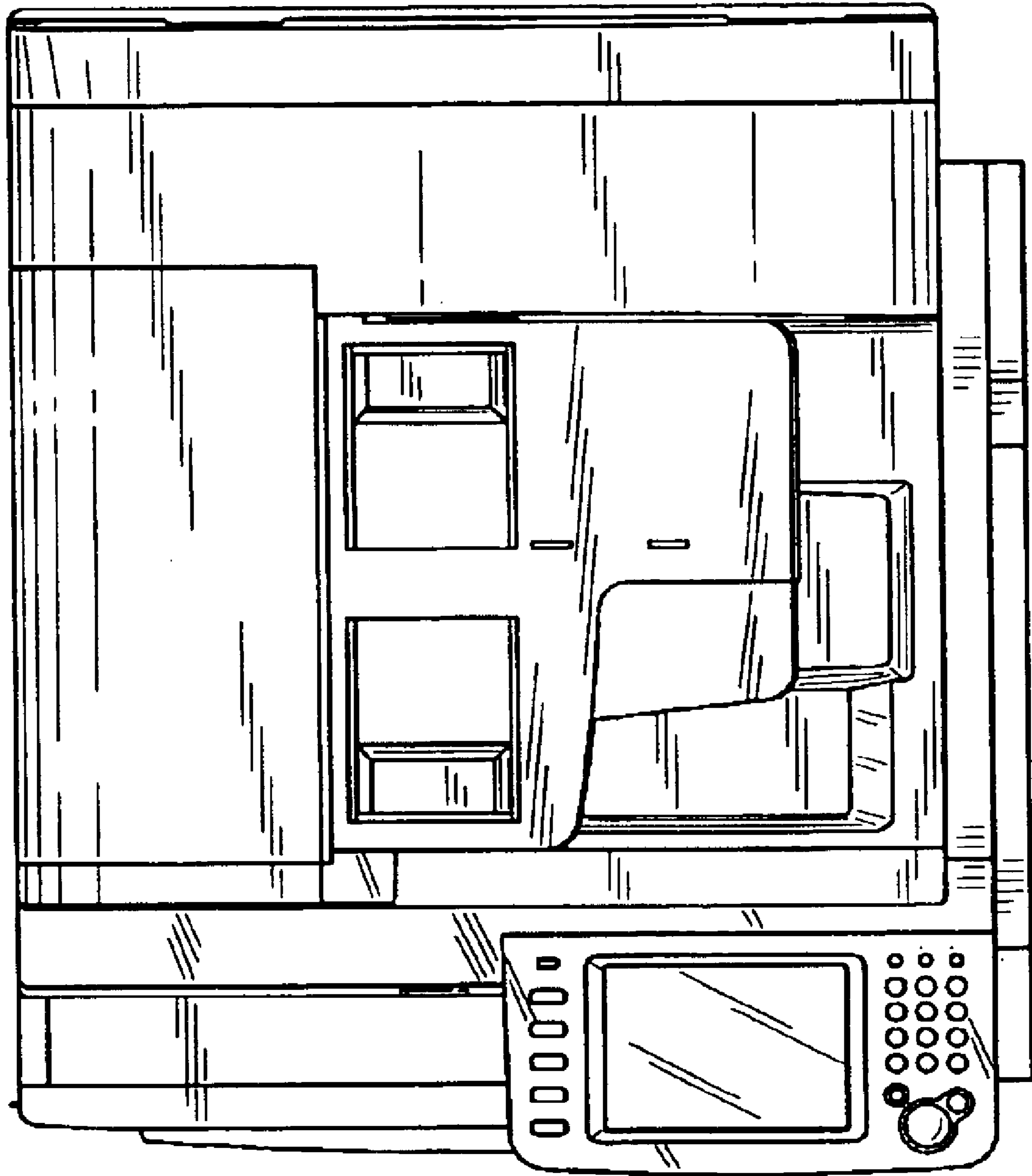

FIG. 6

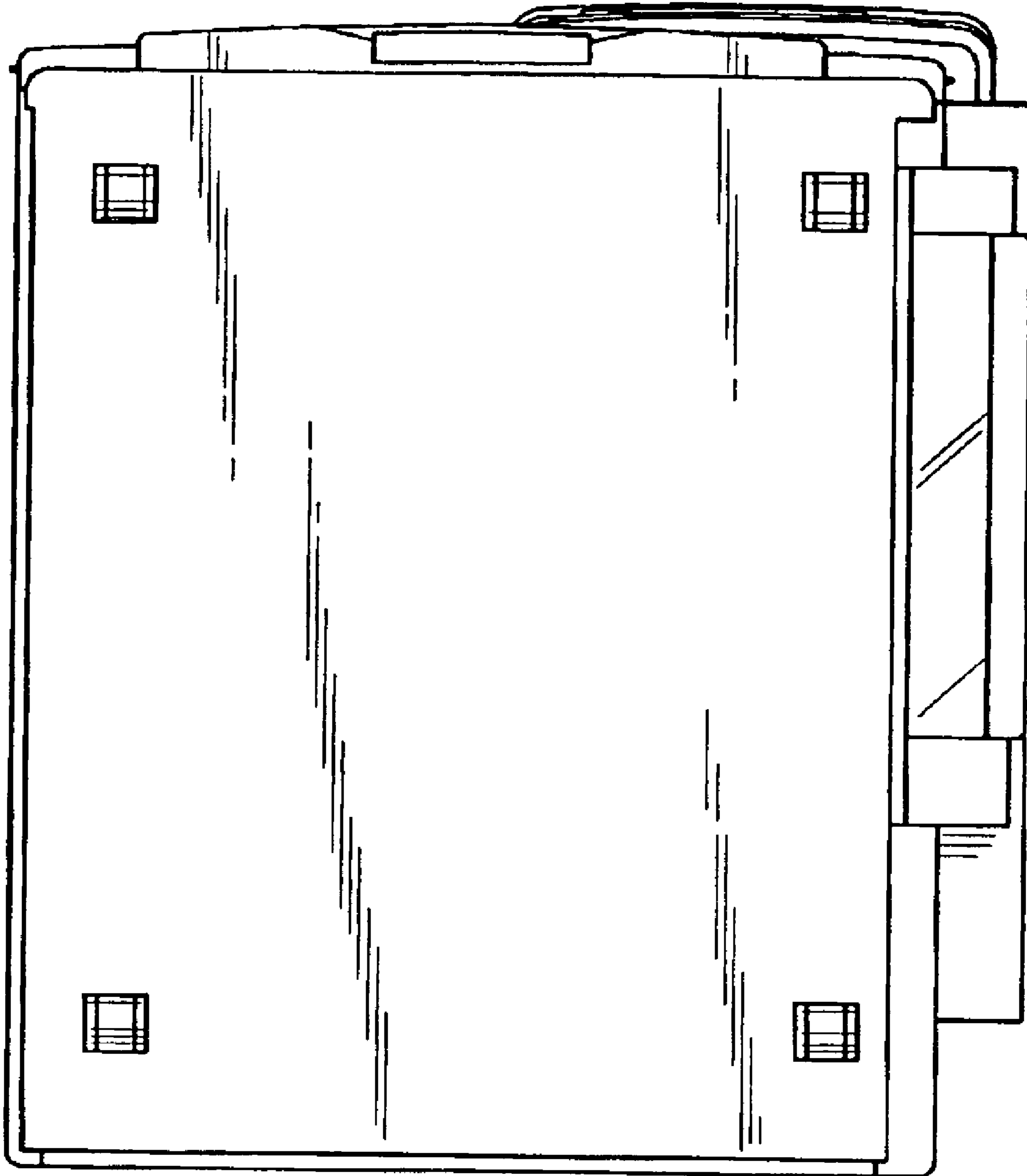

FIG. 7