

US00D501973S

(12) **United States Design Patent**
Bell

(10) **Patent No.:** **US D501,973 S**
(45) **Date of Patent:** **** Feb. 15, 2005**

(54) **ACCESSORY RACK MOUNTABLE ON VEHICLE AND CONVERTIBLE TO A HAND TRUCK**

(76) **Inventor:** **Gary T. Bell**, P.O. Box 1461, Pilot Mountain, NC (US) 27041

(**) **Term:** **14 Years**

(21) **Appl. No.:** **29/185,297**

(22) **Filed:** **Jun. 25, 2003**

(51) **LOC (7) Cl.** **12-02**

(52) **U.S. Cl.** **D34/24**

(58) **Field of Search** D34/12-27; D12/414.1, D12/406, 408; 224/401, 418, 504; 280/654, 47.19, 47.26; D3/215

(56) **References Cited**

U.S. PATENT DOCUMENTS

3,804,432	A	*	4/1974	Lehrman	280/654
D259,715	S	*	6/1981	Melilli	D12/406
5,380,033	A	*	1/1995	Harling	280/654
D409,557	S	*	5/1999	Armour	D12/408
D427,765	S	*	7/2000	Porter	D3/215
6,089,428	A	*	7/2000	Wagner	224/401

* cited by examiner

Primary Examiner—Holly Baynham

(74) *Attorney, Agent, or Firm*—Dougherty, Clements & Hofer

(57) **CLAIM**

The ornamental design for an accessory rack mountable on vehicle and convertible to a hand truck, as shown and described.

DESCRIPTION

FIG. 1 is a perspective view of an accessory rack mountable on a vehicle and convertible to a hand truck showing my

new design; the broken line illustration of the wheels, grating, tire and rear portion of the vehicle in this view and the views of FIGS. 2-10 is for illustrative purposes only and forms no part of the claimed design;

FIG. 2 is a perspective view thereof showing the design with removable side bars oriented in a forward extending position;

FIG. 3 is a perspective view thereof showing the design with side bars oriented to extend in an upward position;

FIG. 4 is a perspective view thereof showing the design with side bars relocated to the top of the rack and oriented to extend in an upward position;

FIG. 5 is a top plan view of FIG. 2;

FIG. 6 is a right side elevation view of FIG. 2;

FIG. 7 is a rear elevation view of FIG. 2;

FIG. 8 is a left side elevation view of FIG. 2;

FIG. 9 is a front elevation view of FIG. 2; and,

FIG. 10 is a bottom plan view of FIG. 2.

The specific number of crossbars and the exact form of the support shelf as shown in broken lines in FIGS. 1 through 4, 5, and 10 is disclaimed, and forms no part of the claimed design.

Material shown in dotted lines is for clarity only, and forms no part of the invented design.

1 Claim, 5 Drawing Sheets

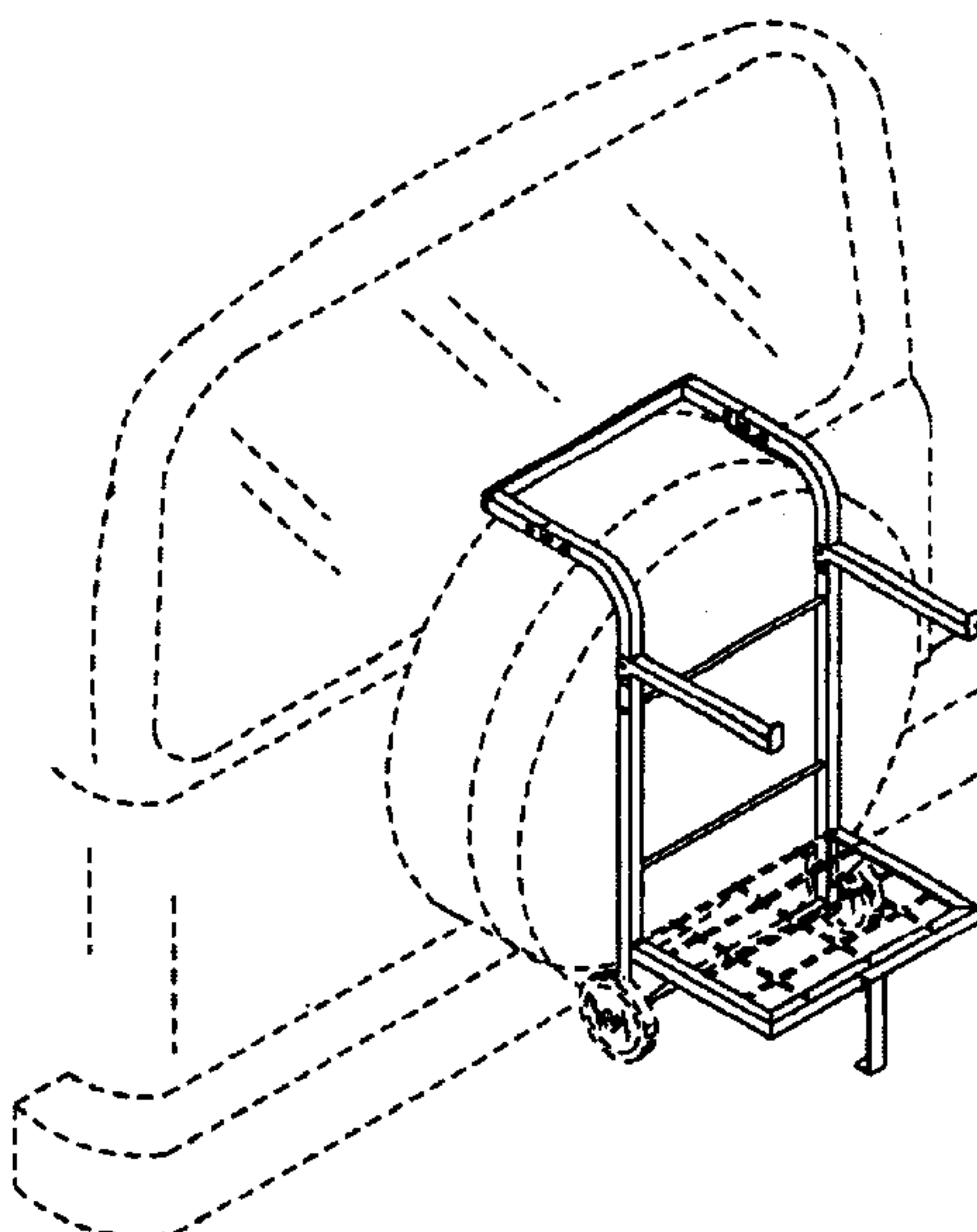

Fig. 1

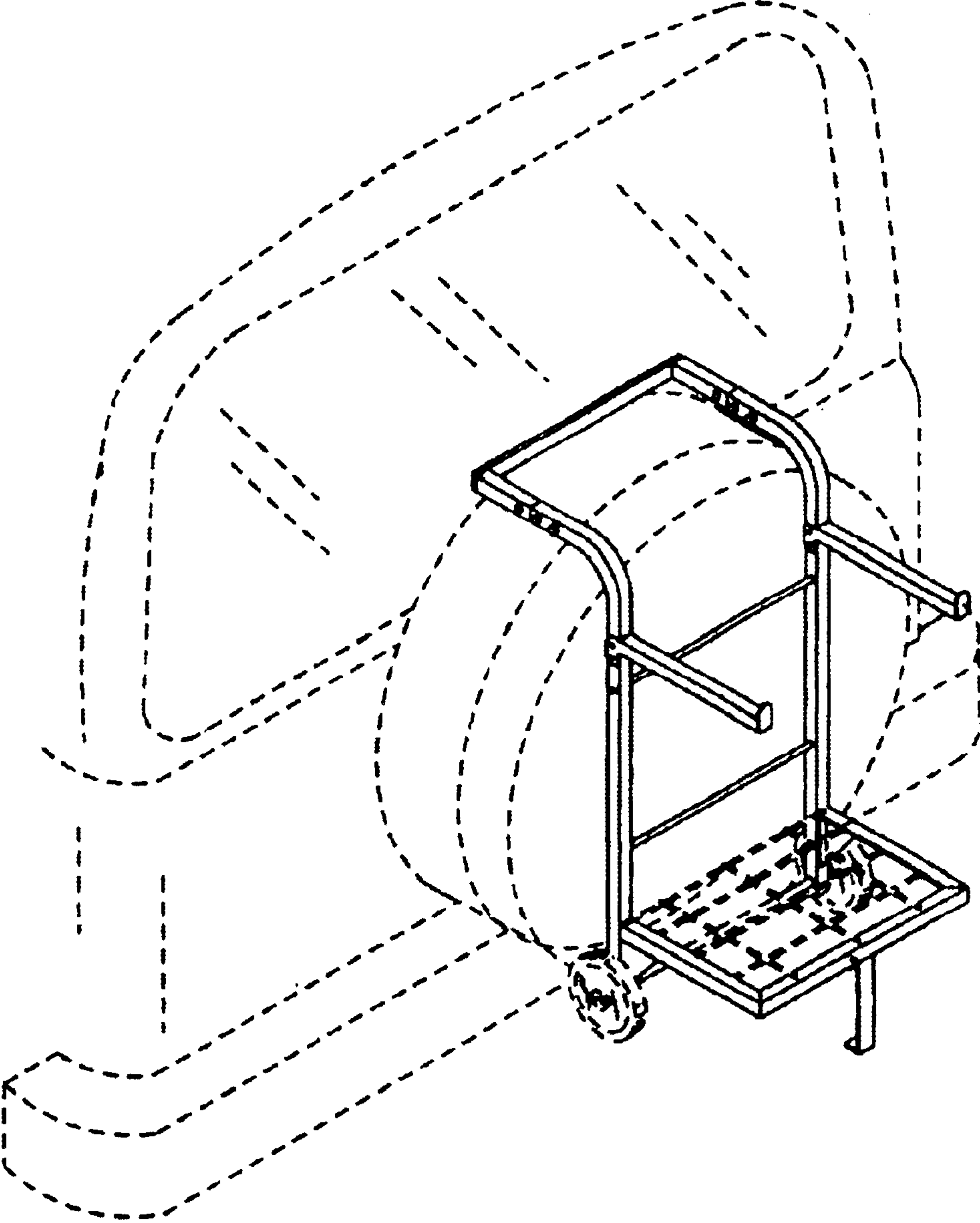

Fig. 2

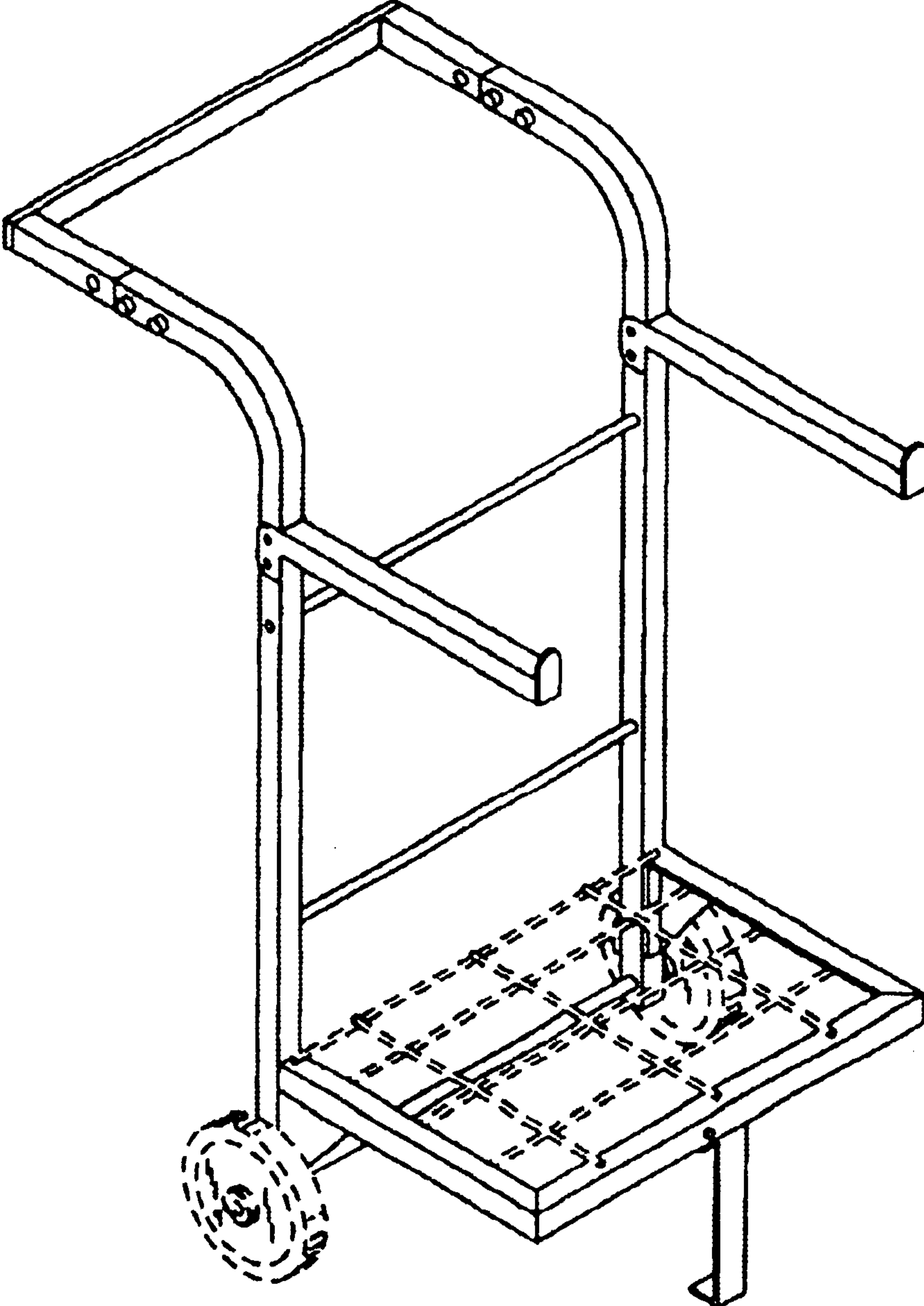

Fig. 3

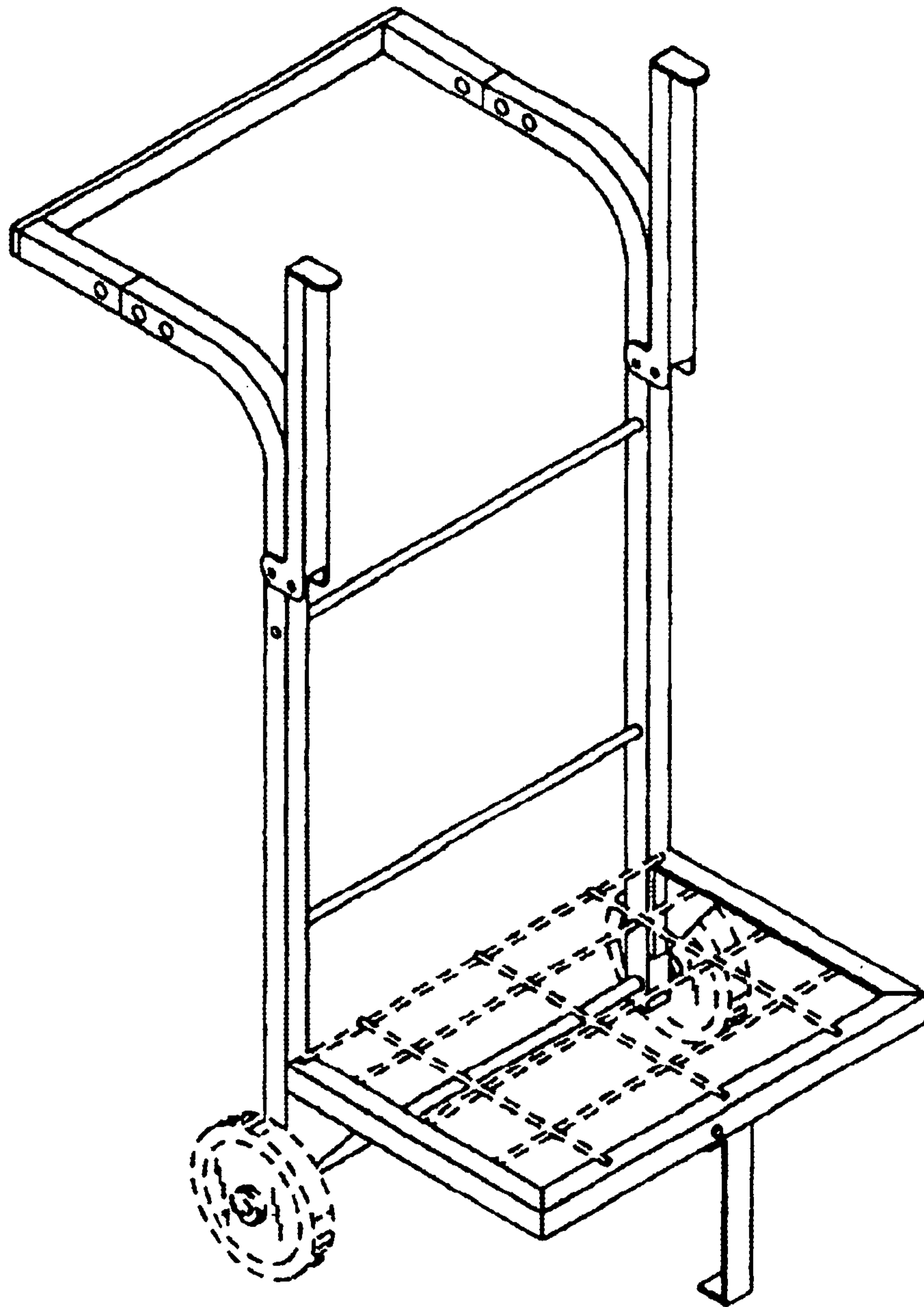
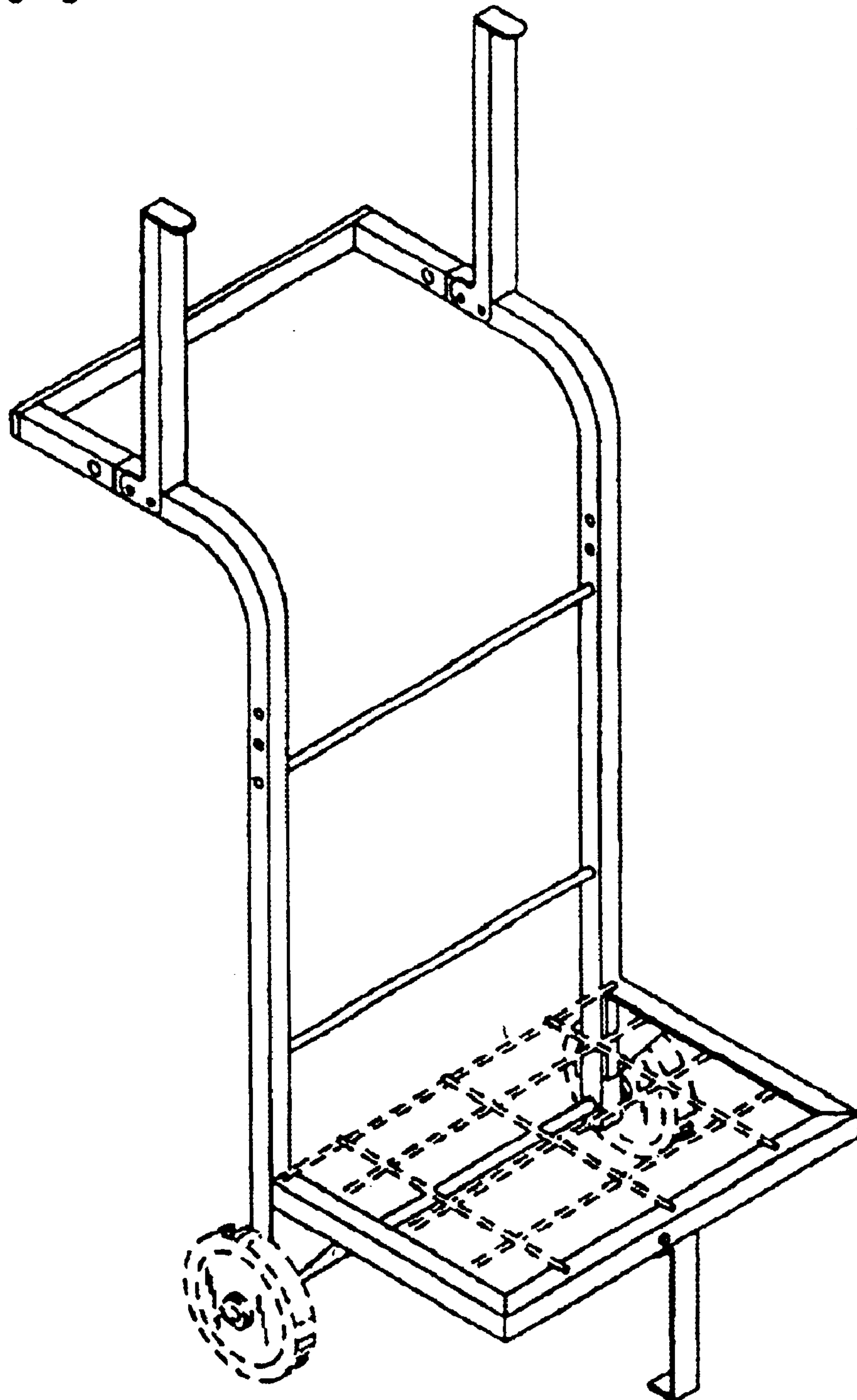

Fig. 4



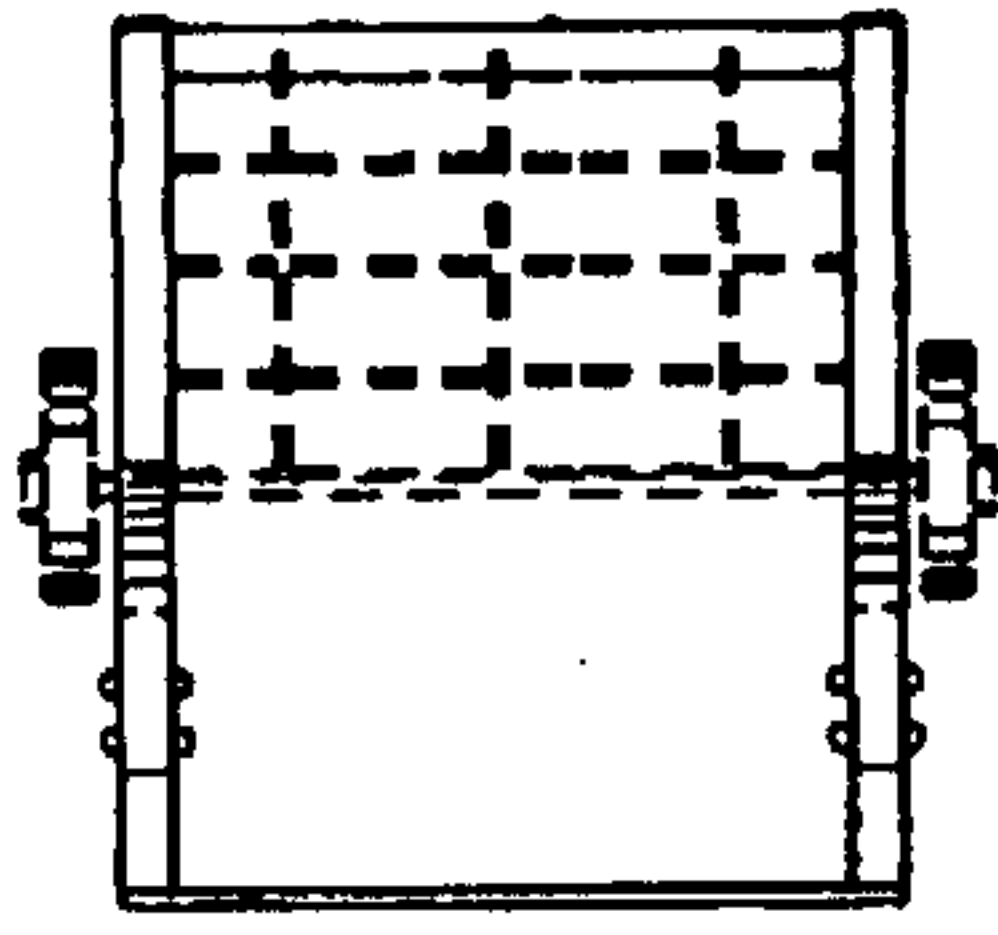

Fig. 5

Fig. 9

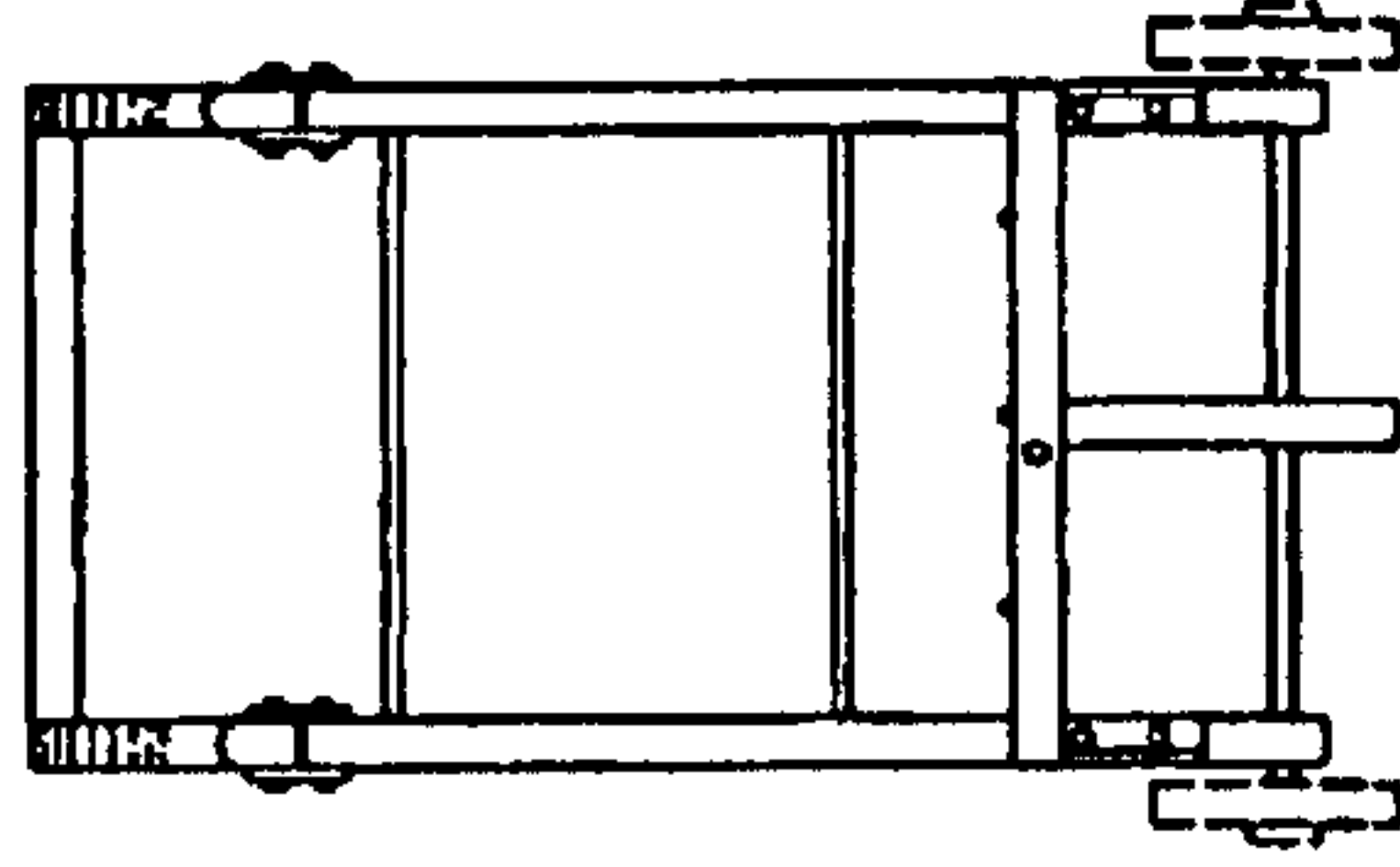

Fig. 8

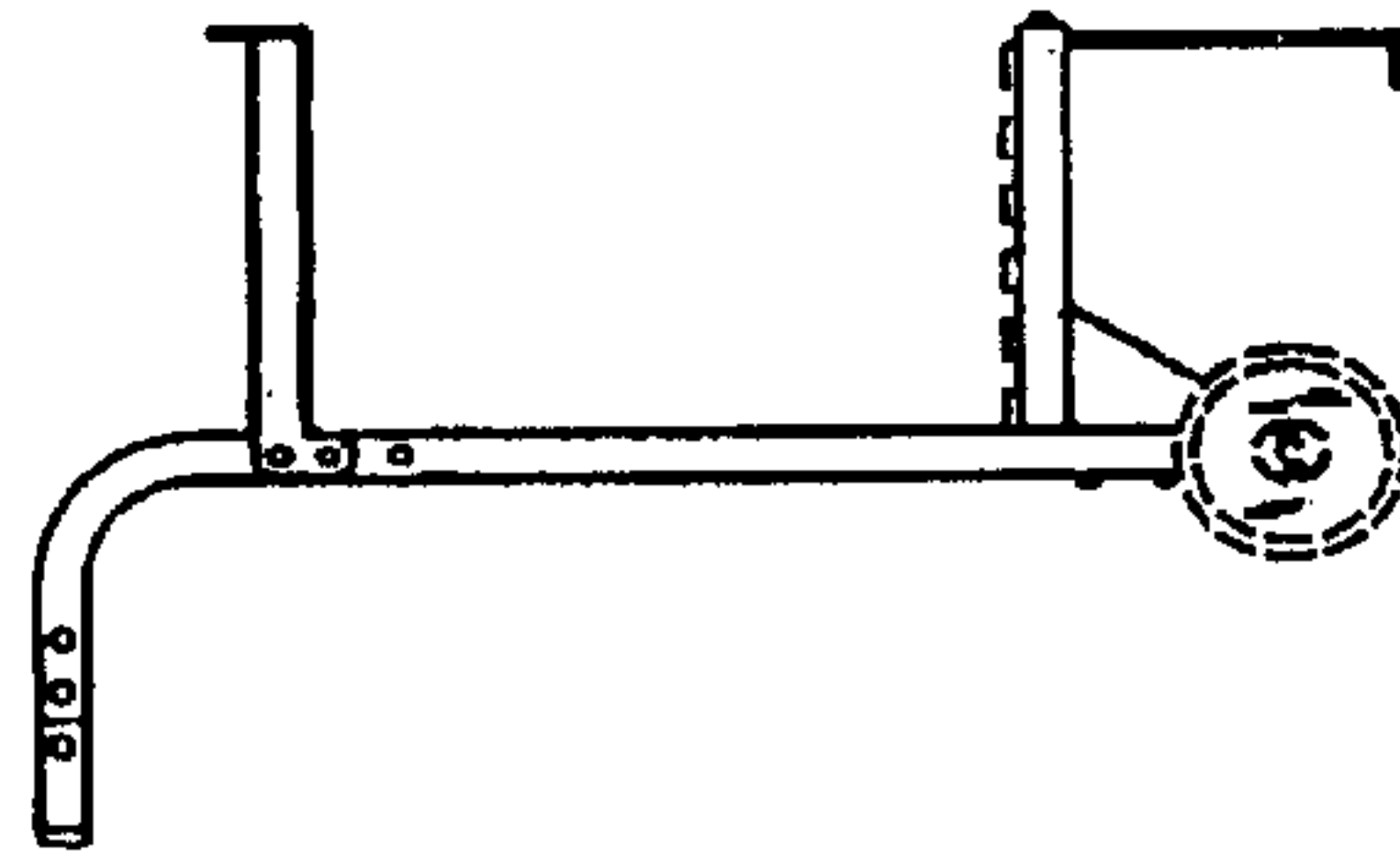

Fig. 7

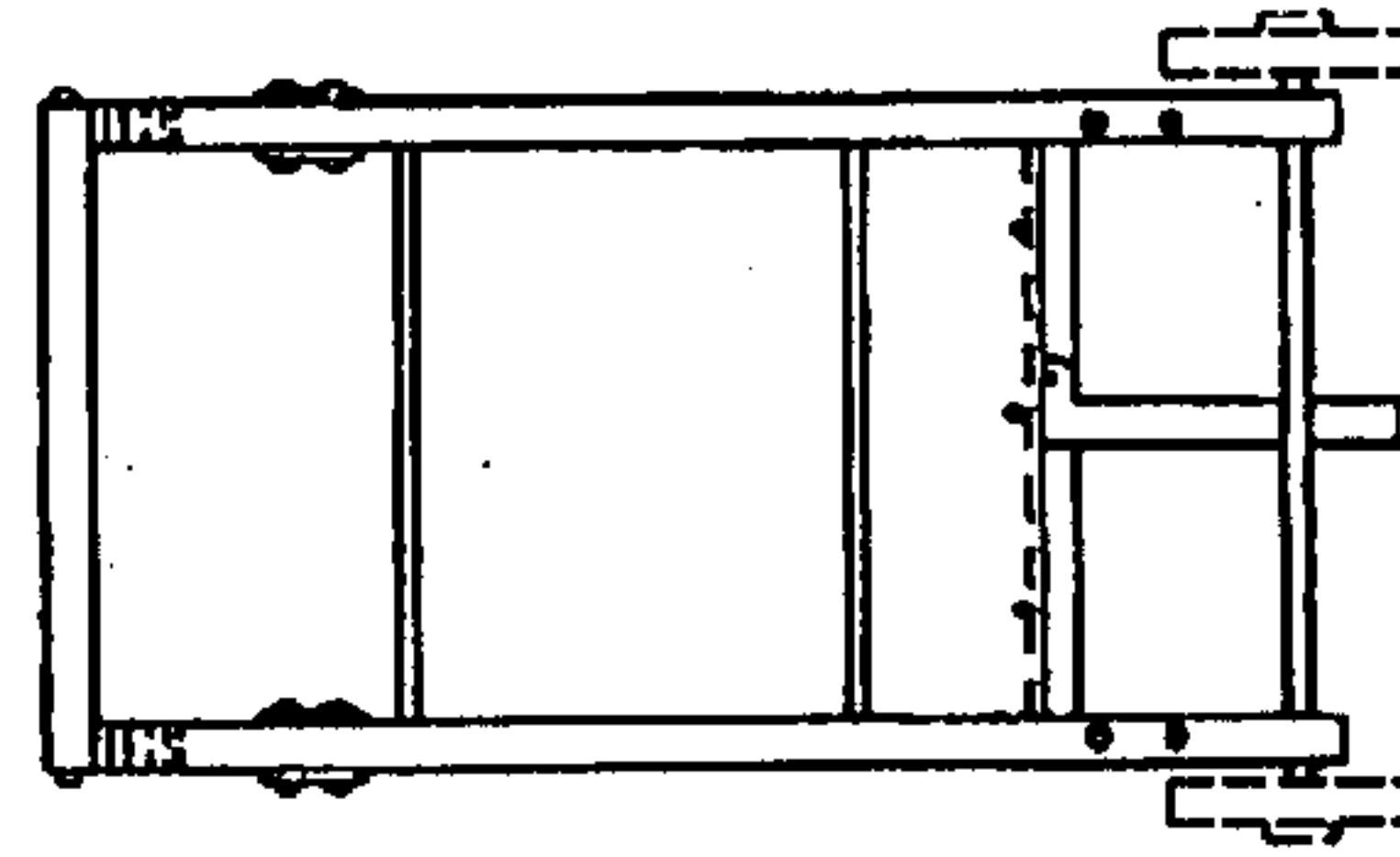

Fig. 6

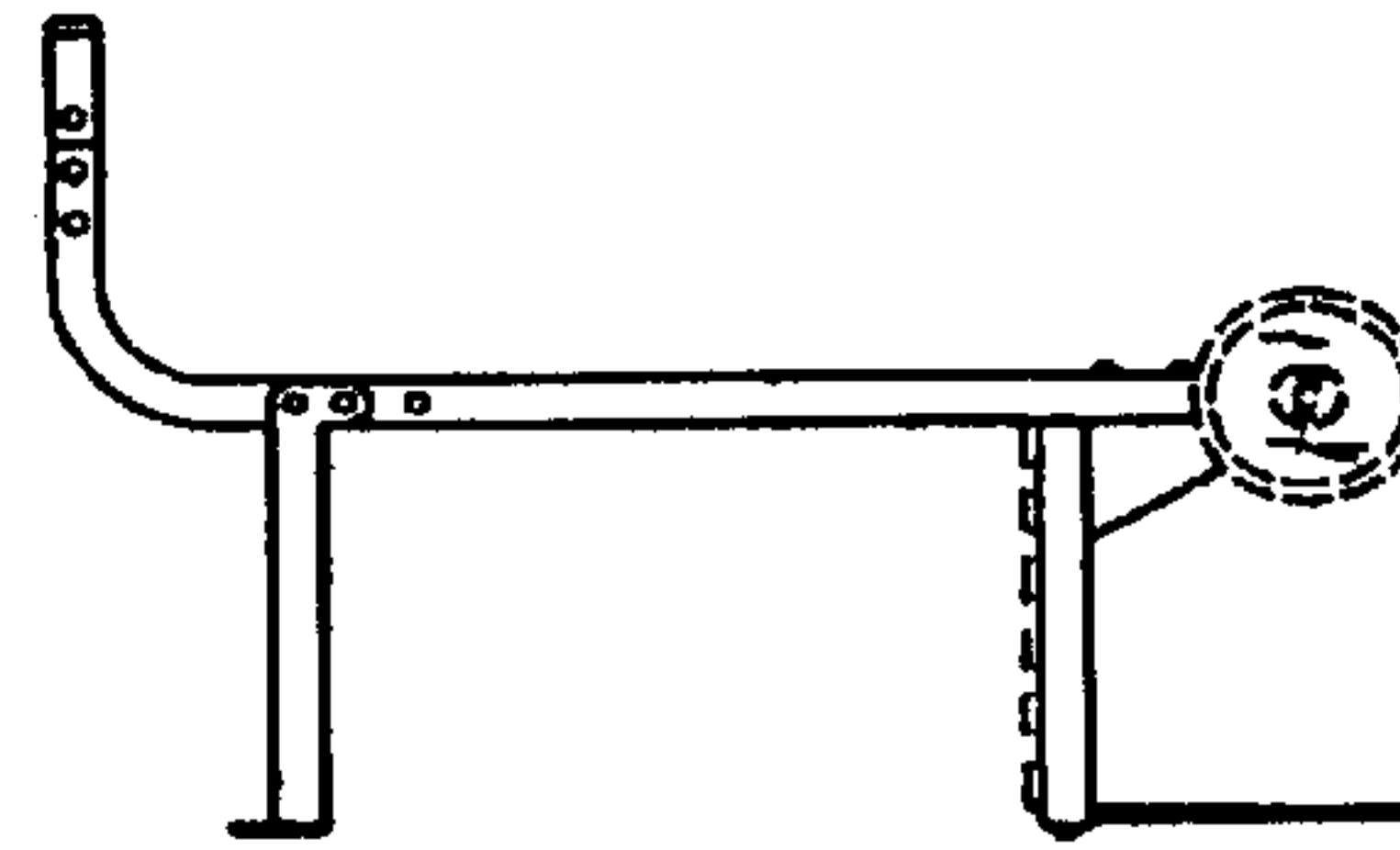

Fig. 10

