

US00D500664S

(12) **United States Design Patent**  
**Myers et al.**

(10) **Patent No.: US D500,664 S**  
(45) **Date of Patent: \*\* Jan. 11, 2005**

(54) **CAM STOP ADAPTOR OF A LOCK**

(75) **Inventors: Gary L. Myers, Monee, IL (US);  
Richard Paeth, St. Charles, IL (US);  
Catalin Captarencu, Wheeling, IL  
(US); Calin V. Roatis, Long Grove, IL  
(US); Tomasz Barnas, Lake in the  
Hills, IL (US)**

(73) **Assignee: TriTeq Lock and Security, L.L.C., Elk  
Grove Village, IL (US)**

(\*\*) **Term: 14 Years**

(21) **Appl. No.: 29/195,985**

(22) **Filed: Dec. 19, 2003**

(51) **LOC (7) Cl. .... 08-07**

(52) **U.S. Cl. .... D8/343**

(58) **Field of Search ..... D8/330, 331, 343,  
D8/334; 70/51, 258, 431, 14, 20, 141, 210,  
315-319, 211; 292/49.111, 98, 159, 170,  
182, 245**

(56) **References Cited**

**U.S. PATENT DOCUMENTS**

1,583,688 A \* 5/1926 Hatch ..... 70/312

3,361,464 A \* 1/1968 Foster ..... 292/245  
4,243,256 A \* 1/1981 Frydrych ..... 292/245  
5,010,749 A \* 4/1991 Lin ..... 70/190  
5,199,285 A \* 4/1993 Lin ..... 70/220  
D436,833 S \* 1/2001 Turner et al. .... D8/331  
D439,132 S \* 3/2001 Rechberg ..... D8/339  
D477,984 S \* 8/2003 Laabs et al. .... D8/343

\* cited by examiner

*Primary Examiner*—Prabhakar Deshmukh

(74) *Attorney, Agent, or Firm*—Leydig, Voit & Mayer, Ltd.

(57) **CLAIM**

The ornamental design for a cam stop adaptor of a lock, substantially as shown and described.

**DESCRIPTION**

FIG. 1 is a top, rear and left perspective view of a cam stop adaptor of a lock showing our new design; FIG. 2 is a left side elevational view thereof; FIG. 3 is a front elevational view thereof; FIG. 4 is a rear elevational view thereof; FIG. 5 is a top plan view of FIG. 3; and, FIG. 6 is a bottom plan view of FIG. 4.

**1 Claim, 1 Drawing Sheet**

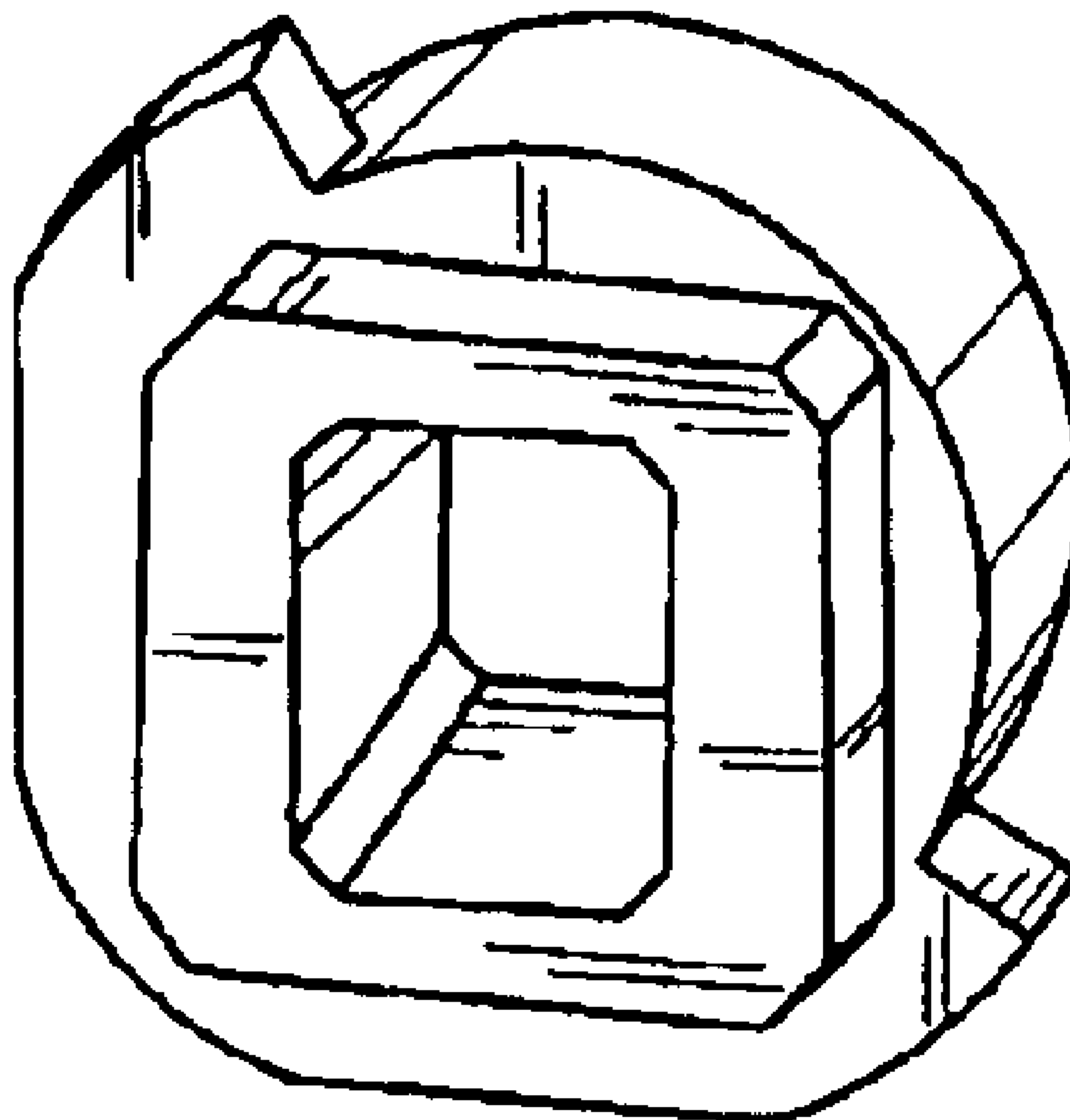

FIG. 1

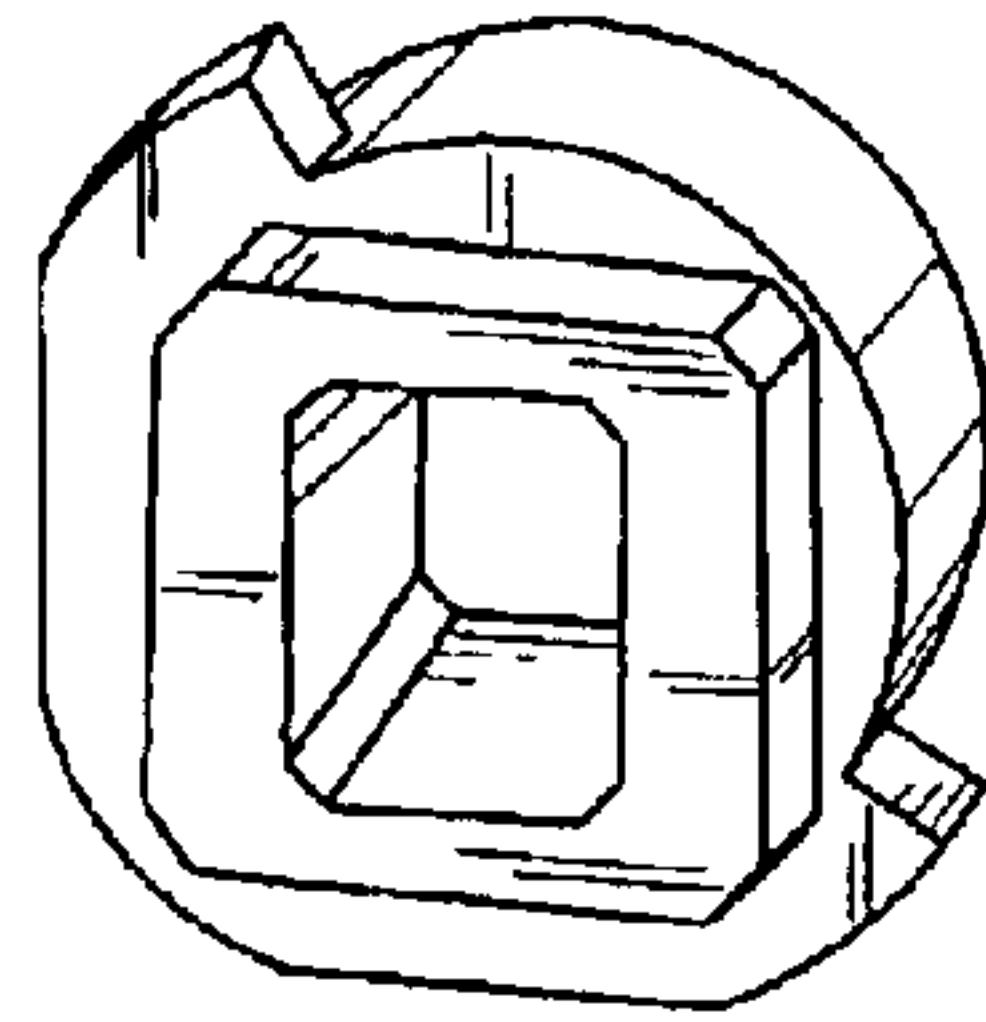

FIG. 5

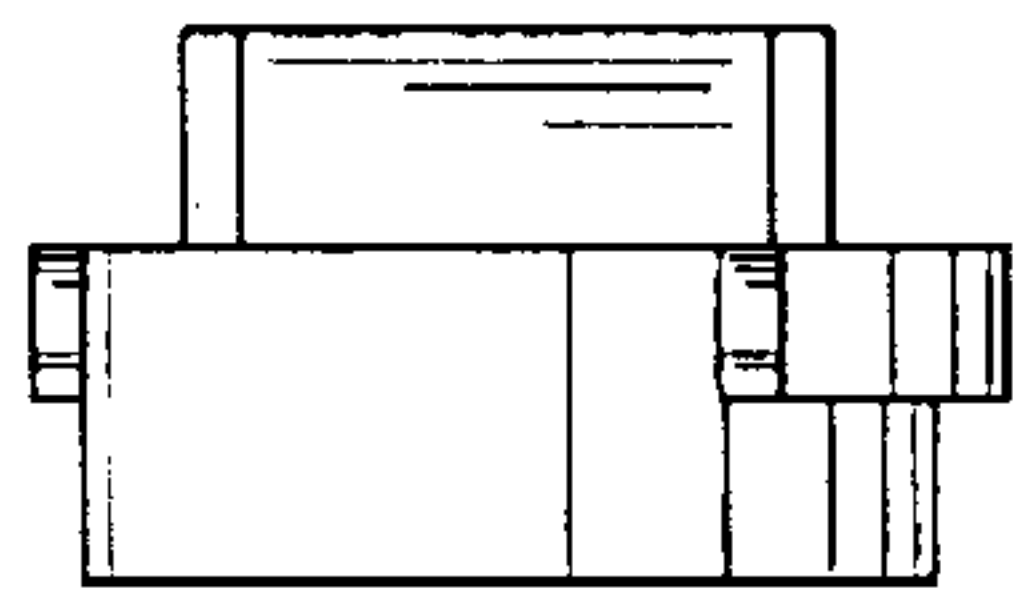

FIG. 3

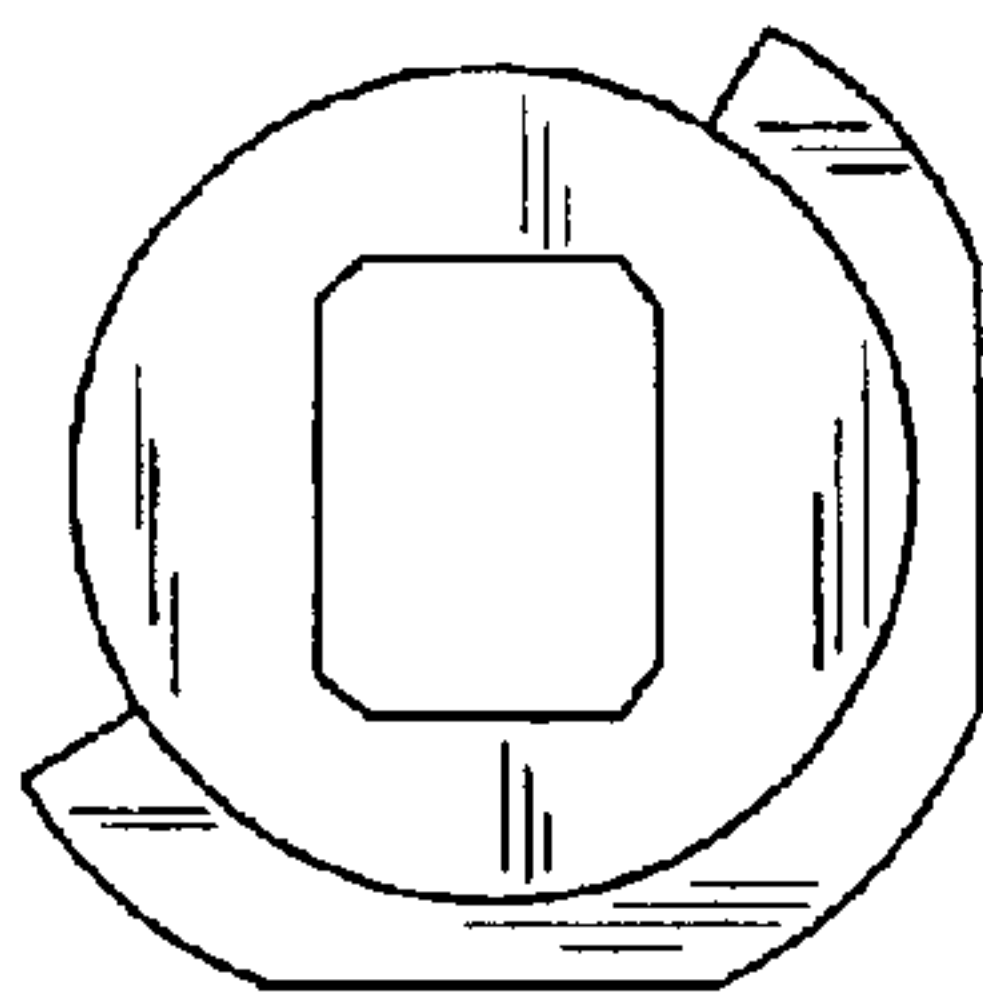

FIG. 2

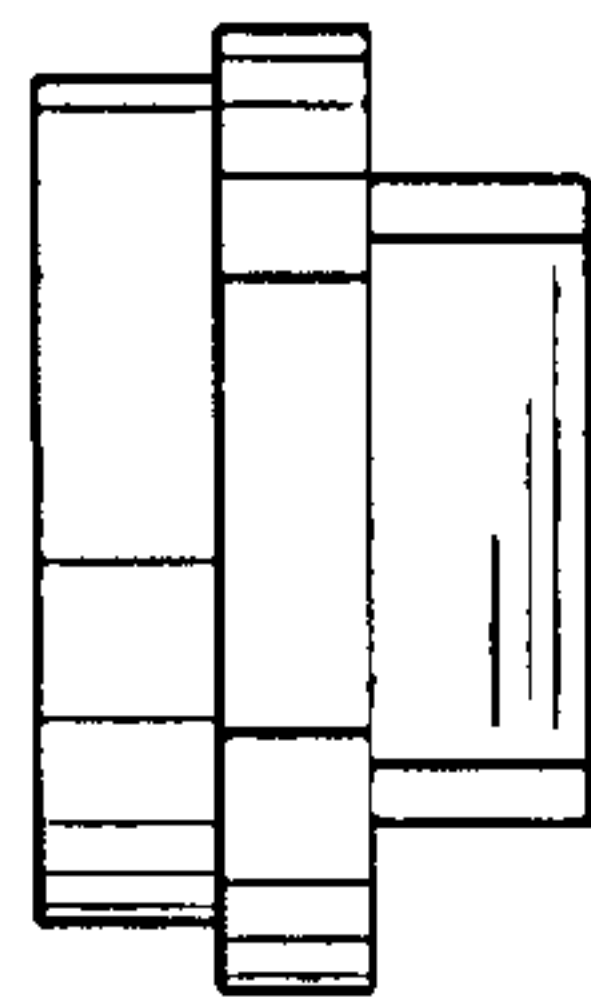

FIG. 4

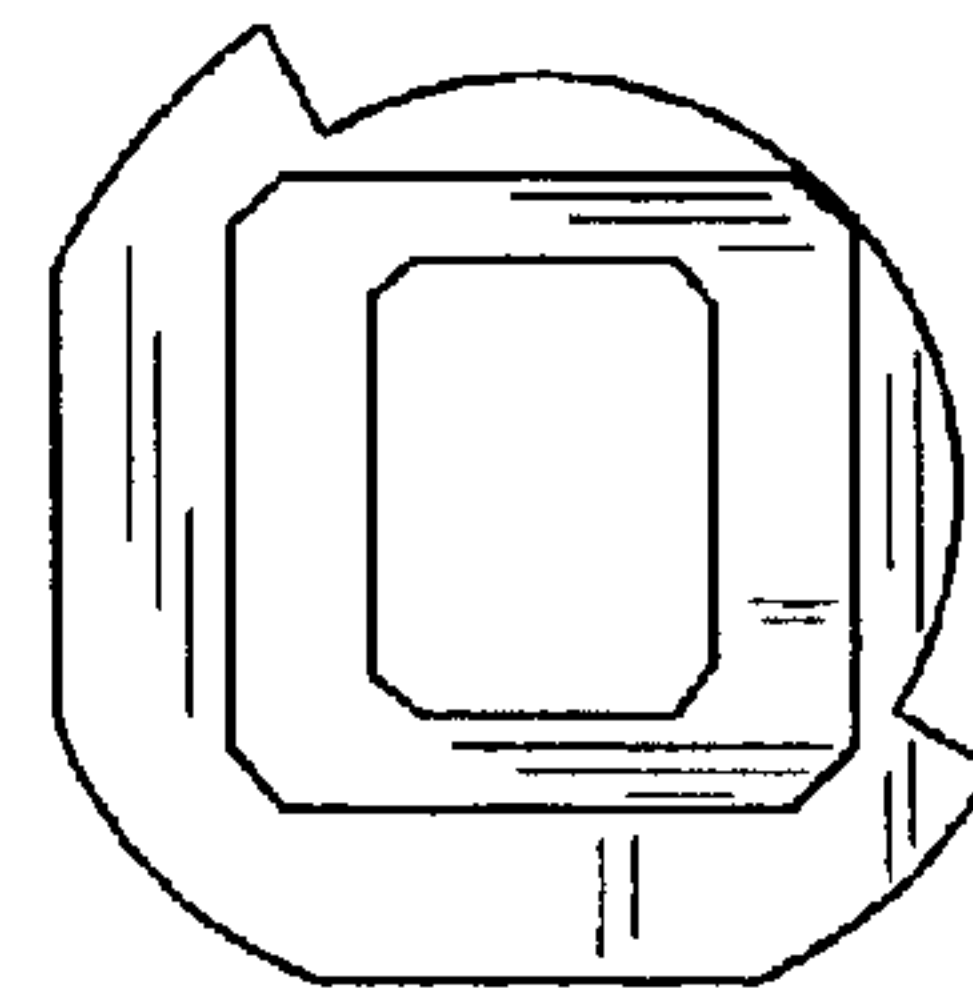

FIG. 6

