

US00D499711S

(12) **United States Design Patent**
Baswell

(10) **Patent No.:** **US D499,711 S**

(45) **Date of Patent:** **** Dec. 14, 2004**

(54) **TELEPHONE TERMINAL**

(76) **Inventor:** **Eric A. Baswell**, 321 51st St. Northeast,
Washington, DC (US) 20019

(**) **Term:** **14 Years**

(21) **Appl. No.:** **29/193,925**

(22) **Filed:** **Nov. 14, 2003**

(51) **LOC (7) Cl.** **14-03**

(52) **U.S. Cl.** **D14/151**

(58) **Field of Search** D14/130, 148,
D14/147, 149-151, 143, 329, 330, 140-142,
144, 240, 241, 243, 170, 171, 159; 379/440,
454, 446, 419, 420.01-420.04, 428.01-428.04,
434-436; 320/110, 113-115; 455/550.1-90.3;
D21/517; D13/107, 108

D375,310 S	*	11/1996	Wooldridge	D14/151
D375,954 S	*	11/1996	Smith	D14/151
5,864,619 A	*	1/1999	Ehara	379/435
D406,138 S	*	2/1999	Ramirez	D14/151
5,966,671 A		10/1999	Mitchell et al.		
D422,279 S	*	4/2000	Zeitman	D14/151
6,052,070 A		4/2000	Kivela et al.		
6,064,732 A		5/2000	Pezzullo et al.		
D431,541 S	*	10/2000	Nagele et al.	D14/151
D452,489 S	*	12/2001	Nagase	D14/151
D463,389 S	*	9/2002	Stafford-Fraser	D14/151
D471,884 S	*	3/2003	Hinds et al.	D14/151
D478,885 S	*	8/2003	Pilotti	D14/151

* cited by examiner

Primary Examiner—Jeffrey Asch

(57) **CLAIM**

The ornamental design for a telephone terminal, as shown and described.

(56) **References Cited**

U.S. PATENT DOCUMENTS

3,932,709 A		1/1976	Hoff et al.		
4,396,799 A	*	8/1983	Franzen et al.	379/388.02
D291,439 S	*	8/1987	Wu	D14/151
D298,429 S	*	11/1988	Lopez-Garcia	D14/149
D306,295 S	*	2/1990	Nagele	D14/149
D319,826 S	*	9/1991	Hung	D14/142
5,121,427 A	*	6/1992	Gumb et al.	379/435
5,131,034 A	*	7/1992	Read	379/435
D330,028 S	*	10/1992	Gagnon et al.	D14/151
D352,283 S	*	11/1994	Schmidt	D14/151
5,381,461 A		1/1995	Baals et al.		
5,412,713 A		5/1995	Baals et al.		
D362,001 S	*	9/1995	Roegner	D14/151
D362,436 S	*	9/1995	Daleen	D14/144

DESCRIPTION

FIG. 1 is a front elevational view of a telephone terminal showing my new design;
 FIG. 2 is a rear elevational view thereof;
 FIG. 3 is a side view, taken from the left side of FIG. 1;
 FIG. 4 is a side view, taken from the right side of FIG. 1;
 FIG. 5 is a top plan view thereof;
 FIG. 6 is a bottom plan view thereof; and,
 FIG. 7 is a perspective view thereof.
 The dotted lines showing a handset in FIG. 7 are for illustrative purposes only and form no part of my claimed design.

1 Claim, 3 Drawing Sheets

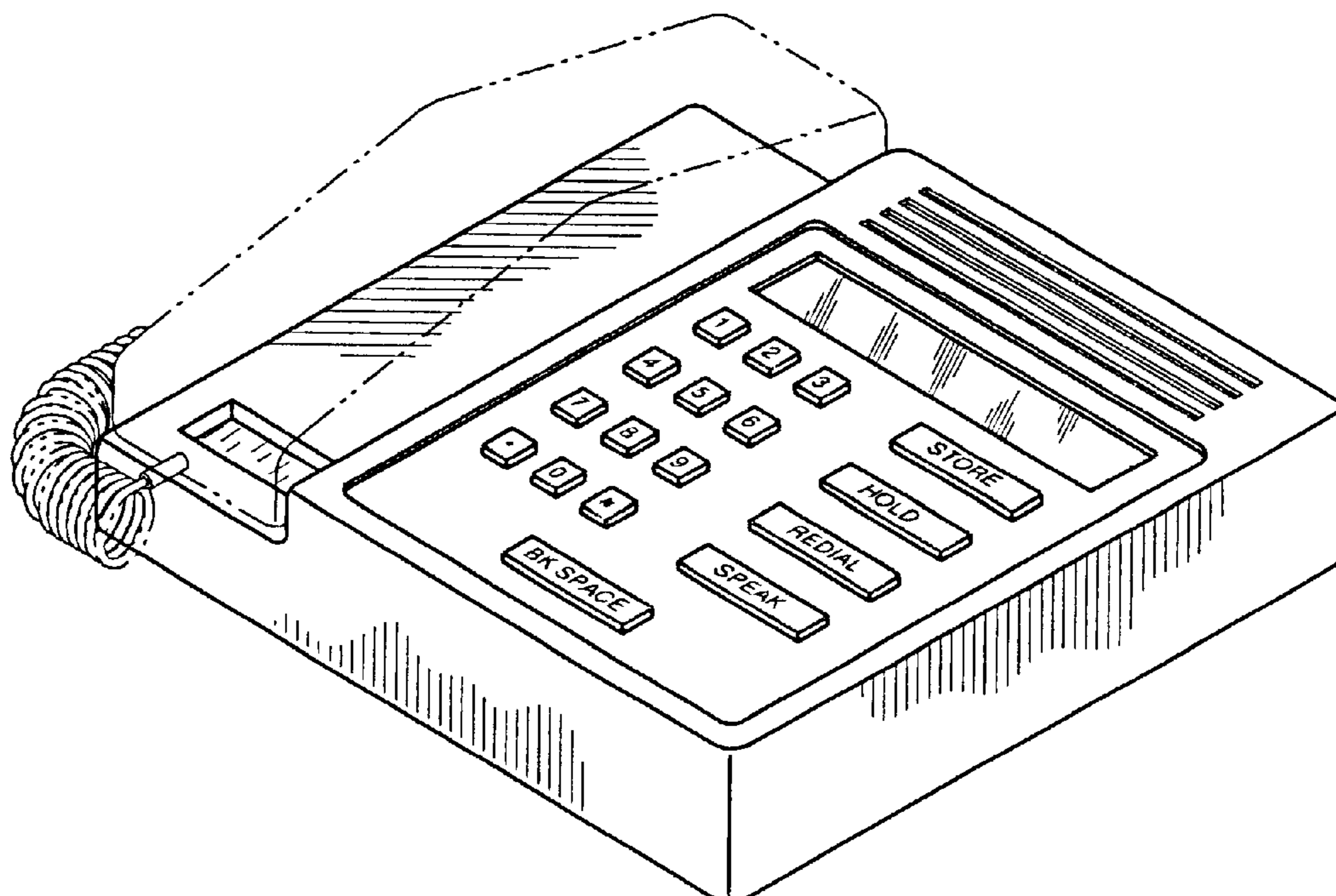

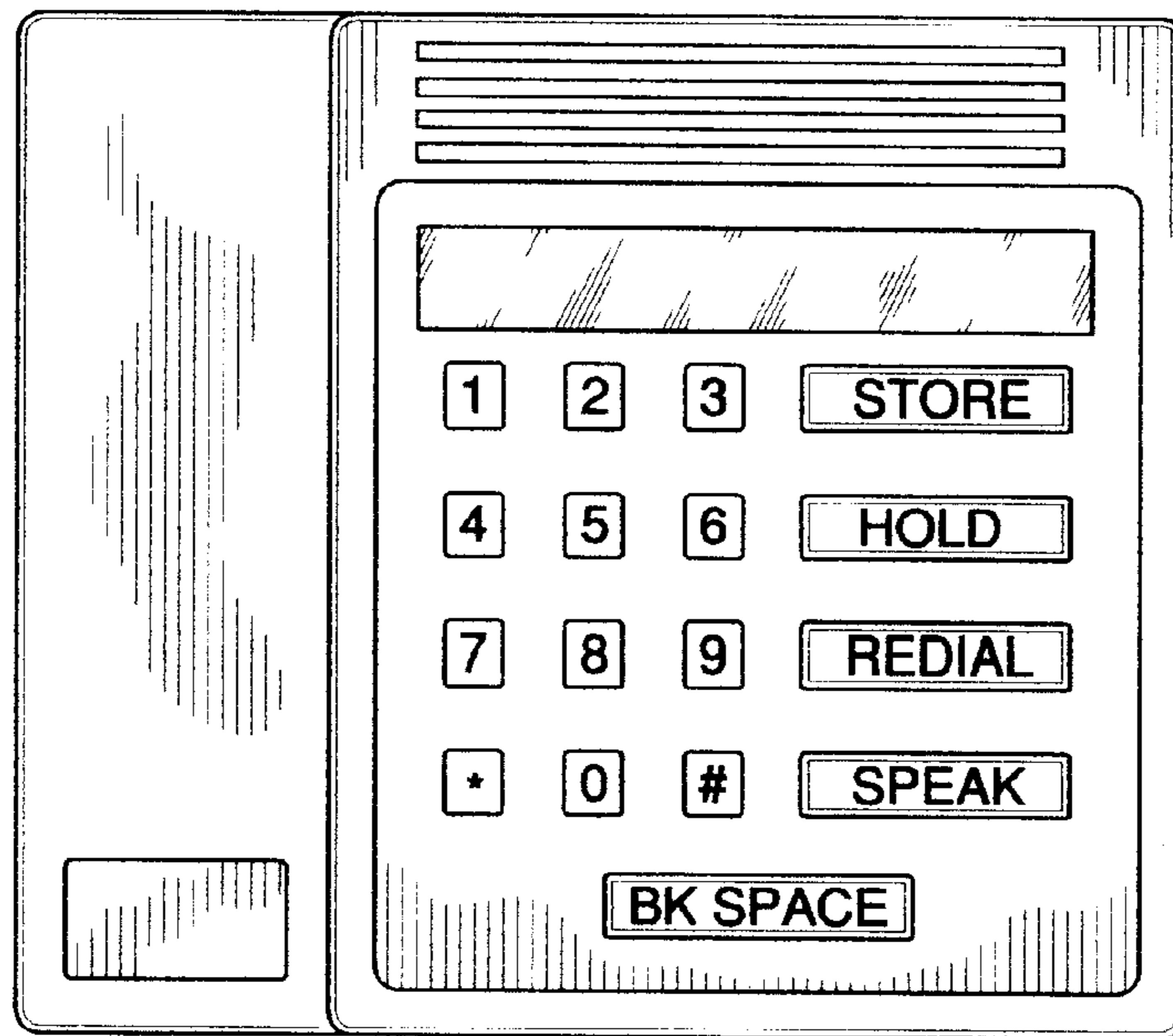

FIG. 1

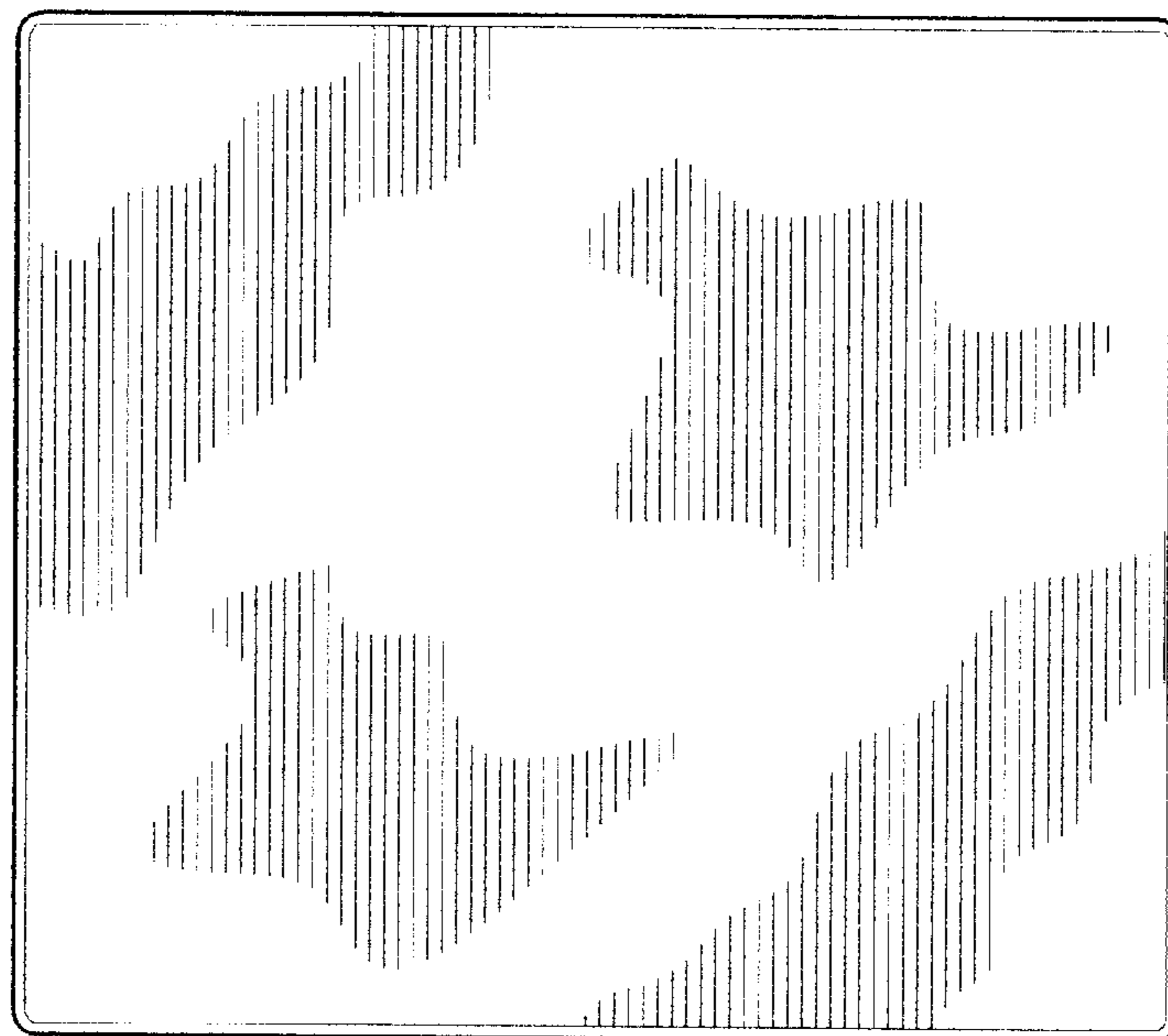

FIG. 2

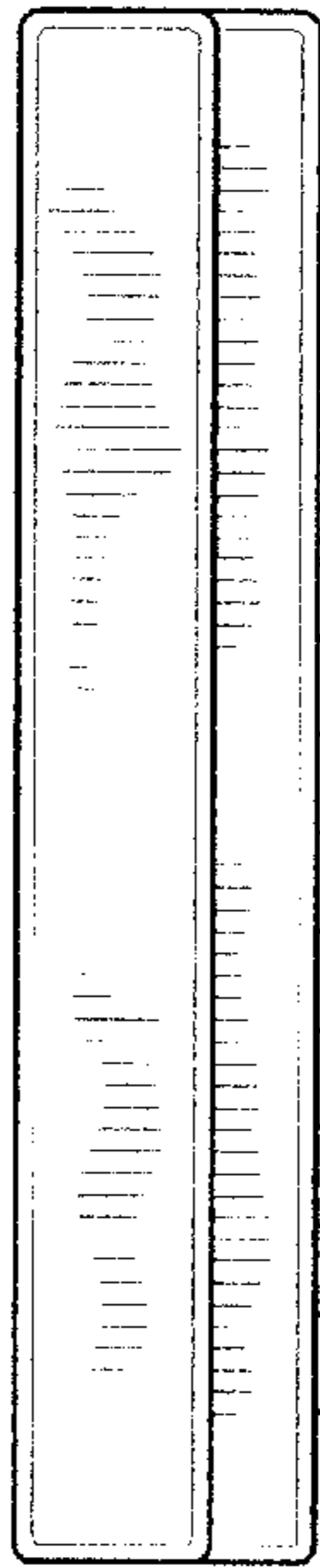

FIG.3



FIG.4

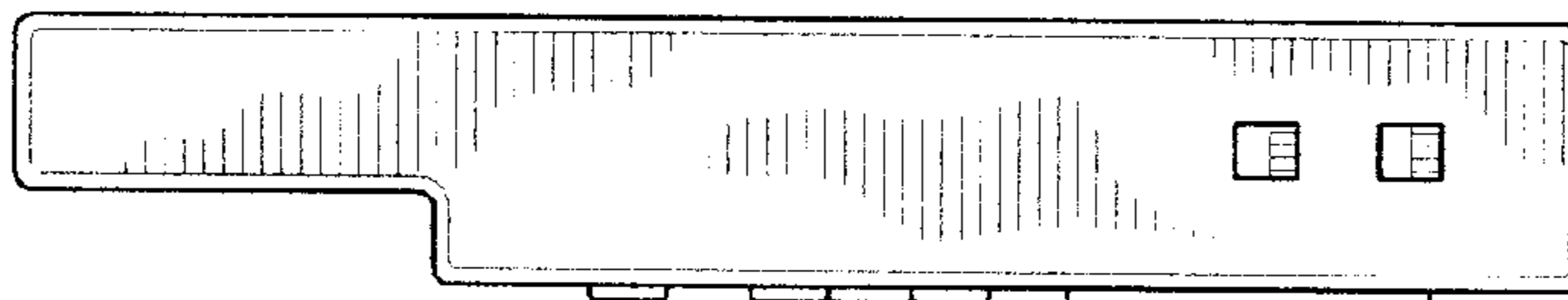

FIG.5

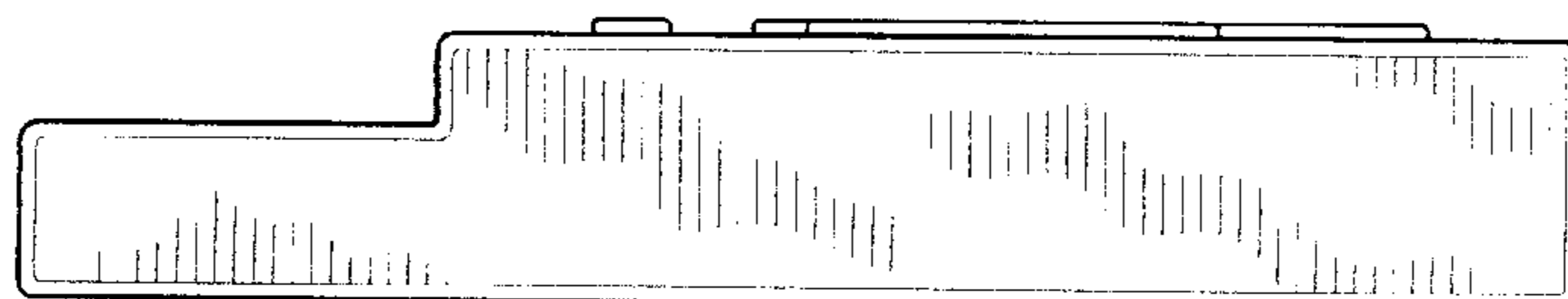

FIG.6

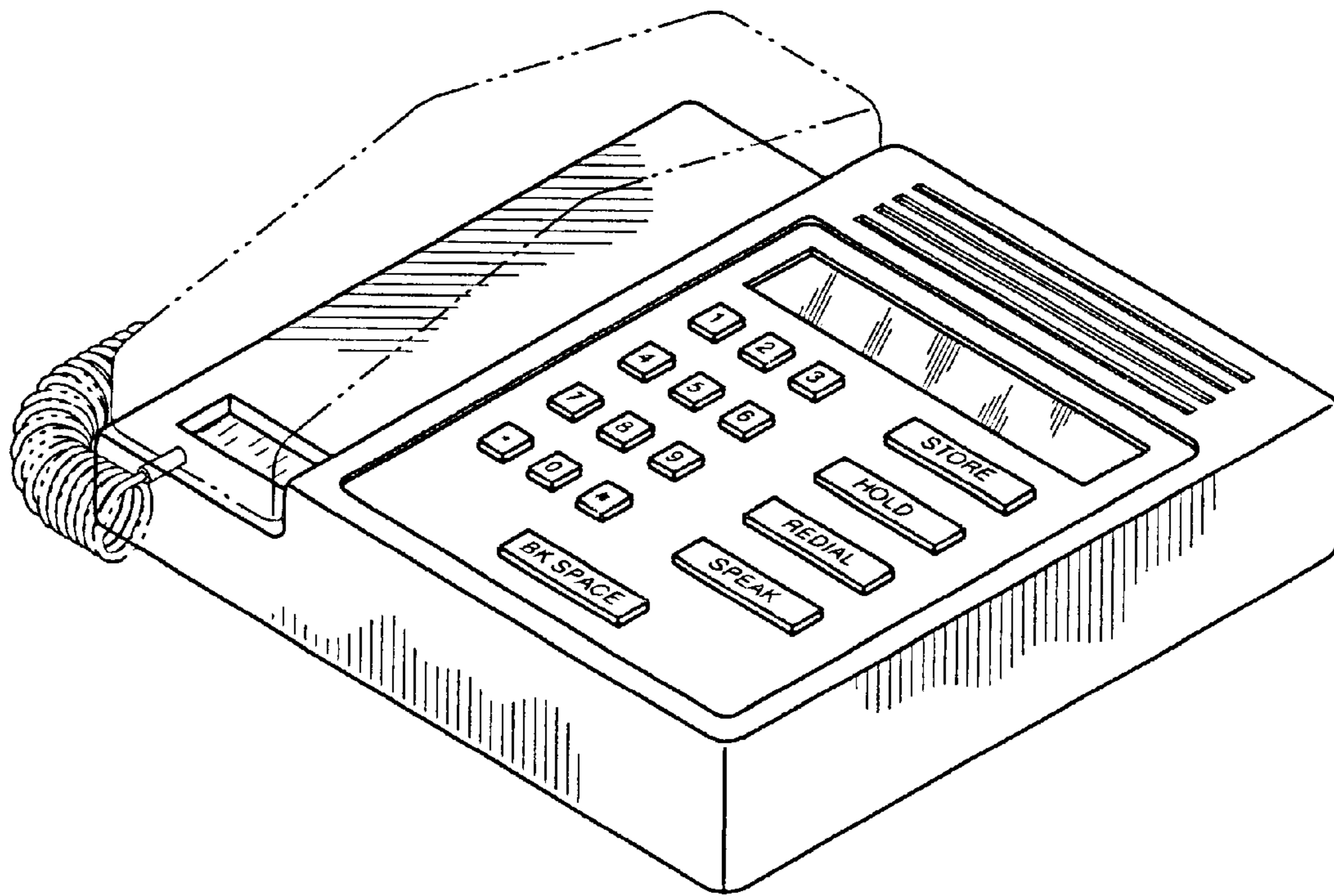

FIG.7