

US00D493683S1

(12) **United States Design Patent** (10) Patent No.: **US D493,683 S**
Hortenbury et al. (45) Date of Patent: **** Aug. 3, 2004**

(54) **ARBOR FOR CIRCULAR SAW BLADES**
 (75) Inventors: **Johnny Hortenbury**, Waddy, KY (US);
John Curtsinger, Shelbyville, KY (US)
 (73) Assignee: **Black & Decker Inc.**, Newark, DE
 (US)
 (**) Term: **14 Years**

D349,441 S * 8/1994 Johnston D8/70
 5,351,595 A * 10/1994 Johnston 83/835
 D382,186 S * 8/1997 Gakhar et al. D8/70
 D382,786 S * 8/1997 Achterberg et al. D8/70
 D392,864 S 3/1998 Koike et al.
 5,901,629 A * 5/1999 Stroud 83/676
 6,158,320 A * 12/2000 Vallance et al. 83/665
 6,230,600 B1 * 5/2001 Stroud 83/665
 D449,769 S * 10/2001 Curtsinger D8/74

* cited by examiner

(21) Appl. No.: **29/152,104**
 (22) Filed: **Dec. 14, 2001**

Primary Examiner—James Gandy
Assistant Examiner—T. Chase Nelson
 (74) *Attorney, Agent, or Firm*—Harness, Dickey & Pierce,
 P.L.C.

(51) **LOC (7) Cl.** **08-03**
 (52) **U.S. Cl.** **D8/70**
 (58) **Field of Search** D8/70, 20, 64,
 D8/66; D15/139; 30/388; 83/665, 666,
 676, 835, 849; 125/12, 13.01; 408/204

(57) **CLAIM**

The ornamental design for an arbor for circular saw blades,
as shown and described.

(56) **References Cited**

DESCRIPTION

U.S. PATENT DOCUMENTS

265,037 A * 9/1882 Donnell 83/665
 464,855 A * 12/1891 Clark 83/835
 1,707,903 A 4/1929 Charlton
 2,472,876 A * 6/1949 Ahrnt et al. 83/676
 2,649,868 A * 8/1953 Gommel 83/665
 2,822,648 A 2/1958 Metzger et al.
 2,912,021 A * 11/1959 Gommel 83/665
 3,899,955 A * 8/1975 Selch 83/665
 4,582,461 A * 4/1986 Ziegelmeyer 83/666
 4,706,386 A * 11/1987 Wiley 30/388
 4,730,952 A 3/1988 Wiley
 4,787,147 A 11/1988 Wiley
 D341,304 S * 11/1993 Johnston D8/70
 5,316,061 A * 5/1994 Lee 83/665

FIG. 1 is a front perspective view of an arbor for circular saw blades (the broken line showing of the saw blade is for environmental purposes and is not considered part of the design);
 FIG. 2 is a front view thereof;
 FIG. 3 is a top view thereof;
 FIG. 4 is a right side view thereof (the left side view is the same as the right side); and,
 FIG. 5 is a rear view thereof.
 The broken line showing portions of the arbor in all of the views is for illustrative purposes only and forms no part of the claimed design.

1 Claim, 1 Drawing Sheet

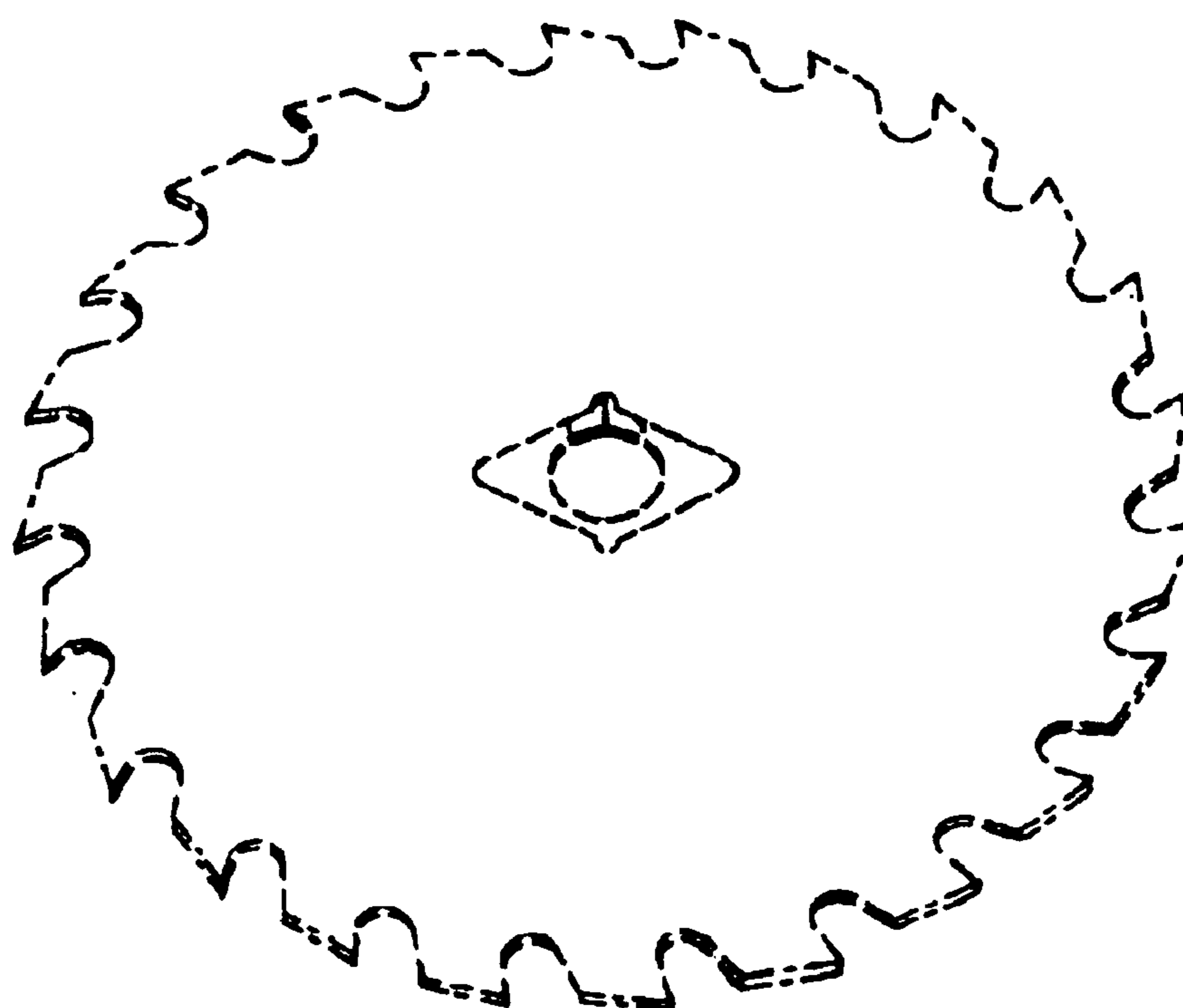

FIG 1

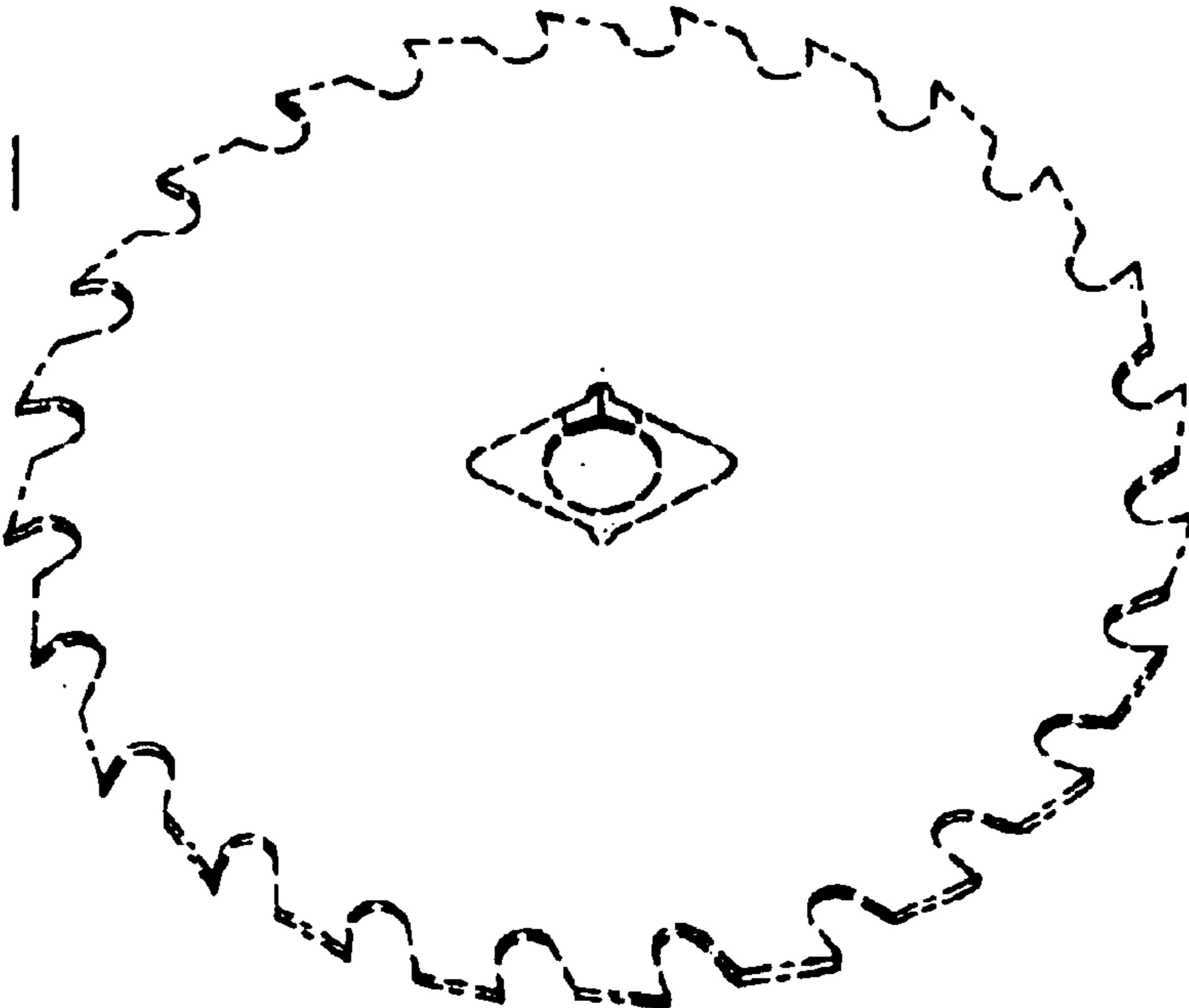

FIG 2



FIG 3

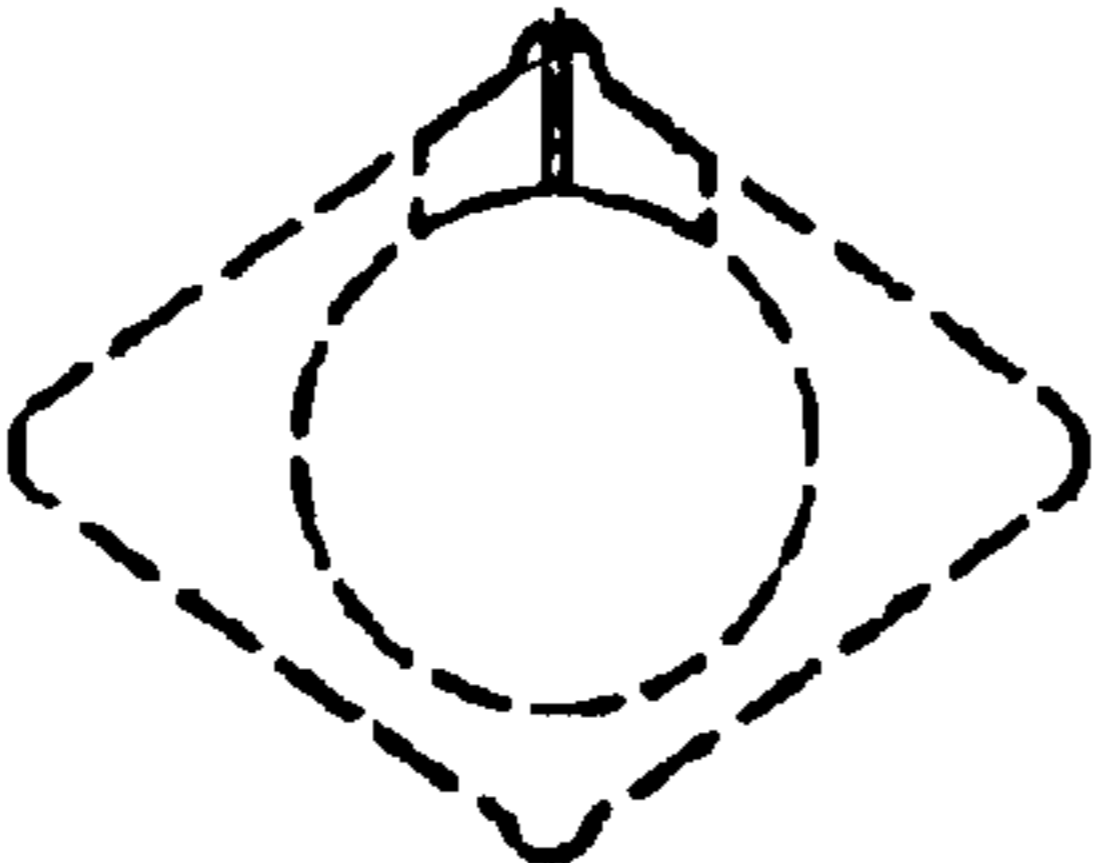

FIG 4

FIG 5

