

US00D492354S1

(12) **United States Design Patent** (10) **Patent No.:** **US D492,354 S**
Fujii (45) **Date of Patent:** **** Jun. 29, 2004**

(54) **ADHESIVE TAPE**

(76) Inventor: **Kenichi Fujii**, Suite 201, Fredrick Terrace 2-26-8, Toshin-cho, Itabashi-ku, Tokyo (JP)

(**) Term: **14 Years**

(21) Appl. No.: **29/177,824**

(22) Filed: **Mar. 18, 2003**

(51) **LOC (7) Cl.** **19-99**

(52) **U.S. Cl.** **D19/69**

(58) **Field of Search** D19/1, 5, 69, 12; D9/416, 419; 156/202, 204, 226, 227, 304.1, 510, 523, 527; 242/556.1; 427/208, 208.2, 208.4, 208.6, 208.8; 428/40.1, 41.7, 42.1, 42.2, 42.3, 43, 44, 343; D5/40; 229/87.01, 87.19; D24/189

(56) **References Cited**

U.S. PATENT DOCUMENTS

3,900,642	A	*	8/1975	Michel	428/40.1
4,033,803	A	*	7/1977	Coder	427/208
4,082,875	A	*	4/1978	Citron	428/343
4,223,058	A	*	9/1980	Citron	428/343
5,130,185	A	*	7/1992	Ness	247/208
5,234,517	A	*	8/1993	Pape et al.	156/192
5,453,141	A	*	9/1995	Rodriguez	428/343
6,146,728	A	*	11/2000	Bay	428/40.1
6,177,163	B1	*	1/2001	Blok et al.	428/40.1
6,319,578	B1	*	11/2001	Nauwelaerts	428/40.1

OTHER PUBLICATIONS

Catalog, "Ribbon Spring 2001," p. 7, Japanese Patent Office Document HC14009633, Accepted Mar. 2, 2002.
 Catalog, "1998 General Catalog," p. 193, Japanese Patent Office Document HC10012283, Accepted Jul. 10, 1998.
 Japanese Design Application Number 2002-6785 filed Mar. 14, 2002.

* cited by examiner

Primary Examiner—Doris V. Coles
Assistant Examiner—Elizabeth A. Albert

(74) *Attorney, Agent, or Firm*—Rader, Fishman & Grauer PLLC

(57) **CLAIM**

The ornamental design for an adhesive tape, as shown and described.

DESCRIPTION

FIG. 1 is a front elevational view of an adhesive tape showing my new design;
 FIG. 2 is a top plan view thereof;
 FIG. 3 is a right side elevational view thereof;
 FIG. 4 is a rear elevational view thereof; and
 FIG. 5 is a bottom plan thereof.
 FIG. 6 is a front elevational view thereof, wherein the upper part of the gray portion of the embodiment of FIG. 1 is folded rearward;
 FIG. 7 is a top plan view thereof;
 FIG. 8 is a right side elevational view thereof;
 FIG. 9 is a rear elevational view thereof;
 FIG. 10 is a bottom plan thereof;
 FIG. 11 is a front elevational view of a second embodiment of an adhesive tape showing my new design;
 FIG. 12 is a top plan view thereof;
 FIG. 13 is a right side elevational view thereof;
 FIG. 14 is a rear elevational view thereof;
 FIG. 15 is a bottom plan thereof;
 FIG. 16 is a front elevational view thereof, wherein the upper part of the gray portion of the embodiment of FIG. 11 is folded rearward;
 FIG. 17 is a top plan view thereof;
 FIG. 18 is a right side elevational view thereof;
 FIG. 19 is a rear elevational view thereof; and
 FIG. 20 is a bottom plan thereof.
 The portions of FIGS. 1-20 shown as even broken lines are for illustrative purposes only and form no part of claimed design. Moreover, the portions of FIGS. 1-20 shown as dot-dash broken lines (excluding the thicker and larger dot-dash broken lines) define, but are not included in, the boundaries of the claimed design.

1 Claim, 7 Drawing Sheets

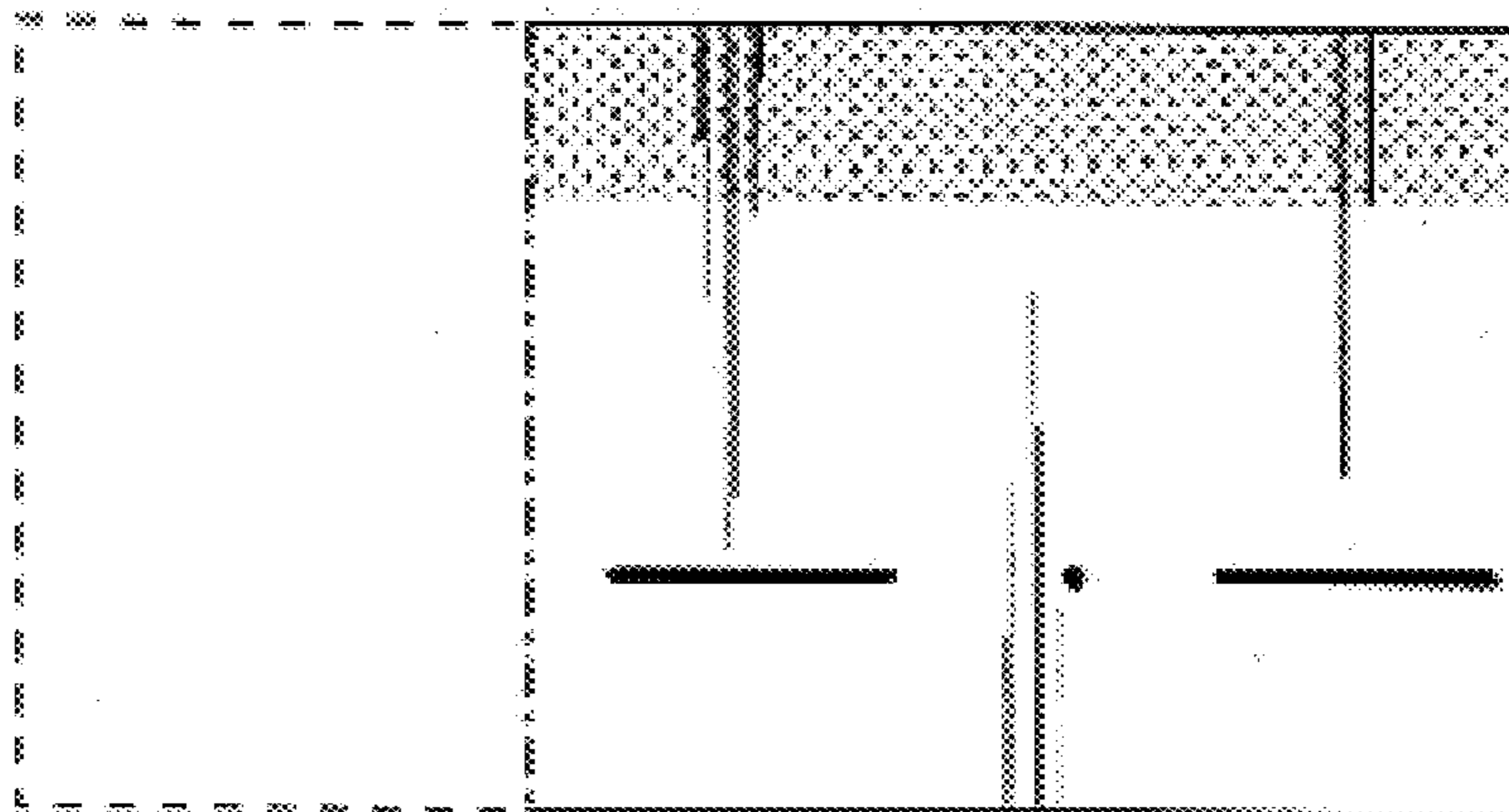

Fig .1

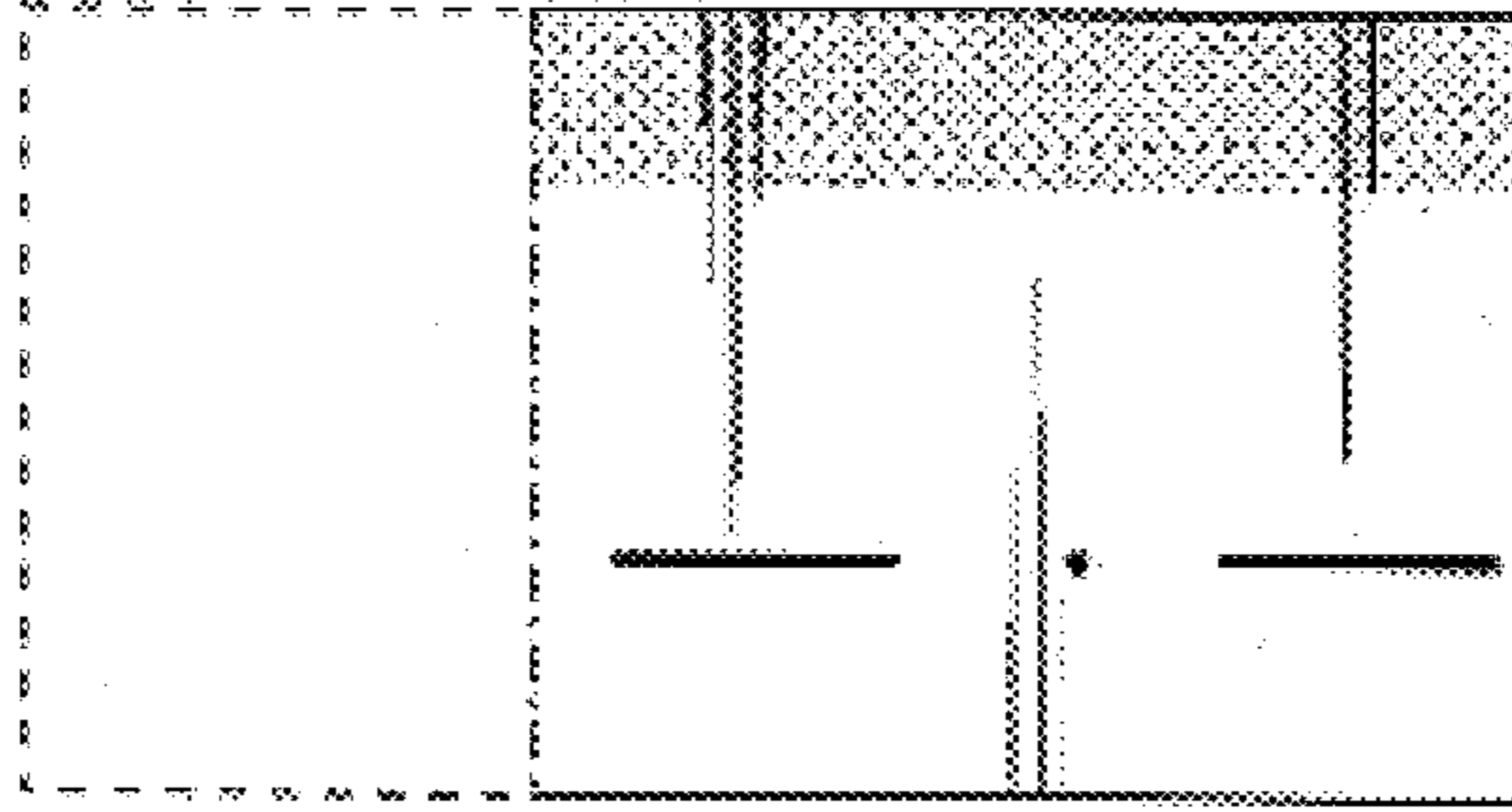

Fig .2

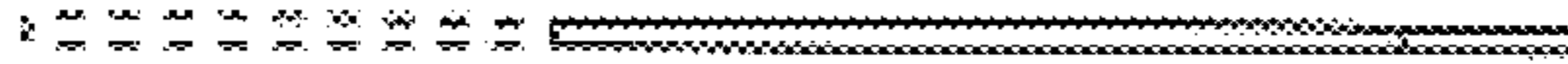

Fig .3



Fig .4

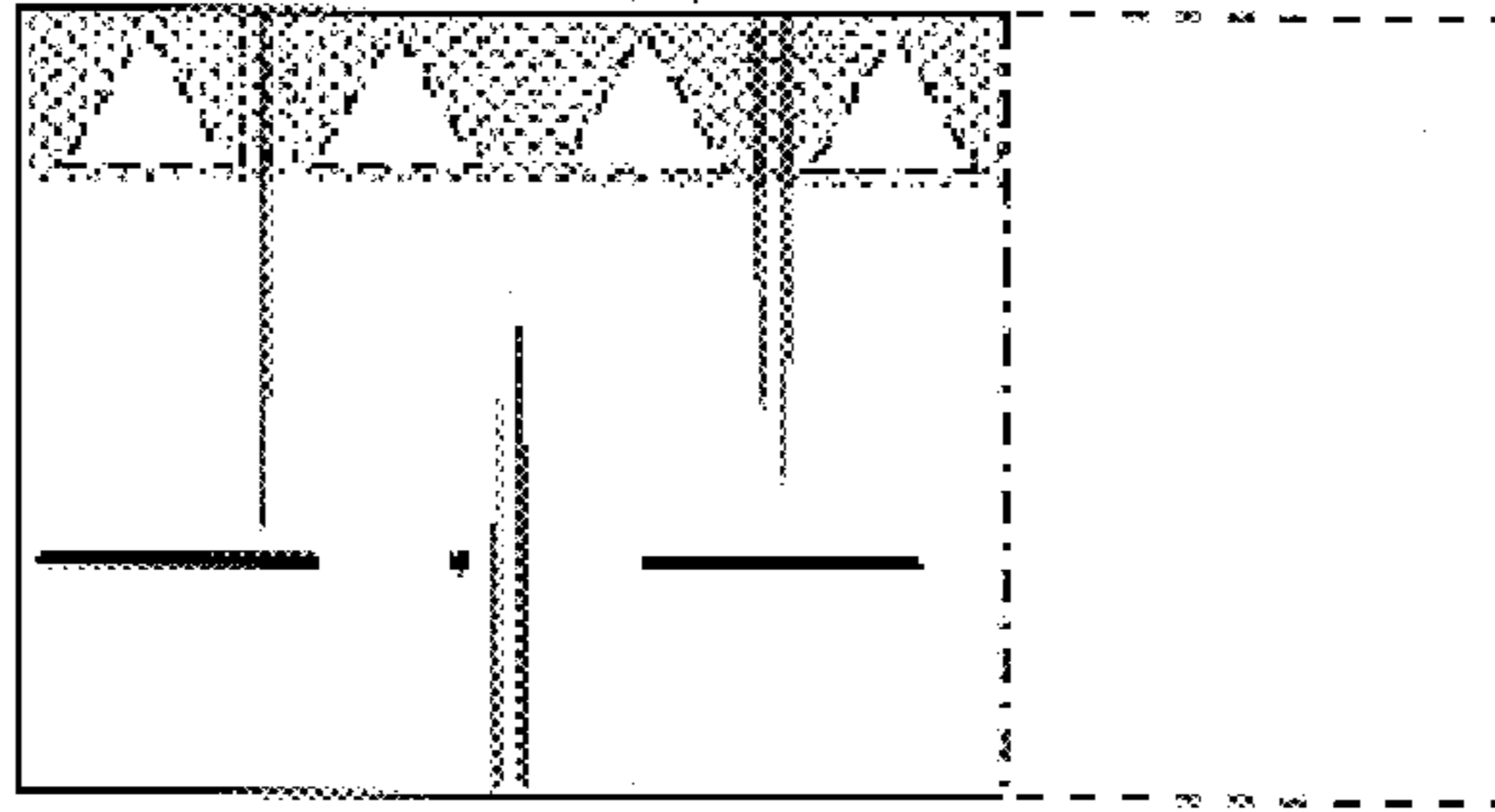

Fig .5



Fig .6

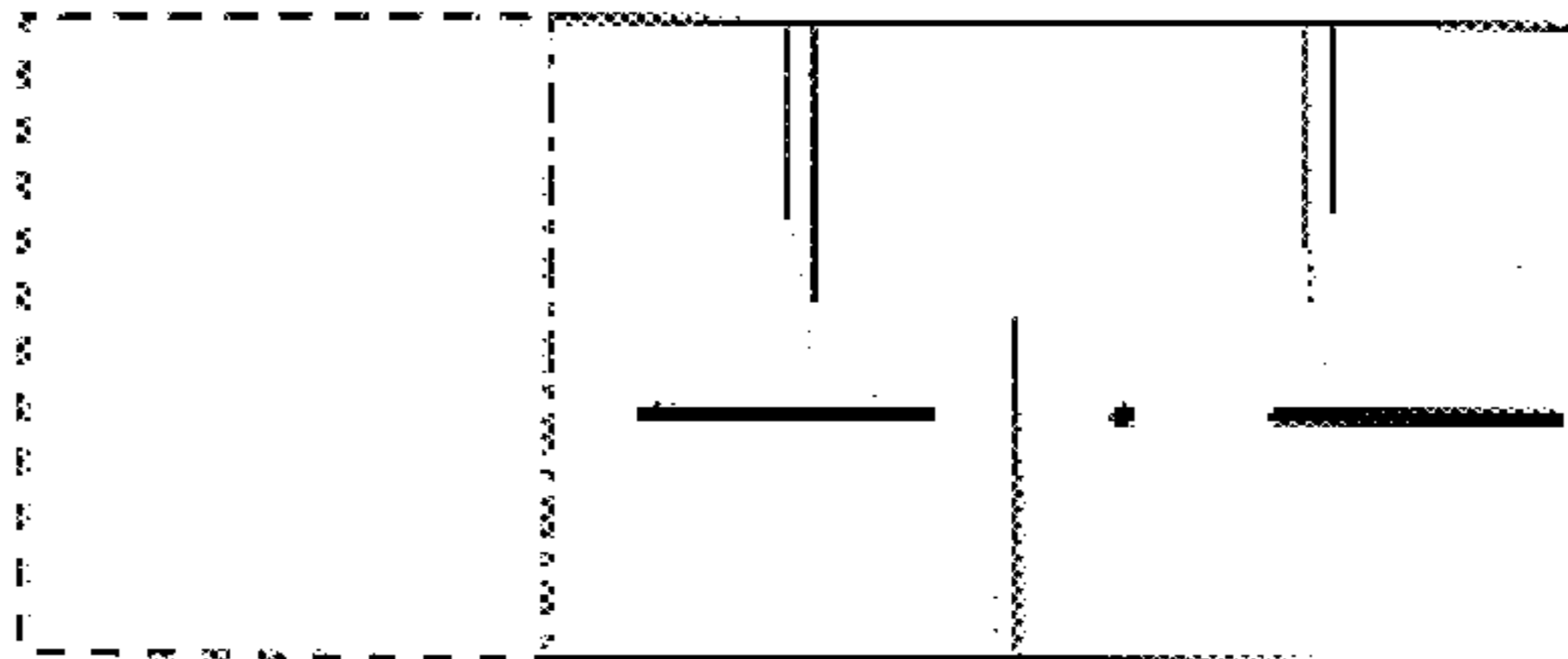

Fig .7



Fig .8

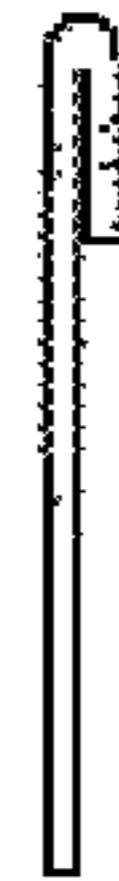

Fig .9

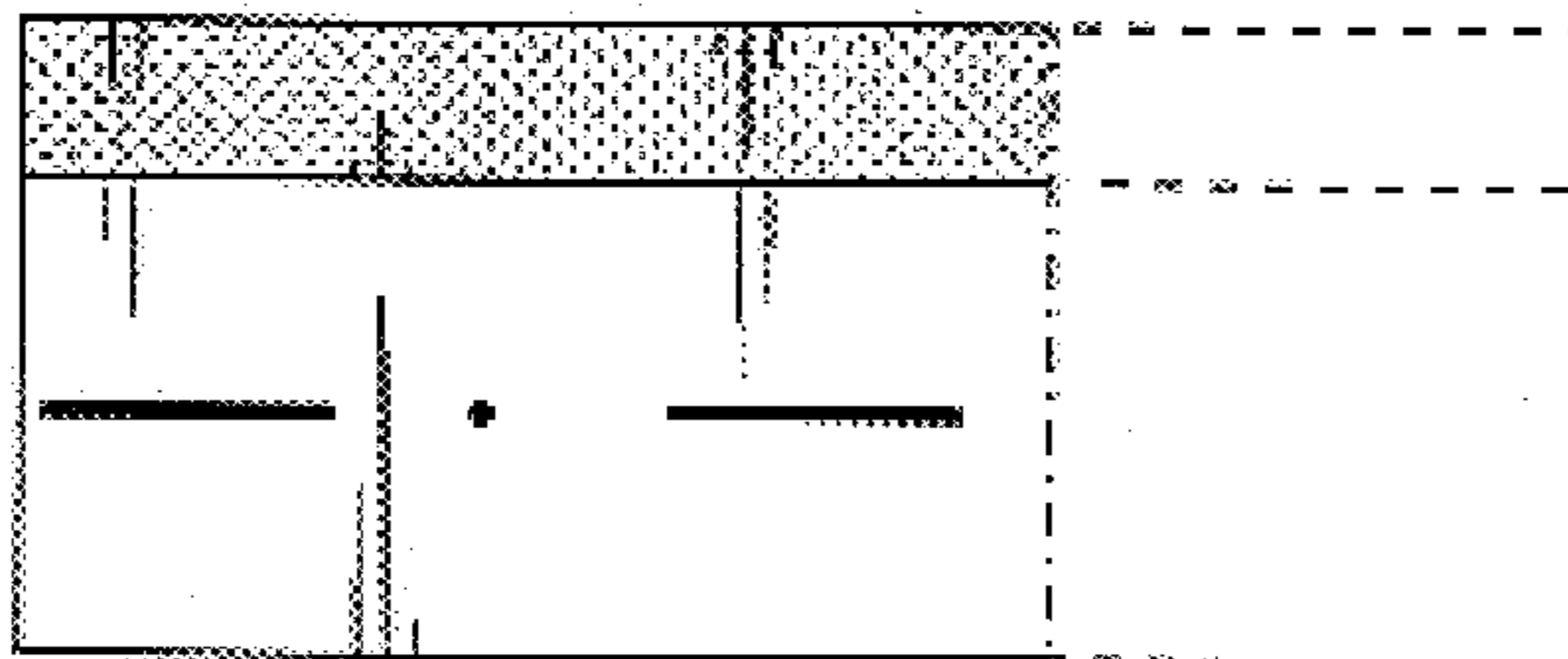

Fig. 10

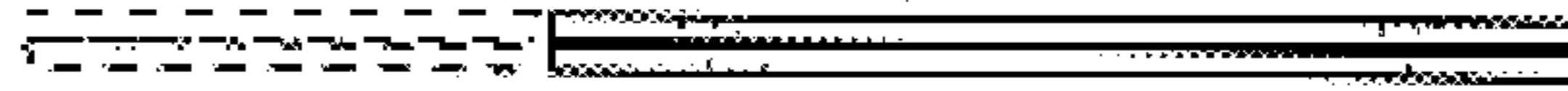

Fig. 11

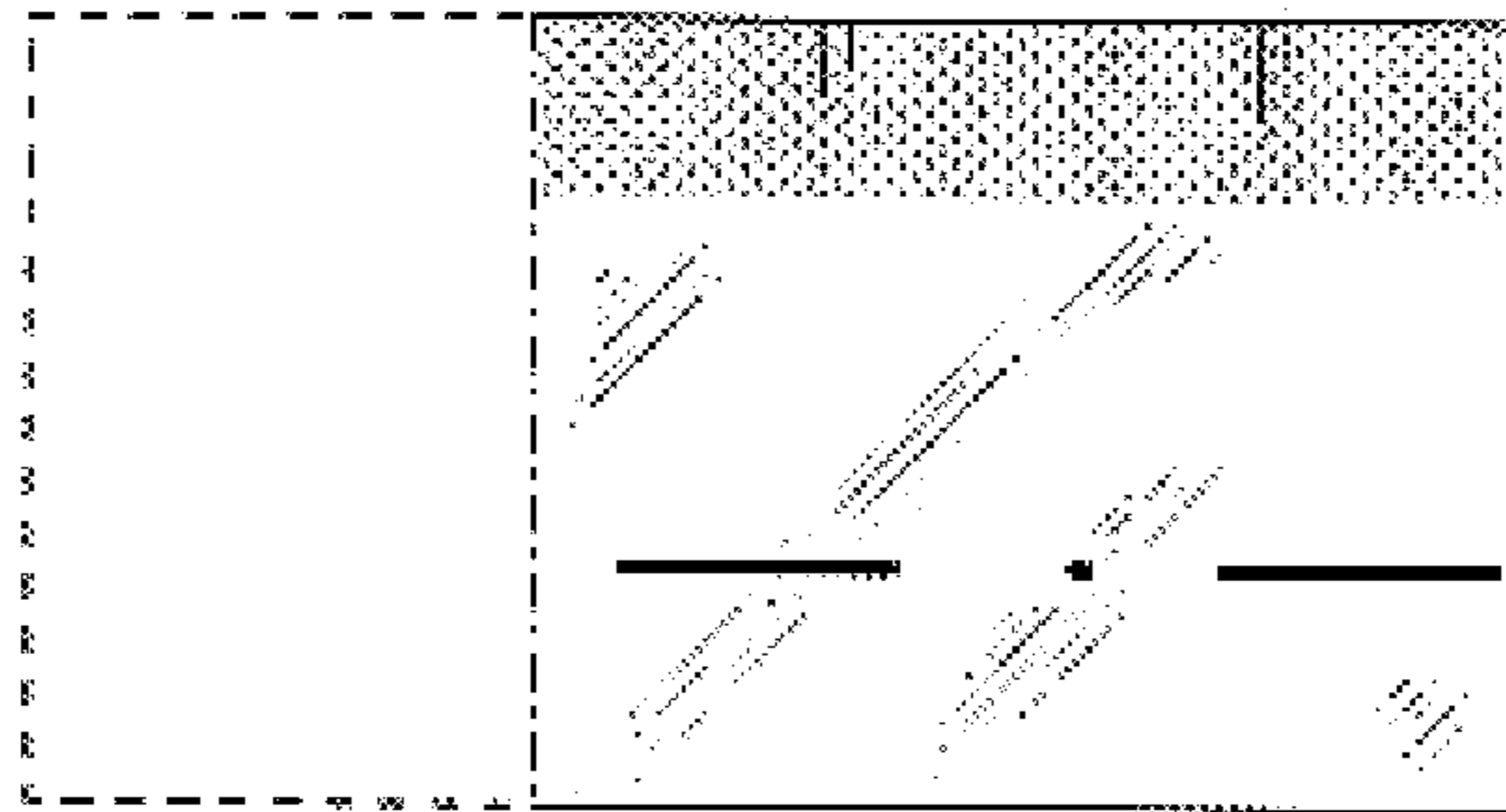

Fig. 12



Fig. 13

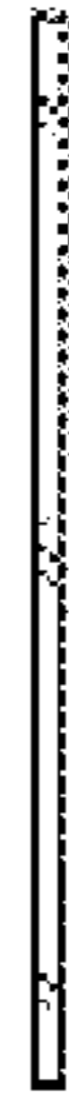

Fig. 14

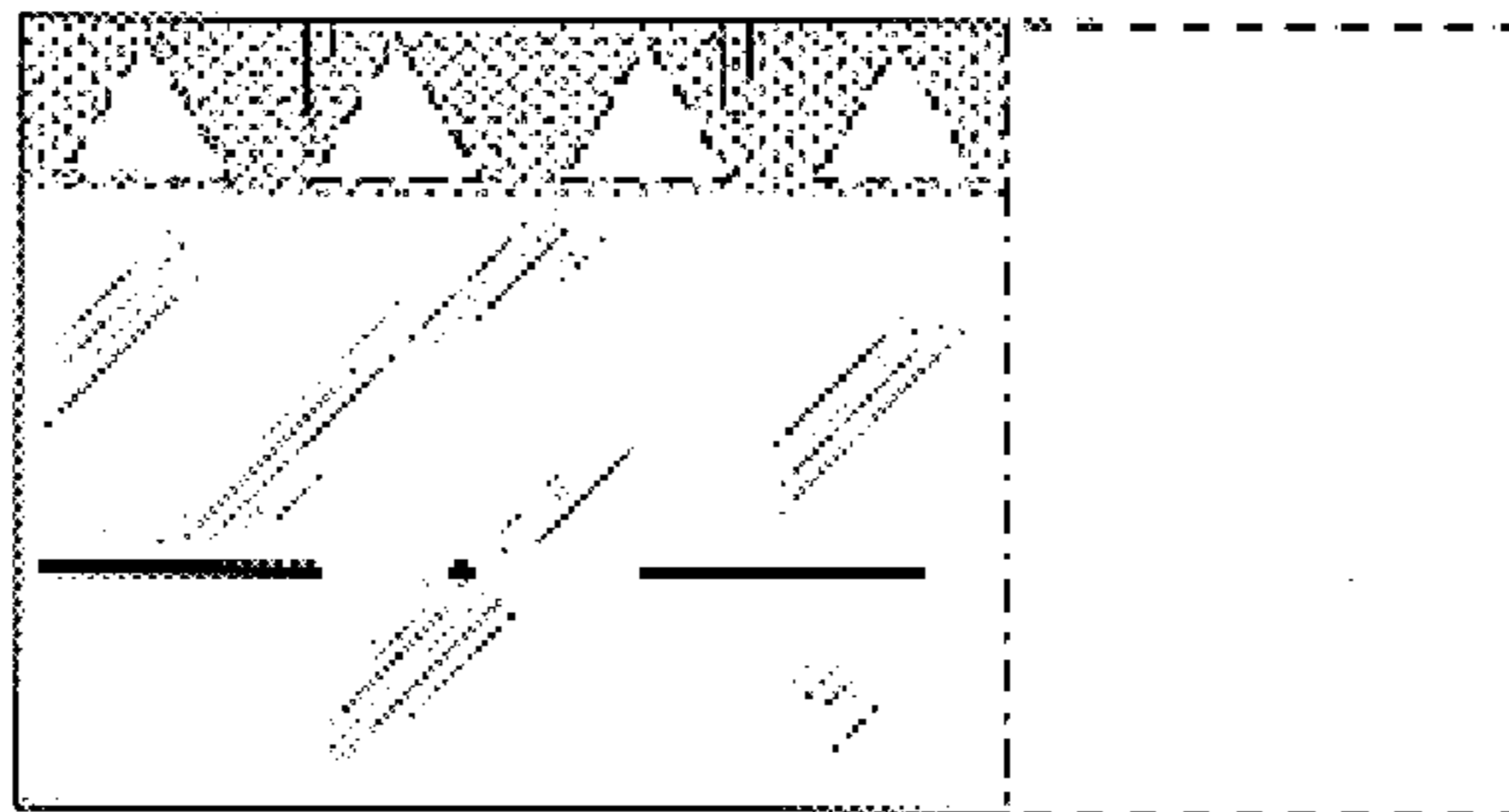

Fig. 15

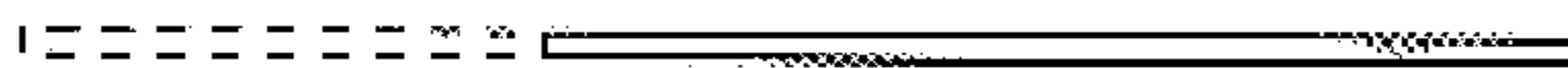

Fig. 16

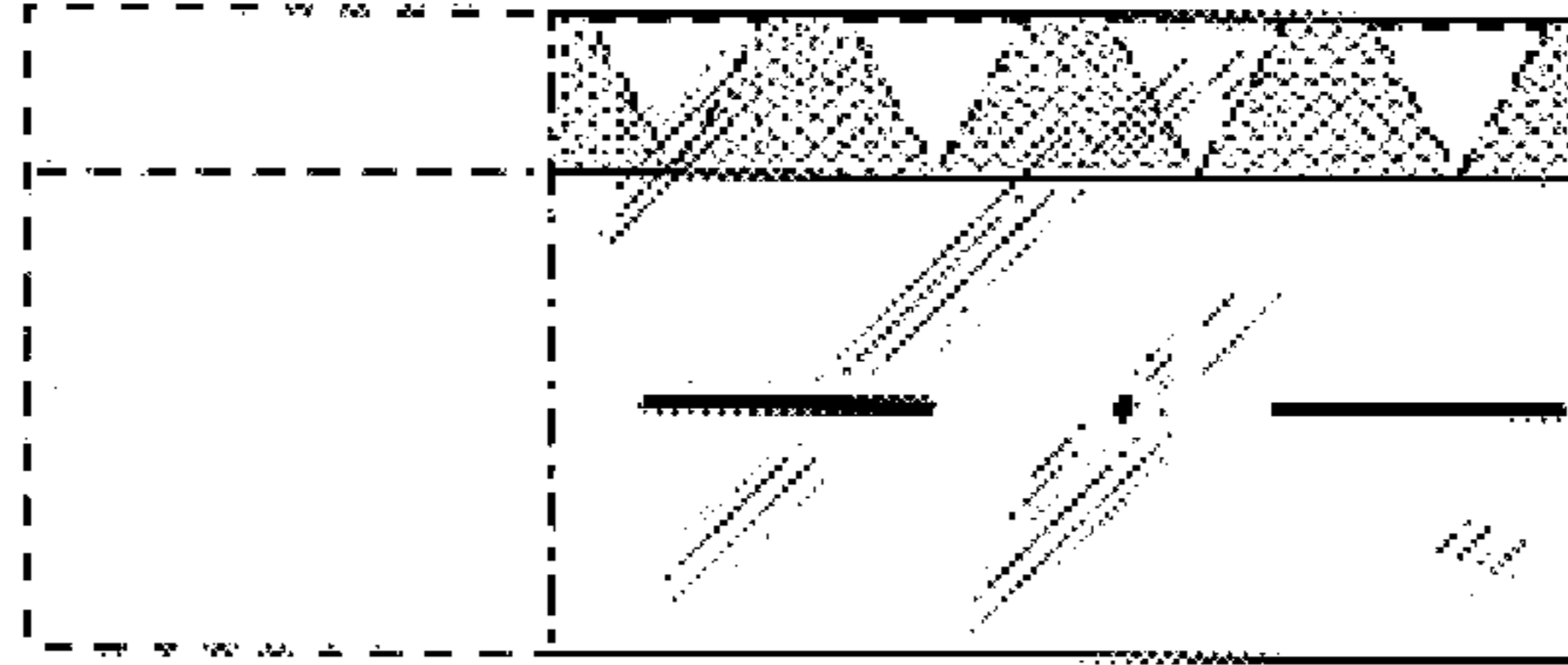

Fig. 17



Fig. 18



Fig. 19

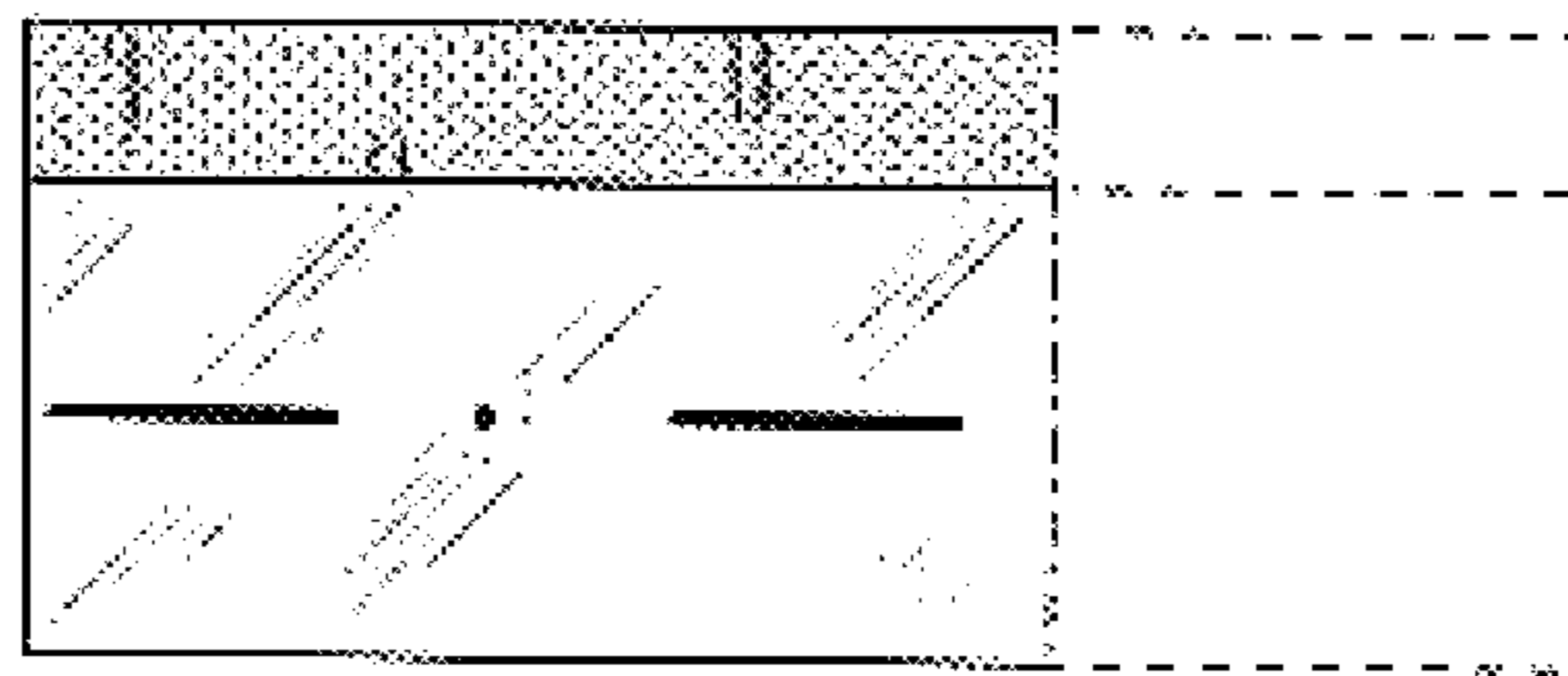

Fig. 20

