



US00D489098S

(12) **United States Design Patent**
Byrd

(10) **Patent No.:** **US D489,098 S**

(45) **Date of Patent:** **** Apr. 27, 2004**

(54) **MINIATURE SPACE WEAPONS**

D454,166 S * 3/2002 Hornsby et al. D21/574
D463,509 S * 9/2002 Huang D23/223

(76) Inventor: **William Jeffrey Byrd**, 7915 Severn
Tree Blvd., Severn, MD (US) 21144

* cited by examiner

(**) Term: **14 Years**

Primary Examiner—Raphael Barkai
(74) *Attorney, Agent, or Firm*—Law Offices of Royal W.
Craig

(21) Appl. No.: **29/182,735**

(22) Filed: **May 30, 2003**

(57) **CLAIM**

Related U.S. Application Data

The new, original, and ornamental design for a miniature
space weapons, as shown in FIGS. 1–7.

(62) Division of application No. 29/166,384, filed on Aug. 27,
2002, now Pat. No. Des. 477,642.

DESCRIPTION

(51) **LOC (7) Cl.** **21-01**

The design of the present invention and as shown in FIGS.
1–7 is an ornamental, miniature space weapon that is com-
patible with miniature space action figure toys.

(52) **U.S. Cl.** **D21/574**

(58) **Field of Search** D21/567–575,
D21/658; D14/428; D23/225–226; D22/103;
446/473, 475, 406, 267, 180, 219, 430;
124/16, 22, 27, 73–76, 83–85; 42/54, 7,
103, 105; 222/78, 79

FIG. 1 is a perspective view of a miniature space weapon
according to my new design.

FIG. 2 is a top view of the miniature space weapon of FIG.
1.

FIG. 3 is a rear view of the miniature space weapon of FIGS.
1–2.

(56) **References Cited**

U.S. PATENT DOCUMENTS

- D163,243 S * 5/1951 Beckett et al. D21/573
- D164,657 S * 9/1951 Tovell D21/574
- D192,474 S * 3/1962 Benkoe D21/574
- D282,764 S * 2/1986 Megargee D21/574
- 5,613,890 A * 3/1997 DeMars 446/473
- D381,711 S * 7/1997 Englert D21/572
- D418,177 S * 12/1999 Lebensfeld et al. D21/574

FIG. 4 is a front view of the miniature space weapon of
FIGS. 1–3.

FIG. 5 is a left side view of the miniature space weapon of
FIGS. 1–4.

FIG. 6 is a right side view of the miniature space weapon of
FIGS. 1–5; and,

FIG. 7 is a bottom view of the miniature space weapon of
FIGS. 1–6.

1 Claim, 2 Drawing Sheets

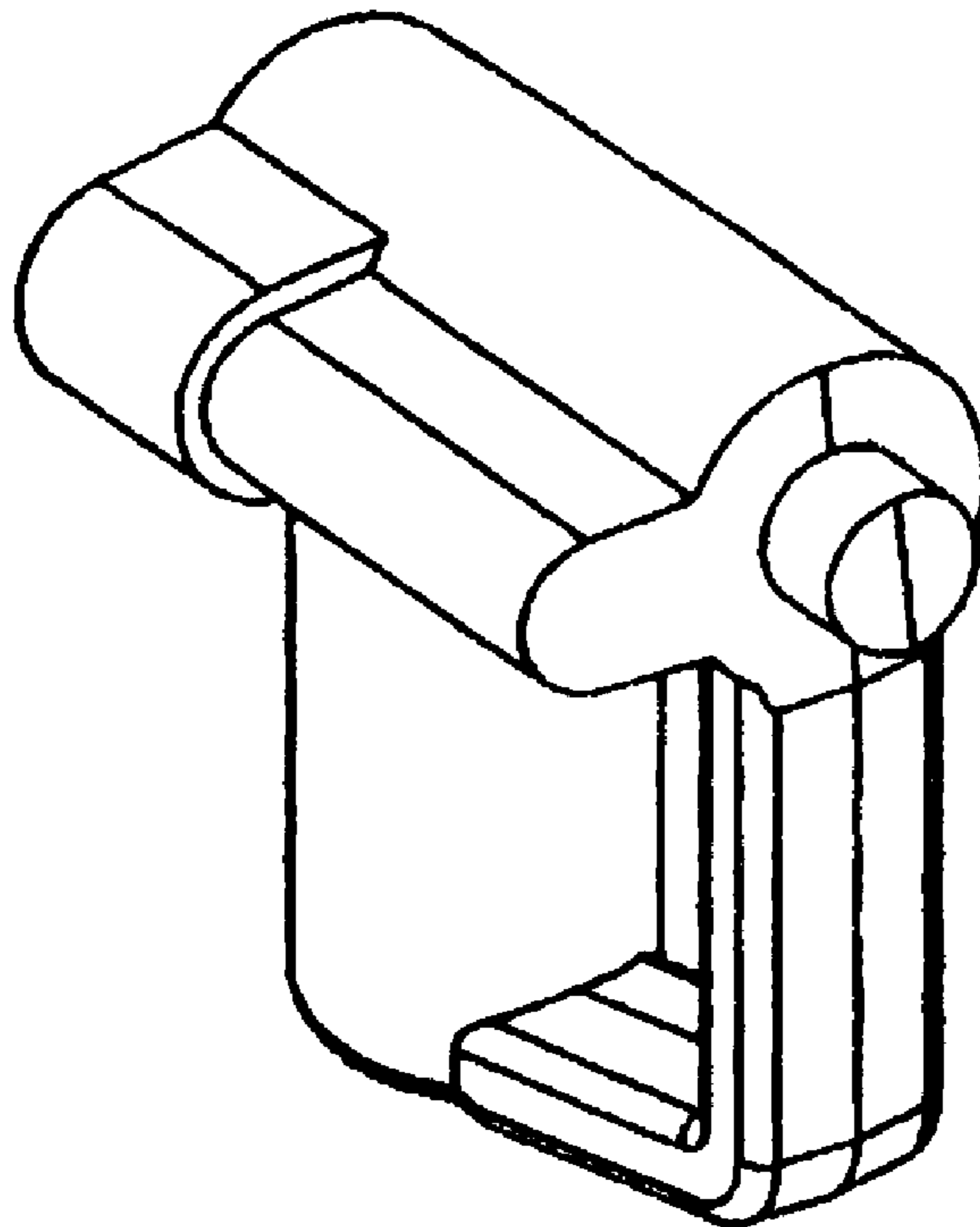

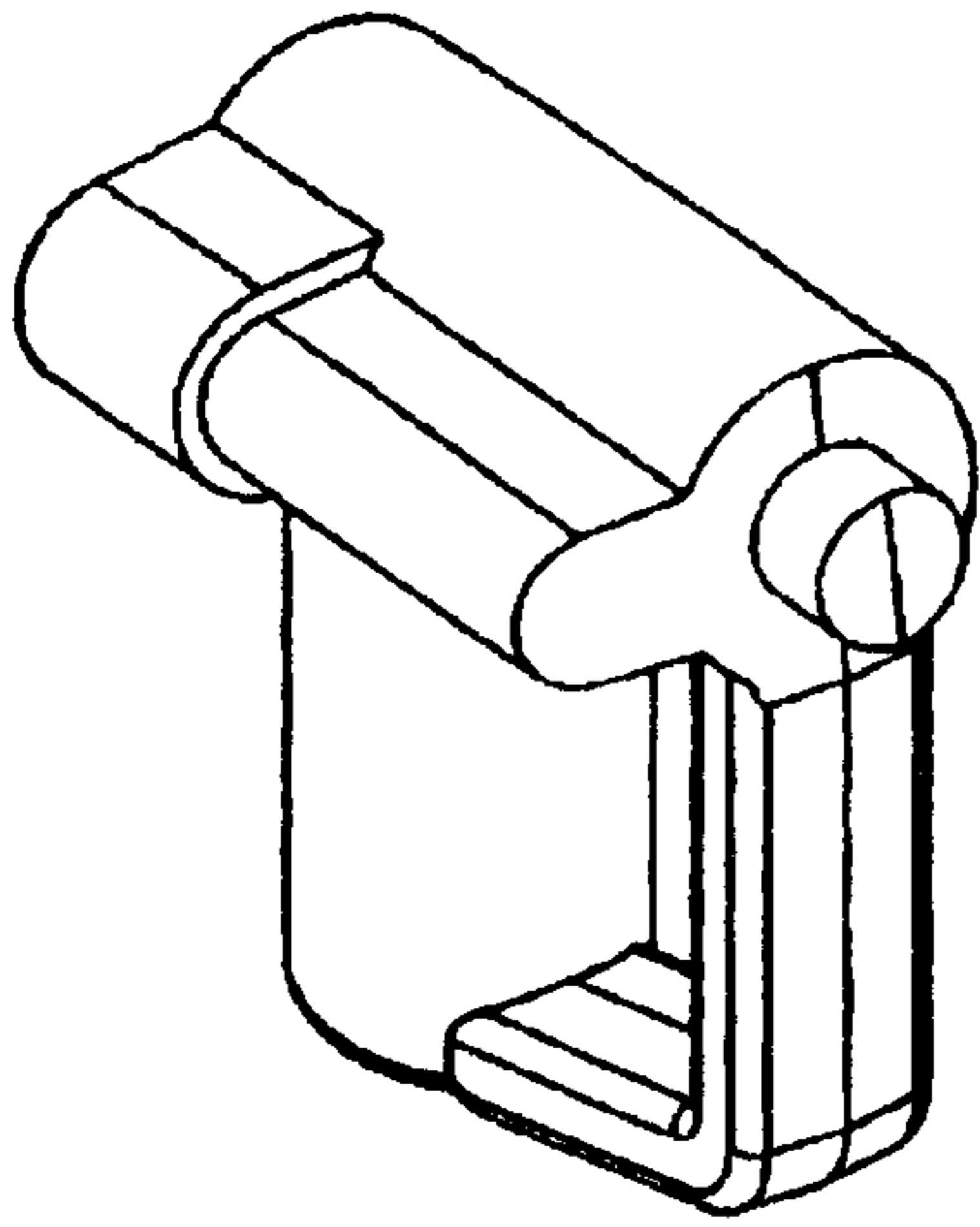

FIG. 1

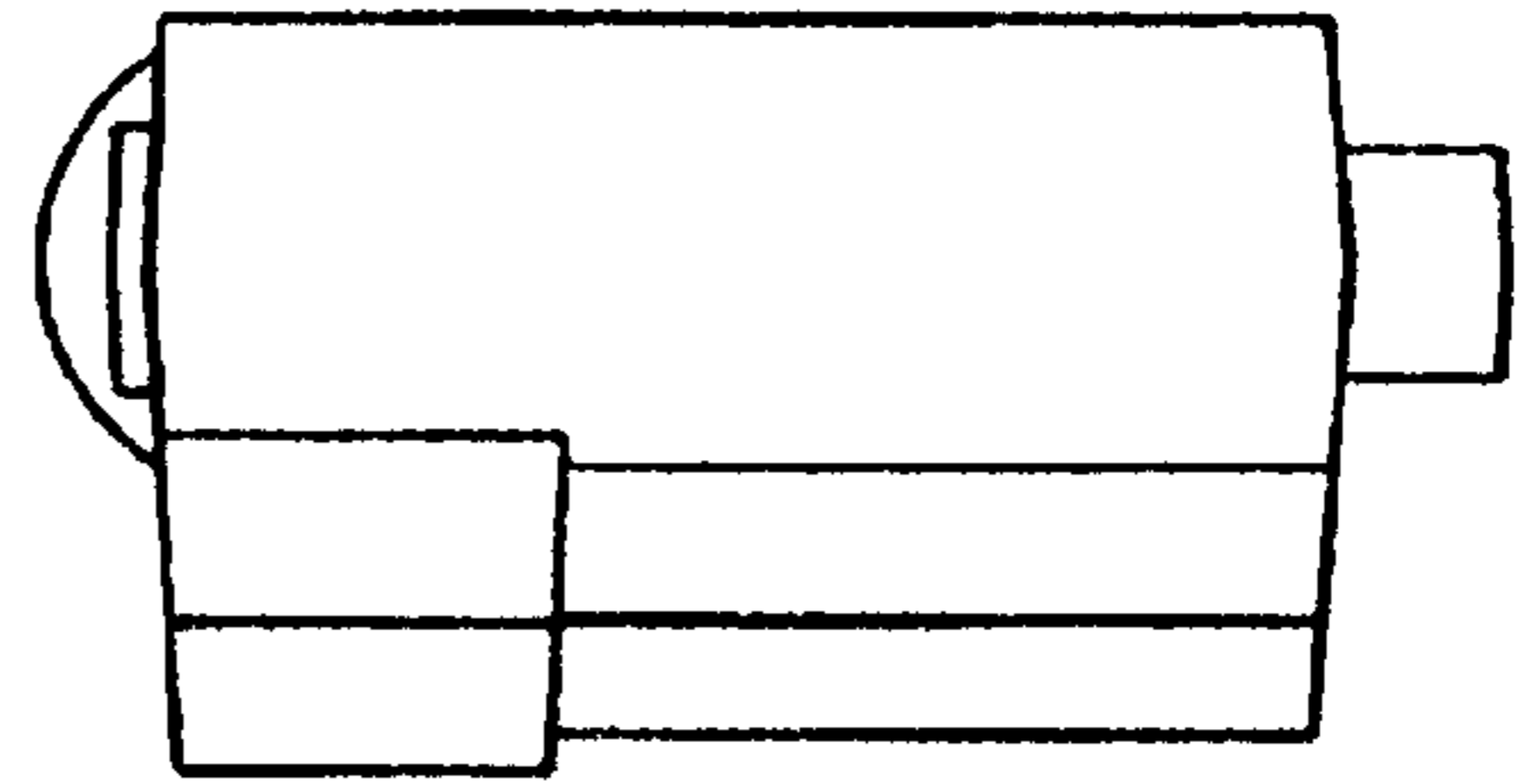

FIG. 2

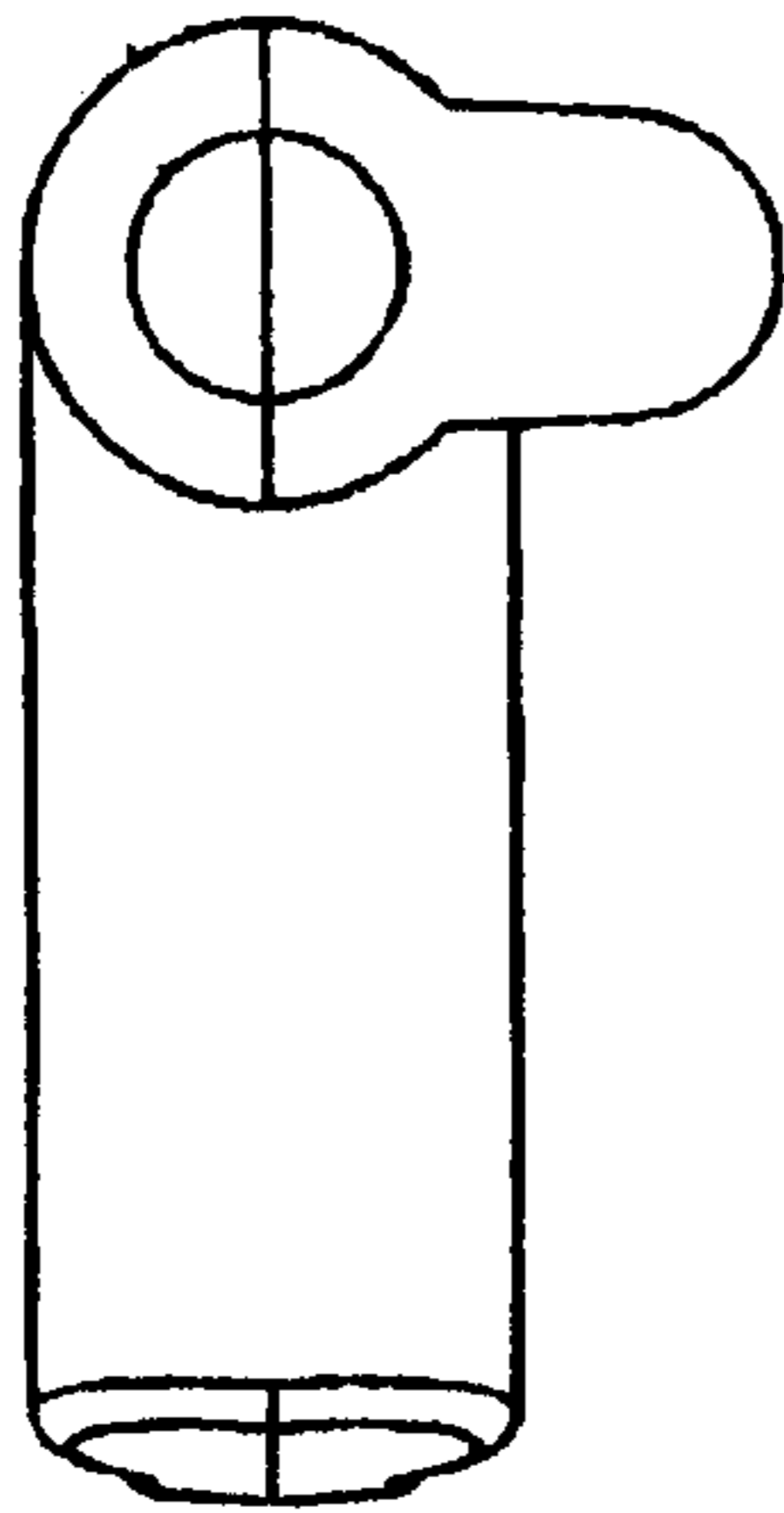

FIG. 3

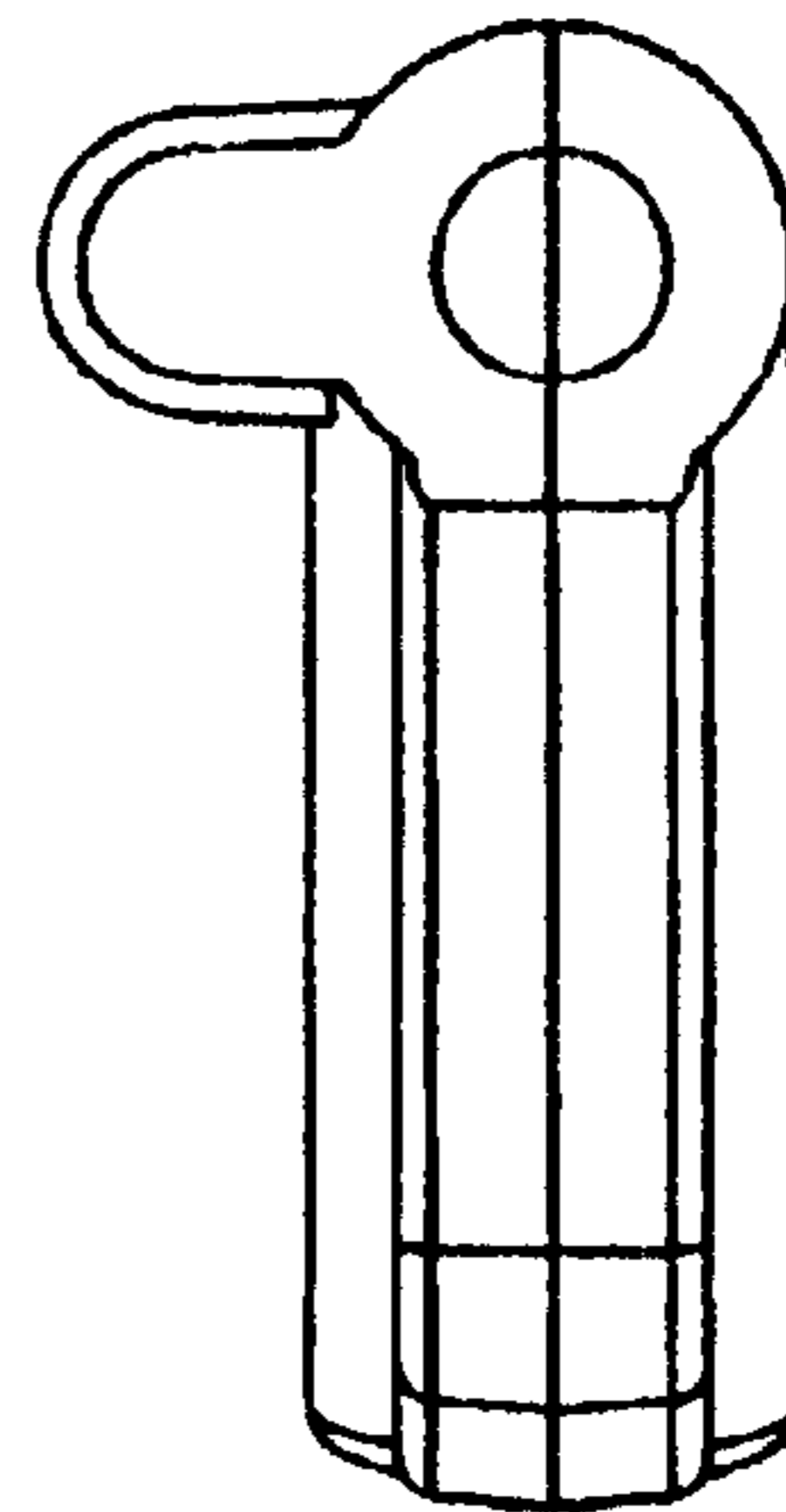

FIG. 4

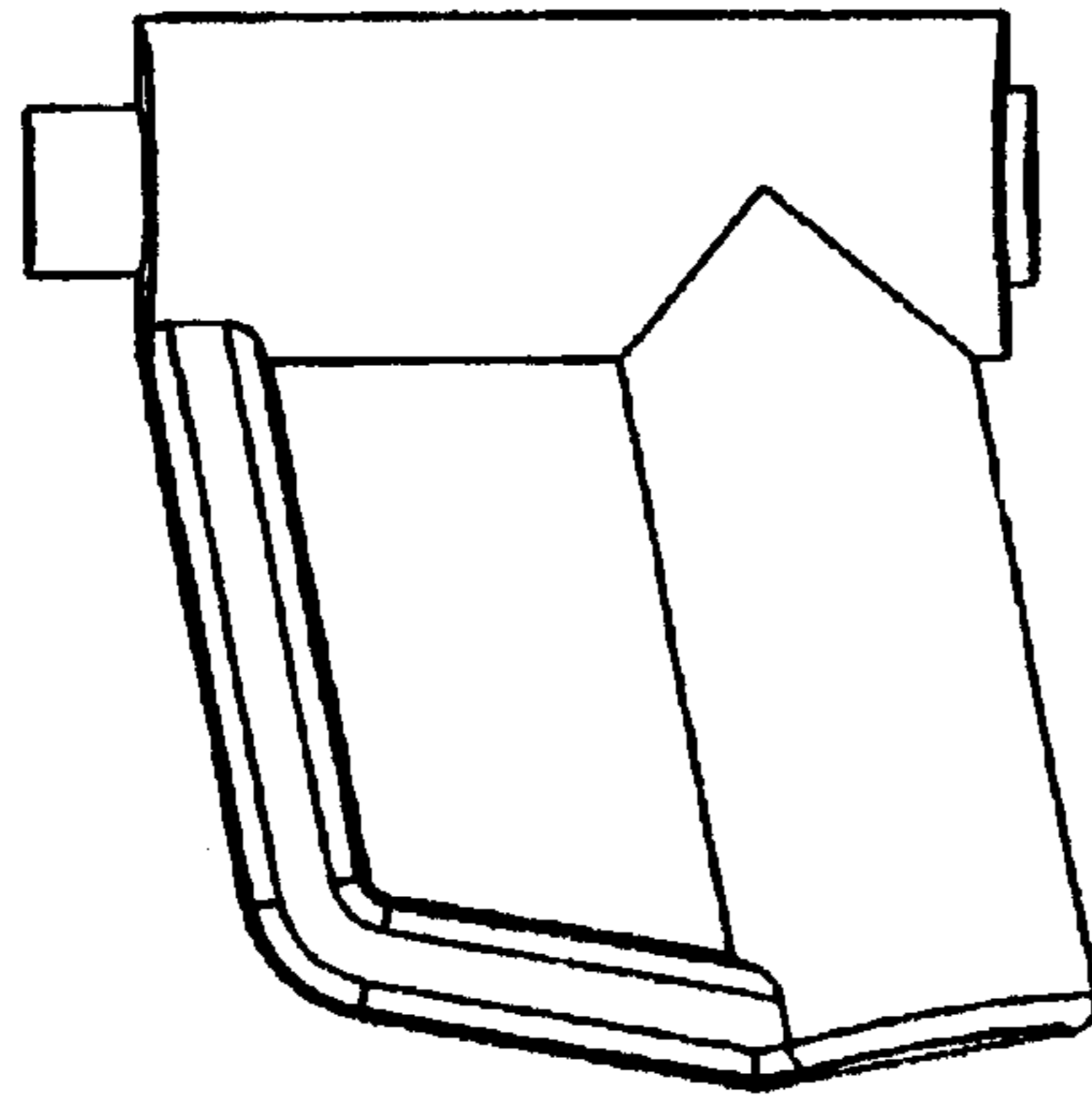

FIG. 5

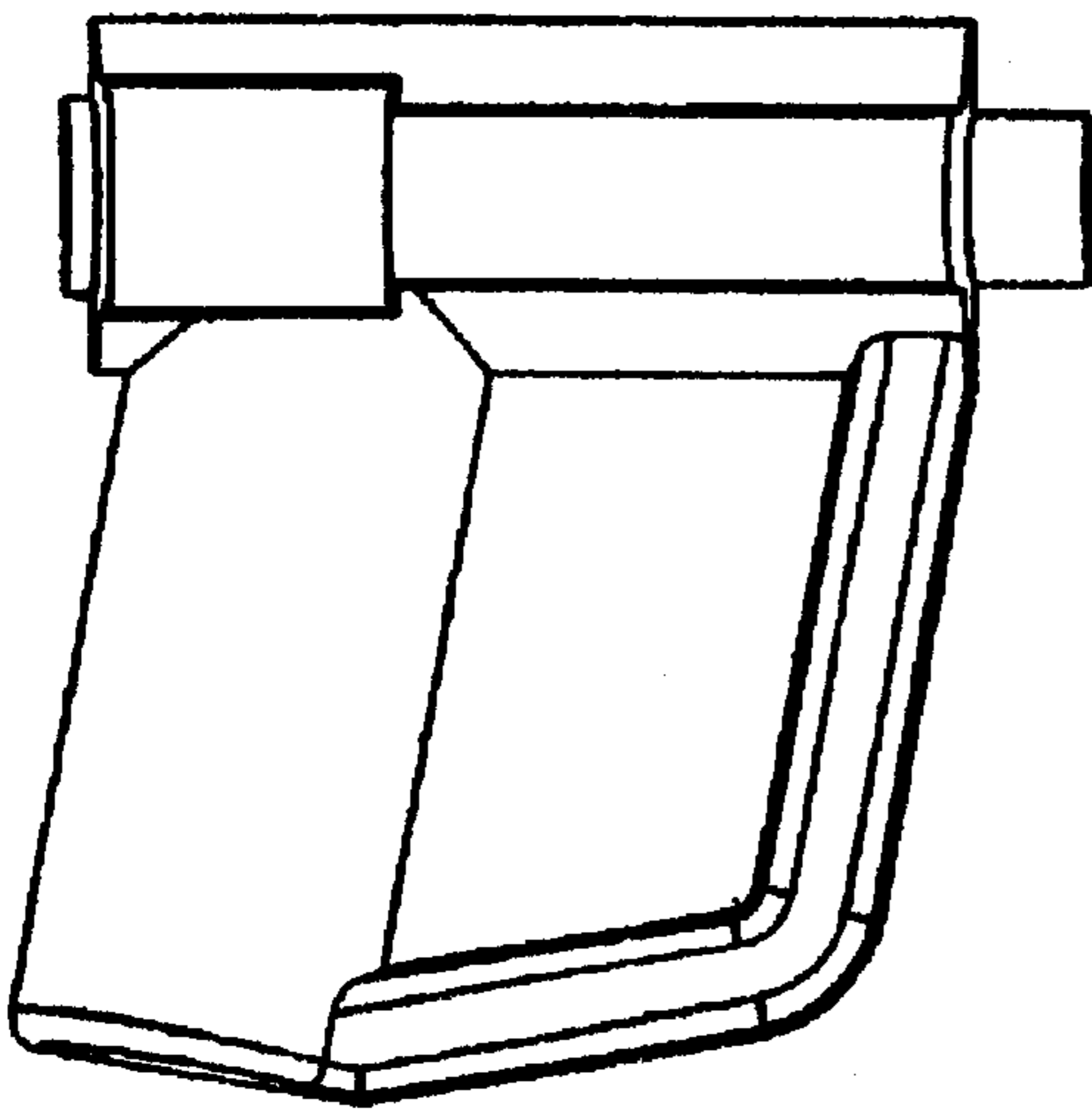

FIG. 6

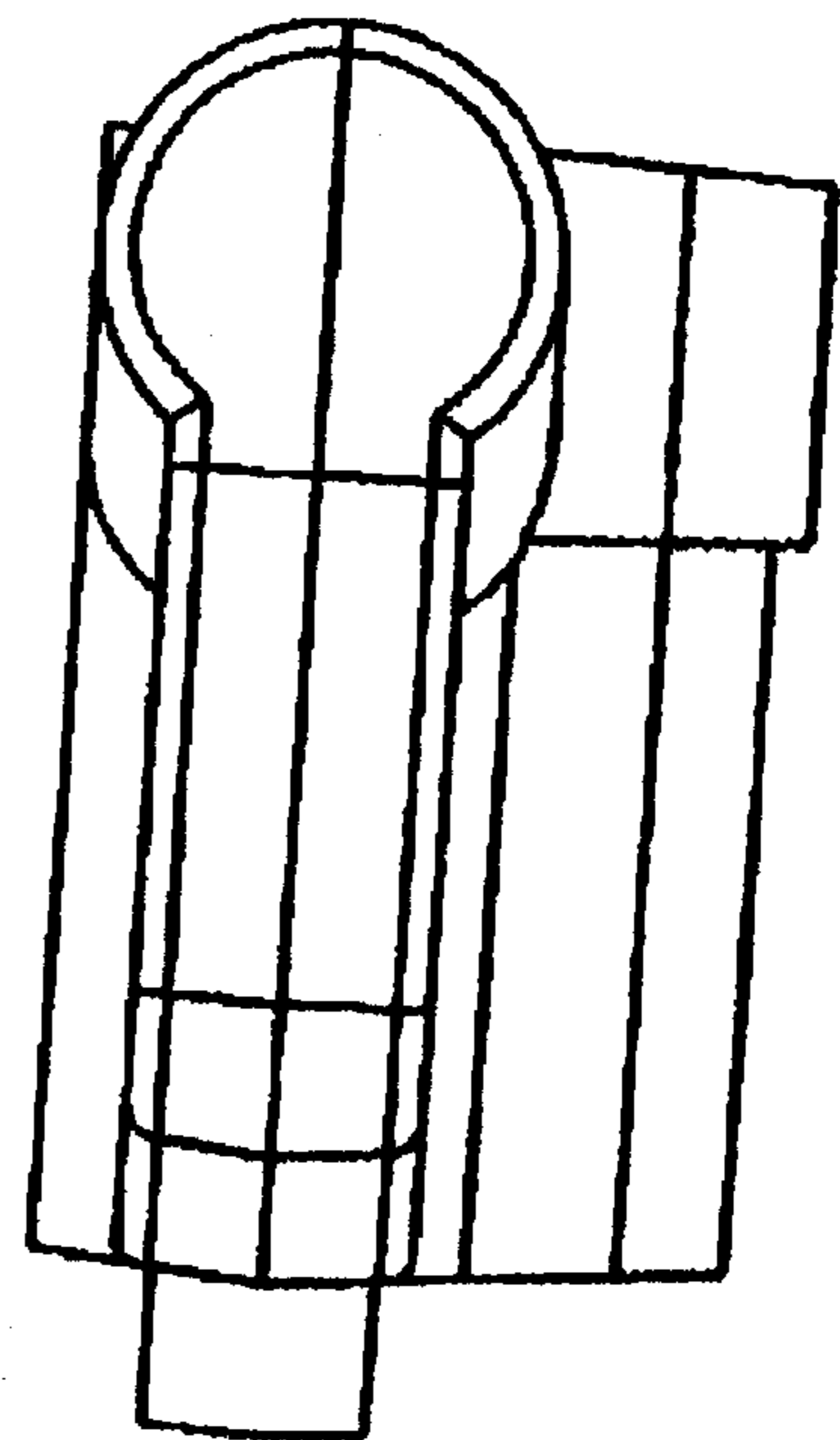

FIG. 7