



US00D487024S

(12) **United States Design Patent**  
**Hsu Li**

(10) **Patent No.:** **US D487,024 S**

(45) **Date of Patent:** **\*\* Feb. 24, 2004**

(54) **DISPLAYER DEVICE FOR ATTACHING TO VEHICLE**

*Primary Examiner*—Antoine Duval Davis

(76) Inventor: **Hsiu-Chu Hsu Li**, P.O. Box 4-67, Hsin Chuang, Taipei (TW)

(\*\*) Term: **14 Years**

(21) Appl. No.: **29/169,781**

(22) Filed: **Oct. 23, 2002**

(51) **LOC (7) Cl.** ..... **10-04**

(52) **U.S. Cl.** ..... **D10/65**

(58) **Field of Search** ..... D10/65; 701/200,  
701/213-218; 340/423.5

(56) **References Cited**

**U.S. PATENT DOCUMENTS**

D467,512 S \* 12/2002 Miyazaki ..... D10/65

D475,642 S \* 6/2003 Murdock et al. .... D10/65

\* cited by examiner

(57) **CLAIM**

The ornamental design for a displayer device for attaching to vehicle, as shown and described.

**DESCRIPTION**

FIG. 1 is a perspective view of a displayer device for attaching to vehicle showing my new design;

FIG. 2 is a front elevational view thereof;

FIG. 3 is a rear elevational view thereof;

FIG. 4 is a top plan view thereof;

FIG. 5 is a bottom plan view thereof;

FIG. 6 is a left side elevational view thereof; and,

FIG. 7 is a right side elevational view thereof.

**1 Claim, 6 Drawing Sheets**

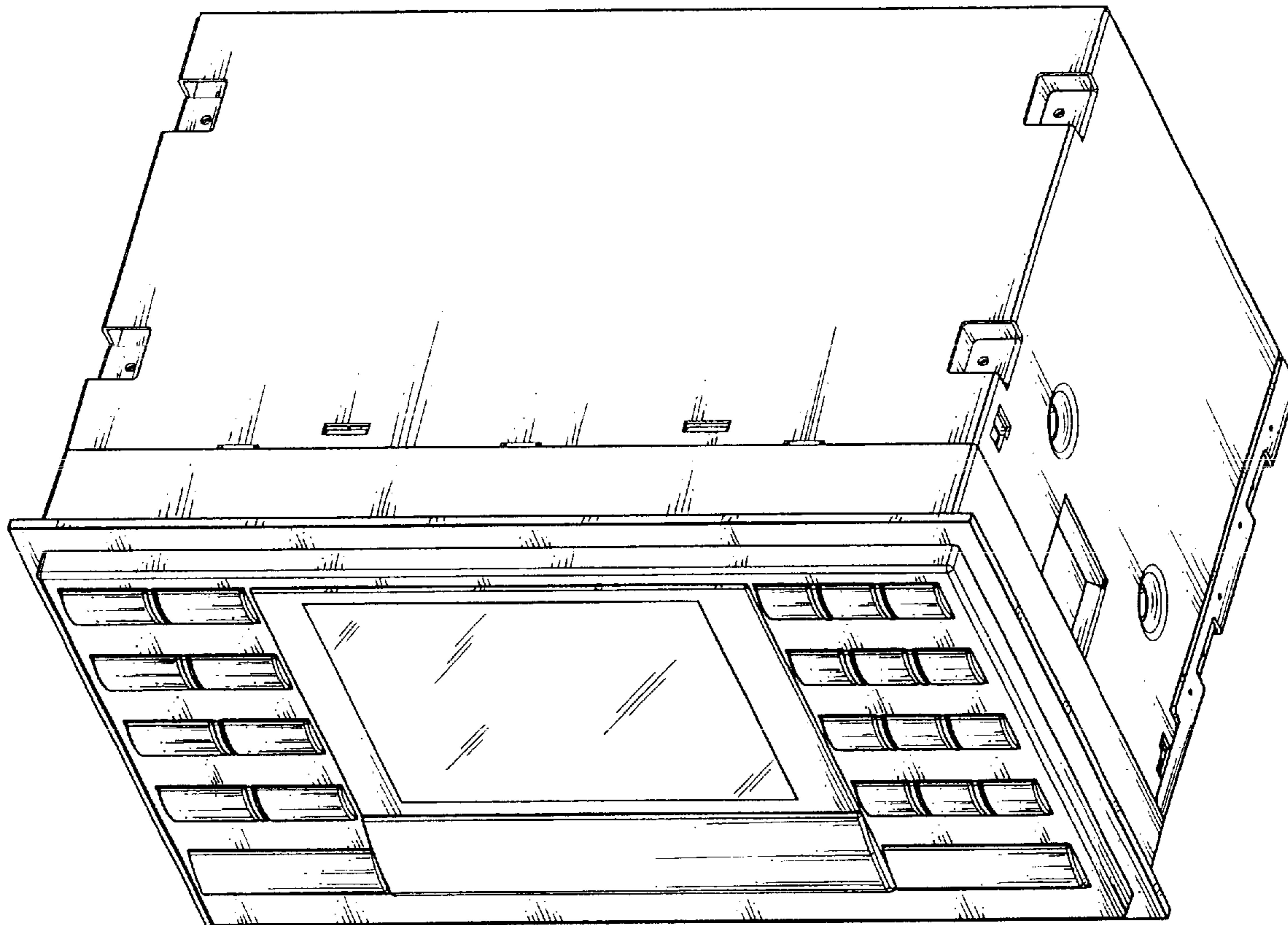

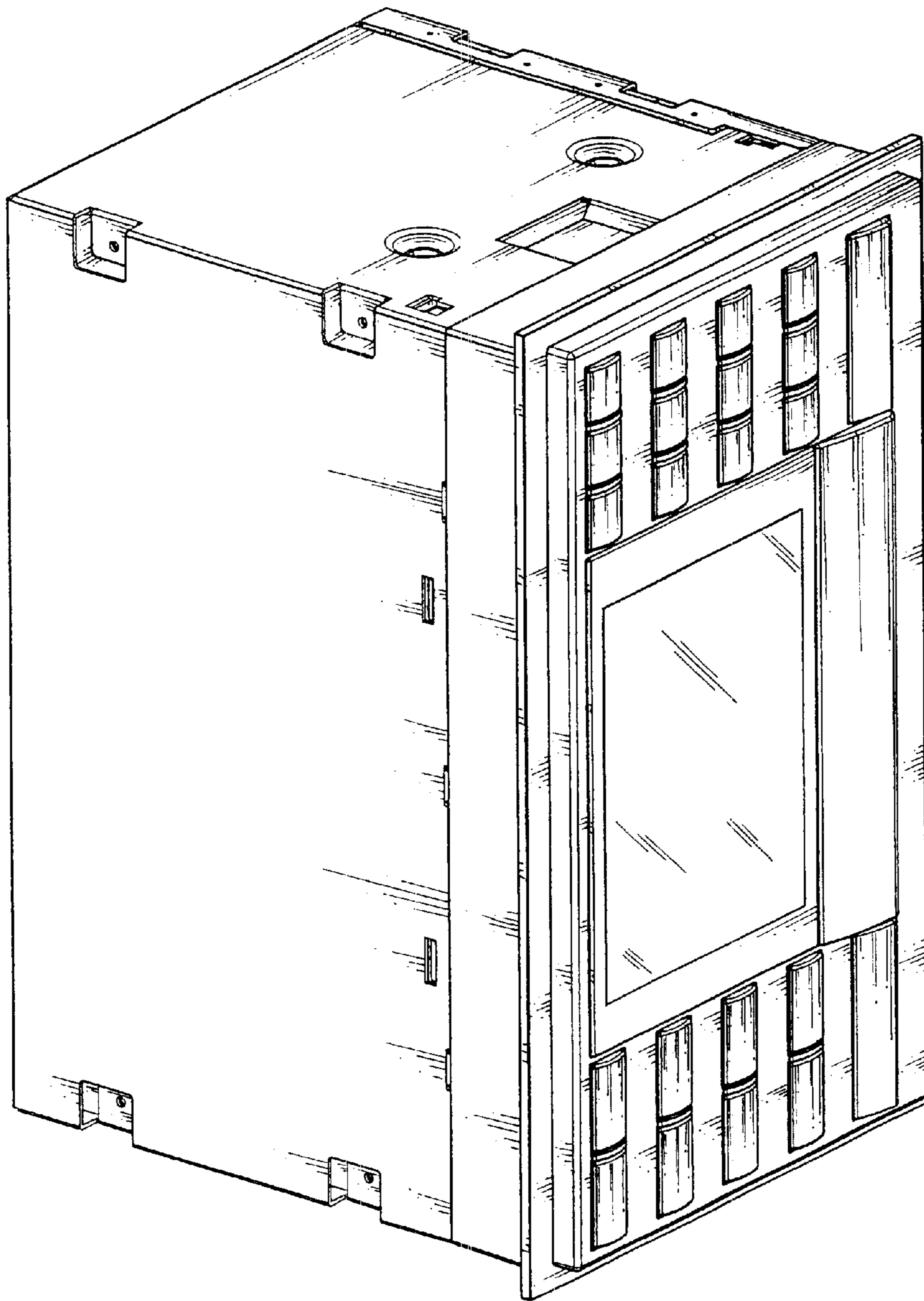

FIG. 1

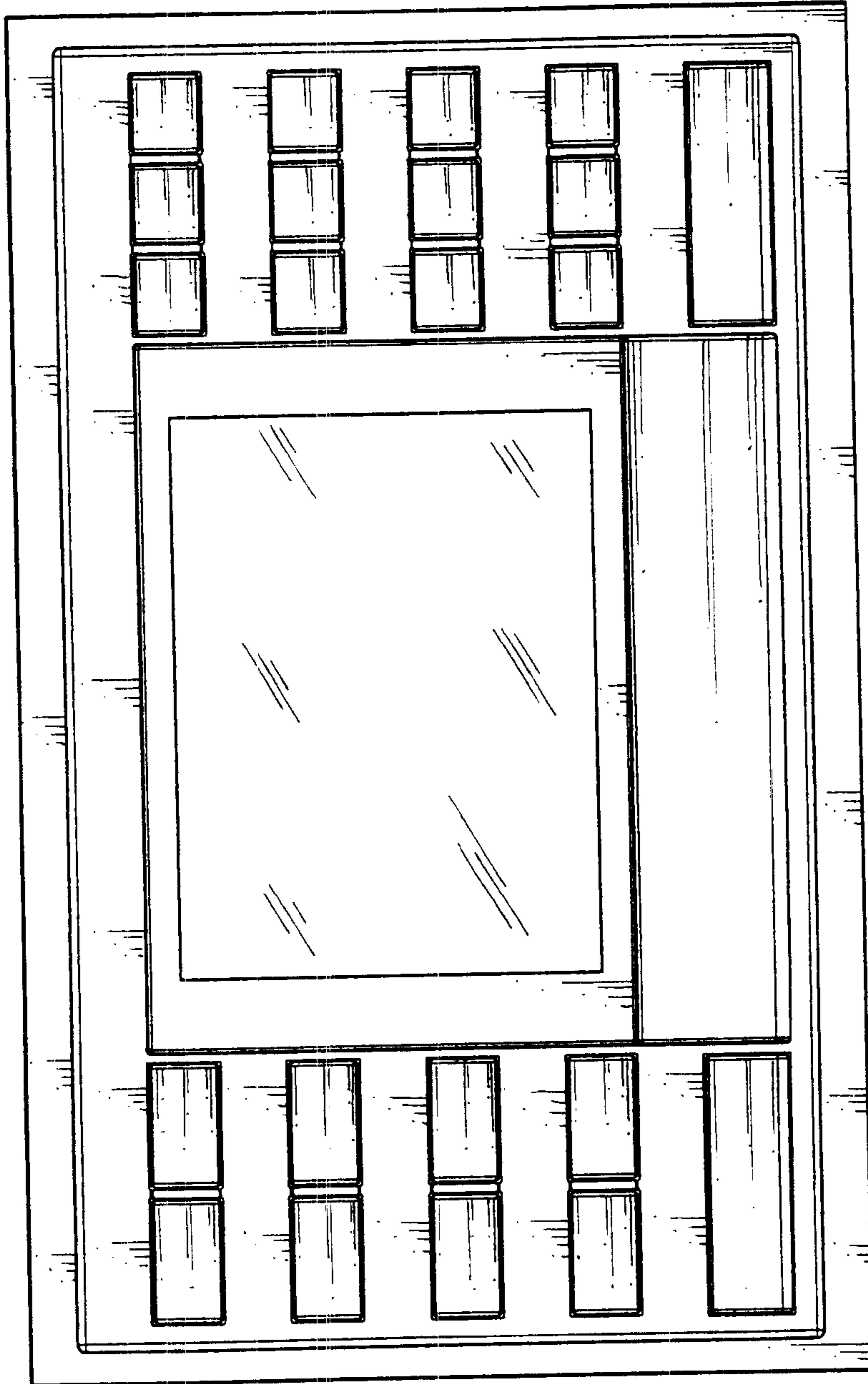

FIG. 2

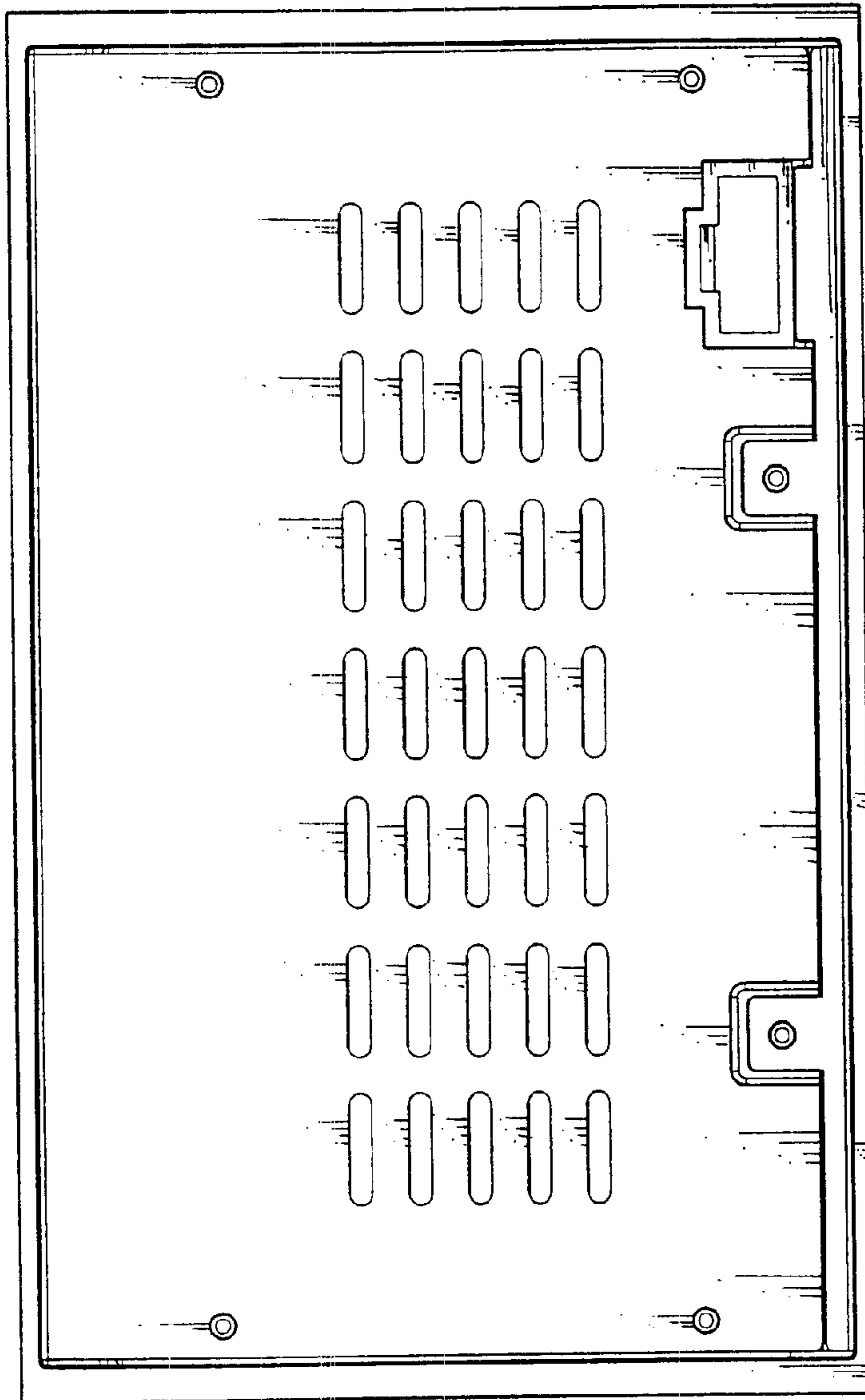

FIG. 3

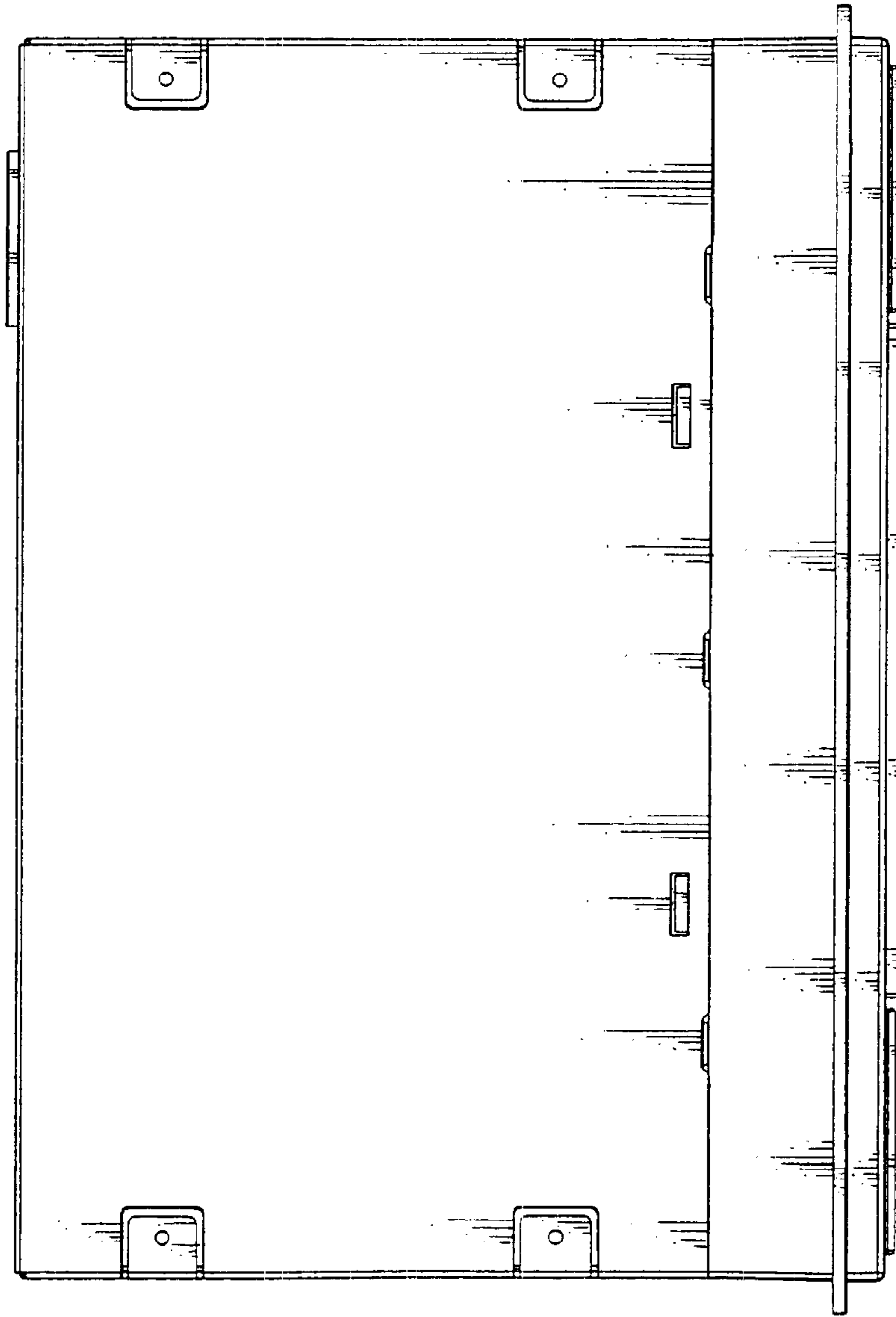

FIG. 4

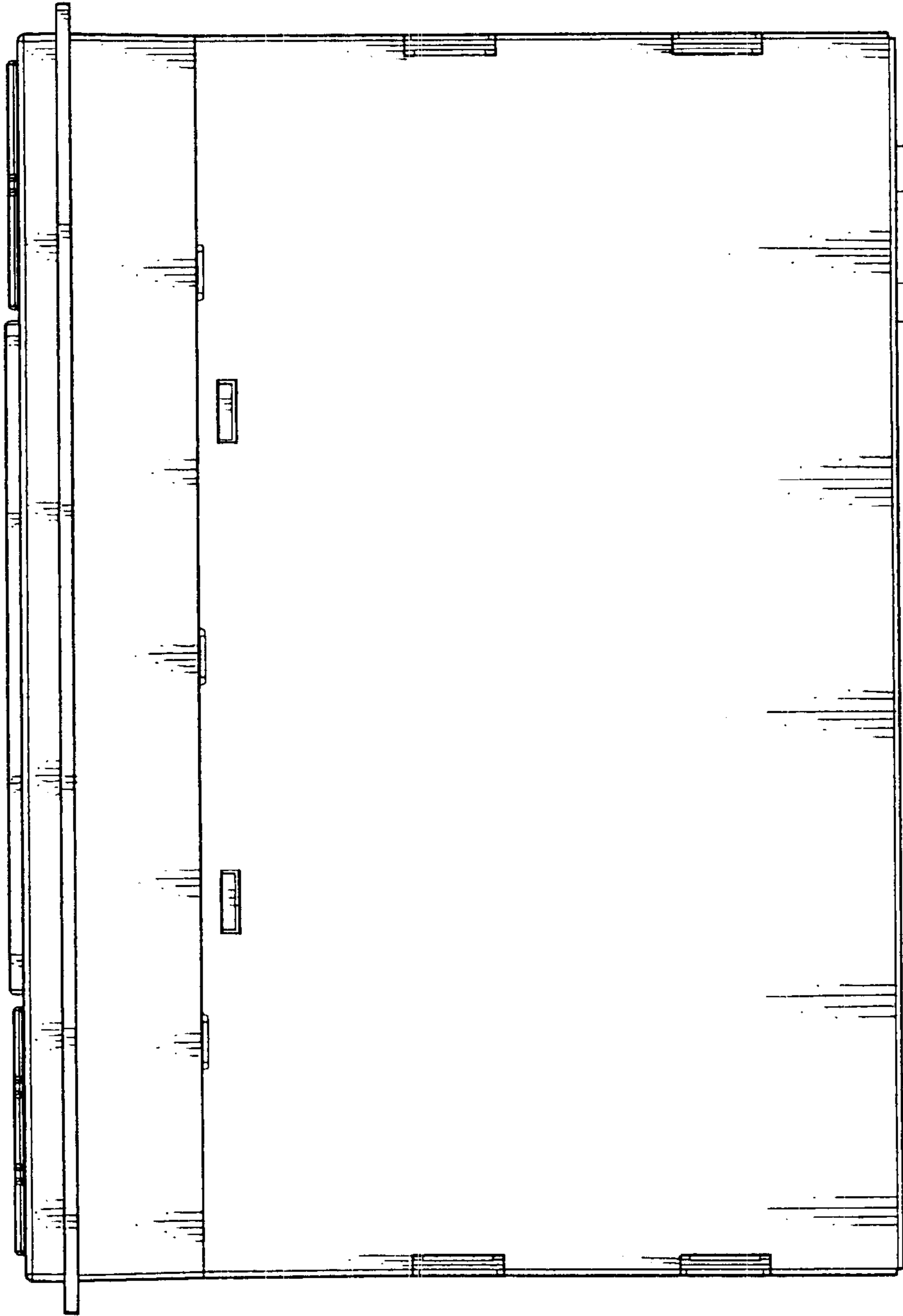

FIG. 5



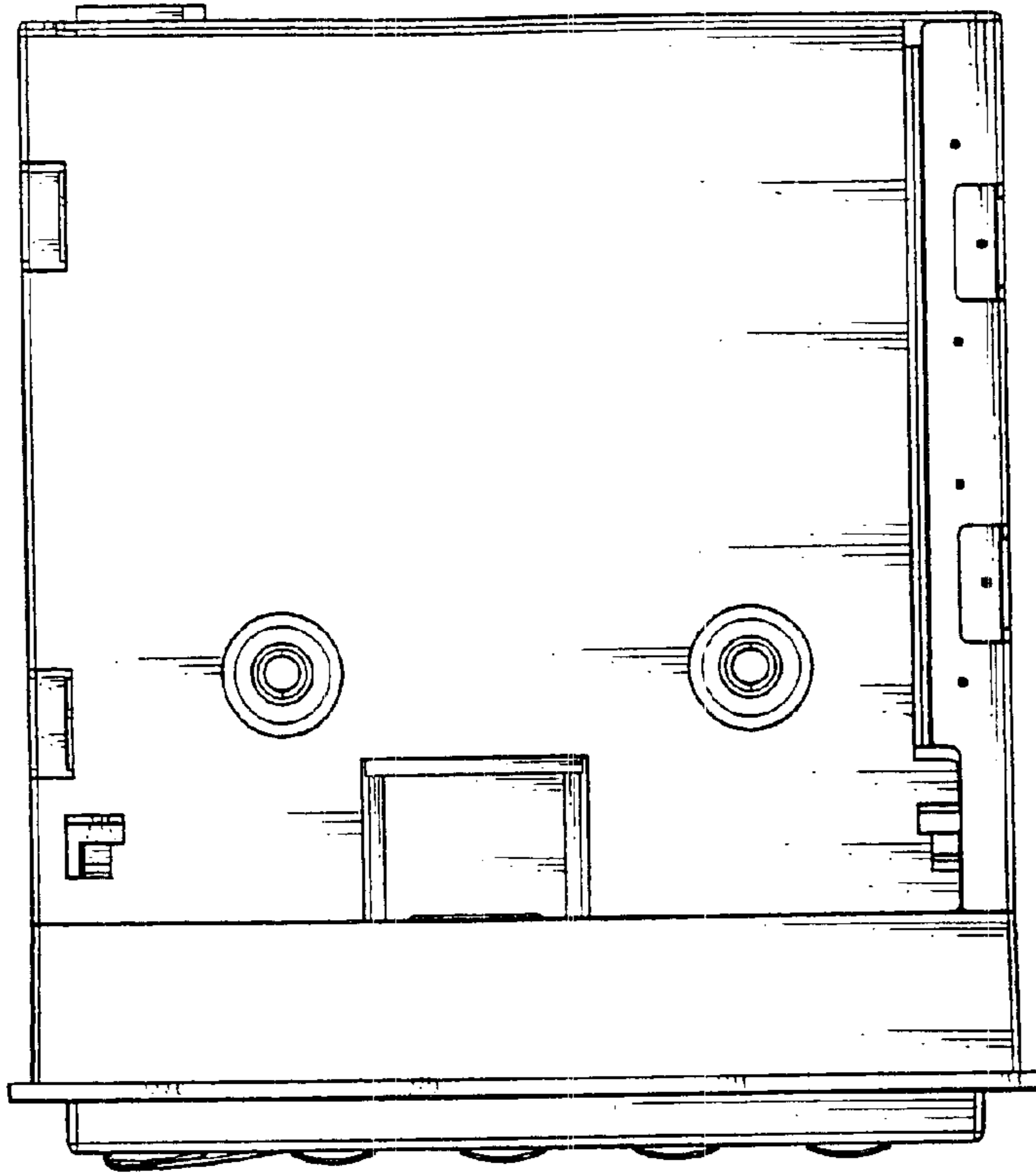

FIG. 7

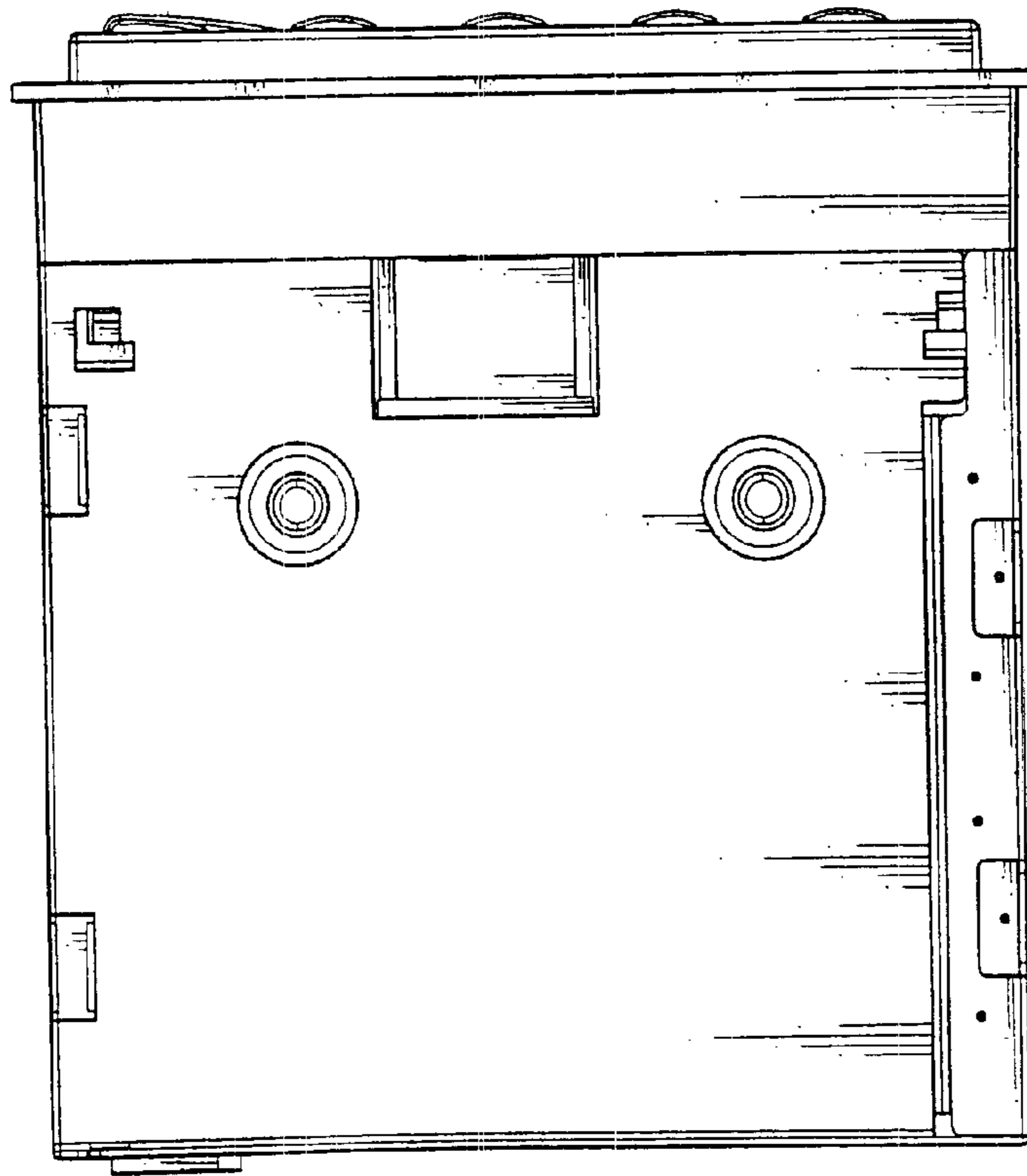

FIG. 6