



US00D485451S

(12)

**United States Design Patent**  
**De Blois**

(10) Patent No.:

**US D485,451 S**

(45) Date of Patent:

**\*\* Jan. 20, 2004**

(54) **FURNITURE**

(75) Inventor: **Martin De Blois**, Chicago, IL (US)

(73) Assignee: **Baronet, Inc.** (CA)

(\*\*) Term: **14 Years**

(21) Appl. No.: **29/179,907**

(22) Filed: **Apr. 16, 2003**

**Related U.S. Application Data**

(62) Division of application No. 29/155,684, filed on Feb. 14, 2002, now Pat. No. Des. 473,401.

(51) **LOC (7) Cl.** ..... **06-04**

(52) **U.S. Cl.** ..... **D6/436**

(58) **Field of Search** ..... D6/436, 438, 439,  
D6/477, 478, 479; 108/59, 91, 92; 211/13.1,  
85.3, 134, 182

(56)

**References Cited**

**U.S. PATENT DOCUMENTS**

D440,074 S \* 4/2001 Hutton ..... D6/446

**OTHER PUBLICATIONS**

Imperial Tables, 1957–1958, table # 5357, p. 32 at middle left (circled).  
Baronet java Brochure, Jul. 1997, p. 6 with 411 and 416 tables (circled).

Room and Board Catalog, 2002, cover page, back page and p. 127, table #F in top row (circled).  
  
\* cited by examiner

*Primary Examiner*—Cathron C. Brooks  
(74) *Attorney, Agent, or Firm*—SAIDMAN DesignLaw Group

(57)

**CLAIM**

The ornamental design for furniture, as shown and described.

**DESCRIPTION**

FIG. 1 is a front view of a first embodiment showing my new design;  
FIG. 2 is a left side view thereof, the right side view being a mirror image;  
FIG. 3 is a front view of a second embodiment showing my new design; and,  
FIG. 4 is left side view thereof, the right side view being a mirror image.  
  
The broken lines are for illustrative purposes only and form no part of the claimed design.

**1 Claim, 2 Drawing Sheets**

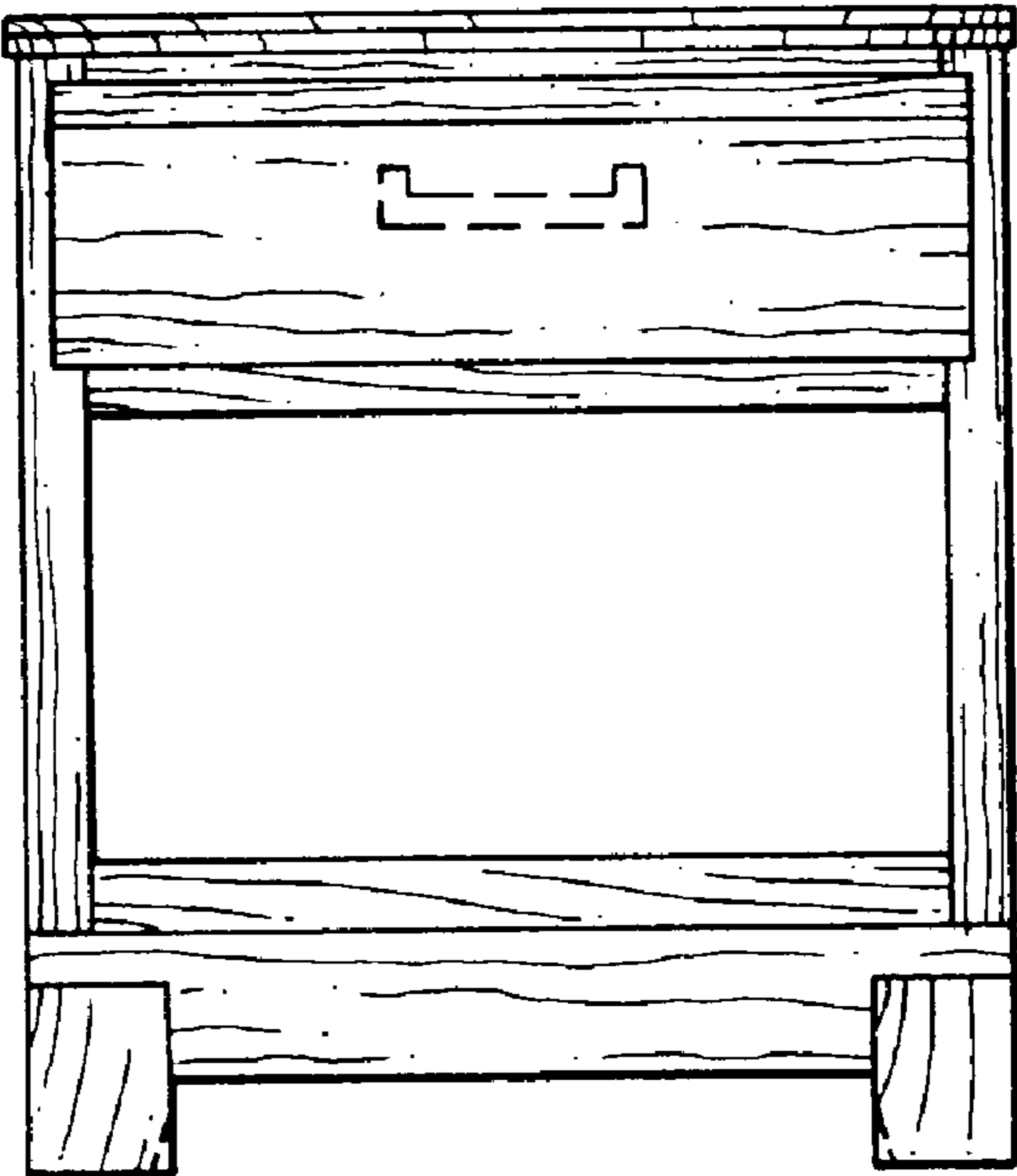

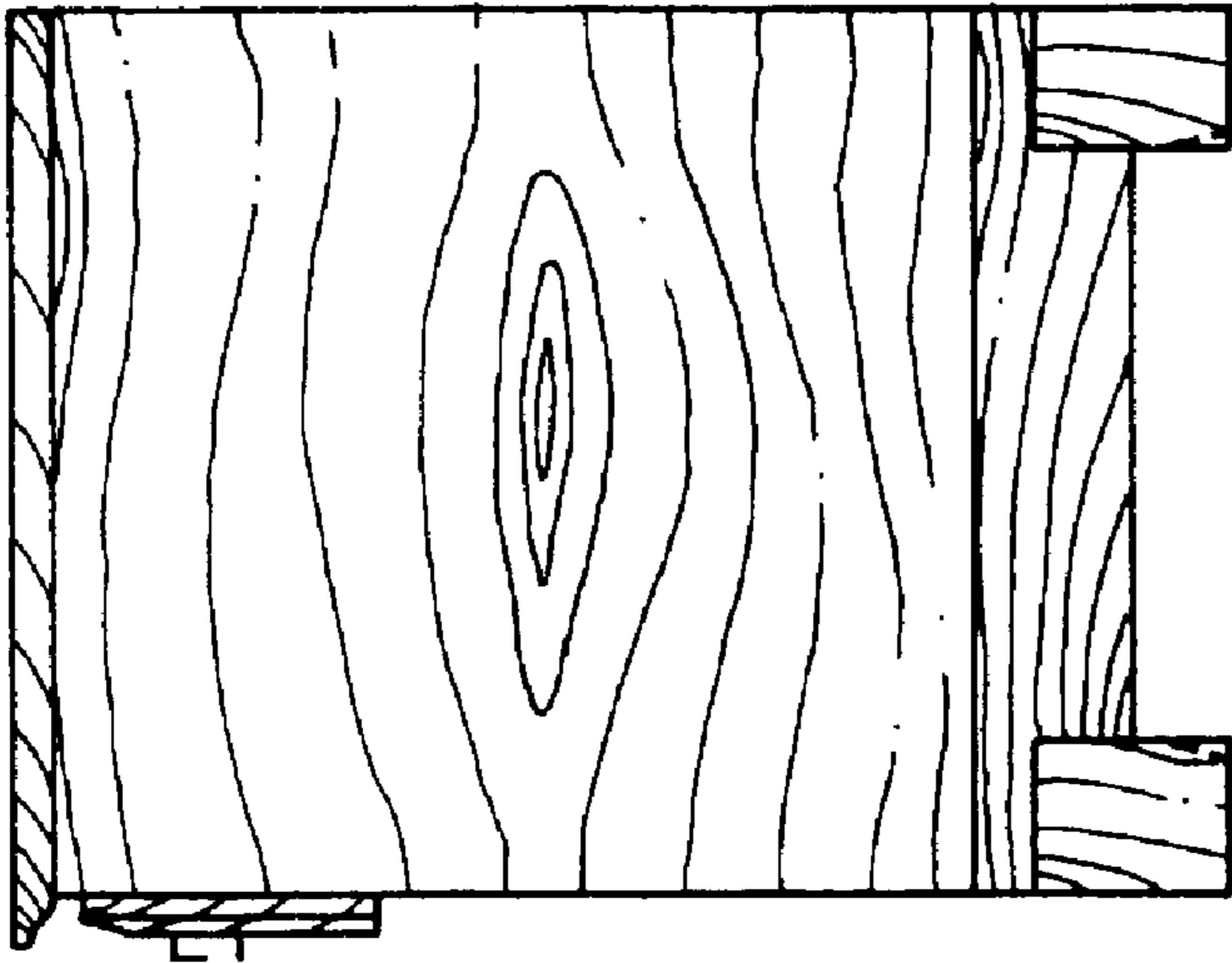

FIG.1

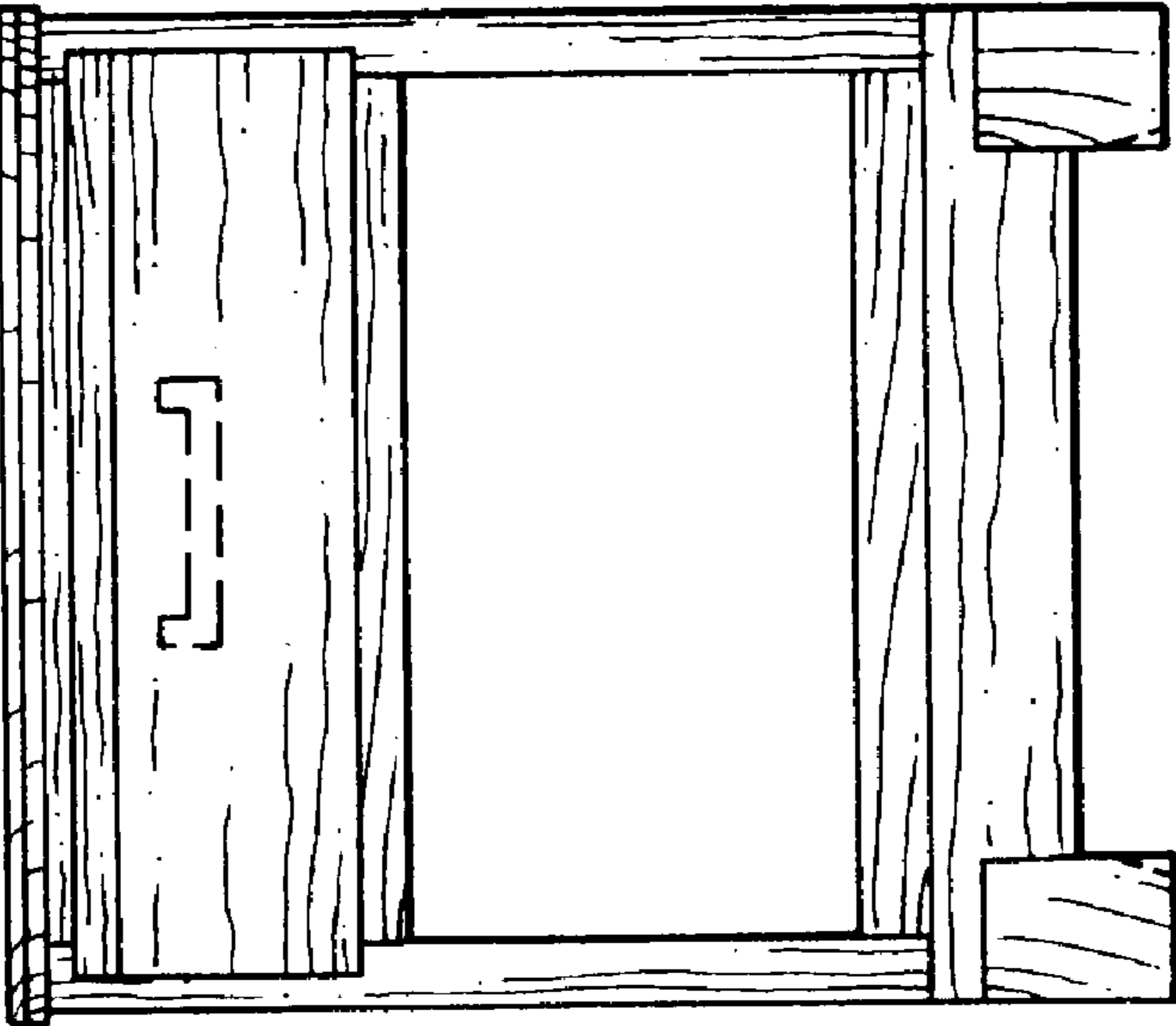

FIG.2



FIG.3

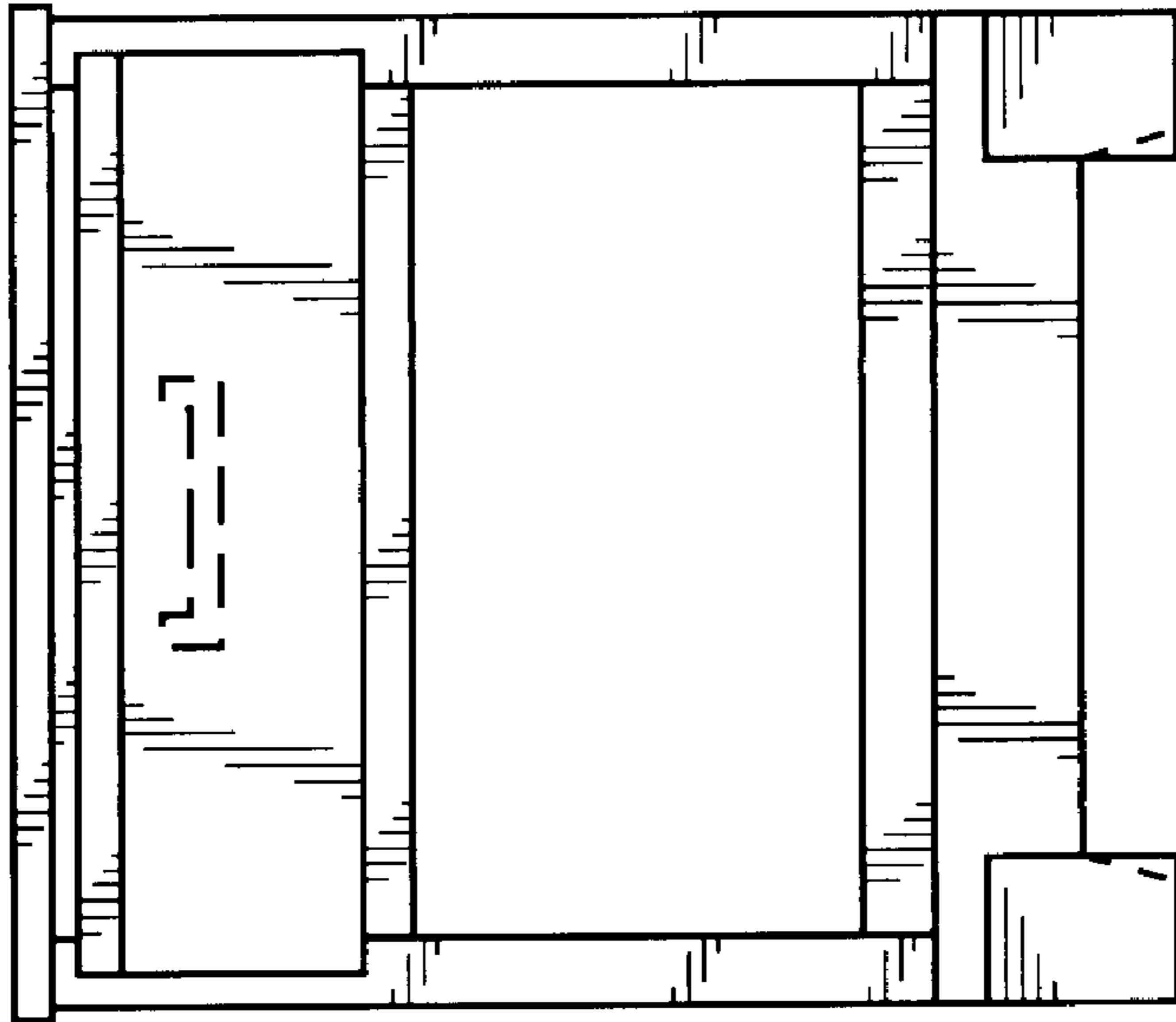

FIG.4