



US00D485152S

(12) **United States Design Patent**
Soreo

(10) **Patent No.:** **US D485,152 S**

(45) **Date of Patent:** **** Jan. 13, 2004**

(54) **PAIR OF TOOL HANDLES**

(75) **Inventor:** **Robert F. Soreo**, Cleveland Heights, OH (US)

(73) **Assignee:** **Stride Tool Inc.**, Ellicottville, NY (US)

(**) **Term:** **14 Years**

(21) **Appl. No.:** **29/179,589**

(22) **Filed:** **Apr. 11, 2003**

(51) **LOC (7) Cl.** **08-05**

(52) **U.S. Cl.** **D8/107; D8/32**

(58) **Field of Search** D8/51, 52-58, D8/107, 4, 5, 32, 60; 81/177.1, 489, 427.5, 436-440, 380-409; 16/110.1, 421, 422, 426, 430, 431, DIG. 12, DIG. 40; 72/31.05, 159, 217, 319, 458, 459, 479

(56) **References Cited**

U.S. PATENT DOCUMENTS

2,428,237 A	9/1947	McIntosh	
2,464,800 A	3/1949	Franck	
2,831,382 A	4/1958	Klamm	
2,986,195 A *	5/1961	Landis	72/154
D199,459 S *	10/1964	Small et al.	D8/32
3,447,172 A *	6/1969	Clark	7/107
3,447,353 A *	6/1969	Noveske	72/217
3,583,264 A *	6/1971	Brunosson	81/415
3,685,335 A *	8/1972	Kowal	72/319
3,888,101 A *	6/1975	Crees	D8/32
4,379,399 A	4/1983	Kowal	
4,379,400 A	4/1983	Schwartz	
4,380,922 A	4/1983	Kowal	

4,389,872 A	6/1983	Kowal
4,389,873 A	6/1983	Kowal
4,403,496 A	9/1983	Kowal
4,424,699 A	1/1984	Peppers
4,827,755 A	5/1989	Strybel
6,463,780 B1	10/2002	Kalanish
6,487,889 B1	12/2002	Bates et al.

* cited by examiner

Primary Examiner—Clare E. Heflin

(74) *Attorney, Agent, or Firm*—Benesch, Friedlander, Coplan & Aronoff LLP

(57) **CLAIM**

The ornamental design for a pair of tool handles, as shown and described.

DESCRIPTION

FIG. 1 is a perspective view of a tube bender tool having a pair of tool handles illustrating my new design; FIG. 2 is a bottom plan view thereof; FIG. 3 is a top plan view thereof; FIG. 4 is a front elevational view thereof; FIG. 5 is a rear elevational view thereof; FIG. 6 is a right side elevational view thereof; FIG. 7 is a left side elevational view thereof; and, FIG. 8 is a perspective view of an alternate embodiment of a tube bender tool having a pair of tool handles illustrating my new design.

The components of the tube bender tool, other than the pair of tool handles, are shown in broken lines for illustrative purposes only and form no part of the claimed design.

1 Claim, 3 Drawing Sheets

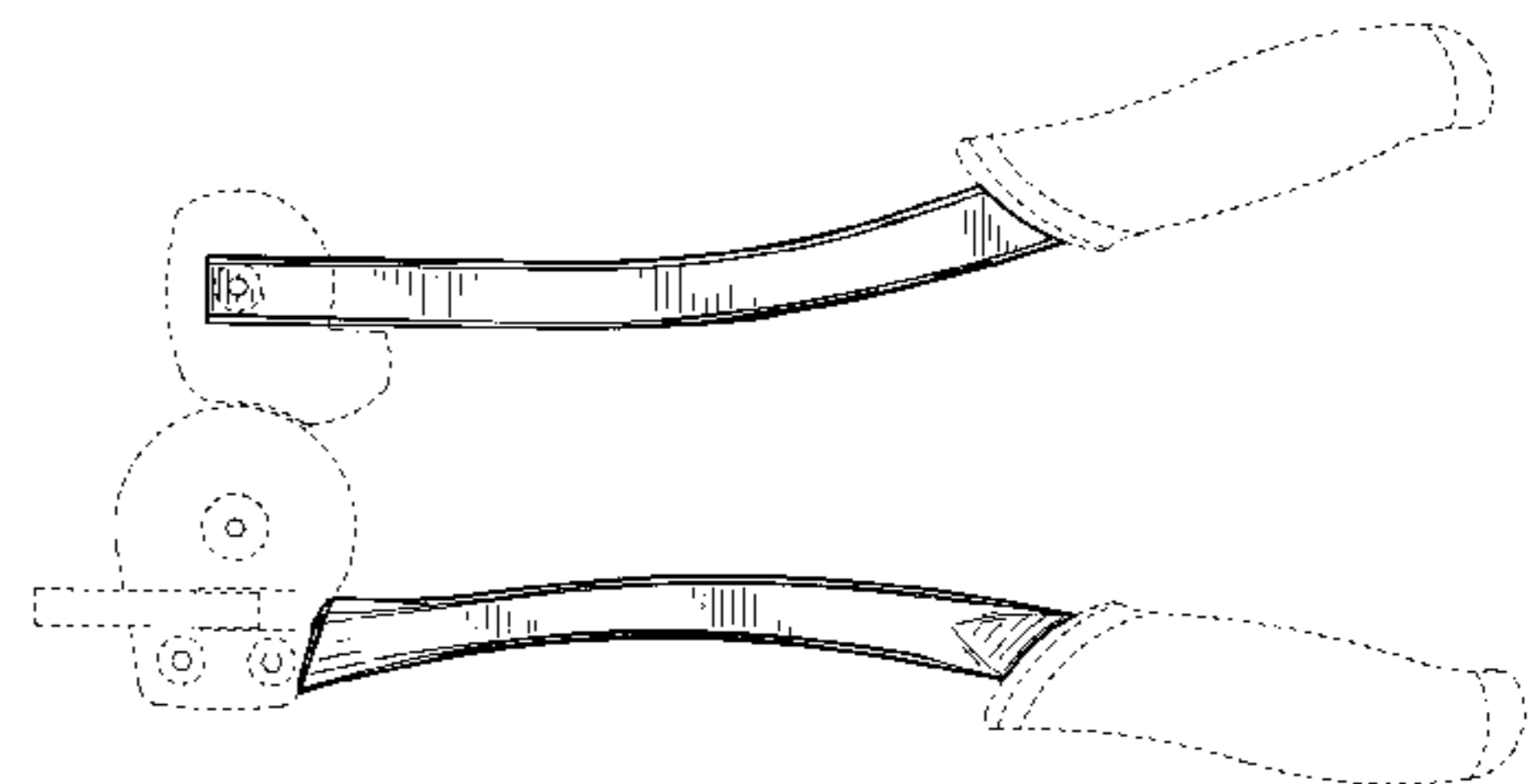
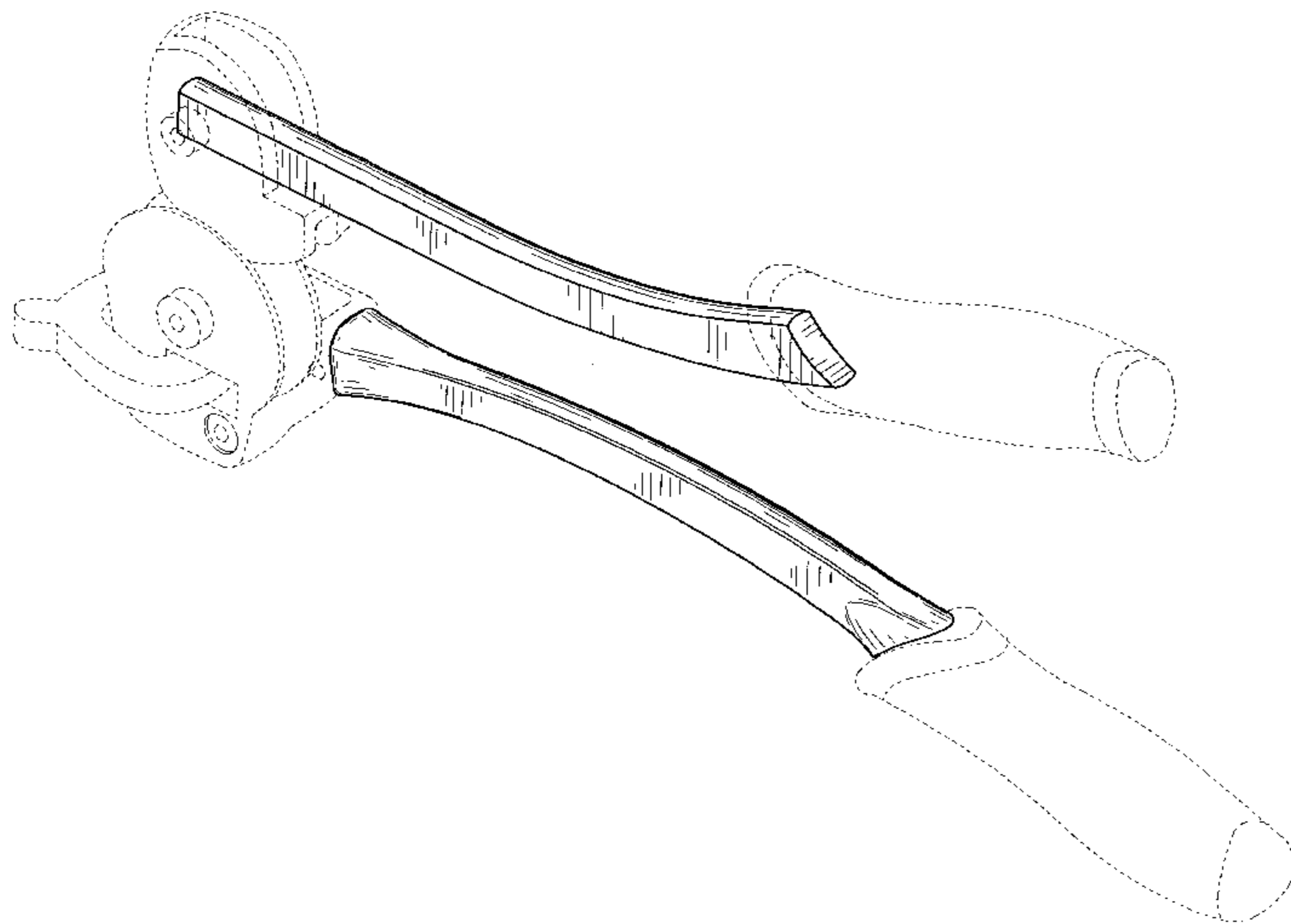

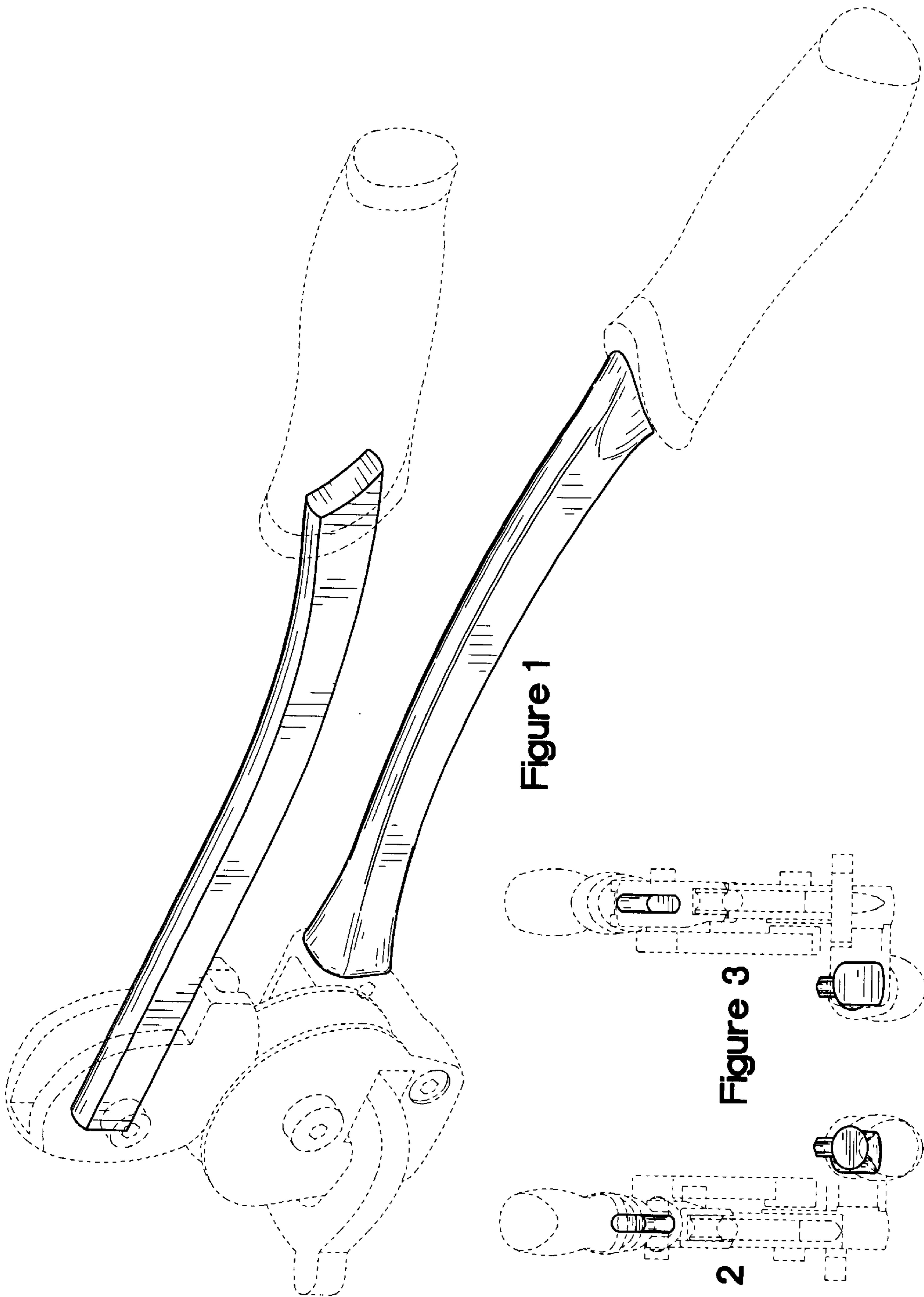
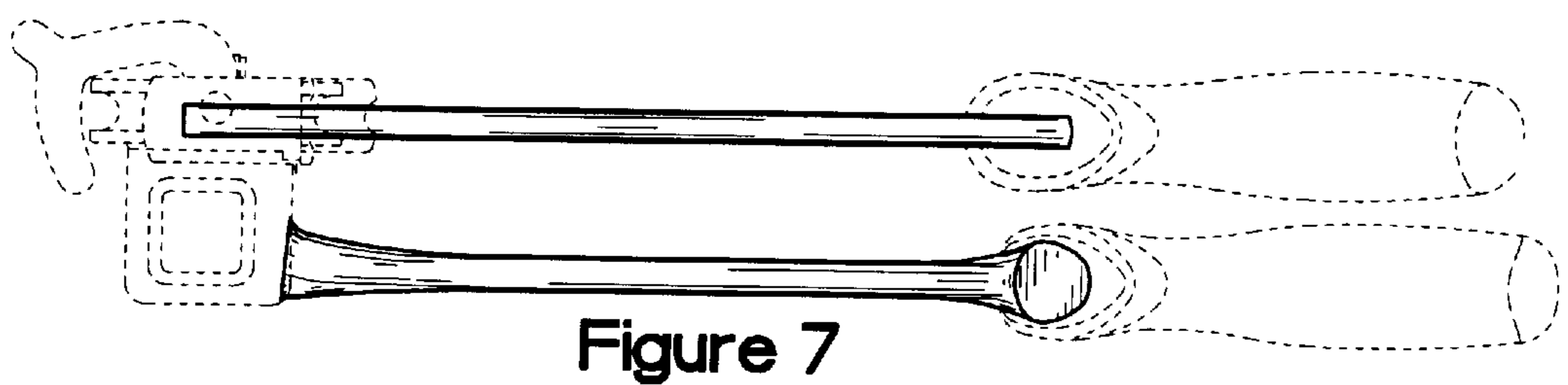
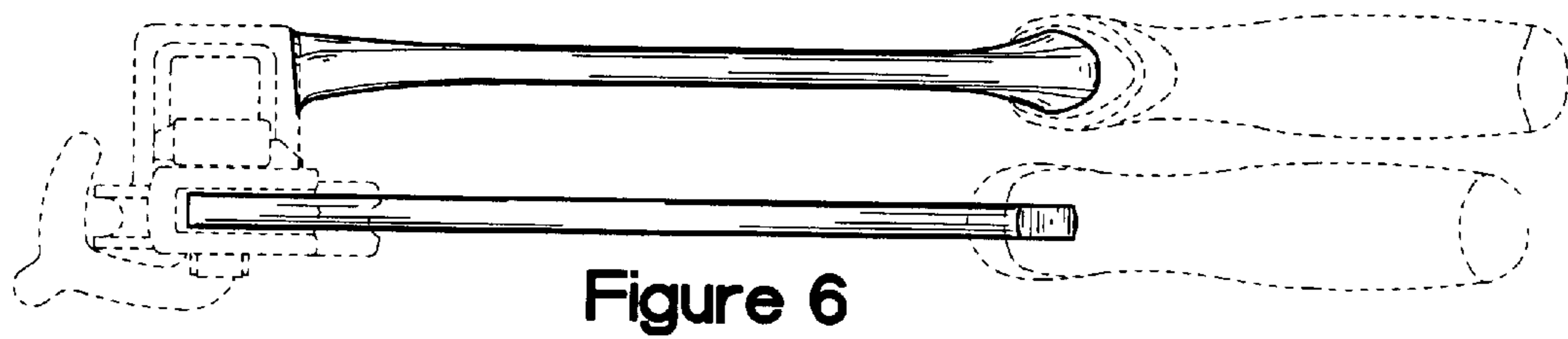
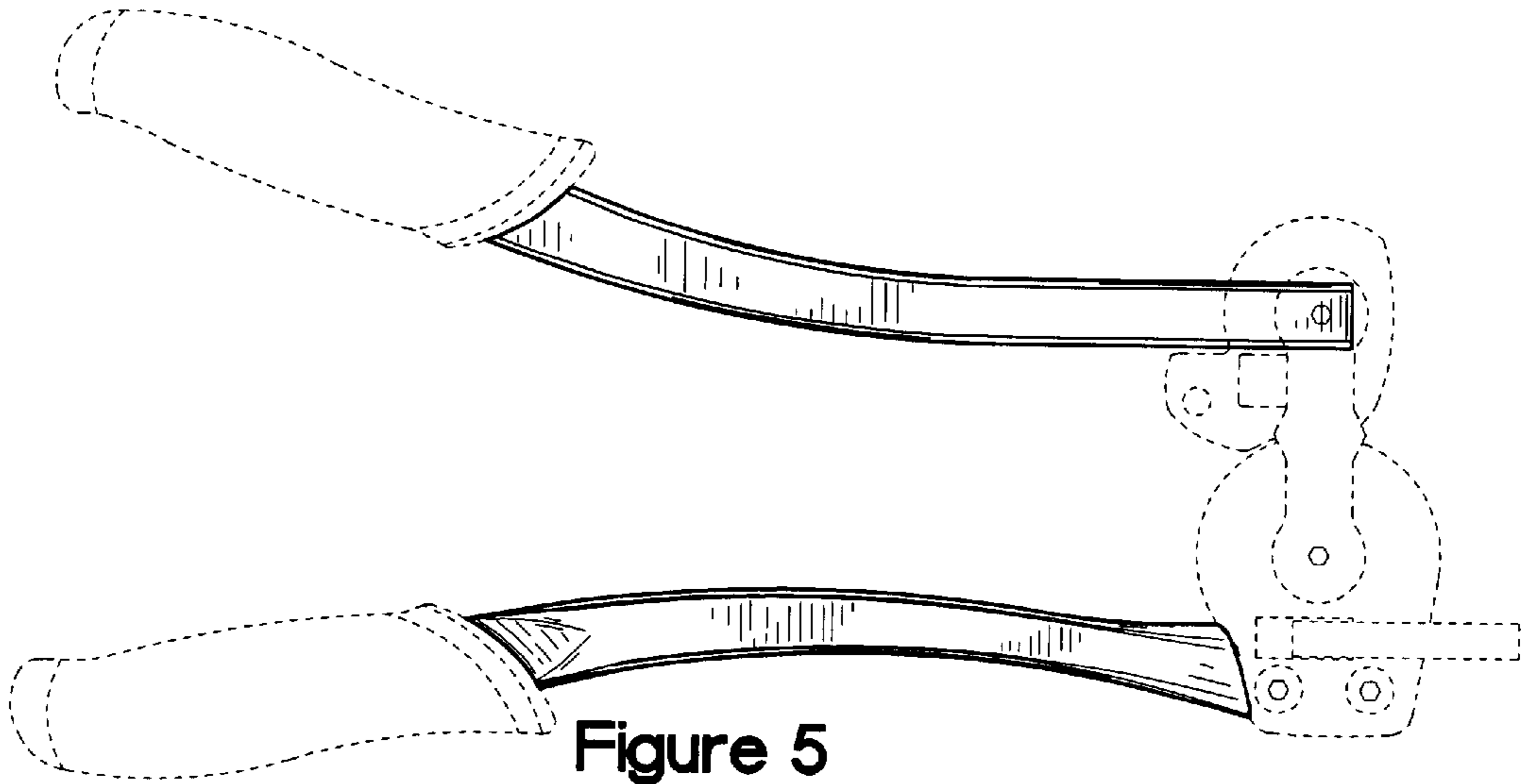
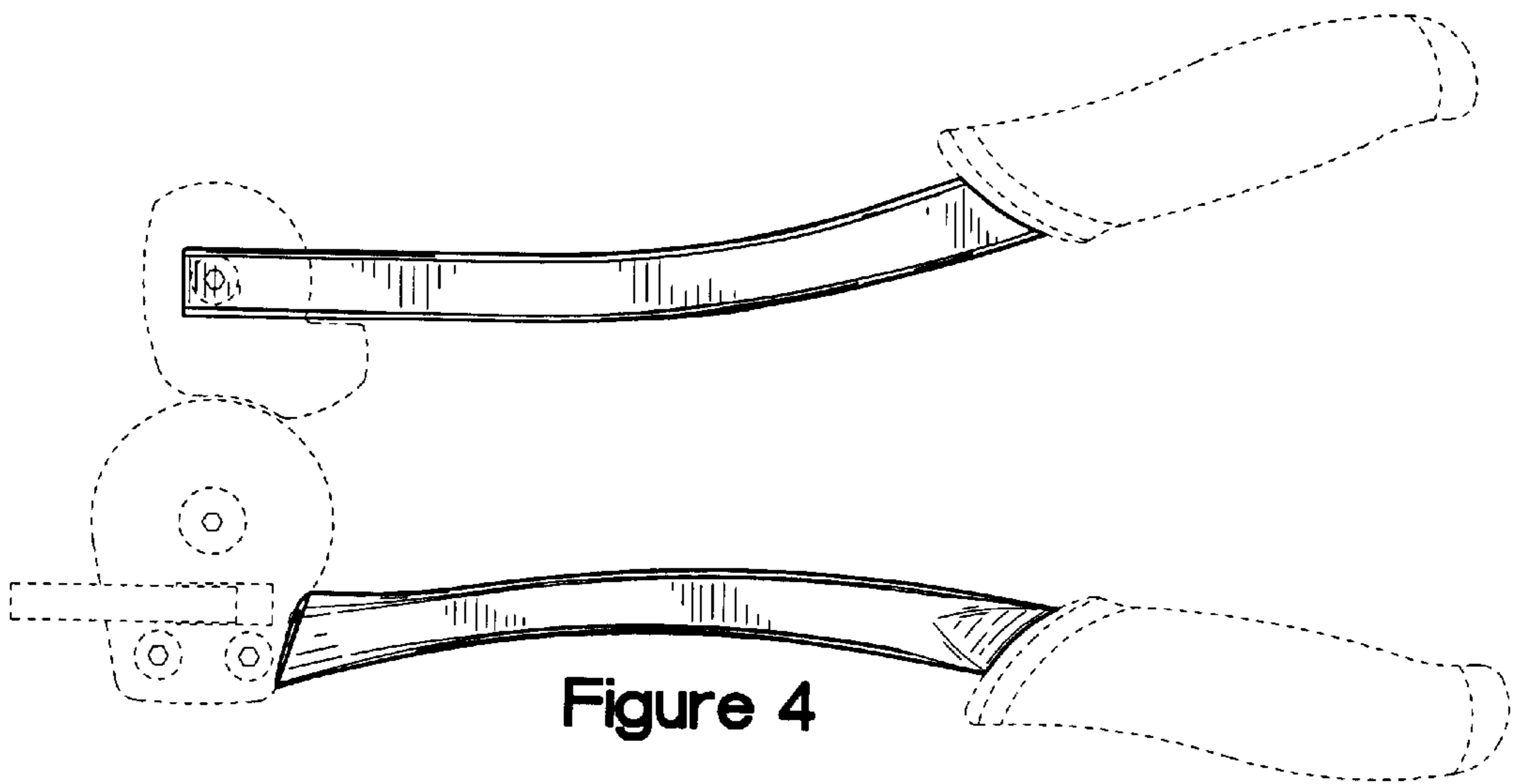

Figure 1

Figure 3

Figure 2



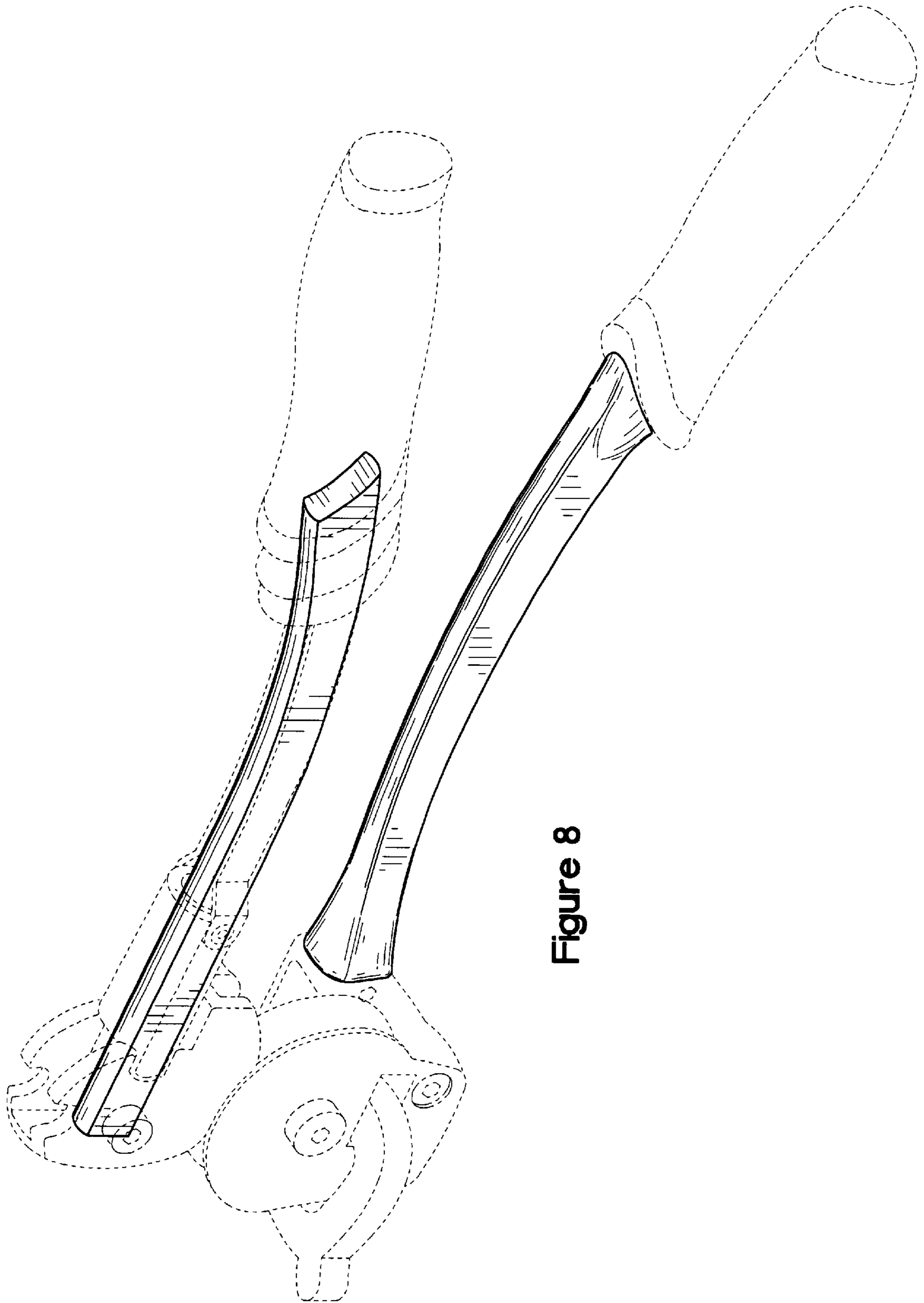

Figure 8