



US00D483789S

(12) **United States Design Patent**
Dordick

(10) **Patent No.:** **US D483,789 S**

(45) **Date of Patent:** **** Dec. 16, 2003**

(54) **CAMERA MOUNT CLAMP**

(76) Inventor: **Scott D. Dordick**, 102 E. Duell,
Glendora, CA (US) 91740

(**) Term: **14 Years**

(21) Appl. No.: **29/166,850**

(22) Filed: **Sep. 5, 2002**

(51) **LOC (7) Cl.** **16-05**

(52) **U.S. Cl.** **D16/245; D16/242**

(58) **Field of Search** **D16/237, 242,**
D16/244, 245; 248/176.1, 176.3, 177.1,
185.1, 187.1; 352/243; 396/419, 428

(56) **References Cited**

U.S. PATENT DOCUMENTS

| | | | | | |
|-------------|---|---------|-------------------|-------|---------|
| D246,528 S | * | 11/1977 | Miller | | D16/245 |
| D292,982 S | * | 12/1987 | Nakatani | | D16/245 |
| 4,959,671 A | * | 9/1990 | Ishikawa | | 396/428 |
| D323,339 S | * | 1/1992 | Ishikawa | | D16/245 |
| D353,825 S | * | 12/1994 | Forbes | | D16/242 |
| D366,887 S | * | 2/1996 | Wood | | D16/242 |
| D449,848 S | * | 10/2001 | Lewis, Jr. et al. | | D16/242 |

* cited by examiner

Primary Examiner—Adir Aronovich

(74) *Attorney, Agent, or Firm*—Edward O. Ansell

(57) **CLAIM**

The ornamental design for a camera mount clamp, as shown and described.

DESCRIPTION

FIG. 1 is a perspective view of a camera mount clamp showing my new design;

FIG. 2 is a top plan view thereof;

FIG. 3 is a bottom plan view thereof;

FIG. 4 is a front elevation view thereof;

FIG. 5 is a rear elevation view thereof;

FIG. 6 is a right elevation view thereof;

FIG. 7 is a left elevation view thereof; and,

FIG. 8 is a perspective view of the clamp in the environment in which the design is used, the broken line disclosure of the camera mount shown for illustrative purposes only and forms no part of the claimed design.

1 Claim, 4 Drawing Sheets

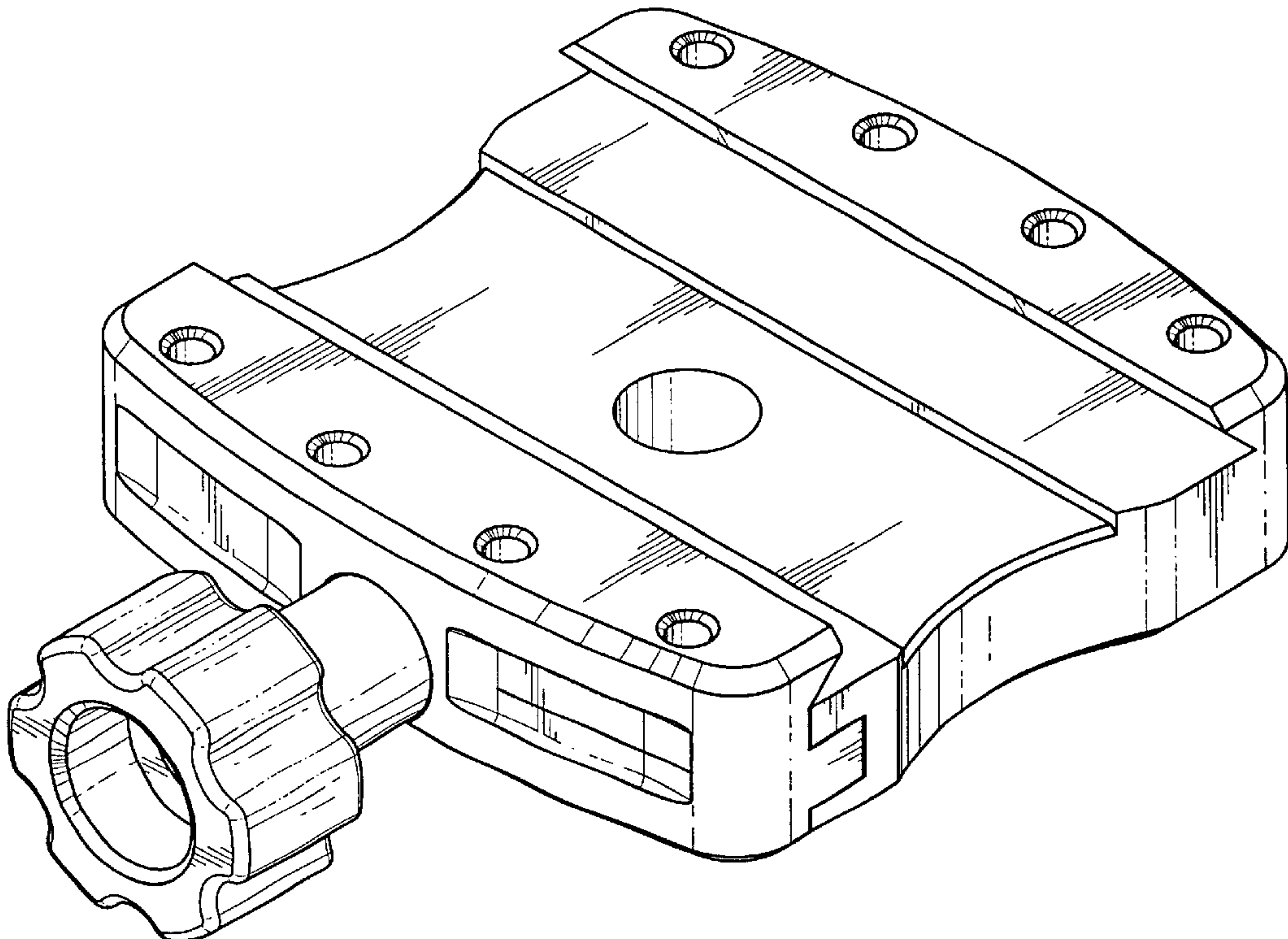

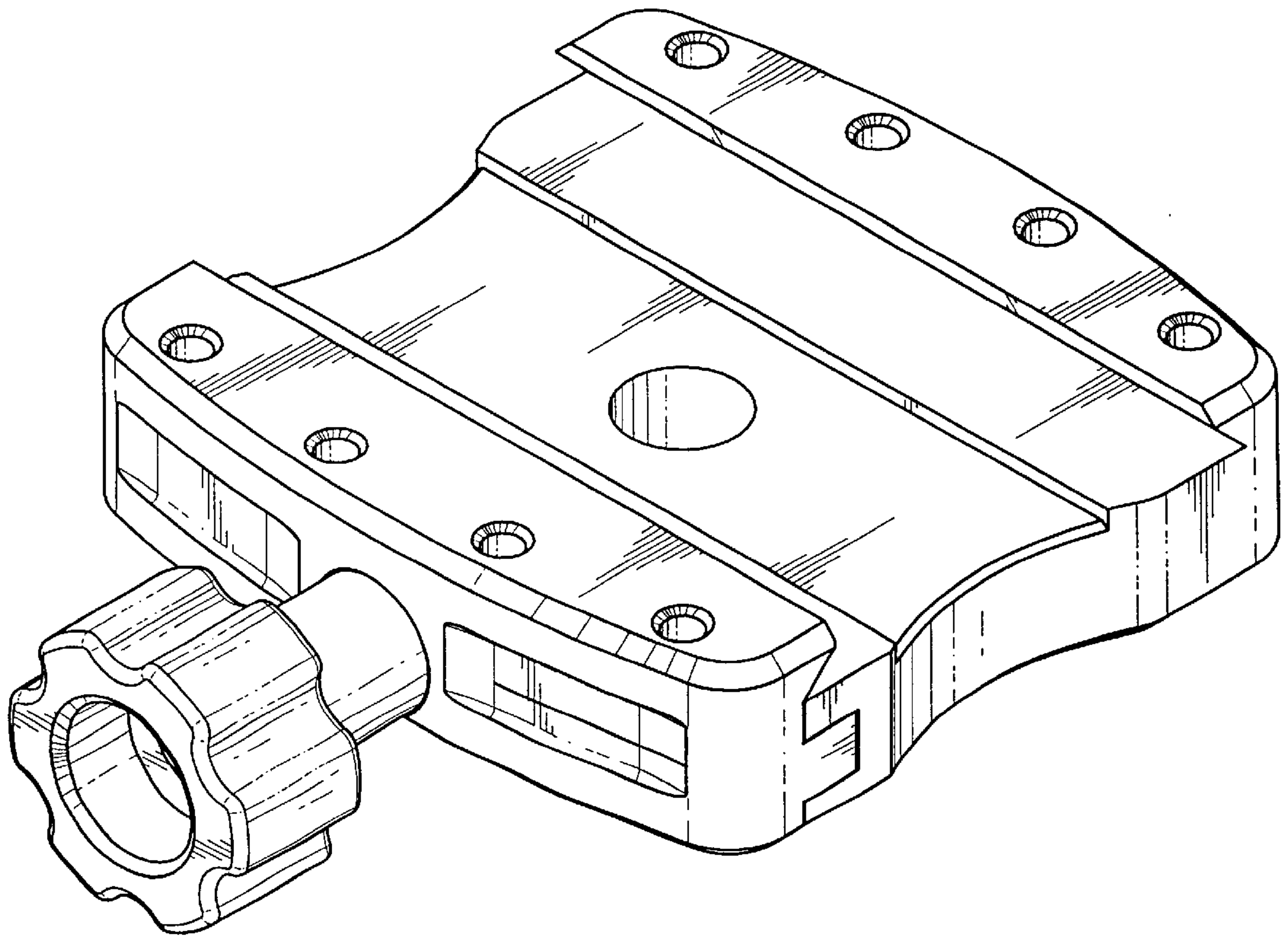

FIG. 1

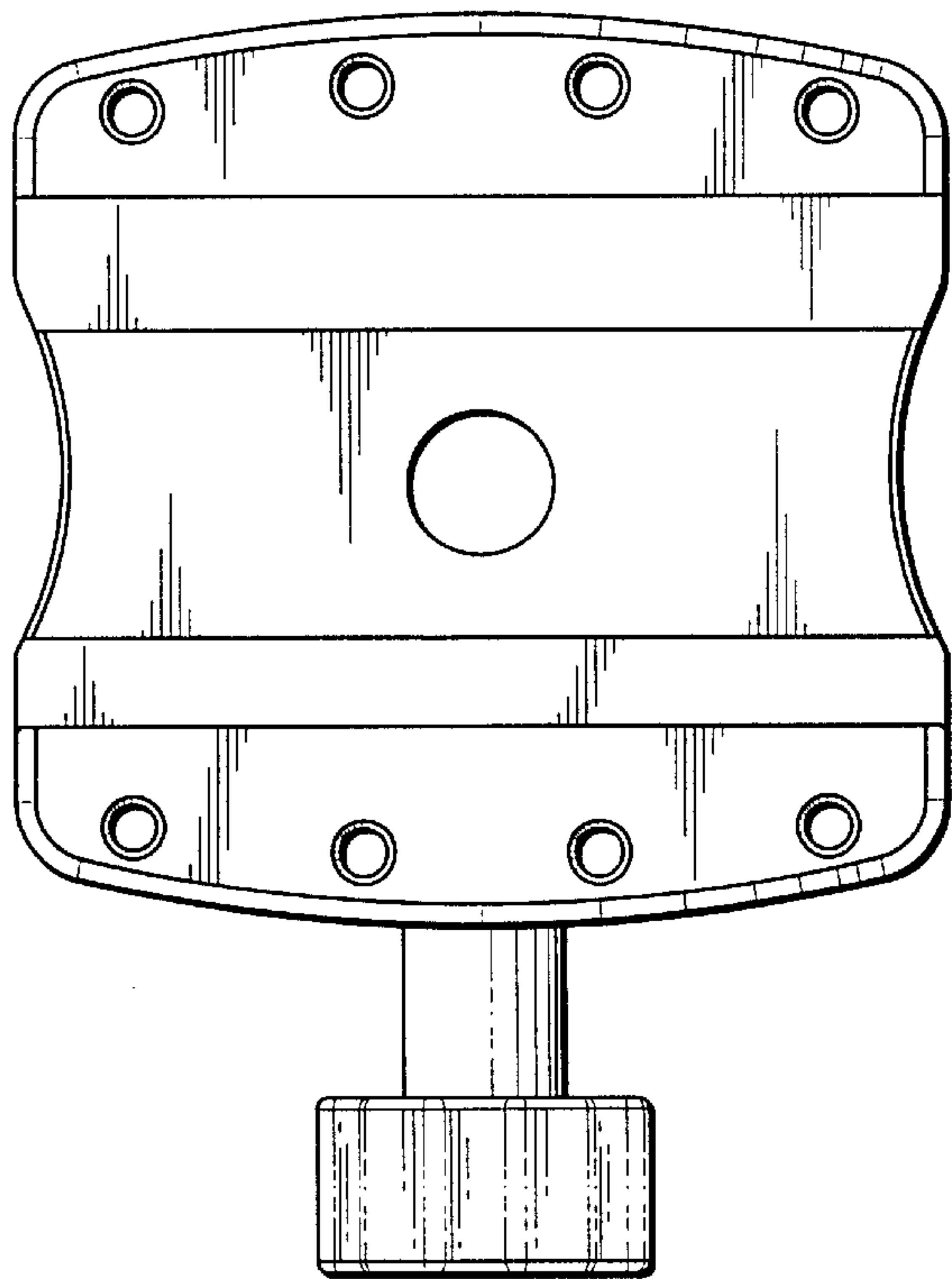

FIG. 2

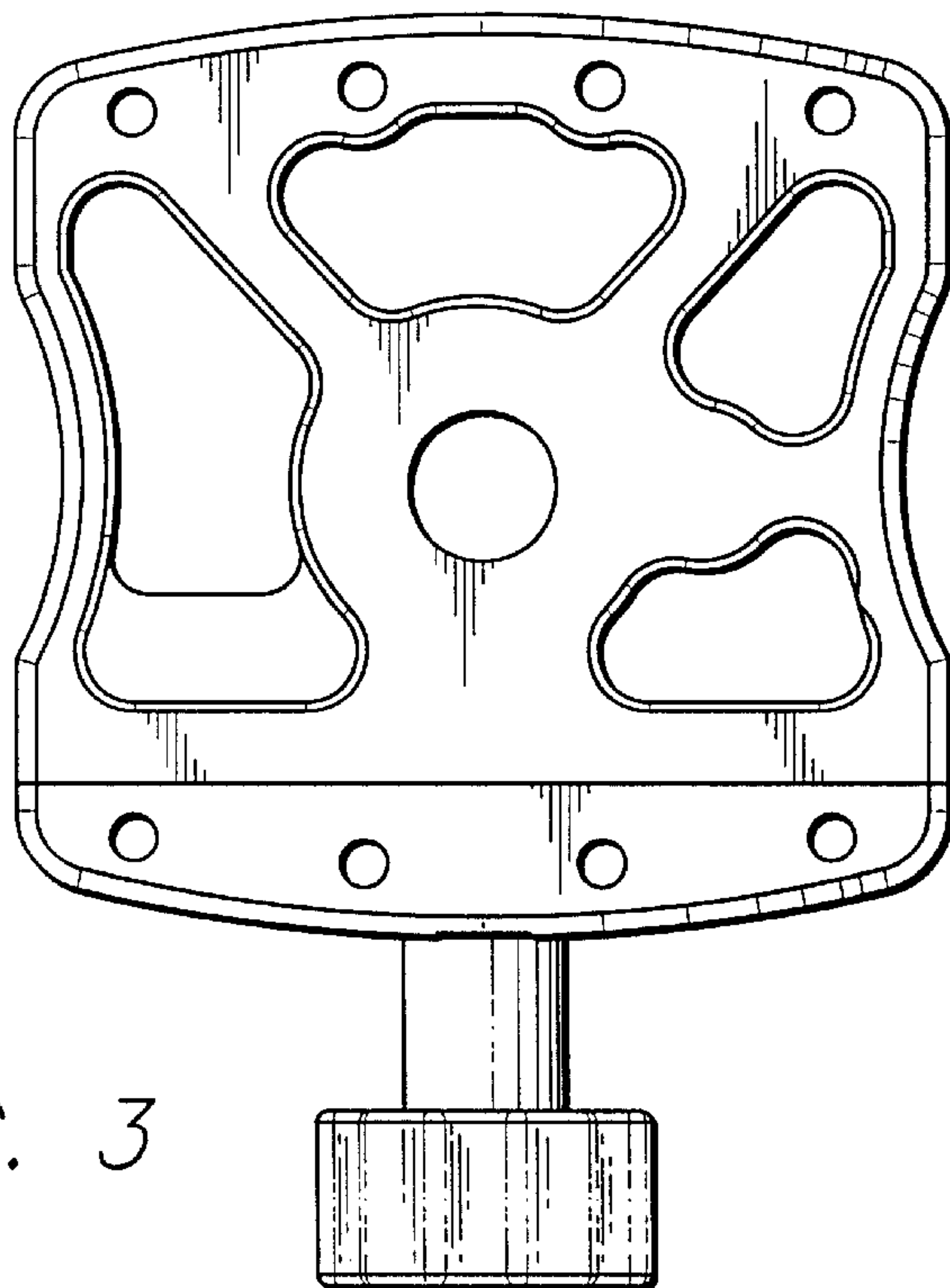

FIG. 3

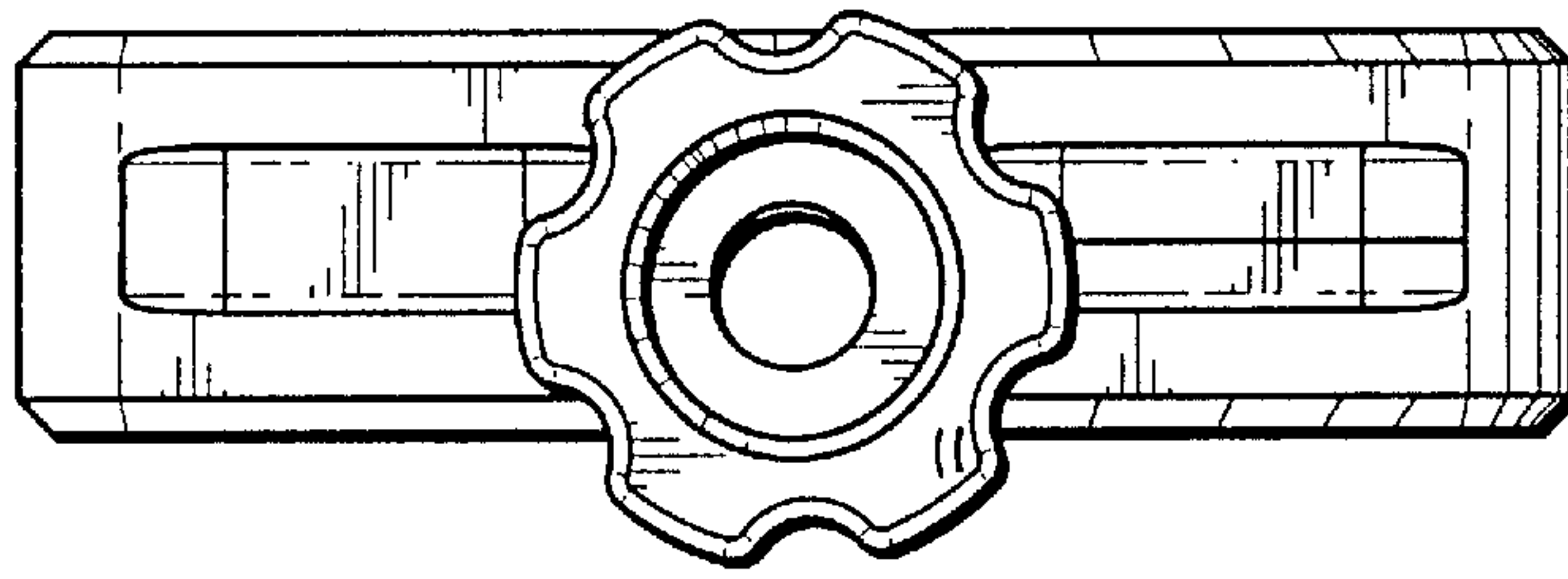

FIG. 4

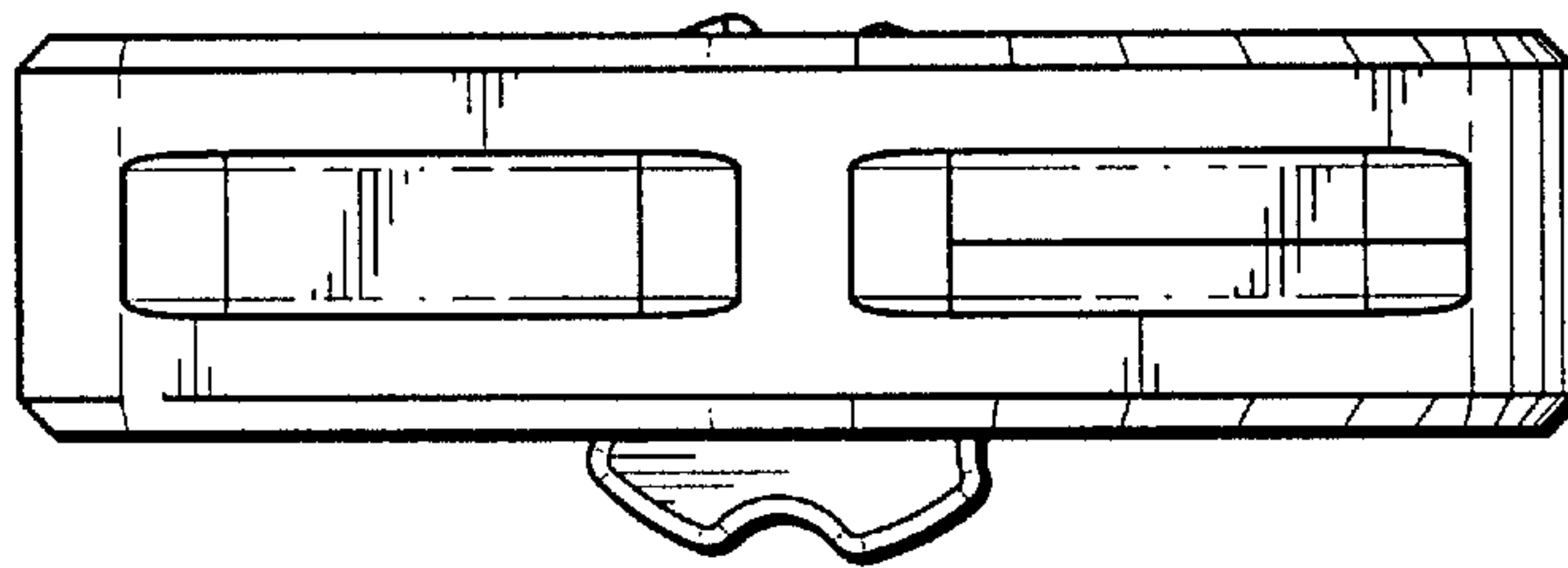

FIG. 5

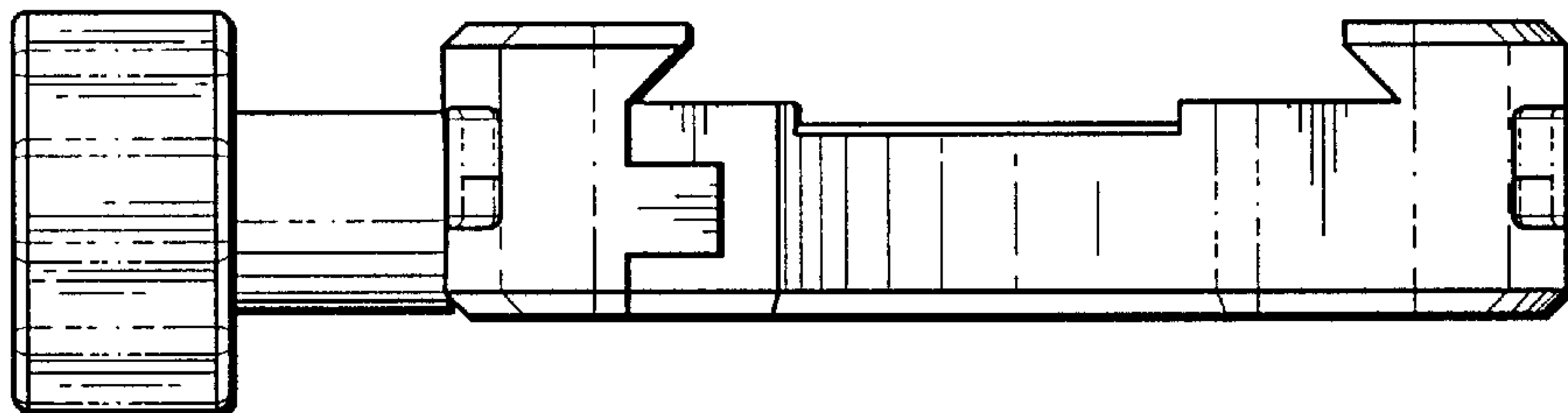

FIG. 6

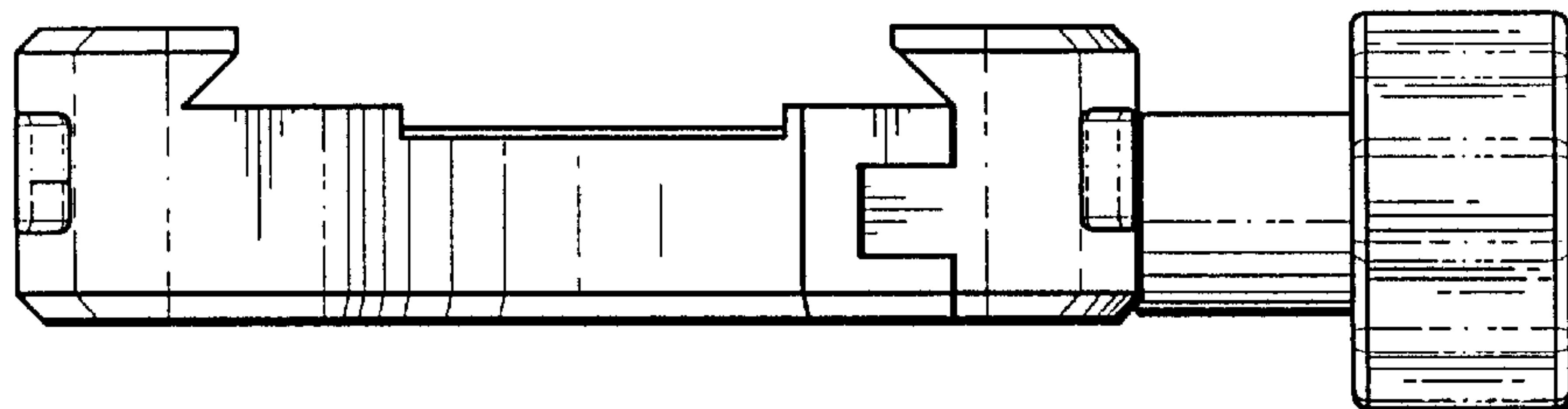

FIG. 7

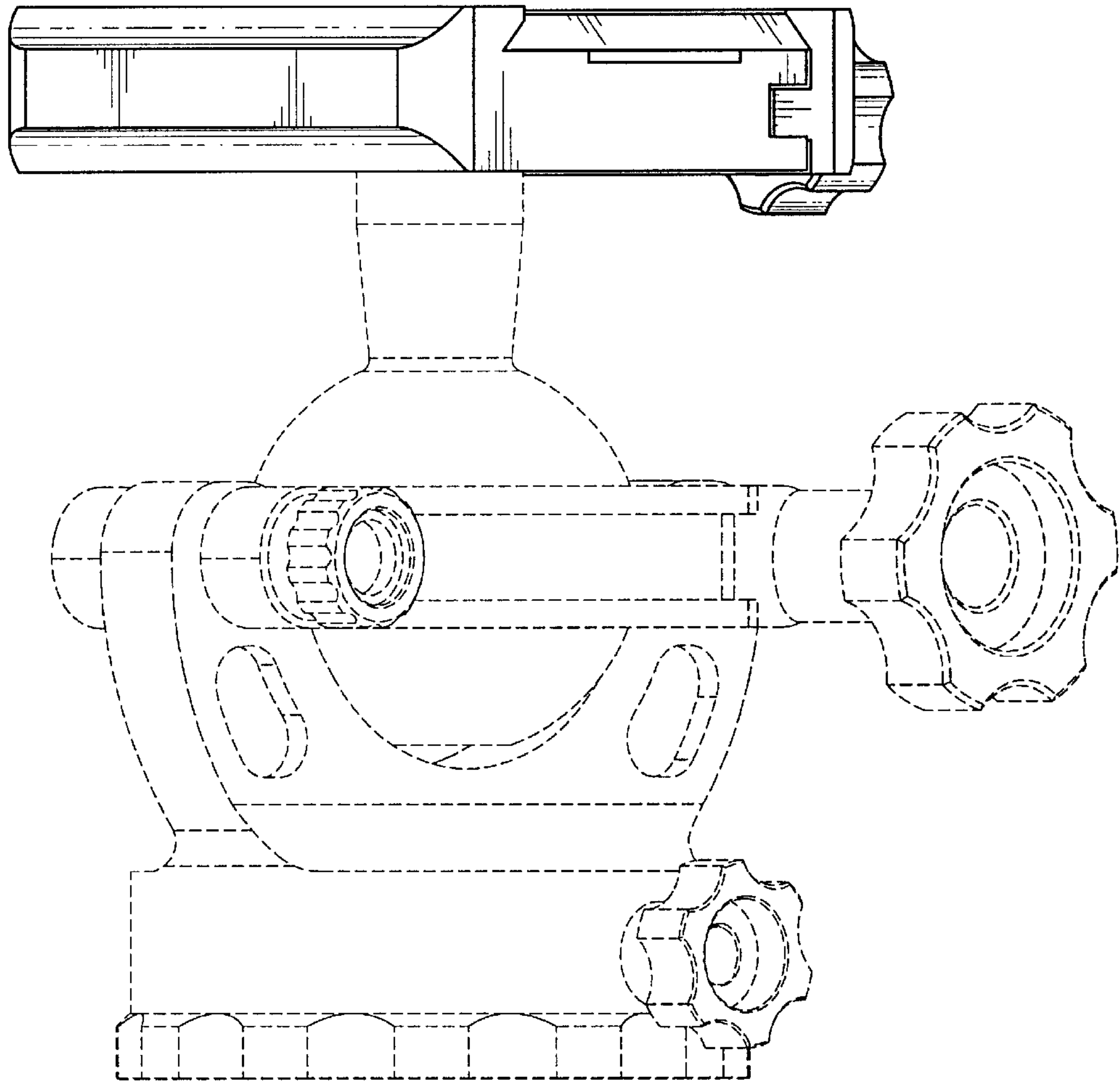

FIG. 8