



US00D483623S

(12) **United States Design Patent**  
**West**

(10) **Patent No.:** **US D483,623 S**

(45) **Date of Patent:** **\*\* Dec. 16, 2003**

(54) **NAPKIN CABINET**

(76) **Inventor:** **Hervel Emmanuel West**, 17160 SW.  
94th Ave., #604, Miami, FL (US) 33157

(\*\*) **Term:** **14 Years**

(21) **Appl. No.:** **29/159,397**

(22) **Filed:** **Sep. 12, 2002**

(51) **LOC (7) Cl.** ..... **07-06**

(52) **U.S. Cl.** ..... **D7/631**

(58) **Field of Search** ..... D7/631, 632; D6/512,  
D6/515, 518, 522; 211/49.1, 50; 221/33-63;  
312/50, 60, 61

(56) **References Cited**

**U.S. PATENT DOCUMENTS**

D92,455 S	*	6/1934	Coles	.....	D7/631
1,974,926 A		9/1934	Marsh	.....	206/44
2,323,395 A		7/1943	Harwood	.....	206/57
2,858,016 A		10/1958	Marano	.....	206/73
3,208,635 A	*	9/1965	Saxe	.....	221/36
3,765,565 A	*	10/1973	Fietzer et al.	.....	221/46
4,320,932 A	*	3/1982	Giffin	.....	211/49.1
4,623,074 A		11/1986	Dearwester	.....	221/48

4,768,679 A		9/1988	Matsui	.....	221/48
D414,085 S	*	9/1999	Campbell	.....	D7/631
D445,651 S	*	7/2001	Tramontina	.....	D7/631

\* cited by examiner

*Primary Examiner*—Terry A. Wallace

(74) *Attorney, Agent, or Firm*—Hervel E. West

(57) **CLAIM**

The ornamental design for a napkin cabinet, as shown and described.

**DESCRIPTION**

FIG. 1 is a perspective view of the napkin cabinet showing my new design;

FIG. 2 is a top plan view thereof;

FIG. 3 is a bottom plan view thereof;

FIG. 4 is a front elevation view thereof;

FIG. 5 is a rear elevation view thereof;

FIG. 6 is a right side elevation view thereof, the left side being a mirror image;

FIG. 7 is a front elevation view thereof without the door; and,

FIG. 8 is a perspective view there of with the door open.

**1 Claim, 5 Drawing Sheets**

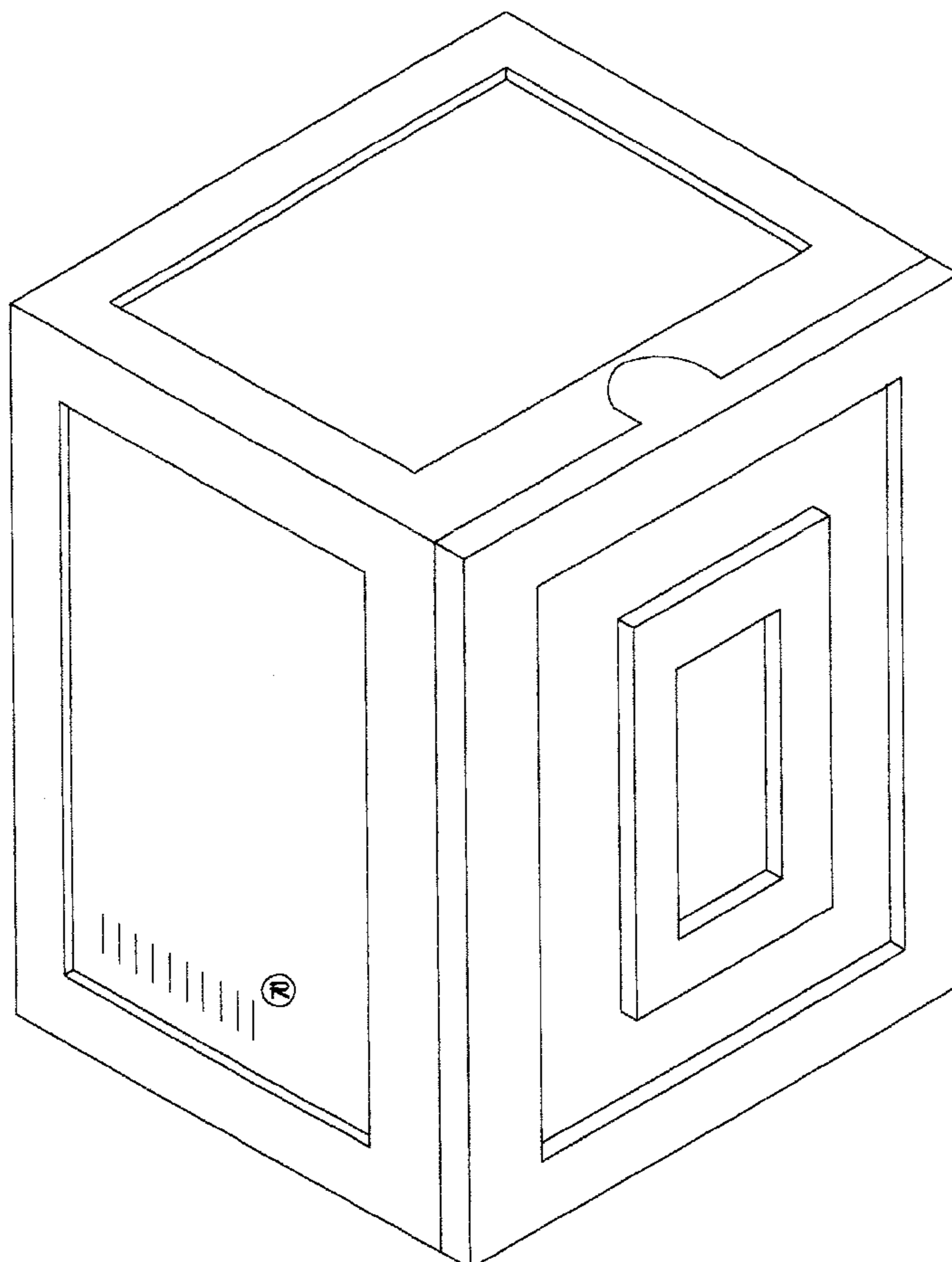

FIG. 1

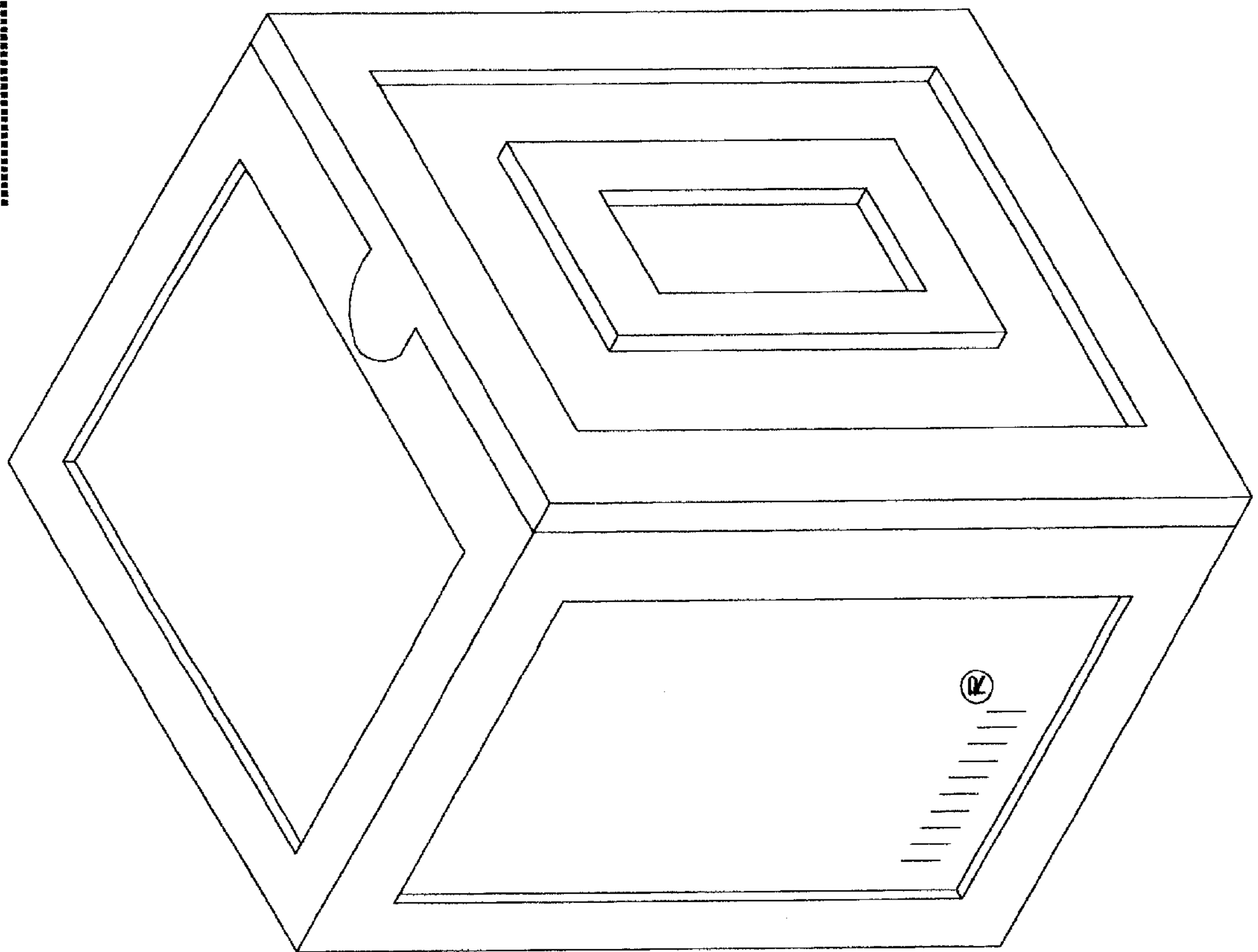

FIG. 3

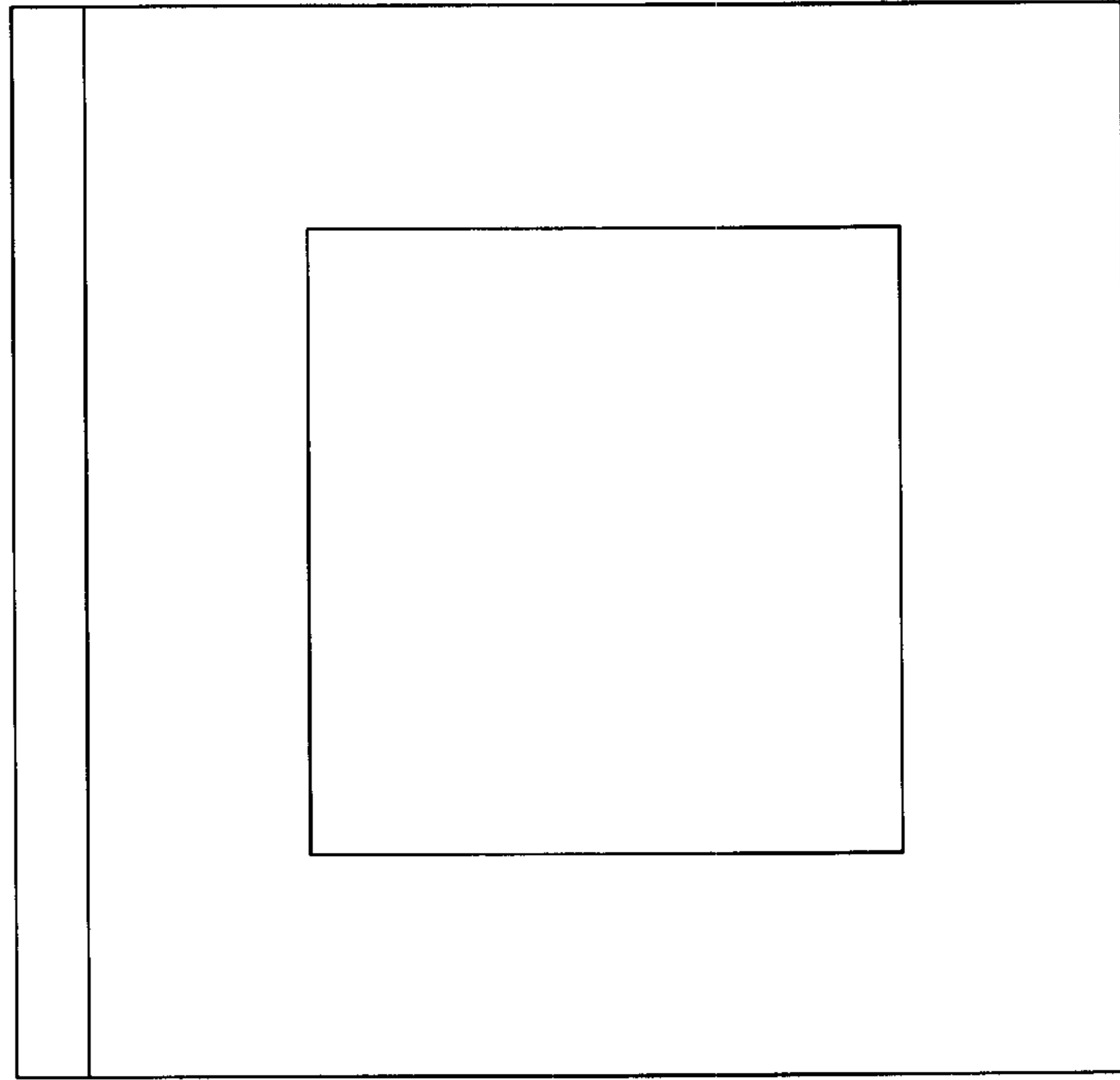
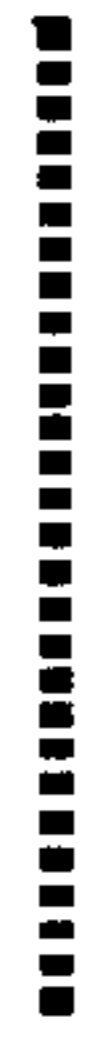

FIG. 2

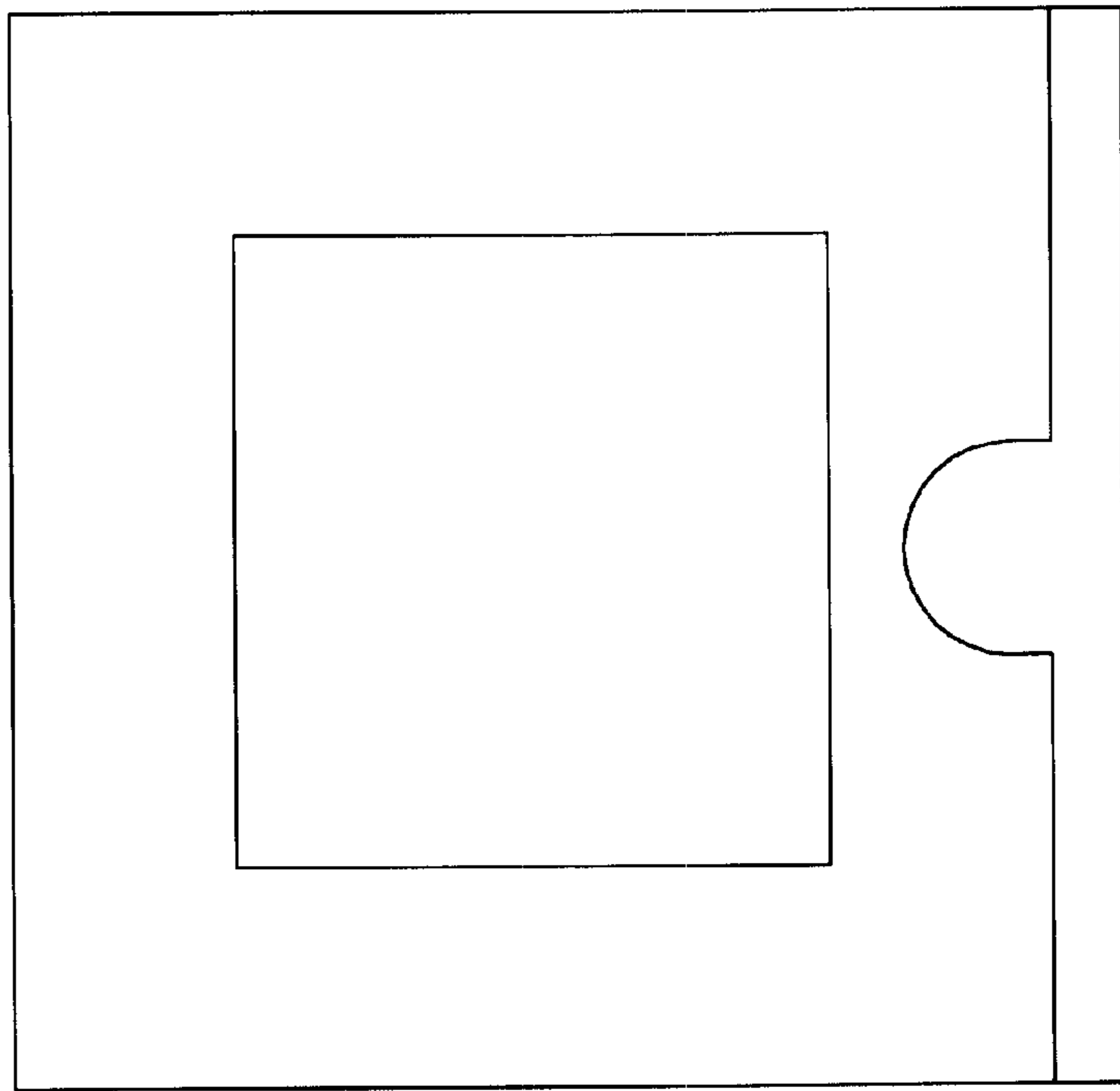

FIG. 5

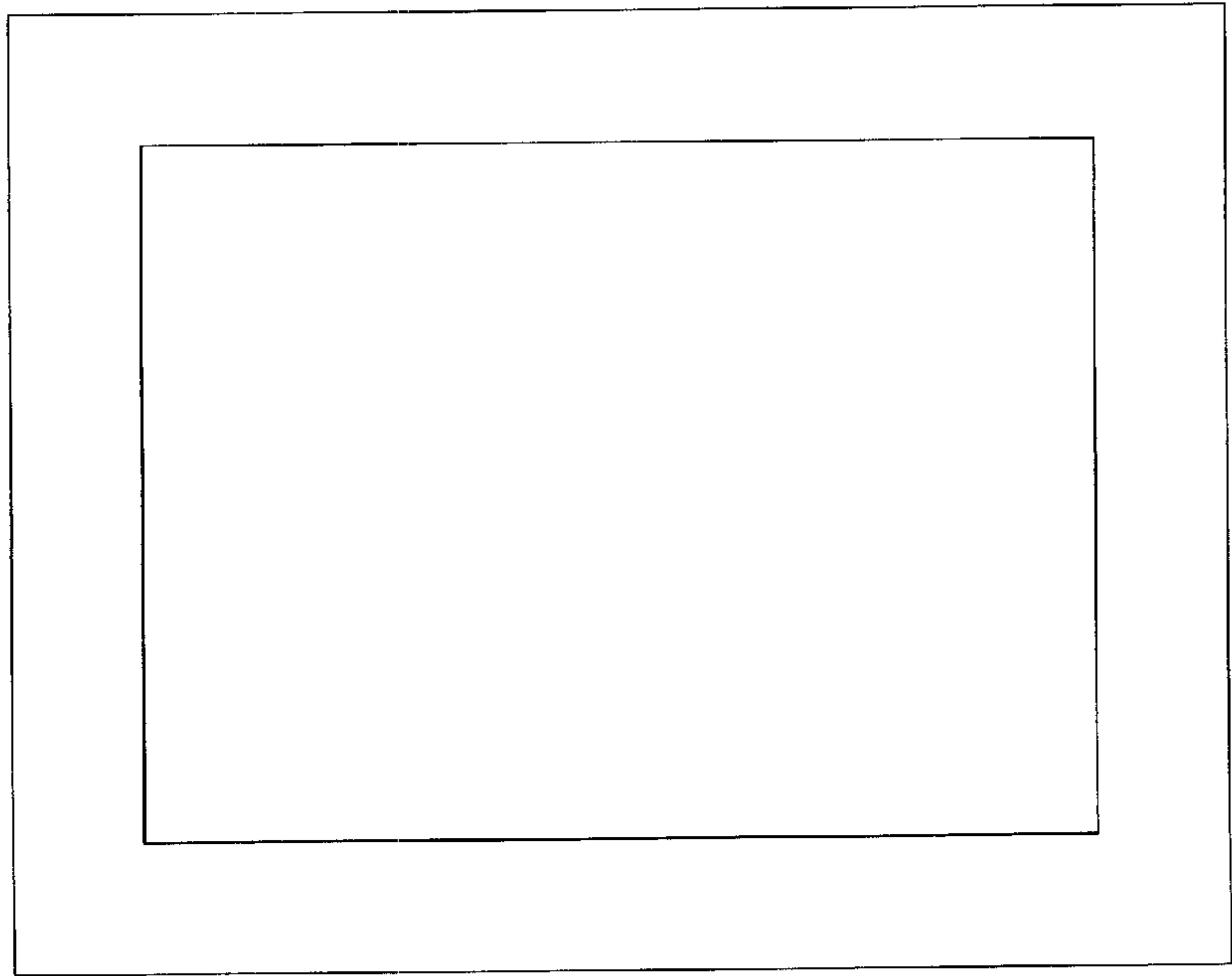

FIG. 4

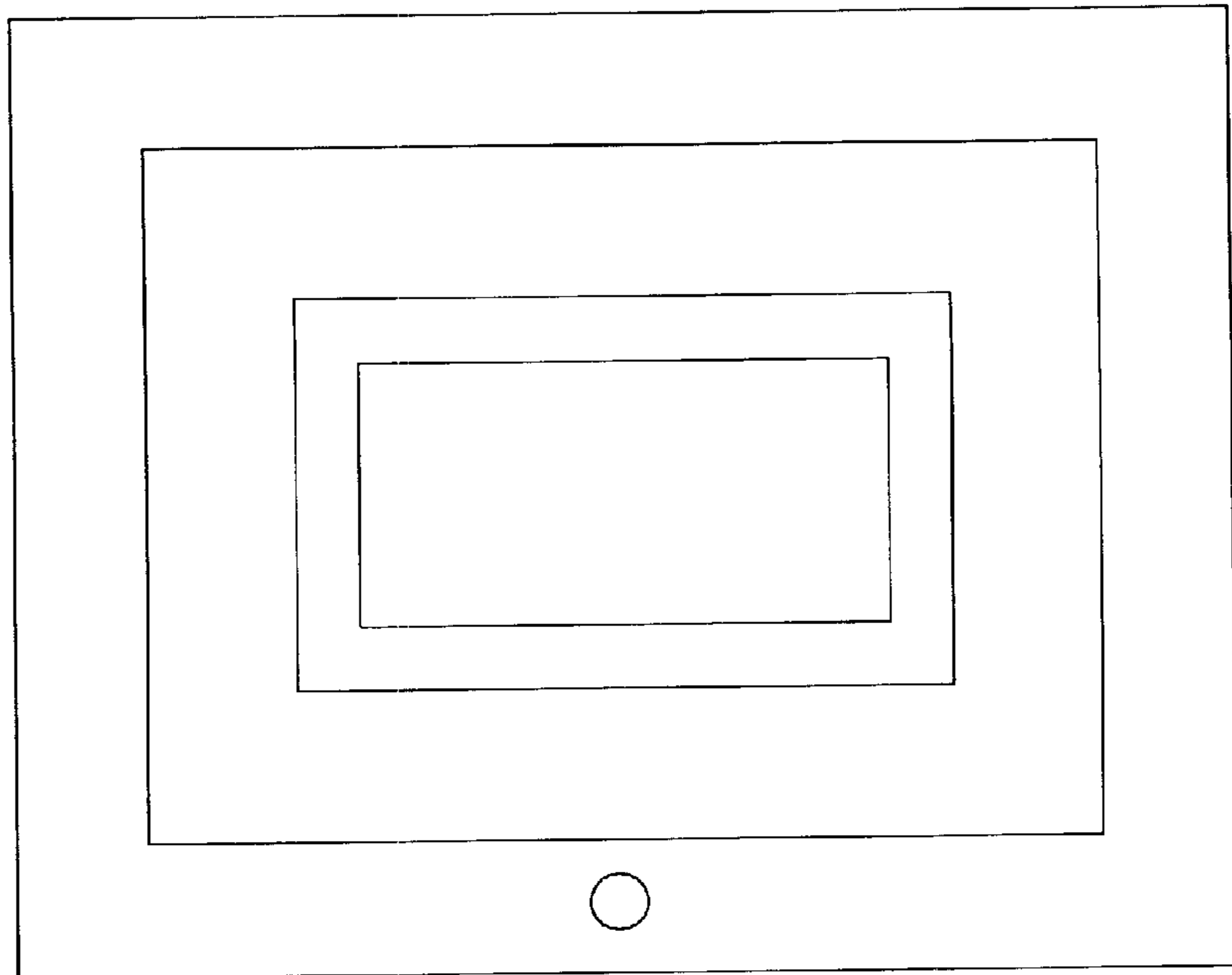

FIG. 7

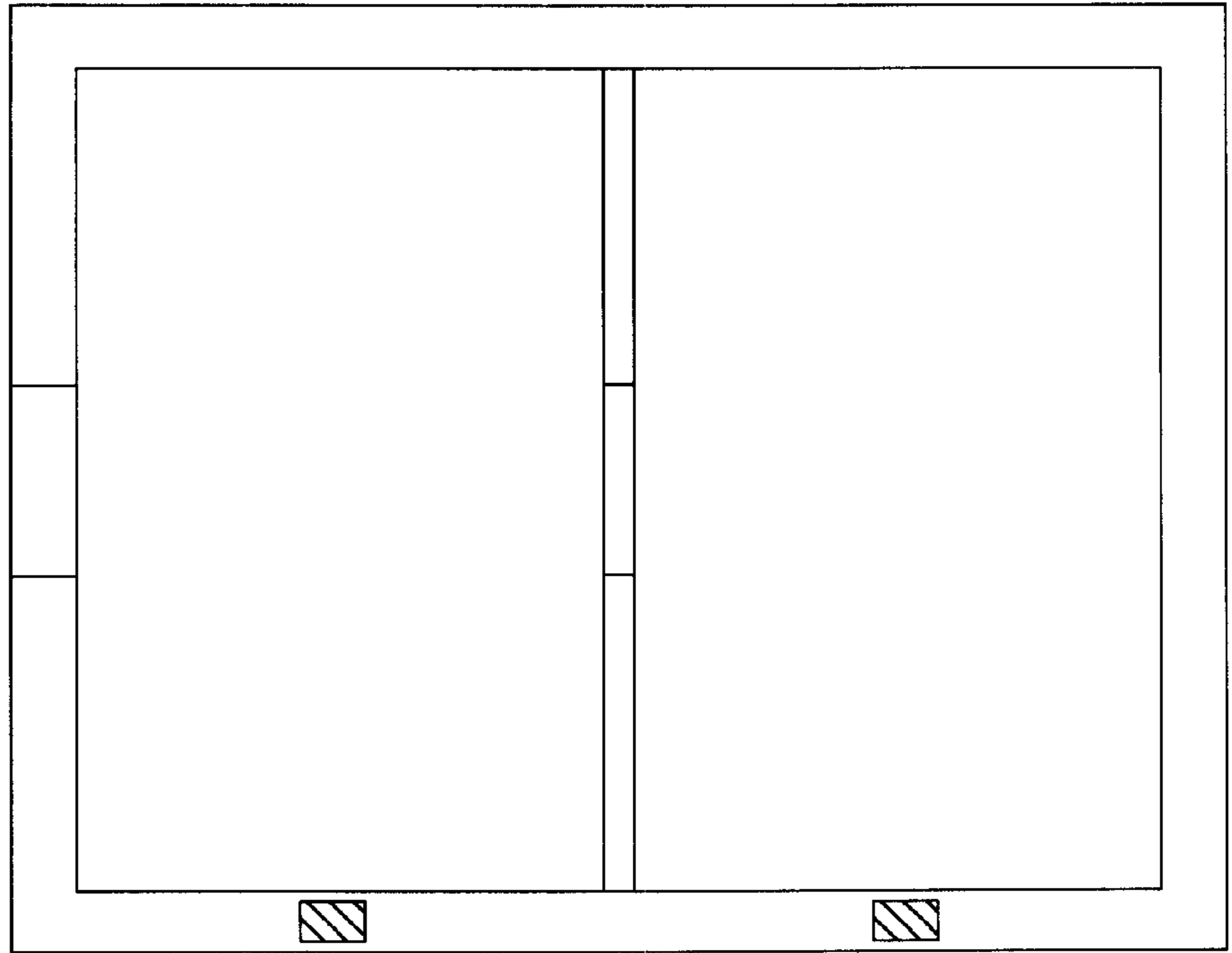

FIG. 6

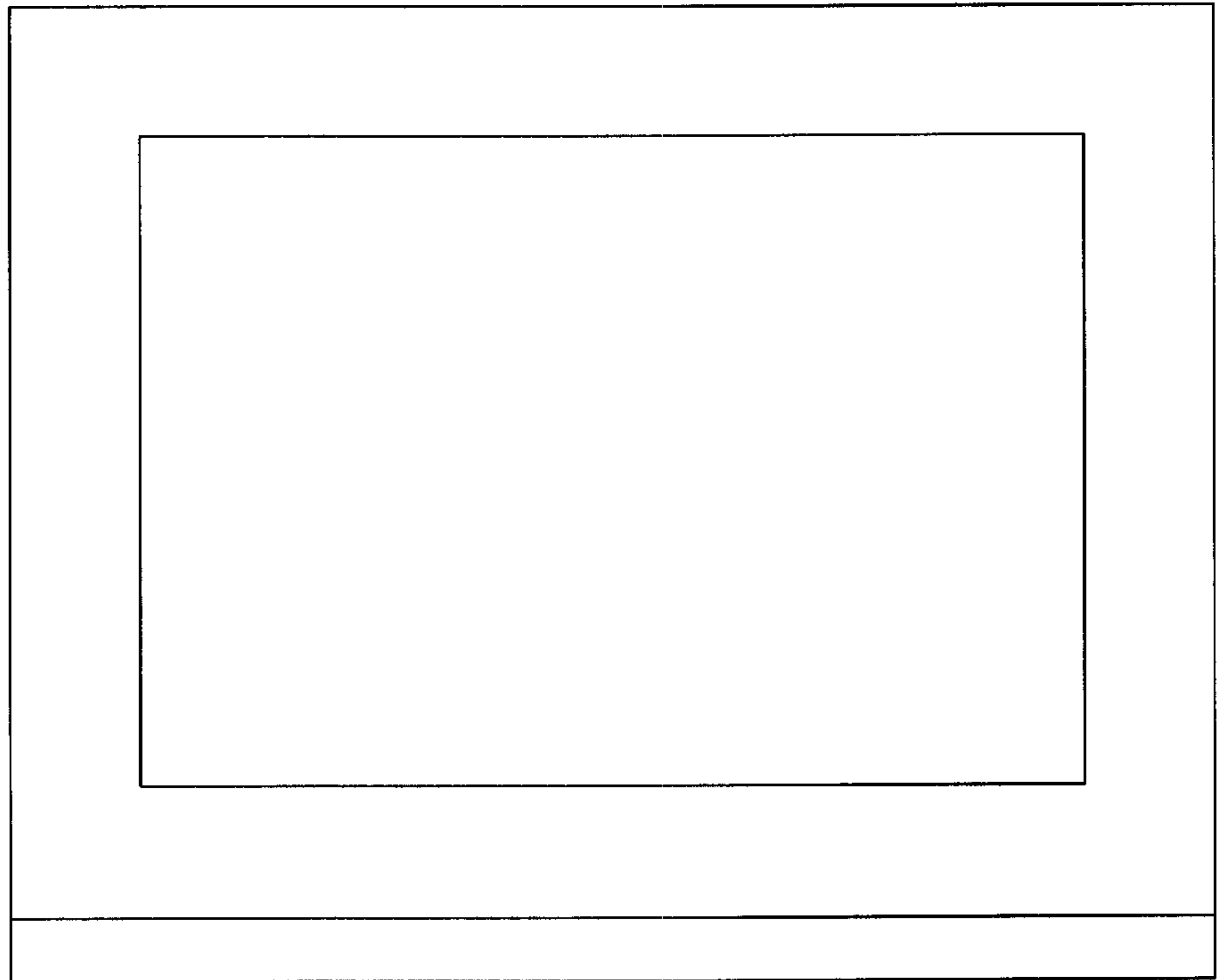

FIG. 8

