



US00D483428S

(12) **United States Design Patent**
Frey et al.

(10) **Patent No.: US D483,428 S**

(45) **Date of Patent: ** Dec. 9, 2003**

(54) **RIDING SURFACE OF AN ACTION SPORT RAMP**

(76) Inventors: **Wendy Frey**, R.R. #3, Box 466A, Watontown, PA (US) 17777; **Craig Mellott**, 121 Sassafras St., Beavertown, PA (US) 17813; **Dale Miller**, 73 Dogwood La., Lewisburg, PA (US) 17837; **Kevin Owens**, 28 S. 8th St., Lewisburg, PA (US) 17837; **Eric Tritsch**, 103 Two Steeples La., P.O. Box 192, Spring Mills, PA (US) 16875

(**) Term: **14 Years**

(21) Appl. No.: **29/163,361**

(22) Filed: **Jul. 3, 2002**

(51) **LOC (7) Cl. 21-03**

(52) **U.S. Cl. D21/817**

(58) **Field of Search D21/318, 385, D21/811, 814, 322, 817; 482/35, 36; 472/91; 405/22, 52, 79**

(56) **References Cited**

U.S. PATENT DOCUMENTS

D246,638 S	12/1977	Hegedus	D12/53
D257,874 S	1/1981	Sheehan et al.	D21/244
4,423,864 A	*	1/1984	Wiik 472/91
4,662,781 A	*	5/1987	Tinkler 405/52
D353,930 S	12/1994	Johnson	D34/32
D390,621 S	2/1998	Cosentino	D21/240
D414,526 S	*	9/1999	Kashani D21/385
5,946,756 A	9/1999	Mapp	14/69.5
6,042,480 A	3/2000	Labelson	472/89

OTHER PUBLICATIONS

Website page: <http://www.smackfu.com/photos/gravity-games/DSCF1365.JPG.html>, discovered on or around Jan. 17, 2002, printed Jun. 19, 2002.

Photograph from formerly active website: <http://www.richlite.com/skate/pic.cfm?pic=newpicbig>, accessed on or around Jan. 17, 2002.

Photographs from website: www.woodwardcamp.com, accessed Jun. 19, 2002.

* cited by examiner

Primary Examiner—Mitchell Siegel

(57) **CLAIM**

The ornamental design for a riding surface of an action sport ramp, as shown and described.

DESCRIPTION

FIG. 1 is an isometric view of the design of a riding surface of an action sport ramp as applied to a quarter pipe ramp. The design shows a riding surface having an outer border and two panels separated by an intermediate band.

FIG. 2 is a side elevation view of the riding surface of an action sport ramp shown in FIG. 1, it being understood that the opposite side is substantially a mirror image of the side shown herein.

FIG. 3 is a top plan view of the riding surface of an action sport ramp shown in FIG. 1.

FIG. 4 is an isometric view of the same embodiment of the riding surface of an action sport ramp embodying the design as applied to a spine ramp.

FIG. 5 is a side elevation view of the riding surface of an action sport ramp shown in FIG. 4, it being understood that the opposite side is substantially a mirror image of the side shown herein; and,

FIG. 6 is a top plan view of the riding surface of an action sport ramp shown in FIG. 4.

The bottom and back side of the action sport ramps neither shown in the drawings nor described in the specification form no part of the claimed design.

1 Claim, 4 Drawing Sheets

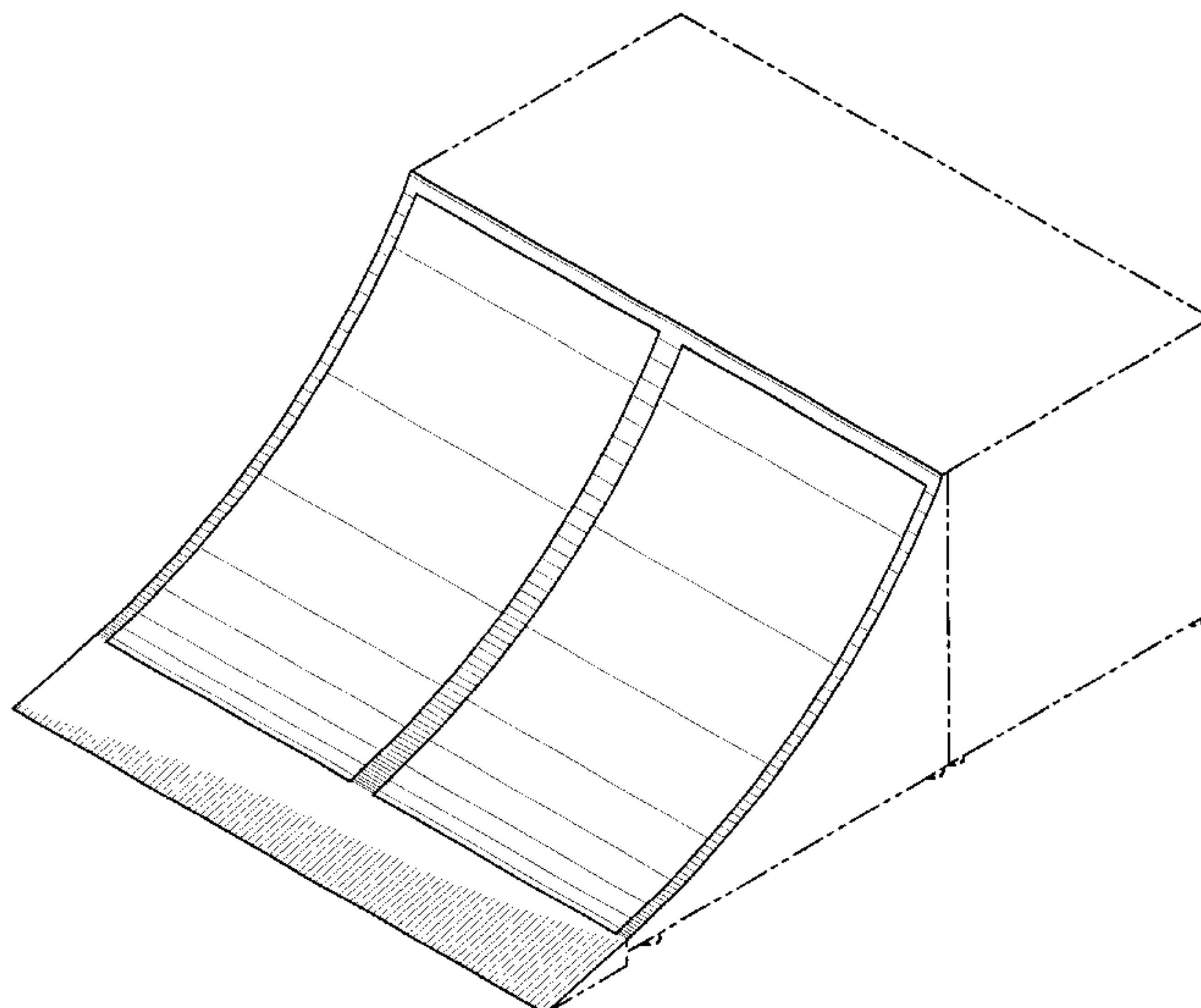

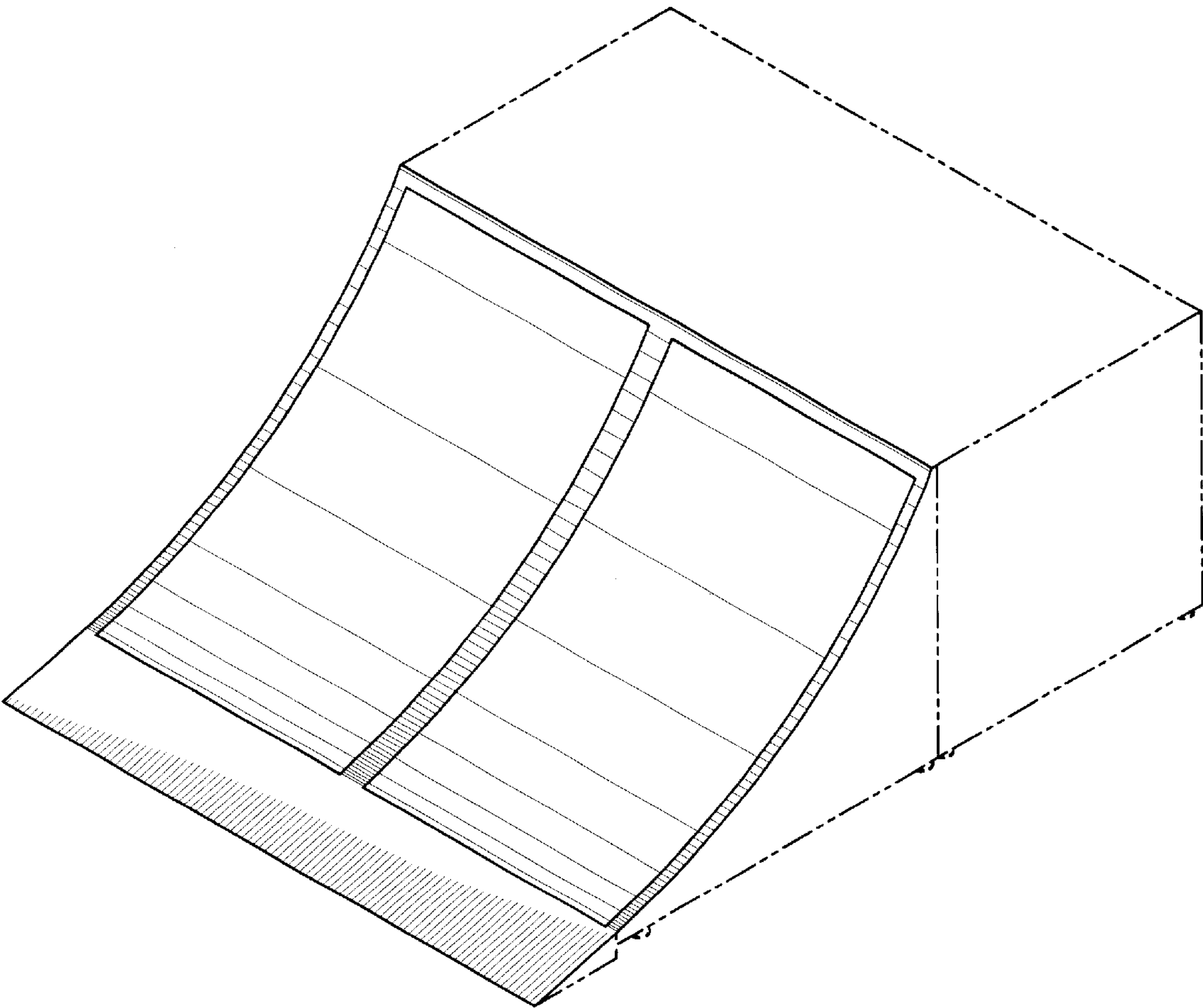

FIG. 1

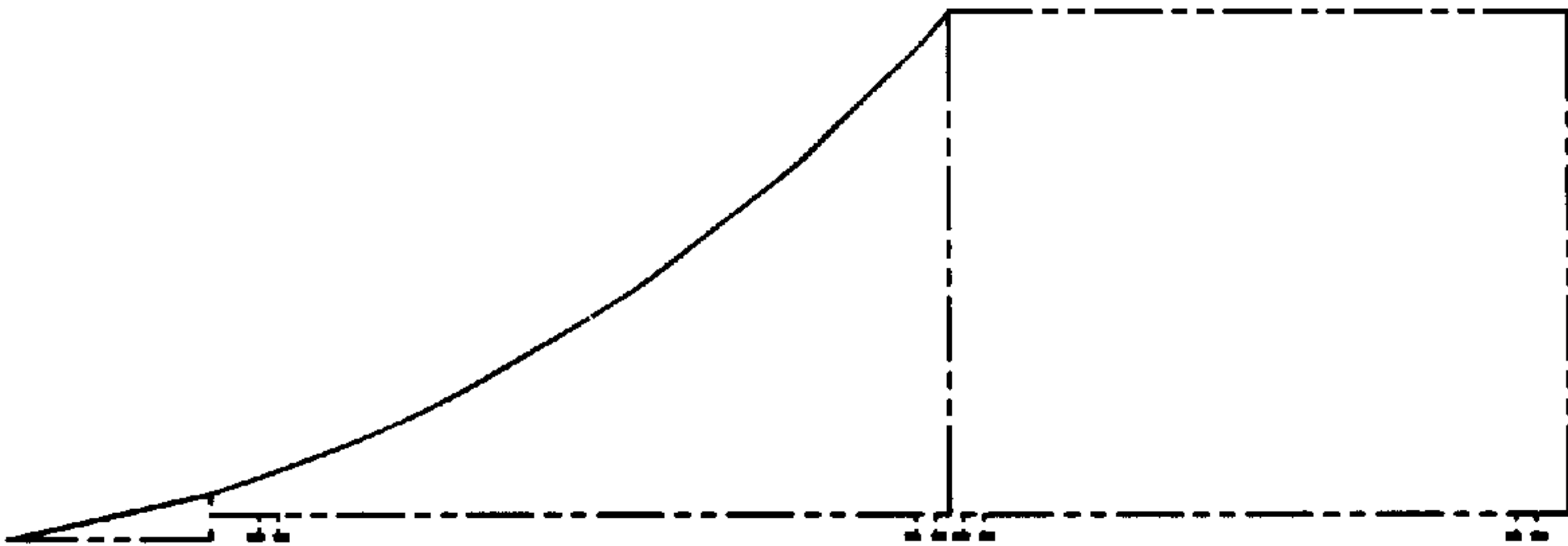

FIG. 2

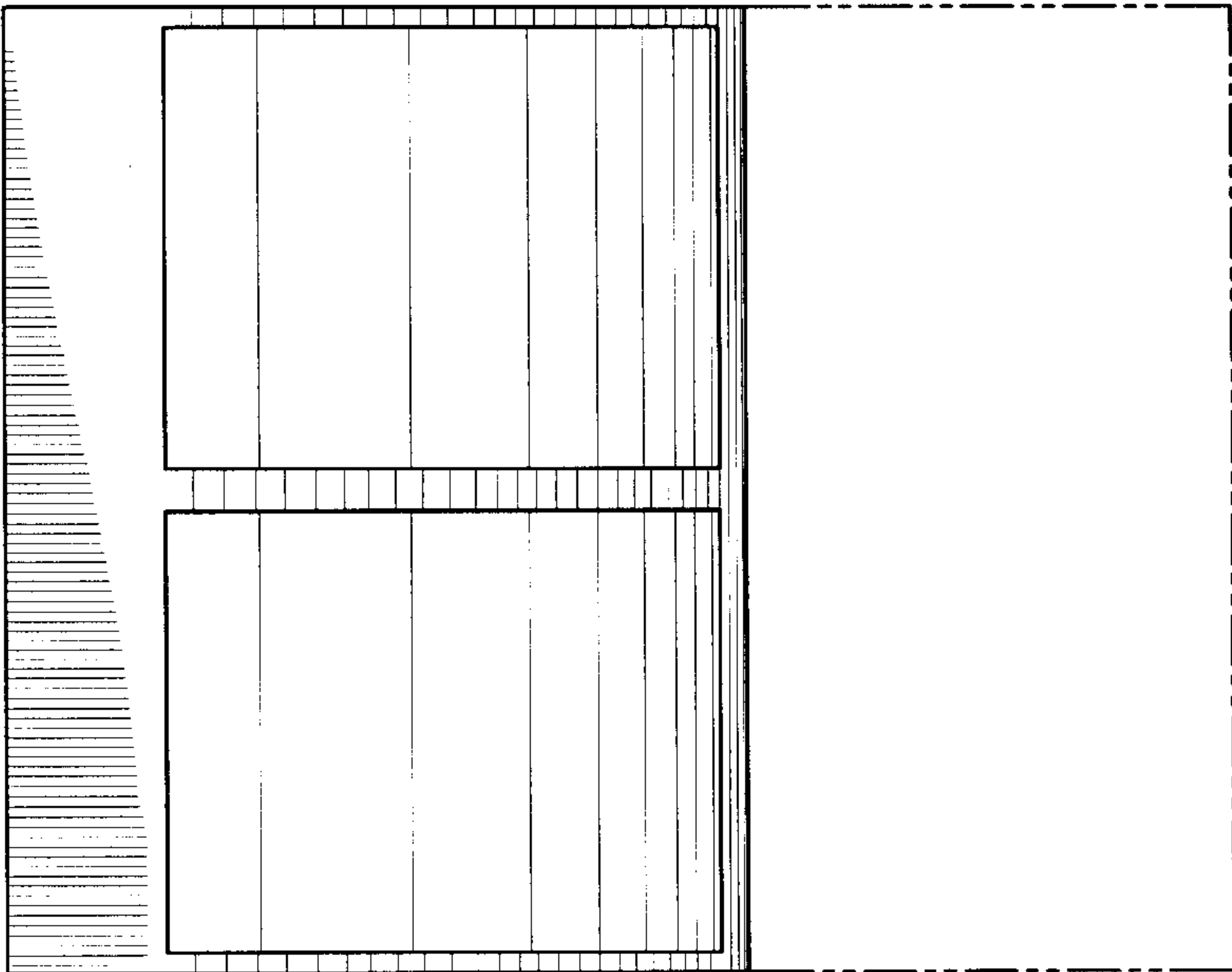

FIG. 3

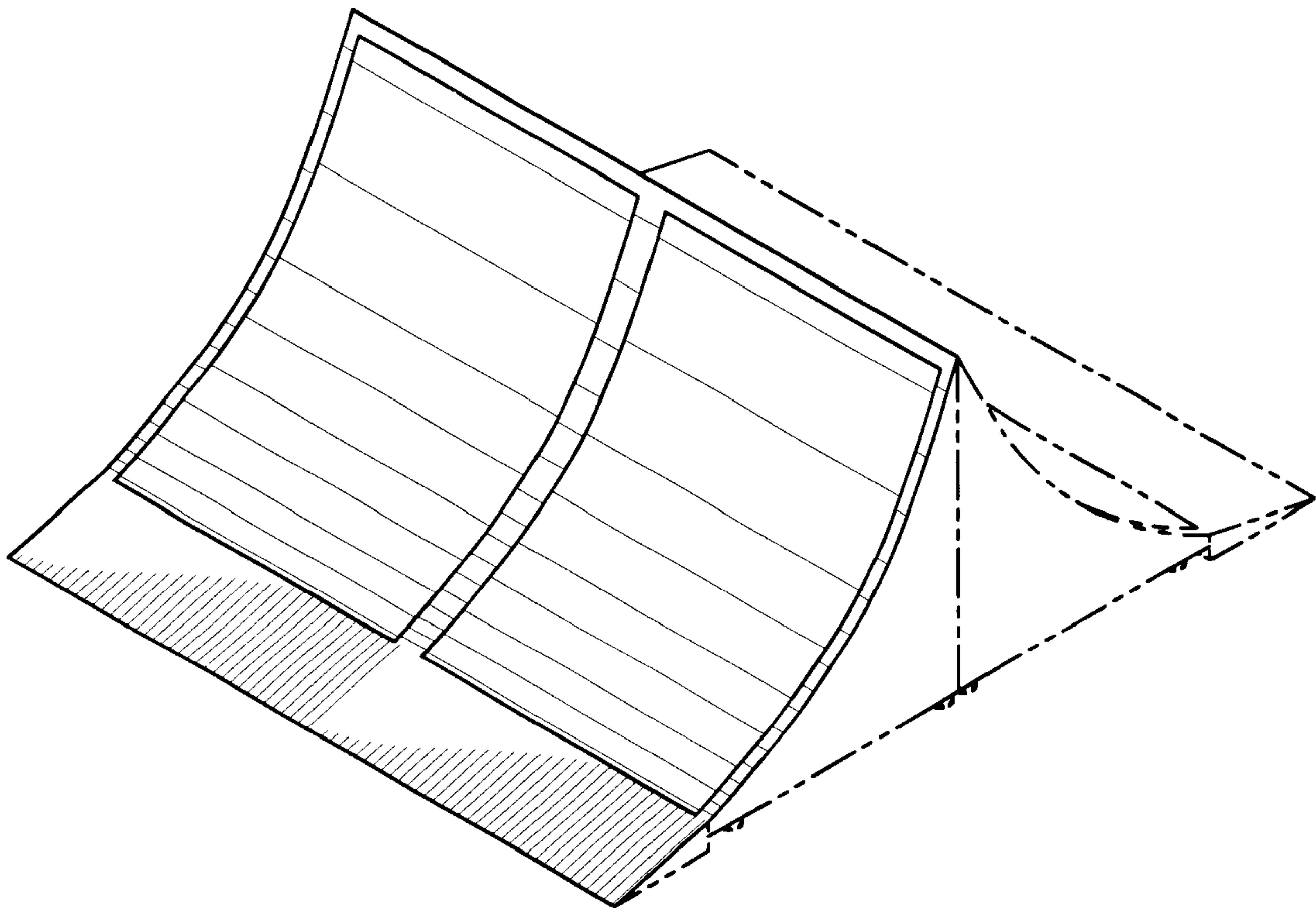

FIG. 4

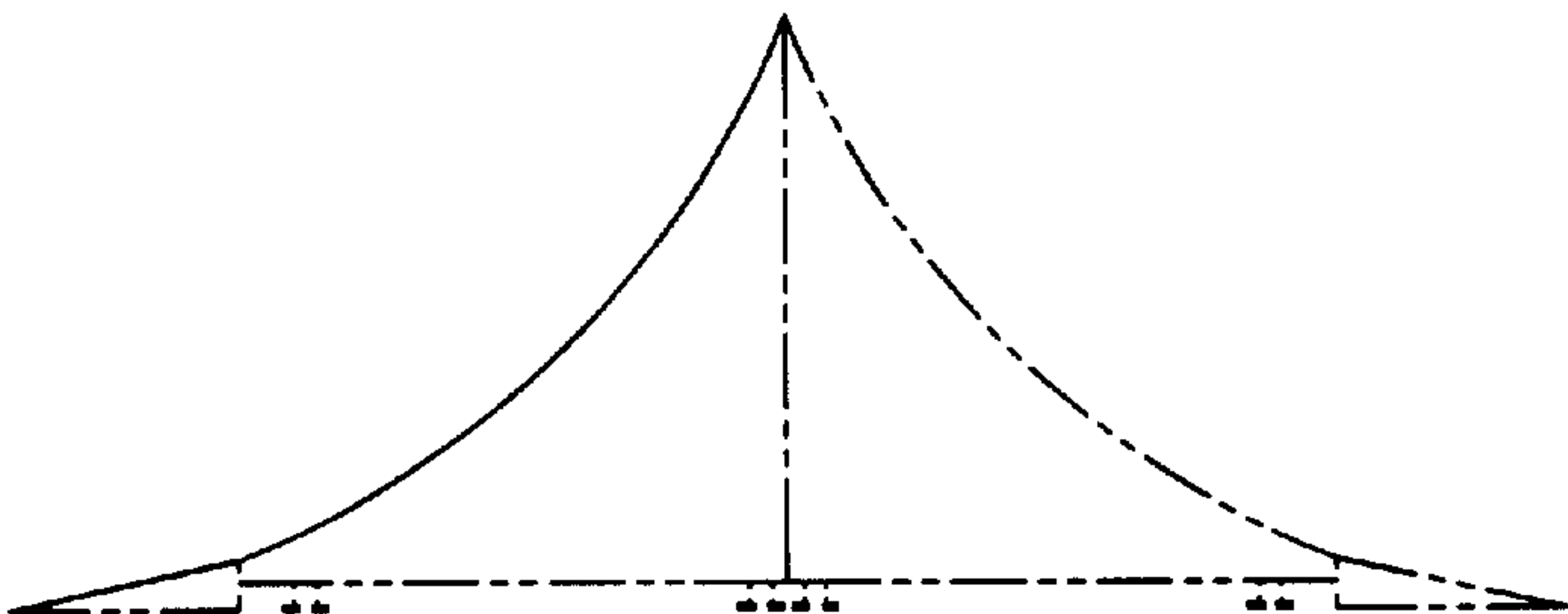

FIG. 5

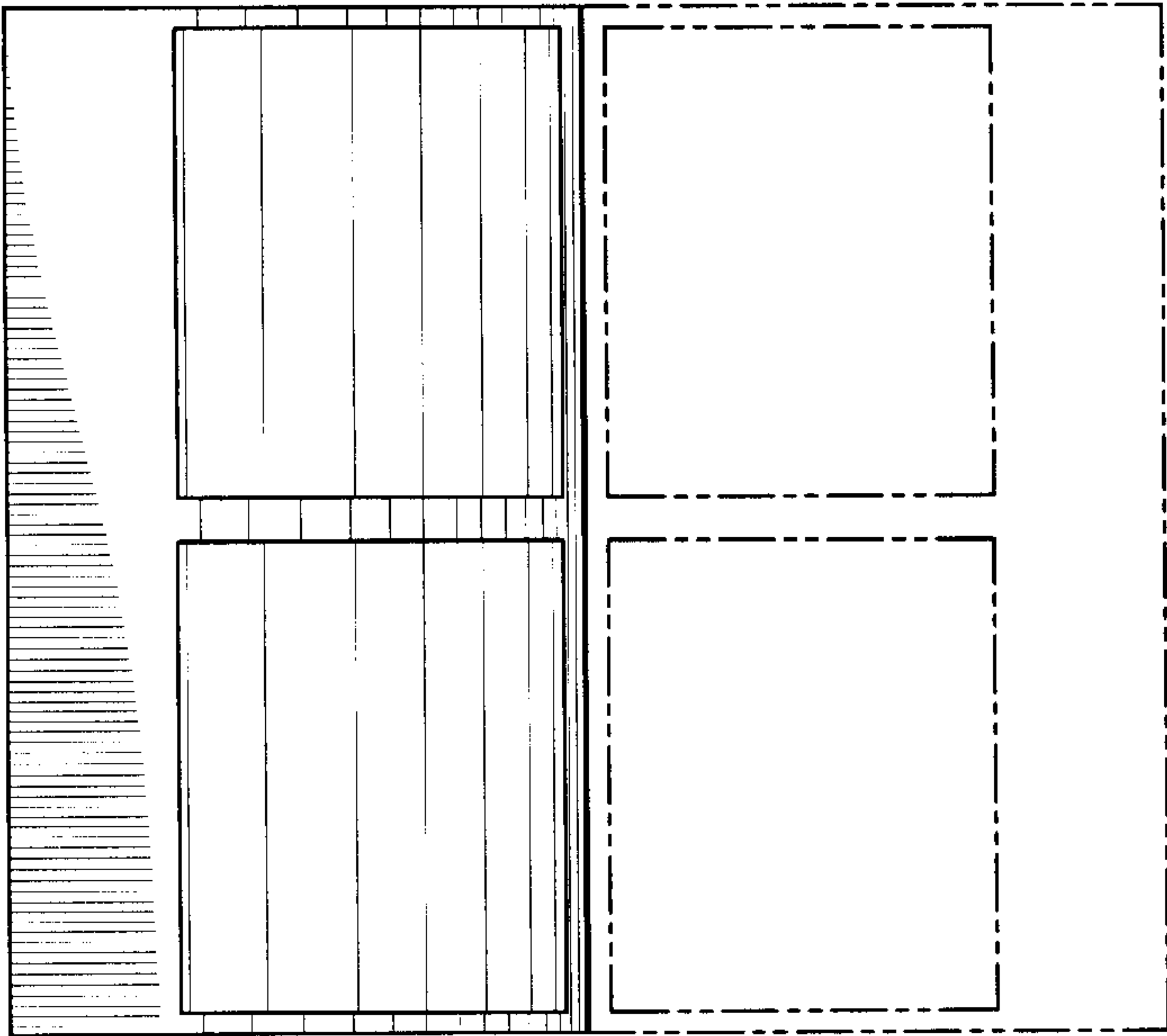

FIG. 6