



US00D482958S

(12) **United States Design Patent**
Damour

(10) **Patent No.:** **US D482,958 S**

(45) **Date of Patent:** **** Dec. 2, 2003**

(54) **SUPPORT LINE CLAMP FOR BOAT ACCESSORIES**

D430,007 S 8/2000 Damour

* cited by examiner

(76) **Inventor:** **Lawrence R. Damour**, 1212 Turtzo Blvd., Bangor, PA (US) 18013

Primary Examiner—Holly Baynham
(74) *Attorney, Agent, or Firm*—Patrick J. Pinto

(**) **Term:** **14 Years**

(57) **CLAIM**

(21) **Appl. No.:** **29/173,619**

The ornamental design for a support line clamp for boat accessories, as shown and described.

(22) **Filed:** **Jan. 2, 2003**

DESCRIPTION

(51) **LOC (7) Cl.** **08-08**

(52) **U.S. Cl.** **D8/387**

(58) **Field of Search** D8/387; 114/230.23; 403/110; 411/378-379, 387.4, 389, 397

FIG. 1 is a front view of a support line clamp for boat accessories, showing my new design;

FIG. 2 is a right side thereof, the left side view being a mirror image

FIG. 3 is a top view thereof, this view having one of a pair of threaded clamping nuts removed for clarity of the illustration, the bottom view being a mirror image thereof; and,

FIG. 4 is a right side view of FIG. 3 and showing an interior beveled face of each of the threaded clamping nuts.

(56) **References Cited**

U.S. PATENT DOCUMENTS

D217,458 S	*	5/1970	Ismert	D8/387
D335,077 S	*	4/1993	Haney	D8/387
D414,403 S	*	9/1999	Coven	D8/387

1 Claim, 1 Drawing Sheet

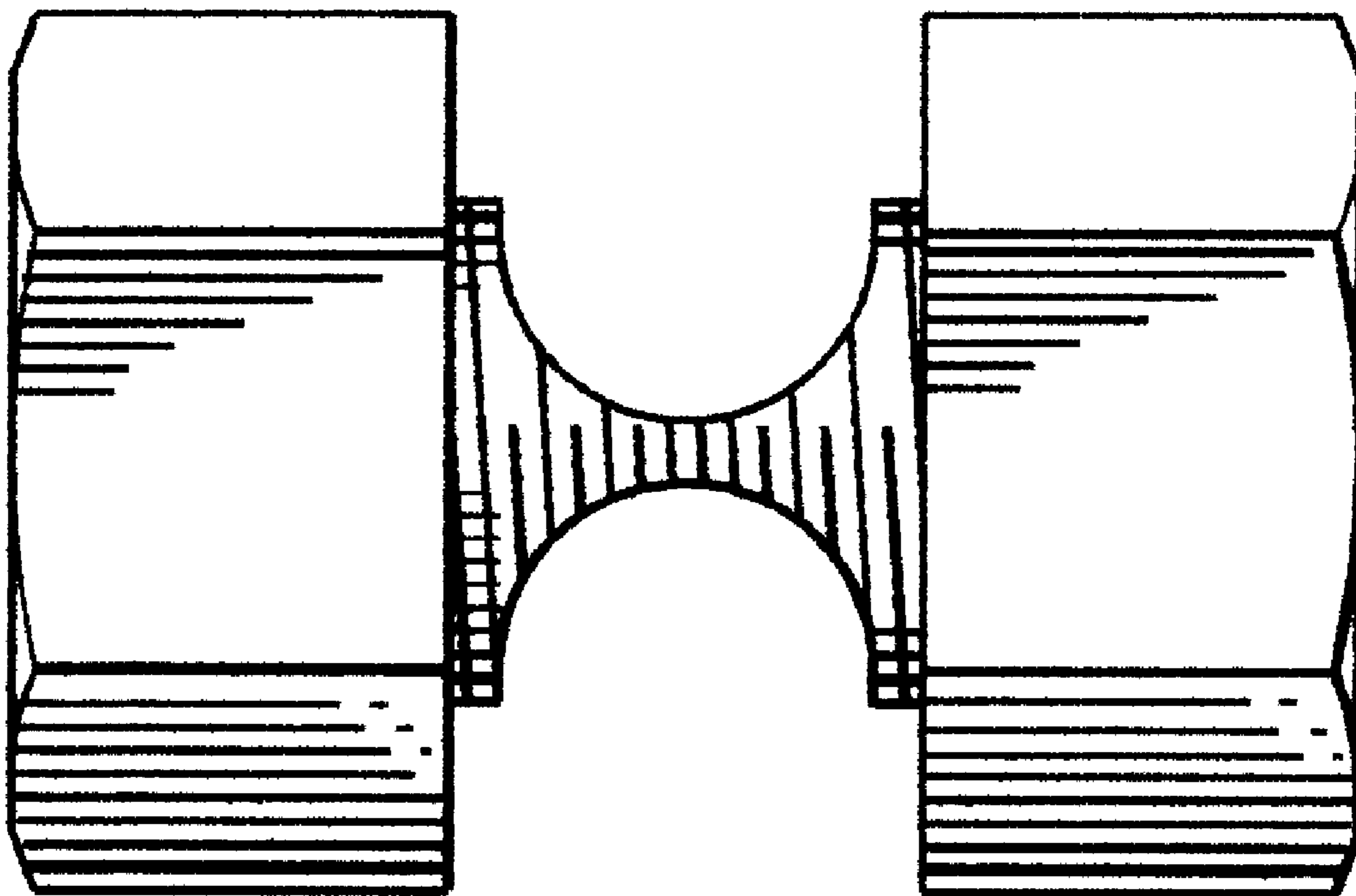

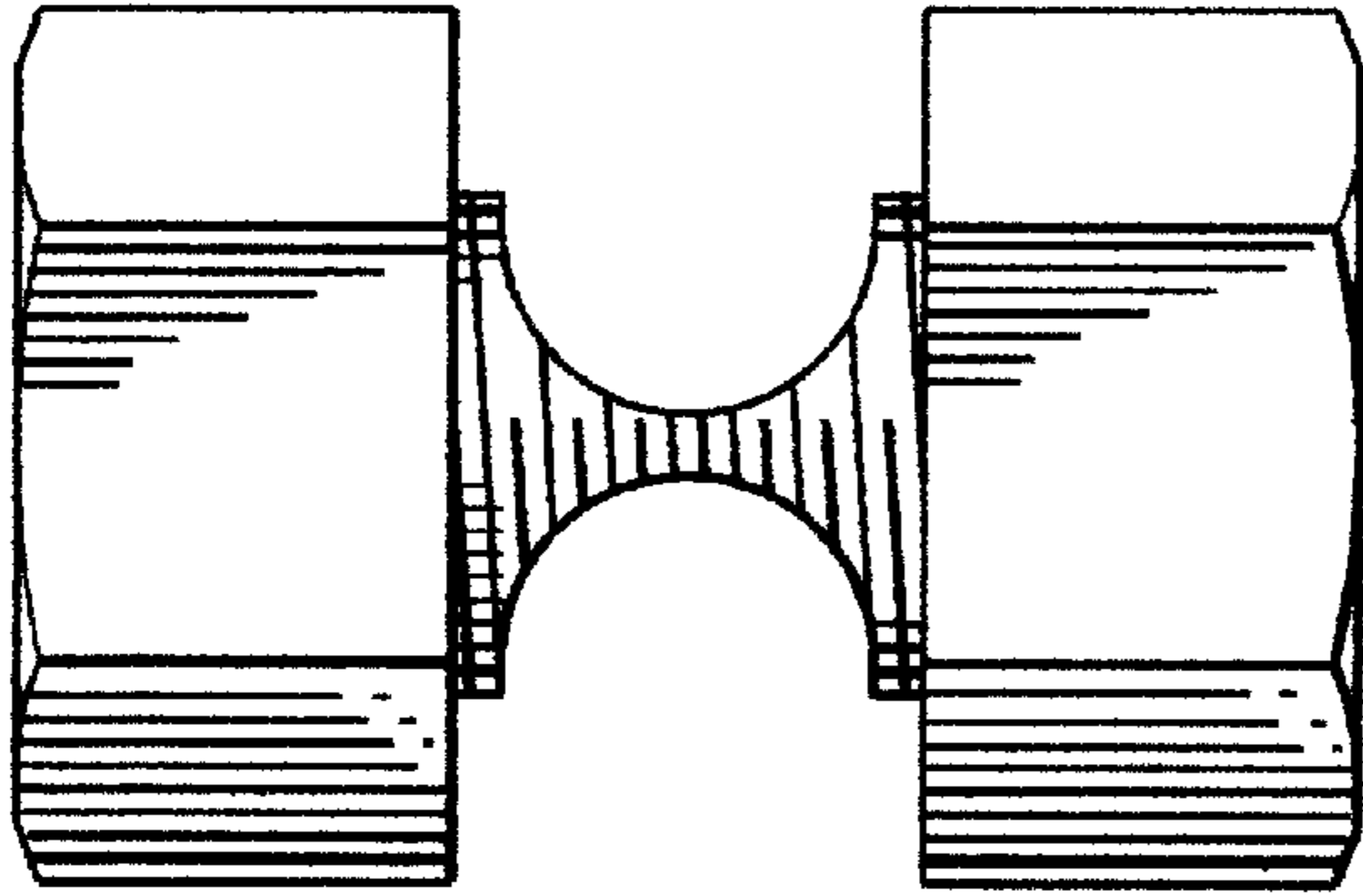

FIG. 1

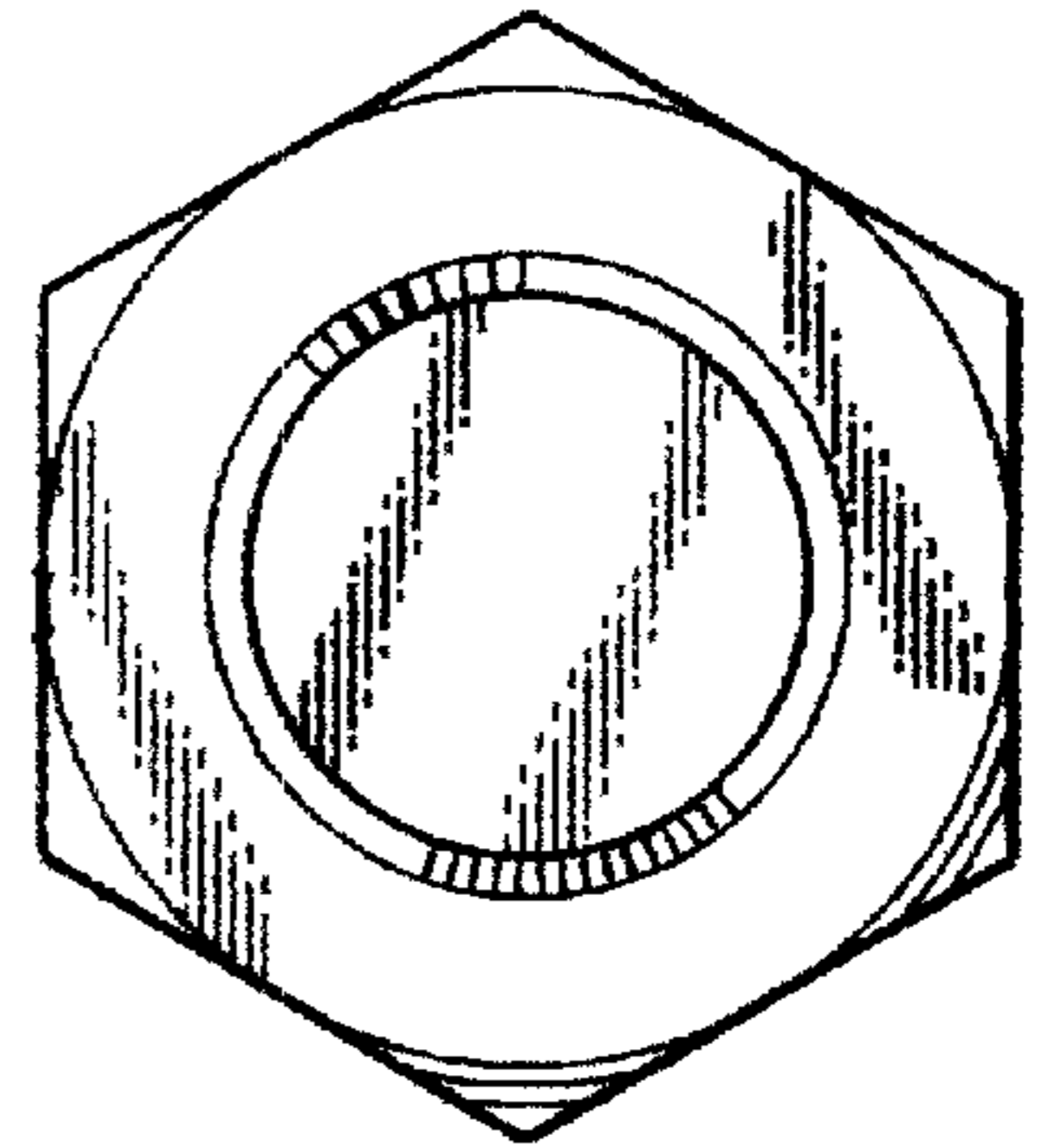

FIG. 2

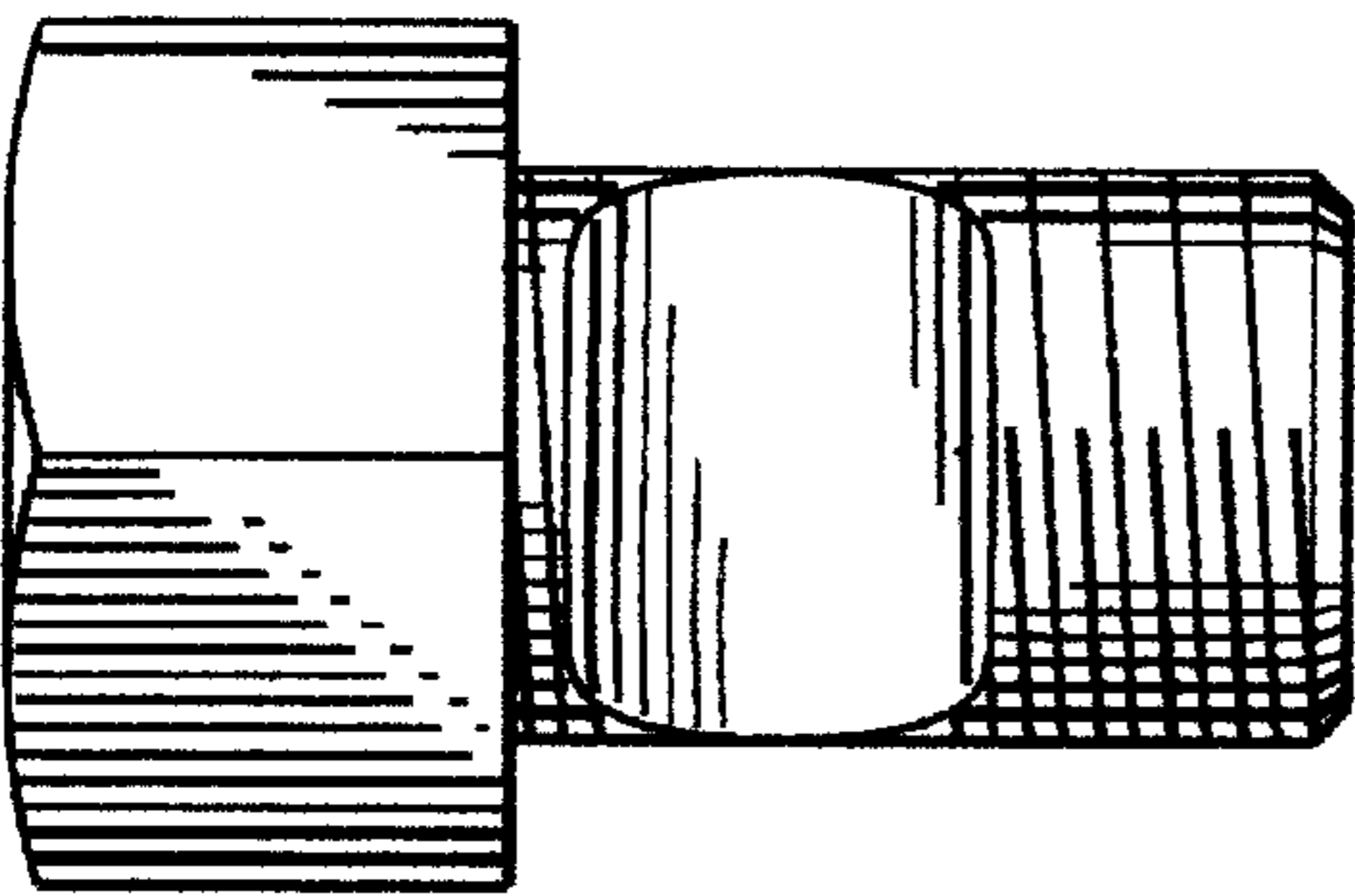

FIG. 3

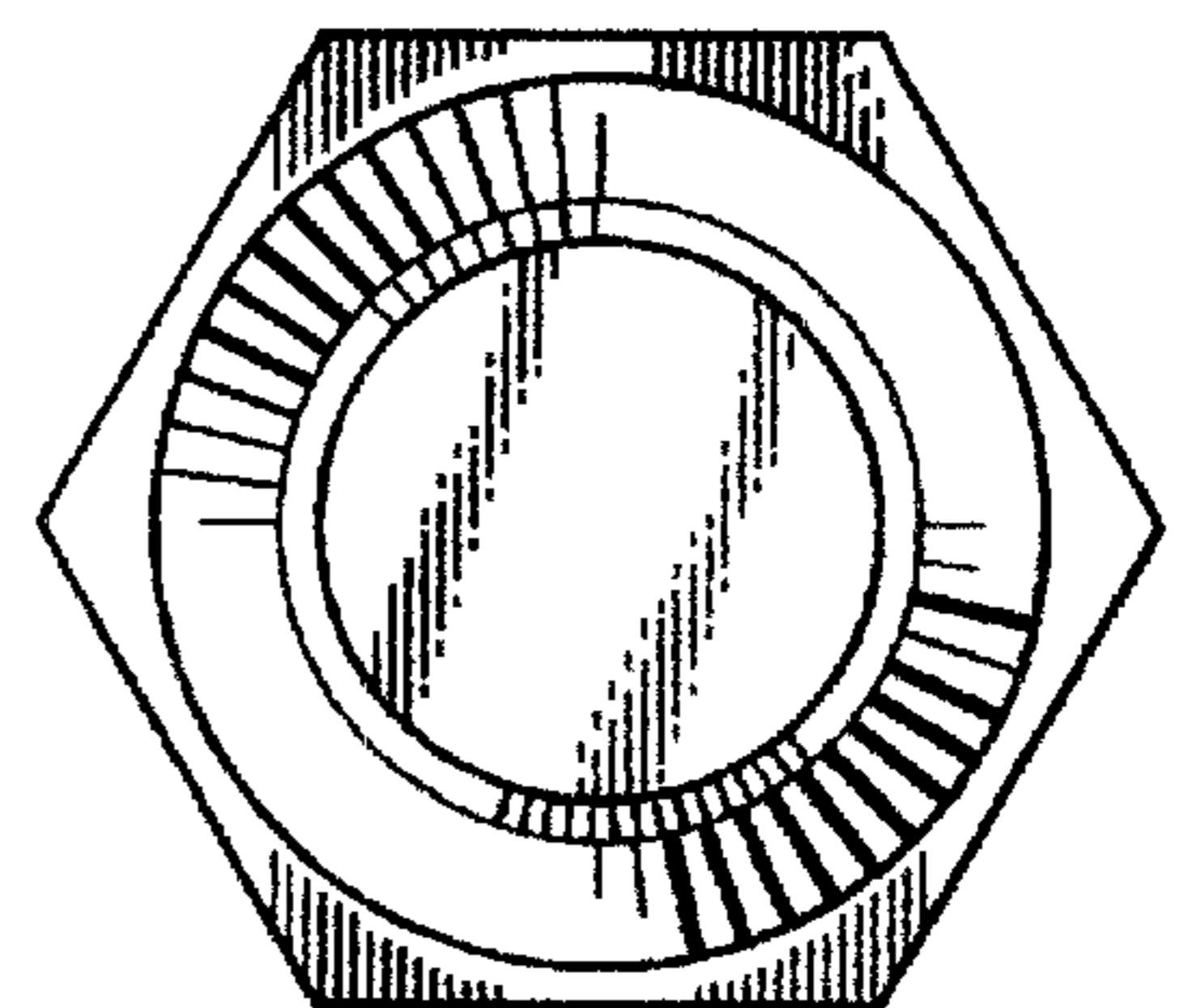

FIG. 4