



US00D481652S

(12) **United States Design Patent**
Kamysiak

(10) **Patent No.:** **US D481,652 S**

(45) **Date of Patent:** **** Nov. 4, 2003**

(54) **WREATH HOLDER WALL PROTECTOR**

(76) Inventor: **Jerry Kamysiak**, 9528 S. Bolton Rd.,
Posen, MI (US) 49776

(**) Term: **14 Years**

(21) Appl. No.: **29/161,244**

(22) Filed: **May 24, 2002**

(51) **LOC (7) Cl.** **11-05**

(52) **U.S. Cl.** **D11/130**

(58) **Field of Search** D11/120, 130;
D8/352, 379; D26/113, 138; 428/10

(56) **References Cited**

U.S. PATENT DOCUMENTS

1,518,618	A	*	12/1924	Waters, Jr.	428/10
2,761,233	A	*	9/1956	Brown	47/41.1
D340,672	S	*	10/1993	Adams	D11/120
D353,122	S	*	12/1994	Gilley et al.	D11/164
5,501,889	A	*	3/1996	Church	428/66.5
5,503,883	A	*	4/1996	Kell, et al.	428/10
D409,110	S	*	5/1999	Pool	D11/120

* cited by examiner

Primary Examiner—Dominic Simone

(74) *Attorney, Agent, or Firm*—Our Pal LLC; S. Pal Asija

(57) **CLAIM**

I claim the ornamental design for my wreath holder wall protector, as shown and described.

DESCRIPTION

FIG. 1 is an isometric perspective view of the wreath holder wall protector.

FIG. 2 is a front elevational view thereof;

FIG. 3 is a side elevational view thereof, the opposite side being a mirror image;

FIG. 4 is an enlarged cross-sectional view of the drip section as indicated in FIG. 3;

FIG. 5 is a rear elevational view thereof; and,

FIG. 6 is a front elevational view thereof, the wreath shown in broken lines for illustrative purposes only and forms no part of the claimed design.

1 Claim, 5 Drawing Sheets

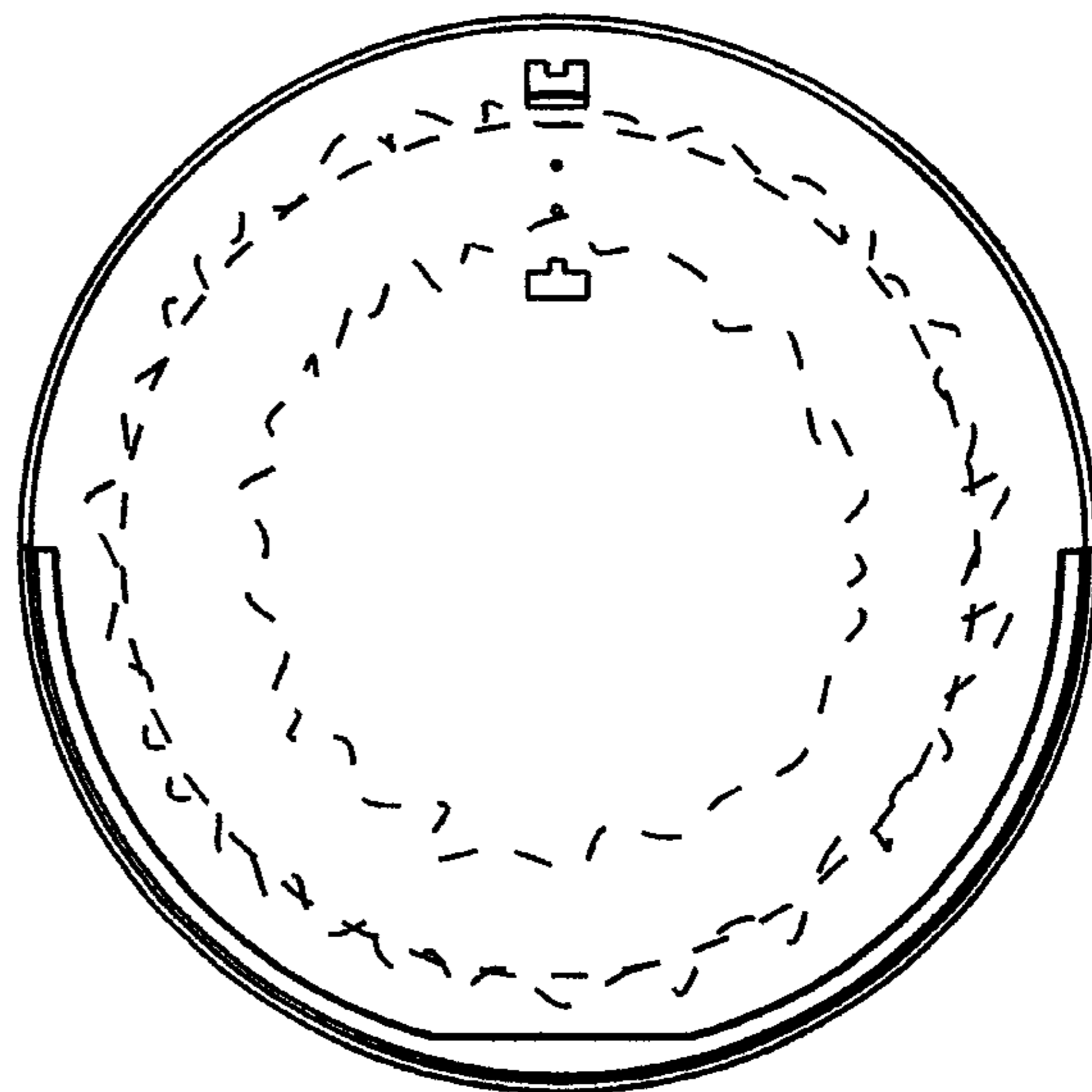
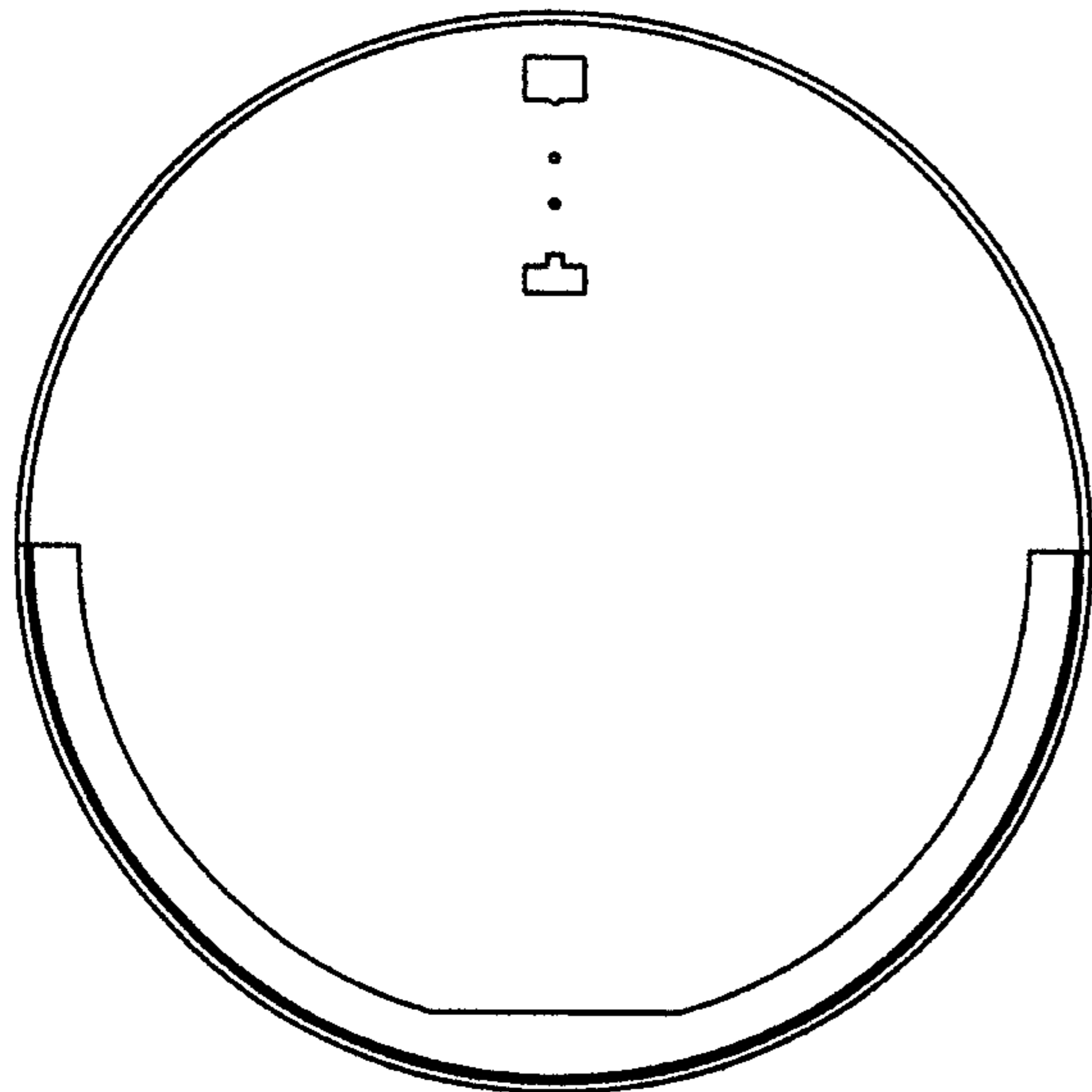

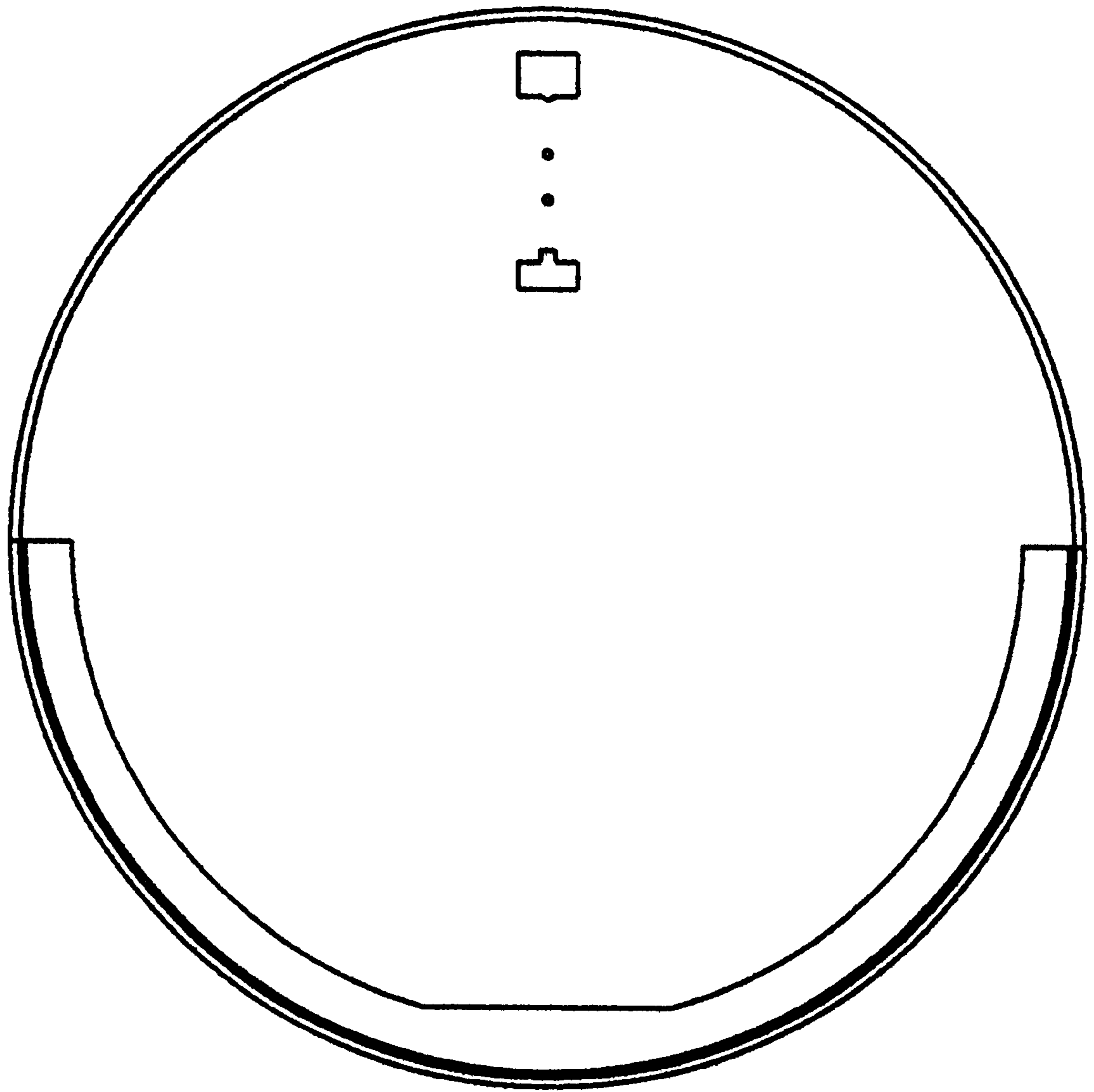

FIG. 1

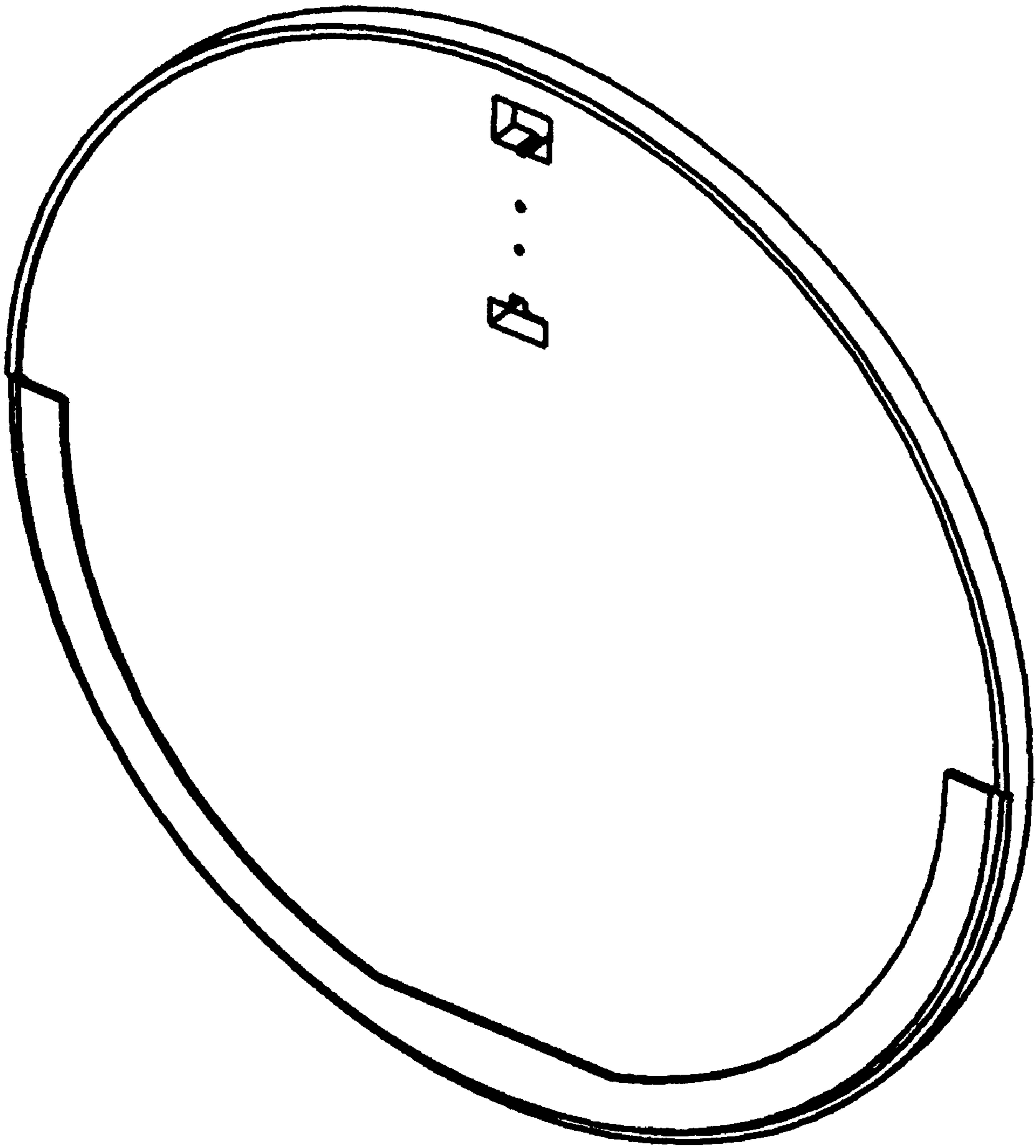

FIG. 2

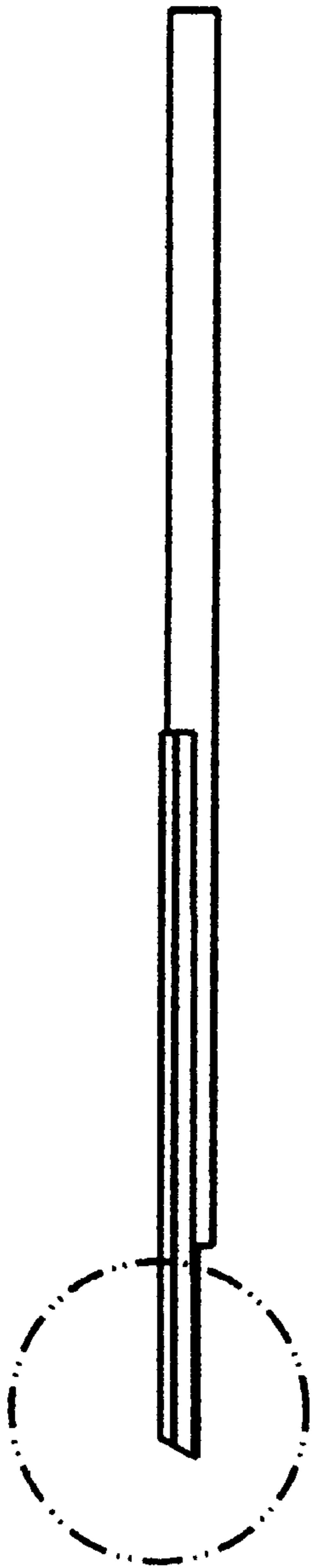
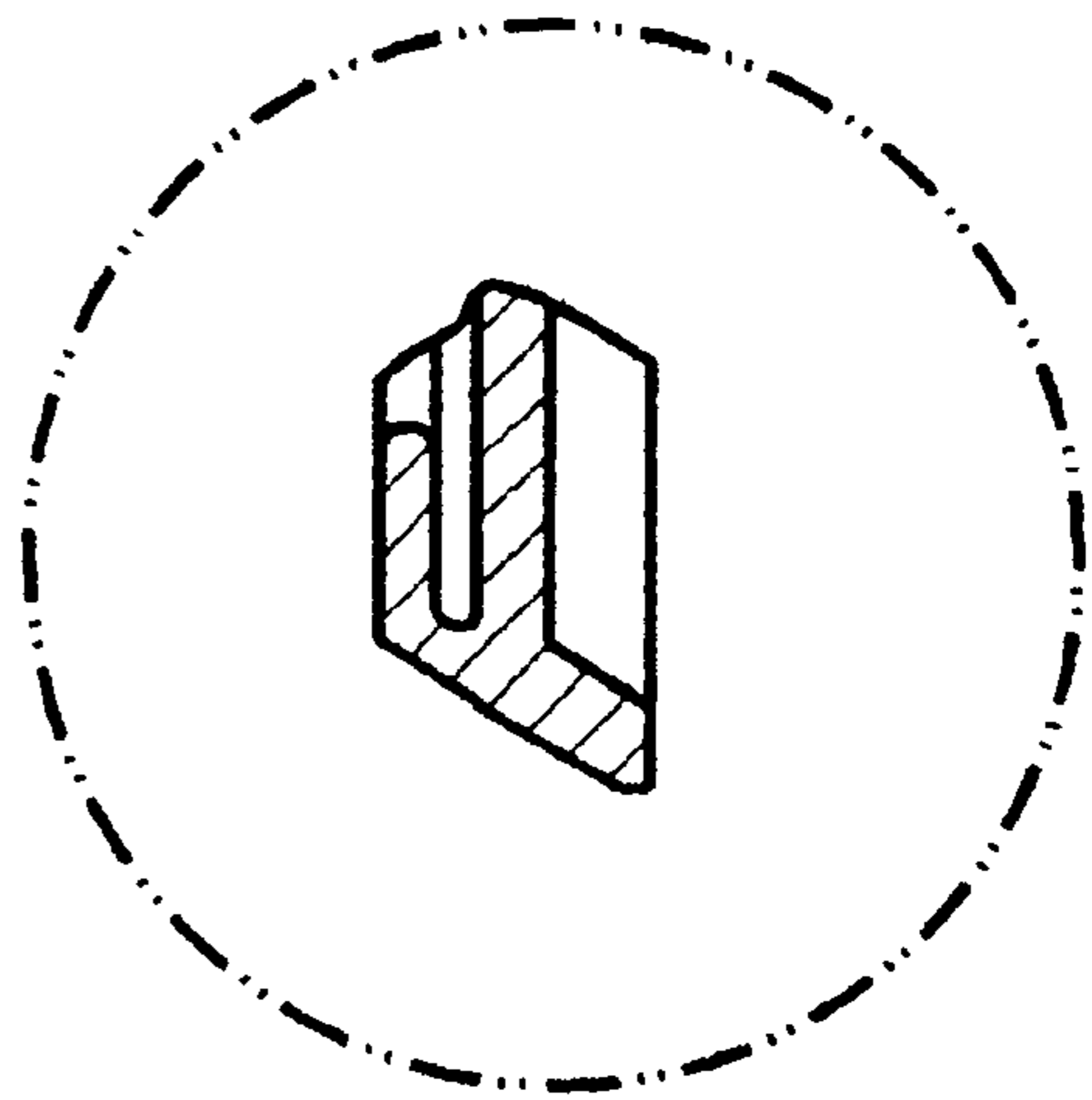

FIG. 3



ENLARGED VIEW
DRIP DETAIL

FIG 4

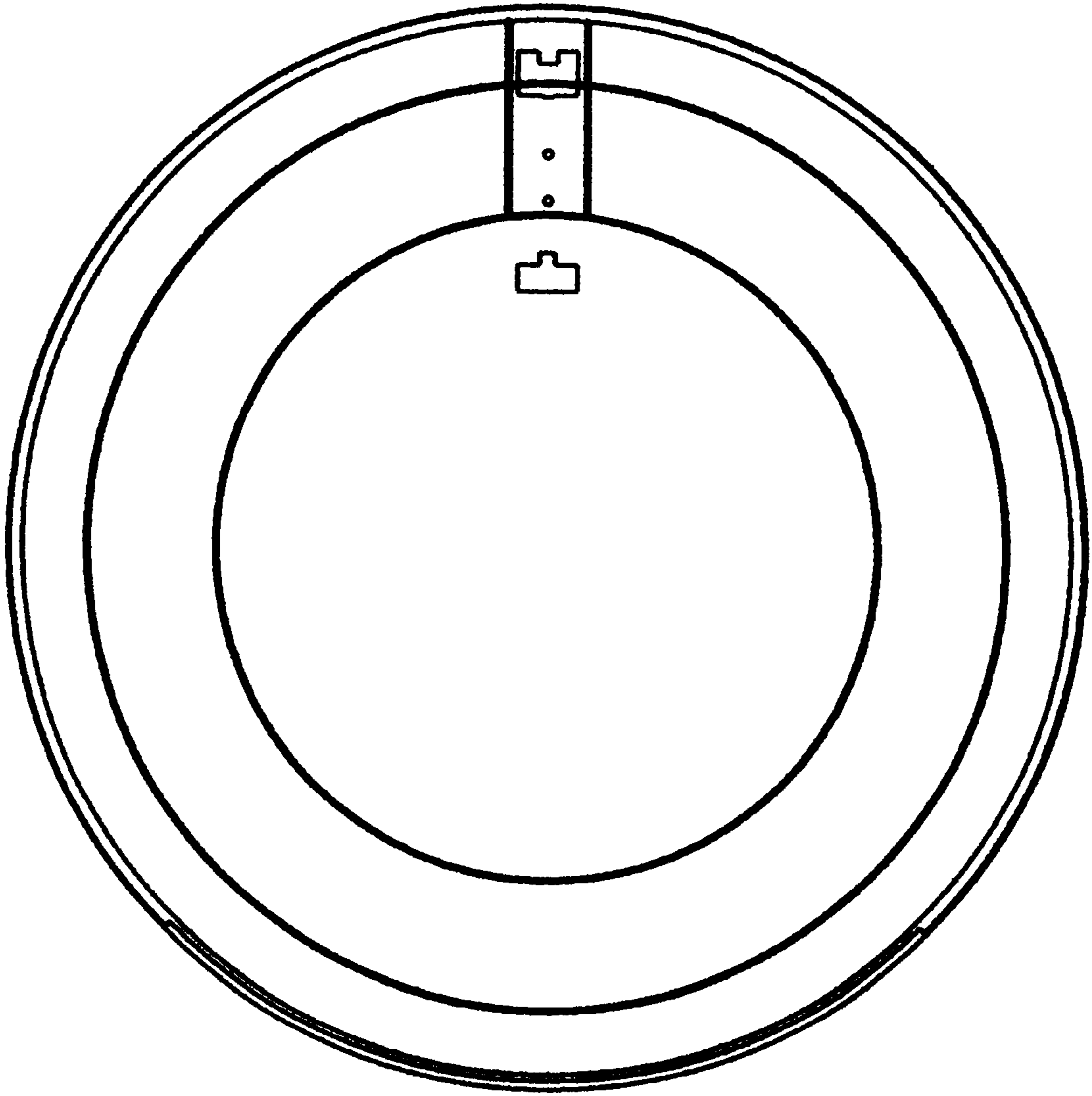

FIG. 5

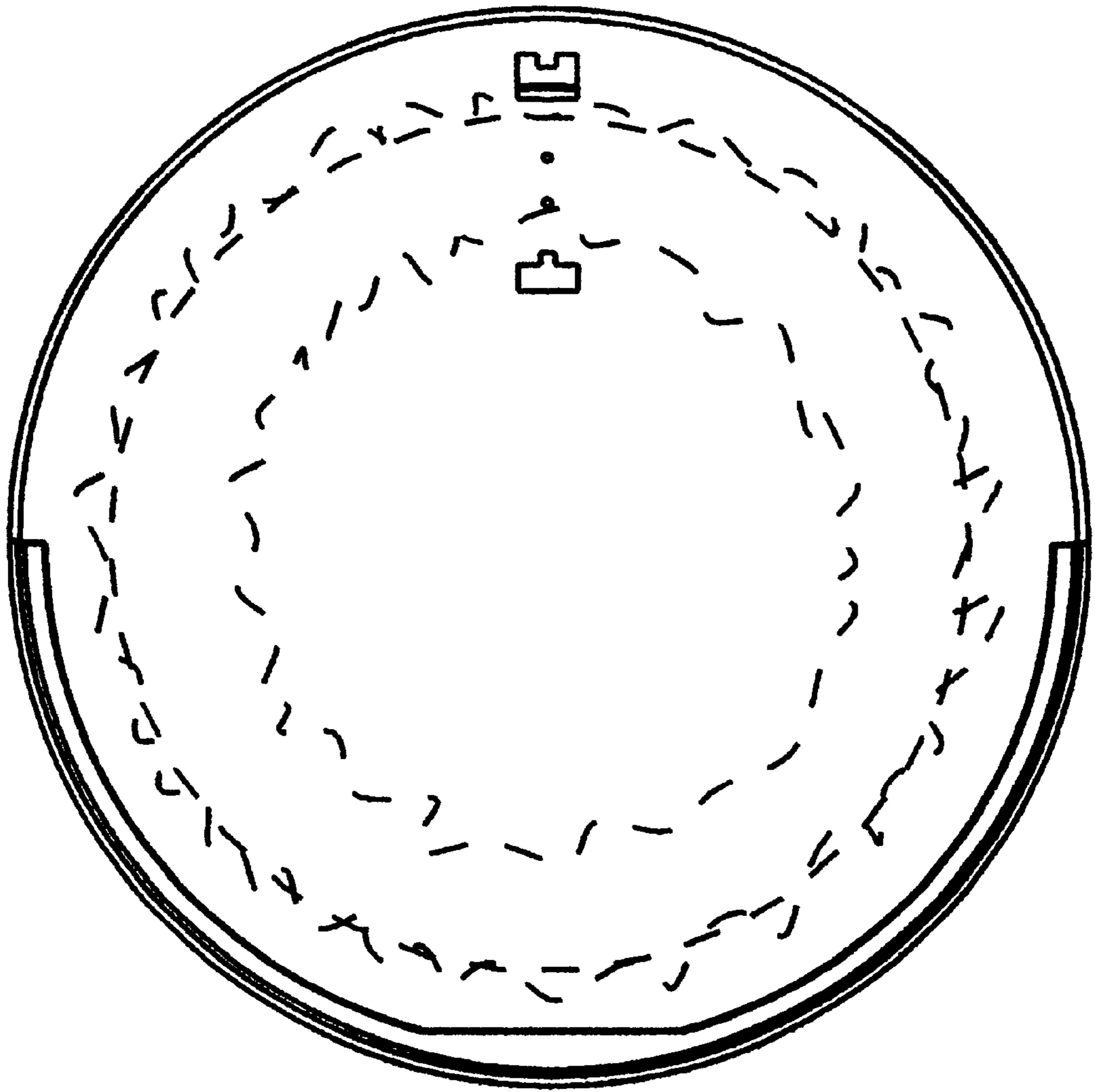

FIG. 6