



US00D479506S

(12) **United States Design Patent**
Aoki et al.

(10) **Patent No.:** **US D479,506 S**

(45) **Date of Patent:** **** Sep. 9, 2003**

(54) **RECTIFIER**

6,175,503 B1 * 1/2001 Hogan et al. 361/733

(75) Inventors: **Yoshio Aoki**, Saitama (JP); **Hikaru Hirashima**, Saitama (JP)

* cited by examiner

(73) Assignee: **Shindengen Electric Manufacturing Co., Ltd.**, Tokyo (JP)

Primary Examiner—Holly Baynham
(74) *Attorney, Agent, or Firm*—Antonellii, Terry, Stout & Kraus, LLP

(**) Term: **14 Years**

(57) **CLAIM**

The ornamental design for a rectifier, as shown.

(21) Appl. No.: **29/171,655**

(22) Filed: **Nov. 27, 2002**

DESCRIPTION

(30) **Foreign Application Priority Data**

May 31, 2002 (JP) 2002-014606

FIG. 1 is a front view of the rectifier showing our new design;

(51) **LOC (7) Cl.** **13-02**

FIG. 2 is a back view thereof;

(52) **U.S. Cl.** **D13/110**

FIG. 3 is a left side view thereof;

(58) **Field of Search** D13/110, 118;

FIG. 4 is a top side view thereof; and

361/678, 695, 692, 730, 733; 363/141;
306/150

FIG. 5 is a bottom view thereof;

FIG. 6 is a cross-sectional view along line 6—6 of FIG. 1; and,

(56) **References Cited**

FIG. 7 is a cross-sectional view along line 7—7 of FIG. 1.

The right side view is a mirror image of the left side.

U.S. PATENT DOCUMENTS

5,132,872 A * 7/1992 Hase 361/692

1 Claim, 5 Drawing Sheets

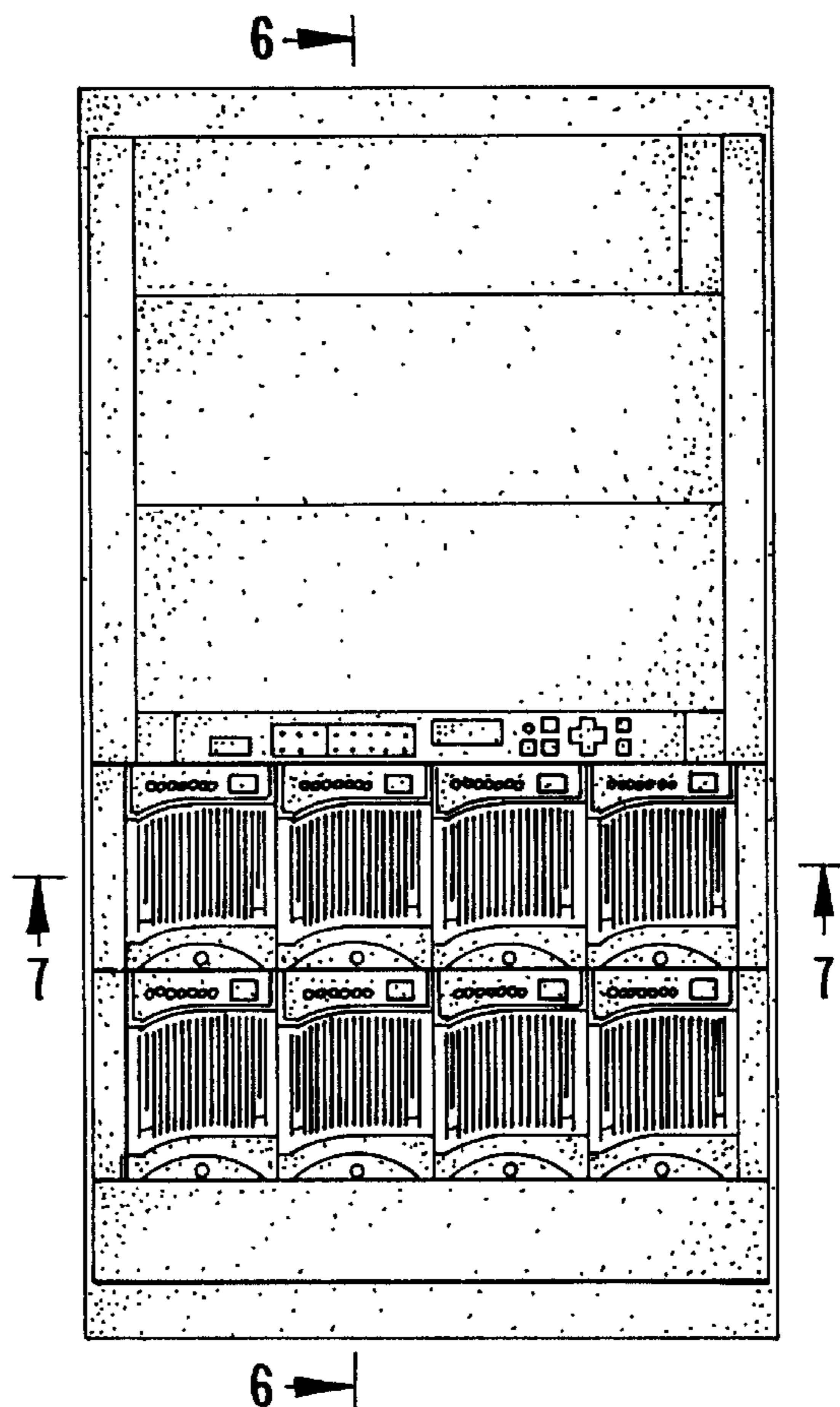

FIG. 1

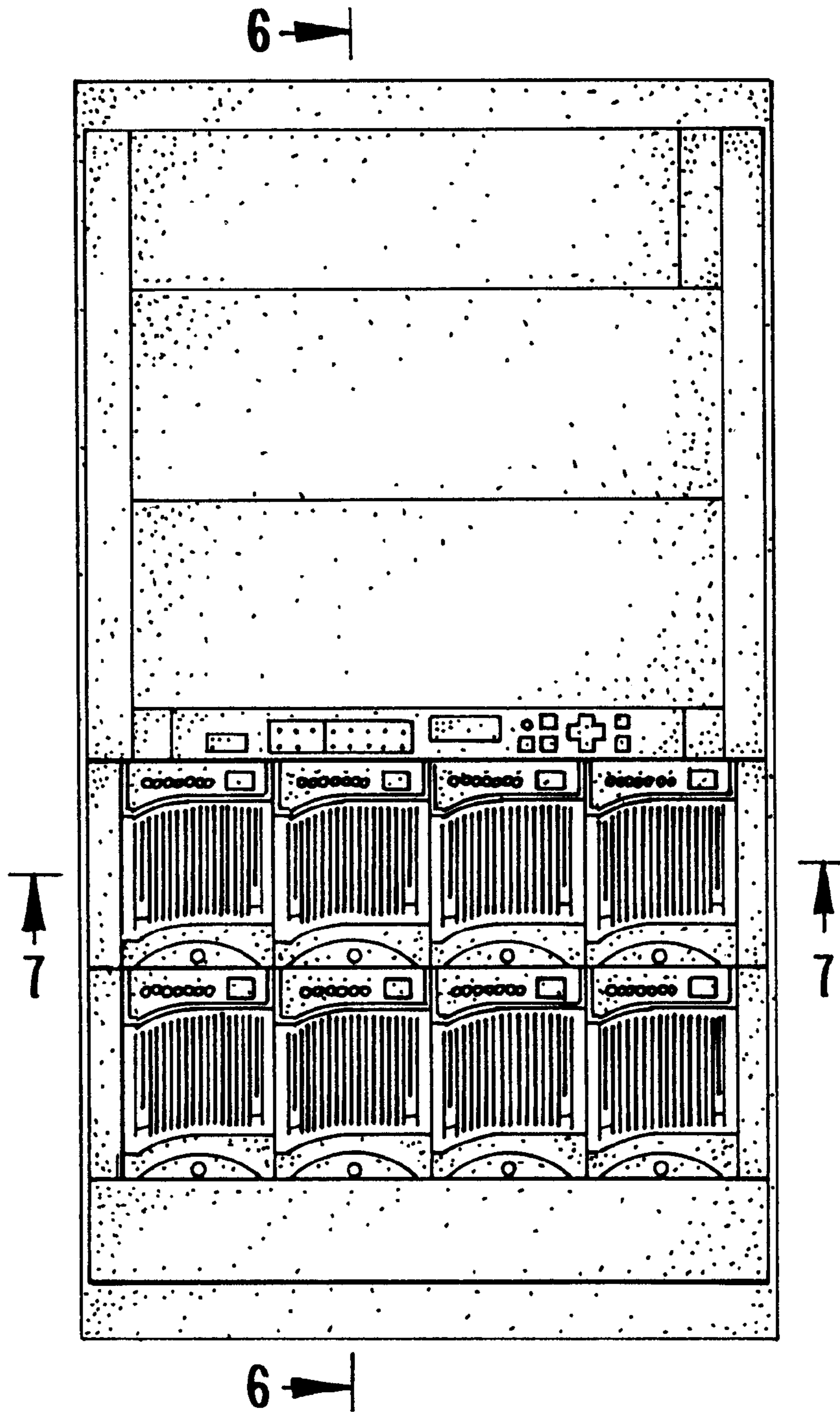

FIG.2

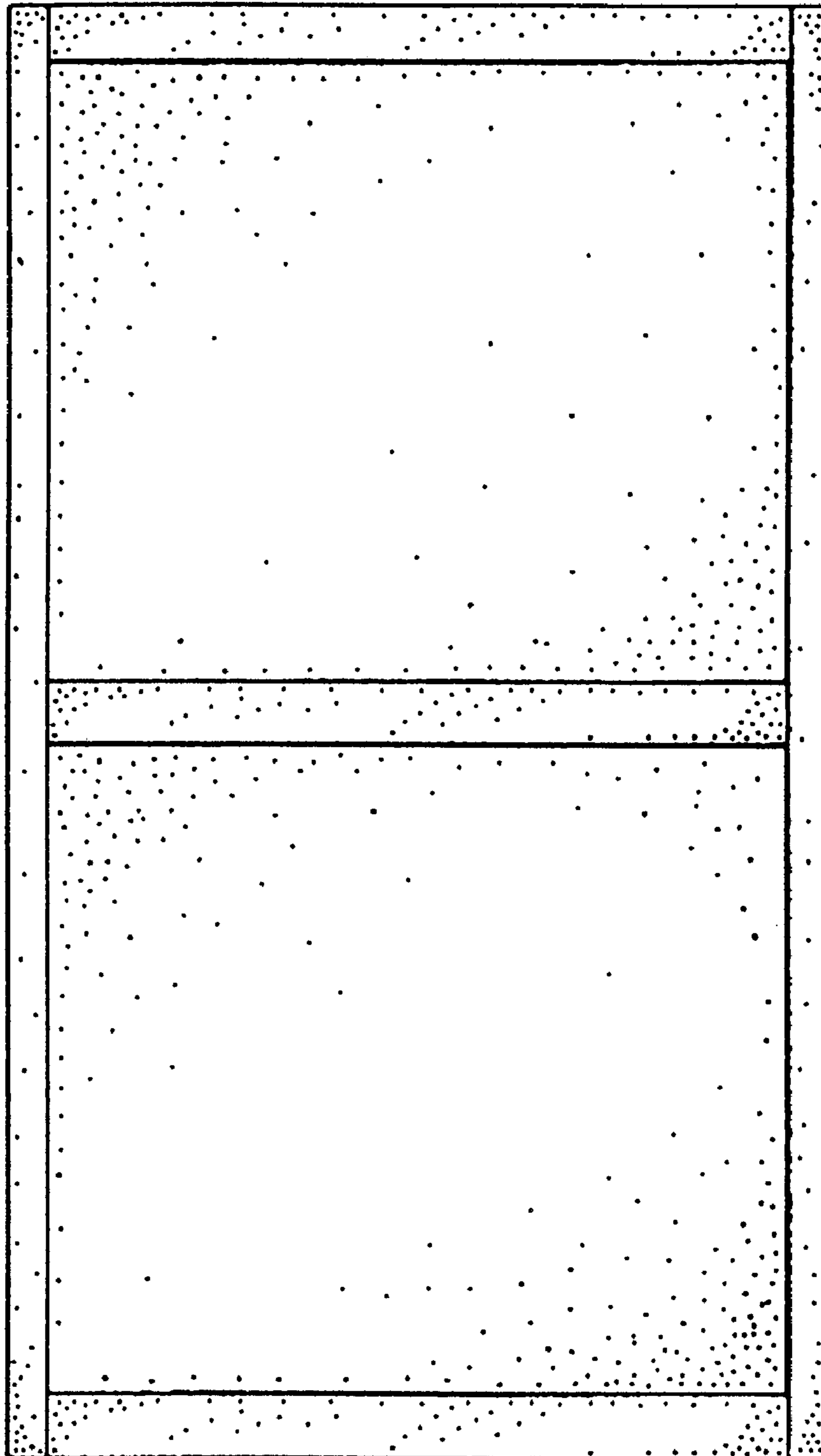

FIG.3

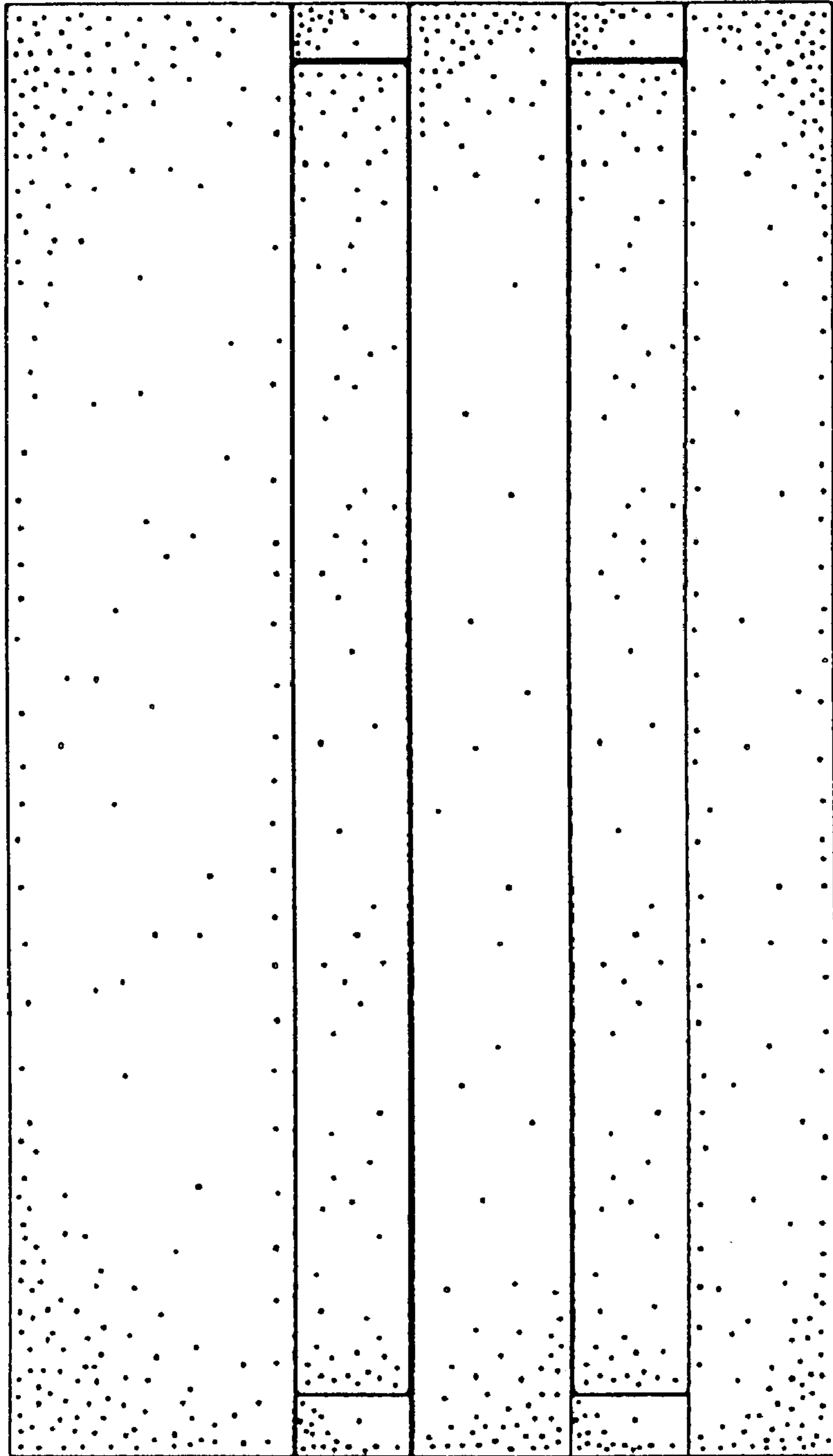

FIG.4

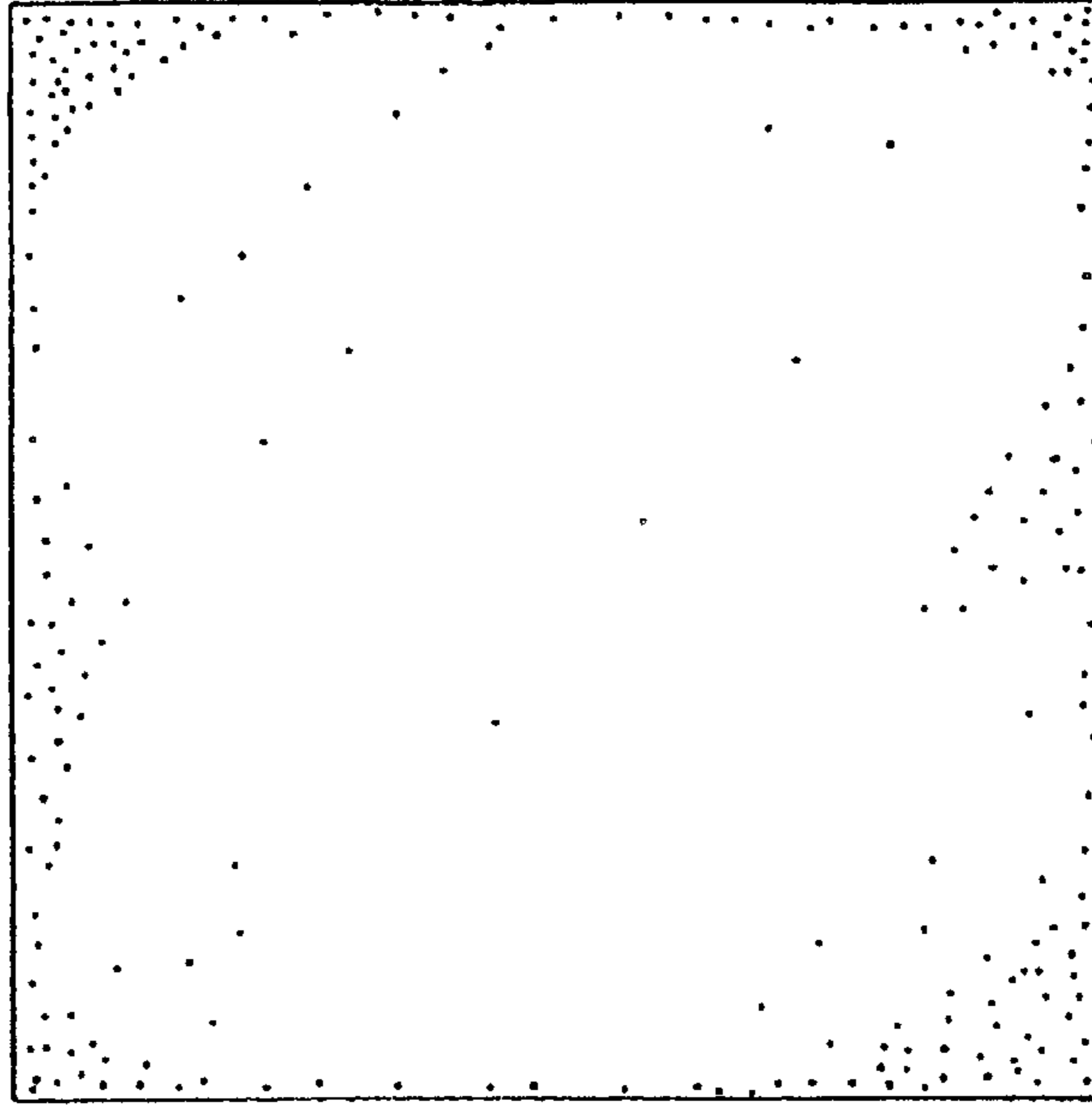

FIG.5

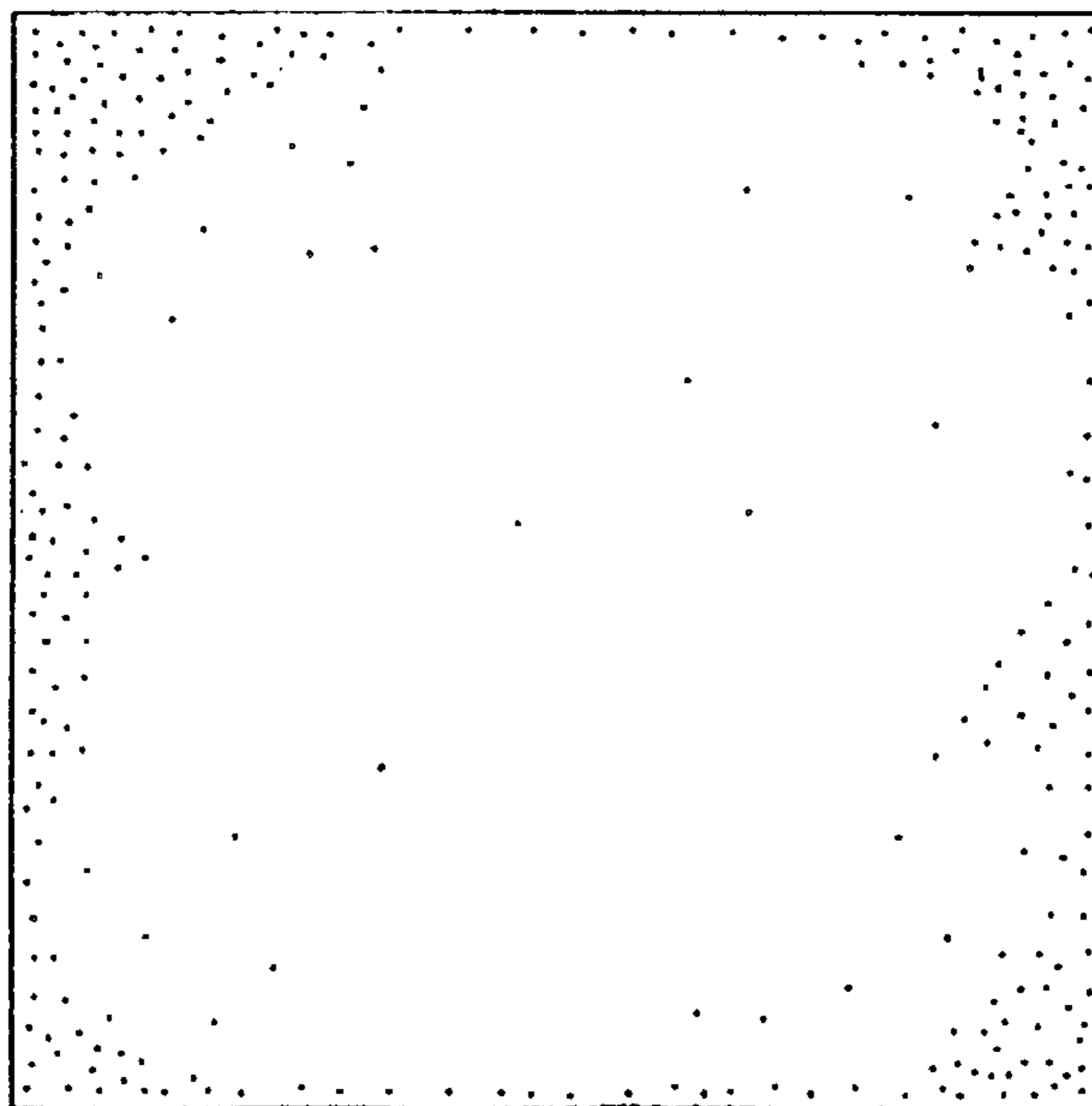

FIG. 6

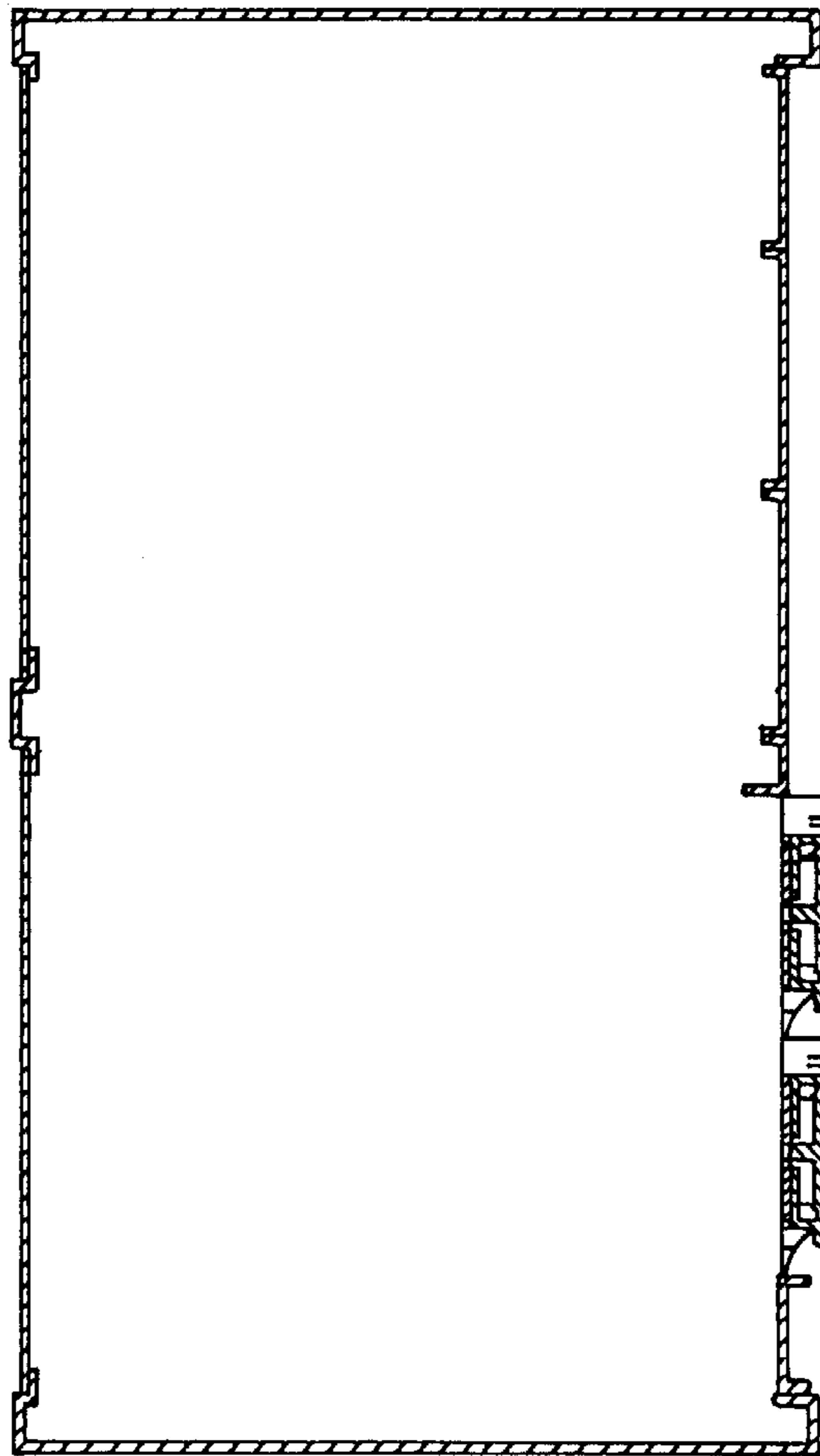

FIG. 7

