



US00D478123S

(12) **United States Design Patent**
Marshall

(10) **Patent No.:** **US D478,123 S**

(45) **Date of Patent:** **** Aug. 5, 2003**

(54) **SHIRT-SHAPED WALL CALENDAR**

(76) Inventor: **Jay Marshall**, P.O. Box 468, Kaneohe, HI (US) 96744

(**) Term: **14 Years**

(21) Appl. No.: **29/157,696**

(22) Filed: **Mar. 22, 2002**

(51) **LOC (7) Cl.** **19-03**

(52) **U.S. Cl.** **D19/24; D19/20; D20/29**

(58) **Field of Search** D20/29; D19/20, D19/21, 22, 23, 24, 25, 52, 1, 2, 6; 434/304; 283/2, 3; 40/107, 109, 110, 113, 114, 115, 119, 120, 121; D2/840, 847, 849

(56) **References Cited**

U.S. PATENT DOCUMENTS

1,799,490 A	*	4/1931	Westerman	283/2 X
D170,723 S	*	10/1953	Secosky	D2/849
2,877,581 A		3/1959	Woofter		
D267,807 S	*	2/1983	Burroughs	D19/24
D284,480 S		7/1986	Wallgren		
D330,225 S	*	10/1992	Cohen	D19/24 X
5,292,154 A	*	3/1994	Williams	283/2
D348,481 S		7/1994	Grant		
D360,651 S	*	7/1995	Budde et al.	D19/52
D390,339 S	*	2/1998	Dipietro	D2/840

D403,707 S	*	1/1999	Wyatt et al.	D20/29
5,979,090 A	*	11/1999	Lee et al.	40/119
D425,114 S		5/2000	Balzer et al.		
D442,630 S	*	5/2001	Harris	D19/24

* cited by examiner

Primary Examiner—Martie K. Holtje

(74) *Attorney, Agent, or Firm*—Seth M. Reiss

(57) **CLAIM**

I claim the ornamental design for a shirt-shaped wall calendar, as shown and described.

DESCRIPTION

FIG. 1 is a front perspective view of a shirt-shaped wall calendar showing my new design; FIG. 2 is a rear perspective view thereof; FIG. 3 is a right side elevational view thereof; FIG. 4 is a front elevational view thereof; FIG. 5 is a rear elevational view thereof; FIG. 6 is a left side elevational view thereof; and, FIG. 7 is a top plan view, the bottom view being substantially identical thereto.

The broken line showings of calendars and shirt patterns are for illustrative purposes only and form no part of the claimed design.

1 Claim, 2 Drawing Sheets

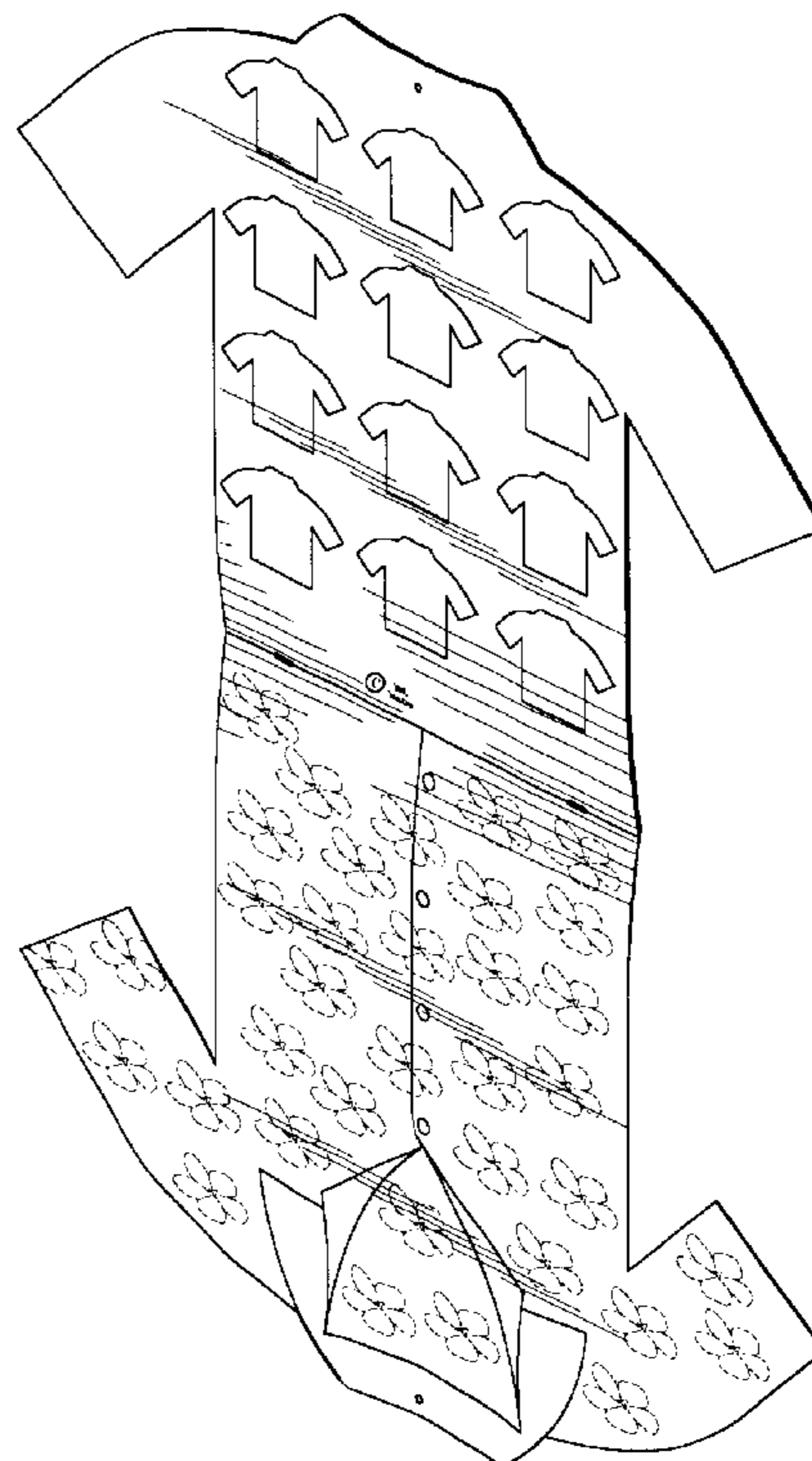
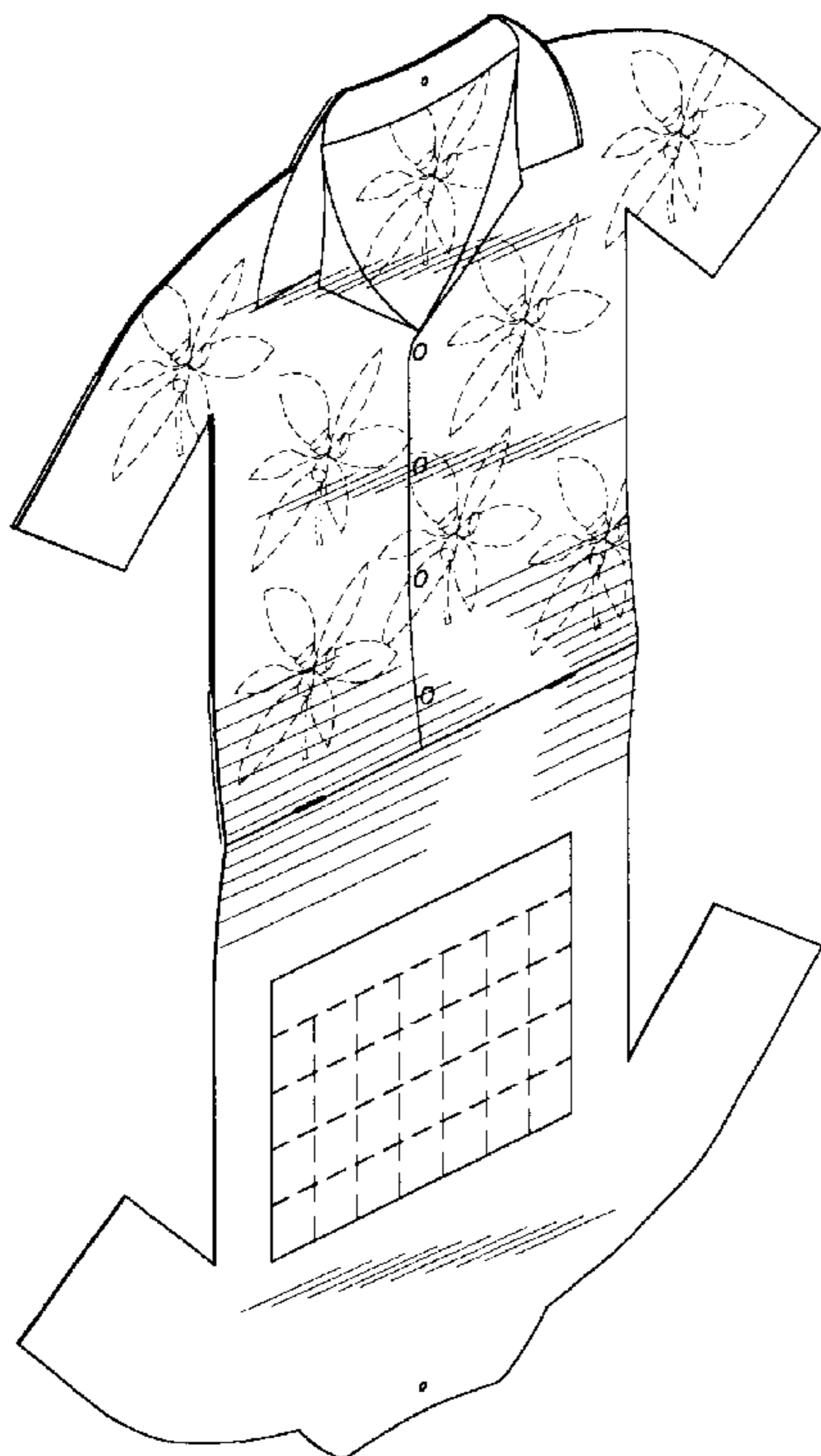

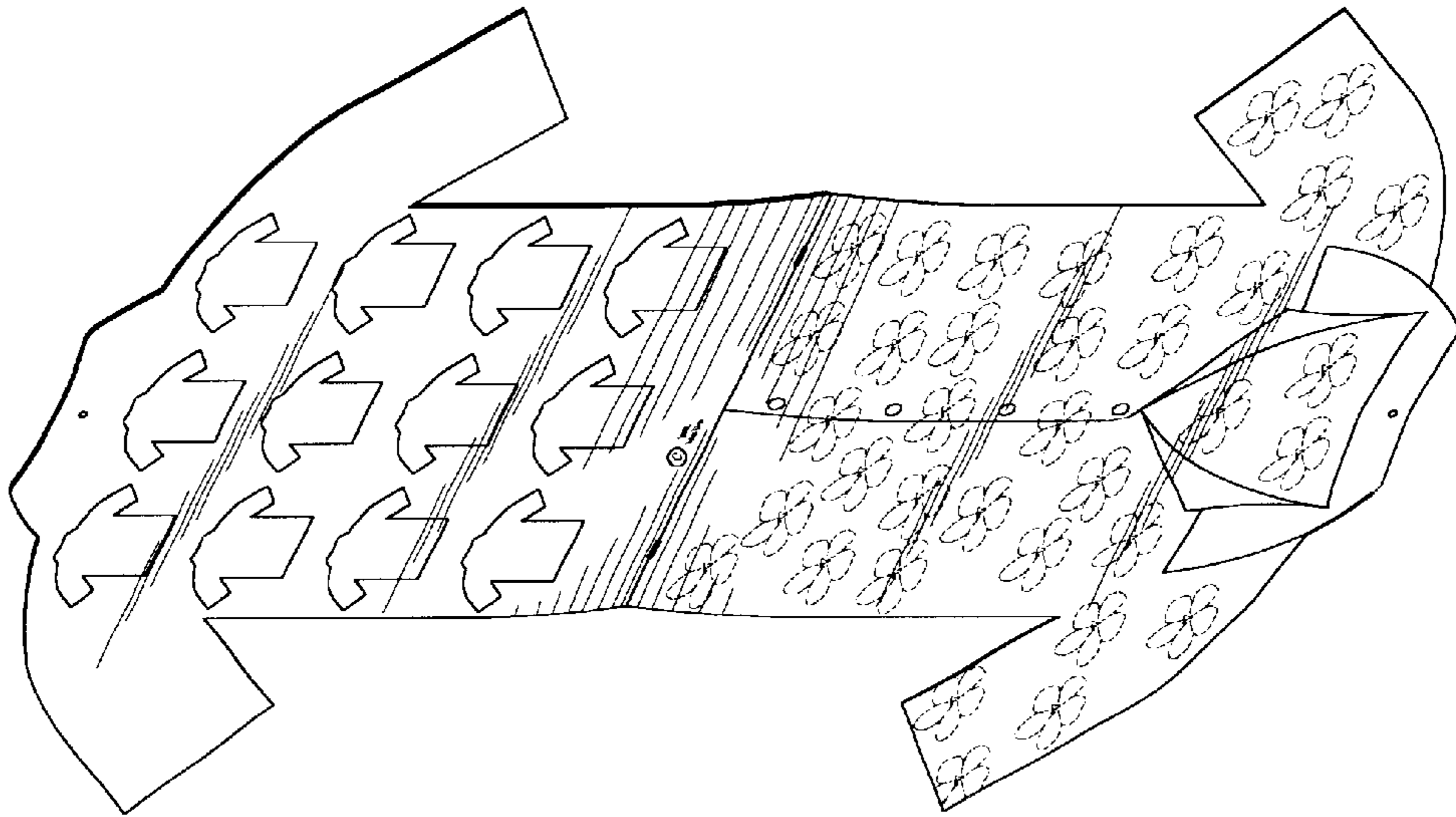

FIG. 2

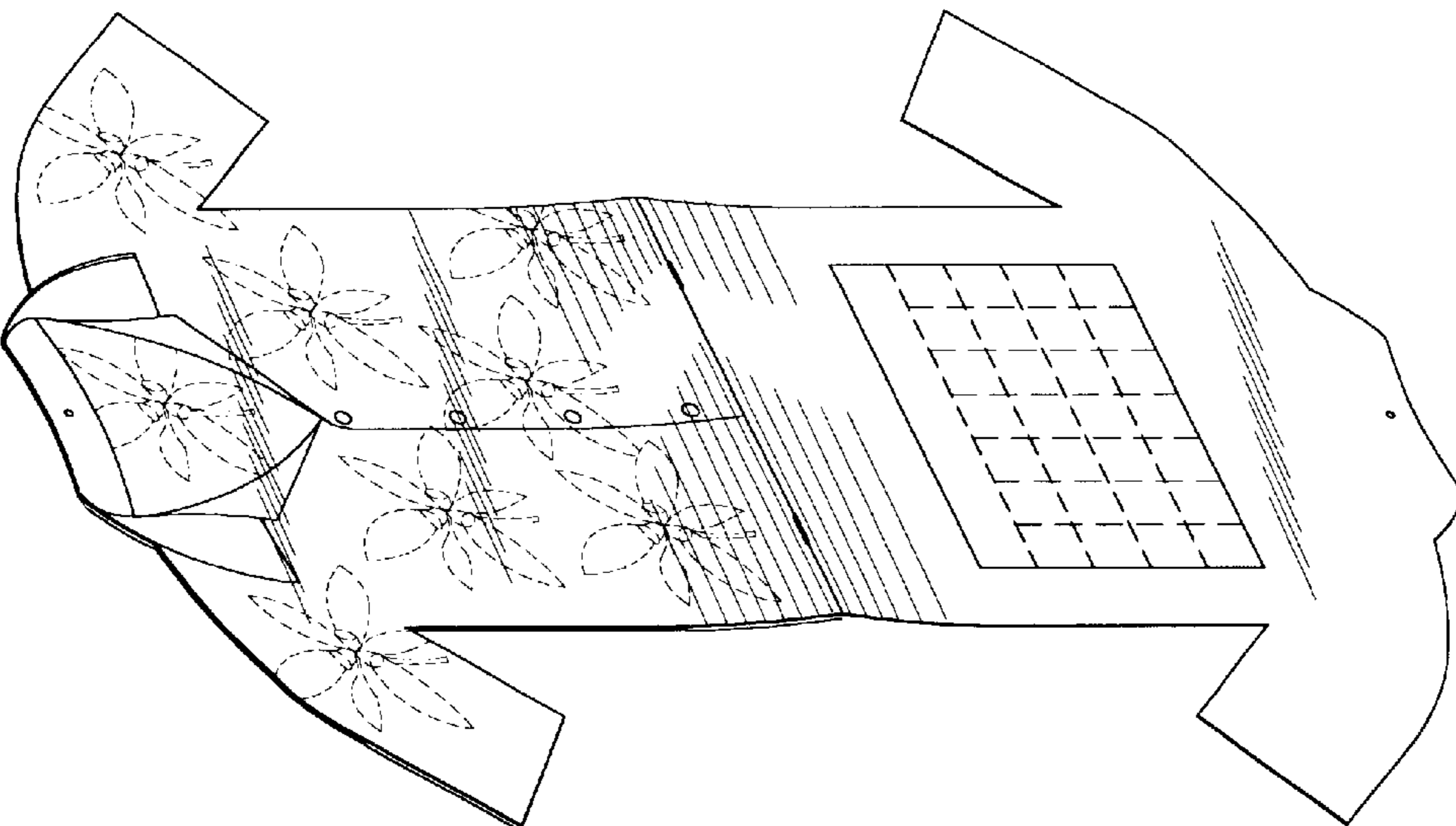

FIG. 1

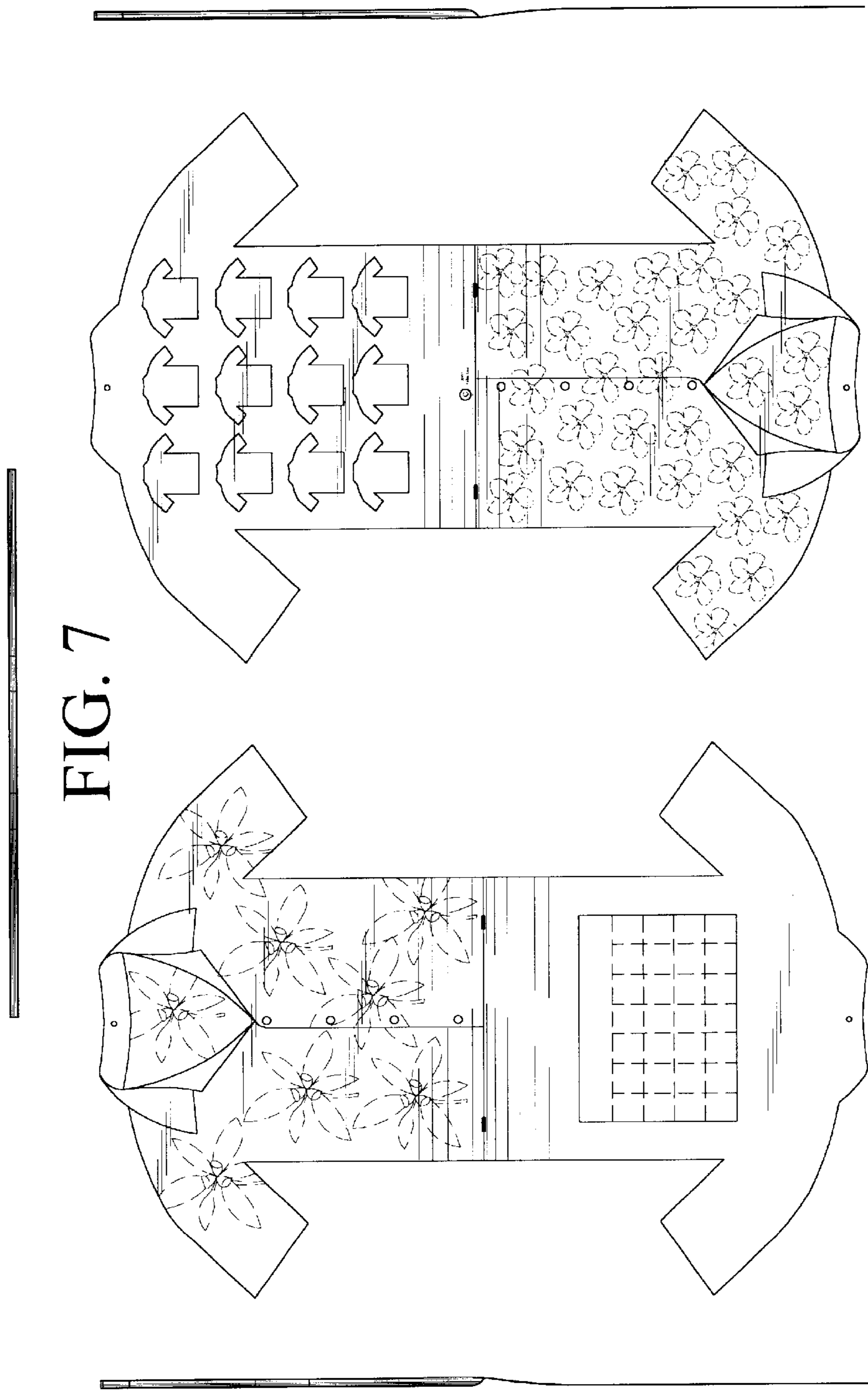

FIG. 7

FIG. 3

FIG. 4

FIG. 5

FIG. 6