



US00D477883S

(12) **United States Design Patent**  
**Smith et al.**

(10) **Patent No.:** **US D477,883 S**

(45) **Date of Patent:** **\*\* Jul. 29, 2003**

(54) **FLOOR TILE ARRANGEMENT**

D366,940 S \* 2/1996 Lechleiter et al. .... D25/138  
D450,859 S \* 11/2001 Abdollahi ..... D25/38

(75) Inventors: **Scott Smith**, Dayton, OH (US); **Greg B. Amburgey**, Enon, OH (US); **Frederick R. Bradshaw**, Centerville, OH (US); **Roy L. Chamberlain**, Fishers, IN (US); **Jeffrey A. Davidson**, Beavercreek, OH (US); **Robert A. Fortman**, Beavercreek, OH (US); **Whitman M. Harson**, Yellow Springs, OH (US); **James R. O'Neil**, Waukesha, WI (US); **Franklin T. Pleasants**, Beavercreek, OH (US)

\* cited by examiner

*Primary Examiner*—Doris Clark  
(74) *Attorney, Agent, or Firm*—Emch, Schaffer, Schaub & Porcello Co., L.P.A.

(73) Assignee: **Marathon Ashland Petroleum LLC**, Findlay, OH (US)

(\*\*) Term: **14 Years**

(21) Appl. No.: **29/132,804**

(22) Filed: **Nov. 16, 2000**

(51) **LOC (7) Cl.** ..... **25-01**

(52) **U.S. Cl.** ..... **D25/138**

(58) **Field of Search** ..... D25/35, 138; 52/311.1, 52/311.2, 314, 316

(57) **CLAIM**

The ornamental design for a floor tile arrangement, as shown and described.

**DESCRIPTION**

FIG. 1 is a perspective view of the floor tile arrangement, showing all unclaimed subject matter in broken lines.

FIG. 2 is a top plan view of FIG. 1 with all unclaimed subject matter shown by broken lines.

FIG. 3 is a top plan view of FIG. 2 with a portion of the unclaimed subject matter removed to show the continuous floor tile arrangement that exists under the unclaimed subject matter; and,

FIG. 4 is a perspective view of FIG. 3 with unclaimed subject matter partially cutaway and removed to present the complete perspective view of the floor tile arrangement.

The broken lines showing are for illustrative purposes only and form no part of the claimed design.

(56) **References Cited**

**U.S. PATENT DOCUMENTS**

D202,545 S \* 10/1965 Gould

**1 Claim, 4 Drawing Sheets**

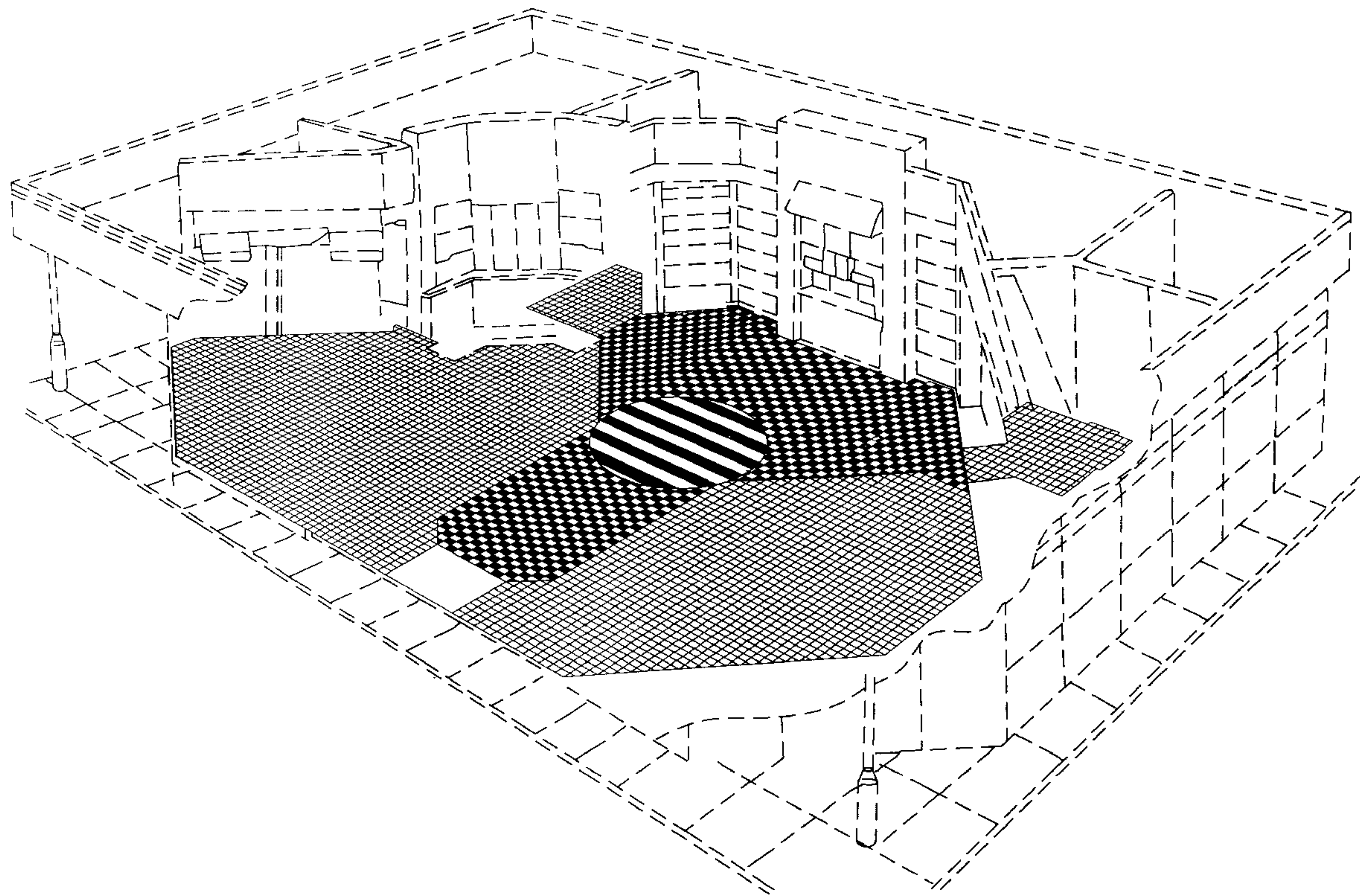

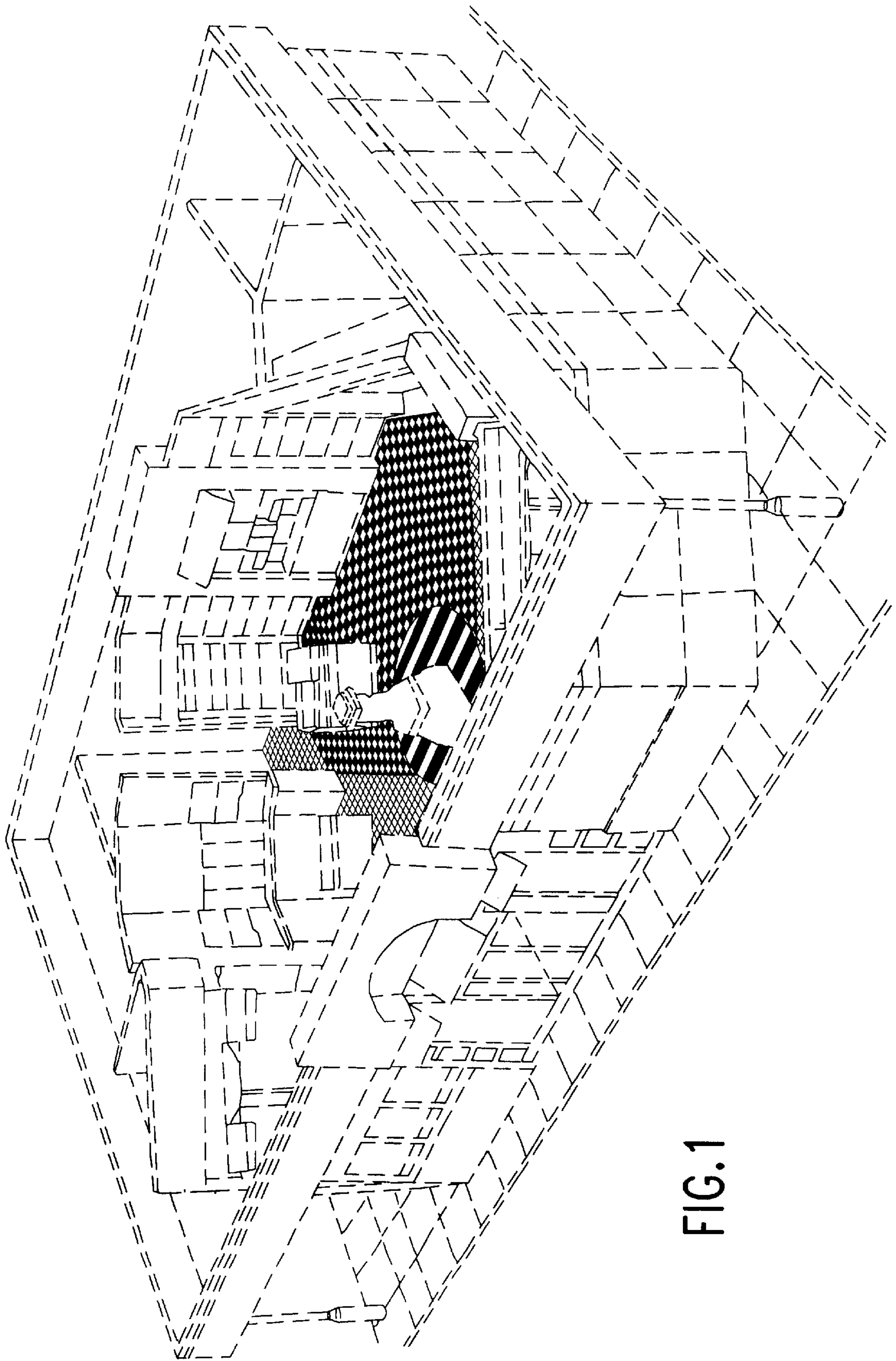

FIG. 1



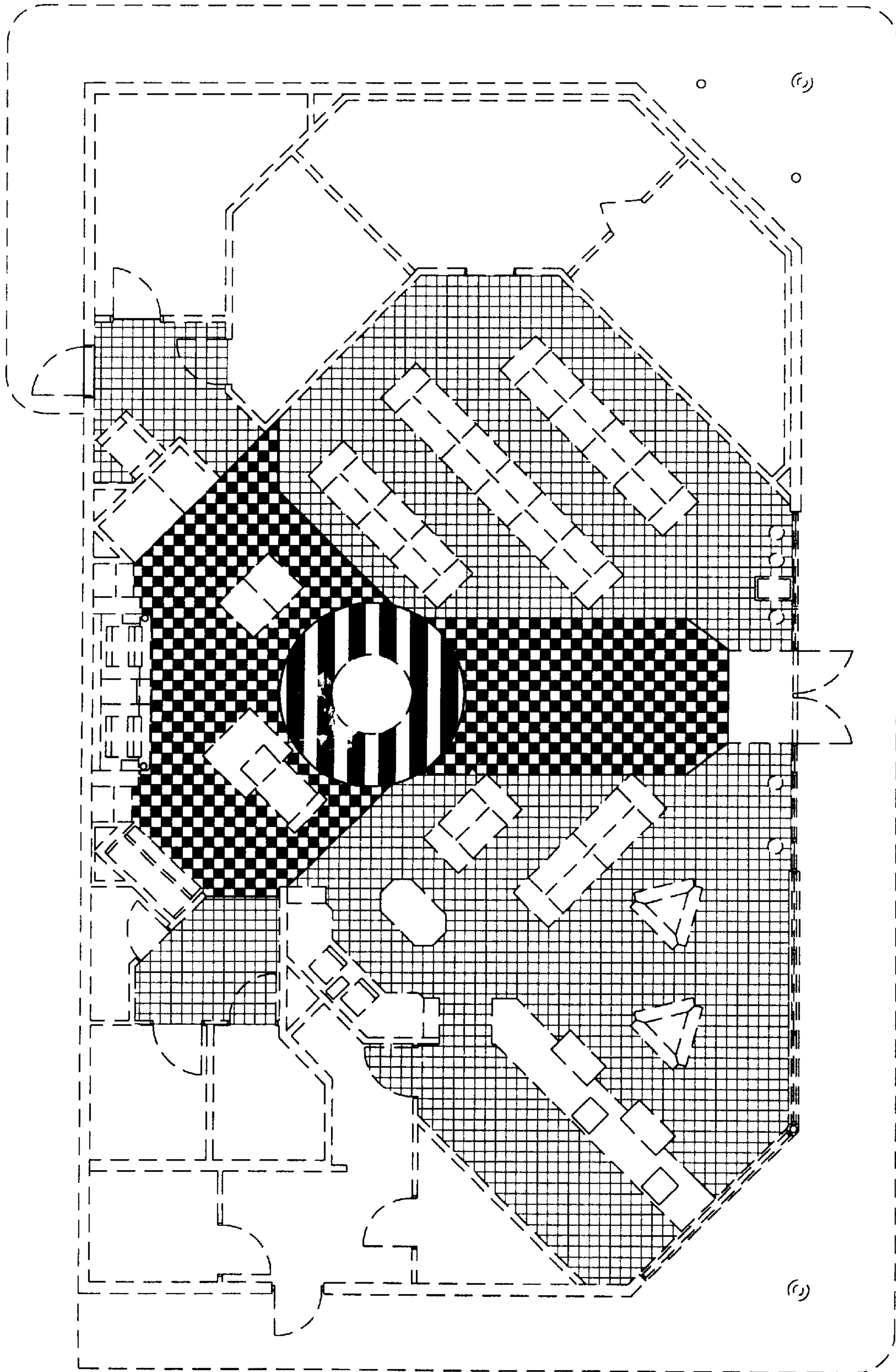

FIG. 2

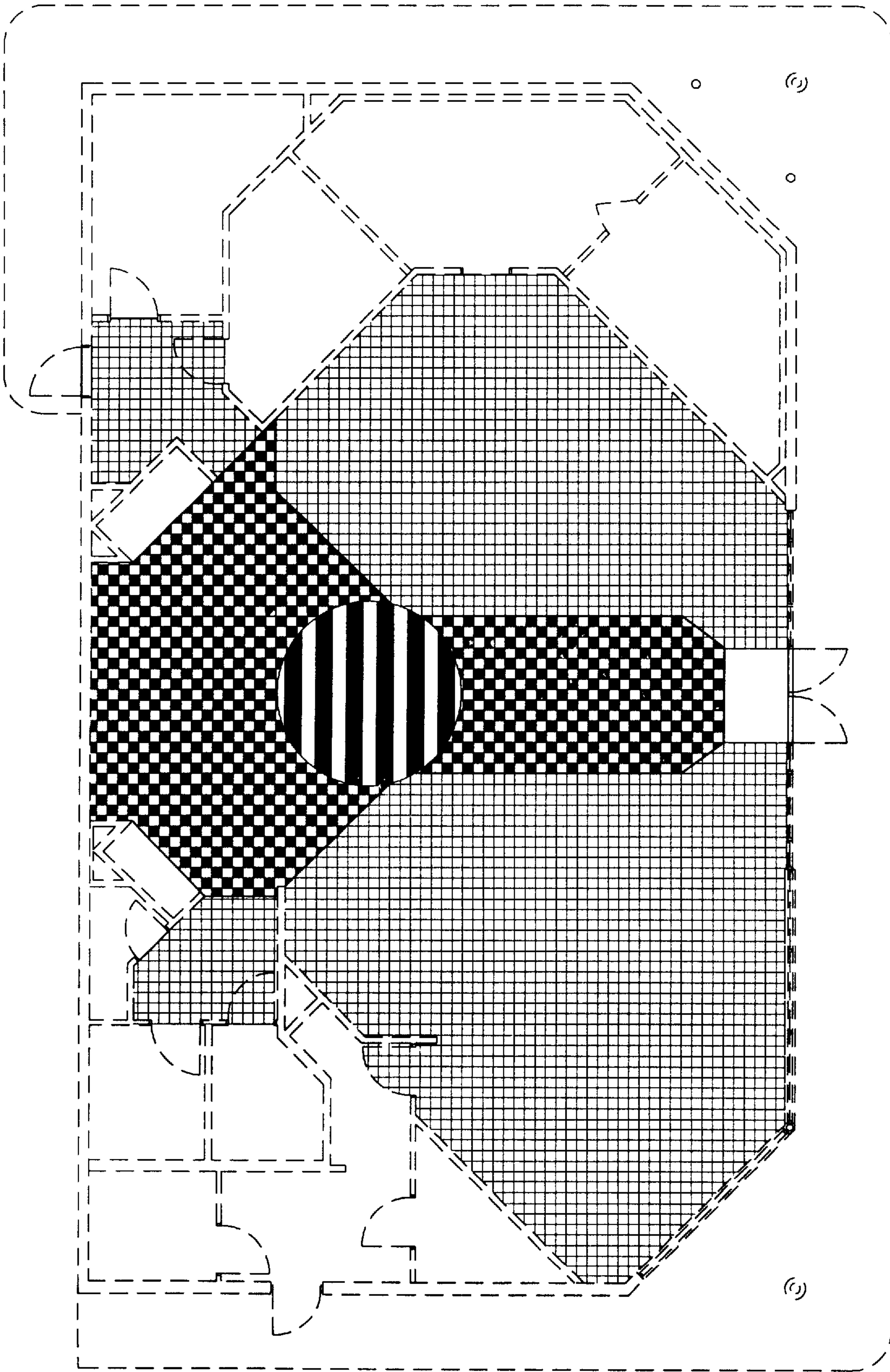

FIG. 3



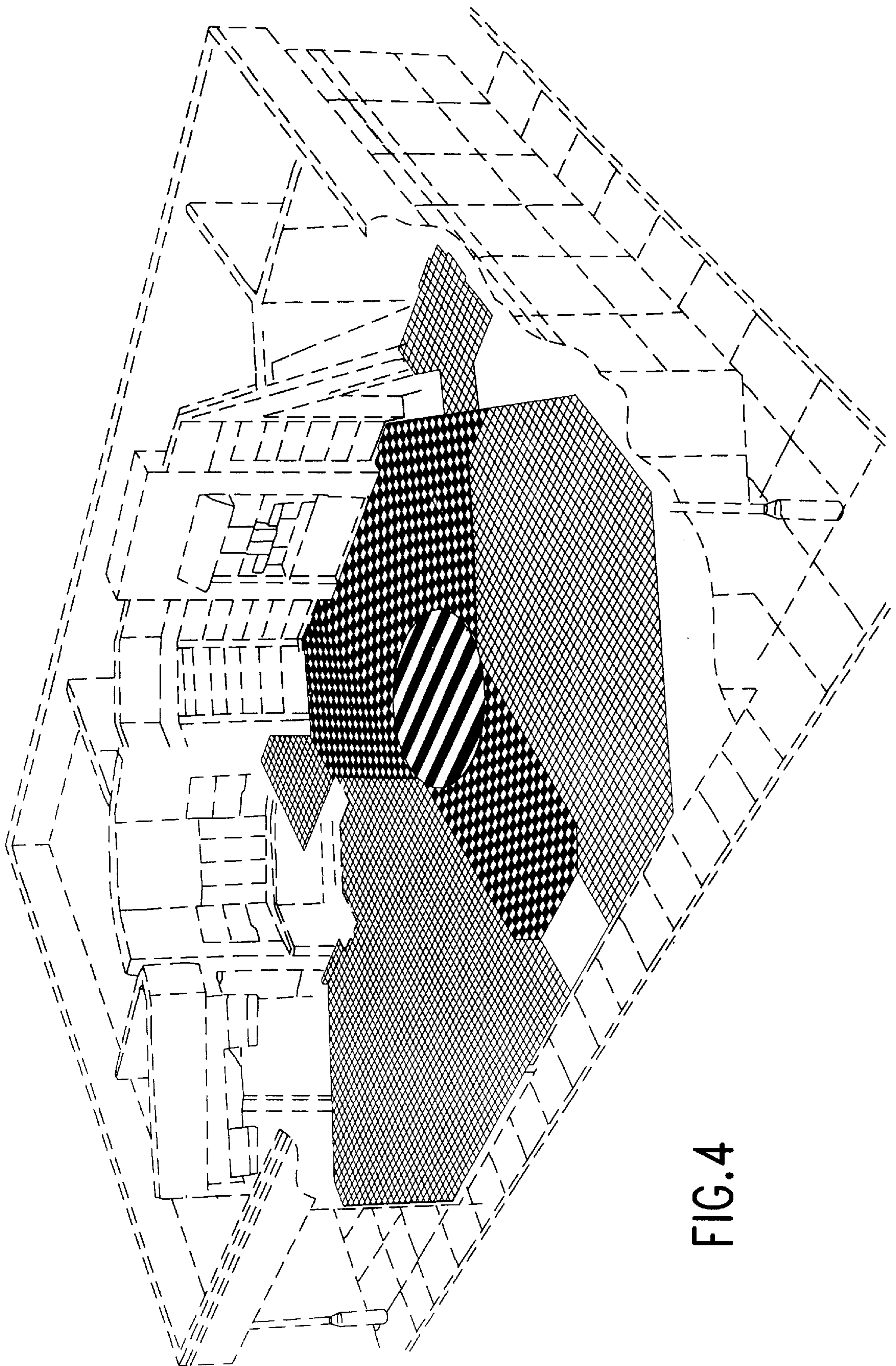

FIG.4