



US00D477161S

(12) **United States Design Patent**
de Blois

(10) **Patent No.:** **US D477,161 S**

(45) **Date of Patent:** **** Jul. 15, 2003**

(54) **APRON FOR FURNITURE**

(75) Inventor: **Martin de Blois**, Chicago, IL (US)

(73) Assignee: **Baronet, Inc.** (CA)

(**) Term: **14 Years**

(21) Appl. No.: **29/159,129**

(22) Filed: **Apr. 15, 2002**

(51) **LOC (7) Cl.** **06-06**

(52) **U.S. Cl.** **D6/491**

(58) **Field of Search** D6/480-489, 495,
D6/511, 477, 479; 108/153.1, 155, 156,
157.1, 161; 248/188, 188.1, 188.8

(56) **References Cited**

U.S. PATENT DOCUMENTS

| | | | | | |
|------------|---|---------|-----------------|-------|--------|
| D73,551 S | * | 10/1927 | Bach | | D6/488 |
| D283,864 S | * | 5/1986 | Bergelin | | D6/484 |
| D283,865 S | * | 5/1986 | Bergelin | | D6/484 |
| D296,165 S | * | 6/1988 | Ferguson et al. | | D6/422 |
| D429,087 S | * | 8/2000 | Gilbert | | D6/422 |
| D452,624 S | | 1/2002 | de Bolis | | |

OTHER PUBLICATIONS

Antiques May 1977, p. 961; table at bottom right.*

Color Photograph of Roche-Bobois various LA Route du Thé furniture centered on rectangular coffee table, available in 1985.

* cited by examiner

Primary Examiner—Janice E. Seeger

(74) *Attorney, Agent, or Firm*—SAIDMAN DesignLaw Group

(57) **CLAIM**

The ornamental design for an apron for furniture, as shown and described.

DESCRIPTION

FIG. 1 is a left side view of an apron for furniture showing my new design, the right side view being a mirror image; FIG. 2 is a front view thereof, the rear view being a mirror image;

FIG. 3 is a left side view of a second embodiment showing my new design, the right side view being a mirror image; FIG. 4 is a front view thereof, the rear view being a mirror image;

FIG. 5 is a bottom view thereof;

FIG. 6 is a left side view of a third embodiment showing my new design, the right side view being a mirror image;

FIG. 7 is a front view thereof, the rear view being a mirror image; and,

FIG. 8 is a bottom view thereof.

The dashed lines in the drawings are shown for environmental purposes only and form no part of the claimed design.

1 Claim, 5 Drawing Sheets

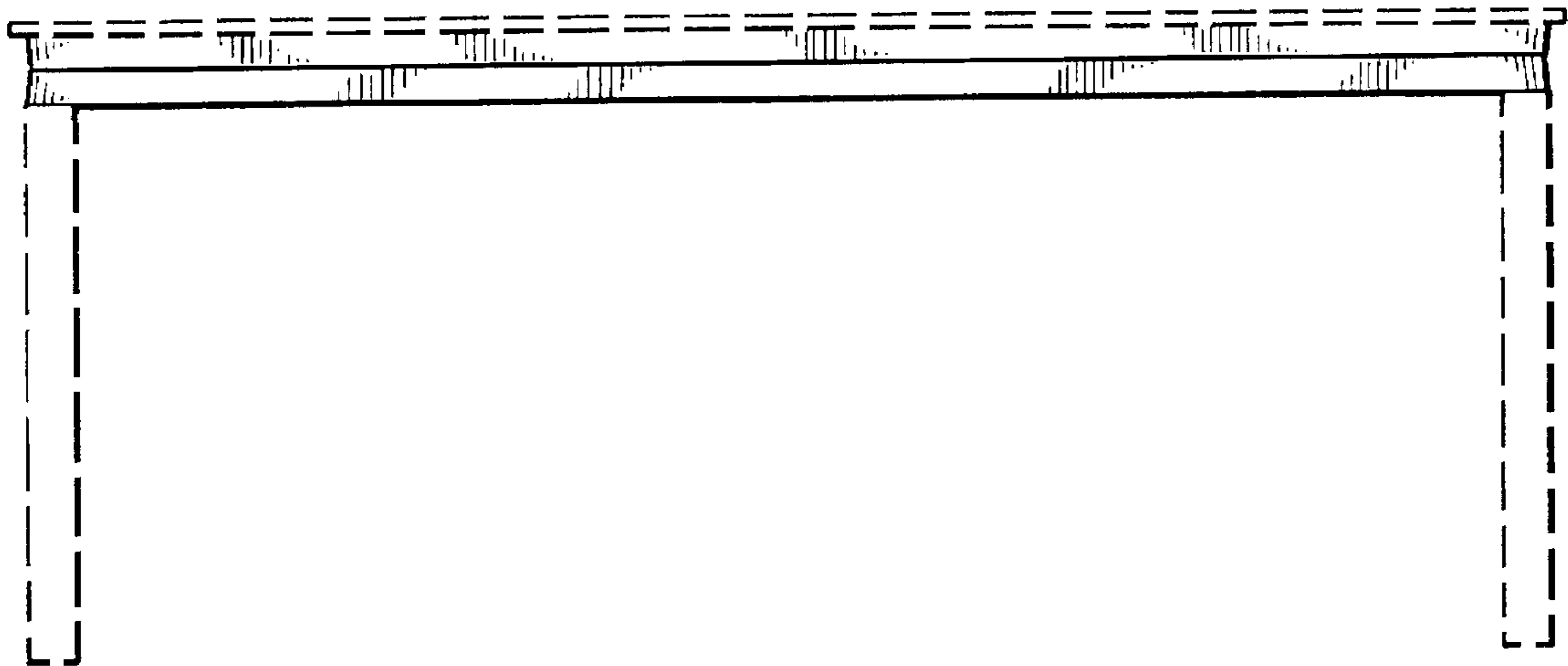

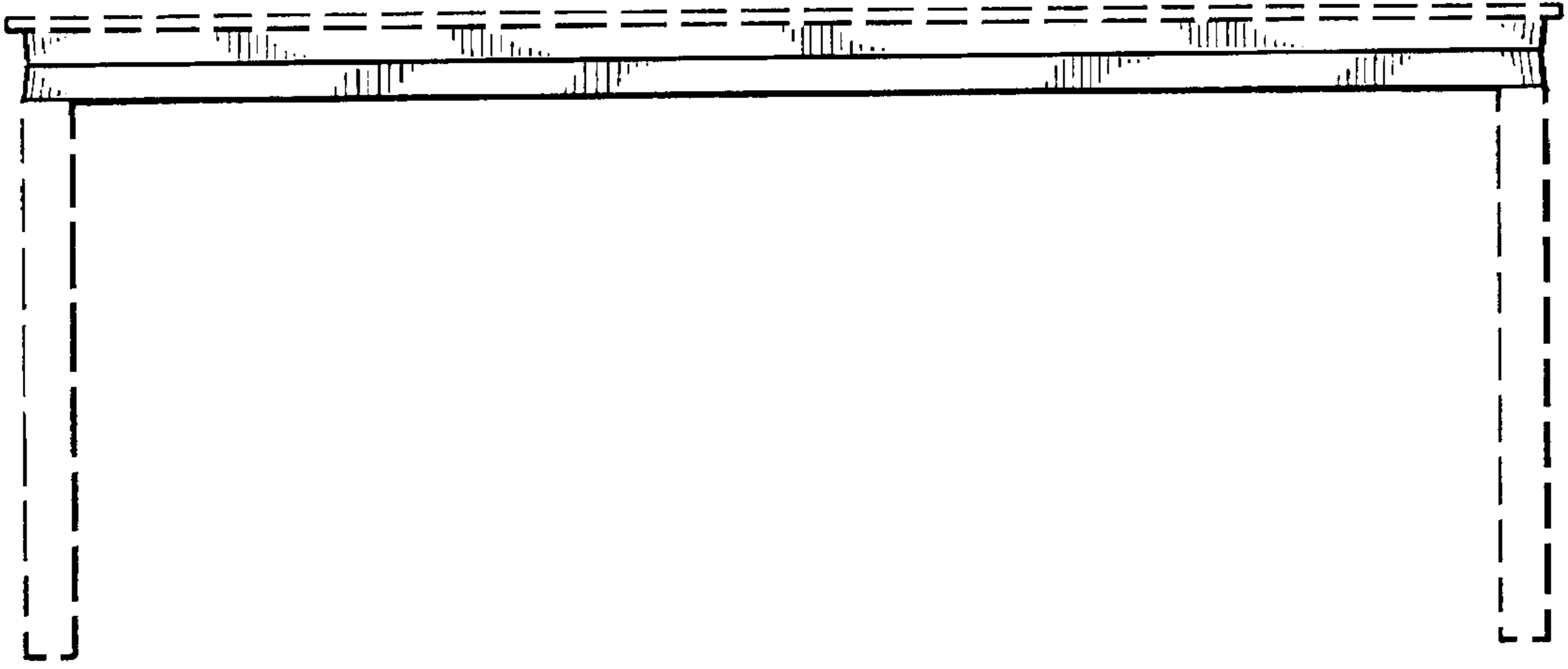

FIG.1

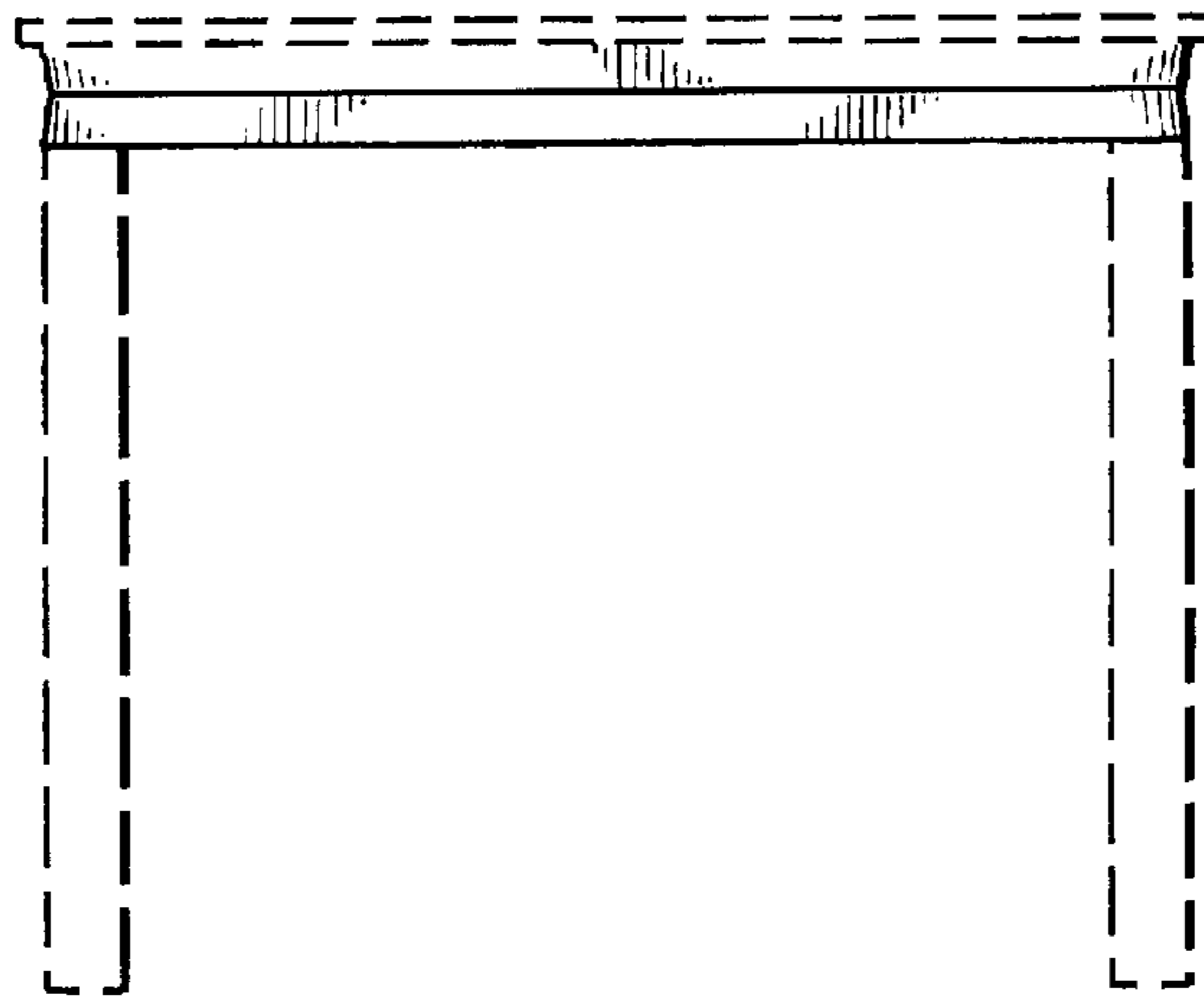

FIG.2

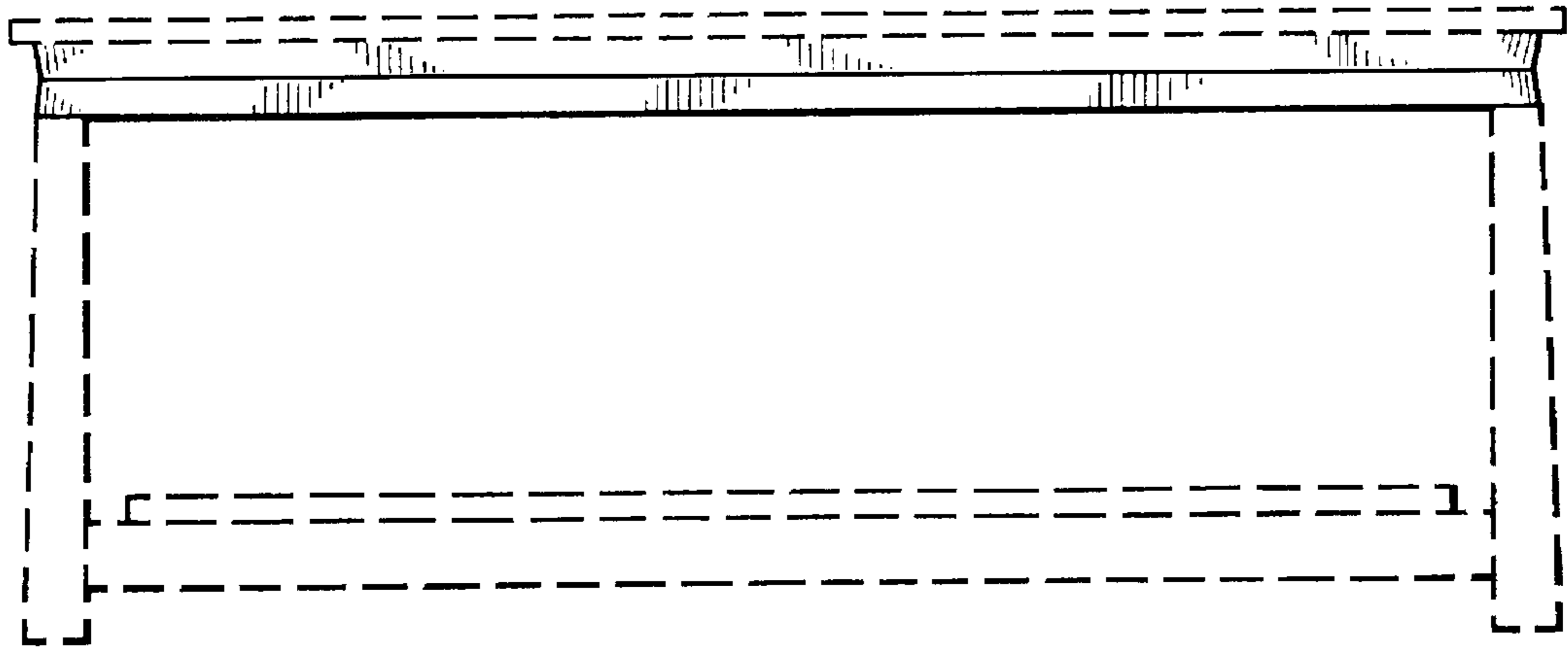

FIG.3

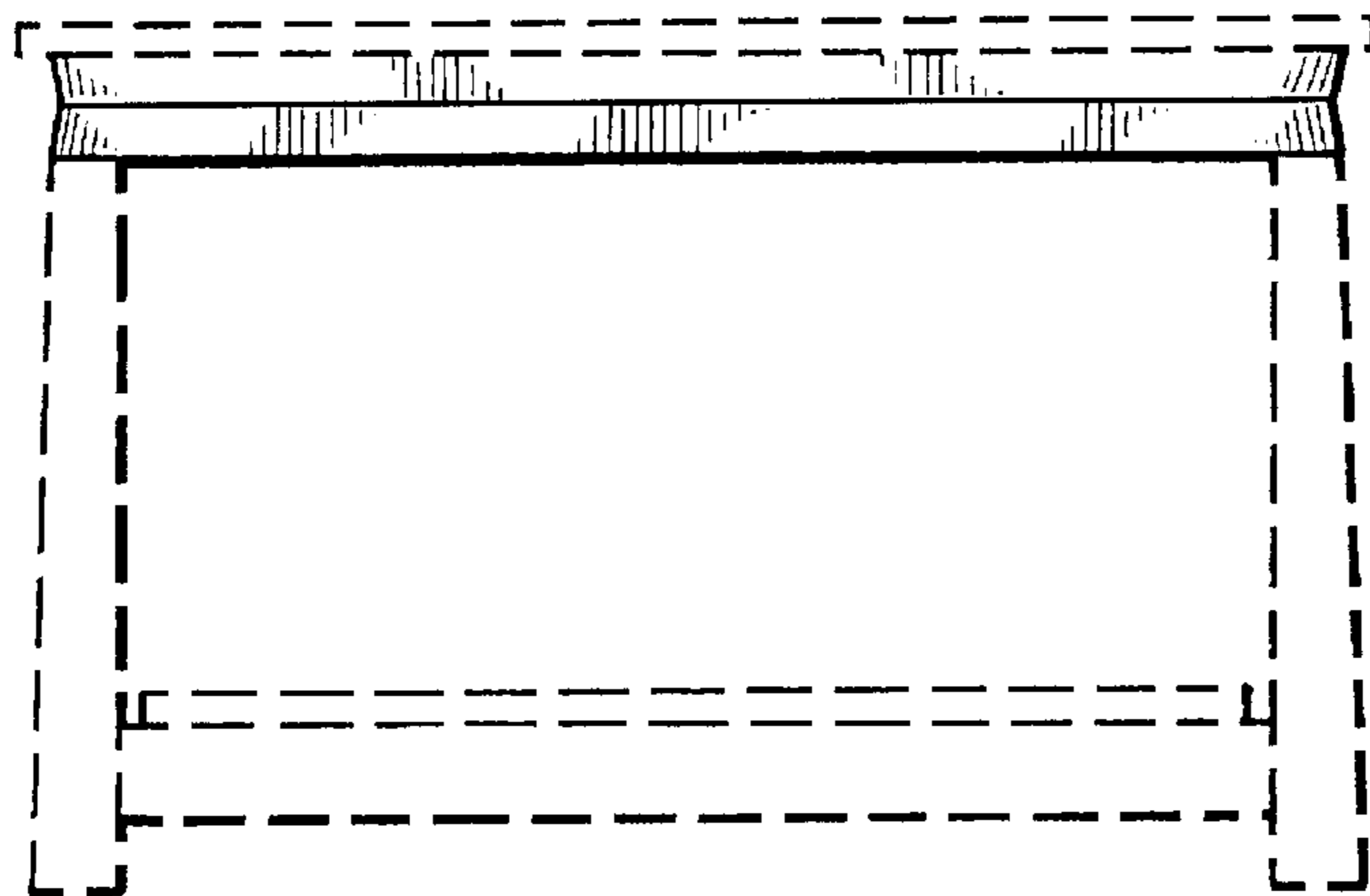

FIG.4

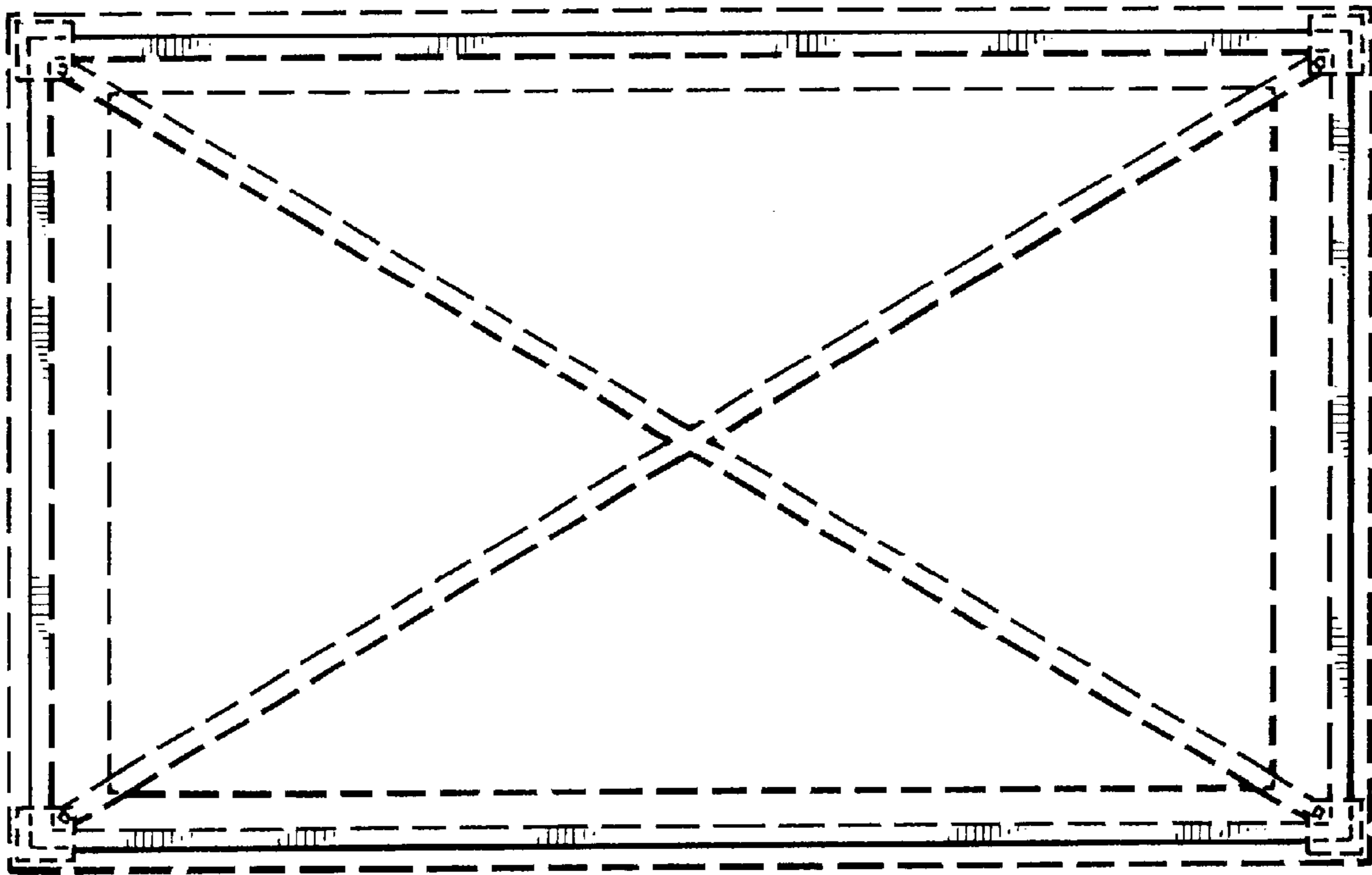

FIG.5

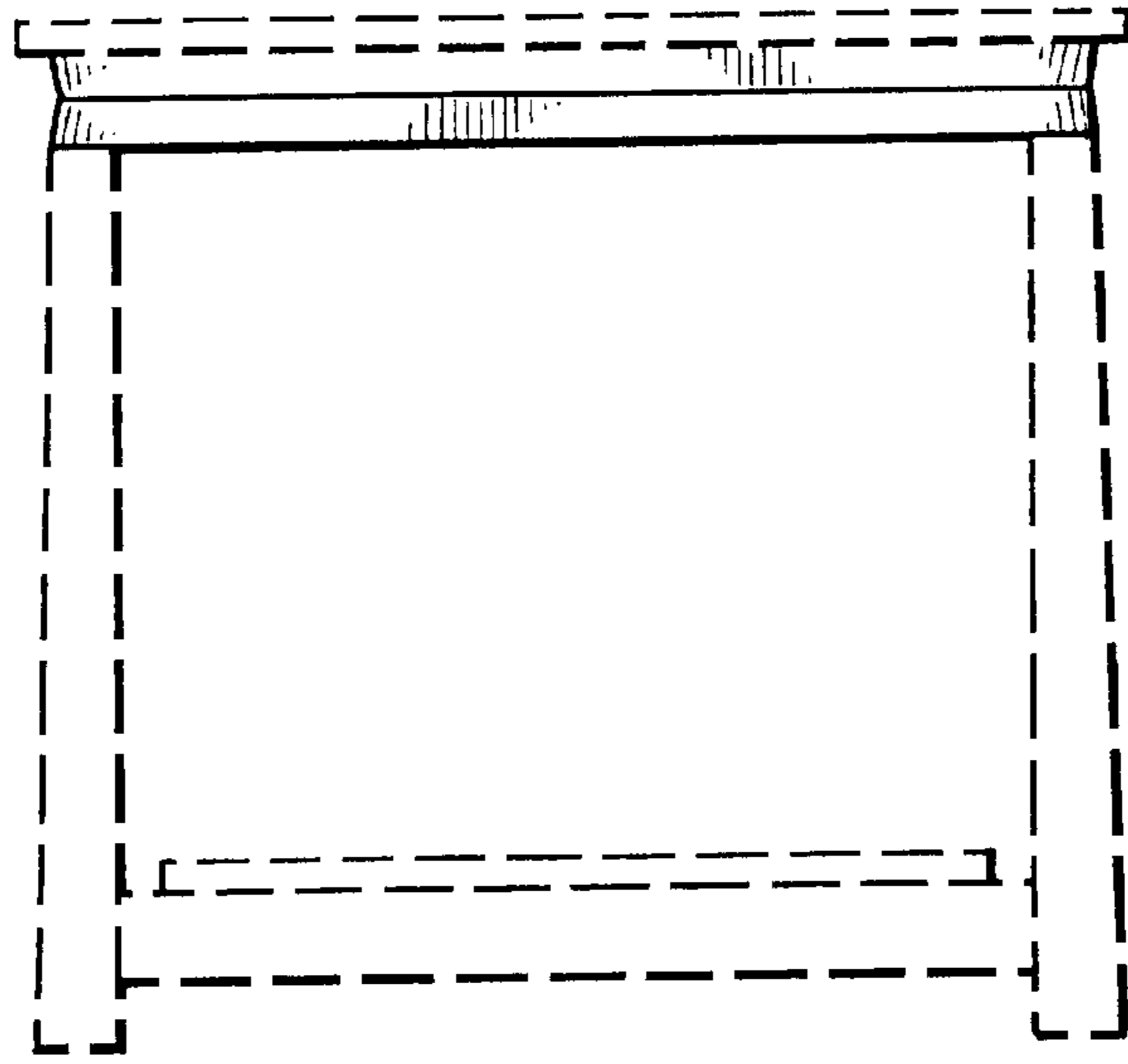

FIG. 6

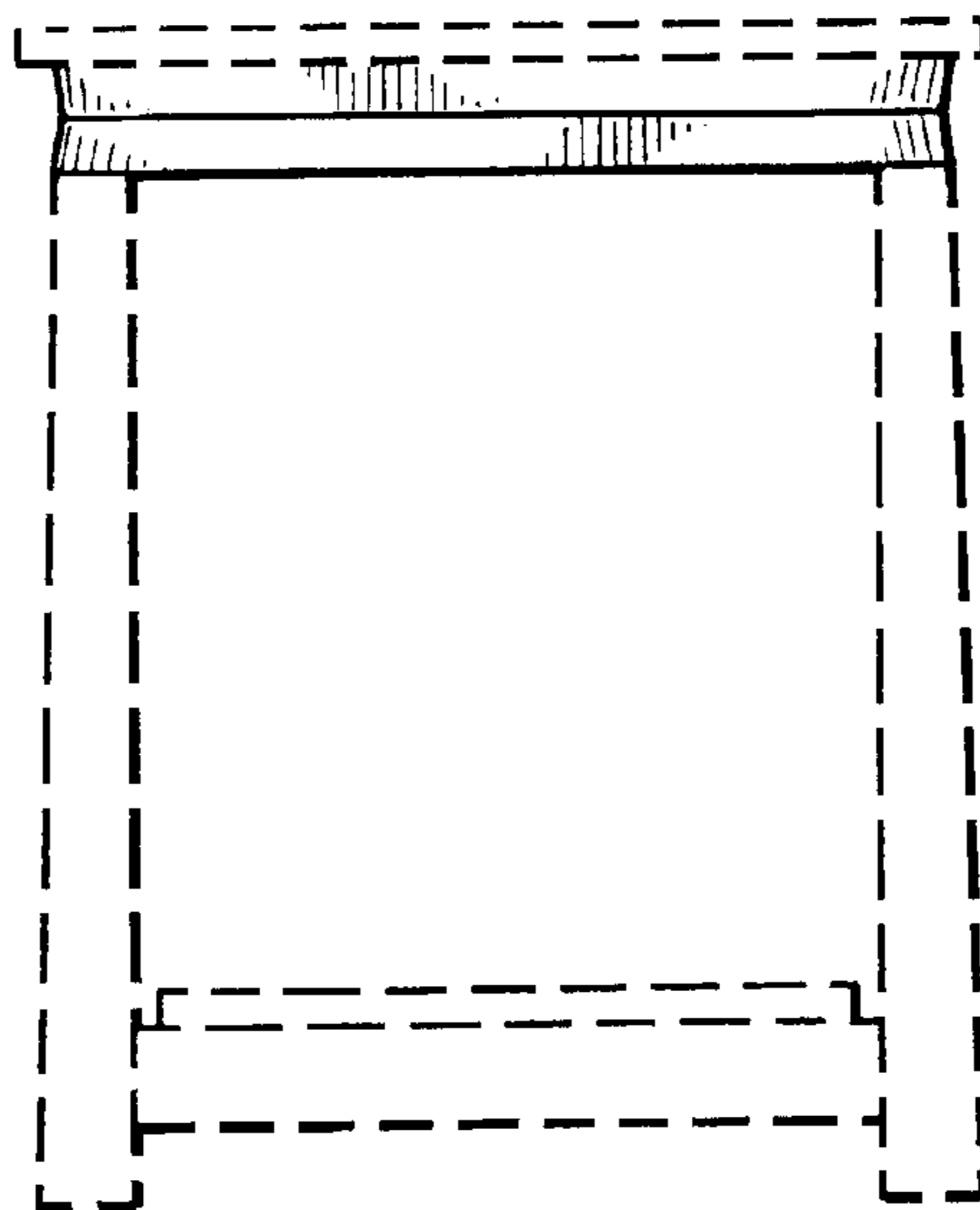

FIG. 7

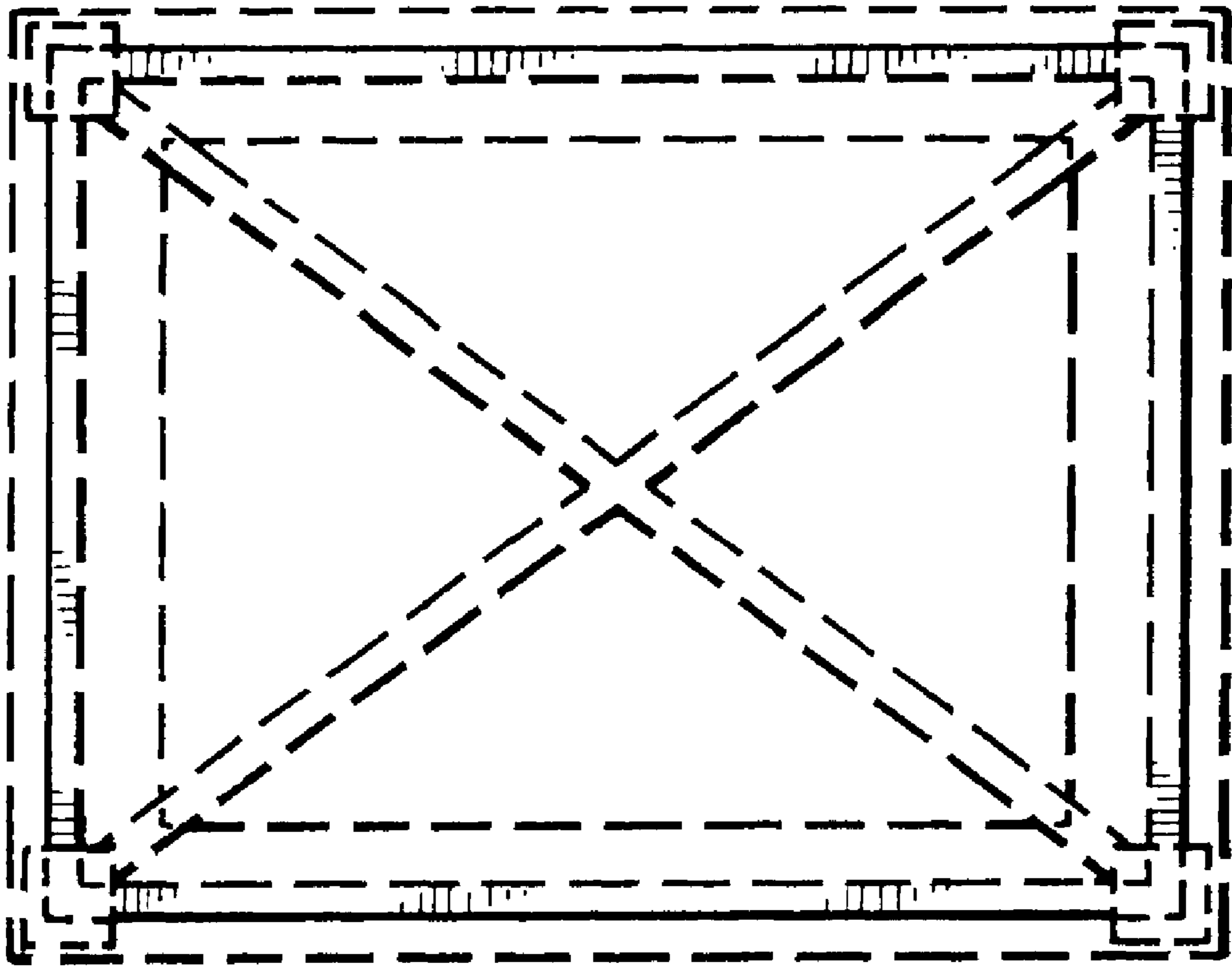

FIG.8