



US00D477133S

(12) **United States Design Patent**  
**Yeh**

(10) **Patent No.:** **US D477,133 S**

(45) **Date of Patent:** **\*\* Jul. 15, 2003**

(54) **KEY CHAIN FOB**

D424,657 S \* 5/2000 Kang et al. .... D22/141  
D443,019 S \* 5/2001 Kang et al. .... D22/141

(76) Inventor: **Shih-Yuan Yeh**, No. 260, Chen-Fu Rd.,  
Tai-Ping City, Taichung Hsien (TW)

\* cited by examiner

(\*\*) Term: **14 Years**

*Primary Examiner*—Ralf Seifert

(74) *Attorney, Agent, or Firm*—Dellett and Walters

(21) Appl. No.: **29/154,031**

(57) **CLAIM**

(22) Filed: **Jan. 11, 2002**

The ornamental design for a key chain fob, as shown and described.

(51) **LOC (7) Cl.** ..... **03-01**

(52) **U.S. Cl.** ..... **D3/211**

(58) **Field of Search** ..... D3/207–211; D26/38,  
D26/46; 70/456 R, 456 B; 24/36; D8/347;  
D22/140, 141

**DESCRIPTION**

FIG. 1 is a perspective view of a key chain fob showing my new design;

FIG. 2 is a front elevational view thereof;

FIG. 3 is a rear elevational view thereof;

FIG. 4 is a left side view thereof;

FIG. 5 is a right side view thereof;

FIG. 6 is a top plain view thereof;

FIG. 7 is a bottom plain view thereof; and,

FIG. 8 is a view showing the application thereof, wherein the broken line portion is for illustrative purpose only and forms no part of the claimed design.

(56) **References Cited**

**U.S. PATENT DOCUMENTS**

D127,727 S	*	6/1941	Pietrzyk	.....	D3/210
D159,984 S	*	9/1950	Jackson	.....	D3/211
2,694,844 A	*	11/1954	Grumbach	.....	24/3.6
2,840,878 A	*	7/1958	Olson	.....	D3/211
D316,443 S	*	4/1991	Yoshikawa et al.	.....	D22/141
D404,793 S	*	1/1999	Oh	.....	D22/141
D414,237 S	*	9/1999	Kang et al.	.....	D22/141

**1 Claim, 5 Drawing Sheets**

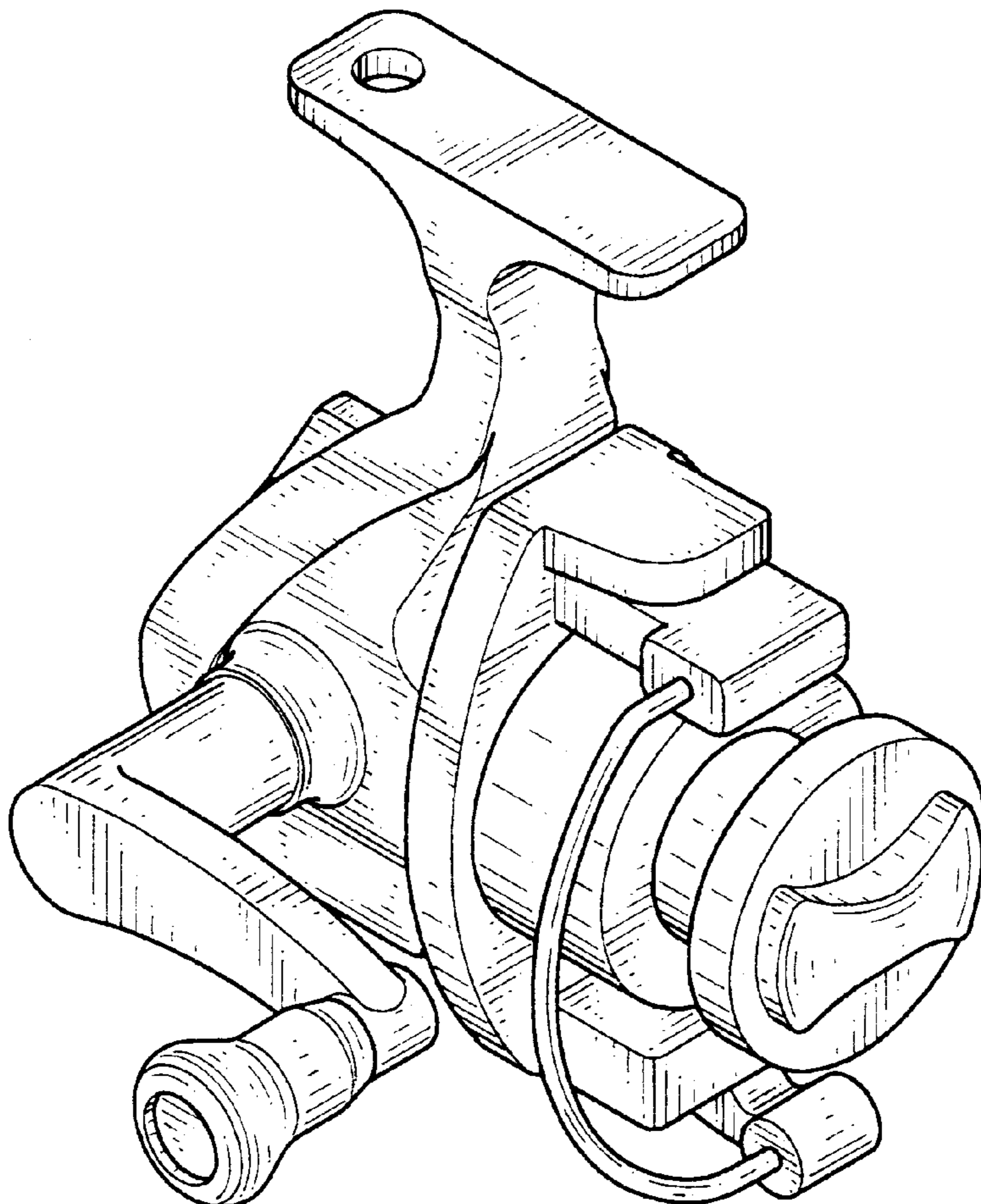

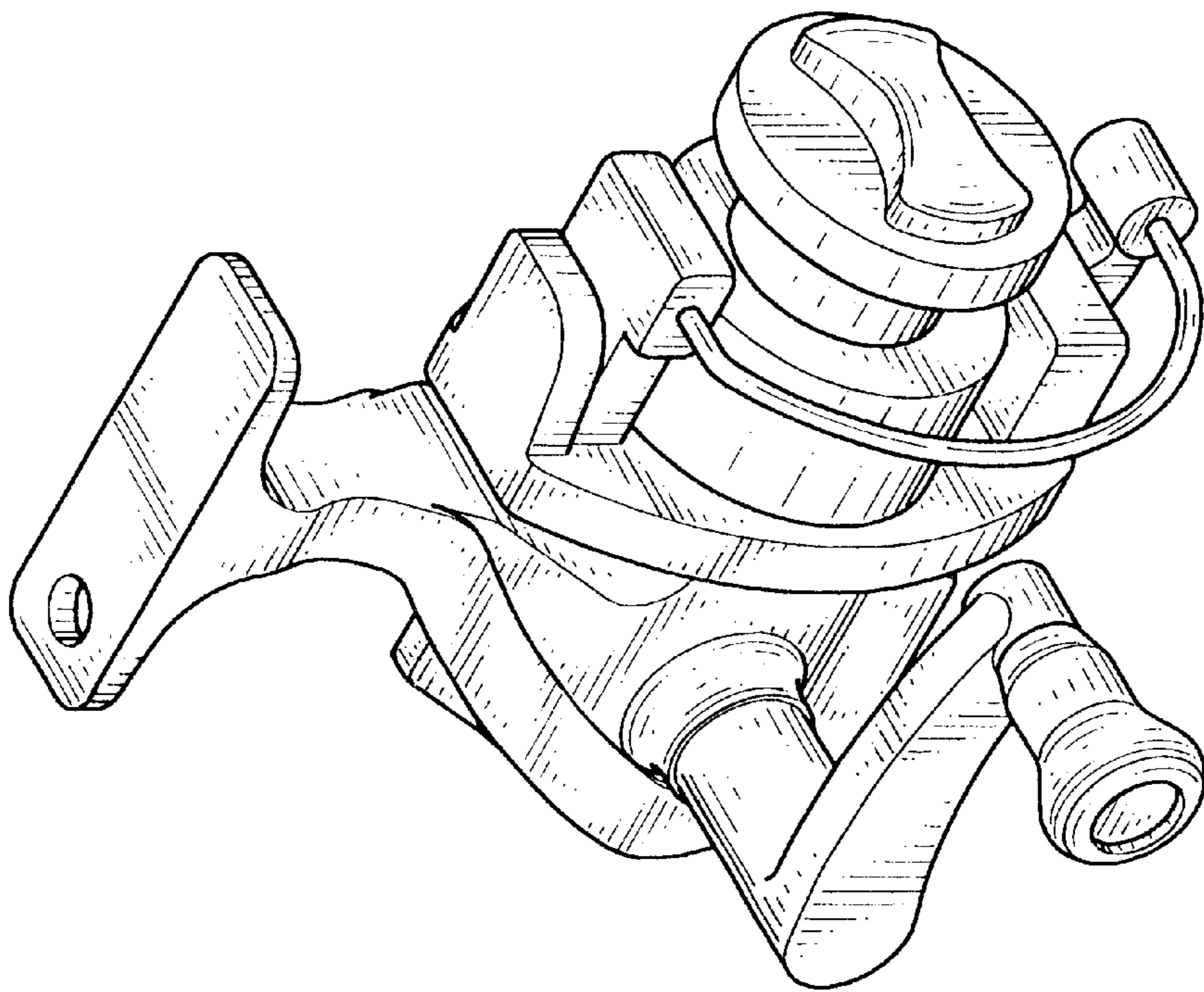

FIG. 1

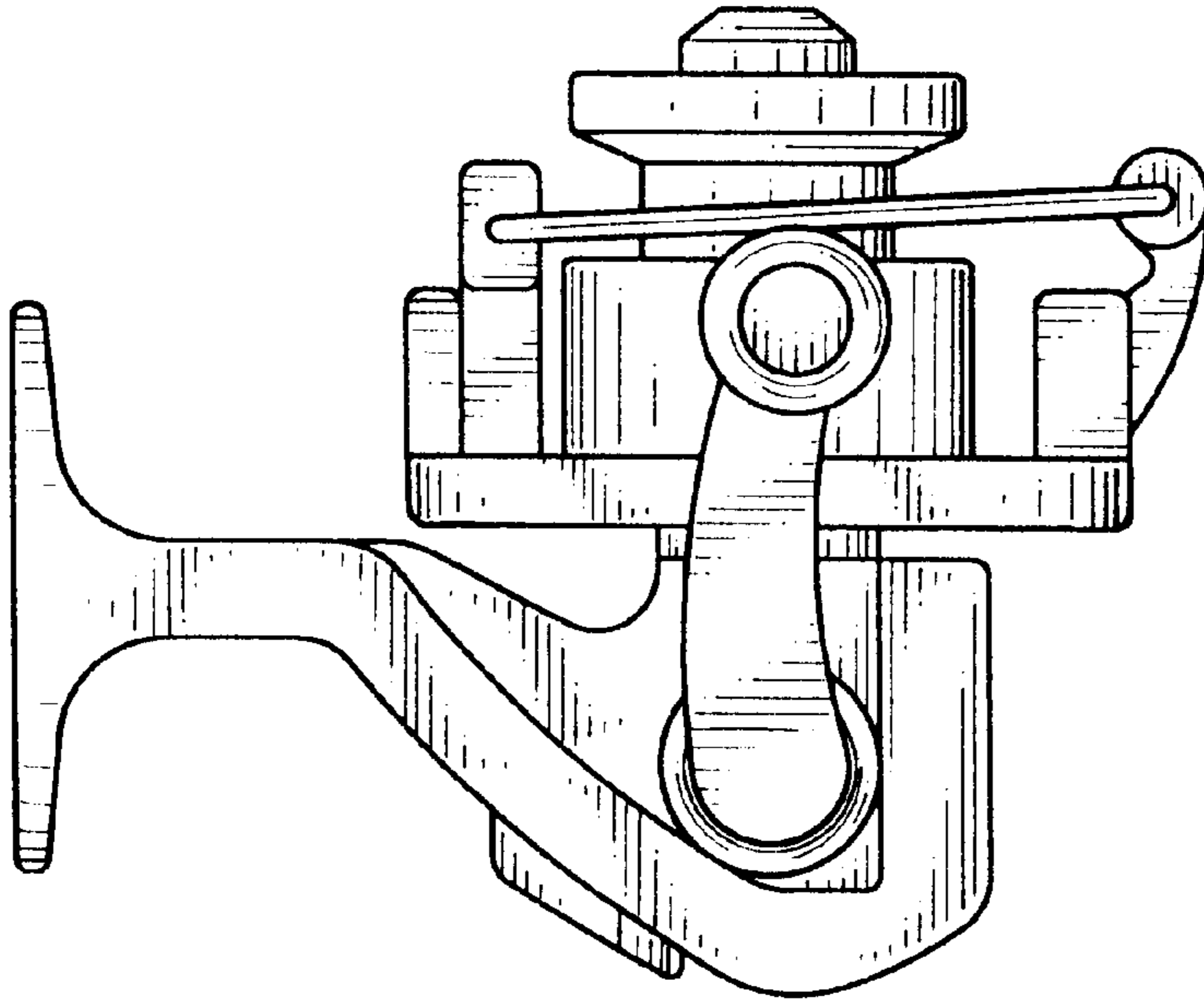

FIG. 2

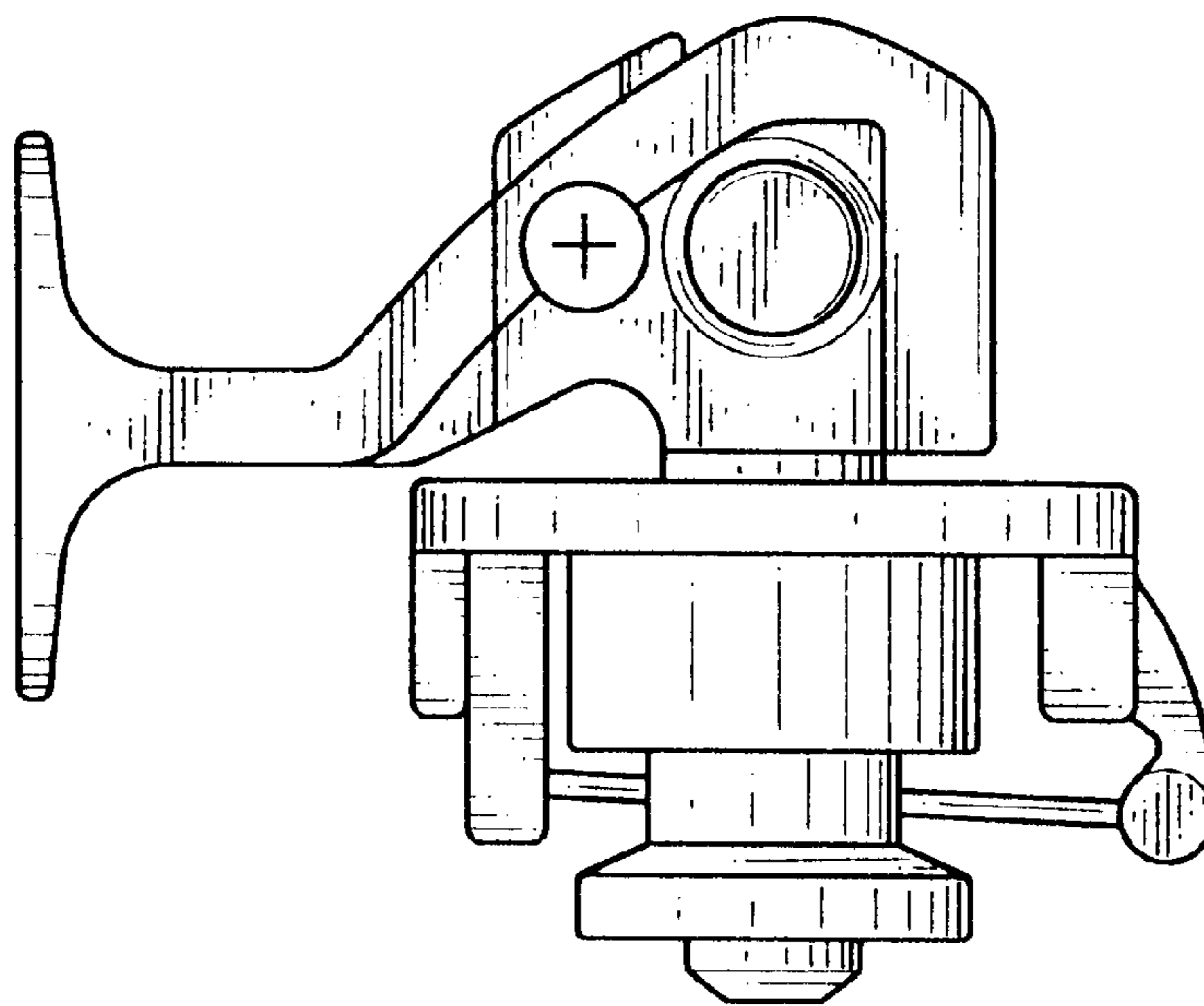

FIG. 3

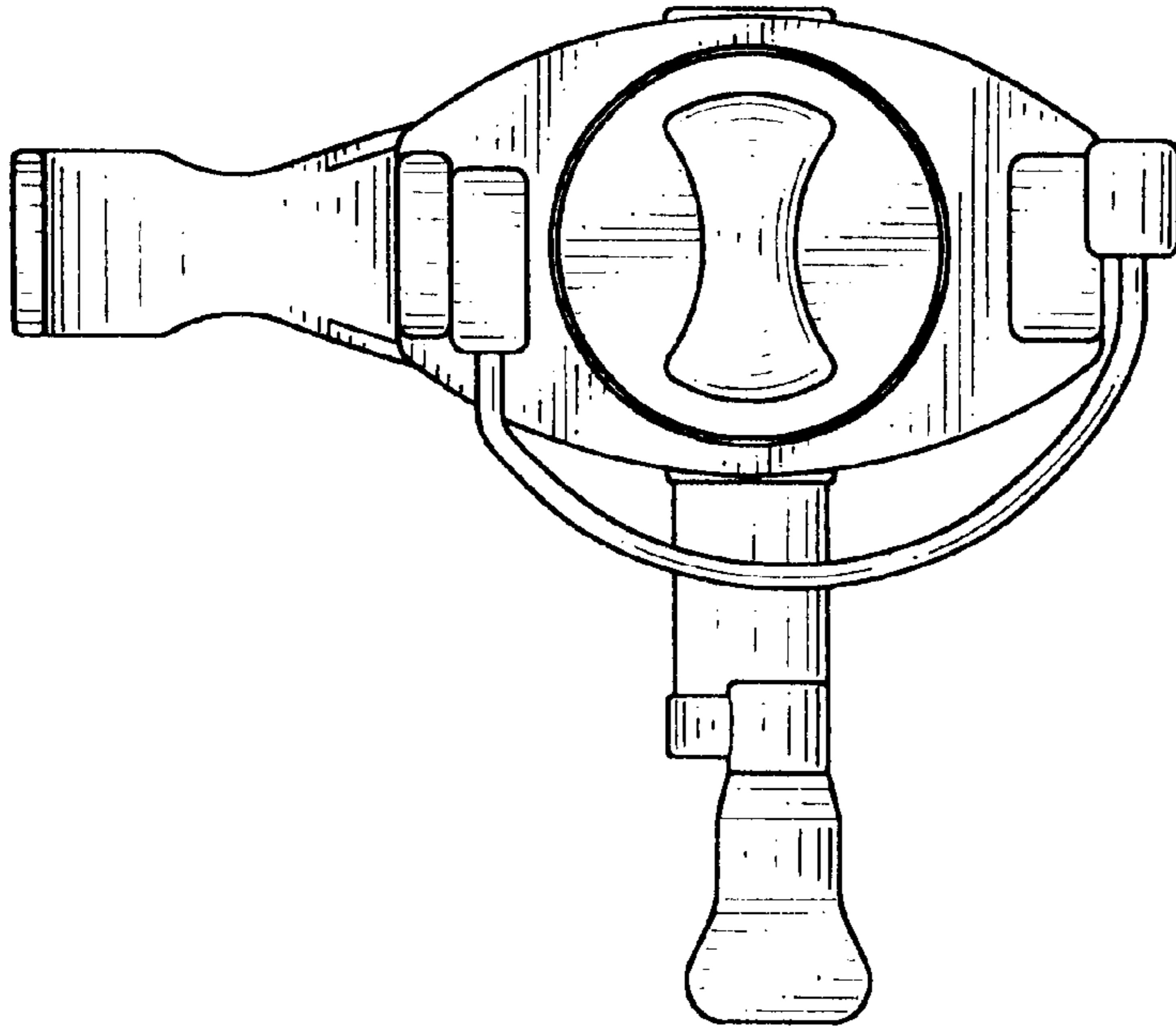

FIG. 5

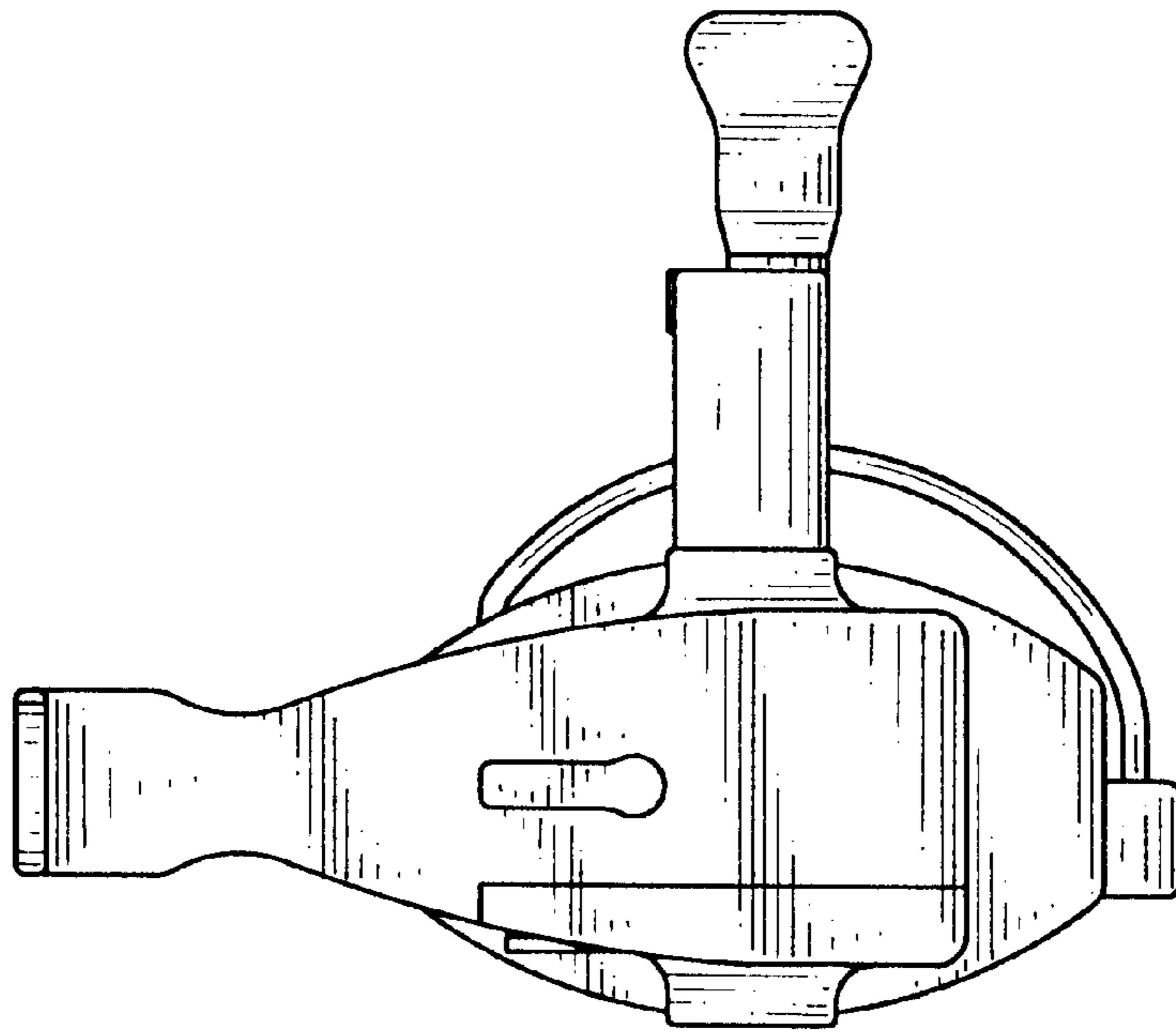

FIG. 4

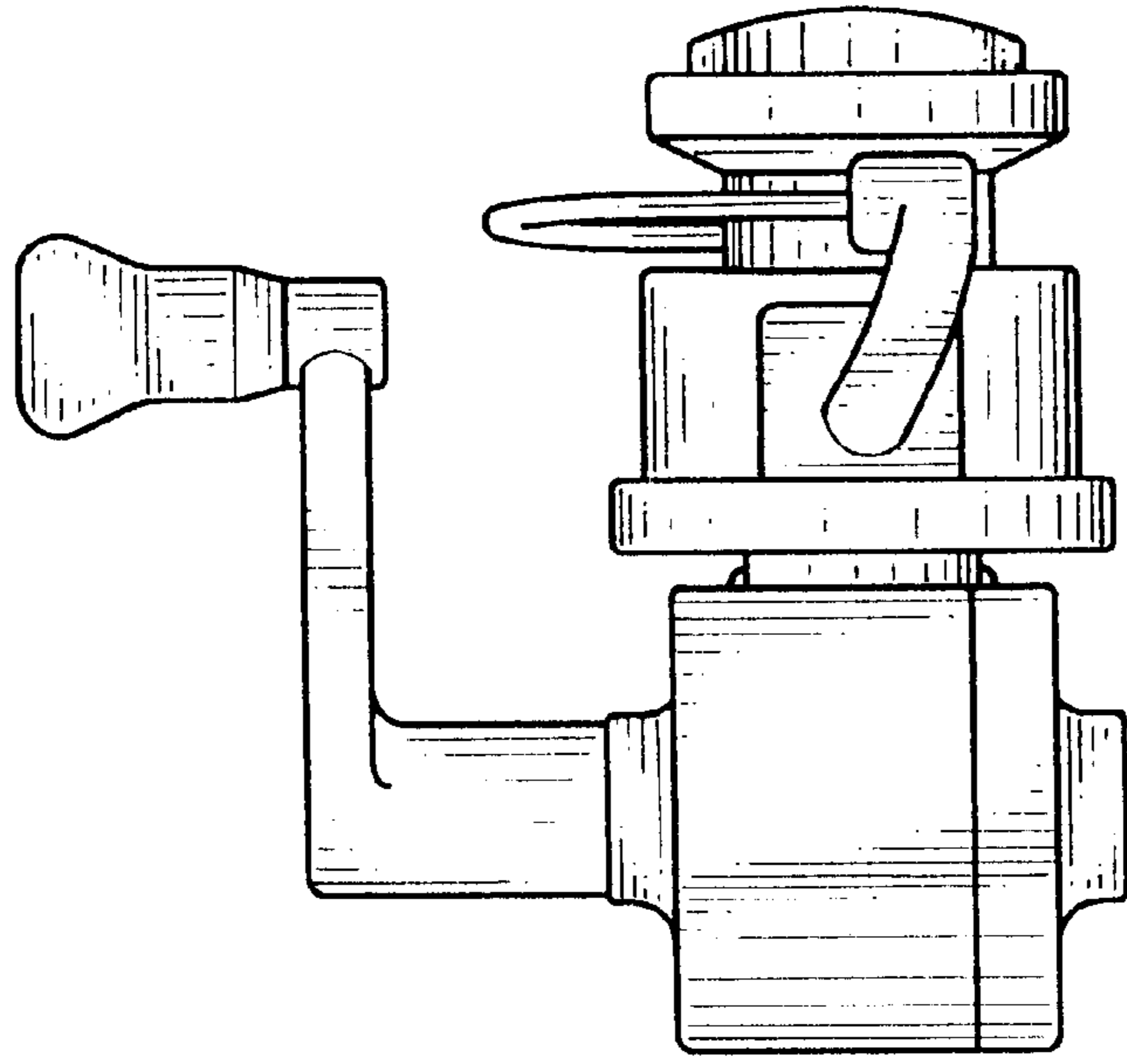

FIG. 6

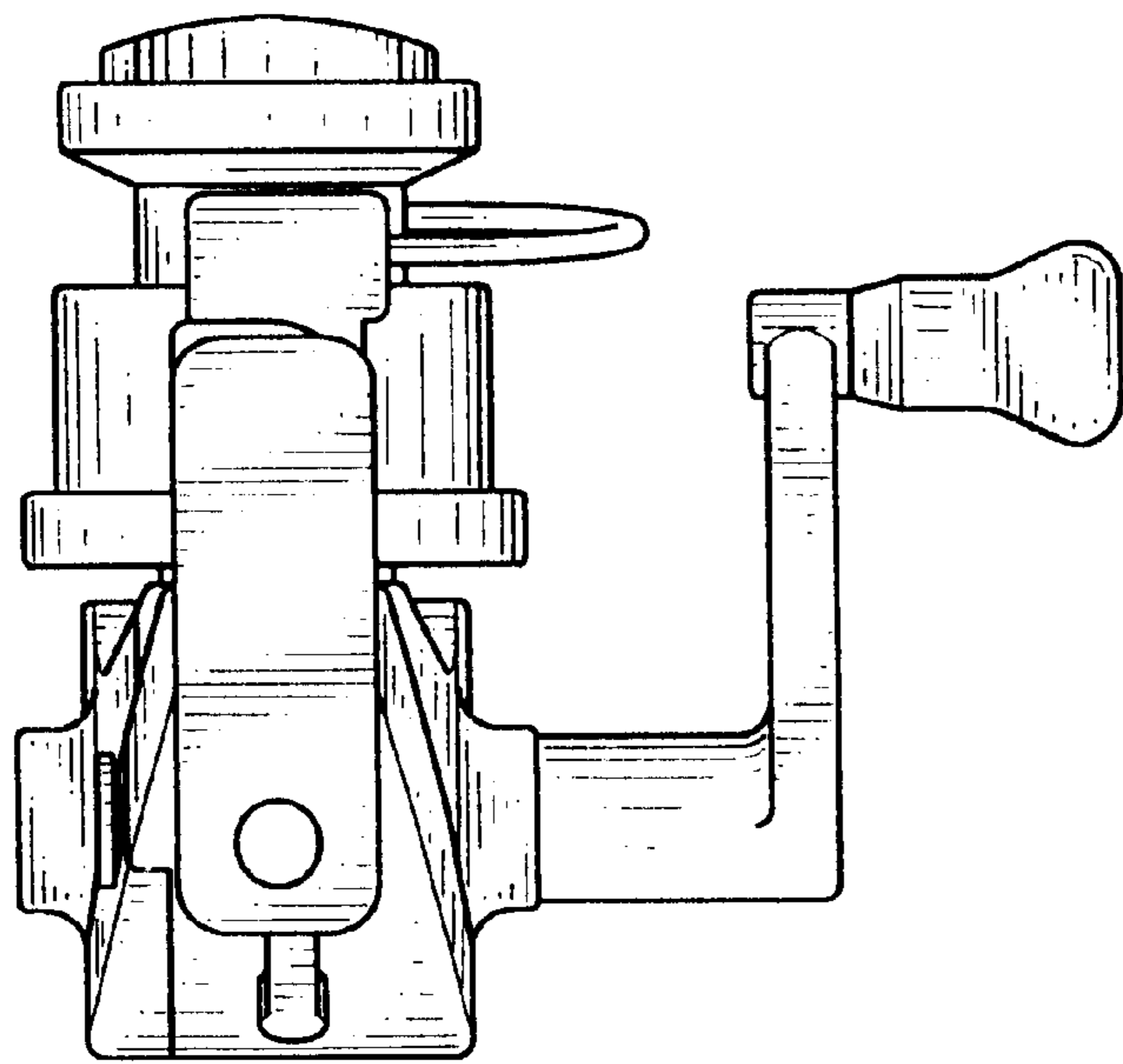

FIG. 7

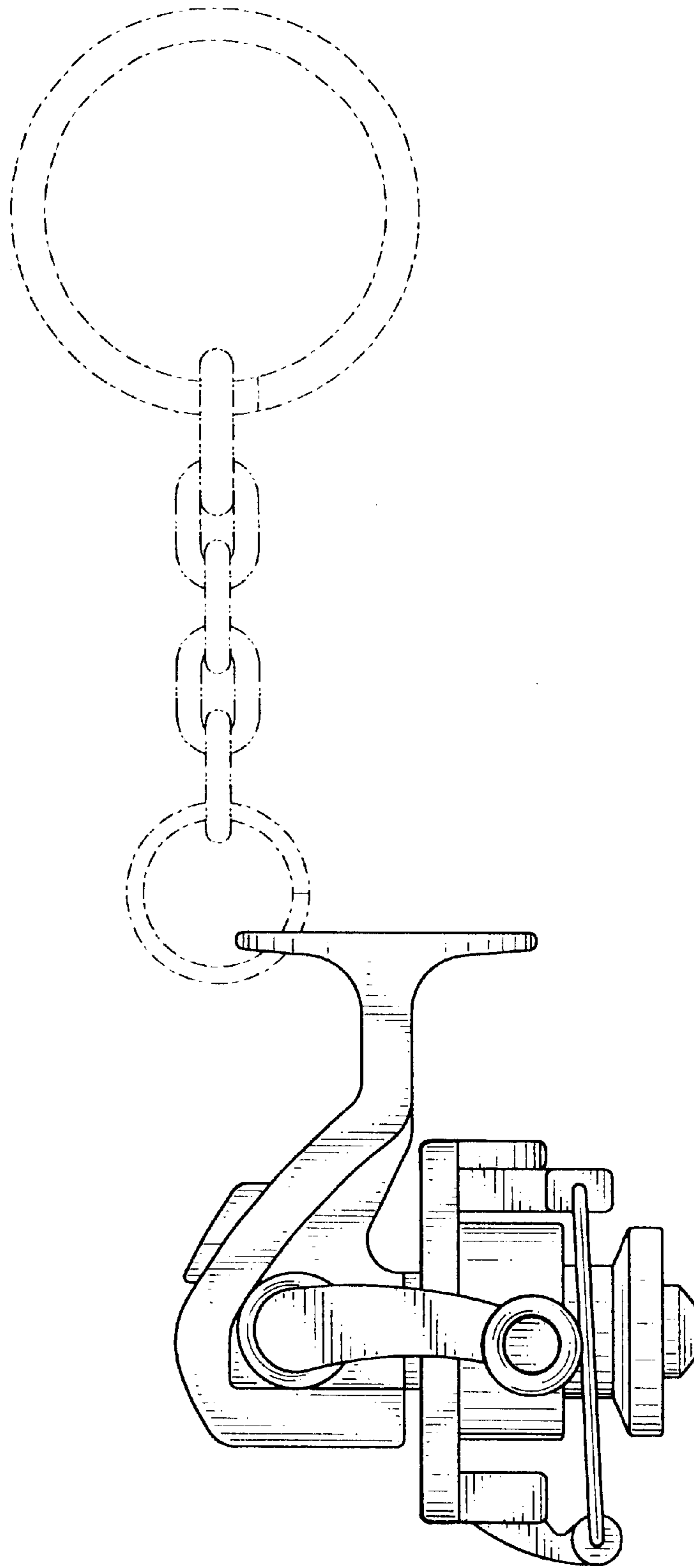

FIG. 8