



US00D474947S

(12) **United States Design Patent**  
**Holmdahl et al.**

(10) **Patent No.:** **US D474,947 S**

(45) **Date of Patent:** **\*\* May 27, 2003**

(54) **TRIMMER AND STARTING DEVICE**

(75) Inventors: **Mikael Holmdahl**, Jönköping (SE);  
**Claes Losdahl**, Huskvarna (SE);  
**Marcus Kragner**, Huskvarna (SE);  
**Stina Nilimaa-Wickström**, Nacka (SE)

(73) Assignee: **Aktiebolaget Electrolux**, Stockholm (SE)

(\*\*) Term: **14 Years**

(21) Appl. No.: **29/163,503**

(22) Filed: **Jul. 3, 2002**

(51) **LOC (7) Cl.** ..... **08-01**

(52) **U.S. Cl.** ..... **D8/8**

(58) **Field of Search** ..... D8/8, 9; 30/276,  
30/DIG. 5, 228; 172/13, 14; 56/12.7

(56) **References Cited**

**U.S. PATENT DOCUMENTS**

D303,671 S \* 9/1989 Kiyooka et al. .... D8/8

D347,772 S \* 6/1994 Kiyooka et al. .... D8/8

D356,013 S \* 3/1995 Kiyooka et al. .... D8/8

D360,341 S \* 7/1995 Hirooka et al. .... D8/8

\* cited by examiner

*Primary Examiner*—Robin V. Taylor

(74) *Attorney, Agent, or Firm*—Pearne & Gordon LLP

(57) **CLAIM**

The ornamental design for a trimmer and starting device, as shown and described.

**DESCRIPTION**

FIG. 1 is an enlarged rear view, showing our new trimmer. FIG. 2 is a rear perspective view of the trimmer thereof; FIG. 3 is a front perspective view of the trimmer thereof; FIG. 4 is a left side elevation view of the trimmer thereof; FIG. 5 is a top plan view of the trimmer thereof; FIG. 6 is a bottom plan view of the trimmer thereof; and, FIG. 7 is a right side elevation view of the trimmer thereof.

**1 Claim, 4 Drawing Sheets**

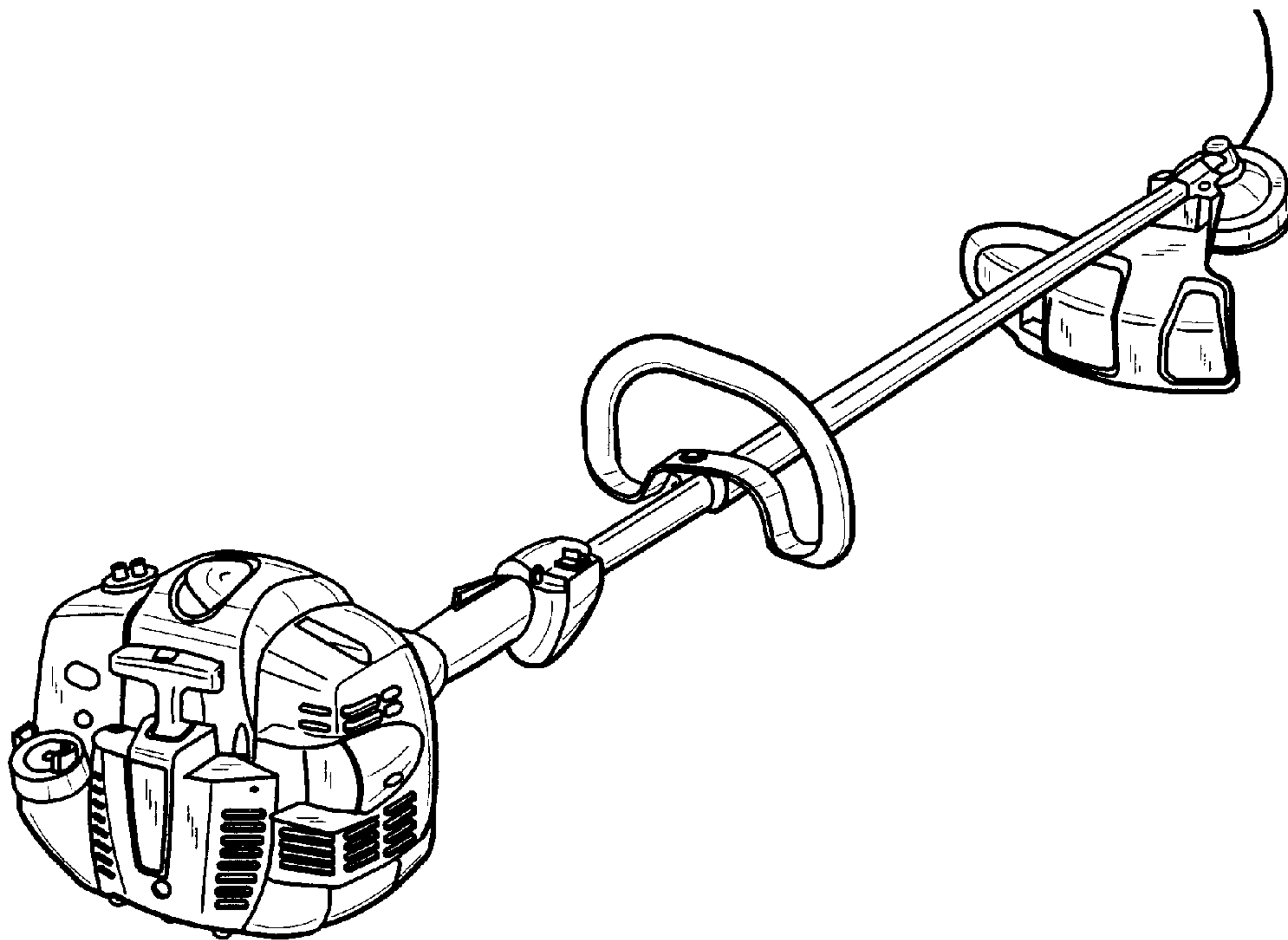

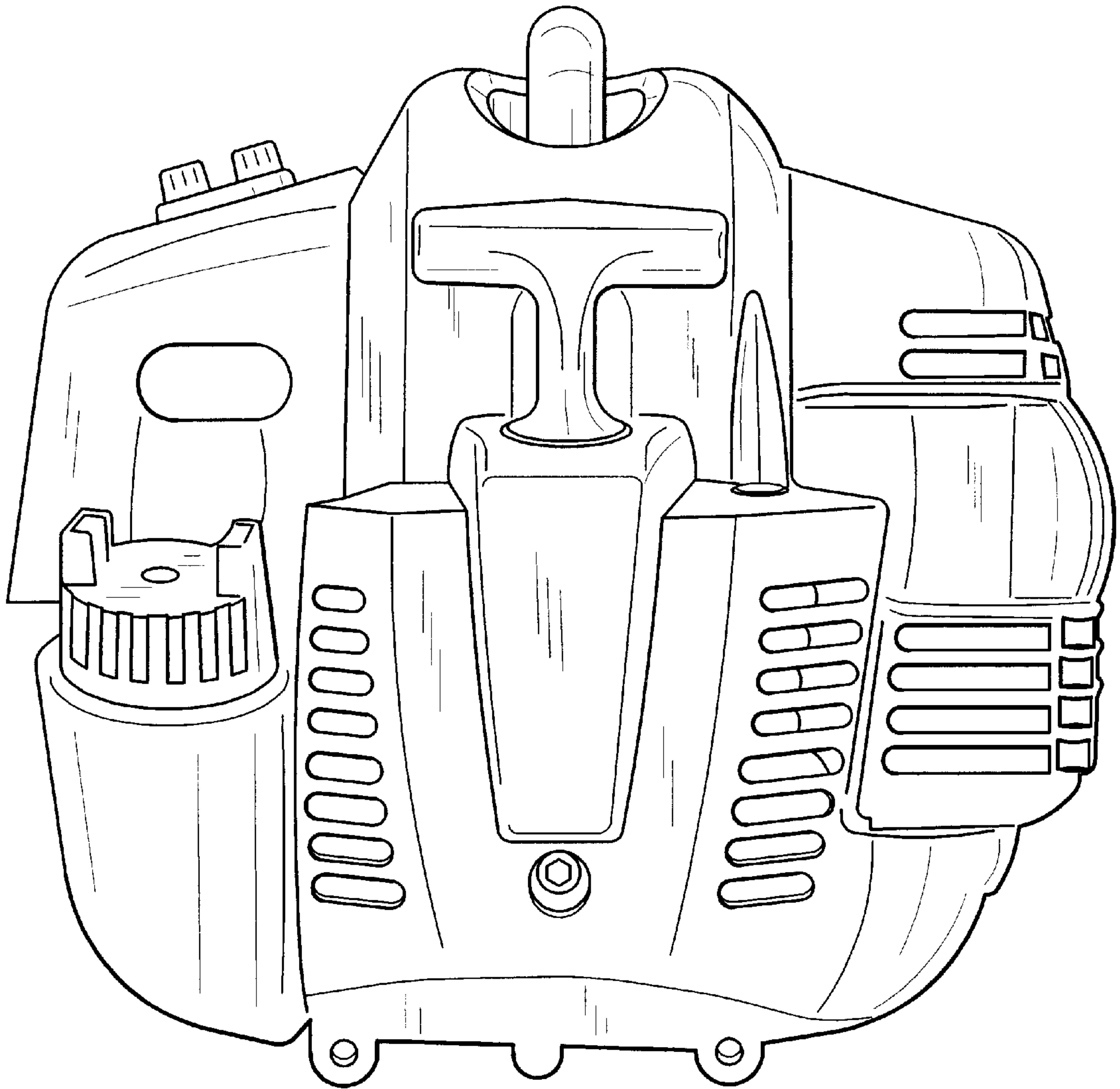

FIG. 1

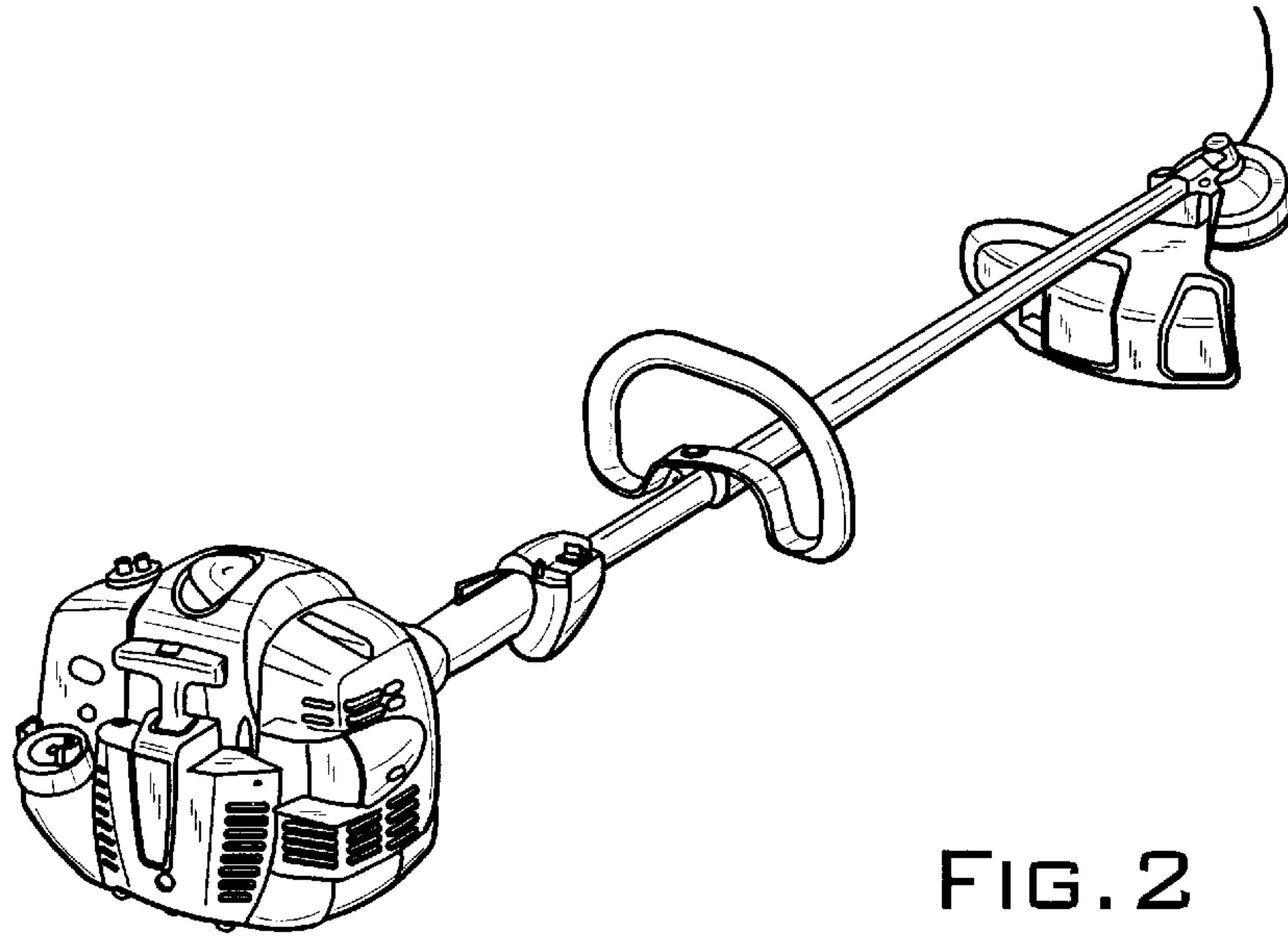

FIG. 2

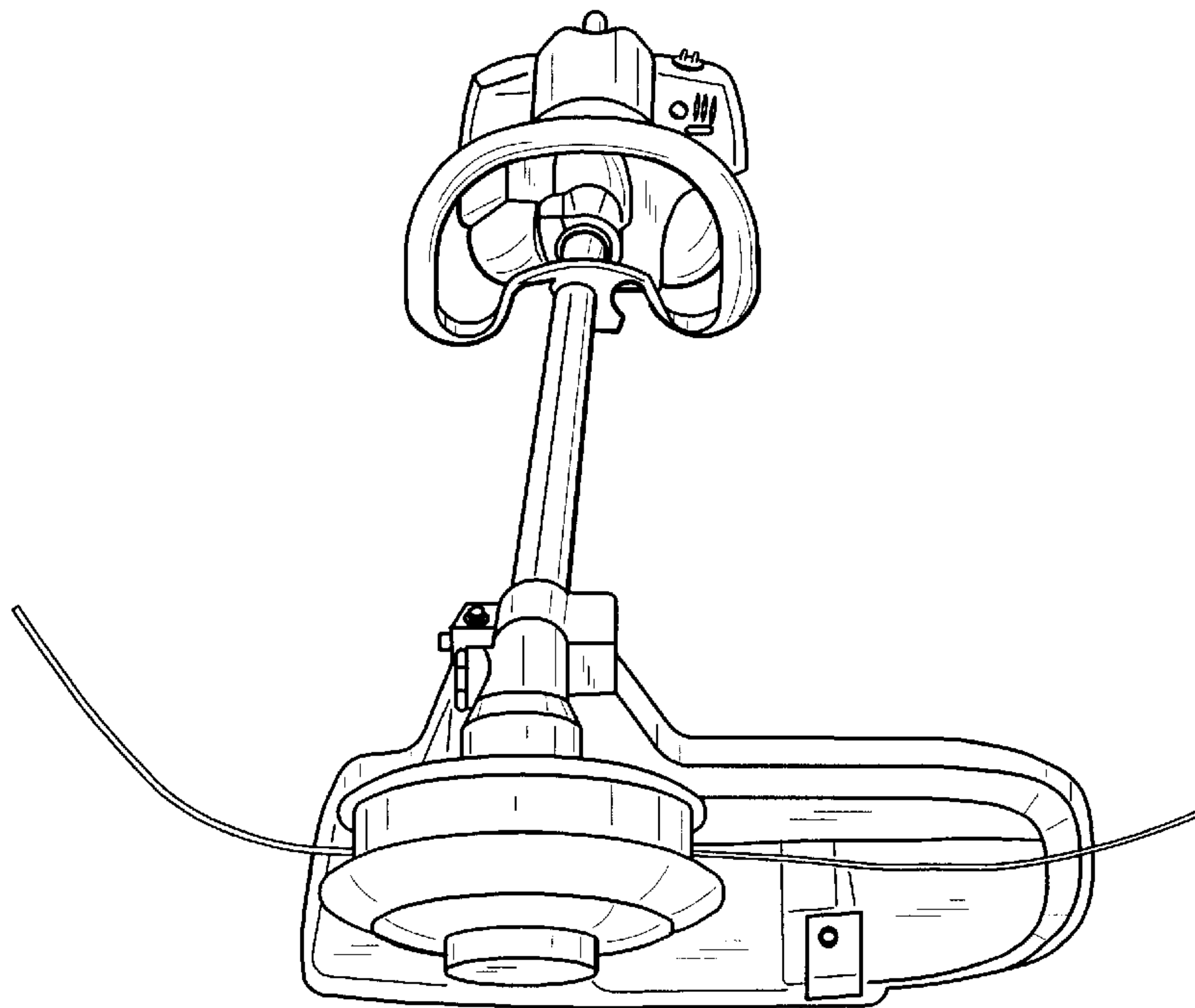

FIG. 3

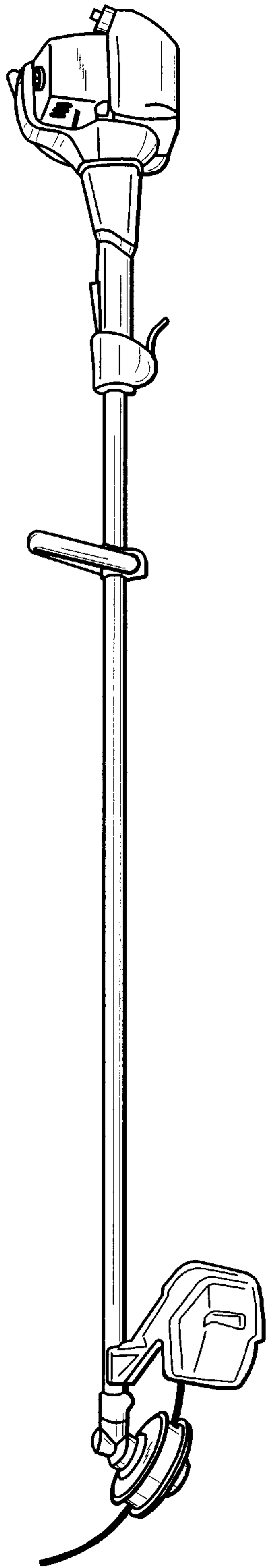

FIG. 4

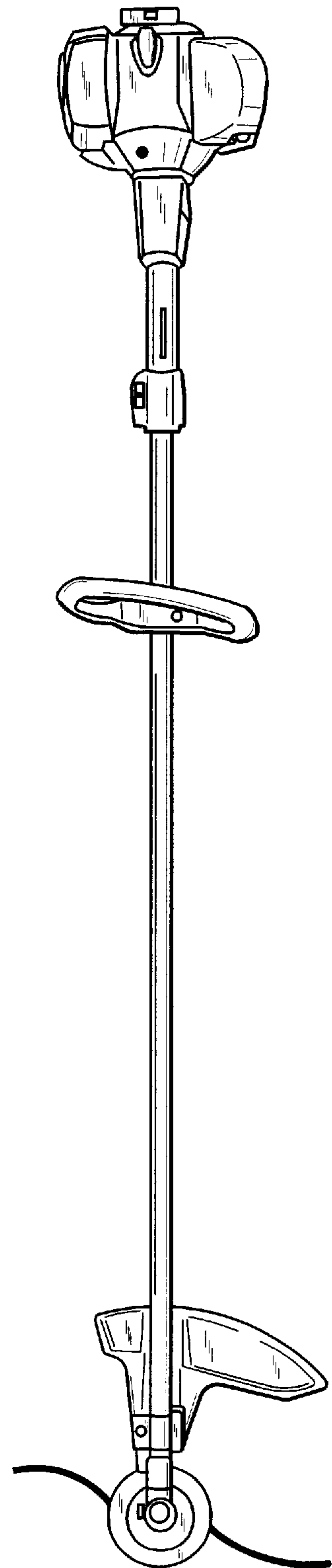

FIG. 5

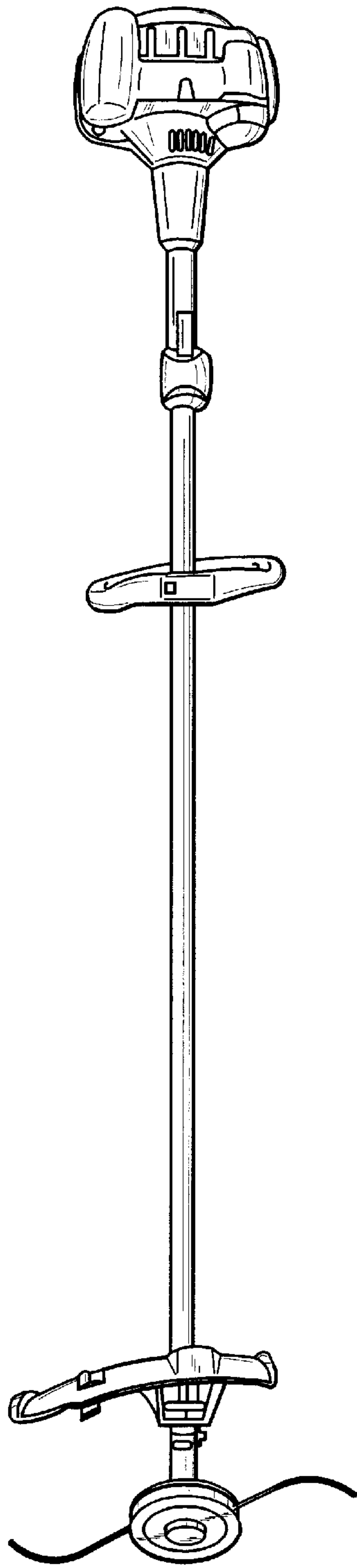

FIG. 6

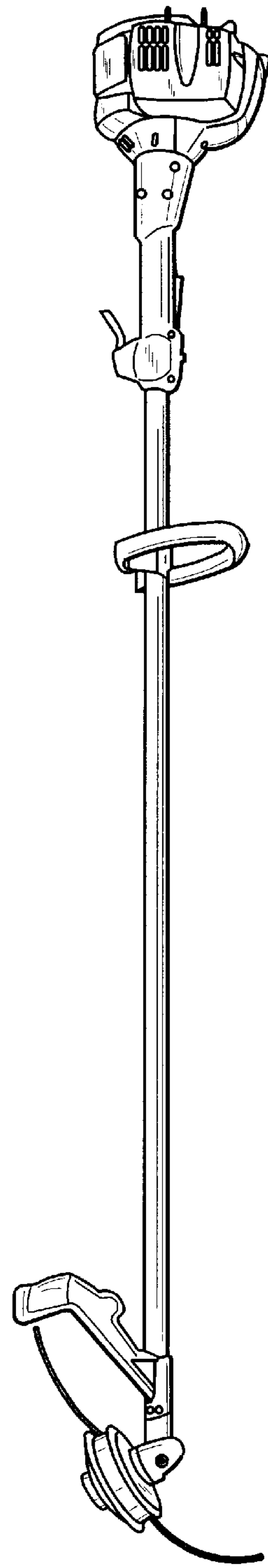

FIG. 7