



US00D474400S

(12) **United States Design Patent**  
**Humphrey**

(10) **Patent No.:** **US D474,400 S**

(45) **Date of Patent:** **\*\* May 13, 2003**

(54) **PACKAGE**

(75) **Inventor:** **Neill W. Humphrey**, El Dorado Hills, CA (US)

(73) **Assignee:** **Trade Source International**, El Dorado Hills, CA (US)

(\*\*) **Term:** **14 Years**

(21) **Appl. No.:** **29/170,842**

(22) **Filed:** **Nov. 12, 2002**

5,289,916 A	*	3/1994	Mickelberg	.....	206/756
D449,519 S	*	10/2001	Humphrey	.....	D9/415
D453,901 S	*	2/2002	Shepperson	.....	D9/415
D455,649 S	*	4/2002	Humphrey	.....	D9/415
D458,839 S	*	6/2002	Weinstein et al.	.....	D9/415
D466,009 S	*	11/2002	Humphrey	.....	D9/415
D467,494 S	*	12/2002	Udwin et al.	.....	D9/415

\* cited by examiner

*Primary Examiner*—Prabhakar Deshmukh  
(74) *Attorney, Agent, or Firm*—Oppenheimer Wolff & Donnelly LLP

**Related U.S. Application Data**

(62) Division of application No. 29/162,130, filed on Jun. 10, 2002, which is a division of application No. 29/137,251, filed on Feb. 15, 2001, now Pat. No. Des. 466,009.

- (51) **LOC (7) Cl.** ..... **09-03**
- (52) **U.S. Cl.** ..... **D9/415**
- (58) **Field of Search** ..... D9/415, 418, 337,  
D9/341, 430; 206/461–471, 495, 775–783,  
765, 756, 757, 320

(56) **References Cited**

**U.S. PATENT DOCUMENTS**

5,002,187 A \* 3/1991 Rysner et al. .... 206/461

(57) **CLAIM**

The ornamental design for a package, as shown and described.

**DESCRIPTION**

FIG. 1 is a front perspective view of a package showing my new design;  
FIG. 2 is a top plan view thereof;  
FIG. 3 is a left side elevational view thereof;  
FIG. 4 is a right side elevational view thereof; and,  
FIG. 5 is a bottom plan view thereof.

**1 Claim, 2 Drawing Sheets**

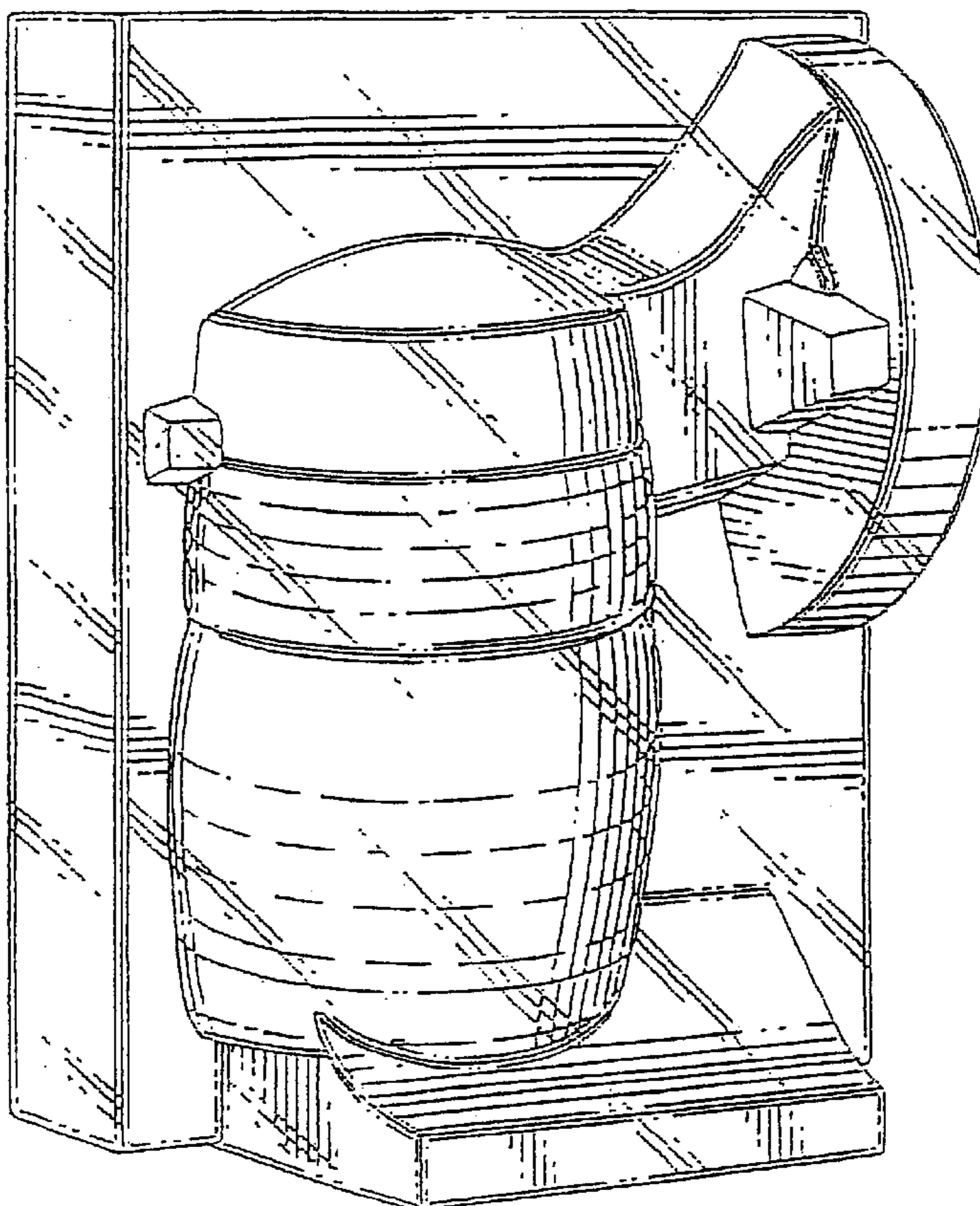

*FIG. 1*

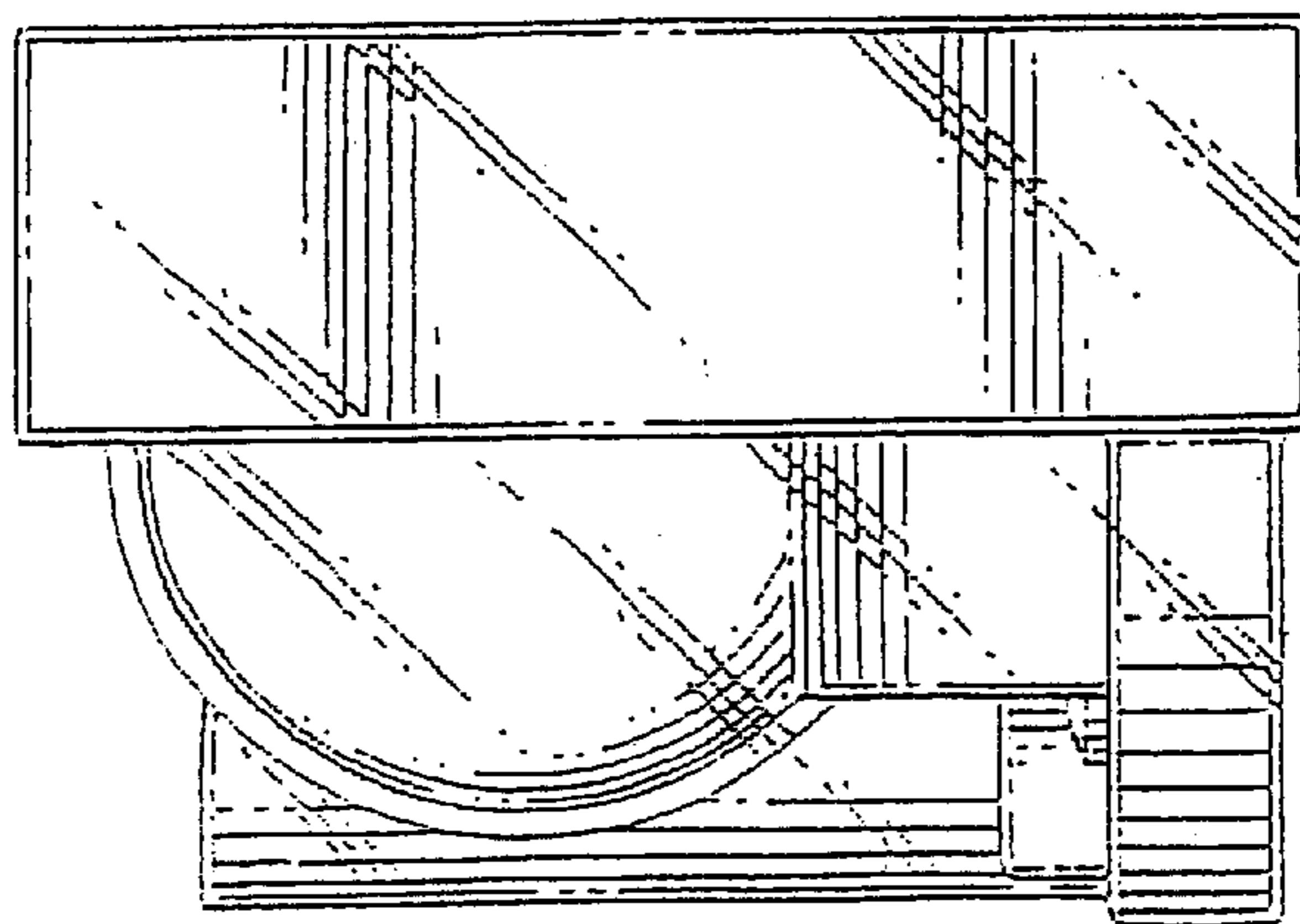
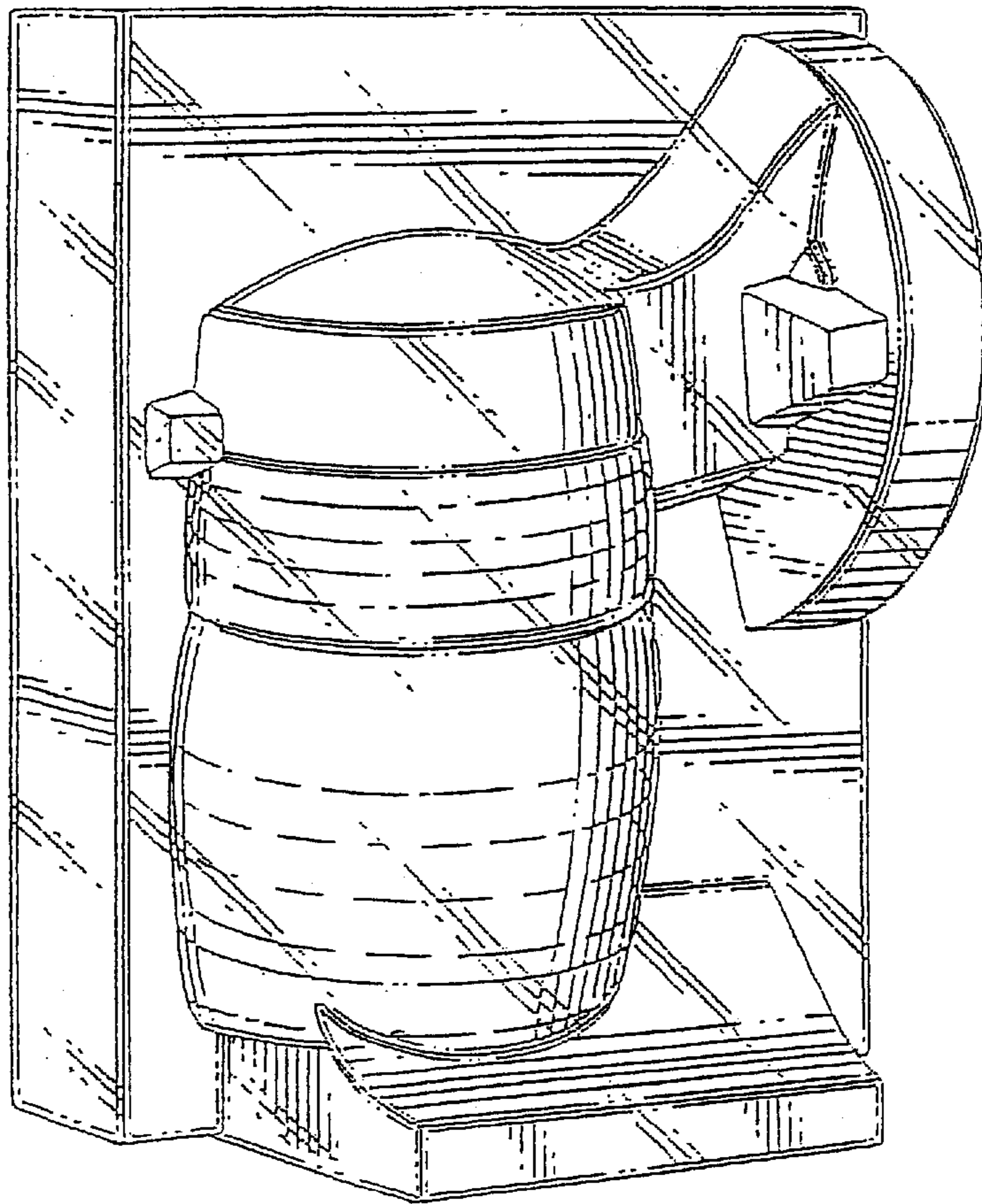

*FIG. 2*

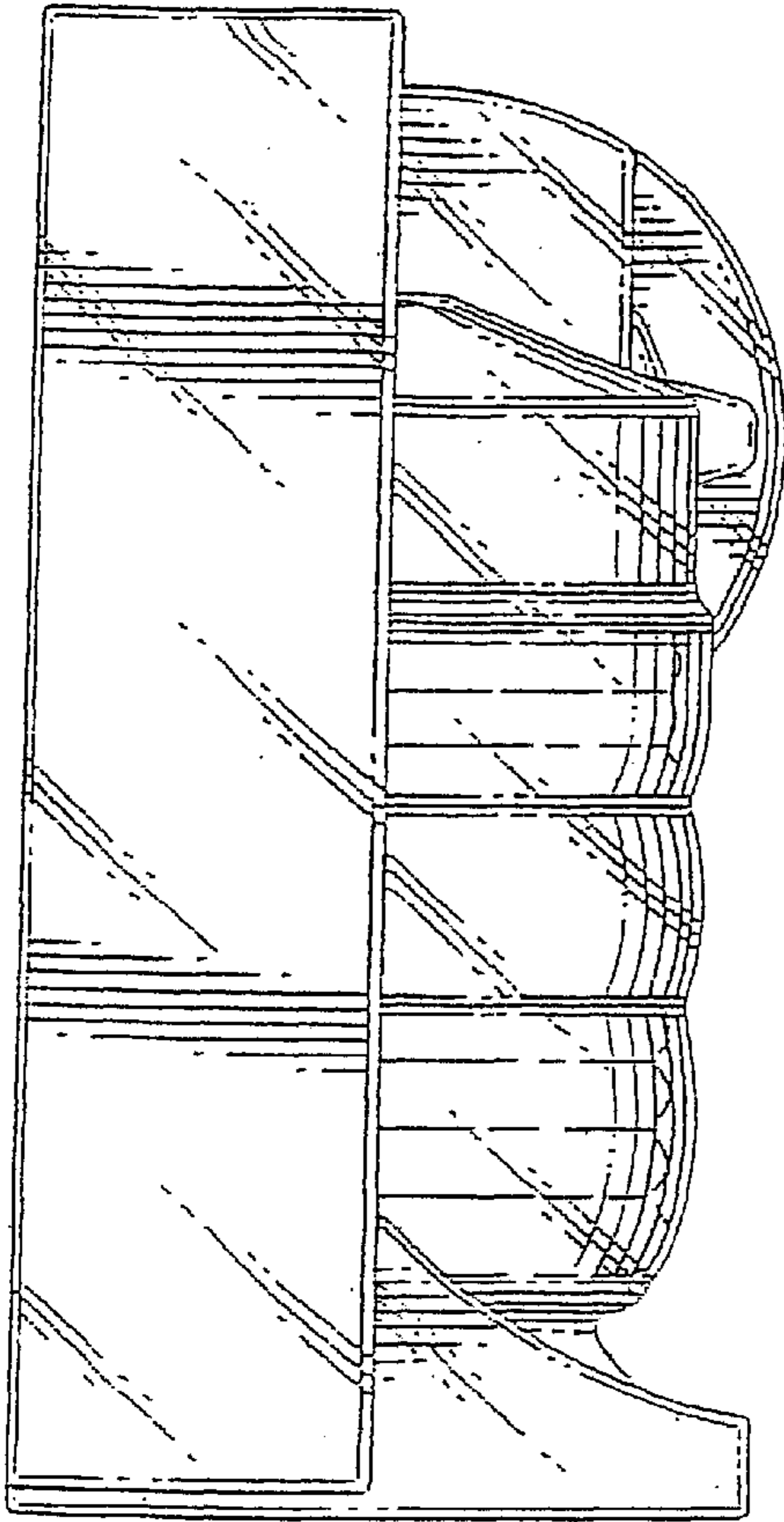

*FIG. 3*

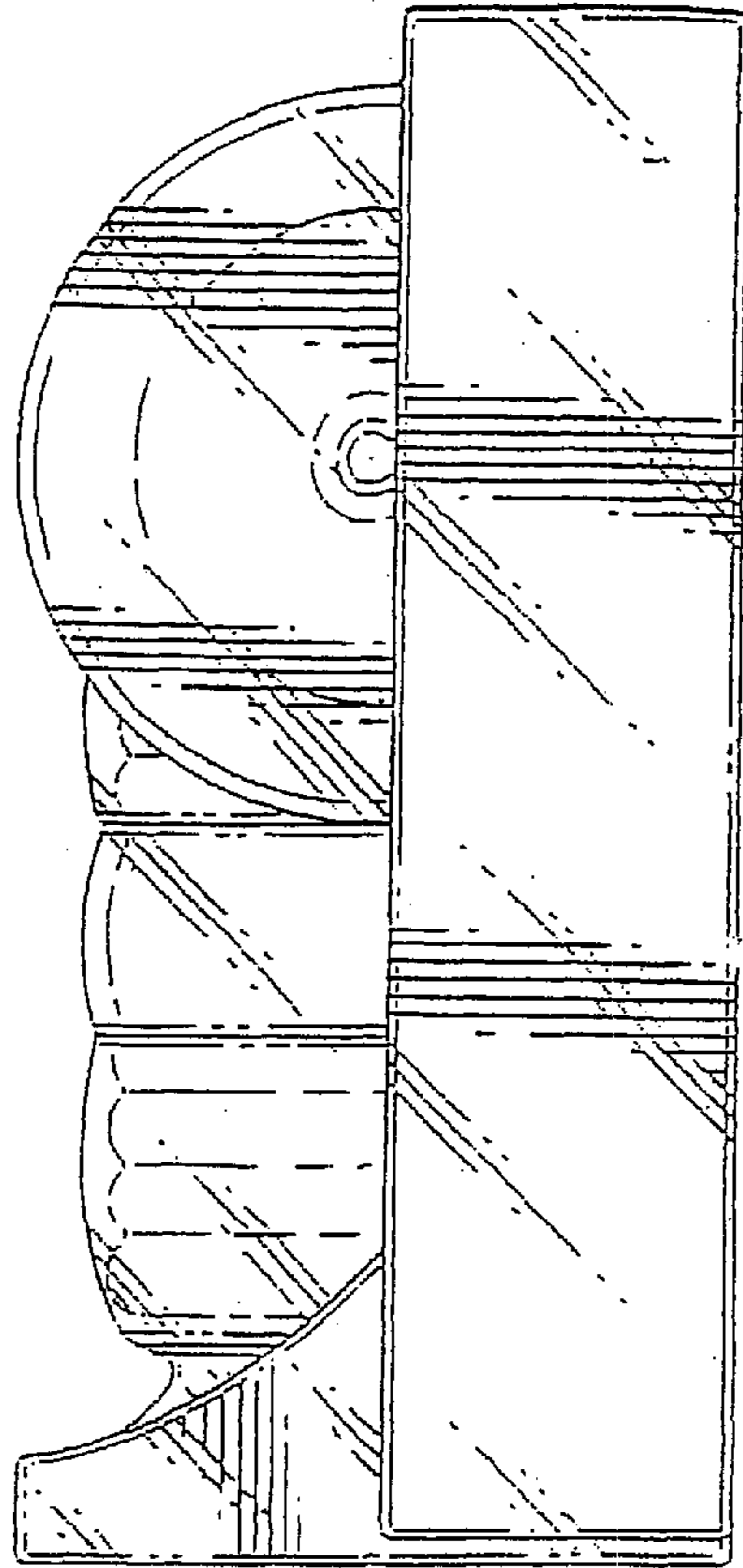

*FIG. 4*

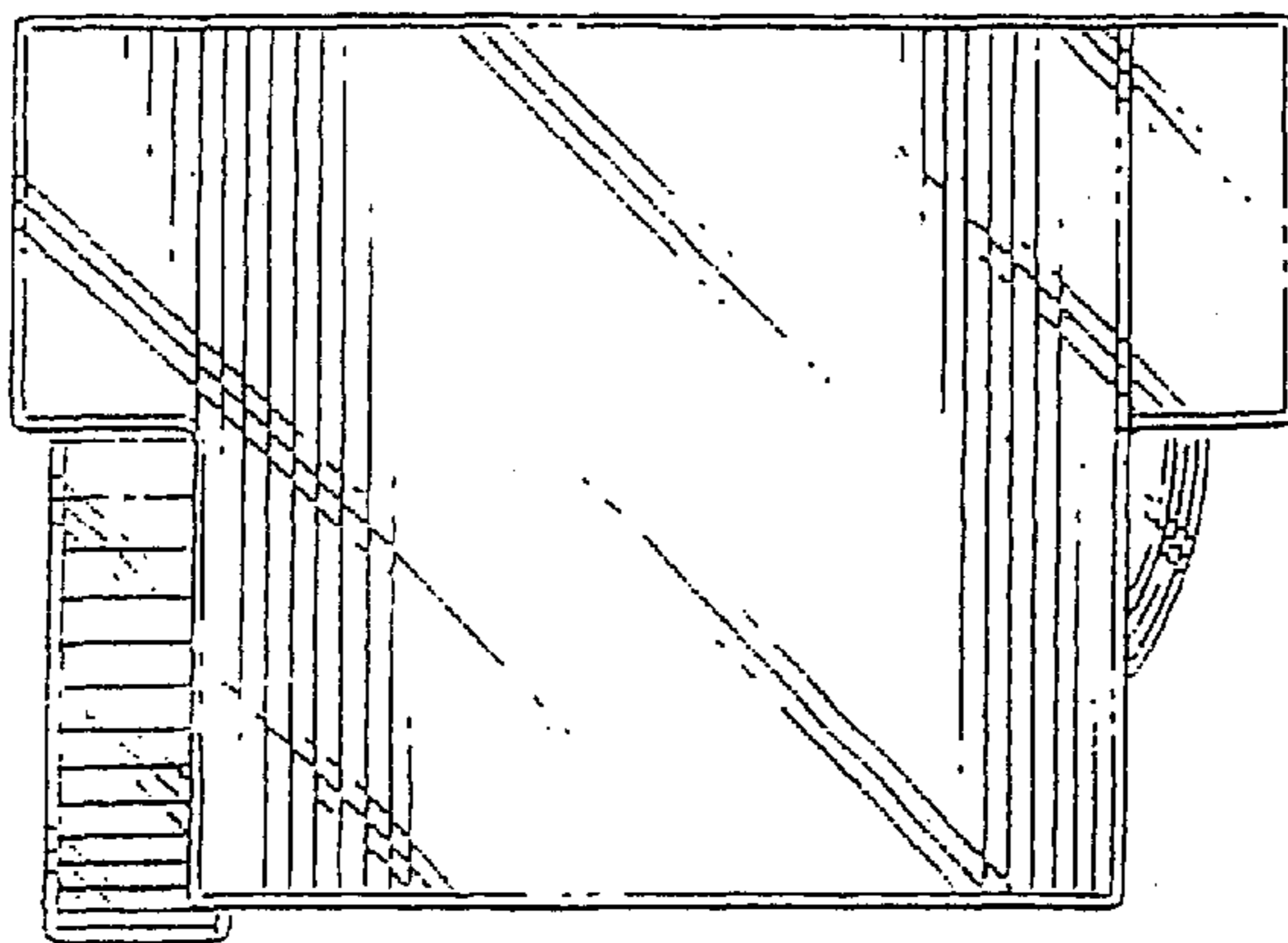

*FIG. 5*