



US00D473826S

(12) **United States Design Patent**
Schlangen et al.

(10) **Patent No.:** **US D473,826 S**

(45) **Date of Patent:** **** Apr. 29, 2003**

(54) **MODULAR PERSON TRANSPORT CHAIR**

(57) **CLAIM**

(75) Inventors: **Phillip E. Schlangen**, Minneapolis, MN (US); **Paul R. Lawson**, Jordan, MN (US); **William L. Eshleman**, Jordan, MN (US)

The ornamental design of a modular person transport chair, as shown and described.

DESCRIPTION

(73) Assignee: **Kurt Manufacturing Company**, Minneapolis, MN (US)

FIG. 1 is a perspective view of the modular person transport chair of our new design;
FIG. 2 is a top plan view thereof;
FIG. 3 is a front elevational view thereof;
FIG. 4 is a rear elevational view thereof;
FIG. 5 is a side elevational view of the right side thereof;
FIG. 6 is a side elevational view of the left side thereof;
FIG. 7 is a bottom plan view thereof;
FIG. 8 is an exploded perspective view of the chair of FIG. 1 without the seat and back rest;
FIG. 9 is a perspective view of a modification of the modular person transport chair of my new design;
FIG. 10 is a top plan view of FIG. 9;
FIG. 11 is a front elevational view of FIG. 9;
FIG. 12 is a rear elevational view of FIG. 9;
FIG. 13 is a side elevational view of the right side of FIG. 9;
FIG. 14 is a side elevational view of the left side of FIG. 9;
FIG. 15 is a bottom plan view of FIG. 9; and,
FIG. 16 is an exploded perspective view of the chair of FIG. 9 without the seat and back rest.

(**) Term: **14 Years**

(21) Appl. No.: **29/141,937**

(22) Filed: **May 17, 2001**

(51) **LOC (7) Cl.** **12-12**

(52) **U.S. Cl.** **D12/131**

(58) **Field of Search** **D12/128-133;**
280/5.26, 5.28, 5.24, 250.1, 647, 648; 180/8.2,
907

(56) **References Cited**

U.S. PATENT DOCUMENTS

- D359,260 S * 6/1995 Shriver D12/131
- D430,078 S * 8/2000 Ellis et al. D12/131

* cited by examiner

Primary Examiner—Marcus A. Jackson

1 Claim, 16 Drawing Sheets

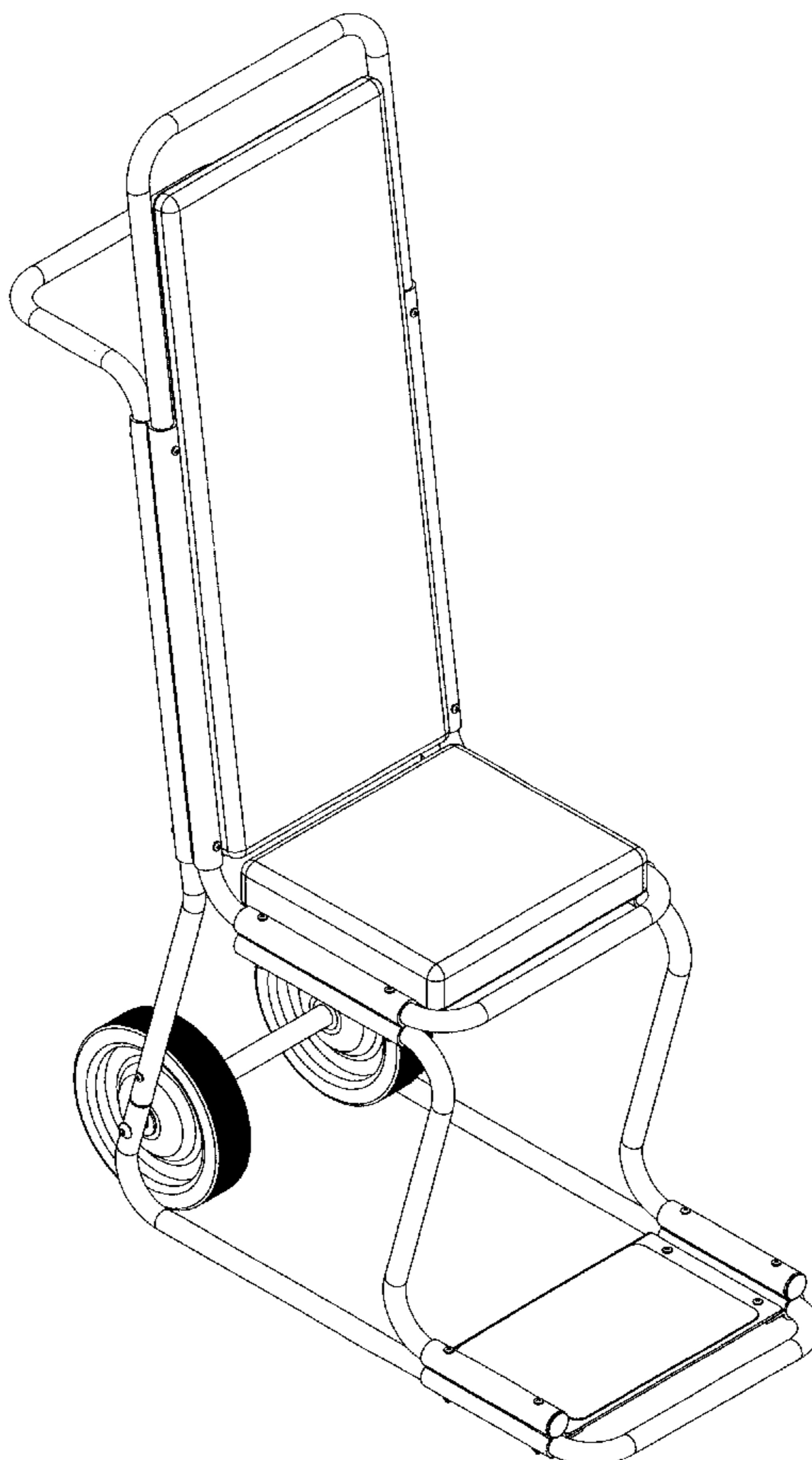
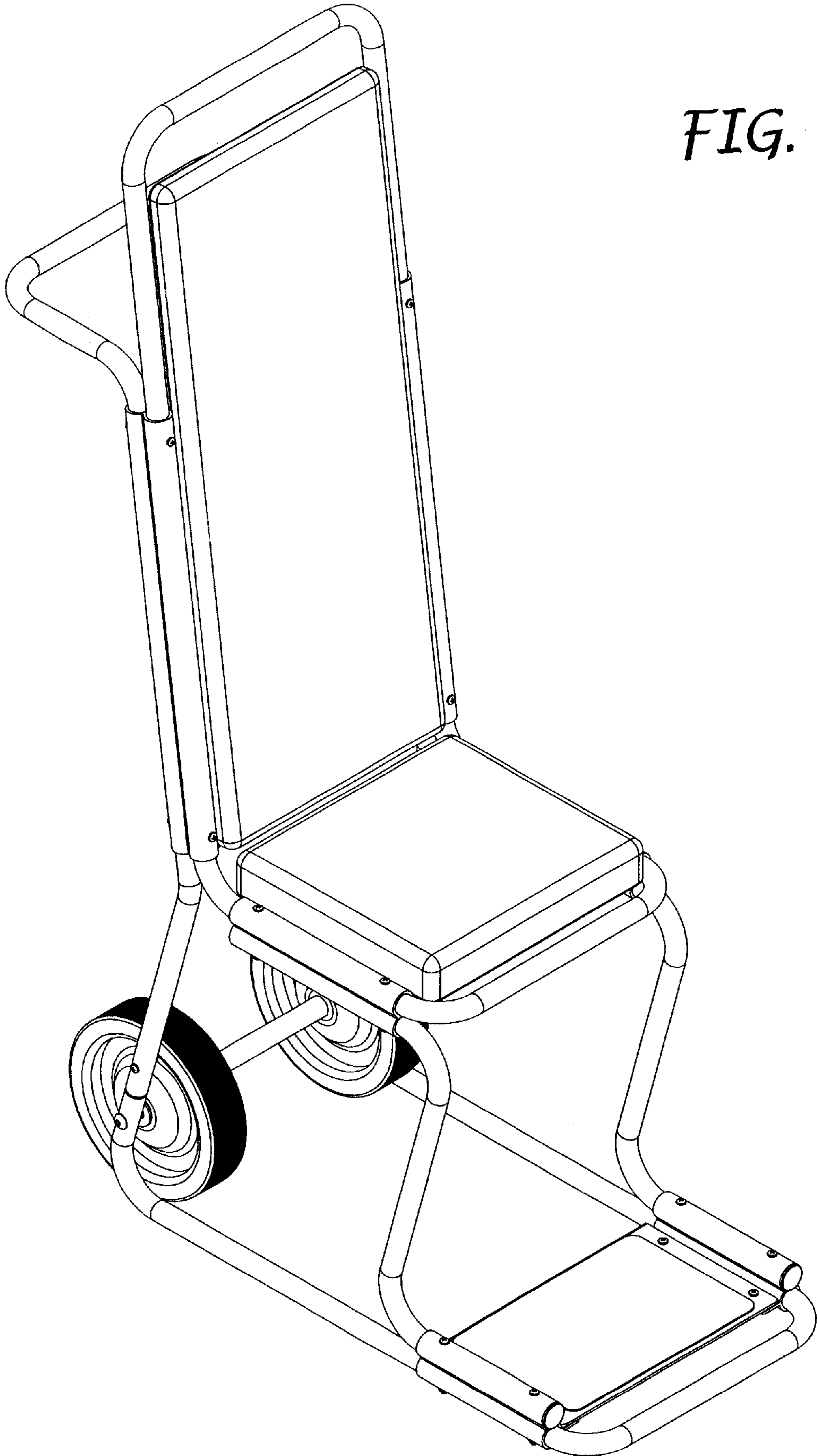

FIG. 1



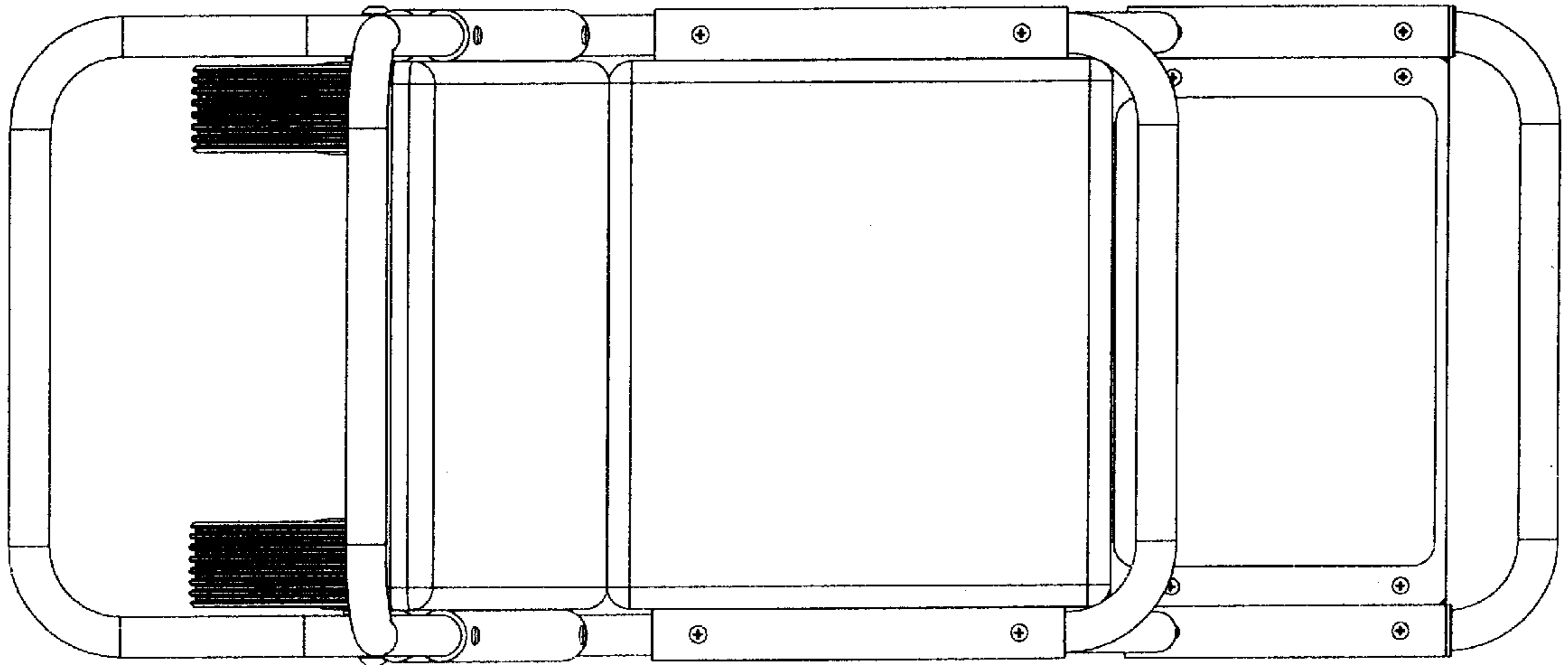

FIG. 2

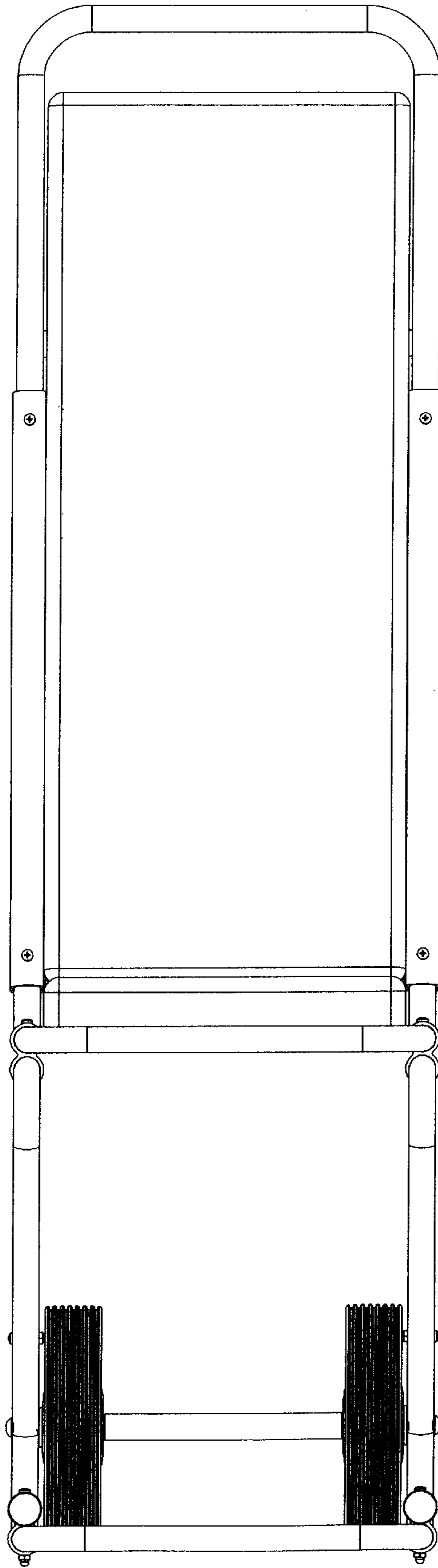

FIG. 3

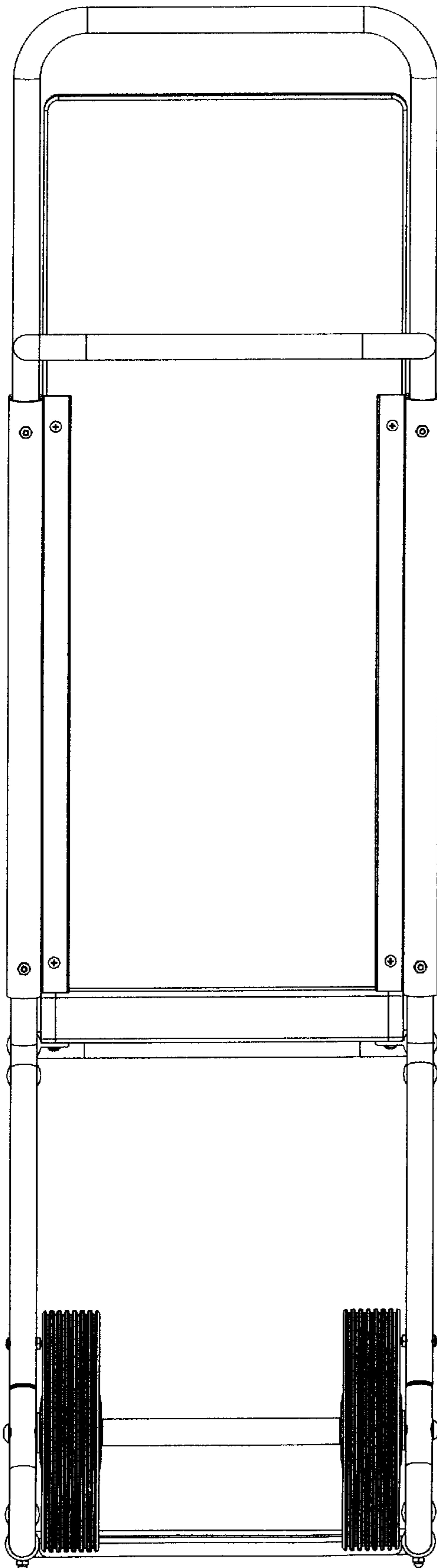

FIG. 4

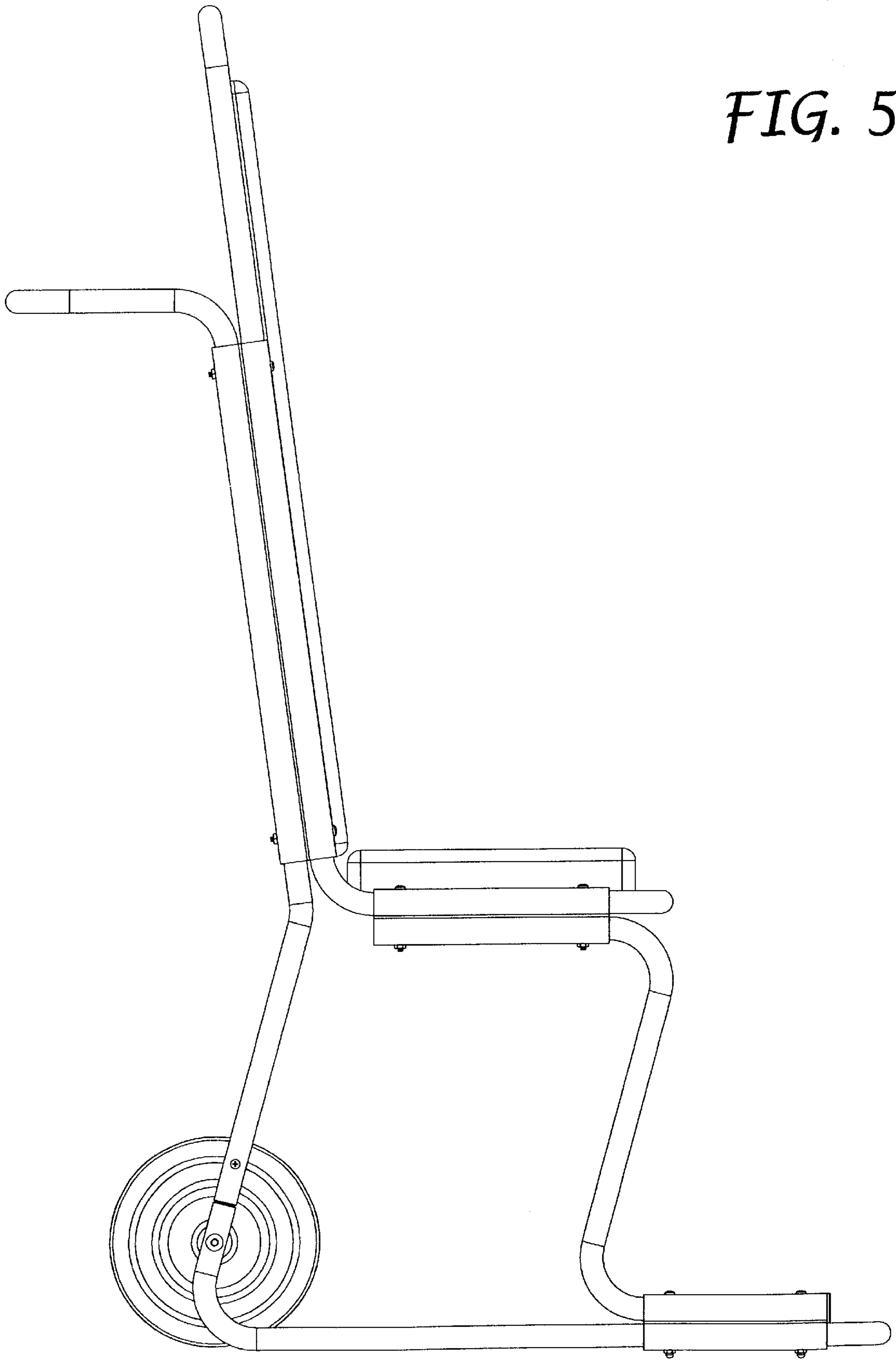
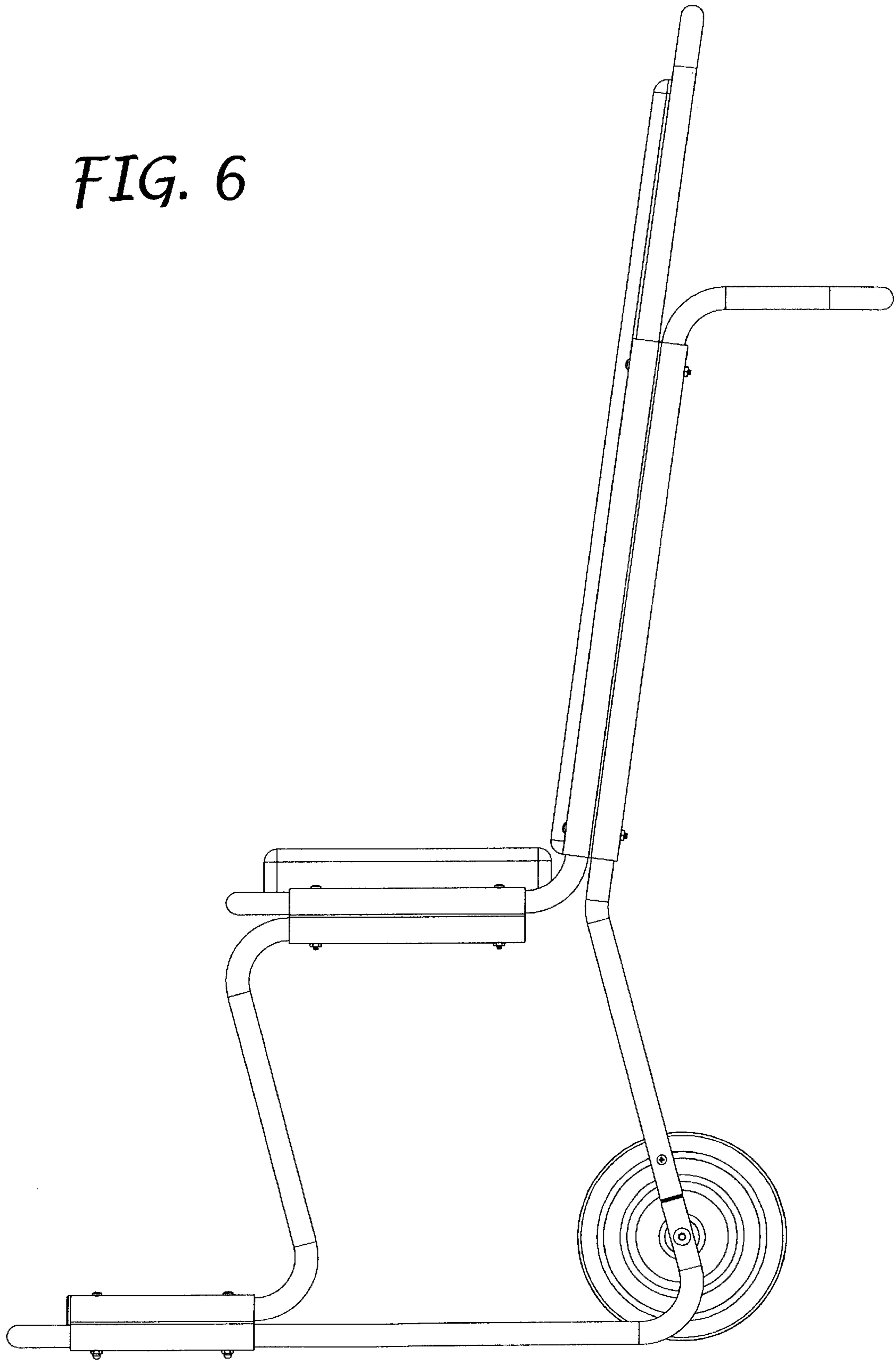

FIG. 5

FIG. 6



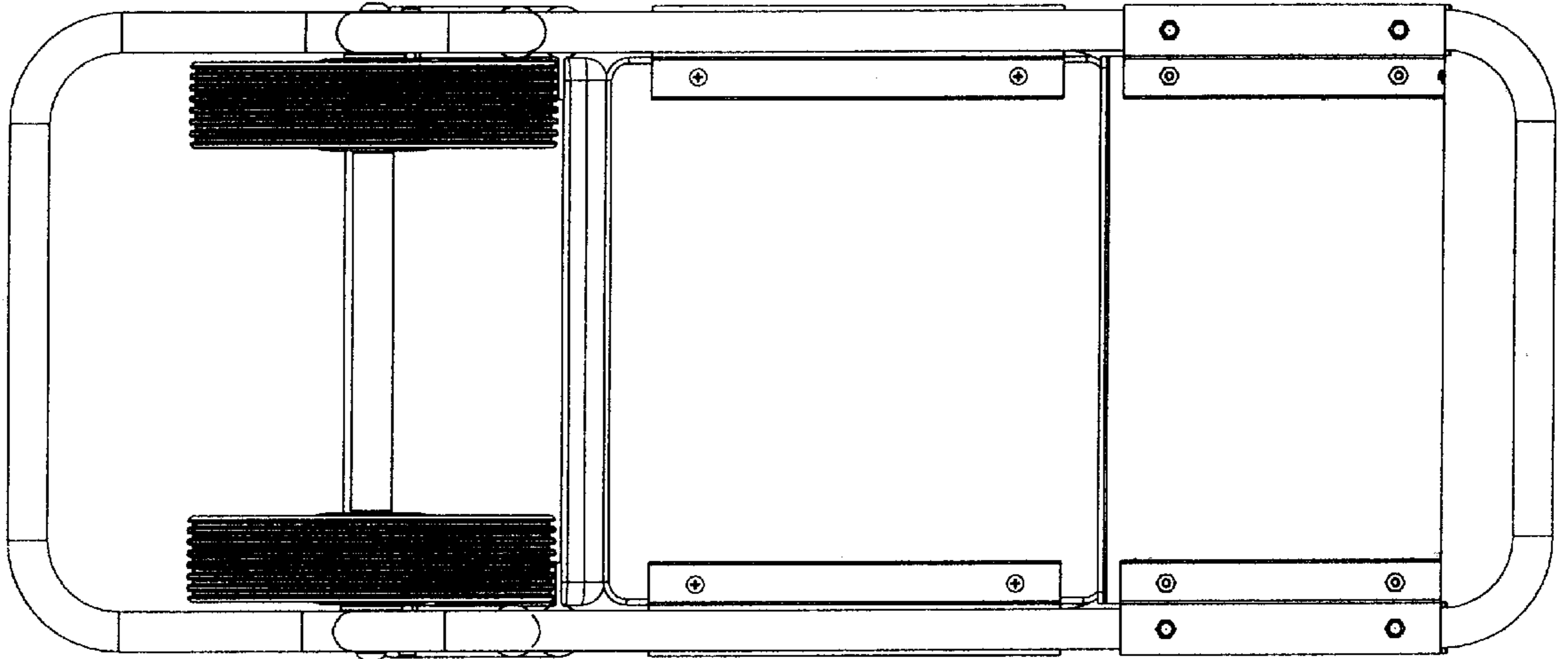
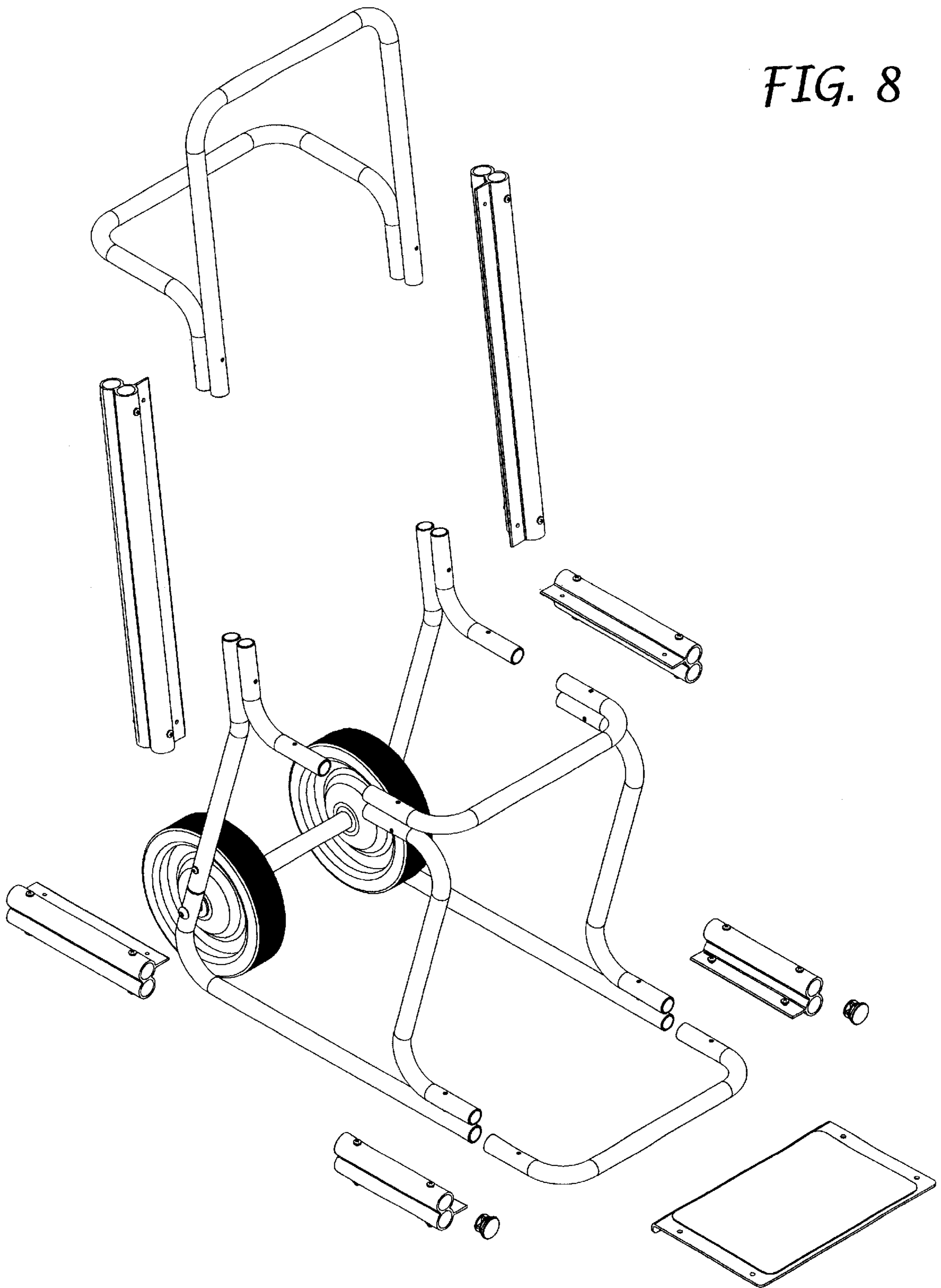

FIG. 7



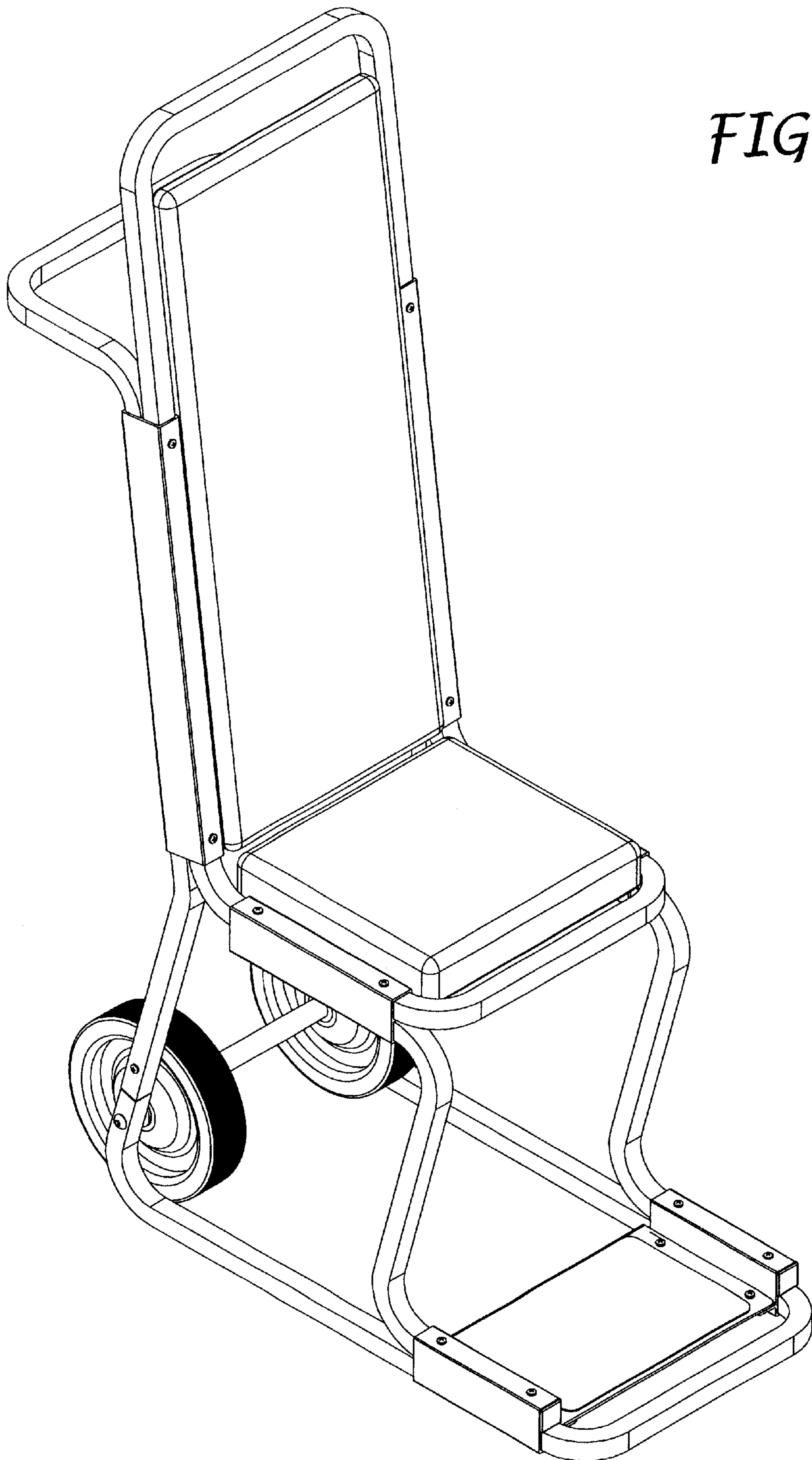

FIG. 9

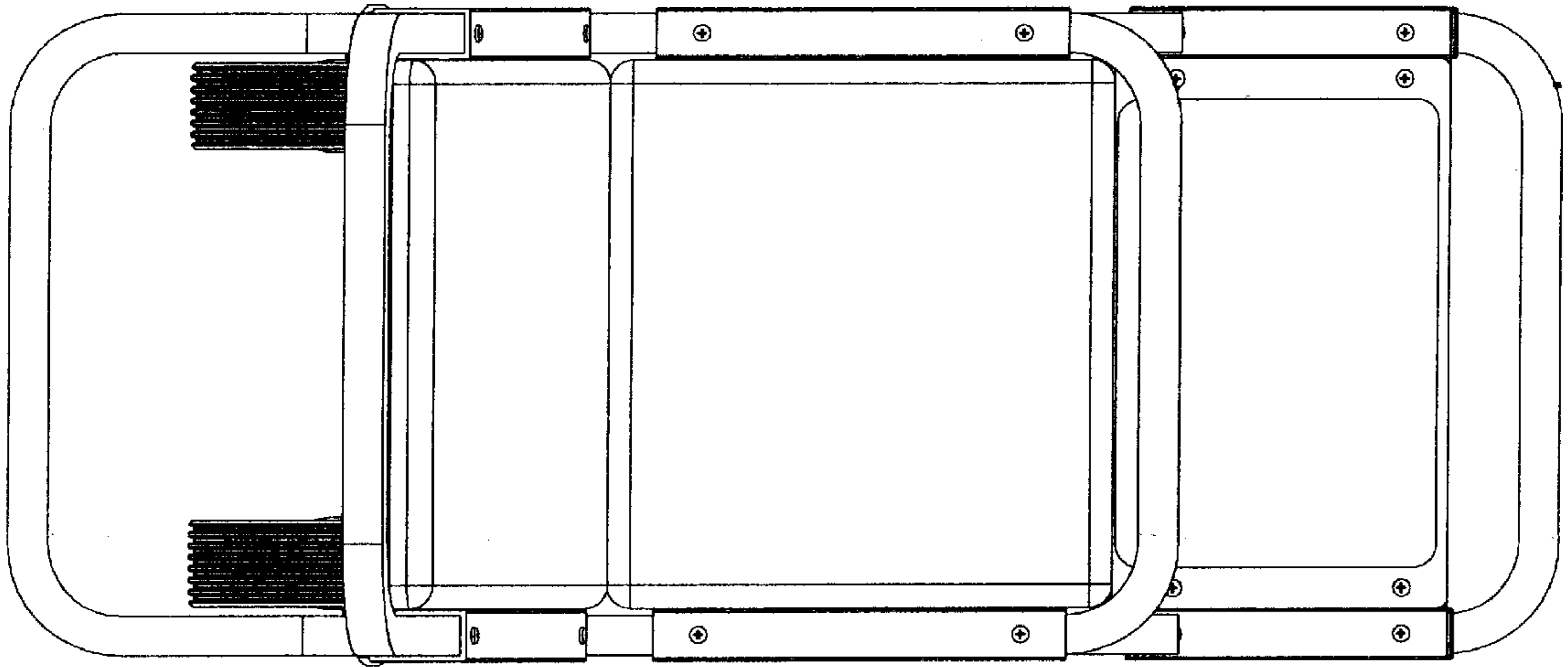

FIG. 10

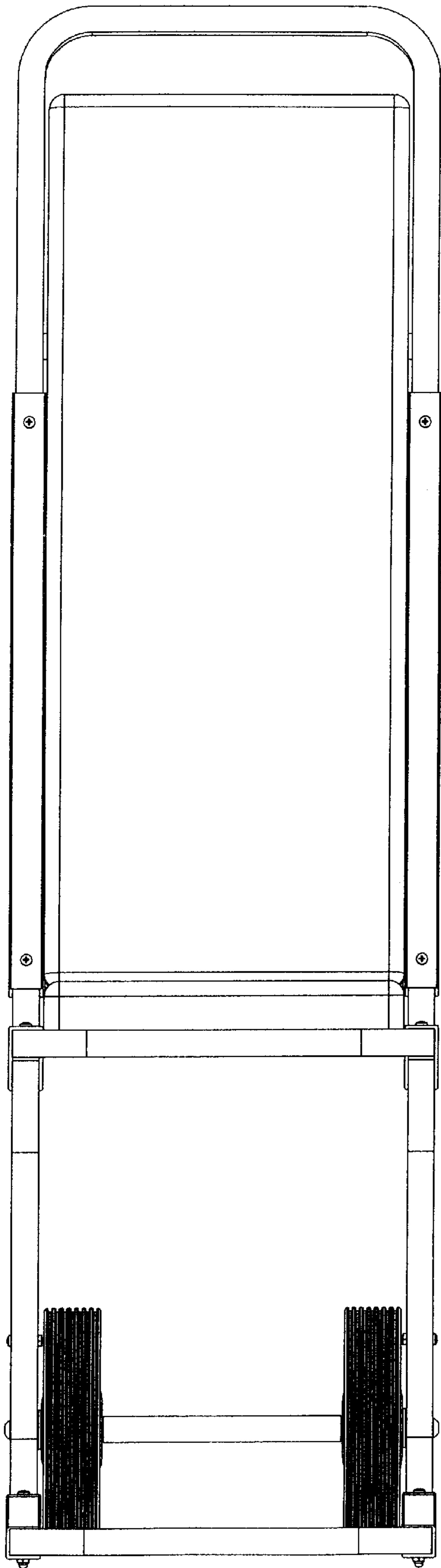

FIG. 11

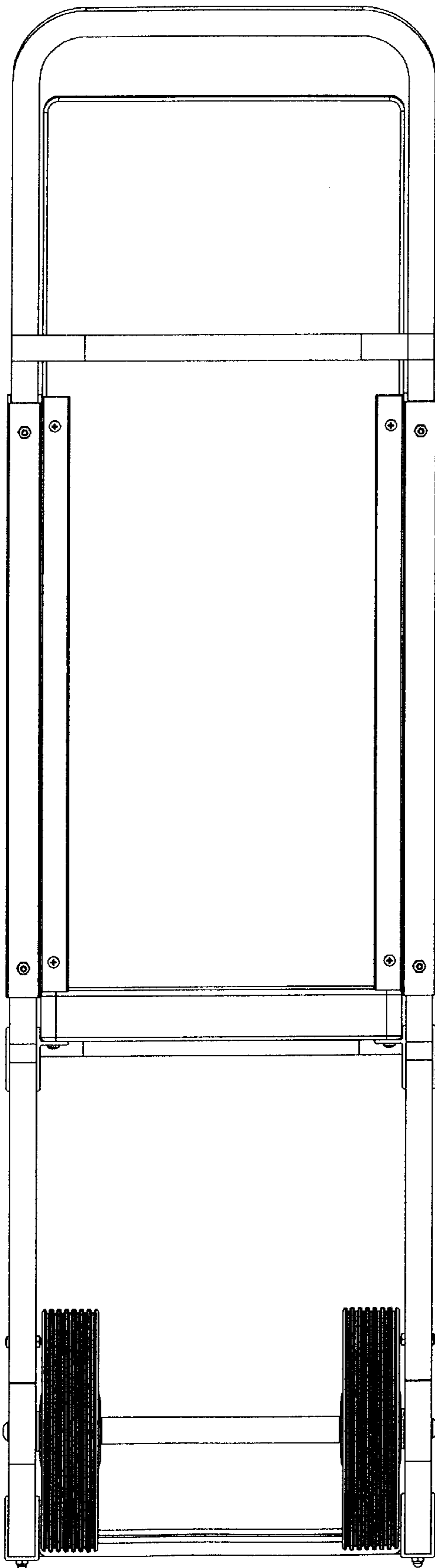

FIG. 12

FIG. 13

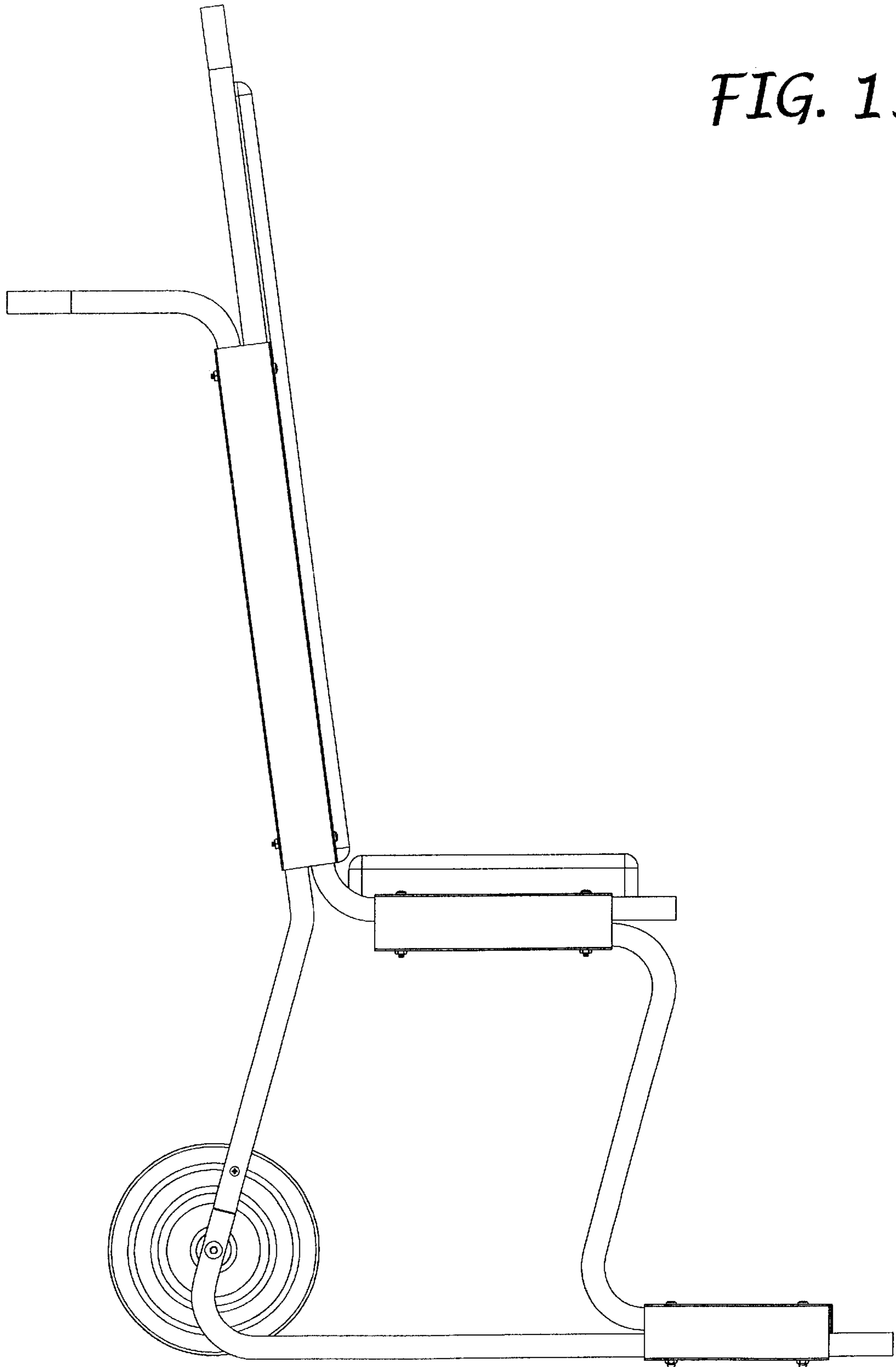
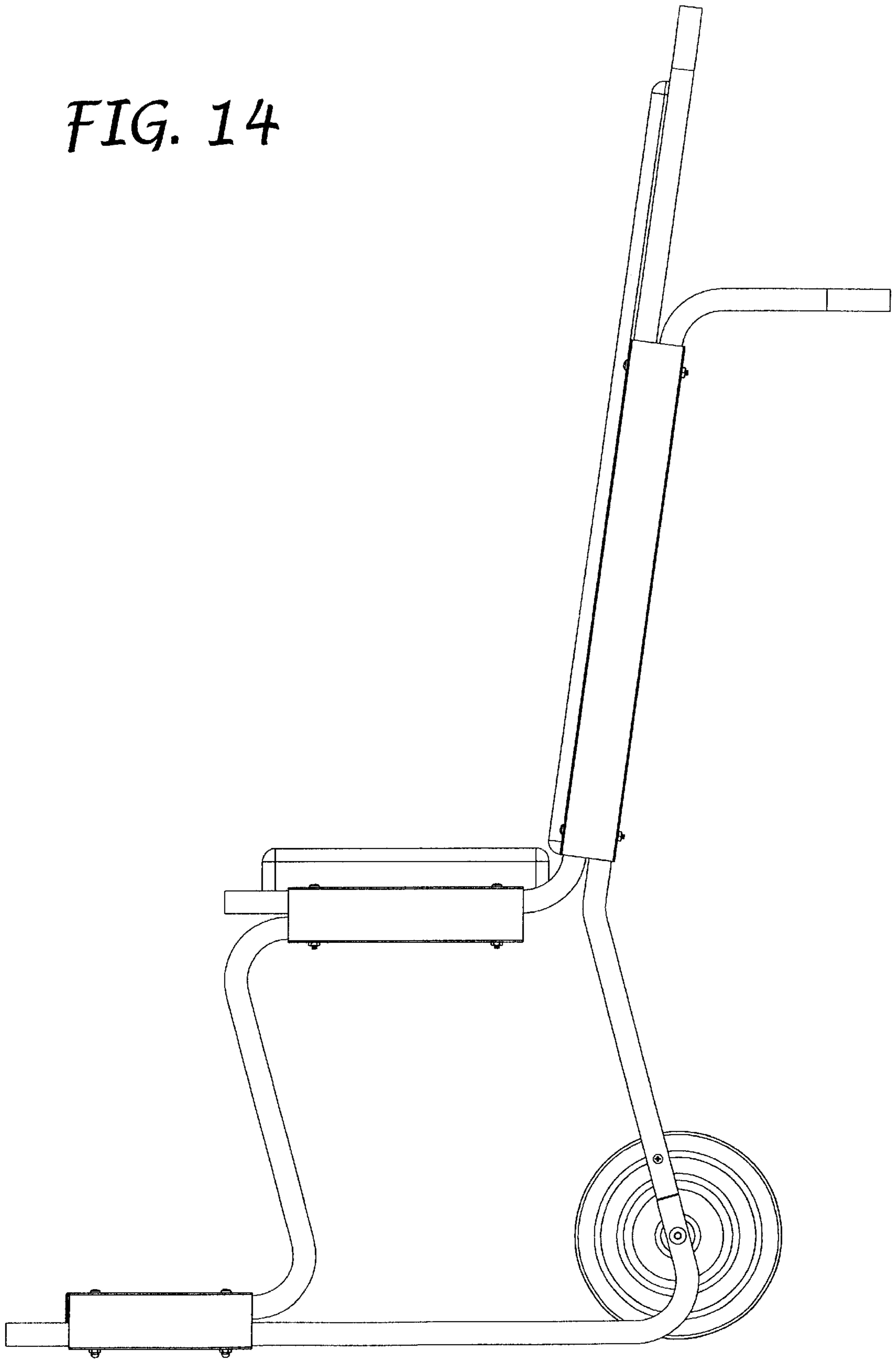

FIG. 14



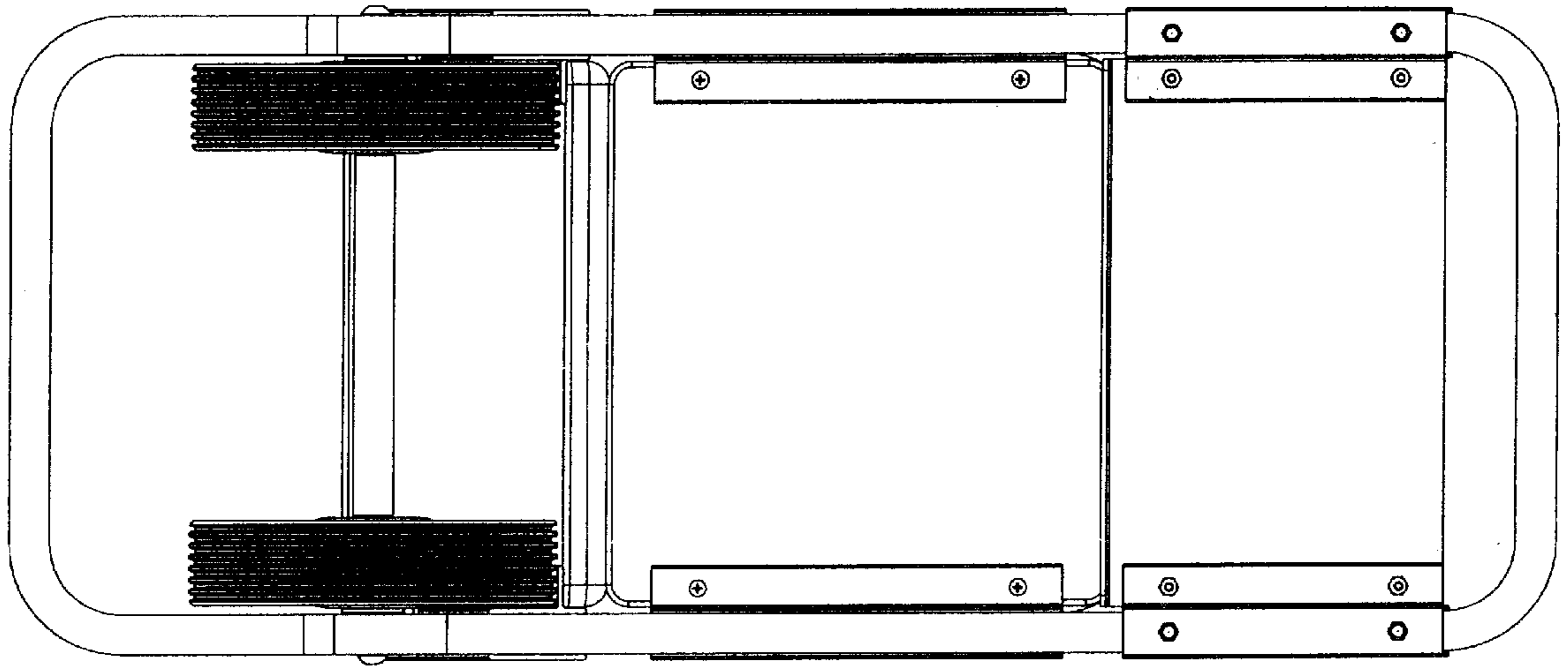

FIG. 15

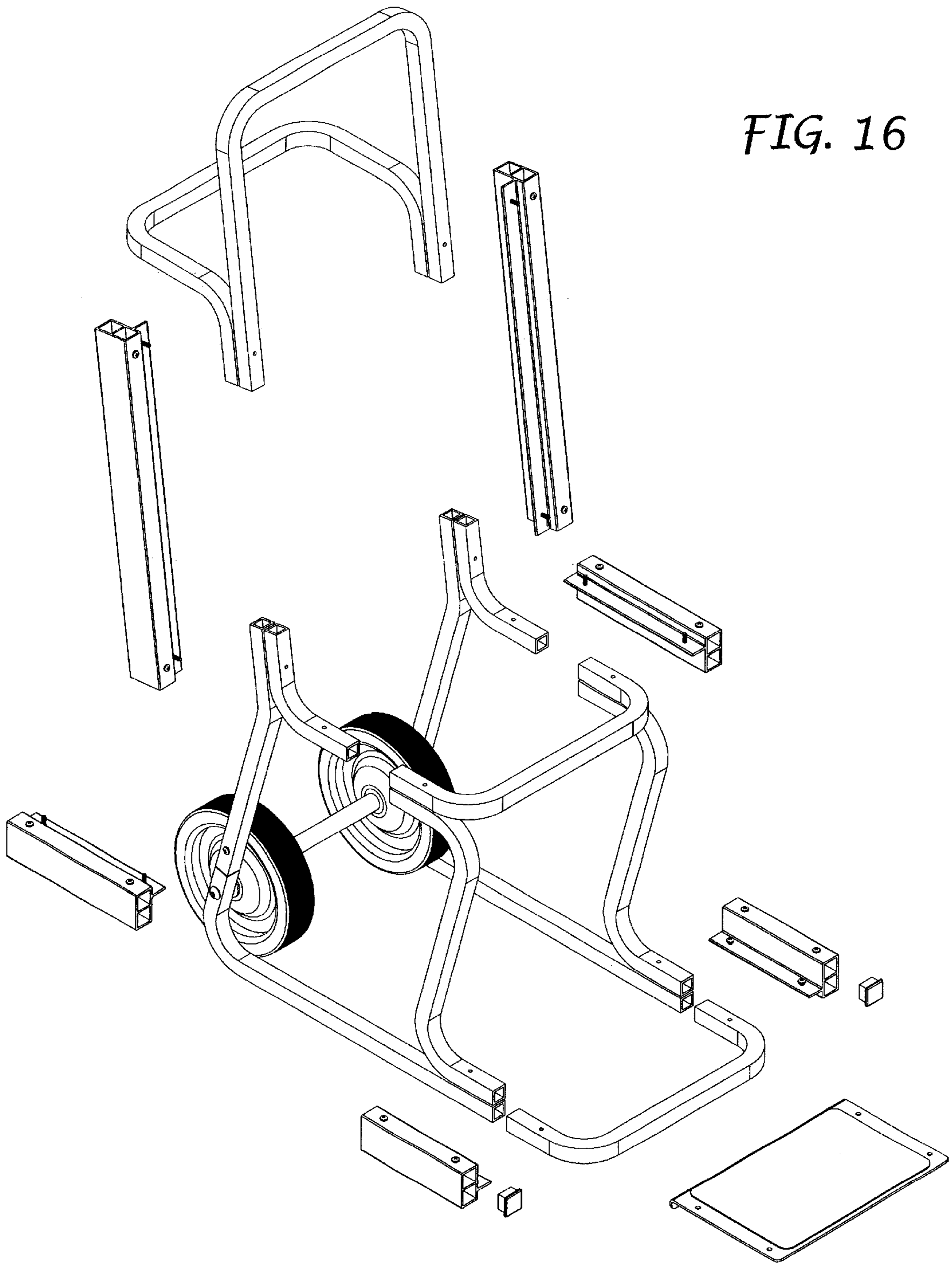

FIG. 16